

RESERVE ACTION SHEET: REGIONAL PARKS CONSERVATION RESERVES

RESERVE No. 44838

LOCAL GOVERNMENT: City of Busselton

NAME:

PURPOSE: Nature Reserve (Conservation of Flora and Fauna)

VESTING: Department of Parks and Wildlife

ACTION: Addition of Lots 8000 and 8001 to R44838.

Total Area: 20.2850 ha

REASON FOR ACTION:

Lots 8000 and 8001 were created as a condition of subdivision (Western Australian Planning Commission 152152 Condition 15), for addition to wetlands reserve in accordance with the Busselton Wetlands Conservation Strategy (WAPC October 2005). The reserve is to be added to existing Nature Reserve R44838, which is vested with the Conservation and Parks Commission's predecessor.

Date of amendment: 5/12/2016

Maps: p. 28

Customer advice: p. 33

Proposal Summary: see pp. 36-45

Recommended IUCN classification: 1a

File: 2015/001852

1	LAND UNIT	Provide populated RAS, customer advice, Reserve Enquiry Detail (RED) to Catherine Prideaux at Regional Parks.	VW 14/3/17
2	REGIONAL PARKS	Complete unpopulated sections above, provide map and proposal summary. Return to Land Unit.	TT 21/3/17
3	LAND UNIT LEADER	To note	
4	LAND UNIT	Send scan of RAS, customer advice, Reserve Enquiry Detail (RED) and maps to: <ul style="list-style-type: none"> • Lisa Wright (Kensington) DIGITAL COPY • Regional Manager DIGITAL COPY • Geoffrey Banks GIS Branch DIGITAL COPY Check and strikethrough from District Proposals spreadsheets Create Conservation Commission summary	VW 21/3/17
			VW 21/3/17
			VW 21/3/17
			VW 21/3/17
			VW 21/3/17
5	DIRECTOR, PARKS AND VISITOR SERVICES	To note	
6	C.I.S.	Please rename file/create new file Keyword: Activity: Subject: Free text:	N/A

**Customer Advices for Reserve Actions
1/02/2017 - 28/02/2017**

City of Busselton 1/02/2017 - 28/02/2017

Reserve No.	Land Description	DoL File No.	Volume/Folio	Action	Document No.	Registered	Street Name	Area	Public Plans
43244	Lot 4985 on Deposited Plan 19168	01989-1994-01RO	3103-945 3103-945	Change of Purpose to "Public Recreation and Drainage"	N512841	19/12/2016	Windlemere Drive, Dunsborough	1376 sqm	
43244	Lot 8000 on Deposited Plan 403468	01989-1994-01RO	3165-25 3165-25	Amendment of Reserve to add Lot 8000 on Deposited Plan 403468 and its area being increased to 1396 meters square accordingly.	N512842	19/12/2016	Windlemere Drive, Dunsborough	1396 sqm	
43244 43244		01989-1994-01RO	3103-945 3165-25	Management Order to Shire of Busselton of LOCKED BAG 1 BUSSELTON WA 6280 for the designated purpose of "Public Recreation"	N512843	19/12/2016	Windlemere Drive, Dunsborough	1396 sqm	
43244		01989-1994-01RO	3103-945	?	N512840	19/12/2016	Windlemere Drive, Dunsborough	1376 sqm	
44836	Lot 8000 on Deposited Plan 407525 Lot 8001 on Deposited Plan 407525	01571-1995-01RO	3167-302 3167-303	Amendment of Reserve to add Lots 8000 and 8001 on Deposited Plan 407525 and its area being increased to 122.6367 hectares, accordingly.	N501234	05/12/2016	adj Wonnerup Estuary, Wonnerup	122.6367 Ha	
45170	Lot 5209 on Plan 22630 Lot 5210 on Plan 22191	02846-1996-01RO	3089-980 3090-272	Amendment of Reserve to add Lot 5209 on Plan 22630 and Lot 5210 on Plan 22191 and its area being increased to 21015 sqm accordingly.	N527033	10/01/2017	College Av, West Busselton	21015 sqm	
45810	Lot 5223 on Plan 23070	01083-1999-01RO	3114-157	Management Order to City of Busselton of LOCKED BAG 1 BUSSELTON WA 6280 To be utilised for the designated purpose of "Public Recreation" only, for the designated purpose of "Public Recreation"	N506712	12/12/2016	Spinnaker Bvd, Geographe	675 sqm	
46071	Lot 5085 on Plan 21425	02037-1996-01RO	3107-870	Management Order to City of Busselton of LOCKED BAG 1 BUSSELTON WA 6280 To be utilised for the designated purpose of "Public Recreation" only, for the designated purpose of "Public Recreation"	N523590	04/01/2017	Pebble Dr, Geographe	7462 sqm	
47818	Lot 34 on Deposited Plan 24493	50290-2004-01RO	3128-783	Management Order to City of Busselton of LOCKED BAG 1 BUSSELTON WA 6280 To be utilised for the designated purpose of "Public Recreation" only, for the designated purpose of "Public Recreation"	N524550	05/01/2017		33695 sqm	
48100	Lot 5557 on Deposited Plan 37401	50462-2004-01RO	3135-249	Management Order to City of Busselton of LOCKED BAG 1 BUSSELTON WA 6280 To be utilised for the designated purpose of "Public Recreation" only, for the designated purpose of "Public Recreation"	N506709	12/12/2016	Butterworth Springs Av, Dunsborough	255 sqm	
48101	Lot 5558 on Deposited Plan 37401	50463-2004-01RO	3135-247	Management Order to City of Busselton of LOCKED BAG 1 BUSSELTON WA 6280 To be utilised for the designated purpose of "Public Recreation" only, for the designated purpose of "Public Recreation"	N506708	12/12/2016	Butterworth Springs Av, Dunsborough	3270 sqm	

Reserve Enquiry Detail [5100L]

Screen Friendly Pr

Reserve	44838	Legal Area (ha)	122.6367
Name		Status	Current
Type	Subject to 20 A & 152	Current Purpose	CONSERVATION OF FLORA AND FAUN
Notes			
File Number	1571/1995		
Additional Reserve Information	RESERVE COMPRISES LOT 5015 ON D85801, LOT 5907 ON P18664, LOT 37 ON DP4011, LOTS 8000 & 8001 ON DP407525 (N501234)		

Class	Responsible Agency	Date of Last Change
C	DEPARTMENT OF PARKS AND WILDLIFE	06/02/2017

Management Orders	Document	Land Use	Local Government Authc
NATIONAL PARKS AND NATURE CONSERVATION AUTHORITY		CONSERVATION FAUNA PROTECTION OF FLORA	BUSSELTON, CITY OF

Add Item	CLT Number	Parcel Identifier	Street Address	Suburb	File Number	PIN	Area (sqm)	Map
<input type="checkbox"/>	LR3103-2	Lot 5015 On Diagram 85801			01571-1995-01RO.	1099178	10418.0	
<input type="checkbox"/>	LR3113-269	Lot 5907 On Plan 18664			01571-1995-01RO.	1099182	311213.0	
<input type="checkbox"/>	LR3165-19	Lot 37 On Plan 401181			01571-1995-01RO	12103416	690173.0	
<input type="checkbox"/>	LR3165-19	Lot 37 On Plan 401181			01571-1995-01RO	12103421	11713.0	
<input type="checkbox"/>	LR3167-302	Lot 8000 On Plan 407525			01571-1995-01RO	12251074	198584.0	
<input type="checkbox"/>	LR3167-303	Lot 8001 On Plan 407525			01571-1995-01RO	12251078	4266.0	

Reserve Number 44838

Previous Certificates of Title	Historic Crown Allotments
LR3105-790 Cancelled	SUSSEX Location 5015 WELLINGTON Location 5907

Gaz Page/Document	Date	Type	Text
N501234	05/12/2016	Current Area	122.6367
N33136	18/06/2015	Historical Area	102.3517
H260915	26/10/1999	Historical Area	32.1631
H260915	26/10/1999	Location	SUSSEX LOC 5015 & WELLINGTON LOC 5907
H260915	26/10/1999	Public Plan	BF30 (10) 6.1
H260915	26/10/1999	Street Name	FORREST BEACH ROAD
H260915	26/10/1999	Survey Number	LTO:PLANS 85801 & 18664
2248	06/05/1997	Class	C
2248	06/05/1997	Current Purpose	CONSERVATION OF FLORA AND FAUNA
2248	06/05/1997	Correspondence File Number	1571/1995
2248	06/05/1997	Historical Area	1.0418
2248	06/05/1997	Original Gazettal and page	ORIGINAL GAZETTE
	06/05/1997	Current Vesting	VEST:NATIONAL PARKS& NATURE CONSERVAT AUTHORITY

VER.	AMENDMENT	AUTHORISED BY	DATE
2	Landgate Audit Amendments	Malcolm Cockman	16/8/2016

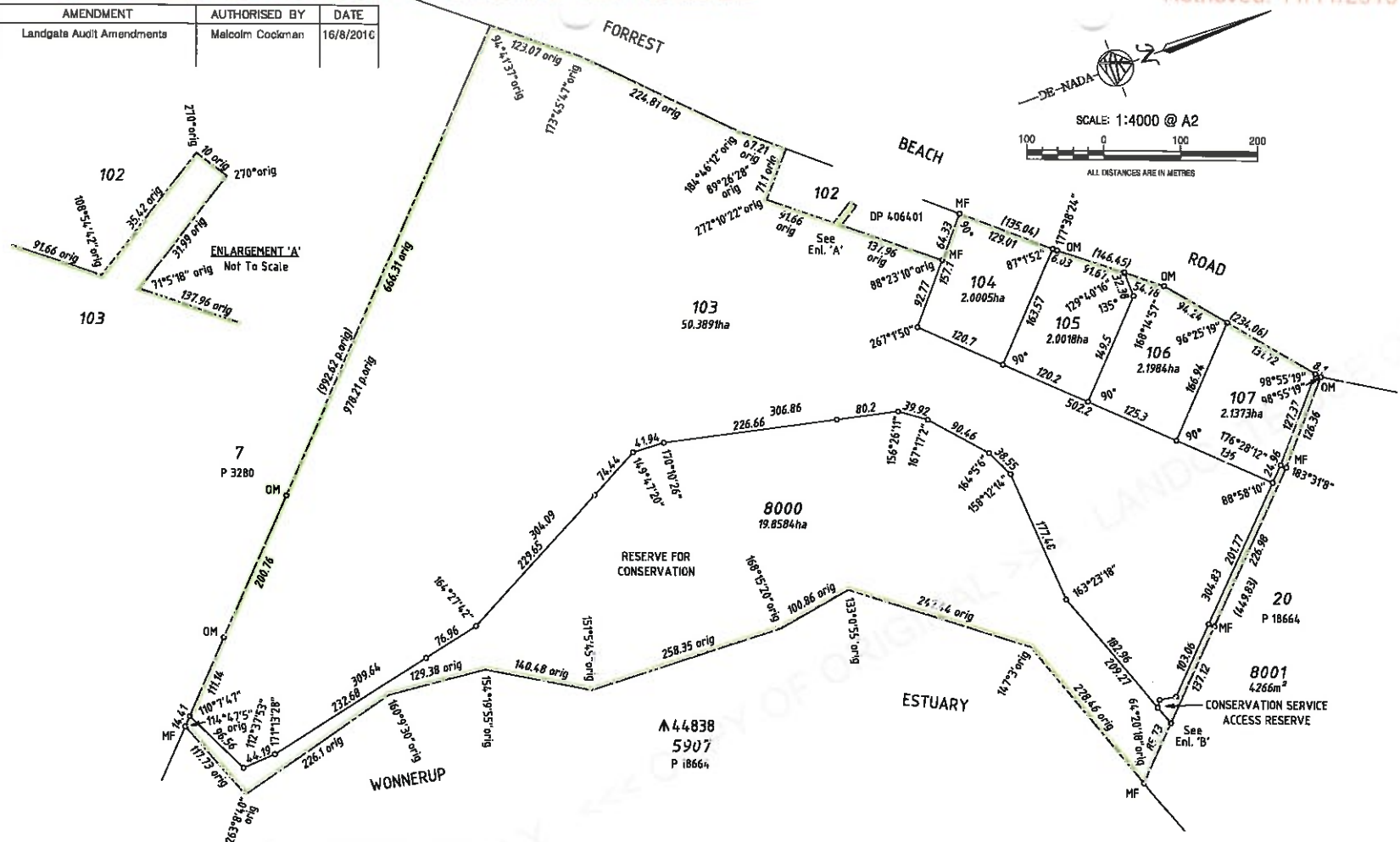

TYPE	FREEHOLD	S.S.A. NO
PURPOSE	SUBDIVISION	
PLAN OF	LOTS 103-107, 8000 AND 8001	
FORMER TENURE	LOT 101 ON DP 406401 C.T. 2902/652	
LOCAL AUTHORITY	CITY OF BUSSELTON	
LOCALITY	WONNERUP	
D.O.L. FILE		
FIELD RECORD	134786	
SURVEYOR'S CERTIFICATE - REG 54	I, MALCOLM GEORGE COCKMAN hereby certify that this plan is accurate and is a correct representation of the - (a) survey; and/or (b) calculations from measurements recorded in the field records, (+ delete if inapplicable) undertaken for the purposes of this plan and that it complies with the relevant written law(s) in relation to which it is lodged.	
Date:	2016.06.16	8-Aug-16
LICENSED SURVEYOR		DATE
LOGGED		
DATE	16.08.2016	ASSESS No.
I.S.C.		
EXAMINED	E. Mikowka	16.08.2016
DATE		
WESTERN AUSTRALIAN PLANNING COMMISSION		
FILE	152152	
Delegated Under S.16 P&D Act 2005		16-Aug-2016
DATE		
IN ORDER FOR DEALINGS		
SUBJECT TO	SEC 152 OF THE P&D ACT SEC 165 OF THE P&D ACT	
FOR INSPECTOR OF PLANS AND SURVEYS		17.08.2016
DATE		
APPROVED		
FOR INSPECTOR OF PLANS AND SURVEYS		18.8.2016
DATE		
GOVERNMENT OF WESTERN AUSTRALIA DEPOSITED PLAN 407525 SHEET 1 OF 1 SHEETS VERSION 2		

INTERESTS & NOTIFICATIONS

SUBJECT	PURPOSE	STATUTORY REFERENCE	ORIGIN	LAND BURDENED	BENEFIT TO	COMMENTS
LOT 8000	RESERVE FOR CONSERVATION	VESTS IN THE CROWN UNDER SEC 152 OF THE P & D ACT	THIS PLAN			Lot 8000 is "to be added to Crown Reserve 44838 and vested in the Conservation Commission of WA".
LOT 8001	RESERVE FOR CONSERVATION SERVICE ACCESS NOTIFICATION	VESTS IN THE CROWN UNDER SEC 152 OF THE P & D ACT SEC 165 OF THE P & D ACT	THIS PLAN DOC N412167	LOT 103-107		RURAL LAND USE

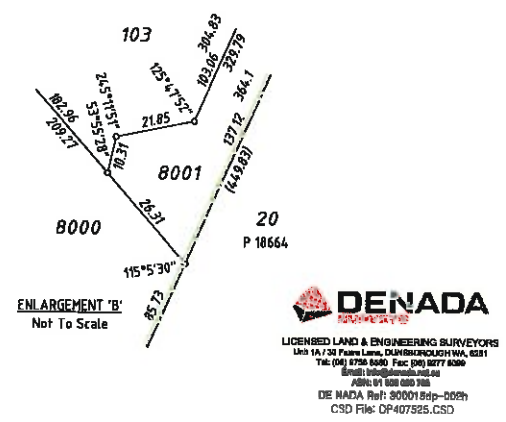



Proposed addition of Lot 8000 and Lot 8001 to Nature Reserve R44838

- Legend**
- Nature Reserve
 - Marine Park

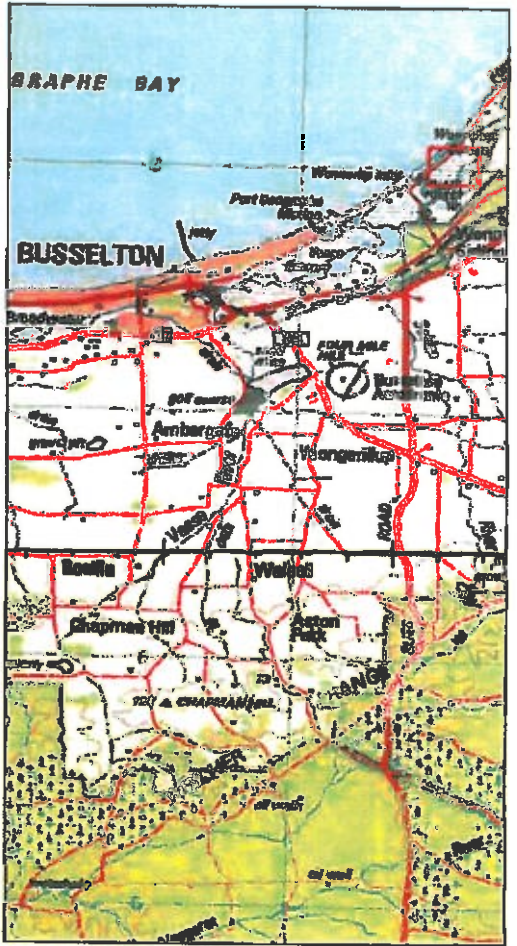

Projection: Universal Transverse Mercator
 MGA Zone 50, Datum: GDA84

Horizontal datum is GDA84. Vertical datum is MGA94.

The Department of Parks and Wildlife does not guarantee that the information contained in this document is correct, complete, or up-to-date. It is provided as a guide only. Users should verify the information contained in this document with the Department of Parks and Wildlife before relying on it for any purpose.



Produced at 250ppm, on No 7 22, 2018