

(MIDWEST REGION)  
(GERALDTON DISTRICT)

Customer Advices for Reserve Actions  
1/06/2014 - 30/06/2014

Shire of Chapman Valley 1/06/2014 - 30/06/2014

2013/001118  
(DEPT FILE Nº 2005F000612)

Reserve No.	Land Description	DoL File No.	Volume/Folio	Action	Document No.	Registered	Street Name	Area	Public Plans
13226	Lot 13 on Deposited Plan 222885 Lot 14 on Deposited Plan 222885 Lot 15 on Deposited Plan 222885 Lot 100 on Deposited Plan 187478	14479-1910-01RO	3026-586 3026-588 3026-595 3026-655 3026-586 3026-588 3026-595 3026-655	Amendment of Reserve to To redescribe Reserve 13226 to now comprise Lot 500 on Deposited Plan 400902 in lieu of Lots 13,14,15 on Deposited Plan 222885 and 100 on Deposited Plan 187478 and its area increased to 6178 metres square accordingly	M587515	25/03/2014		0.6178 sqm	
13226	Lot 13 on Deposited Plan 222885 Lot 14 on Deposited Plan 222885 Lot 15 on Deposited Plan 222885 Lot 100 on Deposited Plan 187478 Lot 501 on Deposited Plan 400902	14479-1910-01RO	0000-000 0000-000 0000-000 0000-000 0000-000 0000-000 0000-000 0000-000	Management Order to Shire of Chapman Valley of PO Box 1, NABAWA WA 6532 for the designated purpose of "	M587516	25/03/2014			
13226; 13226; 13226; 13226	Lot 501 shown as inset lot on Deposited Plan 400902	14479-1910-01RO	3026-655 3026-586 3026-598 3026-595 3026-655	?	M587514	25/03/2014			
40587	Lot 11764 on Diagram 47611	00999-1988-01RO	3142-357	Amendment of Reserve to To now comprise Lots 500, 501 and 502 on Deposited Plan 68468 in lieu of Lot 11764 on Diagram 47611 and its area being decreased to 42.7859 hectares accordingly.	M598040	03/04/2014		42.7859 Ha	
51375	Lot 42 on Deposited Plan 54800	00972-2008-01RO	0000-000	Reserve Creation for the designated purpose of "Nature Reserve".	M598020	03/04/2014		206.4382 Ha	HOWATHARRA (25) N.E. HOWATHARRA (25) S.E.
51376	Lot 31 on Deposited Plan 36396	00681-2000-01RO	0000-000	Reserve Creation for the designated purpose of "Conservation Park".	M598021	03/04/2014	Lot 31 Bray Road, Yetna	747.1932 Ha	HOWATHARA (25) N.E. HOWATHARA (25) S.E.

NEW: CONSERVATION PARK (R51376)  
PREVIOUSLY CFDI 2571/775  
(747.1932 ha)

TO: ALEX ERRINGTON (LAND UNIT),  
ALL DATABASES AMENDED INCLUDING  
TENNIS. RELEVANT DOCUMENT PERTAINING  
TO THIS RESERVE ACTION ON PAGES

WHITE FOLDER - 17/7/14 RD.  
TENNIS - 17/7/14 RD  
SHAPE FILE - 17/7/14 RD  
PROPOSED  
TENURE - NOTIFIED CAROLINE  
BERRYMAN TO AMEND FILE 14/7/14  
RD

Rob DORIA  
TENURE OFFICER  
GIS BRANCH 18/7/14 R.Doria

Landgate MAP VIEWER

Window Show/Hide

Cadastral Parcels

Catalogue (tick box to select) help

- Property View
- Aerial Photography
- Street Maps

Service Details - Property View help

Transparency

Layers Legend Search

Crown Reserve

Number 51376

Search Type New

Submit Reset

Map help

Scale 1: 30,062 Latitude: -28.611633 Longitude 114.688881 [change](#)

1 record selected

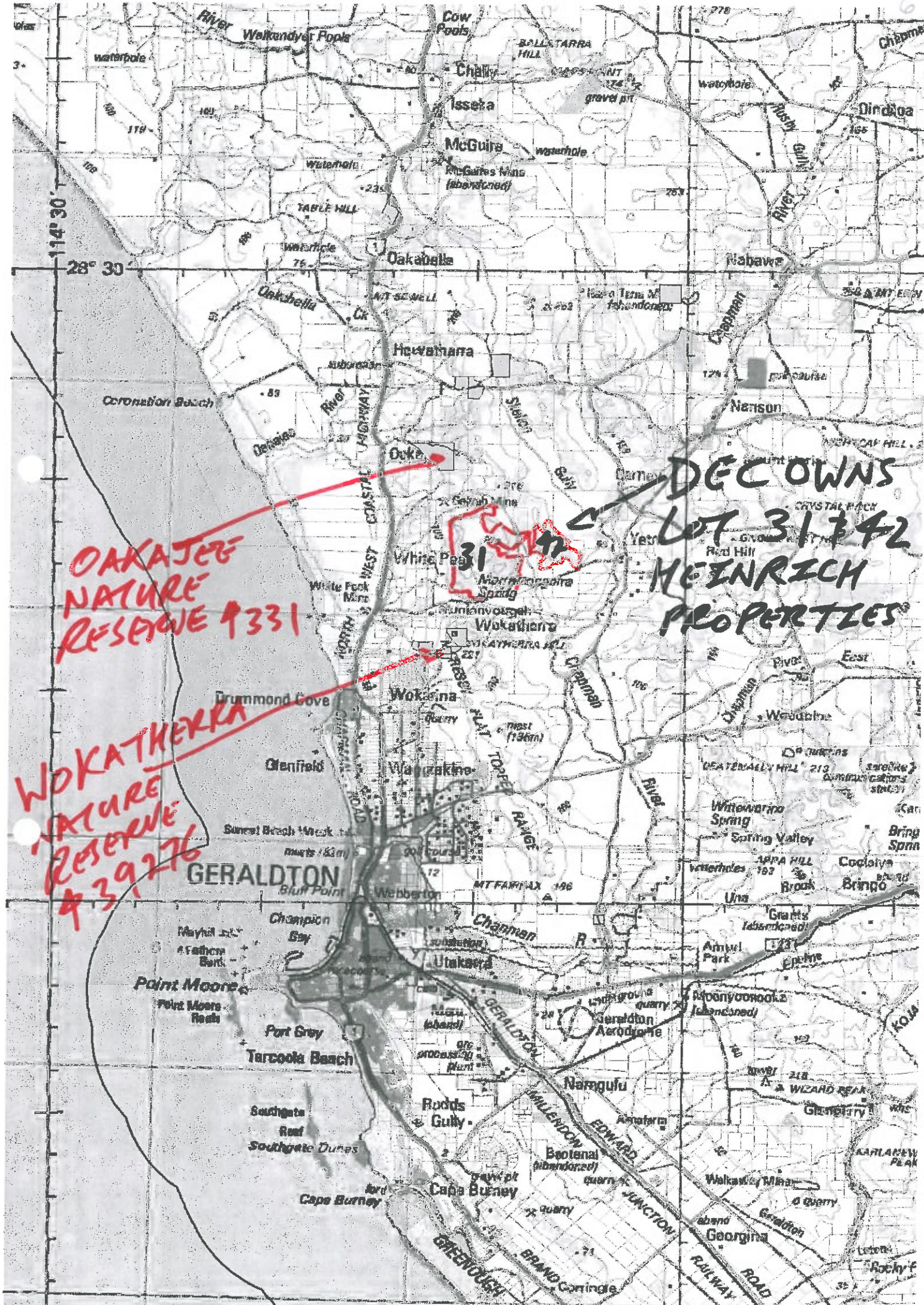

**OKAJEEB  
NATURE  
RESERVE #331**

**WOKATHERRA  
NATURE  
RESERVE  
#39276**

**DEC OWNS  
LOT 31 & 42  
HEINRICH  
PROPERTIES**

**GERALDTON**

**GERALDTON**

**NARGUFU**

**RODGS  
GULFY**

**GEORGINA**

**CAPE BURNEY**

**POINT MOORE**

**TARCOOLA BEACH**

**SOUTHGATE  
DUNES**

**CAPE BURNEY**

**BEOTENAL**

**WALKERLEY MINES**

**BRAND CORRIE**

**ROCKY F**

