

QUADRAT No. BOLD 01 VEGETATION TYPE Chenopium Heath  
 DATE FIRST TRIP 22/10/92 VOLUNTEERS \_\_\_\_\_  
 DATE SECOND TRIP 26/11/92 VOLUNTEERS BJK  
 BOTANIST NG / BJK

**BOLD**

**1. LOCATION of the QUADRAT**

- a. Mud Map Draw a sketch of the location of the quadrat the back of this sheet →
- b. Photograph Photographer's name \_\_\_\_\_
- c. Topographic position - Circle position of quadrat

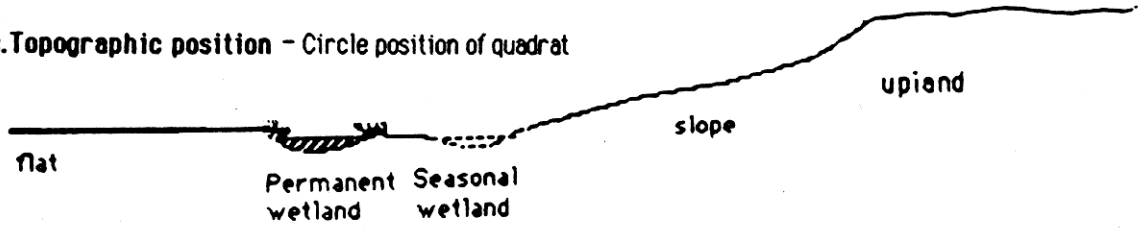

Keighery and Keighery, 1990  
 Adapted from Griffin and Keighery, 1989  
 MOORE RIVER to JURIE SANDPLAIN  
 SURVEY. WILDFLOWER SOCIETY of WA

**2. SITE DATA** - Circle the correct response

Slope flat gentle steep Aspect N NE E SE S SW W NW

% Bare ground \_\_\_\_\_ Drainage well mod poor Wet All year winter/spring

Litter (% cover) \_\_\_\_\_ Surface soil \_\_\_\_\_ Sub-surface soil \_\_\_\_\_

**3. VEGETATION STRUCTURE AND COVER.** Record appropriate cover class

Cover Class - percentage classes

over 70%		<b>TREES</b>		<b>MALLEES</b>	
LIFE FORM	or > 15m 5-15m  	Under 5m  	MALLEE SHRUB less than 8m  	MALLEE TREE 8m or more  	15m 10m 5m
COVER CLASS (%)	> 15m 5-15m				

		<b>SHRUBS</b>				
LIFE FORM	Chenopium over 2m ← Calothrix good Olea sp.  	2.0-1.5m  	1.5-1.0m  	1.0m - .5m Grew critch Acacia  	under 5m  	3m 2m 1m
COVER CLASS (%)		30-50%		30-50%		

Height (metres)

	<b>BUNCH GRASSES</b>	<b>HERBS</b>	<b>SEDGES</b>		
LIFE FORM	Eriophorum caly Stiparia Burchardia Lycopodium under .5m (Not dense)  	Conocarpus under .5m (except creepers)  	over .5m  	under .5m  	2.0m 1.5m 1.0m .5m
COVER CLASS (%)	30-50%	2-10%			

**1. LOCATION of the QUADRAT**

a. Mud Map Draw a sketch of the location of the quadrat:

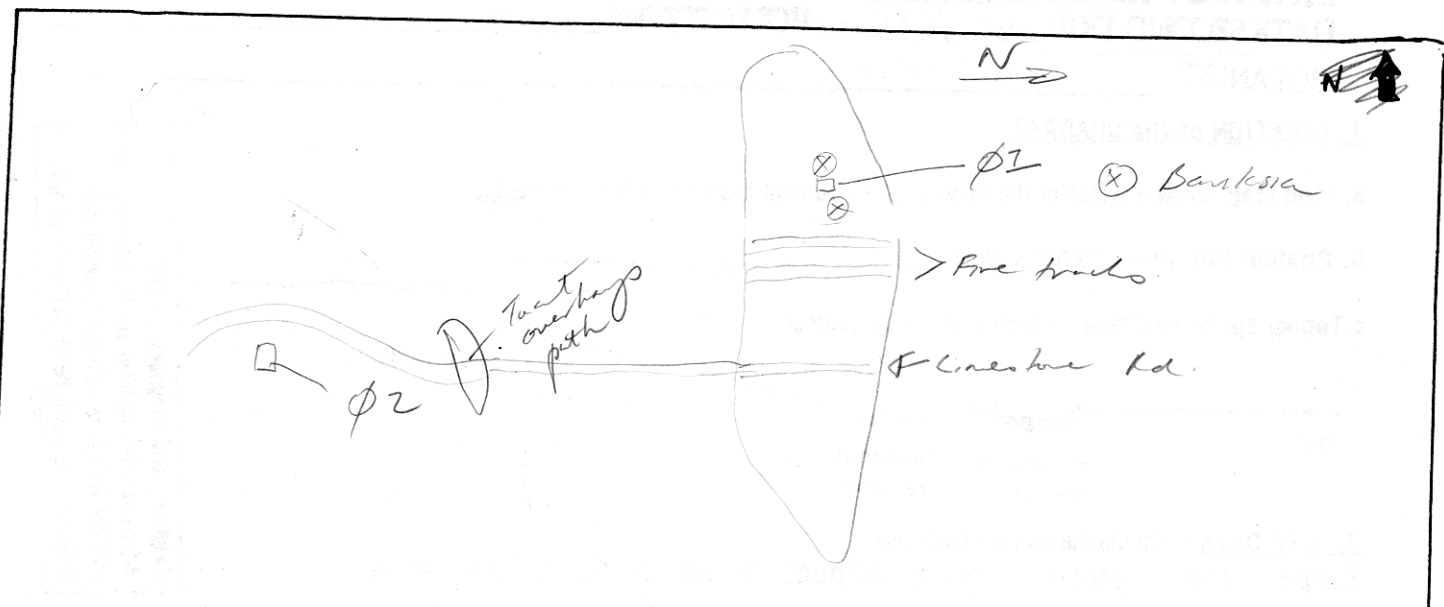

b Road Location	c. Latitude		Longitude
West Coast Hwy	31° 57' 09.5"		115° 45' 43.3"
d. Photograph Photographer's name <u>NG</u>	Photo # No <u>± 200</u>	Altitude <u>20m</u>	

e. Topographic position - Circle position of quadrat

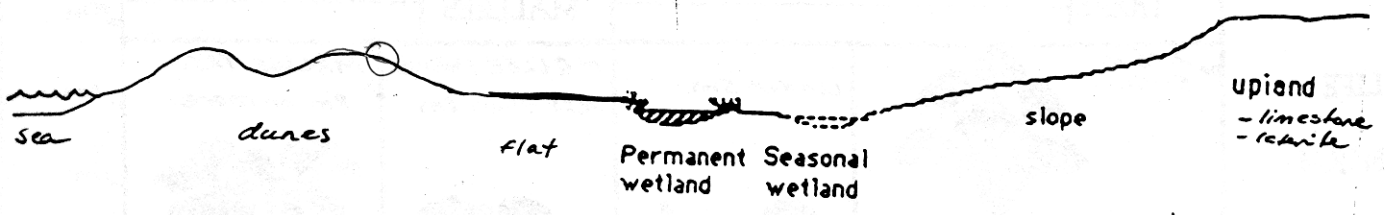

**2. SITE DATA - Circle the correct response**

Slope flat  gentle  steep

Aspect  N  NE  E  SE  S  SW  W  NW

Surface soil grey sand

Sub-surface soil cream sand

Drainage  well  mod  poor

Wet All year  winter/spring

Litter (% cover) \_\_\_\_\_

% Bare ground 15%

**4. VEGETATION CONDITION**

EXCELLANT		Comments Veldt grass } Briza } moss swards Lagurus } intact on plus. 20-30% (not dense)
VERY GOOD		
GOOD	<input checked="" type="checkbox"/>	
POOR		
VERY POOR		

