

QUADRAT No. C71 03 VEGETATION TYPE _____
 DATE FIRST TRIP 12/10/92 VOLUNTEERS _____
 DATE SECOND TRIP _____ VOLUNTEERS _____
 BOTANIST: Ne BJA

1. LOCATION of the QUADRAT

a. Mud Map Draw a sketch of the location of the quadrat the back of this sheet. →

b. Photograph Photographer's name _____

c. Topographic position - Circle position of quadrat

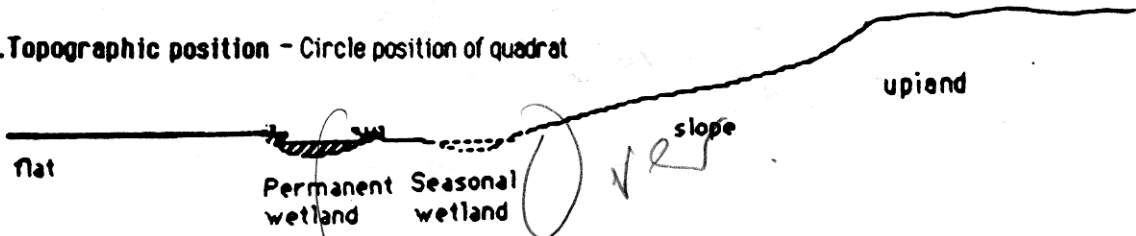

Keighery and Keighery, 1990
 Adapted from Griffin and Keighery, 1989
 MOORE RIVER to JURLEN SANDPLAIN
 SURVEY. WILDFLOWER SOCIETY of WA

2. SITE DATA - Circle the correct response

Slope flat gentle steep Aspect N NE E SE S SW W NW

% Bare ground _____ Drainage well mod poor Wet All year winter/spring

Litter (% cover) _____ Surface soil _____ Sub-surface soil _____

3. VEGETATION STRUCTURE AND COVER Record appropriate cover class

Cover Class - percentage classes	over 70%	TREES		MALLEES		Height (metres)	
	50-70%	Bank aff.					
	30-50%	LIFE FORM > 15m 5-15m Marri Jarrah Emergent scattered to W bank also there to W bank	Under 5m	MALLEE SHRUB less than 8m	MALLEE TREE 8m or more		
20-30%	COVER CLASS (%)	> 15m Marri < 2%					
10-20%	20-30%	SHRUBS					
2-10%	10-20%	over 2m		2.0-1.5m	1.5-1.0m	1.0m - .5m	under 5m
0%	2-10%					Mac reed	Abbey
	0%	BUNCH GRASSES		HERBS		SEDGES	
	0%	under .5m (not dense small plants)		under .5m (except creepers)		under .5m	
	0%	COVER CLASS (%)		COVER CLASS (%)		COVER CLASS (%)	
	0%	20-30%		2-10%		< 2%	

a. Mud Map Draw a sketch of the location of the quadrat

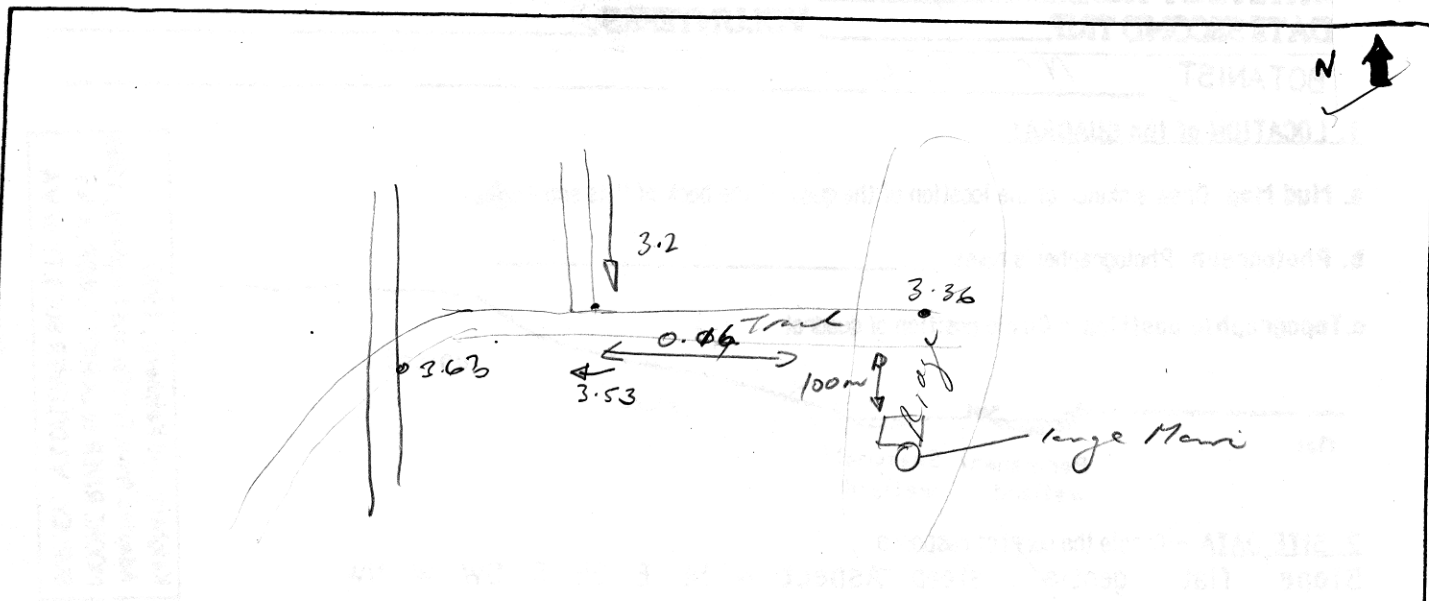

b Road Location	c. Latitude	Longitude
	33° 26' 17.3"	115° 36' 33.8"
d. Photograph Photographer's name <u>NG</u>	Photo # No <u>1</u>	Altitude <u>20m</u>

e. Topographic position - Circle position of quadrat

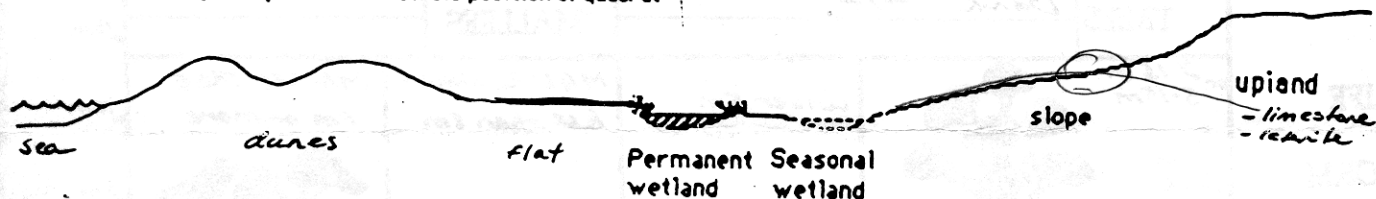

2. SITE DATA - Circle the correct response

Slope flat gentle steep

Aspect N NE E SE S SW W NW

Surface soil brown/grey sand

Sub-surface soil pink yellow brown sand

Drainage well mod poor

Wet All year winter/spring

Litter (% cover) 80-90%

% Bare ground 2%

4. VEGETATION CONDITION

EXCELLANT		Comments Burnt too frequently 20-30% Briza max. large dead trees and charcoal over ground.
VERY GOOD		
GOOD		
POOR		
VERY POOR		

