

(N) ✓

QUADRAT No. CAPEL - SYP7 VEGETATION TYPE Torrell Woodland
 DATE FIRST TRIP 8/11/92 VOLUNTEERS (6) BJK
 DATE SECOND TRIP 12/11/93 VOLUNTEERS BJK NG
 BOTANIST: Bromwyn

1. LOCATION of the QUADRAT

a. Mud Map Draw a sketch of the location of the quadrat the back of this sheet →

b. Photograph Photographer's name _____

c. Topographic position - Circle position of quadrat

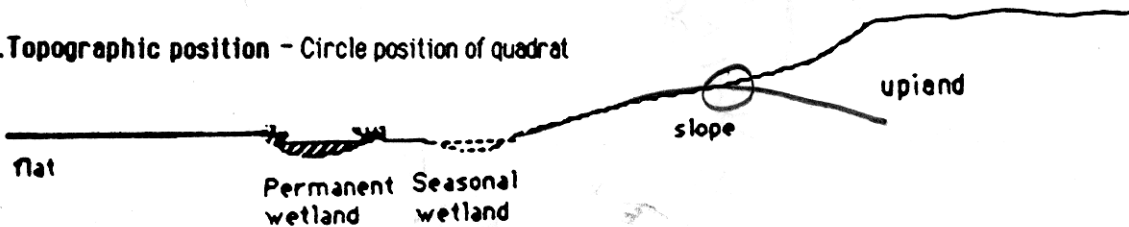

Keighery and Keighery, 1990
 Adapted from Griffin and Keighery, 1989
 MOORE RIVER to JURIE SANDPLAIN
 SURVEY. WILDFLOWER SOCIETY of WA

2. SITE DATA - Circle the correct response

Slope flat gentle steep Aspect N NE E SE S SW W NW

% Bare ground _____ Drainage well mod poor Wet All year winter/spring

Litter (% cover) _____ Surface soil _____ Sub-surface soil _____

3. VEGETATION STRUCTURE AND COVER. Record appropriate cover class

Cover Class - percentage classes	over 70%	TREES <u>Torrell</u>				MALLEES				Height (metres)
	50-70%	LIFE FORM	> 15m or 5-15m 	Under 5m 	MALLEE SHRUB less than 8m 	MALLEE TREE 8m or more 	15m	10m	5m	
	COVER CLASS (%)	2-15m 5-15m	30-50%							
30-50%	SHRUBS									
20-30%	LIFE FORM	over 2m 	2.0-1.5m 	1.5-1.0m 	1.0m - .5m 	under 5m 	3m	2m	1m	
COVER CLASS (%)			20-30		30-50%					
10-20%	BUNCH GRASSES									
2-10%	LIFE FORM	under .5m 	HERBS <u>Daisy broom</u> <u>Phlebocit</u> <u>Pater oes</u> Annuals under .5m (except creepers) 	SEDGES over .5m 	under .5m 	2.0m	1.5m	1.0m	.5m	
COVER CLASS (%)			2-40%							
0%	under 2%									

a. Mud Map Draw a sketch of the location of the quadrat

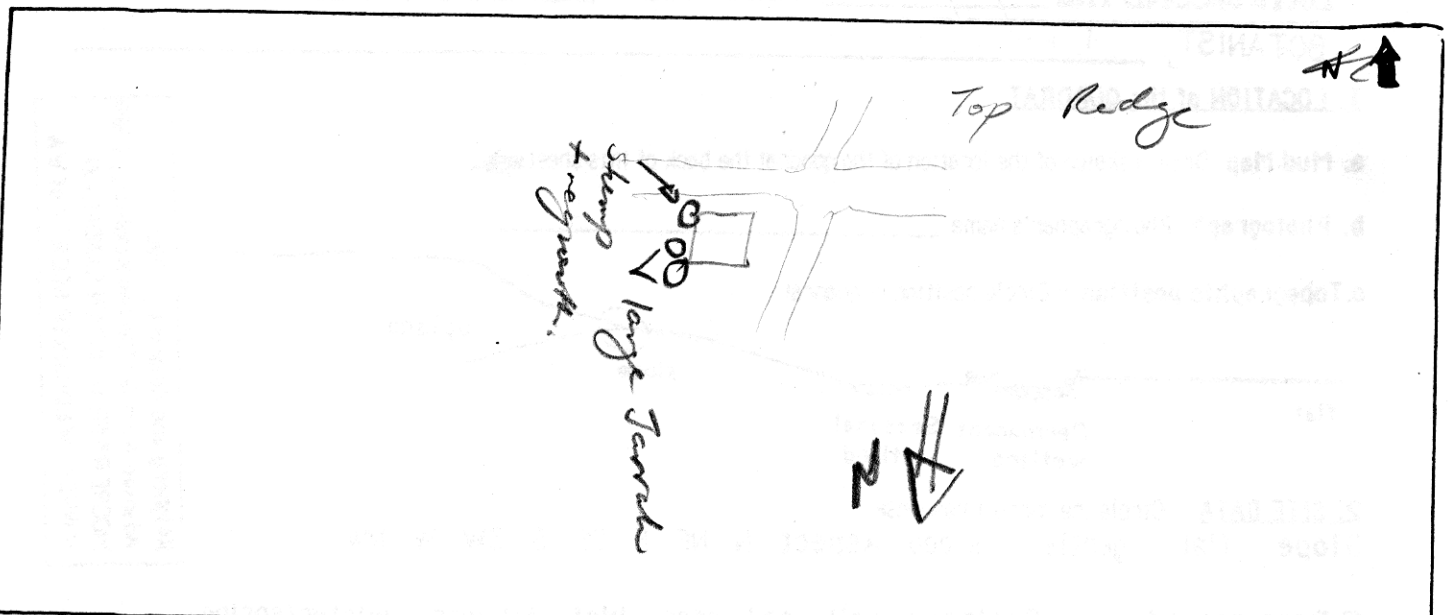

b Road Location	c. Latitude	Longitude
Capel Nat Park	33° 34' 22.2"	115° 32' 47.5"
d. Photograph Photographer's name	NG Photo No 15	
	12/1/93	

e. Topographic position - Circle position of quadrat

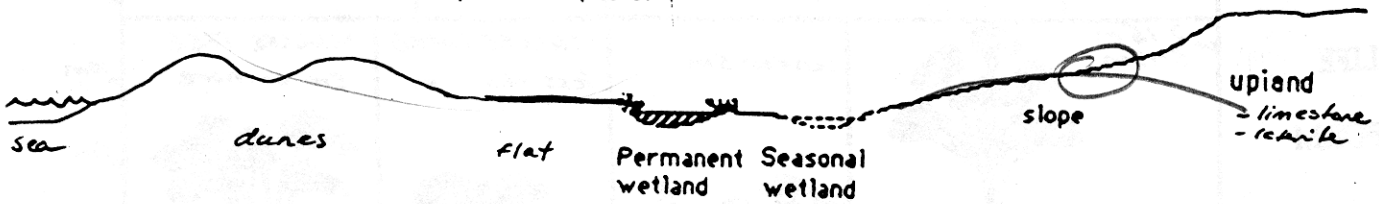

2. SITE DATA - Circle the correct response

Slope flat gentle steep

Aspect

N	NE	E	SE	S	SW	<u>W</u>	NW
---	----	---	----	---	----	----------	----

Surface soil grey sand

Sub-surface soil grey sand

Environ Geol SB

Drainage well mod poor

Wet All year winter/spring

Litter (% cover) _____

% Bare ground _____

4. VEGETATION CONDITION

EXCELLANT		Comments Fire ~ 1yr/2yrs previously regrowth need lignotubers 2/1/93 regrowing well, weeds reducing
VERY GOOD	<input checked="" type="checkbox"/>	
GOOD	<input type="checkbox"/>	
POOR	<input type="checkbox"/>	
VERY POOR	<input type="checkbox"/>	

SPECIES PRESENCE

CAPREL 9
 QUADRAT NO.
 CAPREL 8

- work systematically through the vegetation; start with the tallest stratum, i.e. trees
- within each stratum try to record the most common species first and the most uncommon last.
- as each species is collected label it with a numbered tag and use this number on your recording sheet
- indicate if the species is in flower

Keighery and Keighery, 1990
 Adapted from Griffin and Keighery, 1989
 MOORE RIVER to JURIE SANDPLAIN
 SURVEY. WILDFLOWER SOCIETY OF WA

NOTE: XANT PUS = SEED
 XAN MEA = RARIORUM i.e. XN respresent

Herbs from fire, Xp from soil.

Trees	No	ID	SHRUBS	No	ID	HERBS	No	ID
BA. MITRACATA	1	X	ROSEMARY ERIO	31	X	12/11/93		
			MONARONIS	32	X	12/11/93		
			STIPA COMPACTA	34	X	BURCH		
			LEVENHOOKA PUS	35	X	UMBRELL		
			LEVENHOOKA PUS	49	X			
			ALBA CART	37	X	ADJACENT NEAR		
			PROSERA MENZ	38	X	BAKERIA GOOD		
			HEVENA TRIPERMA	40	X	Lowland purg		
			XANTHOSIA NEURELL	41	X	Calyx		
			CONOSTYLIS ACUTATA	42	X			
			ENOCCHYLIS DICENTRA	43	X			
			STYLABIUM COMNOIDEN	44	X			
			BELIA MASTEX	45	X			

SHRUBS

BUNCH GRASSES

AC. EXTENSISIA	3	X	STYLABIUM COMNOIDEN	44	X			
PHL. THYMOCIDIS	4	X	TRICH. PIPSEA	47	X			
HIB. RACEMOSA	5	X	LARENIEGIA HUEG.	48	X			
HIB. HYPERICOIDES	6	X	HYPHARRHENIA	49	X			
HIB. HYPERICOIDES	7	X						
CONOSTERAPHUM PENN	8	X						
CONOSTERAPHUM PENN	9	X						
CONOSTERAPHUM PENN	10	X						
CONOSTERAPHUM PENN	11	X						
CONOSTERAPHUM PENN	12	X						
CONOSTERAPHUM PENN	13	X						
CONOSTERAPHUM PENN	14	X						
CONOSTERAPHUM PENN	15	X						
CONOSTERAPHUM PENN	16	X						
CONOSTERAPHUM PENN	17	X						
CONOSTERAPHUM PENN	18	X						
CONOSTERAPHUM PENN	19	X						
CONOSTERAPHUM PENN	20	X						
CONOSTERAPHUM PENN	21	X						
CONOSTERAPHUM PENN	22	X						
CONOSTERAPHUM PENN	23	X						
CONOSTERAPHUM PENN	24	X						
CONOSTERAPHUM PENN	25	X						
CONOSTERAPHUM PENN	26	X						
CONOSTERAPHUM PENN	27	X						
CONOSTERAPHUM PENN	28	X						
CONOSTERAPHUM PENN	29	X						
CONOSTERAPHUM PENN	30	X						

Herbs

12/11/93								
Stylid repens								
Gondal fern								
Agrost scaberrim								
Dracy brown								
Issay brown								
Phleb cilata								
Yell. brassia								
* Oenothera compressa								
Patellaria angust								
Lygodes bald								
Enochilae d.l. Got								
Danthonia								

Sedges

ADJACENT								
Trigonosus								
Stylidium = REASON.								
Stachys								

or hispidulae

55