

BUSHLAND PLANT SURVEY RECORDING SHEET 1- use pencil only

BUSHLAND AREA M53 FORRESTFIELD SITE NUMBER M53 05
 DATE TRIP 4.11.94 RECORDERS BJK, JJA, NCT
 DATE TRIP _____ RECORDERS _____
 DATE TRIP _____ RECORDERS _____
 BOTANIST _____

From 'Bushland Plant Survey' written by B. Keighery (1994) and published by the Wildflower Society of WA (Inc.), PO Box 64 Nedlands WA 6008.

1. LOCATION of the QUADRAT

Mud Map Draw a sketch of the location of the site below.

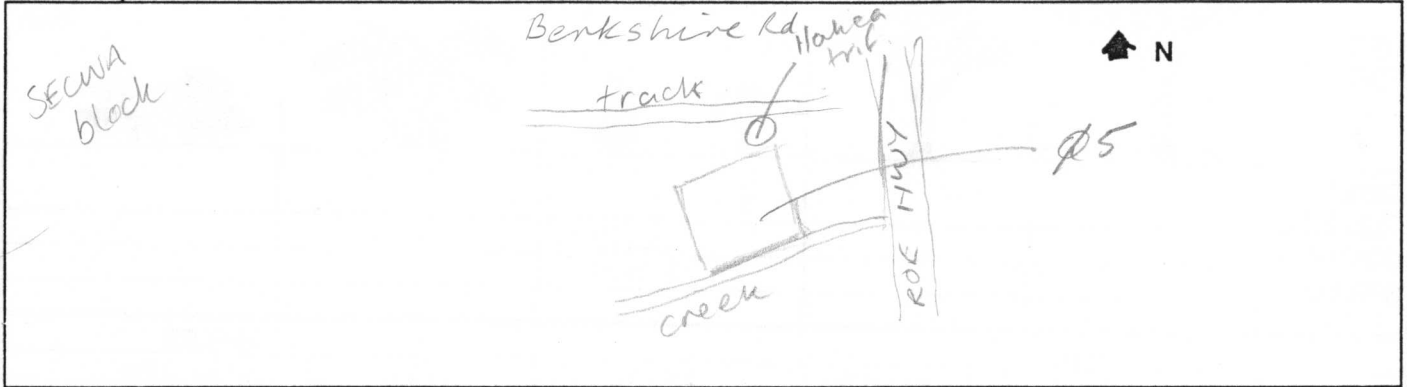

Road Location ROE HWY

Geographic Location Latitude 31° 58.563' S Longitude 115° 59.427' E Altitude _____
 Reference Map ← Not from GPS →

Photograph Photographer's Name JJA Photo No 8

Topographic position Circle position of site on the transect (alter the transect if necessary)

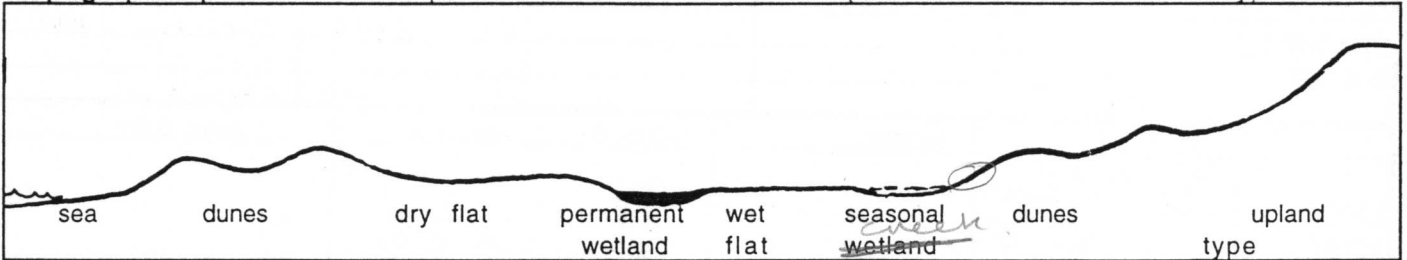

2. SITE DATA Circle the correct response.

Slope flat gentle steep Aspect N NE E SE S SW W NW

Surface Soil sandy loam with laterite Colour grey/brown
 Exposed rock type _____ % surface _____

Sub-surface Soil sandy loam Colour pale brown
 Rock type _____ depth to rock _____

Drainage well mod poor depth water _____ cm Wet all year winter/spring

Litter <u>30-70</u> % cover	Bare Ground <u>zero</u> % cover
Depth / leaf to 10 cm	

thicker toward creek bed

BUSHLAND PLANT SURVEY RECORDING SHEET 2 (Muir)- use pencil only

From 'Bushland Plant Survey' written by B. Keighery (1994) and published by the Wildflower Society of WA (Inc.), PO Box 64 Nedlands WA 6008.

3. VEGETATION STRUCTURE AND COVER

For each layer record - appropriate life form, cover class (see below), and dominant species in each layer.

Cover Class	2-10%	10-30%	30-70%	over 70%
-------------	-------	--------	--------	----------

LIFE FORM	TREES			MALLEES	
	over 30m	15-30m	5-15m under 5m	over 8m	under 8m
			Adj trees (open woodland) to 7.5m Open low woodland (S). 		
COVER CLASS (%)			2-10		
DOMINANT SPECIES			Euc. calo calo		

LIFE FORM	SHRUBS			SHRUBS	
	over 2m	2m-1.5m	1.5-1m	1-0.5m	under 0.5m
	Scrub. 			Dwarf Scrub C. 	Open dwarf Scrub D.
COVER CLASS (%)	10-30			10-30	2-10
DOMINANT SPECIES	Hakea trif			Hakea incr. Acacia pulch Pterop	Baeckha camp. Grevillia hypin Sparta

LIFE FORM	GRASSES	HERBS	SEDGES	under 0.5m
	over 0.5m	over 0.5m	over 0.5m	under 0.5m
	Very open Low grass 		all about 0.5 	
COVER CLASS (%)	2-10		open low Sedges. 10-30	
DOMINANT SPECIES	Neurocline alo Kikyo (creek)	perid	Mesomet tetrag Lepidosp (line rect)	tenue

4. VEGETATION CONDITION

1 'PRISTINE'	COMMENTS Only creek really wrecked. Photos 9 looking West 10 " " East (along creek)
2 EXCELLENT	
3 VERY GOOD	
4 GOOD	
5 DEGRADED	

Note: Grass = Lesmurdie Falls
Rubbish. Creek stained brown

