

## COOPER ROAD WATER RESERVE AND ADJACENT BUSHLAND, BULLSBROOK

**Boundary Definition:** bushland (part taken to cadastre) boundary

### **SECTION 1: LOCATION INFORMATION**

**Bush Forever Site no.** 6

**Area (ha):** bushland 113.8

**Map no.** 23, 24, 30, 31

**Map sheet series ref. no.** 2034-I SE

**Other Names:** not known

**Local Authorities (Suburb):** Shire of Swan (Bullsbrook)

### **SECTION 2: REGIONAL INFORMATION**

#### **LANDFORMS AND SOILS**

##### **Bassendean Dunes**

Bassendean Sands (Qpb: S8)

##### **Bassendean Dunes/Pinjarra Plain**

Bassendean Sands over Guildford Formation (Qpb/Qpa: S10)

##### **Wetlands (within the Bassendean Dunes/Pinjarra Plain)**

Holocene Swamp Deposits (Qhw: Cps)

#### **VEGETATION AND FLORA**

##### **Vegetation Complexes**

###### **Pinjarra Plain**

Yanga Complex

###### **Bassendean Dunes**

Bassendean Complex — North

**Floristic Community Types:** \*not sampled, types inferred

##### **Supergroup 2: Seasonal Wetlands**

\*4 *Melaleuca preissiana* damplands

\*S2 Northern *Pericalymma ellipticum* dense low shrublands

\*S17 *Eucalyptus rudis/Agonis linearifolia* wetlands in Bassendean Dunes

##### **Supergroup 3: Uplands centred on Bassendean Dunes and Dandaragan Plateau**

\*21c Low-lying *Banksia attenuata* woodlands or shrublands

\*23a Central *Banksia attenuata* — *B. menziesii* woodlands

\*23b Northern *Banksia attenuata* — *B. menziesii* woodlands

#### **WETLANDS**

**Wetland Types:** sumpland, palusplain, floodplain, creek

##### **Natural Wetland Groups**

**Bassendean—Pinjarra transition OR Bassendean with fluvial features**

Muchea (B/P.3)

**Wetland Management Objectives:** Conservation (49.5ha), Resource Enhancement, Multiple Use

**Swan Coastal Plain Lakes EPP:** none identified

#### **THREATENED ECOLOGICAL COMMUNITIES**

Not assessed, Not determined

### **SECTION 3: SPECIFIC SITE DETAIL**

**Landscape Features:** vegetated wetland, vegetated uplands

**Vegetation and Flora:** limited survey (DEP 1998, surveyed from roadside, McArthur and Matiske 1985, Muir 1983, Trudgen 1996)

##### **Structural Units**

Uplands: *Banksia attenuata*, *B. menziesii* Low Woodland with occasional *Nuytsia floribunda*, *Banksia littoralis* and *Eucalyptus todtiana*

Wetlands: *Melaleuca preissiana* Closed Forest with occasional *Eucalyptus patens* over *Agonis linearifolia* Tall

Shrubland: *Hypocalymma angustifolium* and *Astartea* aff. *fascicularis* Closed Heath with emergent *Xanthorrhoea preissii*; Sedgeland to Closed Sedgeland

**Scattered Native Plants:** not assessed

**Vegetation Condition:** 90% Pristine to Excellent, <10% Very Good

**Total Flora:** not known

**Significant Flora:** *Verticordia nitens*

**Fauna:** not known

**Linkage:** adjacent native vegetation to the north, east and west (Sites 399); part of Greenway 36 (Tingay, Alan & Associates 1998a); part of a regionally significant contiguous bushland/wetland linkage (Part A, Map 7)

**Other Special Attributes:** contains plant communities representative of the eastern side of the Swan Coastal Plain

***SECTION 4: INTERNATIONAL AND NATIONAL SIGNIFICANCE***

Not listed

***SECTION 5: SELECTION CRITERIA AND RECOMMENDATIONS***

**Criteria:** Representation of ecological communities, General criteria for the protection of wetland, streamline and estuarine fringing vegetation and coastal vegetation

**Recommendation:** Other Government Land Mechanism (see Table 3, Volume 1).

**COOPER ROAD WATER RESERVE AND ADJACENT BUSHLAND, BULLSBROOK**

**Boundary Definition:** bushland (part taken to cadastre) boundary

**SECTION 1: CADASTRAL INFORMATION**

(Lots, locations and derived information to be updated in the public submission period)

**Bushplan Site no.** 6                      **Map no.** 35                      **Map sheet series ref. no.** 2034-I SE

**Other Names:** not known                      **Area (ha):** total 114.4; bushland 113.8

**Local Authorities (Suburb)**                      **Zoning**

Shire of Swan (Bullsbrook)                      **MRS:** Rural

**TPS:** General Rural

**Ownership Categories**                      **Lot/Location/Reserve numbers (Purpose),**

Private                      **Street name**

2717, 3020 street not identified

Crown Reserve

**SECTION 2: REGIONAL INFORMATION**

**LANDFORMS AND SOILS**

**Bassendean Dunes**

Bassendean Sands (Qpb: S8)

**Bassendean Dunes/Pinjarra Plain**

Bassendean Sands over Guildford Formation (Qpb/Qpa:S10)

**Wetlands (within the Bassendean Dunes/Pinjarra Plain)**

Holocene Swamp Deposits (Qhw: Cps)

**VEGETATION AND FLORA**

**Vegetation Complexes**

**Pinjarra Plain**

Yanga Complex

**Bassendean Dunes**

Bassendean Complex - North

**Floristic Community Types:** \*not sampled, types inferred

**Supergroup 2: Seasonal Wetlands**

\*4 *Melaleuca preissiana* damplands

\*S2 Northern *Pericalymma ellipticum* dense low shrublands

\*S17 *Eucalyptus rudis*/*Agonis linearifolia* wetlands in Bassendean Dunes

**Supergroup 3: Uplands centred on Bassendean Dunes and Dandaragan Plateau**

\*21c Low lying *Banksia attenuata* woodlands or shrublands

\*23a Central *Banksia attenuata* — *B. menziesii* woodlands

\*23b Northern *Banksia attenuata* — *B. menziesii* woodlands

**WETLANDS**

**Wetland Types:** sumpland, palusplain, floodplain, creek

**Natural Wetland Groups**

**Bassendean—Pinjarra transition OR Bassendean with fluvial features**

Muchea (B/P.3)

**Wetland Management Objectives:** Conservation (49.5ha), Resource Enhancement, Multiple Use

**Swan Coastal Plain Lakes EPP:** none identified

**THREATENED ECOLOGICAL COMMUNITIES**

Not assessed, Not determined

**SECTION 3: SPECIFIC SITE DETAIL**

**Landscape Features:** vegetated wetland, vegetated uplands

**Vegetation and Flora:** limited survey (DEP 1998 (surveyed from roadside), McArthur and Mattiske 1985, Muir 1983, Trudgen 1996)

**Structural Units**

Uplands: *Banksia attenuata*, *B. menziesii* Low Woodland with occasional *Nuytsia floribunda*, *Banksia littoralis* and *Eucalyptus todtiana*

Wetlands: *Melaleuca preissiana* Closed Forest with occasional *Eucalyptus patens* over *Agonis linearifolia* Tall Shrubland; *Hypocalymma angustifolium* and *Astartea* aff. *fascicularis* Closed Heath with emergent *Xanthorrhoea preissii*; Sedgeland to Closed Sedgeland

**Scattered Native Plants:** not assessed

**Vegetation Condition:** 90% Pristine to Excellent, <10% Very Good

**Total Flora:** not known

**Significant Flora:** *Verticordia nitens*

**Fauna:** no known information



**Linkage:** adjacent native vegetation to the north, east and west (BS399); part of proposed Greenway 37 (Tingay, Alan & Associates 1997a); part of a regionally significant contiguous bushland/wetland linkage (Volume 2A, Map 8)

**Other Special Attributes:** contains plant communities representative of the eastern side of the Swan Coastal Plain

**SECTION 4: INTERNATIONAL AND NATIONAL SIGNIFICANCE**

Not listed

**SECTION 5: SELECTION CRITERIA AND RECOMMENDATIONS**

**Criteria:** Representation of ecological communities, General criteria for the protection of wetland, streamline and estuarine fringing and coastal vegetation

**Opportunities and/or Constraints**

Opportunities: Bushplan Site/part Bushplan Site subject to Swan and Canning Rivers EPP, Gnangara Mound Crown Land EPP; location of conservation category wetlands; under Crown Reserve

Constraints: private land; under General Mineral Resource Area (sand)

**Recommendation:** The most appropriate mechanism for the protection of this Bushplan Site be considered through the public comment period in consultation with the land owner(s).



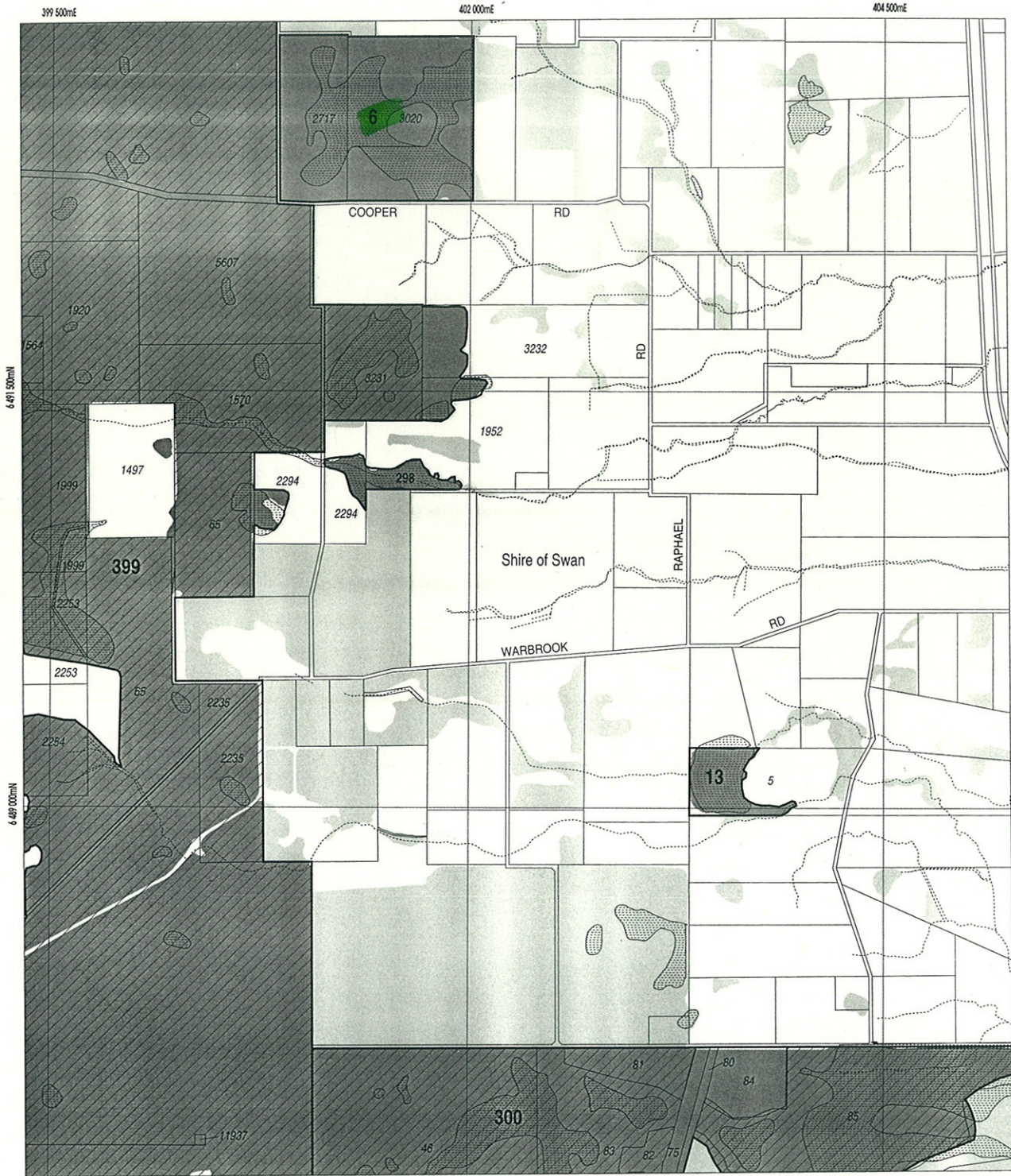

**LEGEND**

- 472 Bushplan Sites With Regionally Significant Bushland
- Other Native Vegetation
- Conservation Category Wetlands
- Bushplan Sites With Some Existing Protection
- 696 Lot Number, Location Number
- Channel Wetlands
- Local Government Boundary

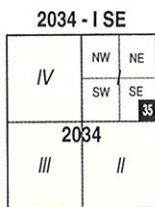

1 : 25 000 AMG Reference Grid showing Perth's Bushplan Map Sheet Breakdown

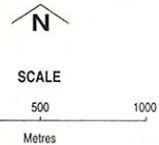
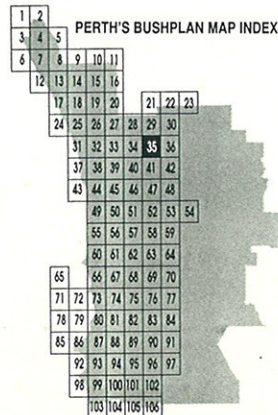

Produced by Project Mapping Section  
Land Information Branch, Ministry for  
Planning, Perth W.A. November 1998  
ntw-map11/environ/bushplan/bushv2\_35.dgn  
Cadastral Data supplied by Department  
of Land Administration, W.A.  
Wetlands Data supplied by  
Water and Rivers Commission  
Native Vegetation Extent for Study Area  
supplied by Agriculture Western Australia

WATER RESERVE (Vol 2 updated)

BUSHLAND AREA BS6 COOPER RD SITES YES/NO

DATE 6.2.98 RECORDERS Natalie + dma

Observations edge walked into Reserve  
transects

Geographic Location	Latitude	S Longitude	E
Reference Map			

Photograph	Photographer's Name	Photo No
	<u>Natalie</u>	

Transect of landscape units (draw in transect incorporating features listed and any other relevant unit)

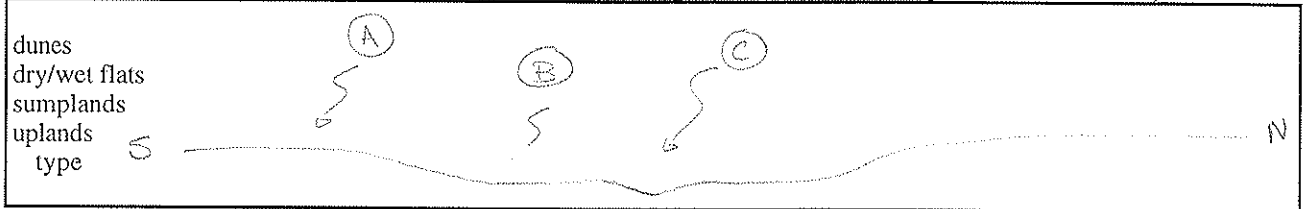

Soil - surface	<u>Ⓐ = grey loose sand</u>	<u>Ⓑ + Ⓒ = dark grey, dense, moist sand.</u>
Exposed rock	type	% area
		sub-soil

FLORA/VEGETATION (list dominant and significant plants below, see over for vege association descriptions)

Eucalypts	<i>E. calophylla</i>	<i>E. wandoo</i>	<i>E. marginata</i>	<i>E. todtiana</i>	<i>E. rudis</i>
	<i>E. decipiens</i>	<i>E. drummondii</i>	<i>E. haematoxylon</i>	<i>E. lanepoolei</i>	<i>E. gomphocephala</i>
	<i>E. accedens</i>	<i>E. patens</i>	<i>E. laeliae</i>	<i>E. megacarpa</i>	
Sheoaks	<i>Allocasuarina fraserana</i>		<i>Casuarina obesa</i>		
Banksia	<i>B. attenuata</i>	<i>B. menziesii</i>	<i>B. prionotes</i>	<i>B. illicifolia</i>	<i>B. grandis</i> <i>B. littoralis</i>
Melaleuca	<i>M. preissii</i>	<i>M. raphiophylla</i>	<i>M. lanceolata</i>	<i>M. cuticularis</i>	
Others	<i>Callitris preissii</i>				
Mallees	Eucalypts	<i>E. argutifolia</i>	<i>E. petrensis</i>	<i>E. decurva</i>	<i>E. foecunda</i> <i>E. latens</i>

SIGNIFICANT SPECIES

NSW Warbler

(see over for vegetation descriptions)

Vegetation Condition - Keighery 1994 (Trudgen 1993) (show range and indicate predominant class)

1 = 'Pristine' (Excellent) = 20%

2 = Excellent (Very Good) = 10%

3 = Very Good (Good) = 10%

4 = Good (Poor)

5 = Degraded (Very Poor)

6 = Completely Degraded

Specific aspects of disturbance

partial clearing					
weeds (list):					
selective removal of species:	timber cutting	mowing	fire	grazing	dieback %area
fire frequency:					
'enrichment plantings' (list)					
animal impact:	horse foxes	rabbits	cats	dogs	goats pigs overgrazing by native mammals
soil movement:	mining	dumping	rubbish dumping	roadworks	
changes in water regimes:		flooding	drainage	watering	nutrient influx
Tracks:	fire breaks	walk trails	off road vehicle use	animal tracks	
Service corridors:	SEC	Main Roads	Water Authority.	Telecom	
Other					

LIFE FORM/HEIGHT CLASS	CANOPY COVER			
	DENSE 70-100%	MID-DENSE 30-70%	SPARSE 10-30%	VERY SPARSE 2-10%
Trees > 30m Trees 15-30m Trees 5-15m Trees < 5m	Dense Tall Forest Dense Forest Dense Low Forest A Dense Low Forest B	Tall Forest Forest Low Forest A Low Forest B	Tall Woodland Woodland Low Woodland A Low Woodland B	Open Tall Woodland Open Woodland Open Low Woodland A Open Low Woodland B
Mallee tree form Mallee shrub form	Dense Tree Mallee Dense Shrub Mallee	Tree Mallee Shrub Mallee	Open Tree Mallee Open Shrub Mallee	Very Open Tree Mallee Very Open Shrub Mallee
Shrubs > 2m Shrubs 1.5-2.0m Shrubs 1.0-1.5m Shrubs 0.5-1.0m Shrubs 0.0-0.5m	Dense Thicket Dense Heath A Dense Heath B Dense Low Heath C Dense Low Heath D	Thicket Heath A Heath B Low Heath C Low Heath D	Scrub Low Scrub A Low Scrub B Dwarf Scrub C Dwarf Scrub D	Open Scrub Open Low Scrub A Open Low Scrub B Open Dwarf Scrub C Open Dwarf Scrub D
Mat plants Hummock Grass  Bunch grass > 0.5m Bunch grass < 0.5m Herbaceous spp.	Dense Mat Plants Dense Hummock Grass  Dense Tall Grass Dense Low Grass Dense Herbs	Mat Plants Mid-Dense Hummock Grass  Tall Grass Low Grass Herbs	Open Mat Plants Hummock Grass  Open Tall Grass Open Low Grass Open Herbs	Very Open Mat Plants Open Hummock Grass  Very Open Tall Grass Very Open Low Grass Very Open Herbs
Sedges > 0.5m Sedges < 0.5m	Dense Tall Sedges Dense Low Sedges	Tall Sedges Low Sedges	Open Tall Sedges Open Low Sedges	Very Open Tall Sedges Very Open Low Sedges
Ferns Mosses, liverwort	Dense Ferns Dense Mosses	Ferns Mosses	Open Ferns Open Mosses	Very Open Ferns Very Open Mosses

**VEGETATION** (describe each unit of vegetation using dominants and life form/height class and canopy cover according to the Muir codes above)

UPLAND	Nf (5-15m)	< 2%
	Bm (5-15)	> 25%
	Ba (5-15)	
	r. occ. Euc. tott	
	occ. Billic	
	Mudstone 1-2m	> 5%
	Xp 50-2m	
	Jadgonia stembel (15-2)	< 2%
< 0.5m LOW.	Puccin non	10%
	calytrix floribunda	
	Hibbertia sp.	
	Petrophile linearis	
	Conostyly - no hair	
	Leurododon	
	Alysicarpus	
	Dactyloctenium brom	
	Lynchia nana	< 2%
	Melaleuca > aerea	
	Lycopodium humos	5%
	Arauc. pulchella	
WETLAND.	Hypocalymn arg. (50-70)	50%
	Xp. emergent (2-4m)	< 2%
	Leurododon	
	Scattered melaleuca > aerea	< 2
	Astilbe all. fascic (50-70)	> 2%
	Fine sedge	10%
	Cosytha	
Fauna comments	Schoenus (10-15m)	10-15%
	LOTS of diggings - in patch in (B)	
Adjacent bushland	(refer to aerial photograph)	

(A) photo 9

(B) photo 10

MT-11-12 → HORTICULTURAL PLOTS!

10/1

WETLAND

36

13

Melaleuca preissii (0-5) 40%

Melaleuca leptophylla (10-15) 20%

Myrica linearis (1.5-3m) 20%

Phalaris fasciculata (1.1-2m)

Sedge " " ? FINE AUSTRALIAN

or. Eucalyptus ? patens (10-15m)



**BUSHPLAN SITES CORRECTED**



WESTERN  
AUSTRALIAN  
PLANNING  
COMMISSION



*B 21/10/98*



SCALE 1:2500



Metres

BJK 1/7/98

BS 6

Boundaries OK BUT block is headwaters of a creek to the east. WRC should decide if mapped veg (Agwa) & E plus wetlands (creek system) should be included.

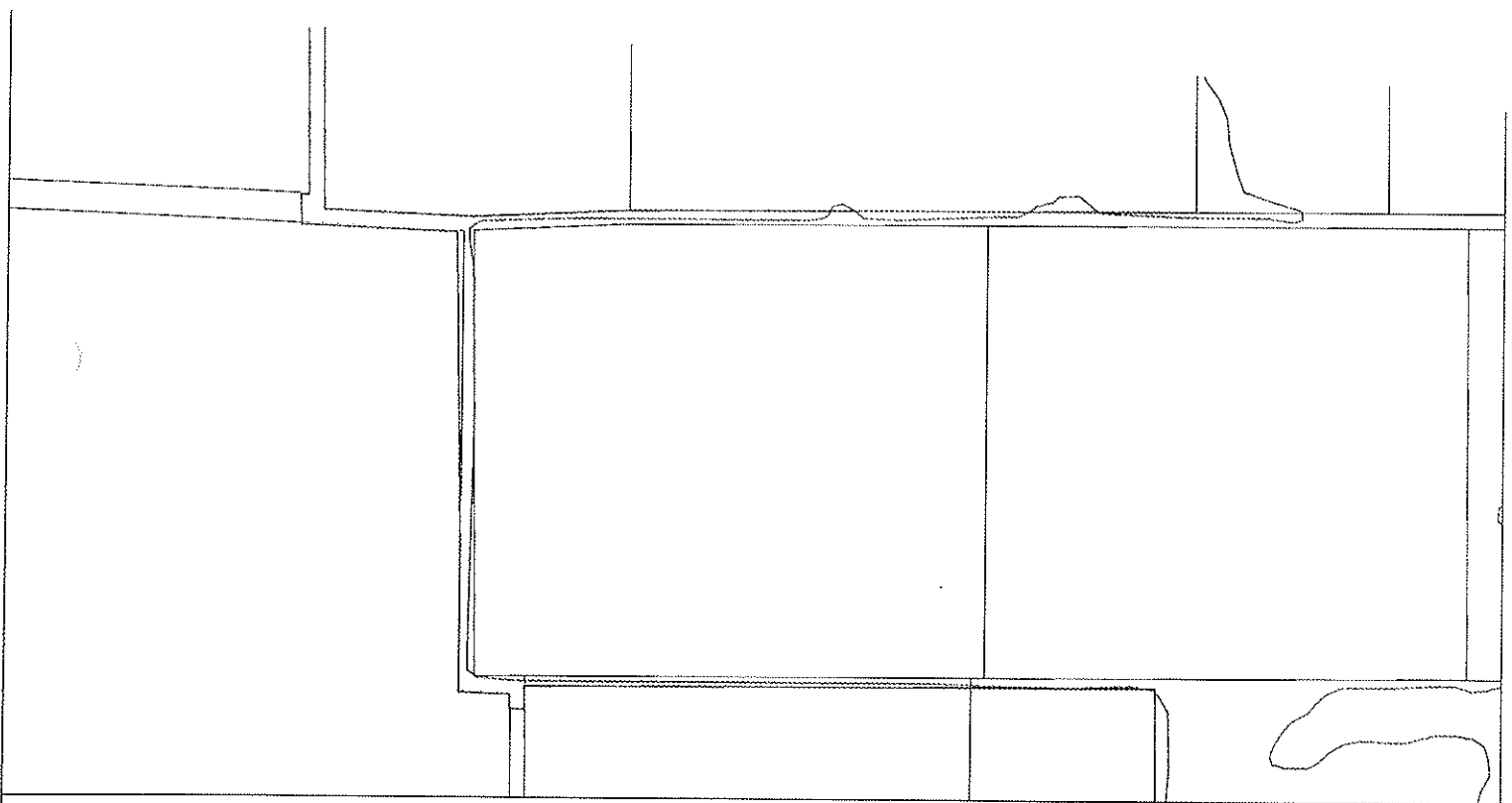

BUSHPLAN SITES CORRECTED



WESTERN AUSTRALIAN PLANNING COMMISSION



CUSTOMER FOCUS  
WESTERN AUSTRALIA

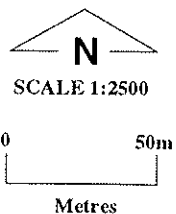

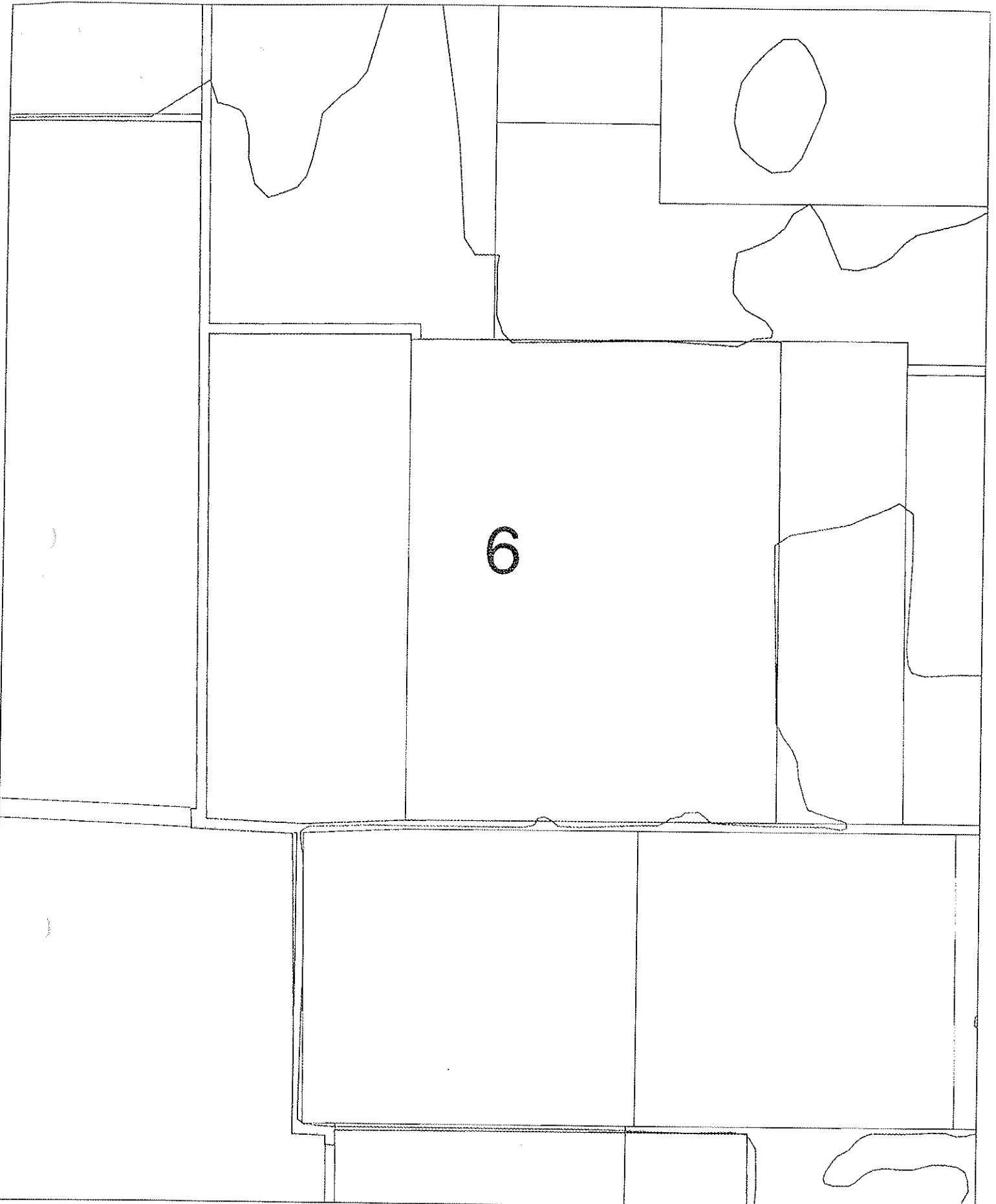

**BUSHPLAN SITES CORRECTED**



**WESTERN  
AUSTRALIAN  
PLANNING  
COMMISSION**



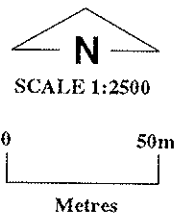

**CUSTOMER  
FOCUS  
WESTERN AUSTRALIA**



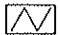

**bp site 6**

-  AG VEG 1998 BOUNDARY THEME
-  Cadastre
-  Bushplan sites refno 1-500 SCP BOUNDARY THEME
-  cons category wetlands

MFP INTERNAL USE ONLY  
 Prepared By: Andrea Zappacosta  
 Prepared For:  
 Map Ident: plot980622\_1  
 Date: 22 May 98  
 Scale 1:16181

Bushplan Site 6  
Cooper Road Water Reserve  
6-2-98



Area A



Area B

Bushplan Site 6  
Cooper Rd Water Reserve  
6-2-98

Area C



↑  
← adj to Area C



WLD 15240AGA  
Nr 19037 152.72

000011

- 5 0 2 2 - 1 2 6 8 - 5 6 1 0 0 0 1 8 0 0 2 6 0 5 6 -

9 0 0 2 0 9 5 2 1 0 0 2 5 1 6 2 0 0 0 0 0 0 0 0

RESTRICTED