

## WELSHPOOL ROAD BUSHLAND, WATTLE GROVE

**Boundary Definition:** bushland (part taken to cadastre) boundary

### **SECTION 1: LOCATION INFORMATION**

**Bush Forever Site no.** 50

**Area (ha):** bushland 4.7

**Map no.** 49

**Map sheet series ref. no.** 2133-IV NW

**Other Names:** Location 67 (Keighery, BJ, and Trudgen 1992)

**Local Authorities (Suburb):** Shire of Kalamunda (Wattle Grove)

### **SECTION 2: REGIONAL INFORMATION**

#### **LANDFORMS AND SOILS**

##### **Foothills**

Colluvial Deposits (Qc: Mgs2)

##### **Bassendean Dunes/Pinjarra Plain**

Bassendean Sands over Guildford Formation (Qpb/Qpa: S10)

#### **VEGETATION AND FLORA**

##### **Vegetation Complexes**

###### **Foothills**

Forrestfield Complex (Ridge Hill Shelf, Darling Plateau)

**Floristic Community Types:** \*not sampled, type inferred

###### **Supergroup 3: Uplands centred on Bassendean Dunes and Dandaragan Plateau**

\*20a *Banksia attenuata* woodlands over species-rich dense shrublands (in area of most southern representation)

#### **WETLANDS**

No wetlands mapped

#### **THREATENED ECOLOGICAL COMMUNITIES**

Endangered (floristic community type 20a)

### **SECTION 3: SPECIFIC SITE DETAIL**

**Landscape Features:** vegetated uplands

**Vegetation and Flora:** limited survey (DEP 1998, Keighery, BJ, and Trudgen 1992, Mattiske Consulting Pty Ltd 1997)

##### **Structural Units**

Uplands: *Banksia attenuata*, *B. menziesii*, *Eucalyptus marginata* subsp. *elegantella* and *Nuytsia floribunda*

Woodland; *Eucalyptus calophylla* Open Woodland

**Vegetation Condition:** >65% Excellent to Very Good, <35% Good to Degraded, with areas of severe localised disturbance

**Total Flora:** not known

**Significant Flora:** *Conospermum undulatum* (R), *Eucalyptus marginata* subsp. *elegantella* (2), *Isopogon drummondii* (3), *Lambertia multiflora* var. *darlingensis* (3); *Dasypogon obliquifolius*, *Hakea conchifolia*, *Xanthorrhoea acanthostachya*

**Fauna:** Significant mammal species: Quenda (Friend 1996 D)

**Linkage:** adjacent bushland to the north through road reserve and canopy to the Darling Range Regional Park (DPUD 1993) and south; part of Greenway 102 (Tingay, Alan & Associates 1998a); part of a regionally significant contiguous bushland/wetland linkage (Part A, Map 7)

**Other Special Attributes:** Category One Area Middle Canning Catchment (Evangelisti & Associates *et al.* 1995); contains plant communities representative of the eastern side of the Swan Coastal Plain

### **SECTION 4: INTERNATIONAL AND NATIONAL SIGNIFICANCE**

Subject to protection under the Commonwealth *Environment Protection and Biodiversity Conservation Act 1999*

### **SECTION 5: SELECTION CRITERIA AND RECOMMENDATIONS**

**Criteria:** Representation of ecological communities, Rarity

**Recommendation:** Part A: Other Government Land Mechanism. Part B: Rural Complementary Mechanism (see Table 3, Volume 1).

**WELSHPOOL ROAD BUSHLAND, WATTLE GROVE**

**Boundary Definition:** bushland (part taken to cadastre) boundary

**SECTION 1: CADASTRAL INFORMATION**

(Lots, locations and derived information to be updated in the public submission period)

**Bushplan Site no.** 50      **Map no.** 64      **Map sheet series ref. no.** 2133-IV NW

**Other Names**      **Area (ha):** total 5.1; bushland 4.7

Location 67 (Keighery, BJ, and Trudgen 1992)

**Local Authorities (Suburb)**

Shire of Kalamunda (Wattle Grove)

**Zoning**

**MRS:** Rural

**TPS:** Rural, Landscape

**Ownership Categories**

Private, State Government

**Lot/Location/Reserve numbers (Purpose),**

**Street name**

1 Welshpool Rd; 15, 2611, 2615 Schofield Rd; 707

Gavour Rd

Crown Reserve

**SECTION 2: REGIONAL INFORMATION**

**LANDFORMS AND SOILS**

**Foothills**

Colluvial Deposits (Qc: Mgs2)

**Bassendean Dunes/Pinjarra Plain**

Bassendean Sands over Guildford Formation (Qpb/Qpa: S10)

**VEGETATION AND FLORA**

**Vegetation Complexes**

**Foothills**

Forrestfield Complex (Ridge Hill Shelf, Darling Plateau)

**Floristic Community Types:** \*not sampled, types inferred

**Supergroup 3: Uplands centred on Bassendean Dunes and Dandaragan Plateau**

\*20a *Banksia attenuata* woodlands over species-rich dense shrublands (in area of most southern representation)

**WETLANDS**

No wetlands mapped

**THREATENED ECOLOGICAL COMMUNITIES**

Endangered (floristic community type 20a)

**SECTION 3: SPECIFIC SITE DETAIL**

**Landscape Features:** vegetated uplands

**Vegetation and Flora:** limited survey (DEP 1998, Keighery, BJ, and Trudgen 1992, Mattiske Consulting Pty Ltd 1997)

**Structural Units:** *Banksia attenuata*, *B. menziesii*, *Eucalyptus marginata* subsp. *elegantella* and *Nuytsia floribunda* Woodland; *Eucalyptus calophylla* Open Woodland

**Vegetation Condition:** >65% Excellent to Very Good, <35% Good to Degraded, with areas of severe localised disturbance

**Total Flora:** not known

**Significant Flora:** *Conospermum undulatum* (R), *Eucalyptus marginata* subsp. *elegantella* (2), *Isopogon drummondii* (3), *Lambertia multiflora* var. *darlingensis* (3); *Dasyopogon obliquifolius*, *Hakea conchifolia*, *Xanthorrhoea acanthostachya*

**Fauna:** no systematic survey. Significant mammal species: Quenda (Friend 1996 D)

**Linkage:** adjacent bushland to the north through road reserve and canopy to the Darling Range Regional Park (DPUD 1993) and south; part of proposed Greenway 116 (Tingay, Alan & Associates 1997a); part of a regionally significant contiguous bushland/wetland linkage (Volume 2A, Map 8)

**Other Special Attributes:** Category One Area Middle Canning Catchment Study (Evangelisti & Associates *et al.* 1995); contains plant communities representative of the eastern side of the Swan Coastal Plain

**SECTION 4: INTERNATIONAL AND NATIONAL SIGNIFICANCE**

Not listed



**SECTION 5: SELECTION CRITERIA AND RECOMMENDATIONS**

**Criteria:** Representation of ecological communities, Rarity

**Opportunities and/or Constraints**

Opportunities: Bushplan Site/part Bushplan Site subject to Swan and Canning Rivers EPP; location of Declared Rare Flora; under TPS Landscape Zoning; Crown Reserve

Constraints: private land

**Recommendation:** The most appropriate mechanism for the protection of this Bushplan Site be considered through the public comment period in consultation with the land owner(s).



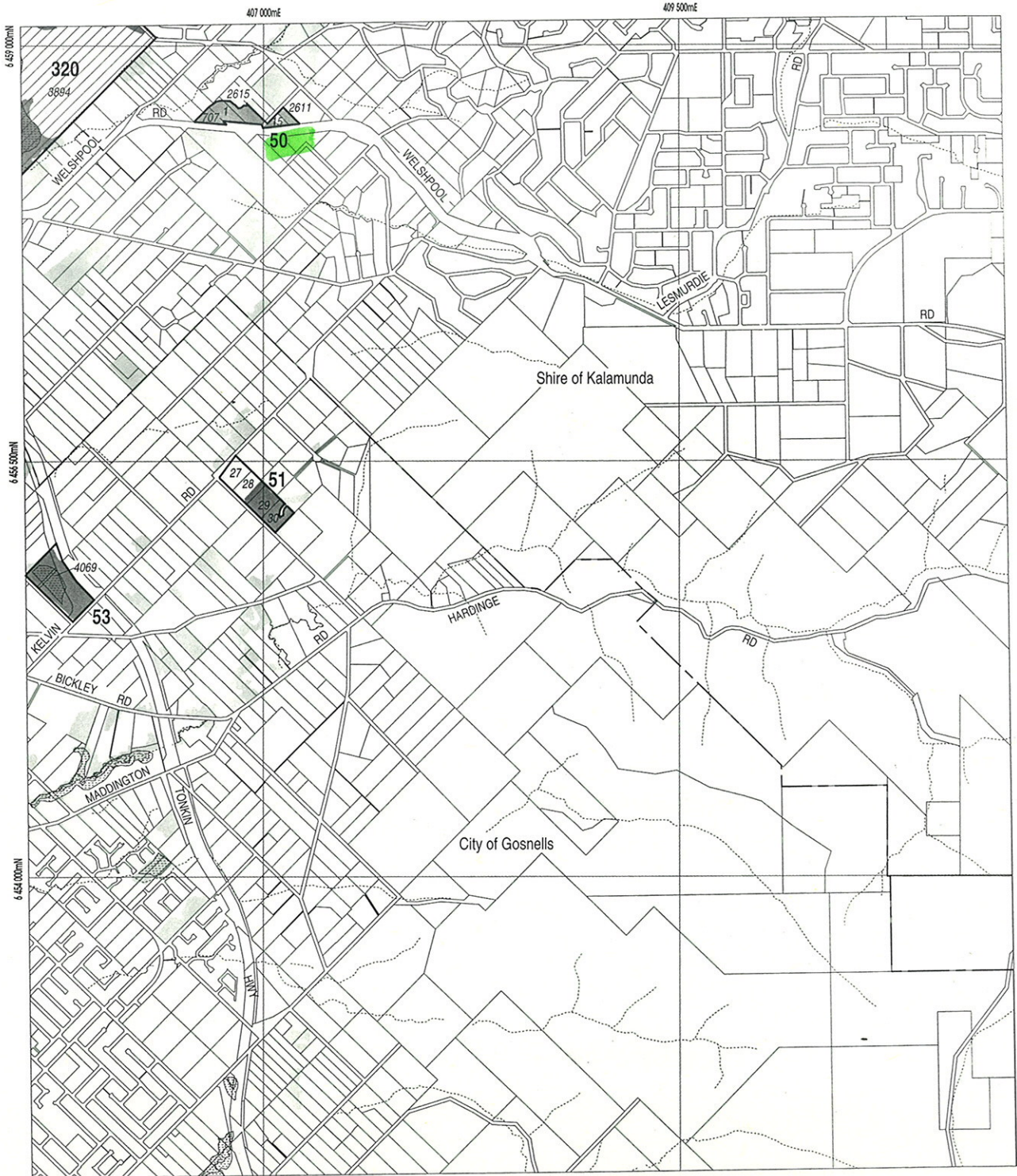

**LEGEND**

- 472 Bushplan Sites With Regionally Significant Bushland
- Other Native Vegetation
- Conservation Category Wetlands
- Bushplan Sites With Some Existing Protection
- 696 Lot Number, Location Number
- Channel Wetlands
- Local Government Boundary

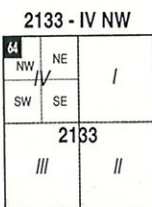

1 : 25 000 AMG Reference Grid showing Perth's Bushplan Map Sheet Breakdown

**PERTH'S BUSHPLAN MAP INDEX**

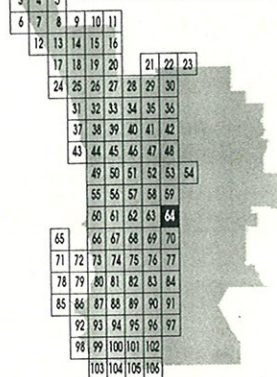

**SCALE**

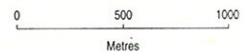

Produced by Project Mapping Section  
 Land Information Branch, Ministry for  
 Planning, Perth W.A. November 1998  
 ntw-map18/environ/bushplan/bushv2\_64.dgn  
 Cadastral Data supplied by Department  
 of Land Administration, W.A.  
 Wetlands Data supplied by  
 Water and Rivers Commission  
 Native Vegetation Extent for Study Area  
 supplied by Agriculture Western Australia

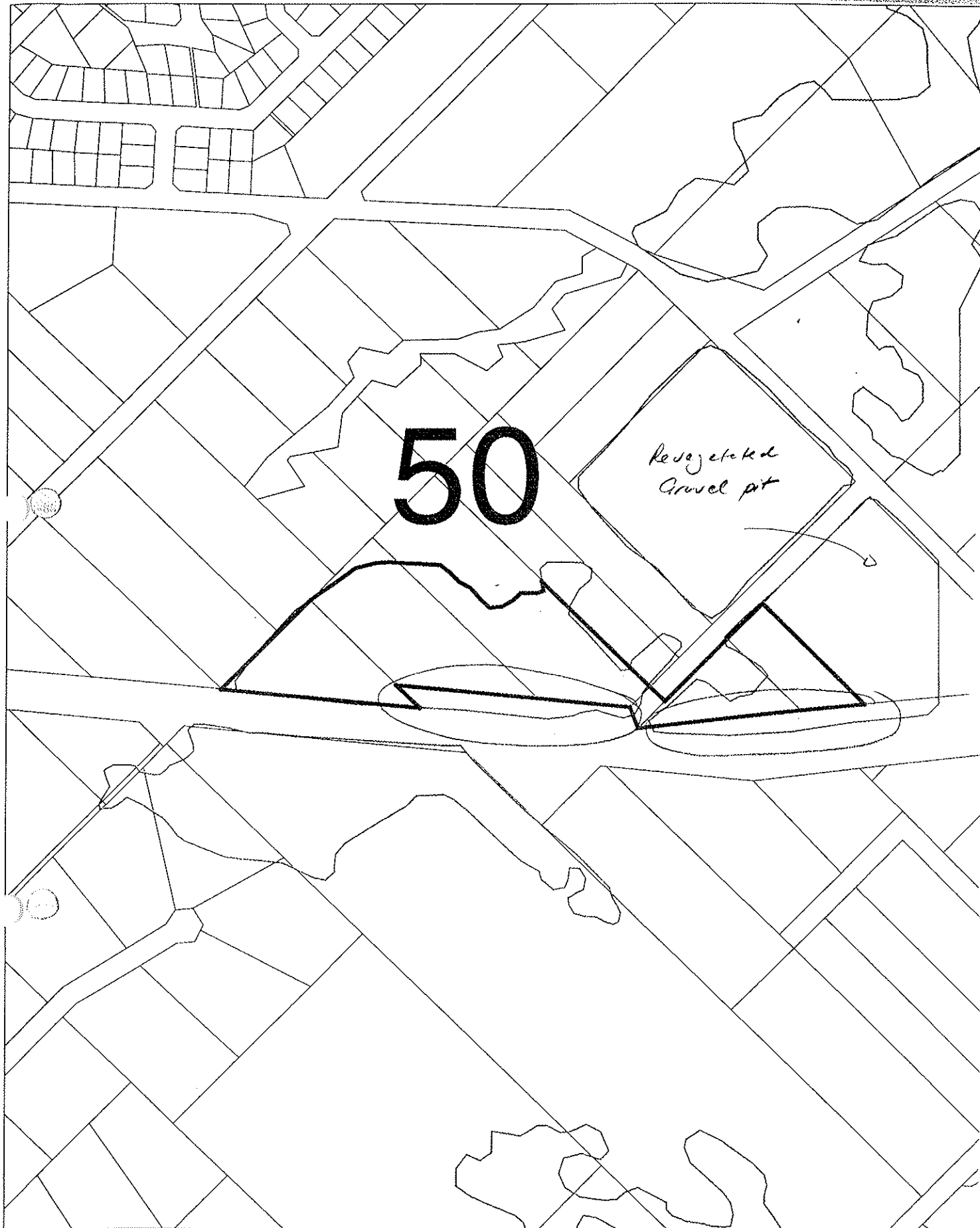

**BUSHPLAN SITES CORRECTED**



WESTERN  
AUSTRALIAN  
PLANNING  
COMMISSION



B Bk/TG 22/10/98

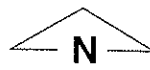

SCALE 1:2500



Metres

BJK 1/7/98

BS 50

BS 50 <sup>How?</sup> links to the Scarp/Poleau  
via road verge WHY leave out  
Vegetated verge.

1) EXISTING ROAD/CONTROLLED ACCESS HWAY

- 2) VERGE INDICATED IN  ON MAP IS  $\approx \frac{1}{2}$  ha and has SEVERAL TRACKS / PRIVATE ROAD. LOW GROUND  
CONSTRUCTION
- 3) FORESTFIELD COMPLEX  $< 10\%$  REMAINING COVERED BY PRESUMPTION AGAINST FURTHER CLEAR
- 4) LOCATION OF VERGE ON VERGE.

BJK U 1/7/98

BS 50

BS 50 links to the Scarp/Poleam  
via road verge WHY lease out  
Voyakad verge.



BUSHPLAN SITES CORRECTED



WESTERN  
AUSTRALIAN  
PLANNING  
COMMISSION



CUSTOMER  
FOCUS  
WESTERN AUSTRALIA

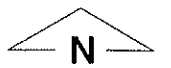

SCALE 1:2500



Metres

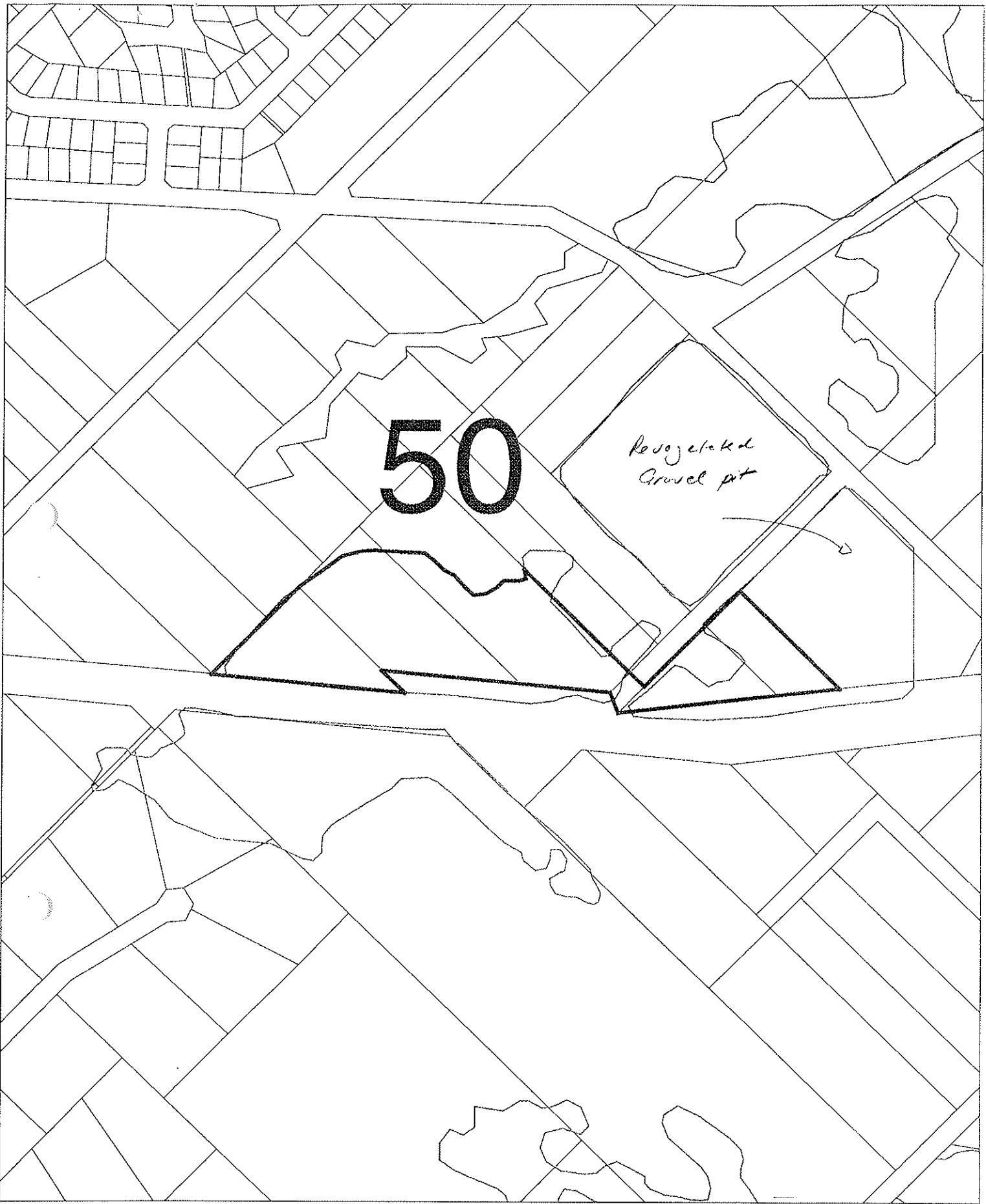

**BUSHPLAN SITES CORRECTED**



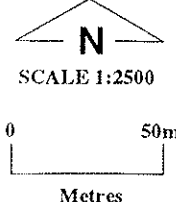

**WESTERN  
AUSTRALIAN  
PLANNING  
COMMISSION**

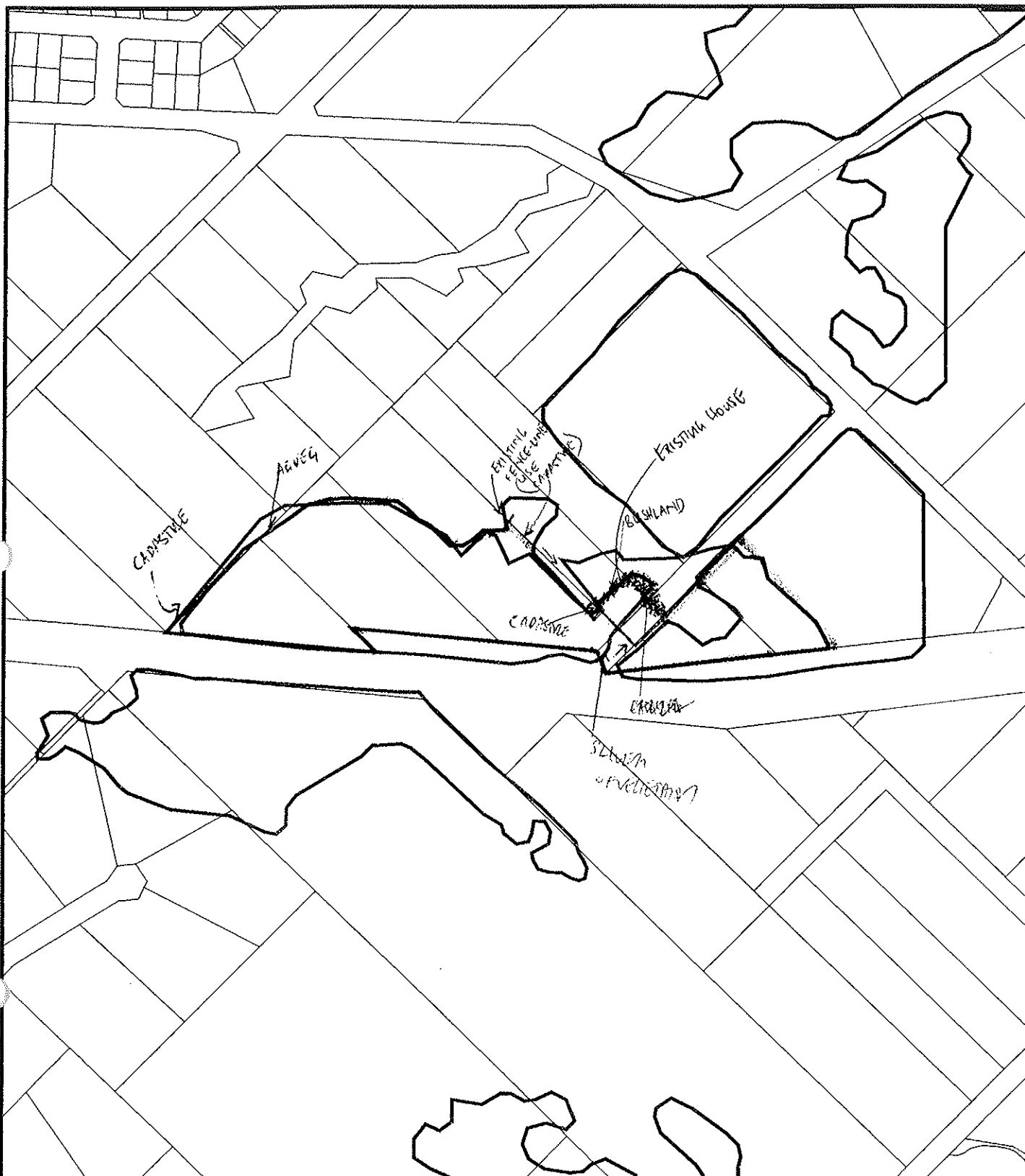



# bp site 50

-  AG VEG 1998 BOUNDARY THEME
-  Bushplan sites refno 1-500 SCP BOUNDARY THEME
-  Cadastre

MFP INTERNAL USE ONLY

Prepared By: Andrea Zappacosta

Prepared For:

Map Ident: plot980515\_1

Date: 15 May 98

Scale 1:5162

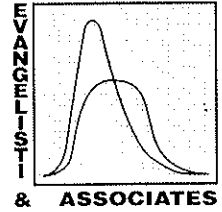

---

# **WATER RESOURCES MANAGEMENT PLAN**

## **MIDDLE CANNING CATCHMENT**

(STAGE 1 - VOLUME 1)

Prepared for the

**Water Authority of Western Australia**

By

**Evangelisti & Associates**  
Consulting Engineers and Project Managers

in association with

**Landvision**  
Consultants in Urban and Environmental Planning

and

**The V & C Semeniuk Research Group**  
Environmental Scientists

October 1995



LIFE FORM/HEIGHT CLASS	CANOPY COVER			
	DENSE 70-100%	MID-DENSE 30-70%	SPARSE 10-30%	VERY SPARSE 2-10%
Trees >30m Trees 15-30m Trees 5-15m Trees <5m	Dense Tall Forest Dense Forest Dense Low Forest A Dense Low Forest B	Tall Forest Forest Low Forest A Low Forest B	Tall Woodland Woodland Low Woodland A Low Woodland B	Open Tall Woodland Open Woodland Open Low Woodland A Open Low Woodland B
Mallee tree form Mallee shrub form	Dense Tree Mallee Dense Shrub Mallee	Tree Mallee Shrub Mallee	Open Tree Mallee Open Shrub Mallee	Very Open Tree Mallee Very Open Shrub Mallee
Shrubs >2m Shrubs 1.5-2.0m Shrubs 1.0-1.5m Shrubs 0.5-1.0m Shrubs 0.0-0.5m	Dense Thicket Dense Heath A Dense Heath B Dense Low Heath C Dense Low Heath D	Thicket Heath A Heath B Low Heath C Low Heath D	Scrub Low Scrub A Low Scrub B Dwarf Scrub C Dwarf Scrub D	Open Scrub Open Low Scrub A Open Low Scrub B Open Dwarf Scrub C Open Dwarf Scrub D
Mat plants Hummock Grass  Bunch grass >0.5m Bunch grass <0.5m Herbaceous spp.	Dense Mat Plants Dense Hummock Grass Dense Tall Grass Dense Low Grass Dense Herbs	Mat Plants Mid-Dense Hummock Grass Tall Grass Low Grass Herbs	Open Mat Plants Hummock Grass Open Tall Grass Open Low Grass Open Herbs	Very Open Mat Plants Open Hummock Grass Very Open Tall Grass Very Open Low Grass Very Open Herbs
Sedges >0.5m Sedges <0.5m	Dense Tall Sedges Dense Low Sedges	Tall Sedges Low Sedges	Open Tall Sedges Open Low Sedges	Very Open Tall Sedges Very Open Low Sedges
Ferns Mosses, Liverwort	Dense Ferns Dense Mosses	Ferns Mosses	Open Ferns Open Mosses	Very Open Ferns Very Open Mosses

**VEGETATION** (describe each unit of vegetation using dominants and life form/height class and canopy cover according to the Muir codes above)

A. W/E Schofield Rd

Bank. all / mixed / tall / low Open Woodland over  
All hum (1-2m) 10-30% over 4m mixed shrubs  
30-70% over 1.5m tall, rest. out open sedge

Verge along Welshpool Rd Excellent  
with patches several localised dips to  
N margin with gravel pit. Patches  
kept. 0.1aev

Soil: Mamm / Juvak

Signif species

Iso. drum, Pit path, Navy oblique, Lamb. multi,  
Yanth. growth, Comb. med, deep hum  
Halt cock, 1 Euc. mar, ssp. tetragastella  
Ac

Links to Scarp along Welshpool Rd.  
Wardoo towards Scarp, "planted +  
re-grassified."

NOTE  
ON  
DESCRIPTION

Fauna comments

Adjacent bushland (refer to aerial photograph)

MAPI: Vegetation of Lots 2611 & 2788 Scofield Rd,  
Wattle Grove and Bushplan Site 50

- Bushplan Site Boundary
- ⊙ Regionally Significant Vegetation
- ⊙ Other Remnant Vegetation

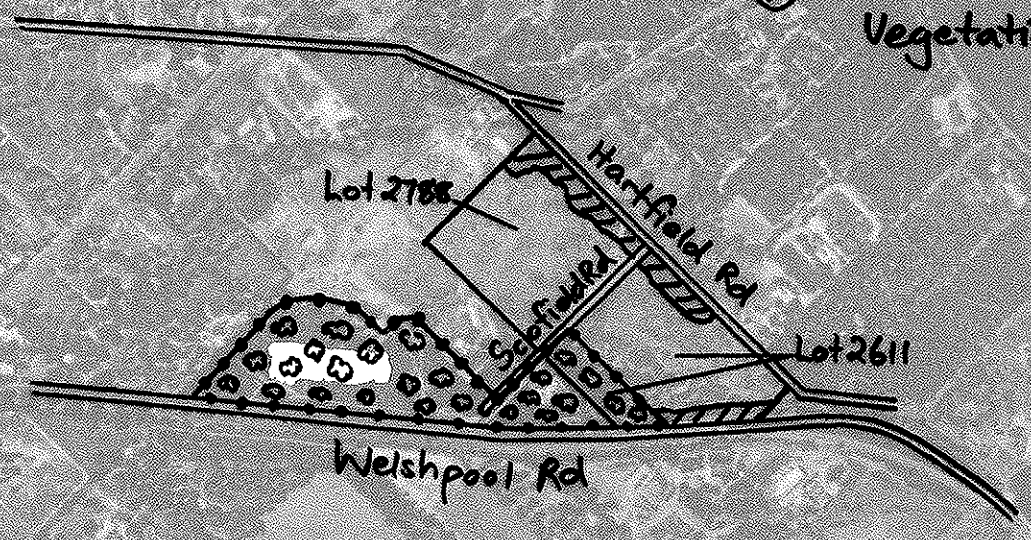

↑ N

Scale 1:10,000

BS 50 FOOT/PIN

LIBRARY  
DEPARTMENT OF ENVIRONMENTAL PROTECTION  
WESTRALIA SQUARE  
141 ST. GEORGE'S TERRACE, PERTH

**VEGETATION AND FLORA  
SURVEY  
OF THE  
SHIRE OF KALAMUNDA  
VESTED RESERVES**

**VOLUME 1 - REPORT  
OCTOBER 1992 TO MARCH 1993**

**PAUL ARMSTRONG RESEARCH OFFICER  
SHIRE OF KALAMUNDA**

## TABLE OF CONTENTS

INTRODUCTION	Page 1
METHODOLOGY	Page 2
2.1 RESERVES	Page 2
2.2 ANALYSIS	Page 3
RESULTS AND DISCUSSION	Page 6
3.1 FLORA	Page 6
3.1.1 Species Distribution	Page 9
3.1.2 Range Extensions	Page 11
3.1.3 Declared Rare and Priority Species	Page 12
3.1.4 Unidentified species	Page 15
3.1.5 Introduced Species	Page 15
3.2 RESERVES	Page 17
3.2.1 Assessment	Page 17
3.2.2 Comments on specific reserves	Page 21
3.3 COMPUTER FILES	Page 20
CONCLUSION	Page 21
4.1 FLORA	Page 21
4.2 RESERVES	Page 22
4.3 OVERALL	Page 22
ACKNOWLEDGMENTS	Page 23
REFERENCES	Page 24

## LIST OF APPENDICES

APPENDIX I.	SPECIES LIST	Page 25
APPENDIX II.	SPECIES RICHNESS	Page 45
APPENDIX III.	SPECIES DISTRIBUTION	Page 47
APPENDIX IV.	VEGETATION CONDITION	Page 51

LIBRARY  
DEPARTMENT OF ENVIRONMENTAL PROTECTION  
WESTRALIA SQUARE  
141 ST. GEORGE'S TERRACE, PERTH

LIBRARY  
DEPARTMENT OF ENVIRONMENTAL PROTECTION  
WESTRALIA SQUARE  
141 ST. GEORGE'S TERRACE, PERTH

VEGETATION AND FLORA  
SURVEY  
OF THE  
SHIRE OF KALAMUNDA  
VESTED RESERVES

VOLUME 2 - RESERVE SPECIES LIST

OCTOBER 1992 TO MARCH 1993

BY PAUL ARMSTRONG RESEARCH OFFICER

SHIRE OF KALAMUNDA

MARCH 1993

**TABLE OF CONTENTS**

	Page
SHEET 01 .....	1
SHEET 02 .....	4
SHEET 05 .....	6
SHEET 06 .....	16
SHEET 10 .....	33
SHEET 11 .....	39
SHEET 12 .....	50
SHEET 14 .....	54
SHEET 15 .....	61
SHEET 16 .....	80
SHEET 21 .....	85
SHEET 22 .....	86

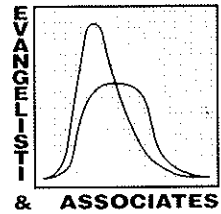

---

# **WATER RESOURCES MANAGEMENT PLAN**

## **MIDDLE CANNING CATCHMENT**

(STAGE 1 - VOLUME 1)

Prepared for the

**Water Authority of Western Australia**

By

**Evangelisti & Associates**  
Consulting Engineers and Project Managers

in association with

**Landvision**  
Consultants in Urban and Environmental Planning

and

**The V & C Semeniuk Research Group**  
Environmental Scientists

October 1995

Thank you for providing this submission. If you want further feedback on the outcome of submission then please leave name and address.

*Should we need to contact you for further site identification it would be helpful to have a name and telephone contact number*

*This information will be treated as confidential*

**Name: (Please Print)** .....

**Address:** .....

**Daytime telephone number:** .....

WILD 1574 UAGA  
Nr 13037 152.72

000053

- 5022 - 1 268 - 55 100 0160 0240 56 -

000000 002790 210125 60 2123