

WHITE ROAD BUSHLAND, ORANGE GROVE

Boundary Definition: bushland (part taken to cadastre) boundary (Areas of bushland within the boundaries of the Site are not accurately mapped. The boundary has been drawn to include any unmapped bushland.)

SECTION 1: LOCATION INFORMATION

Bush Forever Site no. 51

Area (ha): bushland 4.3

Map no. 55

Map sheet series ref. no. 2133-IV NW

Other Names: Location 59 (Keighery, BJ, and Trudgen 1992); part Gosnells remnant bushland area 59 (Trudgen and Keighery 1995)

Local Authorities (Suburb): City of Gosnells (Orange Grove)

SECTION 2: REGIONAL INFORMATION

LANDFORMS AND SOILS

Foothills

Yoganup Formation (Qpr: S12)

VEGETATION AND FLORA

Vegetation Complexes

Foothills

Forrestfield Complex (Ridge Hill Shelf, Darling Plateau)

Floristic Community Types: *not sampled, type inferred

Supergroup 3: Uplands centred on Bassendean Dunes and Dandaragan Plateau

*20a *Banksia attenuata* woodlands over species-rich dense shrublands (most southern representation)

WETLANDS

No wetlands mapped

THREATENED ECOLOGICAL COMMUNITIES

Endangered (floristic community type 20a)

SECTION 3: SPECIFIC SITE DETAIL

Landscape Features: vegetated uplands

Vegetation and Flora: limited survey (Keighery, BJ, and Trudgen 1992, Mattiske Consulting Pty Ltd 1997, Trudgen and Keighery 1995)

Structural Units: mapping (Keighery, BJ, and Trudgen 1992)

Uplands: *Banksia attenuata* and *B. menziesii* Low Woodland over species-rich Open Heath

Vegetation Condition: >90% Excellent to Very Good

Total Flora: not known

Significant Flora: *Conospermum undulatum* (R), *Isopogon drummondii* (3), *Lambertia multiflora* var. *darlingensis* (3)

Fauna: Significant mammal species: Quenda (Friend 1996 D)

Linkage: adjacent bushland to the north (worthy of protection) and east; part of a regionally significant contiguous bushland/wetland linkage (Part A, Map 7)

Other Special Attributes: Category One Area Middle Canning Catchment (Evangelisti & Associates *et al.* 1995); contains plant communities representative of the eastern side of the Swan Coastal Plain

SECTION 4: INTERNATIONAL AND NATIONAL SIGNIFICANCE

Subject to protection under the Commonwealth *Environment Protection and Biodiversity Conservation Act 1999*

SECTION 5: SELECTION CRITERIA AND RECOMMENDATIONS

Criteria: Representation of ecological communities, Rarity

Recommendation: Rural Complementary Mechanism (see Table 3, Volume 1).

WHITE ROAD BUSHLAND, ORANGE GROVE

Boundary Definition: bushland (part taken to cadastre) boundary (Areas of bushland within the boundaries of the Bushplan Site are not accurately mapped. The boundary has been drawn to include any unmapped bushland.)

SECTION 1: CADASTRAL INFORMATION

(Lots, locations and derived information to be updated in the public submission period)

Bushplan Site no. 51 **Map no.** 64 **Map sheet series ref. no.** 2133-IV NW

Other Names

Location 59 (Keighery, BJ, and Trudgen 1992); part
Gosnells remnant bushland area 59 (Trudgen and Keighery
1995)

Area (ha): total 7.8; bushland 4.3

Local Authorities (Suburb)

City of Gosnells (Orange Grove)

Zoning

MRS: Rural

TPS: Rural

Lot/Location/Reserve numbers (Purpose),

Street name

27, 28, 29, 30 White Rd

Ownership Categories

Private

SECTION 2: REGIONAL INFORMATION

LANDFORMS AND SOILS

Foothills

Yoganup Formation (Qpr: S12)

VEGETATION AND FLORA

Vegetation Complexes

Foothills

Forrestfield Complex (Ridge Hill Shelf, Darling Plateau)

Floristic Community Types: *not sampled, types inferred

Supergroup 3: Uplands centred on Bassendean Dunes and Dandaragan Plateau

*20a *Banksia attenuata* woodlands over species-rich dense shrublands (most southern representation)

WETLANDS

No wetlands mapped

THREATENED ECOLOGICAL COMMUNITIES

Endangered (floristic community type 20a)

SECTION 3: SPECIFIC SITE DETAIL

Landscape Features: vegetated uplands

Vegetation and Flora: limited survey (Keighery, BJ, and Trudgen 1992, Mattiske Consulting Pty. Ltd. 1997, Trudgen and Keighery 1995)

Structural Units: mapping (Keighery, BJ, and Trudgen 1992)

Uplands: *Banksia attenuata* and *B. menziesii* Low Woodland over species-rich Open Heath

Vegetation Condition: >90% Excellent to Very Good

Total Flora: not known

Significant Flora: *Conospermum undulatum* (R), *Isopogon drummondii* (3), *Lambertia multiflora* var. *darlingensis* (3)

Fauna: no systematic survey. Significant mammal species: Quenda (Friend 1996 D)

Linkage: adjacent bushland to the north (worthy of protection) and east; part of a regionally significant contiguous bushland/wetland linkage (Volume 2A, Map 8)

Other Special Attributes: Category One Area Middle Canning Catchment Study (Evangelisti & Associates *et al.* 1995); contains plant communities representative of the eastern side of the Swan Coastal Plain

SECTION 4: INTERNATIONAL AND NATIONAL SIGNIFICANCE

Not listed



SECTION 5: SELECTION CRITERIA AND RECOMMENDATIONS

Criteria: Representation of ecological communities, Rarity

Opportunities and/or Constraints

Opportunities: Bushplan Site/part Bushplan Site subject to Swan and Canning Rivers EPP; location of Declared Rare Flora





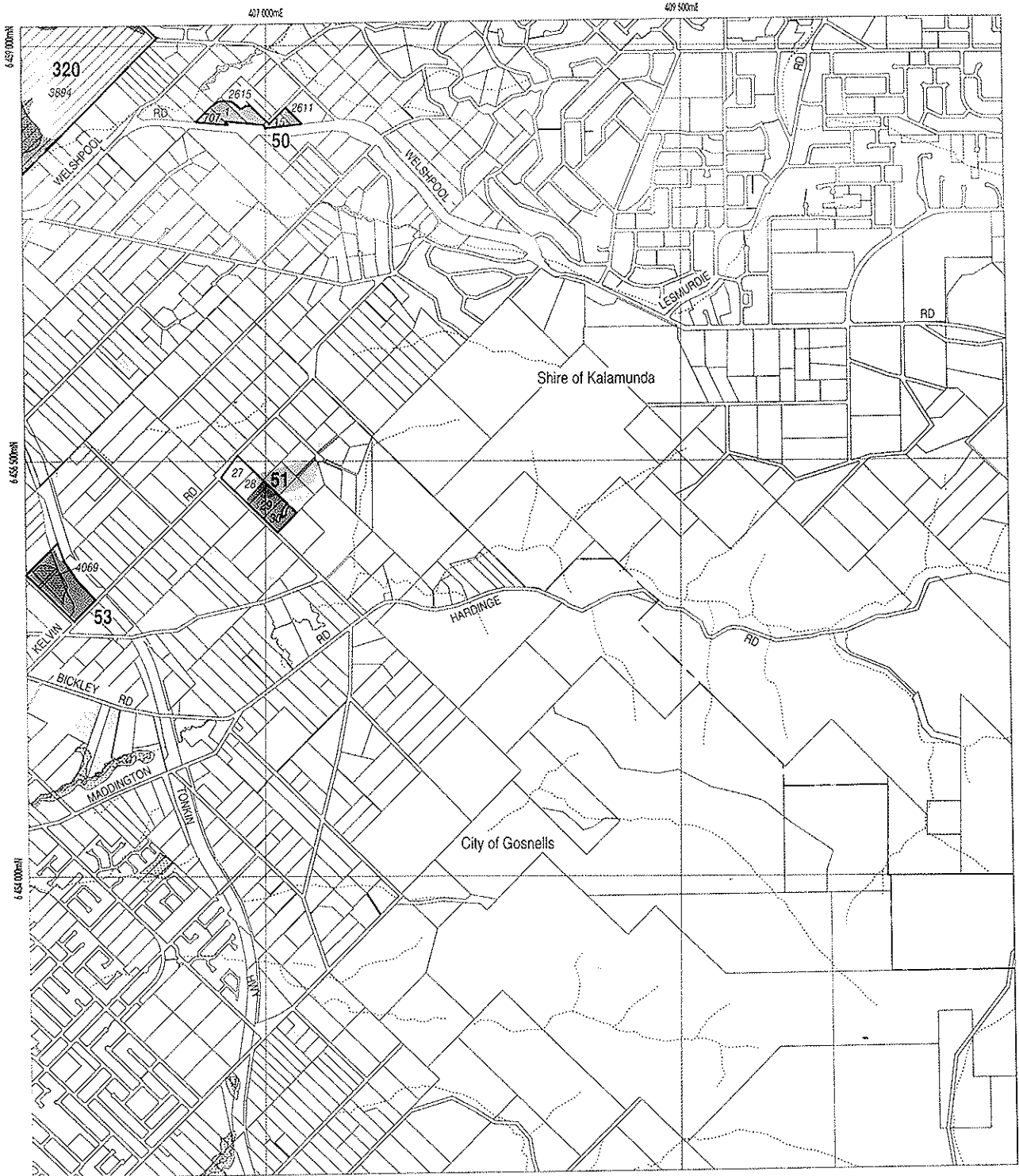

Constraints: private land; under General Mineral Resource Area (clay)

Recommendation: The most appropriate mechanism for the protection of this Bushplan Site be considered through the public comment period in consultation with the land owner(s).





LEGEND

-  Bushplan Sites With Regionally Significant Bushland
-  Other Native Vegetation
-  Conservation Category Wetlands
-  Bushplan Sites With Some Existing Protection
-  Lot Number, Location Number
-  Channel Wetlands
-  Local Government Boundary

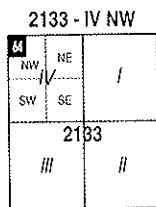

1: 25 000 AMG Reference Grid showing Perth's Bushplan Map Sheet Breakdown

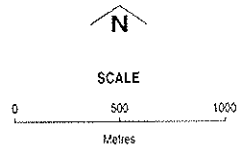
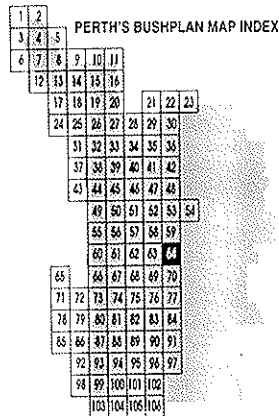

Produced by Project Mapping Section
 Land Information Branch, Ministry for
 Planning, Perth W.A. November 1998
 ntw-map18/environ/bushplan/bushv2_64.dgn
 Cadastral Data supplied by Department
 of Land Administration, W.A.
 Wetlands Data supplied by
 Water and Rivers Commission
 Native Vegetation Extent for Study Area
 supplied by Agriculture Western Australia

508
8/19
INTAKIN

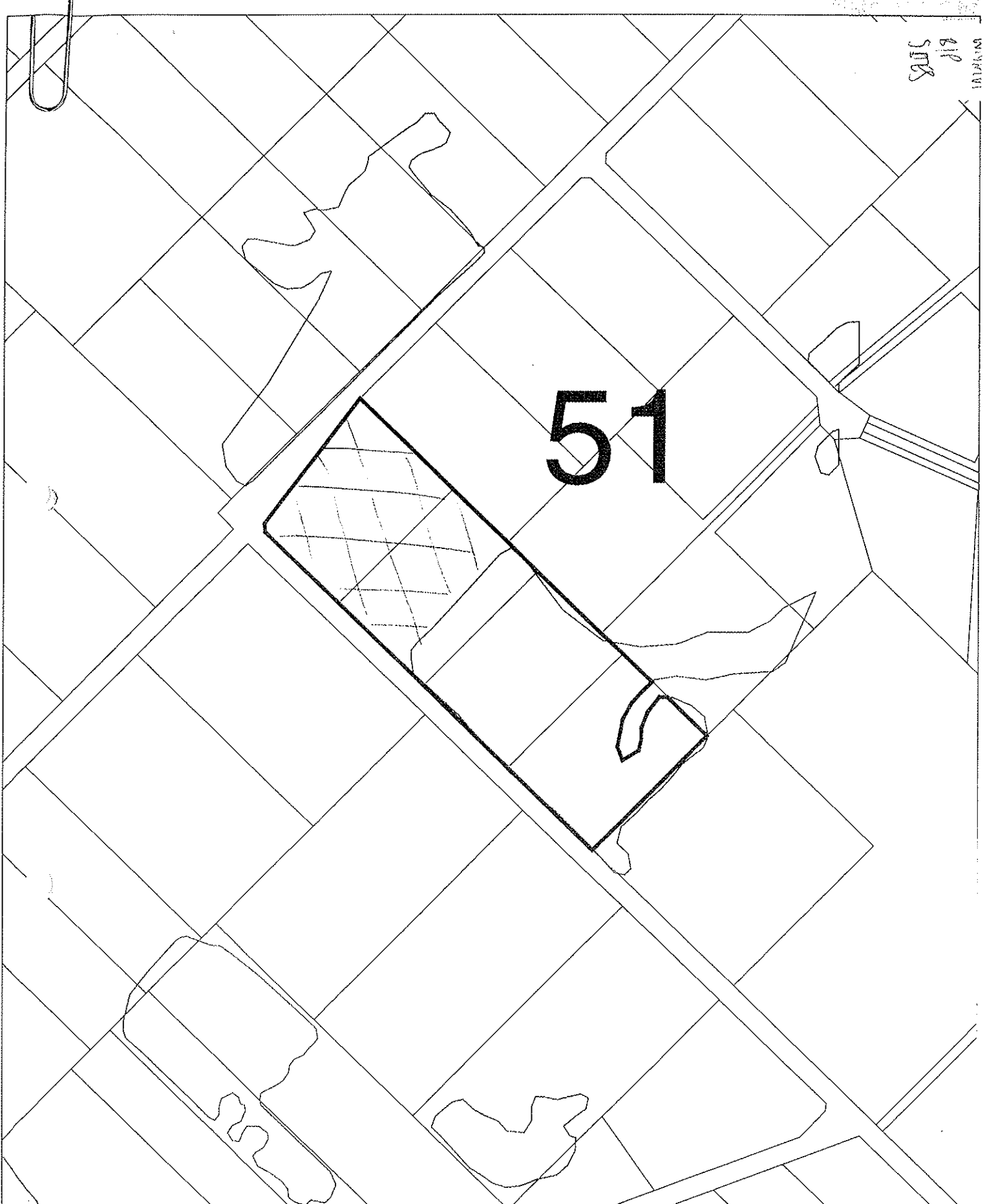

BUSHPLAN SITES CORRECTED

B ok / TB 22/10/98



WESTERN
AUSTRALIAN
PLANNING
COMMISSION



CUSTOMER
FOCUS
WESTERN AUSTRALIA



*Washland, field
inspection 3/6/98 OJK,
as described
Keighan + Trudgeon (1992)*



SCALE 1:2500

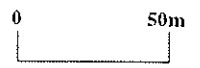

Metres

BJK 1/7/98

DS 51

See note on Map



BUSHPLAN SITES CORRECTED



WESTERN
AUSTRALIAN
PLANNING
COMMISSION



CUSTOMER
FOCUS
WESTERN AUSTRALIA



Lushland, field
inspection 3/6/98 BJK,
as described
Keighan + Trudgeon (1992)



SCALE 1:2500



Metres

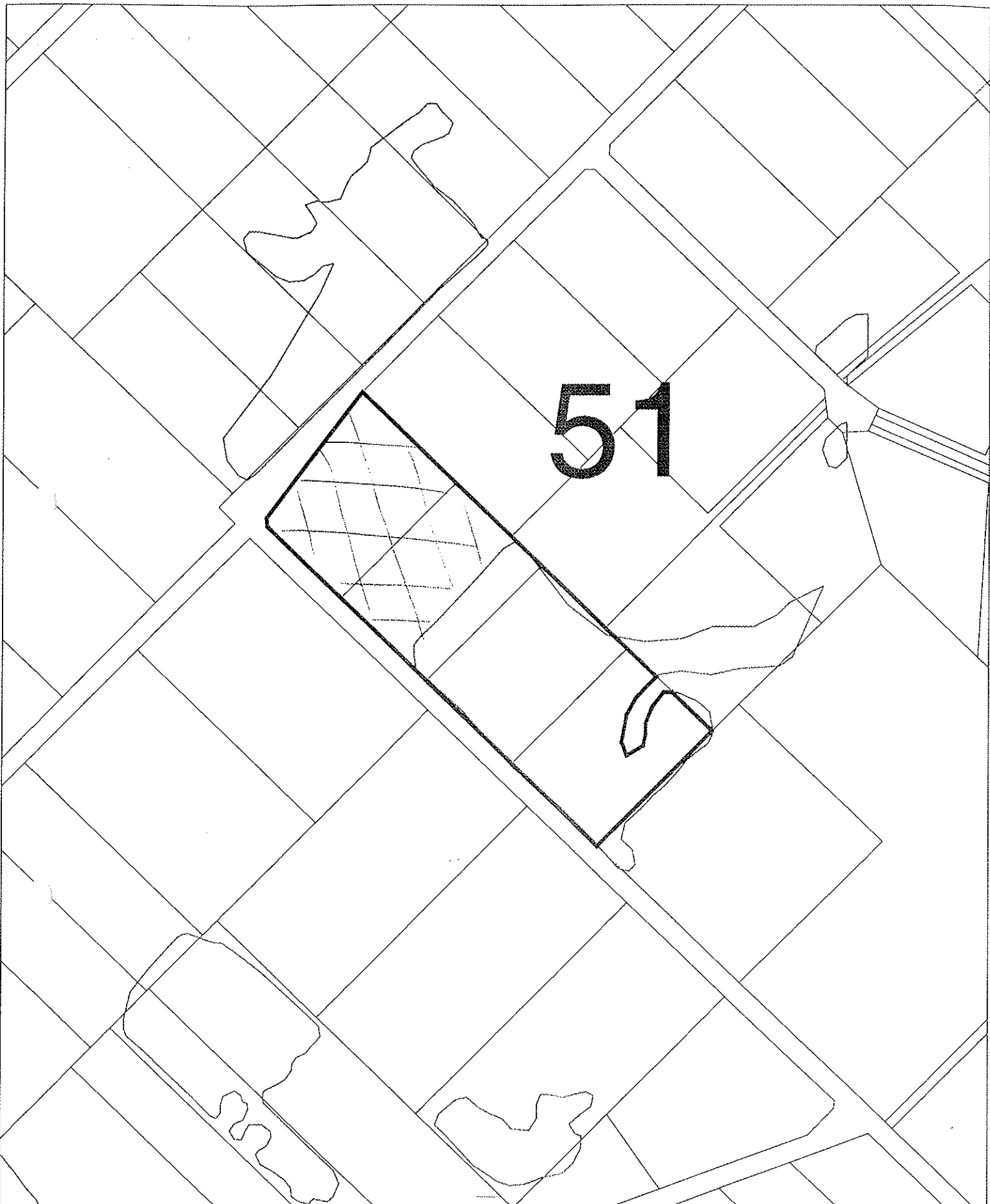

BUSHPLAN SITES CORRECTED



WESTERN
AUSTRALIAN
PLANNING
COMMISSION



*bushland, field
inspection 3/6/98 DJK,
as described
Keighery + Trudgeon (1992)*





SCALE 1:2500

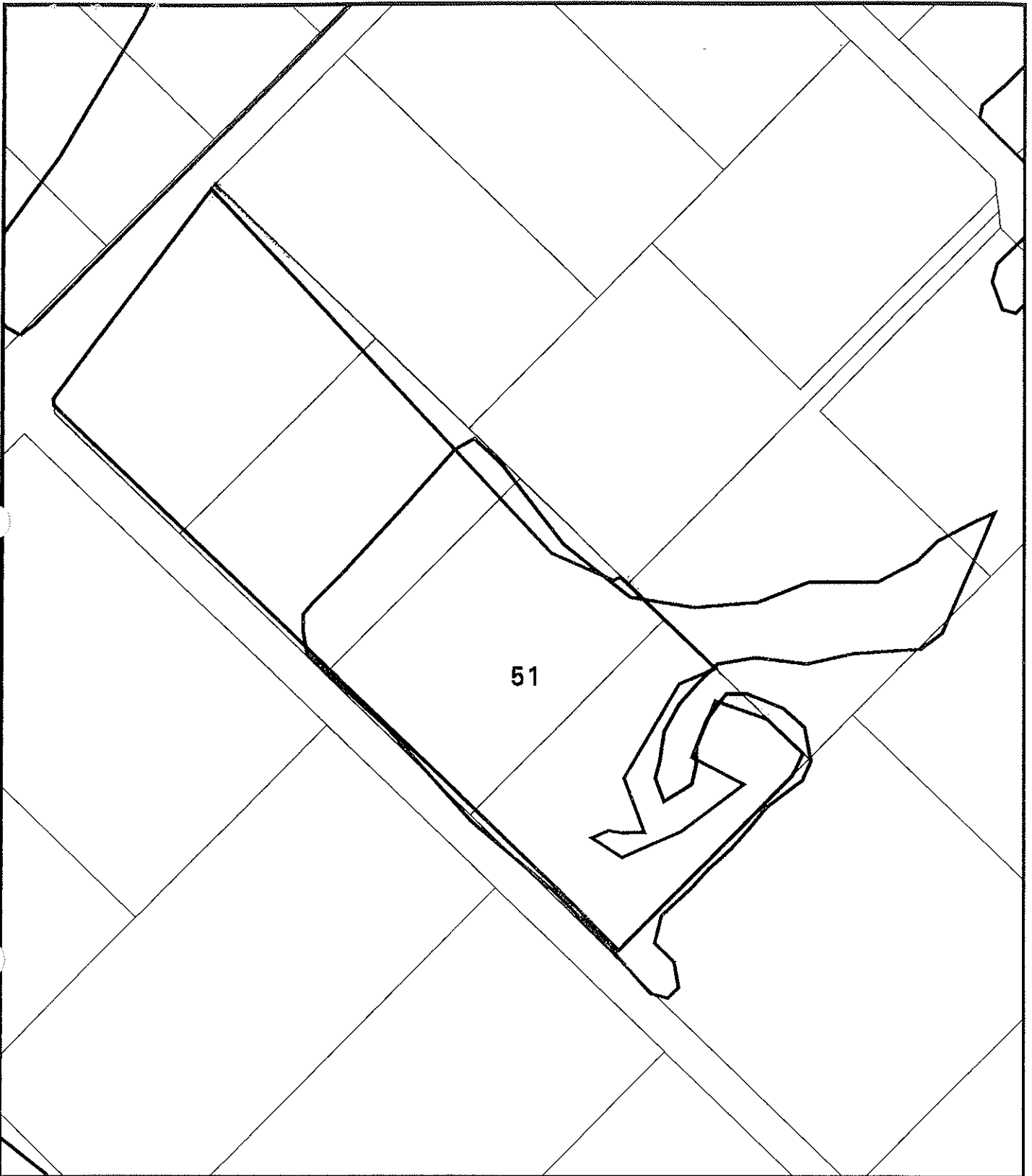

Metres



bp site 51

-  AG VEG 1998 BOUNDARY THEME
-  Cadastre
-  Bushplan sites refno 1-500 SCP BOUNDARY THEME

MFP INTERNAL USE ONLY

Prepared By: Andrea Zappacosta

Prepared For:

Map Ident: plot980522_1

Date: 22 May 98

Scale 1:3270

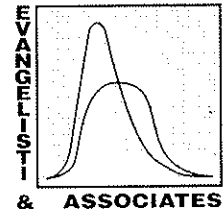

WATER RESOURCES MANAGEMENT PLAN

MIDDLE CANNING CATCHMENT

(STAGE 1 - VOLUME 1)

Prepared for the

Water Authority of Western Australia

By

Evangelisti & Associates
Consulting Engineers and Project Managers

in association with

Landvision
Consultants in Urban and Environmental Planning

and

The V & C Semeniuk Research Group
Environmental Scientists

October 1995



5242 WA 3166(C) METRO REGIONAL AREA & EXT. RUN 15 (5215-5307) 1:20000 11-DEC-92 920676

BSS

[Bushland/Veg
to add
field inspection
CSK 3/6/98

WILD 1574 UAGA
Nr 13037 152.72

000054

- 5 0 2 2 - 1 2 6 7 - 5 6 1 0 0 0 1 8 0 0 2 4 0 5 6 -

0 9 1 2 0 9 2 5 2 1 0 9 1 6 6 2 0 0 0 0 0 0 0 0

