

## BOB BLACKBURN RESERVE BUSHLAND, ARMADALE

**Boundary Definition:** bushland (part taken to cadastre) boundary

### SECTION 1: LOCATION INFORMATION

**Bush Forever Site no.** 62

**Area (ha):** bushland 5.1

**Map no.** 61

**Map sheet series ref. no.** 2033-I SE, 2133-IV SW

**Other Names:** Submission Area 166; Location 41 (Keighery, BJ, and Trudgen 1992)

**Local Authorities (Suburb):** City of Armadale (Armadale)

### SECTION 2: REGIONAL INFORMATION

#### LANDFORMS AND SOILS

##### Pinjarra Plain

Guildford Formation (Qpa: Cs)

##### Bassendean Dunes

Bassendean Sands (Qpb: S8)

##### Bassendean Dunes/Pinjarra Plain

Bassendean Sands over Guildford Formation (Qpb/Qpa: S10)

#### VEGETATION AND FLORA

##### Vegetation Complexes

###### Foothills

Forrestfield Complex (Ridge Hill Shelf, Darling Plateau)

###### Pinjarra Plain

Guildford Complex

**Floristic Community Types:** \*not sampled, type inferred

##### Supergroup 3: Uplands centred on Bassendean Dunes and Dandaragan Plateau

\*20b Eastern *Banksia attenuata* and/or *Eucalyptus marginata* woodlands

#### WETLANDS

No wetlands mapped

#### THREATENED ECOLOGICAL COMMUNITIES

Endangered (floristic community type 20b)

### SECTION 3: SPECIFIC SITE DETAIL

**Landscape Features:** vegetated uplands

**Vegetation and Flora:** limited survey (Keighery, BJ, and Trudgen 1992)

**Structural Units:** mapping (Keighery, BJ, and Trudgen 1992)

Uplands: *Eucalyptus calophylla*, *E. marginata* and *Banksia attenuata* Woodland

**Vegetation Condition:** >75% Very Good to Excellent, <25% Good, with areas of severe localised disturbance

**Total Flora:** not known

**Significant Flora:** *Lambertia multiflora* var. *darlingensis* (S. Wallace pers. comm.)

**Fauna:** Significant mammal species: Quenda (Friend 1996 D)

**Linkage:** no adjacent bushland

**Other Special Attributes:** part Site Category One Area, Middle Canning Catchment Study (Evangelisti & Associates *et al.* 1995); contains plant communities representative of the eastern side of the Swan Coastal Plain

### SECTION 4: INTERNATIONAL AND NATIONAL SIGNIFICANCE

Not listed

### SECTION 5: SELECTION CRITERIA AND RECOMMENDATIONS

**Criteria:** Representation of ecological communities, Diversity, Rarity

**Recommendation:** Local Reserve Mechanism (see Table 3, Volume 1).

**BOB BLACKBURN RESERVE BUSHLAND, ARMADALE**

**Boundary Definition:** bushland (part taken to cadastre) boundary

**SECTION 1: CADASTRAL INFORMATION**

(Lots, locations and derived information to be updated in the public submission period)

**Bushplan Site no.** 62      **Map no.** 76, 77      **Map sheet series ref. no.** 2033-I SE, 2133-IV SW

**Other Names**      **Area (ha):** total 5.2; bushland 5.1

Submission Area 166; Location 41 (Keighery, BJ, and Trudgen 1992)

**Local Authorities (Suburb)**  
City of Armadale (Armadale)

**Zoning**

**MRS:** Urban  
**TPS:** Residential, Landscape

**Ownership Categories**

Local Government, State Government

**Lot/Location/Reserve numbers (Purpose),**

**Street name**

3560 Williams Rd; 32 Champion Dr; 3560 Challis Rd

Crown Reserve

**SECTION 2: REGIONAL INFORMATION**

**LANDFORMS AND SOILS**

**Pinjarra Plain**

Guildford Formation (Qpa: Cs)

**Bassendean Dunes**

Bassendean Sands (Qpb: S8)

**Bassendean Dunes/Pinjarra Plain**

Bassendean Sands over Guildford Formation (Qpb/Qpa: S10)

**VEGETATION AND FLORA**

**Vegetation Complexes**

**Foothills**

Forrestfield Complex (Ridge Hill Shelf, Darling Plateau)

**Pinjarra Plain**

Guildford Complex

**Floristic Community Types:** \*not sampled, types inferred

**Supergroup 3: Uplands centred on Bassendean Dunes and Dandaragan Plateau**

\*20b Eastern *Banksia attenuata* and/or *Eucalyptus marginata* woodlands

**WETLANDS**

No wetlands mapped

**THREATENED ECOLOGICAL COMMUNITIES**

Endangered (floristic community type 20b)

**SECTION 3: SPECIFIC SITE DETAIL**

**Landscape Features:** vegetated uplands

**Vegetation and Flora:** limited survey (Keighery, BJ, and Trudgen 1992)

**Structural Units:** mapping (Keighery, BJ, and Trudgen 1992)

Uplands: *Eucalyptus calophylla*, *E. marginata* and *Banksia attenuata* Woodland

**Vegetation Condition:** >75% Very Good to Excellent, <25% Good, with areas of severe localised disturbance

**Total Flora:** not known

**Significant Flora:** *Lambertia multiflora* var. *darlingensis* (S. Wallace pers. com.)

**Fauna:** no systematic survey. Significant mammal species: Quenda (Friend 1996 D)

**Linkage:** no adjacent bushland

**Other Special Attributes:** part Bushplan Site Category One Area Middle Canning Catchment Study (Evangelisti & Associates *et al.* 1995); contains plant communities representative of the eastern side of the Swan Coastal Plain

**SECTION 4: INTERNATIONAL AND NATIONAL SIGNIFICANCE**

Not listed



**SECTION 5: SELECTION CRITERIA AND RECOMMENDATIONS**

**Criteria:** Representation of ecological communities, Diversity, Rarity

**Opportunities and/or Constraints**

Opportunities: Bushplan Site/part Bushplan Site subject to Swan and Canning Rivers EPP; under TPS

Landscape Zoning, Crown Reserve

Constraints: under MRS Urban Zoning

**Recommendation:** The existing care, control and management intent of the reserve is endorsed. Long-term security and support for conservation management of the Bushplan Site to be enhanced by: amending the purpose of the reserve to include conservation; and applying appropriate mechanisms in consultation with the reserve management body.



# 62

62  
DEP Following  
TAS  
reserve  
should  
be boundary  
+ veg

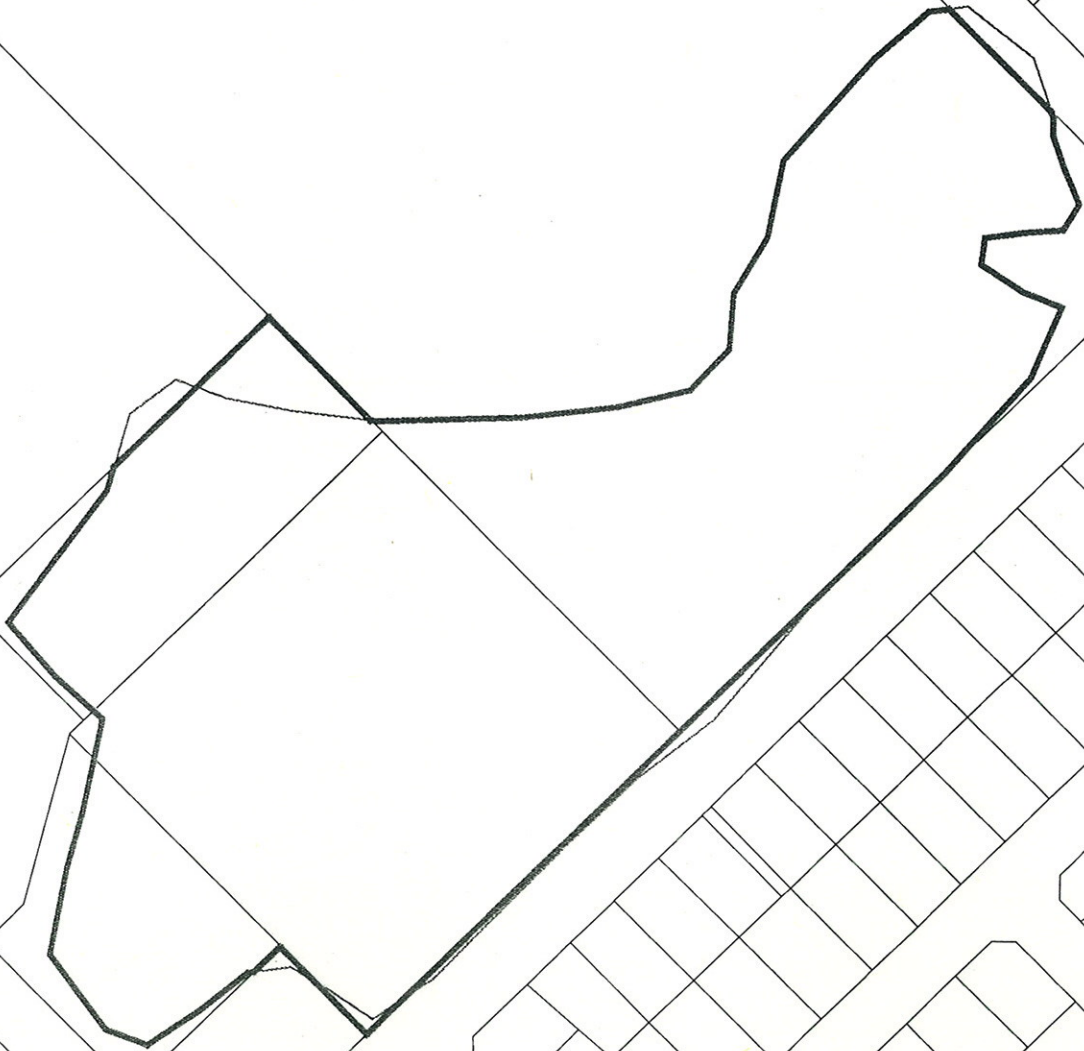

### BUSHPLAN SITES CORRECTED



WESTERN  
AUSTRALIAN  
PLANNING  
COMMISSION



CUSTOMER  
FOCUS  
WESTERN AUSTRALIA

B T2/BL 22/10/28

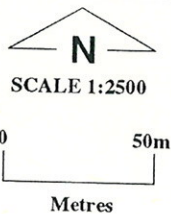

# 62



**BUSHPLAN SITES CORRECTED**



**WESTERN  
AUSTRALIAN  
PLANNING  
COMMISSION**



**CUSTOMER  
FOCUS  
WESTERN AUSTRALIA**





**SCALE 1:2500**

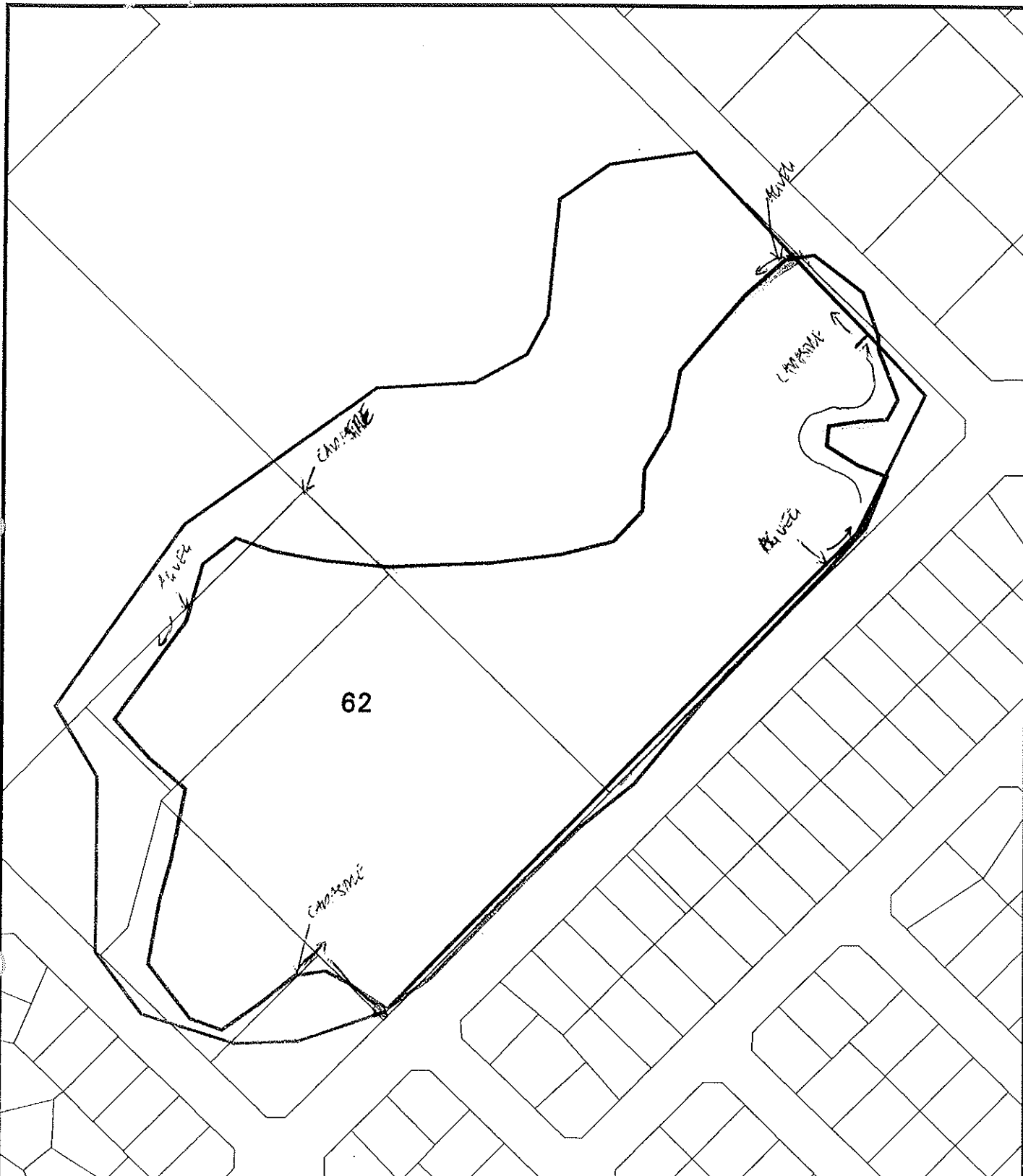

**Metres**

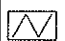

**bp site 62**

-  AG VEG 1998 BOUNDARY THEME
-  Cadastre
-  Bushplan sites refno 1-500 SCP BOUNDARY THEME

MFP INTERNAL USE ONLY

Prepared By: Andrea Zappacosta

Prepared For:

Map Ident: plot980522\_1

Date: 22 May 98

Scale 1:2456

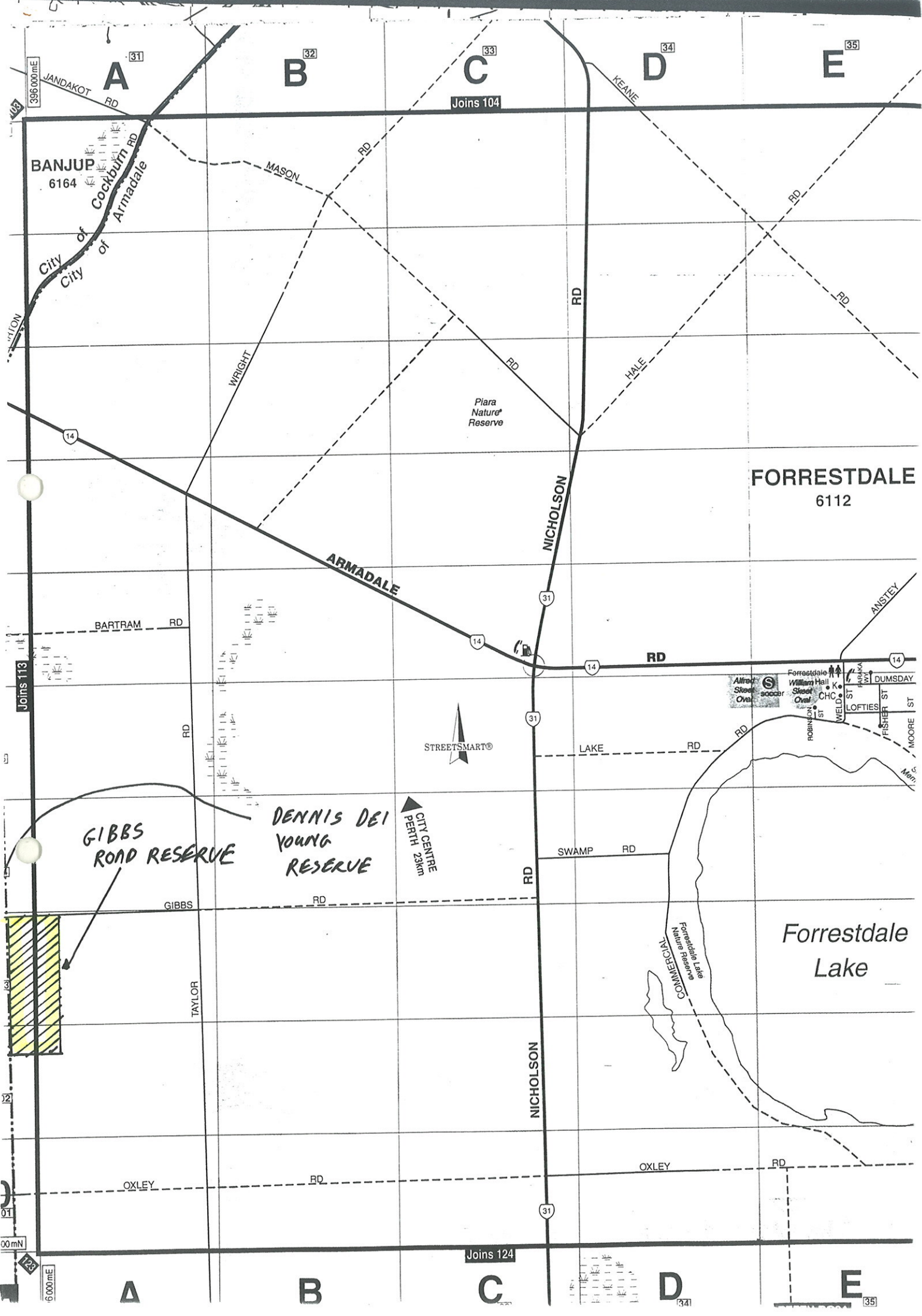

BANJUP  
6164

FORRESTDALE  
6112

Forrestdale Lake

DENNIS DEI  
YOUNG  
RESERVE

GIBBS  
ROAD RESERVE

CITY CENTRE  
PERTH 23km

COMMERCE  
Nature Reserve



396 000 mE  
6 000 mN

Joins 104  
Joins 124

A B C D E  
03  
02  
01  
00 mN  
A B C D E  
341 351

6070m<sup>2</sup> 6070m<sup>2</sup> 2023m<sup>2</sup> 2023m<sup>2</sup> 3592m<sup>2</sup>  
 A28555 A28604 A28640 A28672 A28690 A28703 A14638 A207056 A28820 A28852 A28866  
 0.12 20.12 20.12 20.12 20.12 20.12 20.12 60.36 60.35 20.12 20.12 20.12  
 11 27 25 23 21 19 TS52796 15 7 TS87961 5 3 1

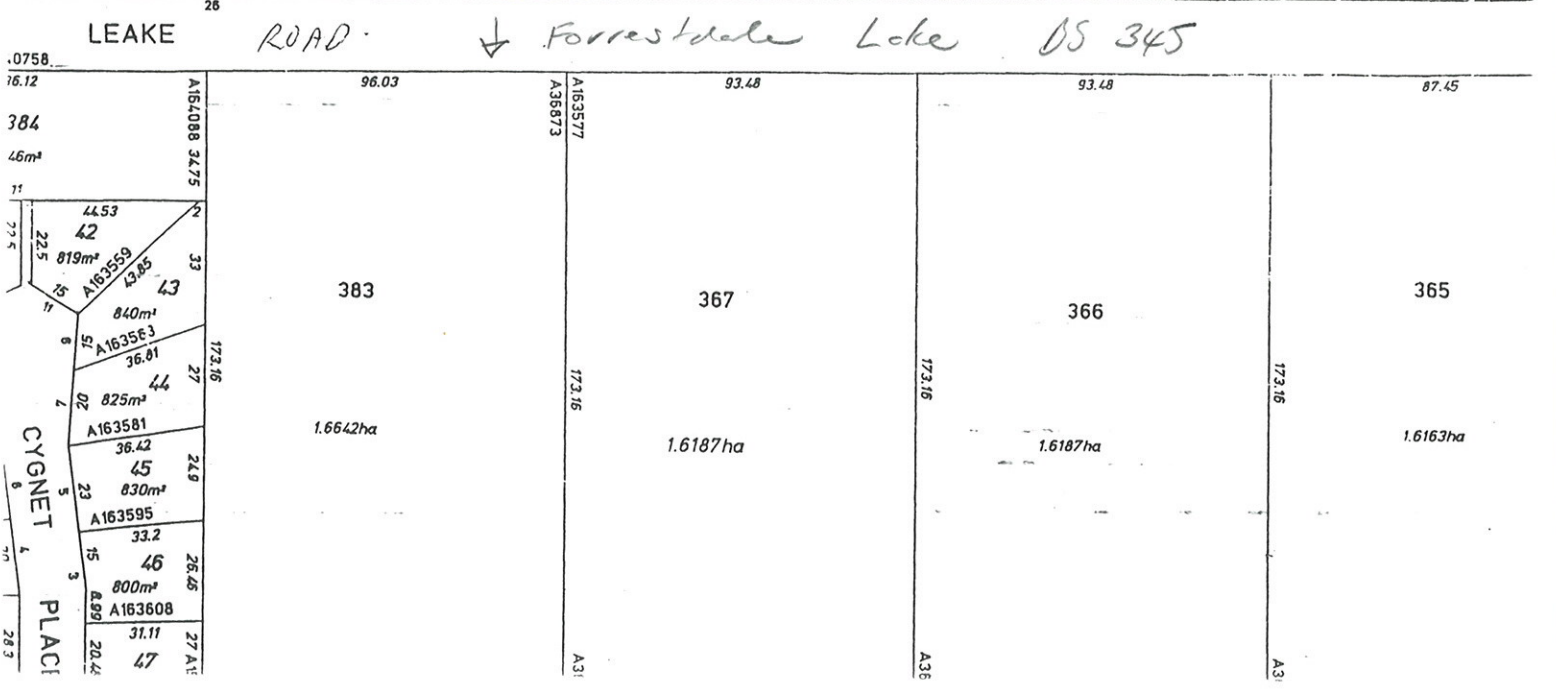
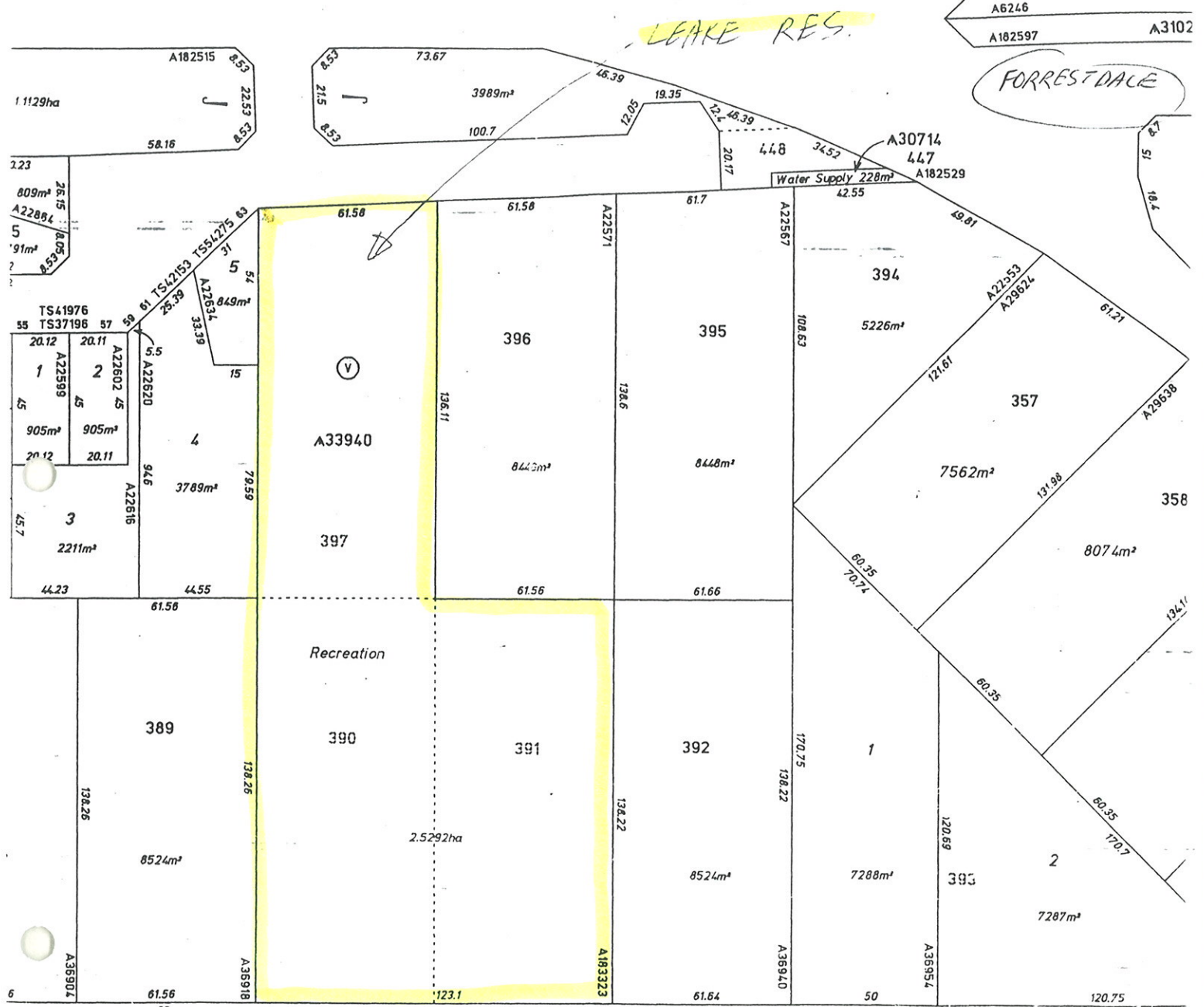



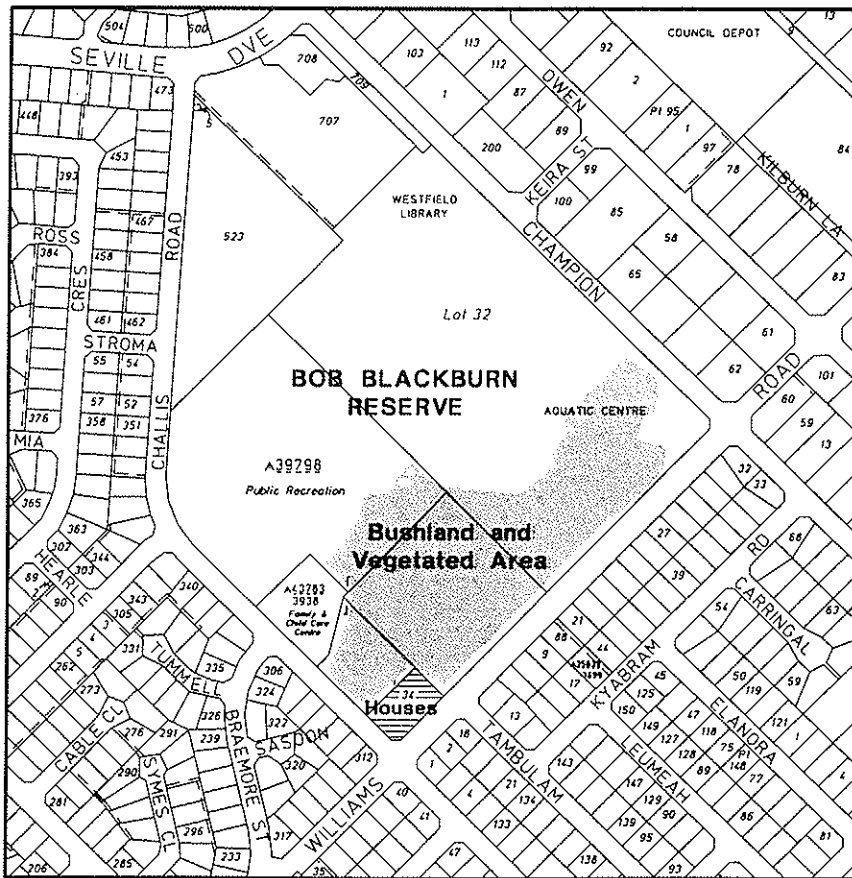
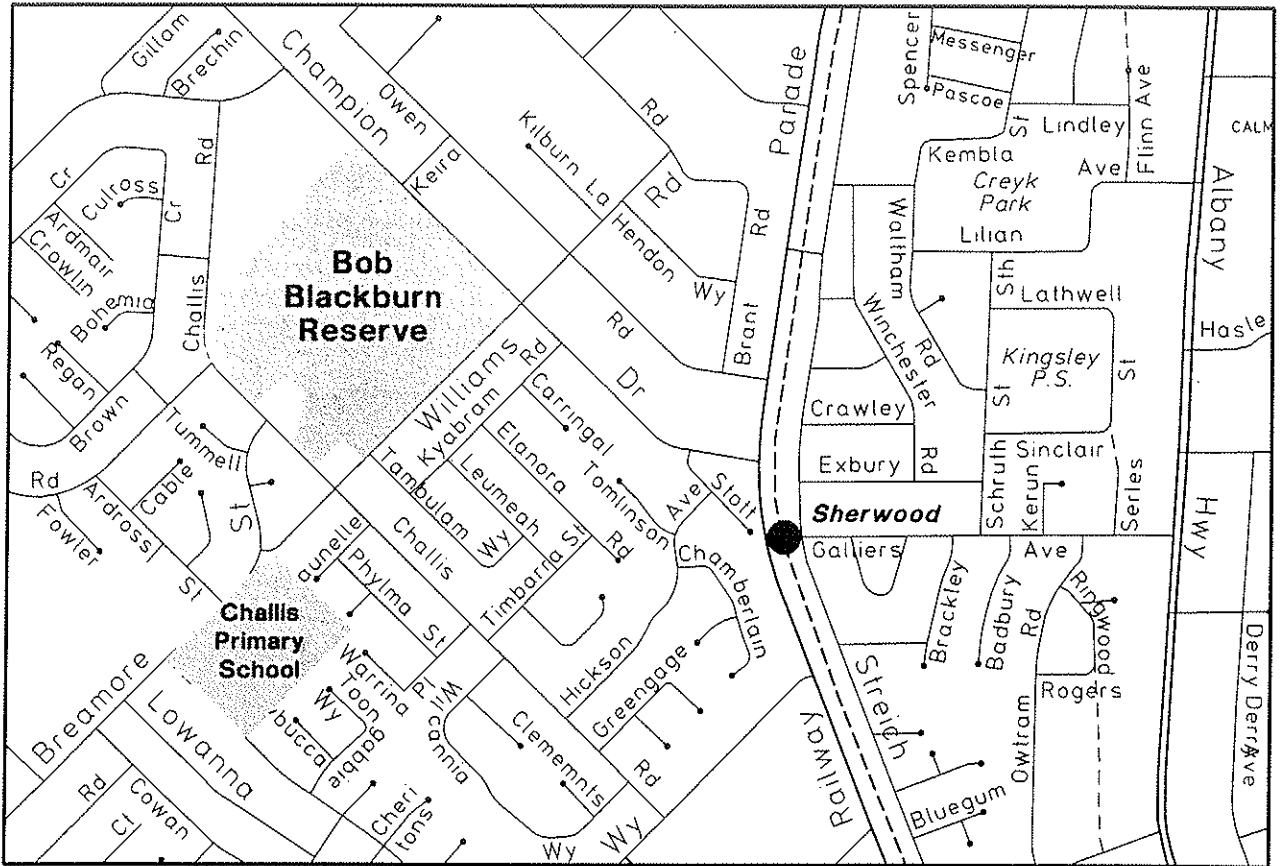

**LOCATION AND TENURE ON BOB BLACKBURN RESERVE**

**Figure 1.1**

*Ref Loc 41*



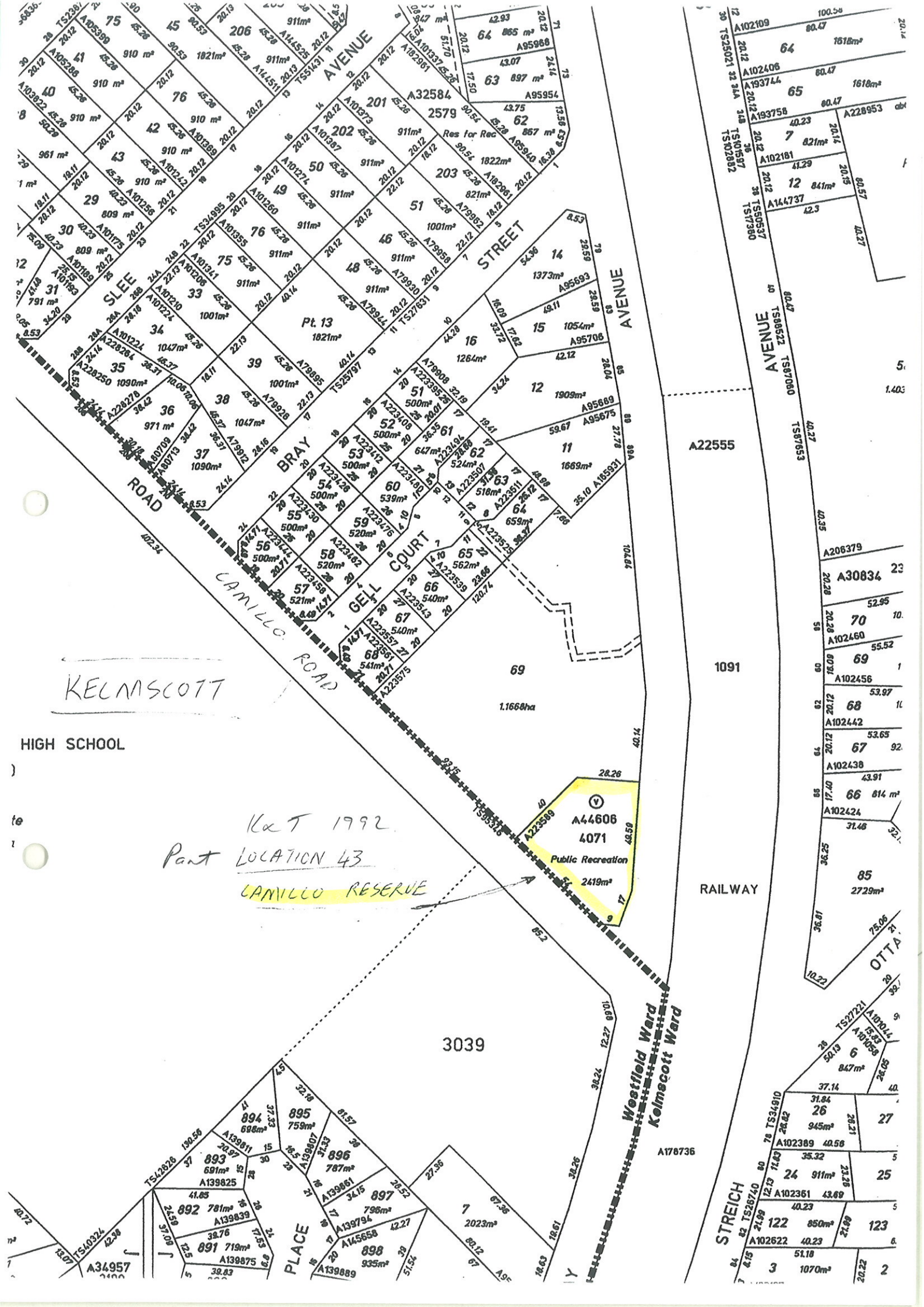

KELMSCOTT

HIGH SCHOOL

Map 1992  
 Part LOCATION 43  
 CAMILLO RESERVE

A44606  
 4071  
 Public Recreation  
 2419m<sup>2</sup>

RAILWAY

Westfield Ward  
 Kelmscott Ward

- A206379
- A30834 23
- 70 10
- A102460
- 69 1
- A102456
- 68 11
- A102442
- 67 92
- A102438
- 66 814 m<sup>2</sup>
- A102424
- 85 2729m<sup>2</sup>

3039

A178736

STREICH

OTTA

A34957

PLACE

- 26 945m<sup>2</sup>
- A102389 40.58
- 24 911m<sup>2</sup>
- A102361 43.69
- 122 850m<sup>2</sup>
- A102622 40.23
- 3 1070m<sup>2</sup>
- 27
- 25
- 123
- 2

BS 264  
K&T 1992  
Location 5

LAMBERT  
LANE  
(NO COUNCIL)

6 441 500mN

6 439 000mN

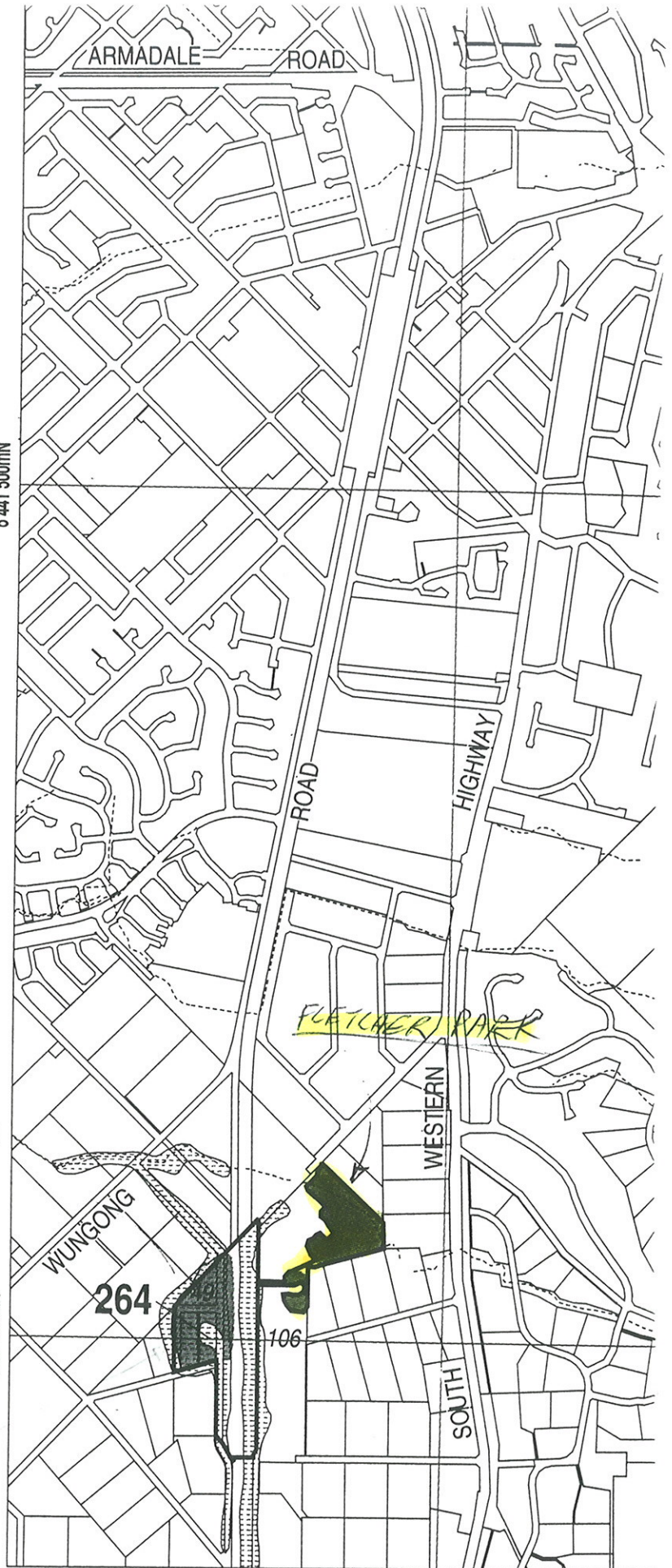

**LEGEND**



Bushplan Sites With Regionally Significant Bushland

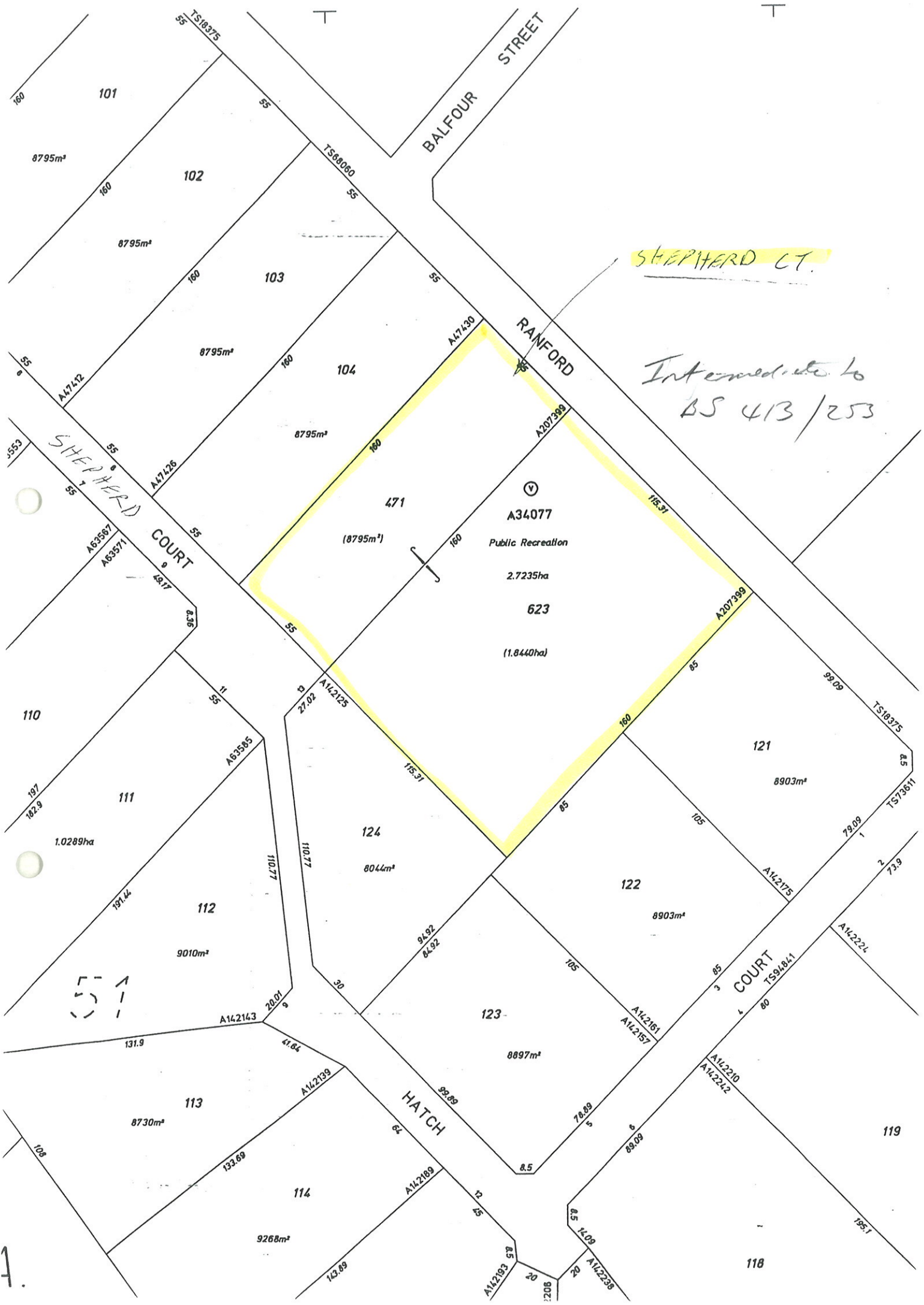

SHEPHERD CT.

Intermediate to  
BS 413/253

51

1.

**APPENDIX A FLORA OF GIBBS ROAD RESERVE**

This listing is based on extending the vegetation type mapping from Denis de Young Reserve undertaken by Keighery (1992) to the Gibbs Road Reserve.

**KEY**

\* = Naturalised

B= Banksia open woodland

Bi = Banksia woodland over heath

| Species                          | Veg Unit |
|----------------------------------|----------|
| ZAMIACEAE                        |          |
| <i>Macrozamia riedlei</i>        | B        |
| ANTHERICACEAE                    |          |
| <i>Arnocrinum preissii</i>       | B        |
| <i>Caesia micrantha</i>          | B        |
| <i>Thysanotus multiflorus</i>    | B        |
| <i>Thysanotus "patersonii"</i>   | B        |
| <i>Thysanotus sparteus</i>       | B        |
| CENTROLEPIDACEAE                 |          |
| <i>Aphelia cyperoides</i>        | B        |
| <i>Centrolepis aristata</i>      | B        |
| <i>Centrolepis drummondiana</i>  | B        |
| CYPERACEAE                       |          |
| <i>Cyathochaeta avenacea</i>     | B, Bi    |
| <i>Isolepus marginatus</i>       | Bi       |
| <i>Lepidosperma angustatum</i>   | B        |
| <i>Mesolmelaena graciliceps</i>  | Bi       |
| <i>Mesolmelaena pseudostygia</i> | B        |
| <i>Schoenus curvifolius</i>      | B        |
| # <i>Schoenus? clandestinus</i>  | B        |
| <i>Schoenus subbulbosus</i>      | B        |

| Species                             | Veg Unit |
|-------------------------------------|----------|
| DASYPOGONACEAE                      |          |
| <i>Dasypogon bromeliifolius</i>     | Bi, B    |
| <i>Lomandra caespitosa</i>          | Bi       |
| <i>Lomandra hermaphrodita</i>       | B        |
| <i>Lomandra. preissii</i>           | Bi       |
| <i>Lomandra sericea</i>             | Bi       |
| <i>C. juncea</i>                    | B        |
| <i>Haemodorum spicatum</i>          | B        |
| <i>Phlebocarya ciliatum</i>         | B        |
| IRIDACEAE                           |          |
| * <i>Gladiolus carylophyllaceus</i> | B        |
| <i>Patersonia occidentalis</i>      | B        |
| JUNCACEAE                           |          |
| <i>Luzula meridionalis</i>          | Bi       |
| POACEAE                             |          |
| <i>Amphipogon turbinatus</i>        | B, Bi    |
| * <i>Avena barbata</i>              | B        |
| * <i>Briza maxima</i>               | B        |
| <i>Danthonia occidentalis</i>       | B        |
| * <i>Ehrharta calycina</i>          | B, D     |
| <i>Eragrostis elongata</i>          | B        |
| <i>Microlaena stipoidea</i>         | Bi       |
| <i>Neurachne alopecuroidea</i>      | B        |
| <i>Stipa compressa</i>              | B        |
| * <i>Vulpia bromioides</i>          | B        |
| RESTIONACEAE                        |          |
| <i>Hypolaena exsulca</i>            | B, Bi    |
| <i>Loxocarya flexuosa</i>           | B        |
| <i>Loxocarya cinerea</i>            | B, Bi    |
| <i>Lyginia barbata</i>              | B        |
| XANTHORRHOEACEAE                    |          |

| Species                            | Veg Unit |
|------------------------------------|----------|
| <i>Xanthorrhoea preissii</i>       | B, Bi    |
| AIZOACEAE                          |          |
| * <i>Carpobrotus edulis</i>        | B        |
| AMARANTHACEAE                      |          |
| <i>Ptilotus drummondii</i>         | B        |
| APIACEAE                           |          |
| <i>Daucus glochidiatus</i>         | Bi, B    |
| <i>Homalosciadium homalocarpum</i> | B        |
| <i>Hydrocotyle callicarpa</i>      | B        |
| <i>Platysace compressa</i>         | B, Bi    |
| <i>Trachymene pilosa</i>           | B        |
| <i>Xanthosia huegelii</i>          | B        |
| ASTERACEAE                         |          |
| <i>Asteridea pulverulenta</i>      | B        |
| <i>Lagenifa huegelii</i>           | Bi, B    |
| <i>Millotia myosotidiifolia</i>    | B        |
| <i>Podotheca angustifolia</i>      | B        |
| <i>Quinetia urvillei</i>           | B        |
| <i>Siloxerus humifusus</i>         | Bi, B    |
| * <i>Sonchus oleraceus</i>         | B        |
| * <i>Ursinia anthemoides</i>       | B        |
| <i>Waitzia paniculata</i>          | B        |
| CAMPANULACEAE                      |          |
| * <i>Wahlenbergia capensis</i>     | B        |
| <i>Wahlenbergia preissii</i>       | B        |
| CASURARINACEAE                     |          |
| <i>Allocasuarina fraseriana</i>    | B, Bi    |
| <i>Allocasuarina humilis</i>       | Bi       |
| CRASSULACEAE                       |          |
| <i>Crassula colorata</i>           | Bi, B    |
| DILLENACEAE                        |          |

| Species                           | Veg Unit |
|-----------------------------------|----------|
| <i>Hibbertia huegelii</i>         | B        |
| <i>Hibbertia hypericoides</i>     | B        |
| <i>Hibbertia racemosa</i>         | B        |
| DROSERACEAE                       |          |
| <i>Drosera erythrorhiza</i>       | B        |
| <i>Drosera glanduligera</i>       | B, Bi    |
| EPACRIDACEAE                      |          |
| <i>Astroloma pallidum</i>         | B, Bi    |
| <i>Conostephium pendulum</i>      | B        |
| <i>Conostephium preissii</i>      | B        |
| <i>Leucopogon conostephioides</i> | B        |
| # <i>Leucopogon racemulosus</i>   | B        |
| <i>Leucopogon ?squarrosus</i>     | B        |
| <i>Lysinema ciliatum</i>          | B        |
| EUPHORBIACEAE                     |          |
| <i>Phyllanthus calycinus</i>      | B        |
| <i>Poranthera microphylla</i>     | Bi, B    |
| GOODENIACEAE                      |          |
| <i>Dampiera linearis</i>          | B        |
| <i>Lechenaultia expansa</i>       | Bi       |
| <i>Lechenaultia floribunda</i>    | B        |
| # <i>Scaevola canescens</i>       | B        |
| HALORAGACEAE                      |          |
| <i>Gonocarpus pithyoides</i>      | B        |
| LAMIACEAE                         |          |
| <i>Hemiandra pungens</i>          | B        |
| LOBELLIACEAE                      |          |
| <i>Isotoma hypocratiformis</i>    | B, Bi    |
| <i>Lobelia tenuior</i>            | B        |
| LOGANIACEAE                       |          |
| <i>Mitrasacme paradoxa</i>        | B        |

| Species                               | Veg Unit |
|---------------------------------------|----------|
| LORANTHACEAE                          |          |
| <i>Nuytsia floribunda</i>             | B, Bi    |
| MIMOSACEAE                            |          |
| <i>Acacia huegelii</i>                | B        |
| <i>Acacia pulchella</i> – upland form | B        |
| <i>Acacia saligna</i>                 | Bi       |
| <i>Acacia stenoptera</i>              | B        |
| <i>Acacia willdenowiana</i>           | B        |
| MOLLUGINACEAE                         |          |
| <i>Macarthuria apetala</i>            | B        |
| MYRTACEAE                             |          |
| <i>Calytrix angulata</i>              | B        |
| <i>Calytrix fraseri</i>               | B        |
| <i>Eucalyptus marginata</i>           | B        |
| <i>Eucalyptus todtiana</i>            | B        |
| <i>Kunzea ericifolia</i>              | B, Bi    |
| <i>Melaleuca ?bracteosa</i>           | Bi       |
| <i>Melaleuca thymoides</i>            | B        |
| <i>Scholzia involucrata</i>           | B        |
| <i>Verticordia densiflora</i>         | Bi       |
| OROBANCHACEAE                         |          |
| * <i>Orobanche minor</i>              | B        |
| PAPILLIONACEAE                        |          |
| <i>Aotus ?procumbens</i>              | B        |
| <i>Bossiaea eriocarpa</i>             | B        |
| <i>Davesia triflora</i>               | Bi       |
| <i>Hovea trisperma</i>                | B        |
| <i>Isotropis cuenifolia</i>           | B        |
| <i>Kennedia prostrata</i>             | B        |
| * <i>Lotus angustissimus</i>          | B        |
| <i>Nemecia capitata</i>               | B        |

| Species                                 | Veg Unit |
|---|----------|
| <i>Gompholobium aristatum</i>           | B        |
| <i>Gompholobium conferta</i>            | B        |
| <i>Gompholobium preissii</i>            | B        |
| <i>Phyllota ?gracilis</i>               | B        |
| POLYGALACEAE                            |          |
| <i>Comesperma virgalum</i>              | Bi       |
| PORTULACACEAE                           |          |
| <i>Calandrinia corrigioloides</i>       | B        |
| PROTEACEAE                              |          |
| <i>Adenanthos cygnorum</i>              | B        |
| <i>Banksia attenuata</i>                | B        |
| <i>Banksia illicifolia</i>              | Bi,      |
| <i>Banksia menziesii</i>                | B        |
| <i>Dryandra nivea</i>                   | B        |
| <i>Hakea prostrata</i>                  | B        |
| <i>Petrophile linearis</i>              | B        |
| <i>Stirlingia latifolia</i>             | B        |
| RUTACEAE                                |          |
| <i>Eriostemon spicatus</i>              | B        |
| SCROPHULARIACEAE                        |          |
| * <i>Dischisma capitatum</i>            | B        |
| STYLIDIACEAE                            |          |
| <i>Levenhookia <del>stipitata</del></i> | Bi,      |
| <i>Stylidium brunonianum</i>            | B        |
| <i>Stylidium calcaratum</i>             | B        |
| <i>Stylidium piliferum</i>              | B        |
| <i>Stylidium repens</i>                 | Bi       |
| <i>Stylidium schoenoides</i>            | B        |
| VIOLACEAE                               |          |
| <i>Hybanthus calycinus</i>              | B        |

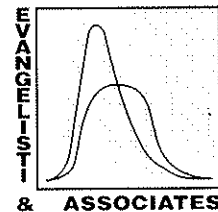

---

# **WATER RESOURCES MANAGEMENT PLAN**

## **MIDDLE CANNING CATCHMENT**

(STAGE 1 - VOLUME 1)

Prepared for the

**Water Authority of Western Australia**

By

**Evangelisti & Associates**  
Consulting Engineers and Project Managers

in association with

**Landvision**  
Consultants in Urban and Environmental Planning



and

**The V & C Semeniuk Research Group**  
Environmental Scientists

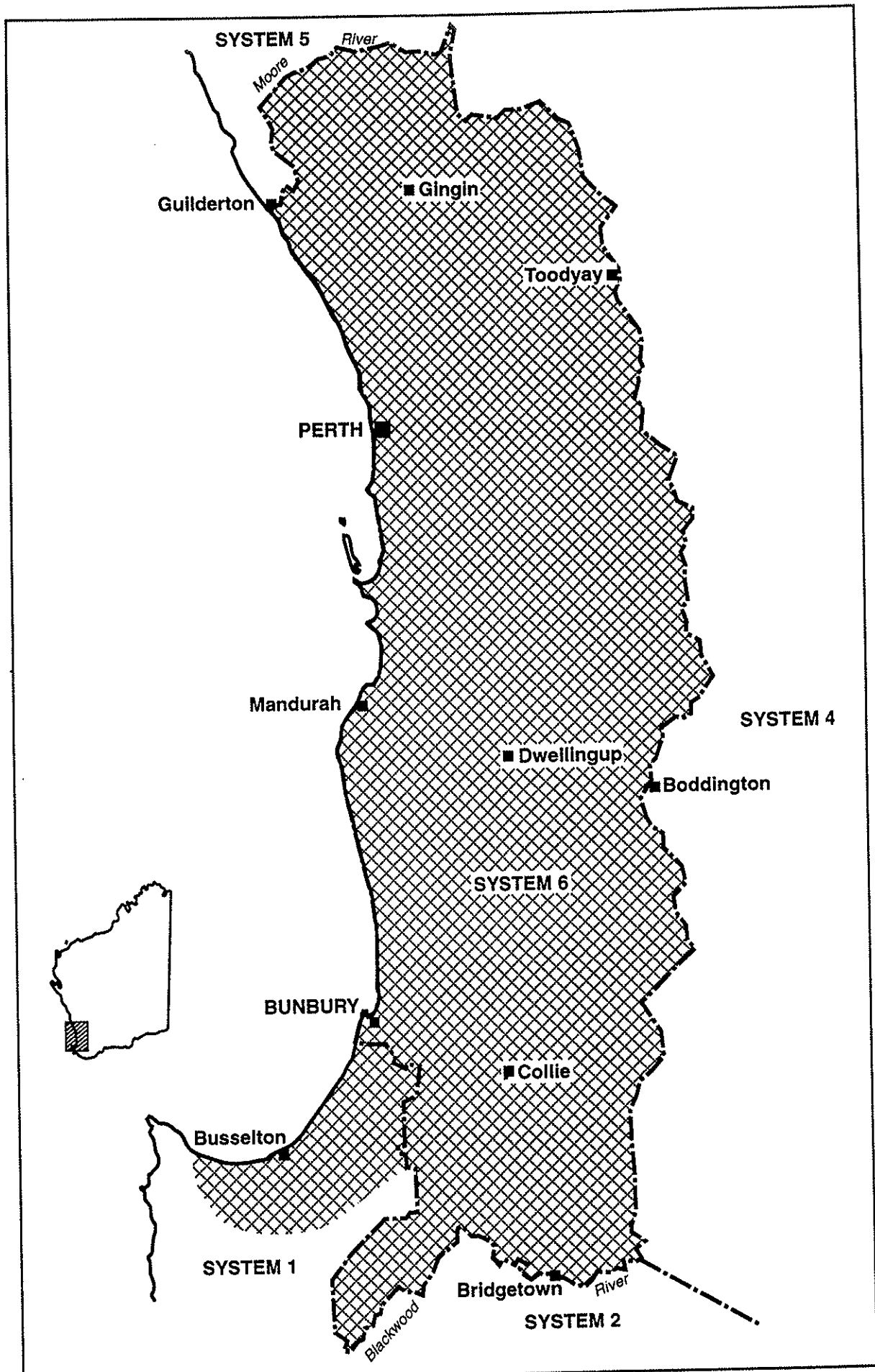
October 1995

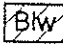
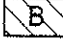
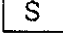

**SYSTEM 6 UPDATE PROGRAMME STUDY AREA**

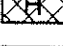
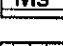
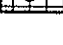
- OPEN*
-  Banksia woodland
  -  Banksia woodland over heath
  -  Sedgeland
  -  Melaleuca woodland
  -  *Hypocalymma angustifolium* heath
  -  Melaleuca closed shrubland
  -  Cleared

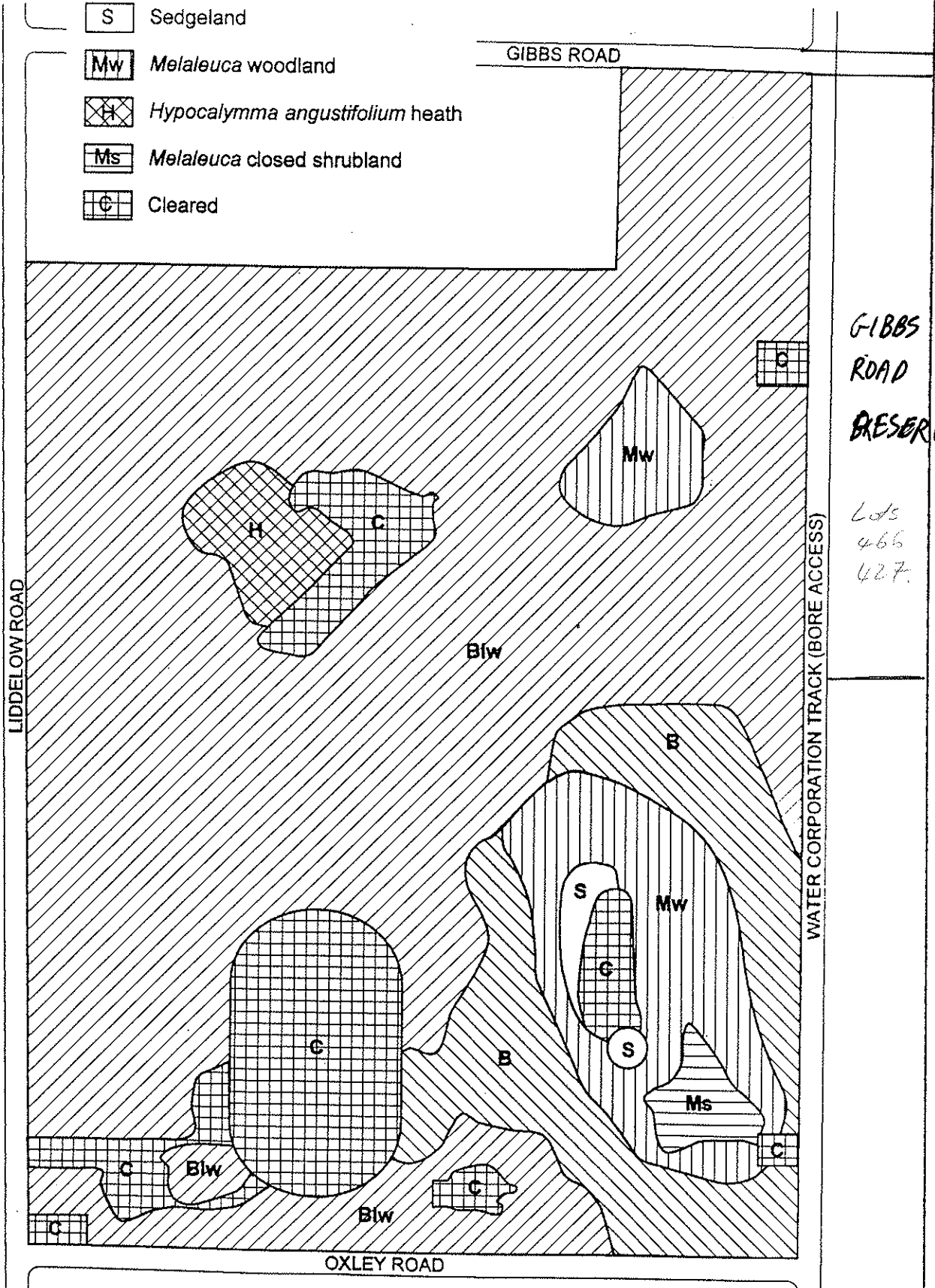

Vegetation  
Denis De Young Reserve

Figure 5