

NEAVES ROAD CREEK, BULLSBROOK

Boundary Definition: management/bushland/conservation wetland boundary (Areas of bushland within the boundaries of the Site are not accurately mapped.)

SECTION 1: LOCATION INFORMATION

Bush Forever Site no. 100 Area (ha): bushland 26.9

Map no. 24

Map sheet series ref. no. 2034-I SE, 2134-IV SW

Other Names: not known

Local Authorities (Suburb): Shire of Swan (Bullsbrook)

SECTION 2: REGIONAL INFORMATION

LANDFORMS AND SOILS

Pinjarra Plain

Guildford Formation (Qpa: Mgs1)

Bassendean Dunes

Bassendean Sands (Qpb: S8)

Bassendean Dunes/Pinjarra Plain

Bassendean Sands over Guildford Formation (Qpb/Qpa: S10)

VEGETATION AND FLORA

Vegetation Complexes

Pinjarra Plain

Yanga Complex

Floristic Community Types: not sampled, types not inferred

Supergroup 2: Seasonal Wetlands

WETLANDS

Wetland Types: palusplain, creek

Natural Wetland Groups

Bassendean—Pinjarra transition OR Bassendean with fluvial features

Muchea (B/P.3)

Swan Coastal Plain Rivers

Ellen Brook (R.3)

Wetland Management Objectives: Conservation (7.2ha), Multiple Use

Swan Coastal Plain Lakes EPP: none identified

THREATENED ECOLOGICAL COMMUNITIES

Not determined

SECTION 3: SPECIFIC SITE DETAIL

Landscape Features: vegetated wetland, creek

Vegetation and Flora: limited survey (Connell 1995, DEP 1998 (surveyed from roadside), DEP 2000, Matiske Consulting Pty Ltd 1997)

Structural Units

Wetlands: *Melaleuca raphiophylla* Low Open Forest with scattered *M. preissiana* and *Eucalyptus rudis*;

Baumea preissii Sedgeland; *Juncus pallidus* Sedgeland

Scattered Native Plants: not assessed

Vegetation Condition: Good to Degraded (Connell 1995, Matiske Consulting Pty Ltd 1997)

Total Flora: not known

Significant Flora: none recorded

Fauna: Significant mammal species: Quenda (Friend 1996 D)

Linkage: adjacent bushland to the west; part of Greenway 42 (Tingay, Alan & Associates 1998a); part of a regionally significant fragmented bushland/wetland linkage (Part A, Map 7)

Other Special Attributes: contains plant communities representative of the eastern side of the Swan Coastal Plain

SECTION 4: INTERNATIONAL AND NATIONAL SIGNIFICANCE

Not listed

SECTION 5: SELECTION CRITERIA AND RECOMMENDATIONS

Criteria: Representation of ecological communities, Rarity, General criteria for the protection of wetland, streamline and estuarine fringing vegetation and coastal vegetation

Recommendation: Regional Creekline Mechanism (with mapped vegetation) (see Table 3, Volume 1).

NEAVES ROAD CREEK, BULLSBROOK

Boundary Definition: management/bushland/conservation wetland boundary

SECTION 1: CADASTRAL INFORMATION

(Lots, locations and derived information to be updated in the public submission period)

Bushplan Site no. 100 **Map no.** 29, 30 **Map sheet series ref. no.** 2034-I SE, 2134-IV SW

Other Names: not known

Area (ha): total 34.4; bushland 26.9

Local Authorities (Suburb)

Shire of Swan (Bullsbrook)

Zoning

MRS: Rural, Railways

TPS: Landscape, General Rural

Ownership Categories

Commonwealth Government, Private

Lot/Location/Reserve numbers (Purpose),

Street name

5, 1478 West Rd; 3, 100, 101, 2136, 2820 Neaves Rd; 8, 89, 1723 Bingham Rd; 2, 1520 Railway Pde; 0, 1 street not identified

SECTION 2: REGIONAL INFORMATION

LANDFORMS AND SOILS

Pinjarra Plain

Guildford Formation (Qpa: Mgs1)

Bassendean Dunes

Bassendean Sands (Qpb: S8)

Bassendean Dunes/Pinjarra Plain

Bassendean Sands over Guildford Formation (Qpb/Qpa:S10)

VEGETATION AND FLORA

Vegetation Complexes

Pinjarra Plain

Yanga Complex

Floristic Community Types: not sampled, types not inferred

Supergroup 2: Seasonal Wetlands

WETLANDS

Wetland Types: palusplain, creek

Natural Wetland Groups

Bassendean—Pinjarra transition OR Bassendean with fluvial features

Muchea (B/P.3)

Swan Coastal Plain Rivers

Ellen Brook (R.3)

Wetland Management Objectives: Conservation (7.2ha), Multiple Use

Swan Coastal Plain Lakes EPP: none identified

THREATENED ECOLOGICAL COMMUNITIES

Not determined

SECTION 3: SPECIFIC SITE DETAIL

Landscape Features: vegetated wetland, creek

Vegetation and Flora: limited survey (Connell 1995, DEP 1998 (surveyed from roadside), Mattiske Consulting Pty Ltd 1997)

Structural Units

Wetlands: *Melaleuca raphiophylla* Low Open Forest with scattered *M. preissiana* and *Eucalyptus rudis*; *Lepidosperma ? gladiatum* Sedgeland; *Juncus pallidus* Sedgeland

Scattered Native Plants: not assessed

Vegetation Condition: Good to Degraded (Connell 1995, Mattiske Consulting Pty. Ltd. 1997)

Total Flora: not known

Significant Flora: none recorded

Fauna: no systematic survey. Significant mammal species: Quenda (Friend 1996 D)

Linkage: adjacent bushland to the west; part of proposed Greenway 43 (Tingay, Alan & Associates 1997a); part of a regionally significant fragmented bushland/wetland linkage (Volume 2A, Map 8)

Other Special Attributes: contains plant communities representative of the eastern side of the Swan Coastal Plain

SECTION 4: INTERNATIONAL AND NATIONAL SIGNIFICANCE

Not listed



SECTION 5: SELECTION CRITERIA AND RECOMMENDATIONS

Criteria: Representation of ecological communities, Rarity, General criteria for the protection of wetland, streamline and estuarine fringing and coastal vegetation

Opportunities and/or Constraints

Opportunities: Bushplan Site/part Bushplan Site subject to Swan and Canning Rivers EPP; location of conservation category wetlands; under TPS Landscape Zoning

Constraints: private land; under General Mineral Resource Area (sand)

Recommendation: The most appropriate mechanism for the protection of this Bushplan Site be considered through the public comment period in consultation with the land owner(s).



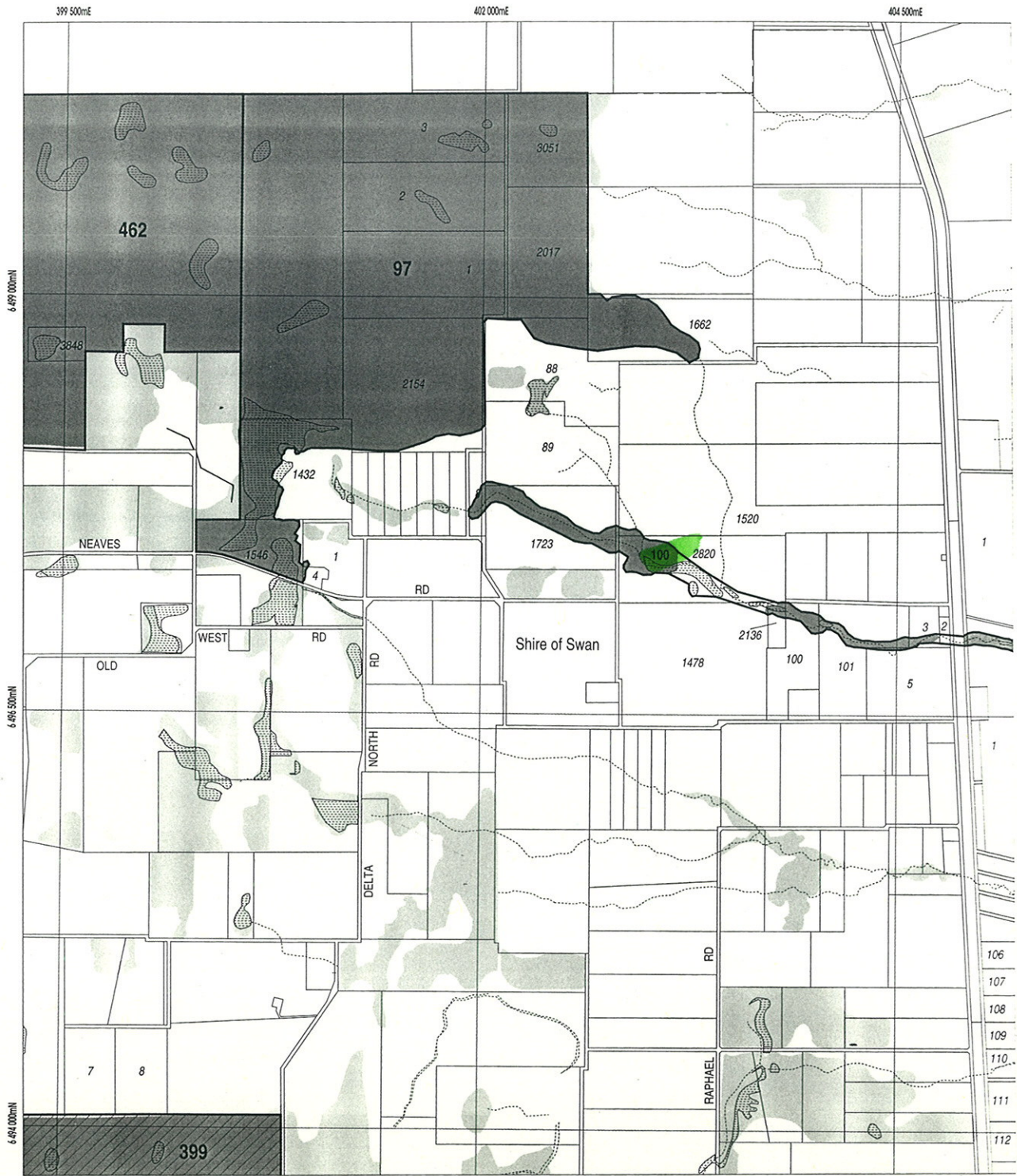

LEGEND

- 472 Bushplan Sites With Regionally Significant Bushland
- Other Native Vegetation
- Conservation Category Wetlands
- Bushplan Sites With Some Existing Protection
- 696 Lot Number, Location Number
- Channel Wetlands
- Local Government Boundary

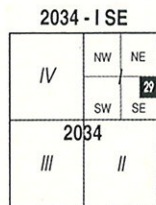

1 : 25 000 AMG Reference Grid showing Perth's Bushplan Map Sheet Breakdown

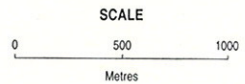
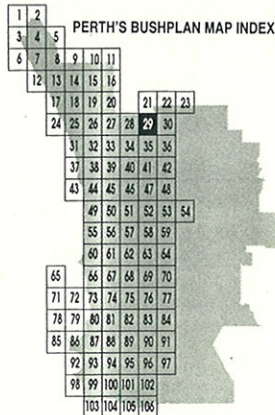

Produced by Project Mapping Section
 Land Information Branch, Ministry for
 Planning, Perth W.A. November 1998
 ntw-map11/envirom/bushplan/bushv2_29.dgn
 Cadastral Data supplied by Department
 of Land Administration, W.A.
 Wetlands Data supplied by
 Water and Rivers Commission
 Native Vegetation Extent for Study Area
 supplied by Agriculture Western Australia

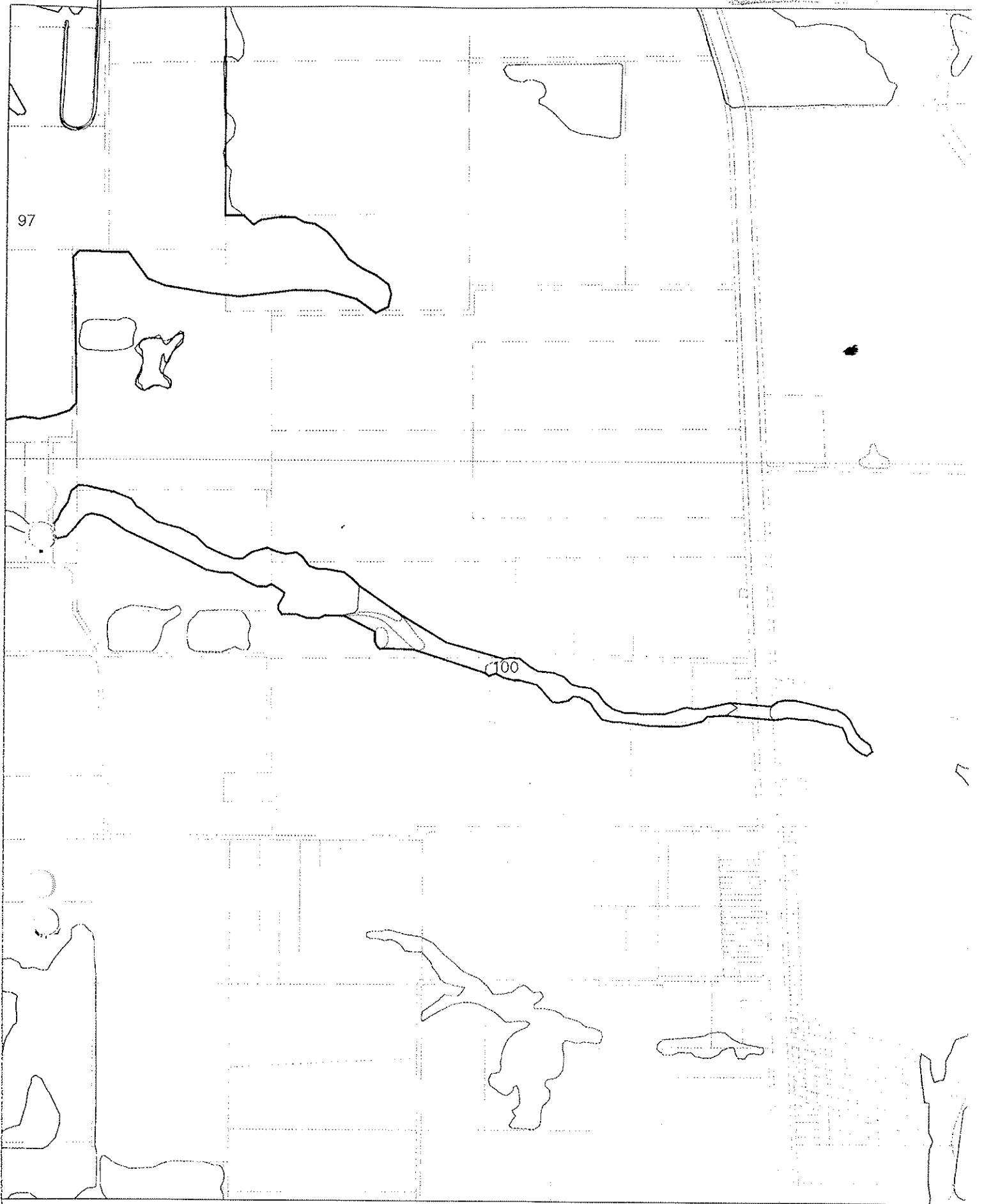

BUSHPLAN SITES CORRECTED



WESTERN
AUSTRALIAN
PLANNING
COMMISSION



CUSTOMER
FOCUS
WESTERN AUSTRALIA

B TG/BK 22/10/98

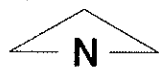

Service
 WETLAND CHANNELS - CONSERVATION
 WETLAND CHANNEL - VERIFICATION



BP Site 100

HELM IMAGE REQUIRED





KINSEY RD BULLSHEAD

MFP INTERNAL USE ONLY
 Prepared By: Clifford Lloyd
 Prepared For:
 Map Ident: plot980522_1
 Date: 22 May 98
 Scale 1:20903

- AG VEG 1998 BOUNDARY THEME
- Bushplan sites refno 1-500 SCP BOUNDARY THEME
- Verified CCWs
- Cadastre

3831
 12/5319 13/5344 14/5164

BP site 100 with wetland channels conservation

-  Cadastre
-  Bushplan sites refno 1-500 SCP BOUNDARY
-  AG VEG 1998 BOUNDARY THEME
-  Verified CCWs
-  Wetland Channels-Conservation Category

Jul

*Subject to verification
I'd say follow vegetation
along Category Wetland
Channel link areas
with dotted purple line*

JA/NZ/OK 23/9 KB
Condition is
- 50-74% vegetated
- on veg condition scale
patchy some in good
condition
- regional link as no
other creek/veg in
vicinity for linkage





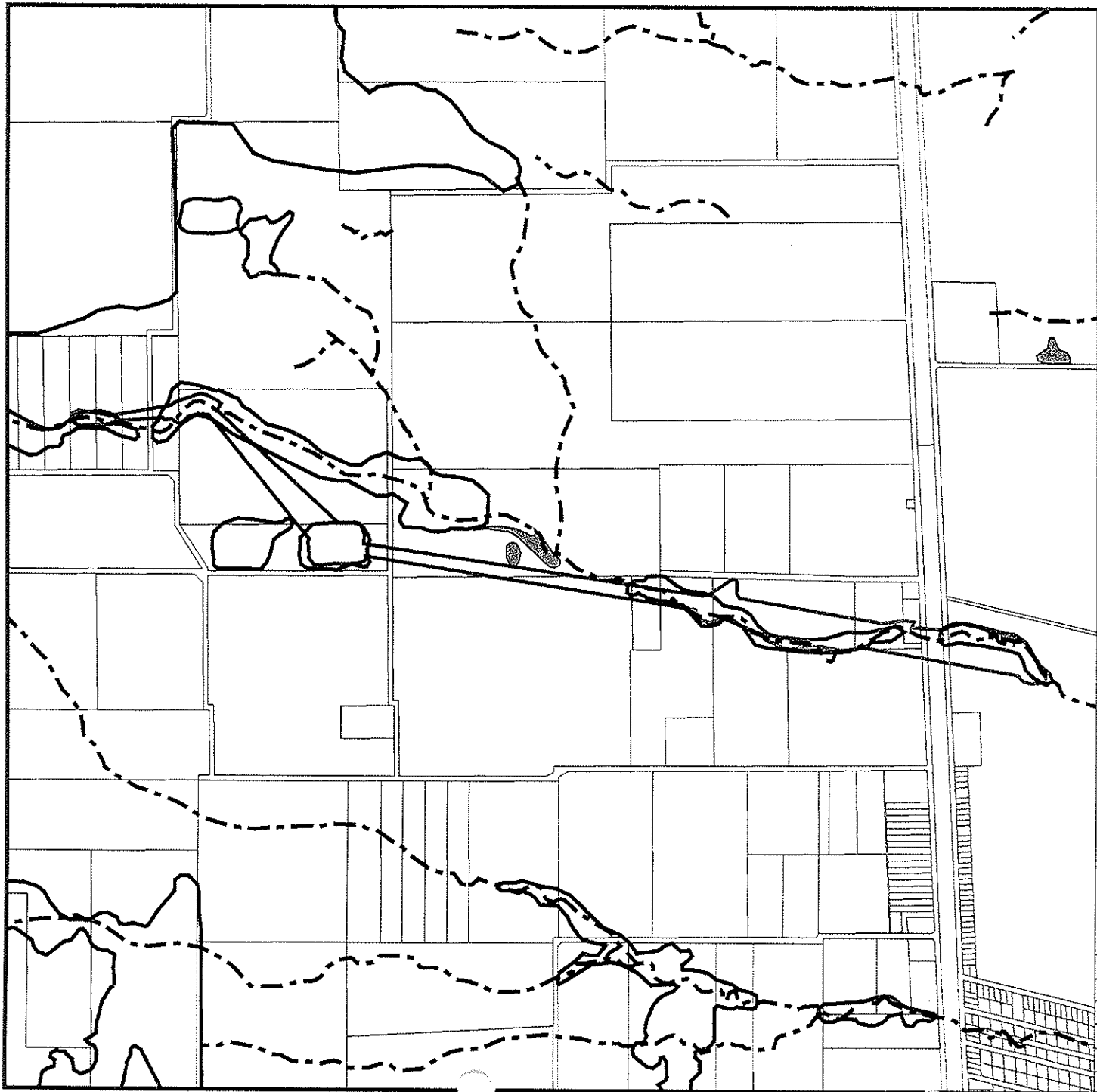



MFP INTERNAL USE ONLY
 Prepared By: Andrea Zappacosta
 Prepared For:
 Map Ident: plot980721_1
 Date: 21 Jul 98
 Scale 1: 21526

include as described by Kiron



BP site 100 with wetland channels vegetated



-  Cadastre
-  Bushplan sites refno 1-500 SCP BOUNDARY
-  AG VEG 1998 BOUNDARY THEME
-  Verified CCWs
-  75 - 100% Vegetated
-  25 - 49% Vegetated
-  0 - 4% Vegetated
-  Not Assessed

MFP INTERNAL USE ONLY
Prepared By: Andrea Zappacosta
Prepared For:
Map Ident: plot980721_1
Date: 21 Jul 98
Scale 1: 21626



6b193
Natalie - Su a

RS 100 Huddle Veen Complex

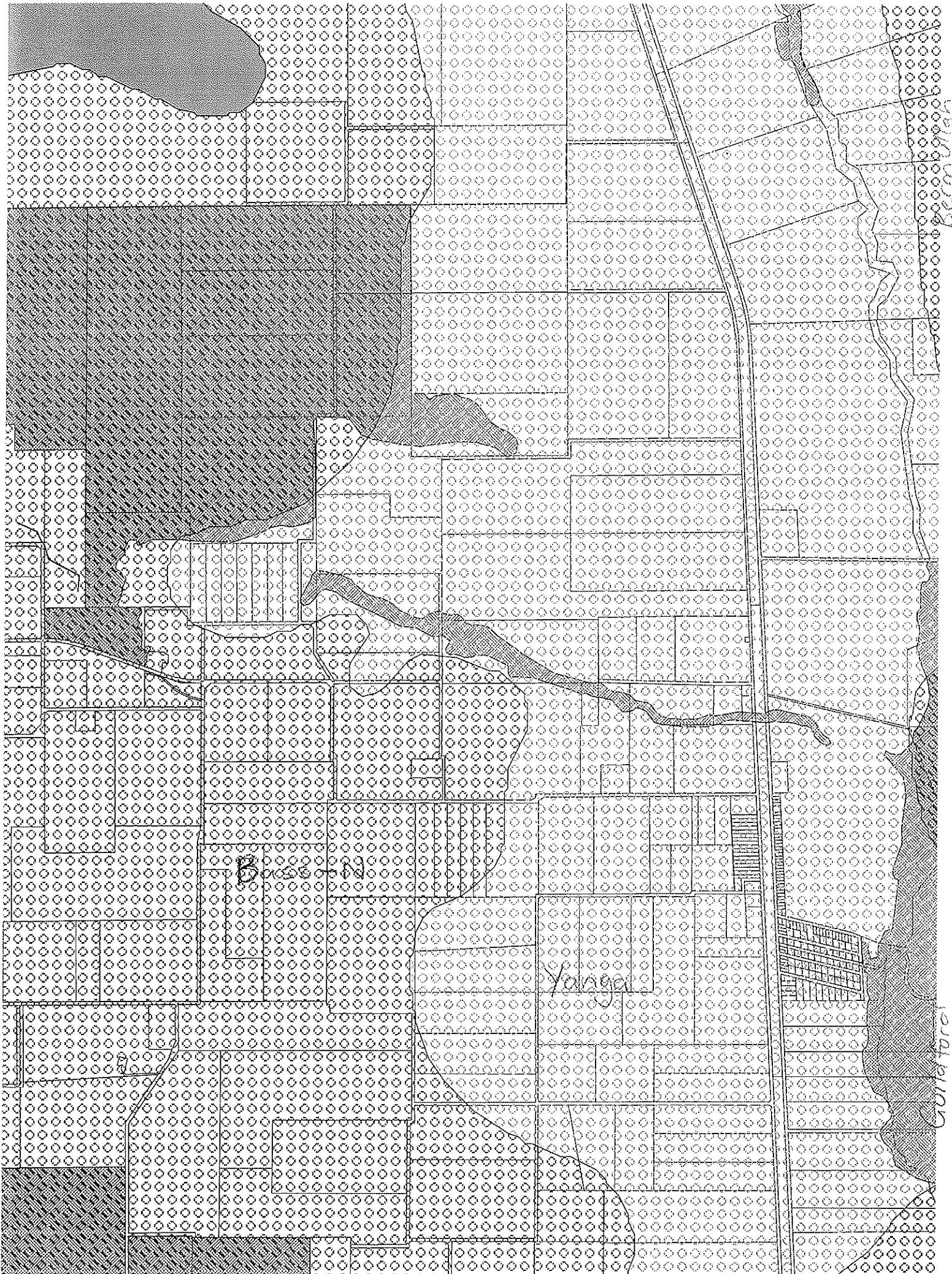

BS100 - Same as old's Channel Wetland Type
9 Veg Coverage



BS 100

Remn Vagn Bushplan (1970)

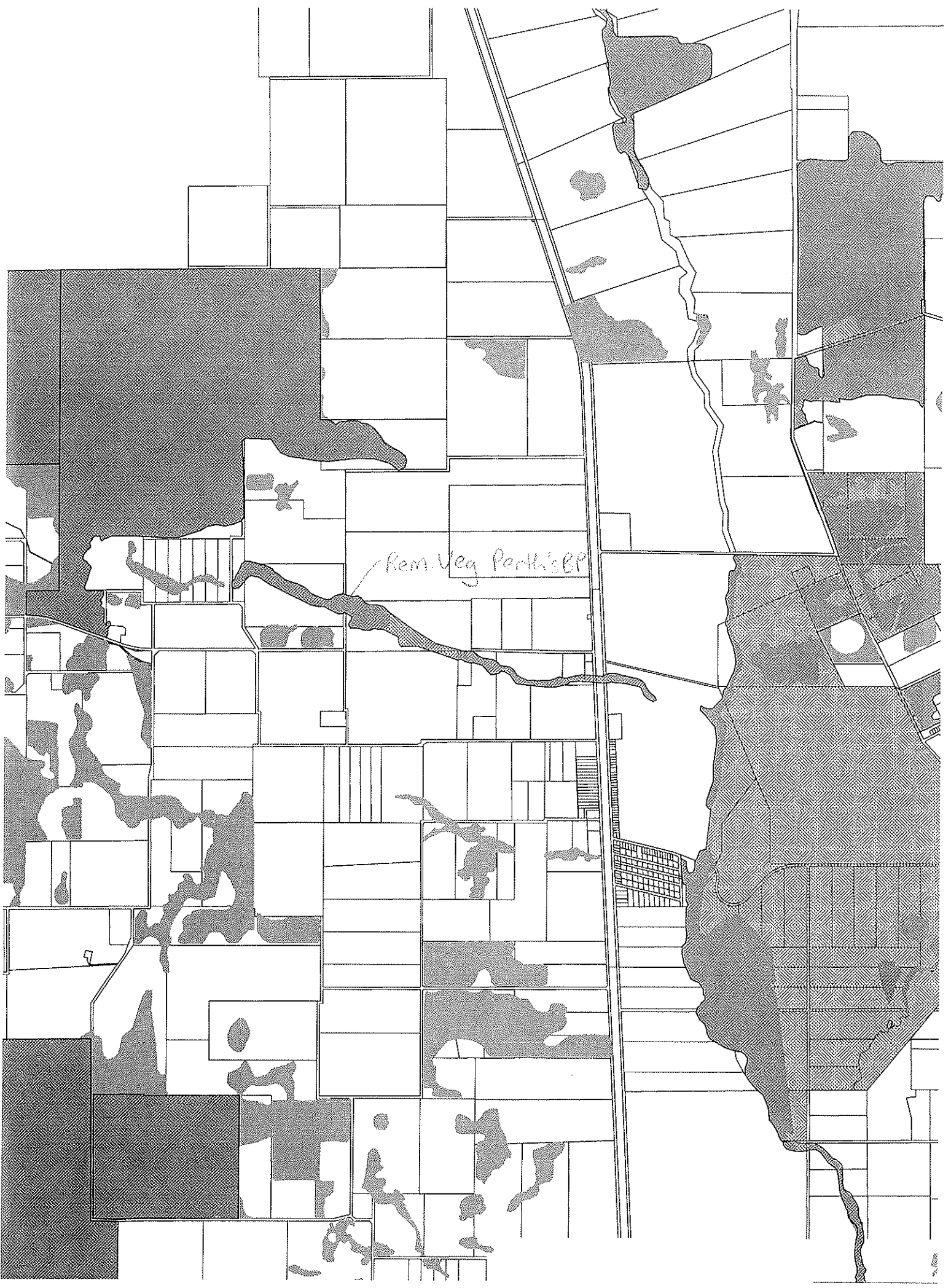

1999 Panorama

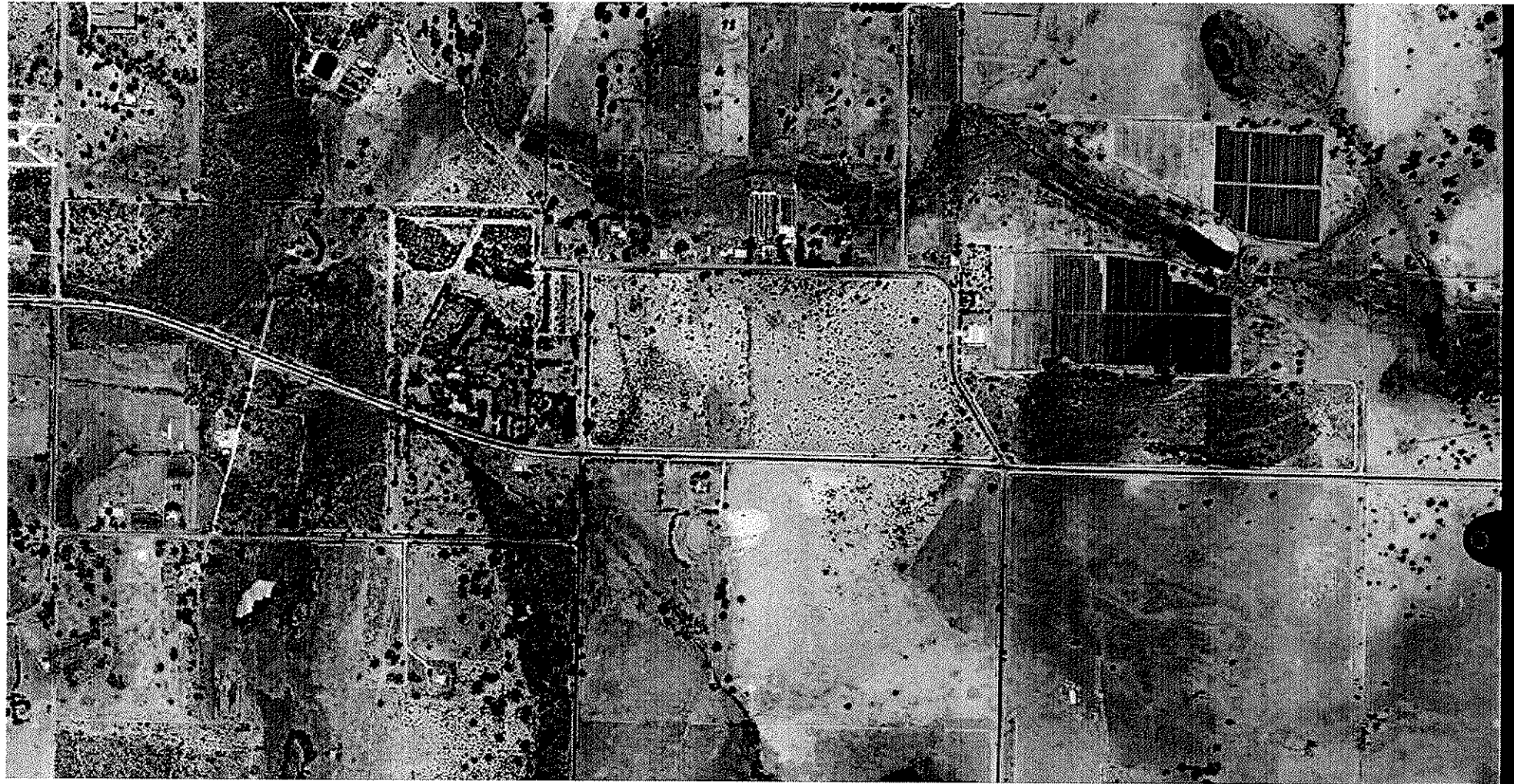

Lot 1723
BS100
1997

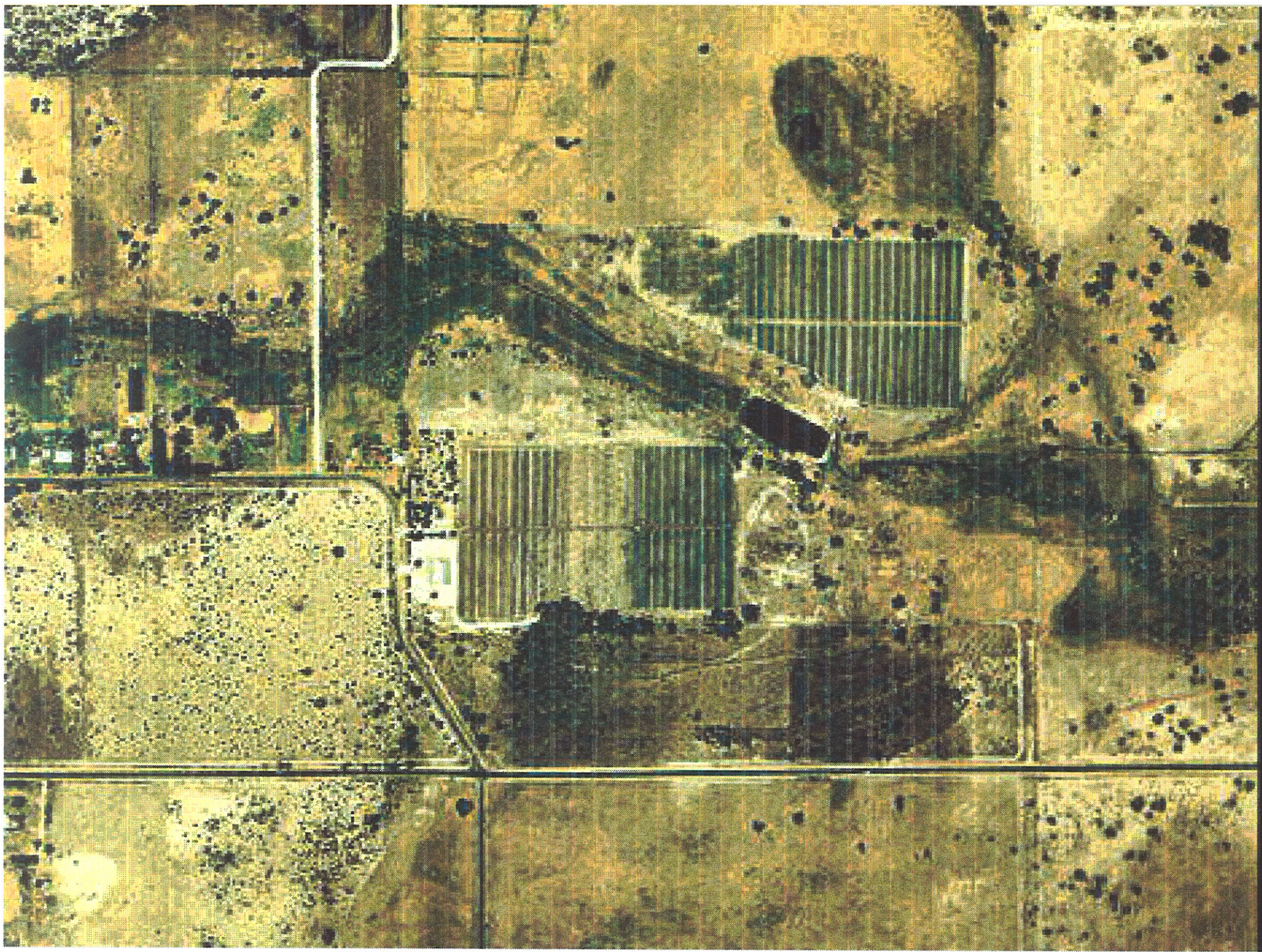

From: Bainbridge, Samantha,

To: Bronwen Keighery (E-mail), Karen Clarke (E-mail), Melissa Patt (E-mail), Collingwood, Sean

CC:

BCC:

Priority: Normal

Date sent: 21/7/00 12:39 PM



Bushplan Site 100 Site visit

I have finalised arrangements with the landowner regarding the proposed site visit to Lot 1723 Bingham Road, Bullsbrook (Bushplan Site 100) next Thursday. He is making arrangements for the local Landcare Coordinator to meet us on site.

Thursday 27th August, 10am on site.

Contact details: Anthony Yewers (Mobile: 0410 543 323)

Directions from Midland:

Follow Great Northern Highway to Bullsbrook townsite and turn left into Rutland Road (after RAAF Pearce). At the end T junction, turn left into Railway Parade and 1st right into Neaves Road. Travel 2 km from corner, turn right into a red gravel driveway (if you reach Bingham Road, you have gone about 1km too far). Meeting Point - Green shed ~500m

Directions from Joondalup:

Follow Wanneroo Road and turn right at Pinjar Road. Turn Right into Neaves Road, and continue 1km after Bingham Road. Turn left into a red gravel driveway. Meeting Point - Green shed ~500m

NB - I live in Bullsbrook townsite, about 5 mins away, so I have tentatively arranged for Sean to pick me up on the way there (pending his schedule). The DEP/WRC may want to car pool?

Thanks, SAM

PS I will plot some aerial maps and forward them next week.

Sam Bainbridge
Bushplan Officer

RFC822 header

RECEIVED: from SF_Database by POP_Mailbox_-1247939205 ; 21 JUL 00 12:41:31 UT
Received: from ENVIRON.WA.GOV.AU by smtpgw.environ.wa.gov.au
with SMTP (QuickMail Pro Server for MacOS 1.1.2); 21-Jul-2000 12:41:28 +0800
Received: from karri.bs.wa.gov.au ([167.30.10.100]) by epagate.environ.wa.gov.au with ESMTP id <119041>; Fri, 21 Jul 2000 12:42:04 +0800
Received: from www.planning.wa.gov.au ([202.2.0.3])
by karri.bs.wa.gov.au (8.9.3+Sun/8.9.3) with SMTP id MAA05007;
Fri, 21 Jul 2000 12:40:11 +0800 (WST)
Received: from 202.2.1.111 by www.planning.wa.gov.au (InterScan E-Mail VirusWall NT); Fri, 21 Jul 2000 12:40:38 +0800
Received: by exchange.planning.wa.gov.au with Internet Mail Service (5.5.2650.21)
id <N2WKF2W7>; Fri, 21 Jul 2000 12:39:45 +0800
Message-ID: <EF8FCB94CA47D211A6DD00A0C9E31ADF011C4F19@exchange.planning.wa.gov.au>
From: "Bainbridge, Samantha" <Samantha.Bainbridge@Planning.wa.gov.au>
To: "Bronwen Keighery (E-mail)" <bronwen_keighery@environ.wa.gov.au>,
"Karen Clarke (E-mail)" <karen_clarke@environ.wa.gov.au>,
"Melissa Patt (E-mail)" <melissa.patt@wrc.wa.gov.au>,
"Collingwood, Sean" <Sean.Collingwood@Planning.wa.gov.au>
Subject: Bushplan Site 100 Site visit

BS100 Neaves Rd Creek, Bullsbrook Site Visit 27/7/00

(DEP 1998) Visited by Natalie & Colma 6/2/98, 2 sites from roadside
(Connell 1995)
(Mattiske Consulting Pty Ltd 1997)

WAPC conditions on subdivision approval -

3. Conservation covenant for BS100.
4. environ. management plan for BS100 areas on each new lot. (see pt 3 of advice to applicant)
5. lot boundaries & fencing firebreaks \neq fragmentation & clearing or degradation of bushland
6. 10% protection of rema. vegn prior to site works

Reveg. along creekline occurring June/July 2000.

Need to avoid disturbing Quenda popⁿ.

Reveg. by Chittering & North Swan Landcare Coordinator
Ian Davis & Damian Crilly (Ellenbrook ICMG coord)

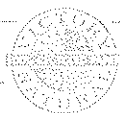

KC, BJK, AYewers, Damian Cilly, Gavin Tray 9297 3045 (Hw)
9571 0300 ✓ 9297 3046 Fax

Anthony ? brother

brother ? father

} subdivision

traygj@inet.net.au

Conditions-Cons cov

What are a problem

EMPlan (eg Kings, Serp J) etc





WRC input? for management plan

- leaf & soil monitoring - "Grower's Rural" fortnightly
 - watering control system going in
 - drip feeding
- results & recomm
- fertilizer application



Bushplan Site 100

1999 Aerial Photography

-  Cadastre with Lot Numbers
-  Wetlands Management - Conservation
-  Wetlands Management - Multiple Use
-  Wetlands Management - Resource Enhanced
-  Bushplan Sites - Proposed Modified Boundaries



Map Ident: plot000726_1
Prepared By: Samantha Bainbridge
Prepared For: Site visit
Date: 26 Jul 2000
Scale 1:5000
0  125 m
MFP INTERNAL USE ONLY

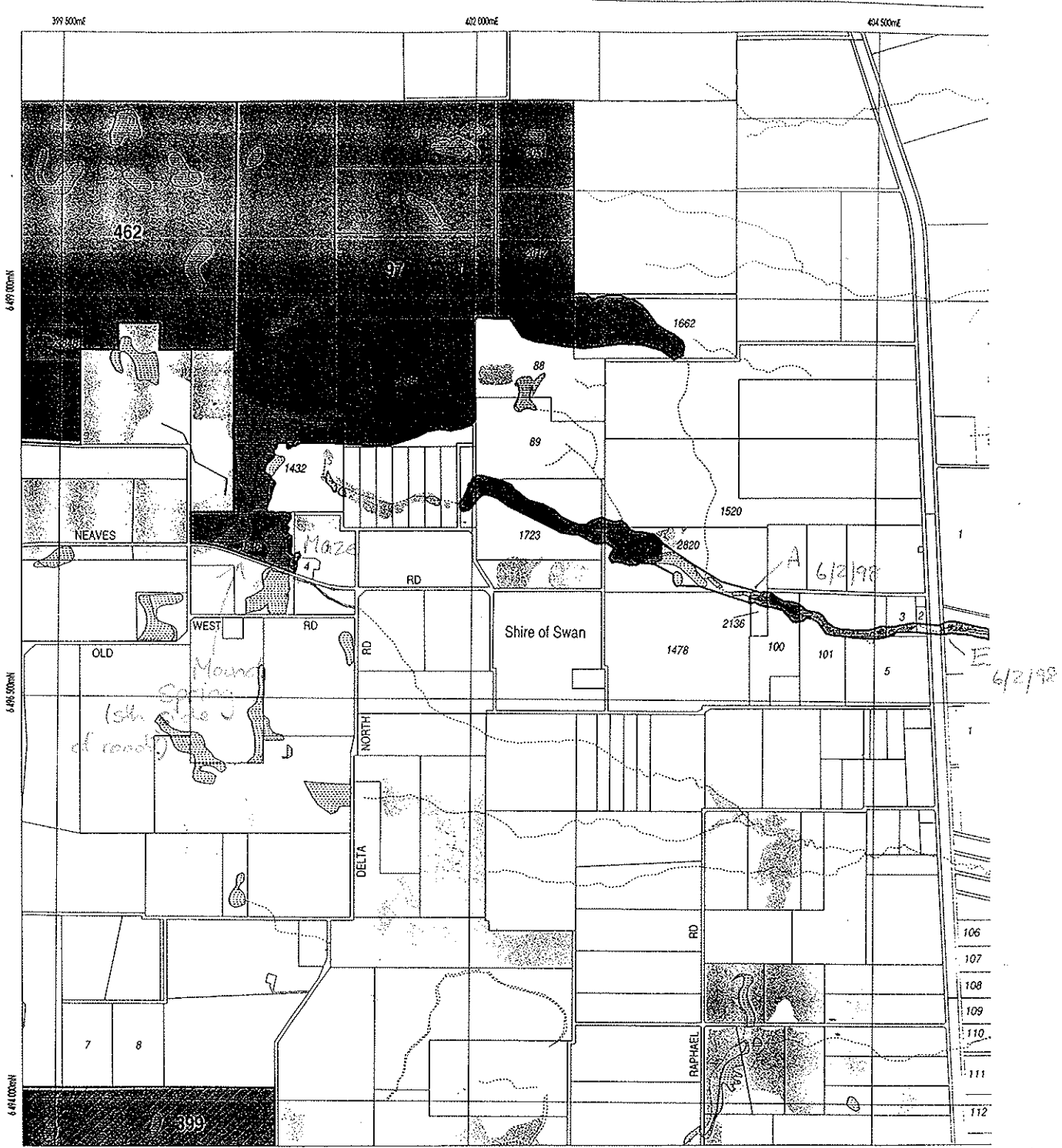

LEGEND

- Bushplan Sites With Regionally Significant Bushland
- Other Native Vegetation
- Conservation Category Wetlands
- Bushplan Sites With Some Existing Protection
- Lot Number, Location Number
- Channel Wetlands
- Local Government Boundary

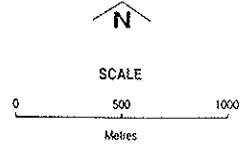
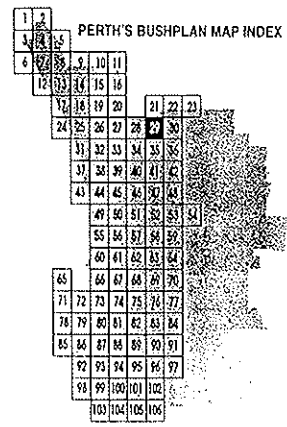
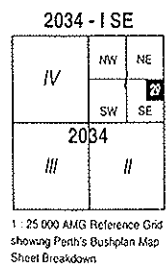

Produced by Project Mapping Section
 Land Information Branch, Ministry for
 Planning, Perth W.A. November 1998
 ntw-map11\environ\bushplan\bushv2_29.dgn
 Cadastral Data supplied by Department
 of Land Administration, W.A.
 Wetlands Data supplied by
 Water and Rivers Commission
 Native Vegetation Extent for Study Area
 supplied by Agriculture Western Australia

④ Discussion with County Council

⑤ Fence-cut creekline

⑥ If no road could
be developed later

⑦ Management agreements/commitments

⑧ Access for horses?

Swan-Canning EPP

- constraints on
property already

-> brief/inform landowners.

MAP 1: LOT 1723 BINGHAM RD, BUSHPLAN SITE 100

- - - Draft Perth's Bushplan Boundary
- · - Wetlands mapped by Hill et al (1996)
- Lot Boundary
- ⊠ Dam
- U U U Upland
- ⊞ Remnant Veg Boundary (based on 1999 aerial photos & site inspection)



Scale 1:5000

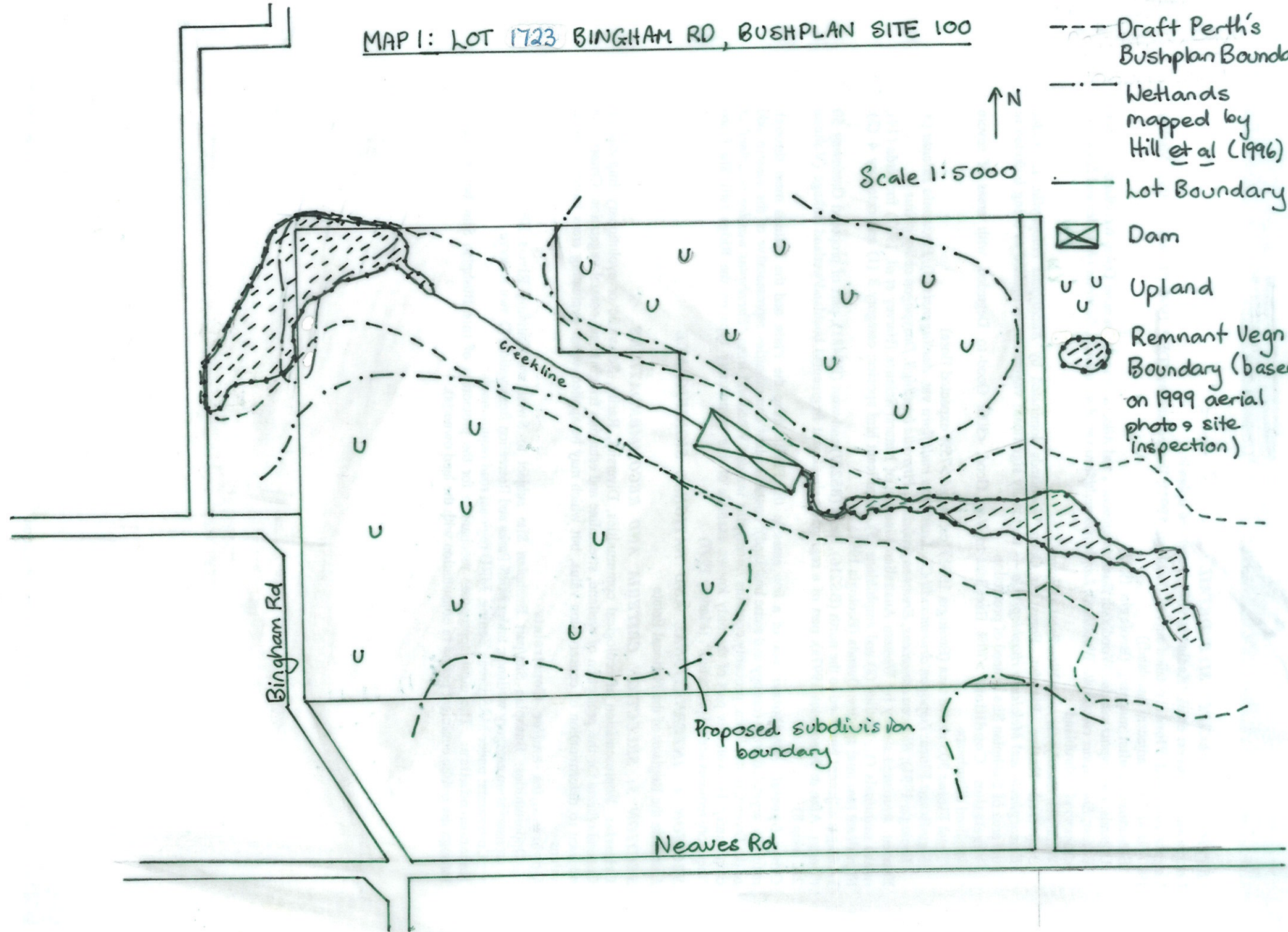

Bingham Rd

Proposed subdivision boundary

Neaves Rd

creekline



LEGEND



SCALE 1:10000



BP SITE 100



AERIAL PHOTOGRAPHY - ORTHO-RECTIFIED
ORIGINAL PHOTOGRAPHY - JANUARY 1997 SCALE 1:20000
POSITIONAL ACCURACY + or - 10 metres



PLANNING
Ministry for Planning



Bushplan Site 100
Lot 1723
1998 Aerial Photography

-  Bushplan Sites (boundaries)
-  Cadastre with Lot Numbers
-  Contours - 1m (MRD)

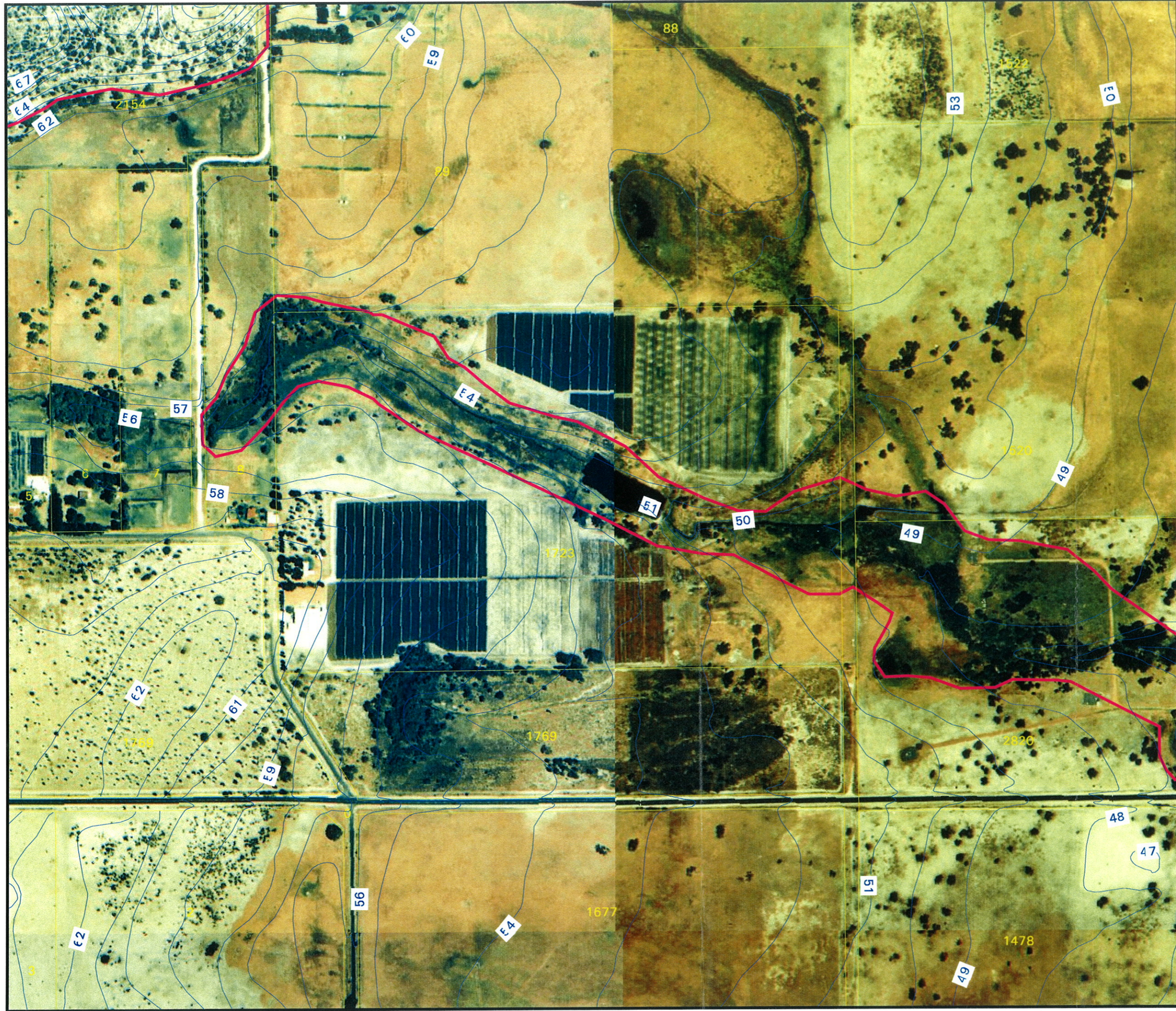







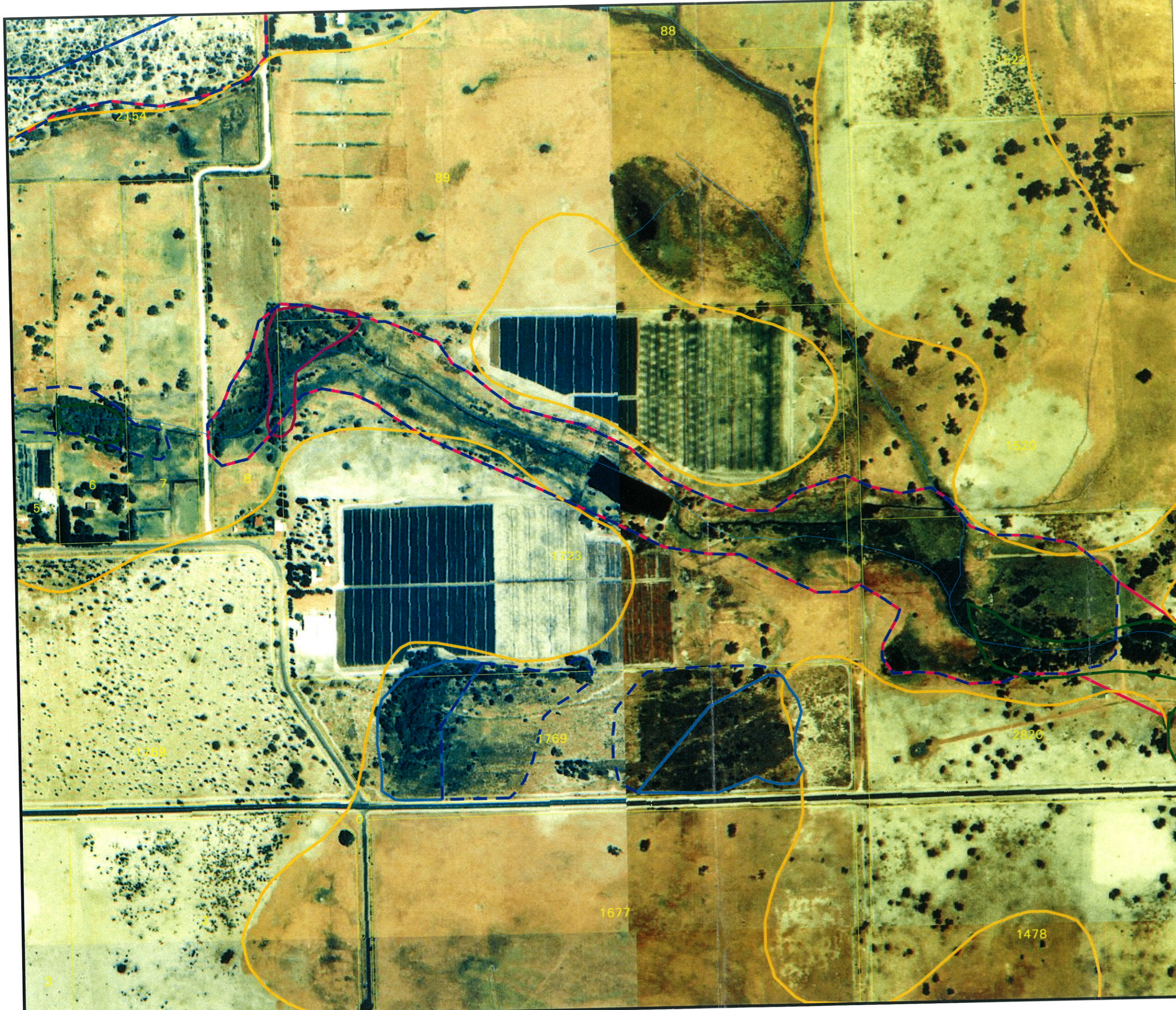

TO DEP- FOR BUSHPLAN
ANALYSIS ONLY!
NOT TO BE REPRODUCED
WITHOUT PERMISSION FROM MFP

Map Ident: plot00808_1
Prepared By: Andrea Zappacosta
Prepared For: SAM BAINBRIDGE
Date: 08 Aug 2000
Scale 1:5000

MFP INTERNAL USE ONLY

Bushplan Site 100
 Lot 1723
 1998 Aerial Photography



-  Bushplan Sites (boundaries)
-  CREEKS
-  Wetlands Management - Conservation
-  Wetlands Management - Multiple Use
-  Wetlands Management - Resource Enhanced
-  Cadastre with Lot Numbers
-  Yanga Complex
-  Bassendean Complex-North

TO DEP - FOR BUSHPLAN
 ANALYSIS ONLY
 NOT TO BE REPRODUCED WITHOUT
 PERMISSION FROM MFP.

Map Ident: plot000808_1
 Prepared By: Andrea Zappacosta
 Prepared For: SAM BAINBRIDGE
 Date: 08 Aug 2000
 Scale 1:5000

0  125 m

MFP INTERNAL USE ONLY

Bushplan Site 100

1999 Aerial Photography

-  Cadastre with Lot Numbers
-  Wetlands Management - Conservation
-  Wetlands Management - Multiple Use
-  Wetlands Management - Resource Enhanced
-  Bushplan Sites - Proposed Modified Boundaries

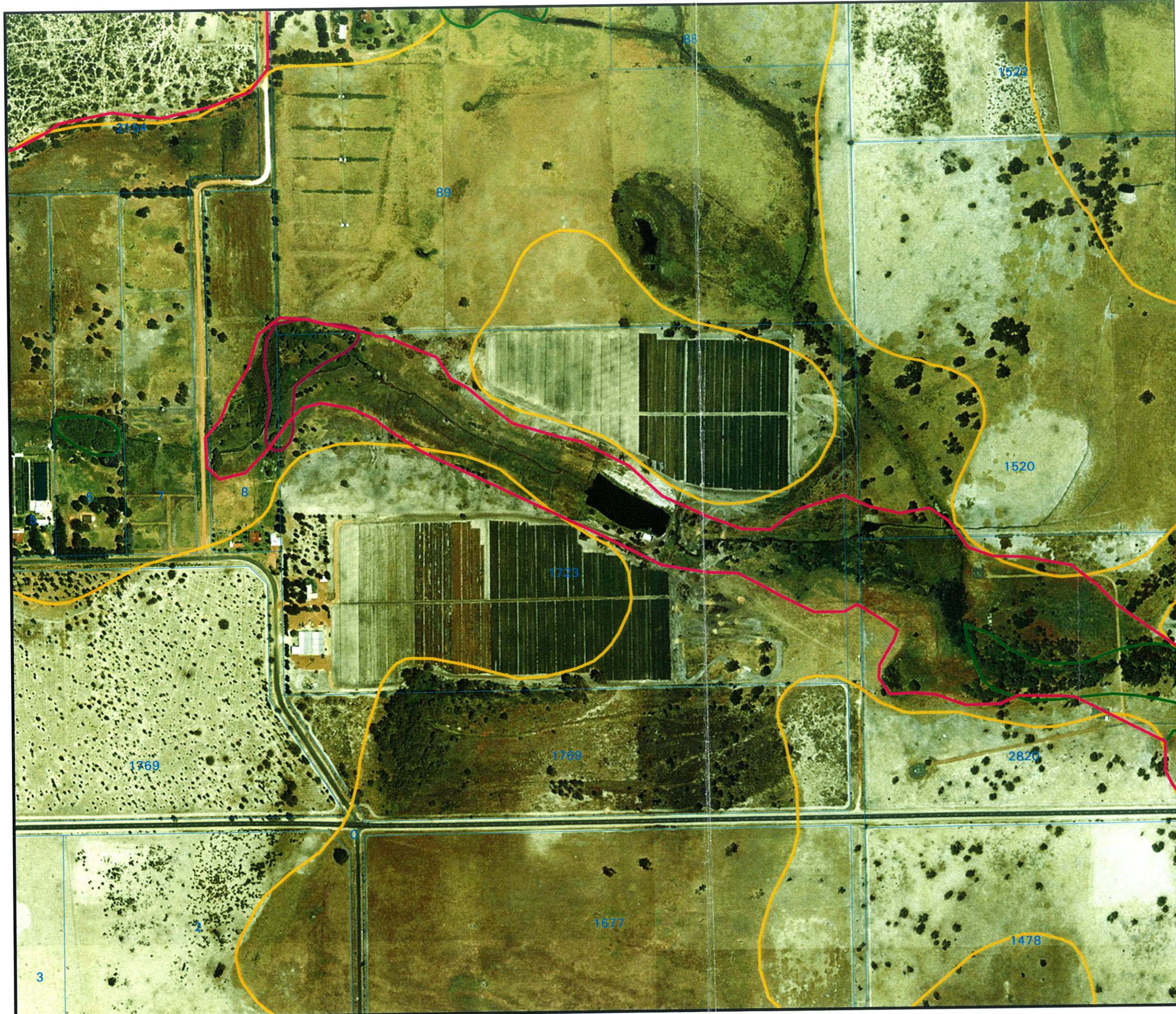

Map Ident: plot000726_1

Prepared By: Samantha Bainbridge

Prepared For: Site visit

Date: 26 Jul 2000

Scale 1:5000

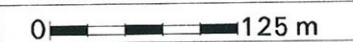
0  125 m

MFP INTERNAL USE ONLY

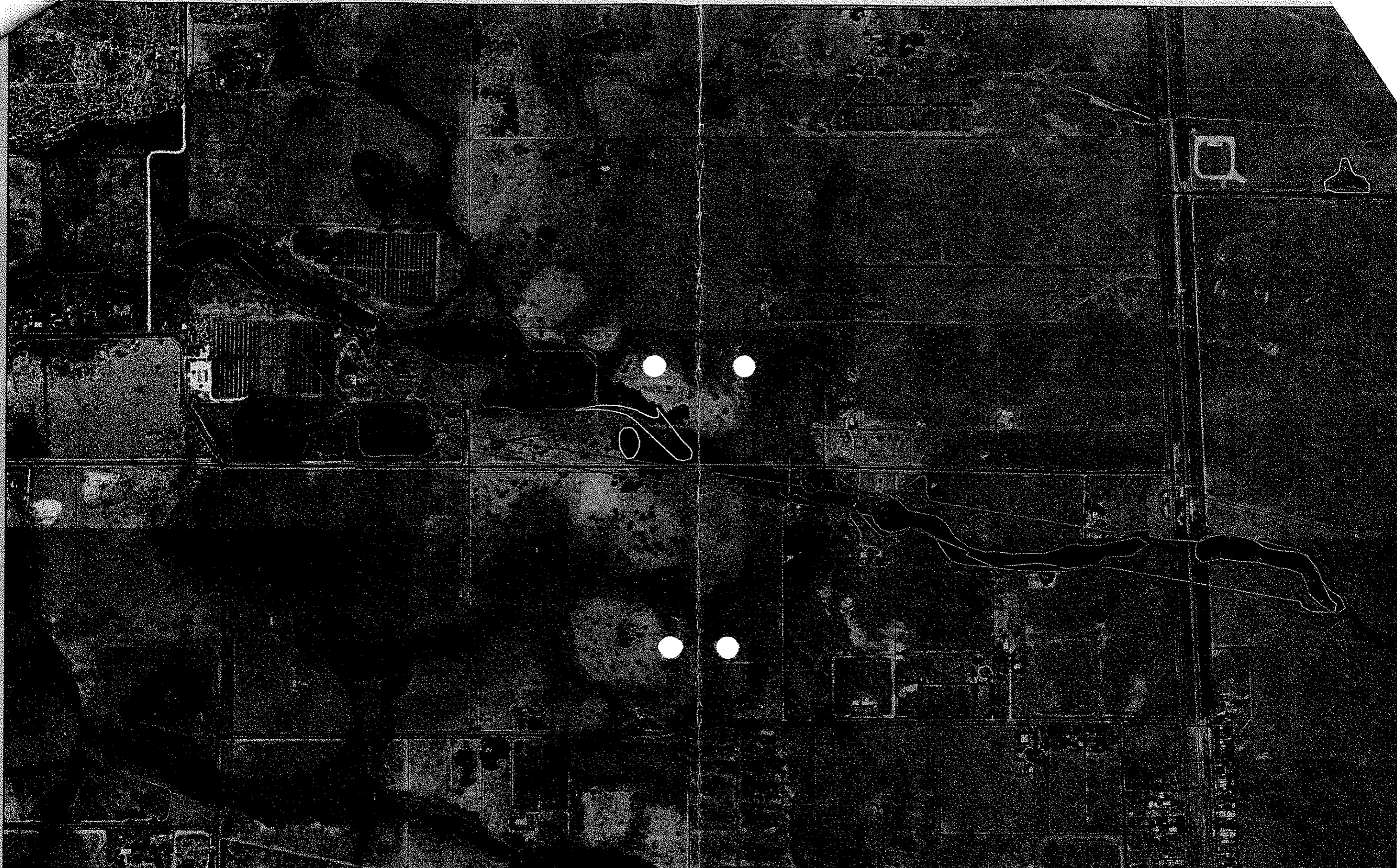

LEGEND



PLANNING
Ministry for Planning



PRODUCED BY THE LAND INFORMATION BRANCH, STATUTORY MAPPING SECTION



SCALE 1:10000



BP SITE 100

AERIAL PHOTOGRAPHY - ORTHO-RECTIFIED
ORIGINAL PHOTOGRAPHY - JANUARY 1997 SCALE 1:20000
POSITIONAL ACCURACY + or - 10 metres

VOL 2 UPDATED

DEP SYSTEM 6 UPDATE SUBMISSION SURVEY SHEET

B.J. KEIGHERY 2/96

BUSHLAND AREA BS100 NEAR ROCK SITES YES/NO

DATE 6/2/98 RECORDERS Natalie + CDWA

Observations edge transects

Geographic Location	Latitude	S Longitude	E
Reference Map			

Photograph	Photographer's Name <u>Natalie</u>	Photo No <u>(A) = 5</u>
------------	------------------------------------	-------------------------

Transect of landscape units (draw in transect incorporating features listed and any other relevant unit)

dunes
dry/wet flats
sumplands
uplands
type

Soil - surface	<u>DARK GREY - MOIST TO SWAMP</u>	sub -soil
Exposed rock	type <u>0</u>	% area

FLORA/VEGETATION (list dominant and significant plants below, see over for vege association descriptions)

Eucalypts	<i>E. calophylla</i>	<i>E. wandoo</i>	<i>E. marginata</i>	<i>E. todtianna</i>	<u><i>E. rudis</i></u>
	<i>E. decipiens</i>	<i>E. drummondii</i>	<i>E. haematoxylon</i>	<i>E. lanepolei</i>	<i>E. gomphocephala</i>
	<i>E. accedens</i>	<i>E. patens</i>	<i>E. laeliae</i>	<i>E. megacarpa</i>	
Sheoaks	<i>Allocasuarina fraserana</i>		<i>Casuarina obesa</i>		
Banksia	<i>B. attenuata</i>	<i>B. menziesii</i>	<i>B. prionotes</i>	<i>B. illicifolia</i>	<i>B. grandis</i> <i>B. littoralis</i>
Melaleuca	<u><i>M. preissii</i></u>	<u><i>M. raphiophylla</i></u>	<i>M. lanceolata</i>	<i>M. cuticularis</i>	
Others	<i>Callitris preissii.</i>				
Mallees	Eucalypts	<i>E. argutifolia</i>	<i>E. petrensis</i>	<i>E. decurva</i>	<i>E. foecunda</i> <i>E. latens</i>
SIGNIFICANT SPECIES					
<i>Lepidosperma</i> ? <i>gladiata</i>					
" ? <i>longitudinale</i>					
(see over for vegeaion descriptions)					

Vegetation Condition - Keighery 1994 (Trudgen 1993) (show range and indicate predominant class)

- 1 = 'Pristine' (Excellent)
- 2 = Excellent (Very Good)
- 3 = Very Good (Good)
- 4 = Good (Poor)
- 5 = Degraded (Very Poor) // very small, long thin area is highly disturbed by (NATIVE) - invaded by Eke.
- 6 = Completely Degraded

Specific aspects of disturbance

partial clearing	<u>FARM LAND - MAJOR ROADS</u>				
weeds (list):	<u>KIKUYU</u> <u>WILD OATS</u>				
selective removal of species:	timber cutting	mowing	fire	grazing	dieback %area
fire frequency:					
'enrichment plantings' (list)					
animal impact:	horse foxes	rabbits	cats	dogs	goats pigs overgrazing by native mammals
soil movement:	mining	dumping	rubbish	dumping	roadworks
changes in water regimes:	flooding		drainage	watering	nutrient influx
Tracks:	fire breaks	walk trails	off road vehicle use	animal tracks	
Service corridors:	SEC	Main Roads	Water Authority.	Telecom	
Other					

LIFE FORM/HEIGHT CLASS	CANOPY COVER			
	DENSE 70-100%	MID-DENSE 30-70%	SPARSE 10-30%	VERY SPARSE 2-10%
Trees >30m Trees 15-30m Trees 5-15m Trees <3m	Dense Tall Forest Dense Forest Dense Low Forest A Dense Low Forest B	Tall Forest Forest Low Forest A Low Forest B	Tall Woodland Woodland Low Woodland A Low Woodland B	Open Tall Woodland Open Woodland Open Low Woodland A Open Low Woodland B
Mallee tree form Mallee shrub form	Dense Tree Mallee Dense Shrub Mallee	Tree Mallee Shrub Mallee	Open Tree Mallee Open Shrub Mallee	Very Open Tree Mallee Very Open Shrub Mallee
Shrubs >2m Shrubs 1.5-2.0m Shrubs 1.0-1.5m Shrubs 0.5-1.0m Shrubs 0.0-0.5m	Dense Thicket Dense Heath A Dense Heath B Dense Low Heath C Dense Low Heath D	Thicket Heath A Heath B Low Heath C Low Heath D	Scrub Low Scrub A Low Scrub B Dwarf Scrub C Dwarf Scrub D	Open Scrub Open Low Scrub A Open Low Scrub B Open Dwarf Scrub C Open Dwarf Scrub D
Mat plants Hummock Grass Bunch grass >0.5m Bunch grass <0.5m Herbaceous spp.	Dense Mat Plants Dense Hummock Grass Dense Tall Grass Dense Low Grass Dense Herbs	Mat Plants Mid-Dense Hummock Grass Tall Grass Low Grass Herbs	Open Mat Plants Hummock Grass Open Tall Grass Open Low Grass Open Herbs	Very Open Mat Plants Open Hummock Grass Very Open Tall Grass Very Open Low Grass Very Open Herbs
Sedges >0.5m Sedges <0.5m	Dense Tall Sedges Dense Low Sedges	Tall Sedges Low Sedges	Open Tall Sedges Open Low Sedges	Very Open Tall Sedges Very Open Low Sedges
Ferns Mosses, liverwort	Dense Ferns Dense Mosses	Ferns Mosses	Open Ferns Open Mosses	Very Open Ferns Very Open Mosses

VEGETATION (describe each unit of vegetation using dominants and life form/height class and canopy cover according to the Muir codes above)

(A) Melaleuca naphiophylla (6-10m) 60%
 Eucalyptus nidis 25%
 Lepidoperma ?? gladiata 75%
 Kikuyu 15cm 75%

- Fat lepid ?? LEPIDOPERMA LONGICORNIS

- Junco pallidus 50%

Occasional Melibomia patellaris 710m

(B) Melaleuca naphiophylla (6-10m) 40%
 Eucalyptus nidis (7-12m) 20%
 *kikuyu
 channel only
 - v. degraded

Fauna comments

Adjacent bushland (refer to aerial photograph)

BS 100 Neaves Rd Creek

6-2-98



Area A



RESTRICTED