

SULTANA ROAD WEST BUSHLAND, HIGH WYCOMBE

Boundary Definition: bushland (part taken to cadastre) boundary

SECTION 1: LOCATION INFORMATION

Bush Forever Site no. 123

Area (ha): bushland 15.1 (part area cleared after bushland mapping)

Map no. 49

Map sheet series ref. no. 2034-II SE, 2134-III SW

Other Names: Location 75 (Keighery, BJ, and Trudgen 1992)

Local Authorities (Suburb): Shire of Kalamunda (High Wycombe, Forrestfield)

SECTION 2: REGIONAL INFORMATION

LANDFORMS AND SOILS

Bassendean Dunes/Pinjarra Plain

Bassendean Sands over Guildford Formation (Qpb/Qpa: S10)

VEGETATION AND FLORA

Vegetation Complexes

Foothills

Forrestfield Complex (Ridge Hill Shelf, Darling Plateau)

Combinations of Bassendean Dunes/Pinjarra Plain

Southern River Complex

Floristic Community Types

Supergroup 3: Uplands centred on Bassendean Dunes and Dandaragan Plateau

20a *Banksia attenuata* woodlands over species-rich dense shrublands

WETLANDS

Wetland Types: palusplain, sumpland

Natural Wetland Groups

Bassendean—Pinjarra transition OR Bassendean with fluvial features

Mungala (B/P.2)

Wetland Management Objectives: Resource Enhancement

Swan Coastal Plain Lakes EPP: none identified

THREATENED ECOLOGICAL COMMUNITIES

Endangered (floristic community type 20a)

SECTION 3: SPECIFIC SITE DETAIL

Landscape Features: vegetated uplands, vegetated wetlands

Vegetation and Flora: limited survey (part Site — DEP 1996 (Sultana plot located outside Site), DEP 1999, Keighery, BJ, and Trudgen 1992)

Structural Units: mapping (Keighery, BJ, and Trudgen 1992)

Upland: *Banksia attenuata* and *B. menziesii* Open Low Forest to Woodland over species-rich Mixed Closed Heath to Open Low Heath

Wetland: *Melaleuca preissiana* Low Open Woodland

Vegetation Condition: >80% Excellent to Pristine, <20% Very Good to Degraded, with areas of severe localised disturbance

Total Flora: 73 native taxa (plot-generated list only) (estimated 50% expected flora)

Significant Flora: *Conospermum undulatum* (R); *Haemodorum loratum* (3), *Isopogon drummondii* (3), *Lambertia multiflora* var. *darlingensis* (3); *Dasypogon obliquifolius*, *Eremaea fimbriata*, *Xanthorrhoea drummondii*, *Banksia incana*, *Hakea conchifolia*, *Pityrodia bartlingii*

Fauna: Significant mammal species: Quenda (Friend 1996 D)

Linkage: adjacent canopy/bushland to the south and unmapped bushland to south-east to bushland along the Roe Highway; part of Greenway 50 (Tingay, Alan & Associates 1998a)

Other Special Attributes: recommended to be managed for flora conservation, with a view to purchase by CALM (Keighery, BJ, and Trudgen 1992); Threatened or Poorly Reserved Plant Community (EPA 1994 GIS); contains plant communities representative of the eastern side of the Swan Coastal Plain

SECTION 4: INTERNATIONAL AND NATIONAL SIGNIFICANCE

Subject to protection under the Commonwealth *Environment Protection and Biodiversity Conservation Act 1999*

SECTION 5: SELECTION CRITERIA AND RECOMMENDATIONS

Criteria: Representation of ecological communities, Diversity, Rarity, General criteria for the protection of wetland, streamline and estuarine fringing vegetation and coastal vegetation

Recommendation: Proposed Parks and Recreation Reservation (see Table 3, Volume I).

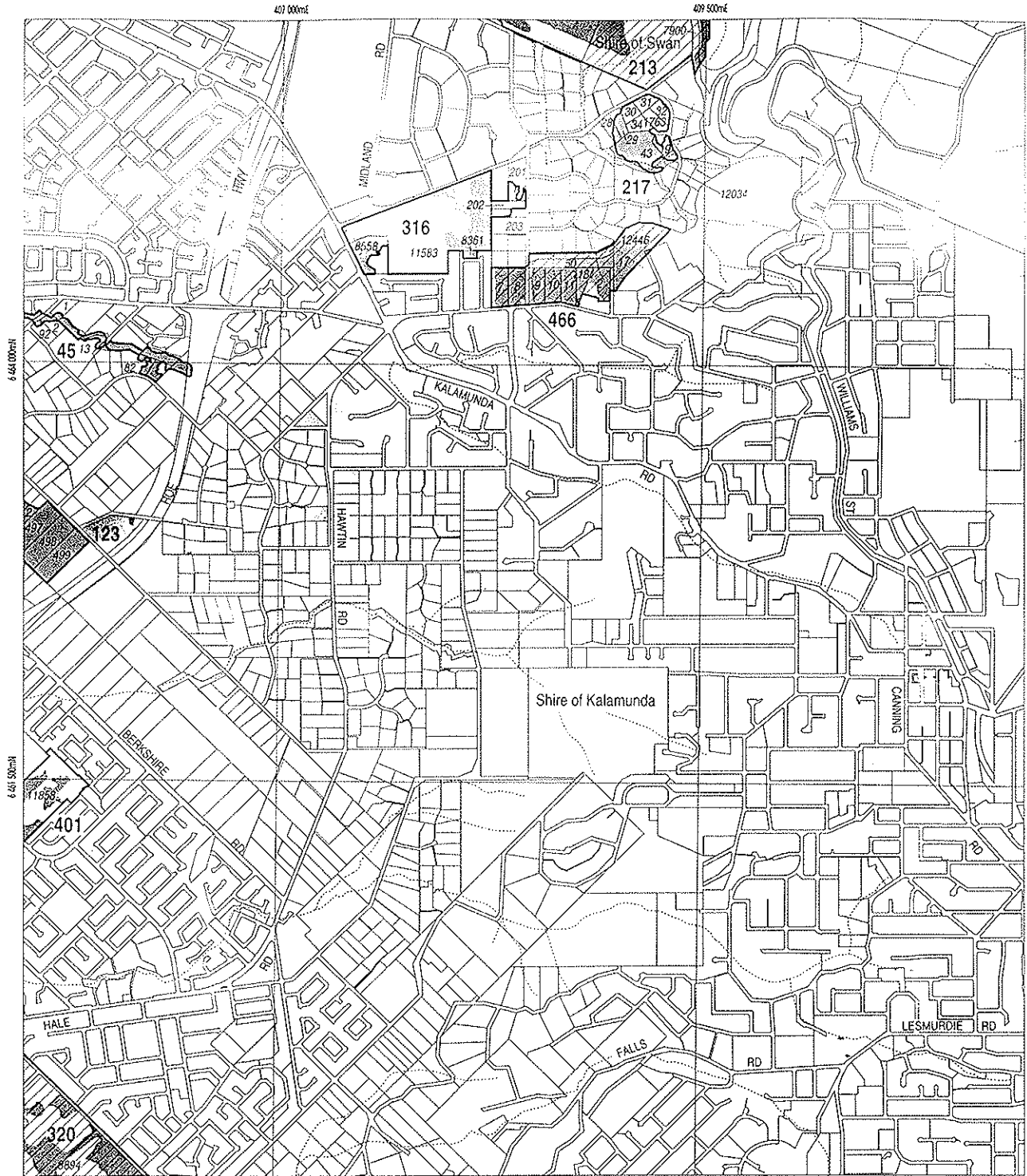

LEGEND

- Bushplan Sites With Regionally Significant Bushland
- Other Native Vegetation
- Conservation Category Wetlands
- Bushplan Sites With Some Existing Protection
- 696 Lot Number, Location Number
- Channel Wetlands
- Local Government Boundary

2134 - III SW

IV		I	
2134			
NW	NE	SW	SE
III		II	
59			

1: 25 000 AMG Reference Grid showing Perth's Bushplan Map Sheet Breakdown

PERTH'S BUSHPLAN MAP INDEX

1	2									
3	4	5								
6	7	8	9	10	11					
12	13	14	15	16						
17	18	19	20	21	22	23				
24	25	26	27	28	29	30				
31	32	33	34	35	36					
37	38	39	40	41	42					
43	44	45	46	47	48					
49	50	51	52	53	54					
55	56	57	58	59						
60	61	62	63	64						
65	66	67	68	69	70					
71	72	73	74	75	76	77				
78	79	80	81	82	83	84				
85	86	87	88	89	90	91				
92	93	94	95	96	97					
98	99	100	101	102						
103	104	105	106							

SCALE

0 500 1000 Metres

Produced by Project Mapping Section
Land Information Branch, Ministry for
Planning, Perth W.A. November 1998

nwt-map11/environ/bushplan/bushv2_59.dgn

Cadastral Data supplied by Department
of Land Administration, W.A.

Wetlands Data supplied by
Water and Rivers Commission

Native Vegetation Extent for Study Area
supplied by Agriculture Western Australia

SULTANA ROAD WEST BUSHLAND, HIGH WYCOMBE

Boundary Definition: bushland (part taken to cadastre) boundary

SECTION 1: CADASTRAL INFORMATION

(Lots, locations and derived information to be updated in the public submission period)

Bushplan Site no. 123 **Map no.** 58, 59 **Map sheet series ref. no.** 2034-II SE, 2134-III SW

Other Names

Location 75 (Keighery, BJ, and Trudgen 1992)

Local Authorities (Suburb)

Shire of Kalamunda (High Wycombe, Forrestfield)

Area (ha): total 15.2; bushland 15.1 (part area cleared after bushland mapping)

Zoning

MRS: Rural

TPS: Rural, Special Rural

Ownership Categories

Private (including commercial organisation)

Lot/Location/Reserve numbers (Purpose),

Street name

1, 2, 479, 498, 499 Sultana Rd

SECTION 2: REGIONAL INFORMATION

LANDFORMS AND SOILS

Bassendean Dunes/Pinjarra Plain

Bassendean Sands over Guildford Formation (Qpb/Qpa:S10)

VEGETATION AND FLORA

Vegetation Complexes

Foothills

Forrestfield Complex (Ridge Hill Shelf, Darling Plateau)

Combinations of Bassendean Dunes/Pinjarra Plain

Southern River Complex

Floristic Community Types

Supergroup 3: Uplands centred on Bassendean Dunes and Dandaragan Plateau

20a *Banksia attenuata* woodlands over species-rich dense shrublands

WETLANDS

Wetland Types: palusplain, sumpland

Natural Wetland Groups

Bassendean—Pinjarra transition OR Bassendean with fluvial features

Mungala (B/P.2)

Wetland Management Objectives: Resource Enhancement

Swan Coastal Plain Lakes EPP: none identified

THREATENED ECOLOGICAL COMMUNITIES

Endangered (floristic community type 20a)

SECTION 3: SPECIFIC SITE DETAIL

Landscape Features: vegetated uplands, vegetated wetlands

Vegetation and Flora: limited survey – part Bushplan Site (DEP 1996 (Sultana plot located outside BS), Keighery, BJ, and Trudgen 1992)

Structural Units: mapping (Keighery, BJ, and Trudgen 1992)

Upland: *Banksia attenuata* and *B. menziesii* Open Low Forest to Woodland over species-rich Mixed Closed Heath to Open Low Heath

Wetland: *Melaleuca preissiana* Low Open Woodland

Vegetation Condition: >80% Excellent to Pristine, <20% Very Good to Degraded, with areas of severe localised disturbance

Total Flora: 73 native taxa (plot-generated list only) (estimated 50% expected flora)

Significant Flora: *Conospermum undulatum* (R); *Haemodorum loratum* (3), *Isopogon drummondii* (3), *Lambertia multiflora* var. *darlingensis* (3); *Dasyogon obliquifolius*, *Eremaea fimbriata*, *Xanthorrhoea drummondii*, *Banksia incana*, *Hakea conchifolia*, *Pityrodia bartlingii*

Fauna: no systematic survey. Significant mammal species: Quenda (Friend 1996 D)

Linkage: adjacent canopy/bushland to the south and unmapped bushland to south-east to bushland along the Roe Highway; part of proposed Greenway 57 (Tingay, Alan & Associates 1997a)

Other Special Attributes: recommended to be managed for flora conservation, with a view to purchase by CALM (Keighery, BJ, and Trudgen 1992); Threatened or Poorly Reserved Plant Community (EPA 1994 GIS); contains plant communities representative of the eastern side of the Swan Coastal Plain

SECTION 4: INTERNATIONAL AND NATIONAL SIGNIFICANCE

Not listed



SECTION 5: SELECTION CRITERIA AND RECOMMENDATIONS

Criteria: Representation of ecological communities, Diversity, Rarity, General criteria for the protection of wetland, streamline and estuarine fringing and coastal vegetation

Opportunities and/or Constraints

Opportunities: Bushplan Site/part Bushplan Site subject to Swan and Canning Rivers EPP; location of Declared Rare Flora

Constraints: private land

Recommendation: The most appropriate mechanism for the protection of this Bushplan Site be considered through the public comment period in consultation with the land owner(s). For Lot numbers 497, 498 and 499 this may include: The Bushplan Site be reserved for Parks and Recreation in the Metropolitan Region Scheme and be purchased for Nature Reserve.



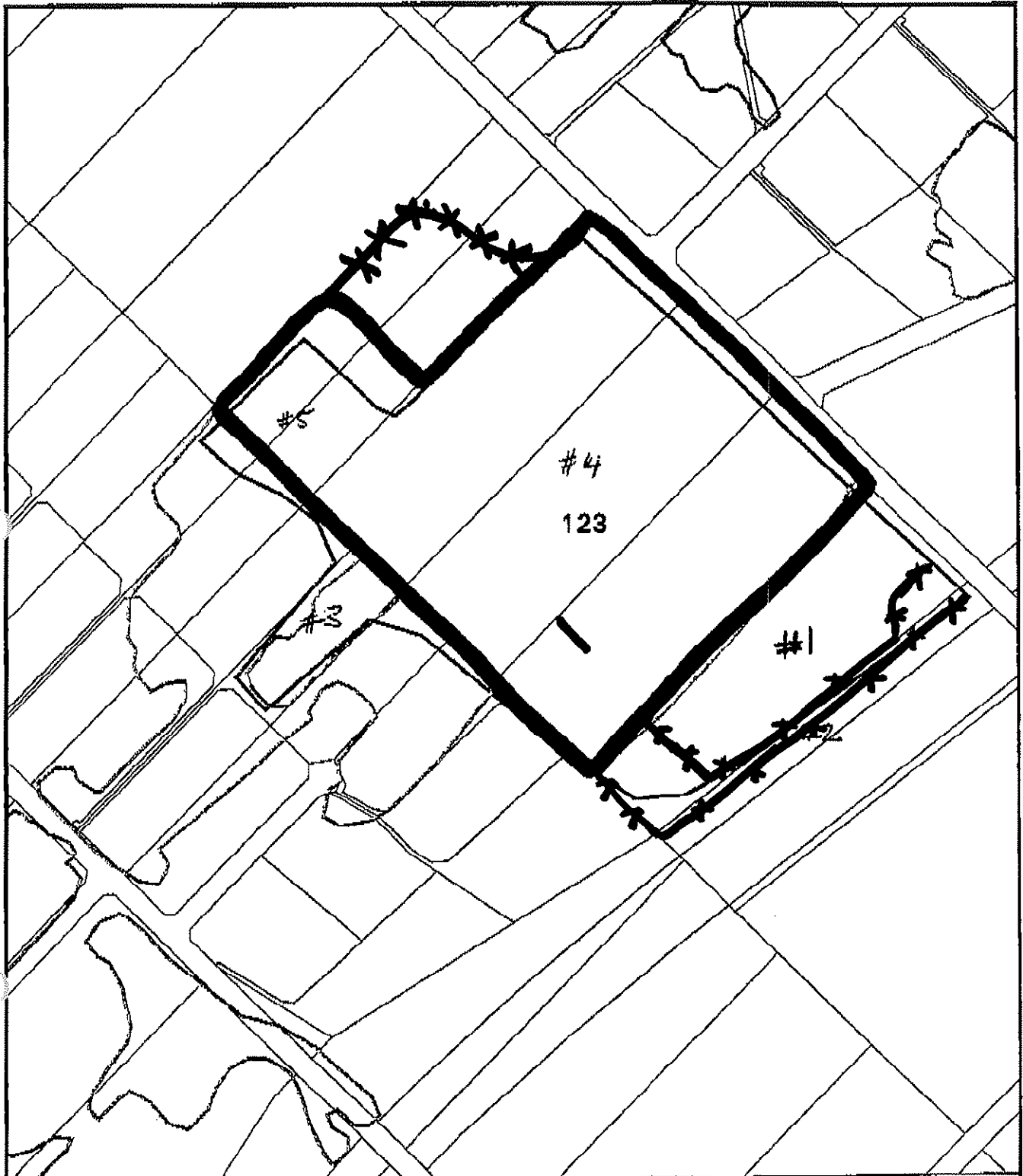



bp site 123

PROPOSED SITE BOUNDARY 

SEE PLAN FOR DETAILS.

-  Bushplan sites (no ccw), boundaries
-  Bush, Swan Coastal Plain, boundary
-  Cadastre

~~xx~~ BJK Line

MFP INTERNAL USE ONLY

Prepared By: Andrea Zappacosta

Prepared For:

Map Identi: plot881014_1

Date: 14 Oct 98

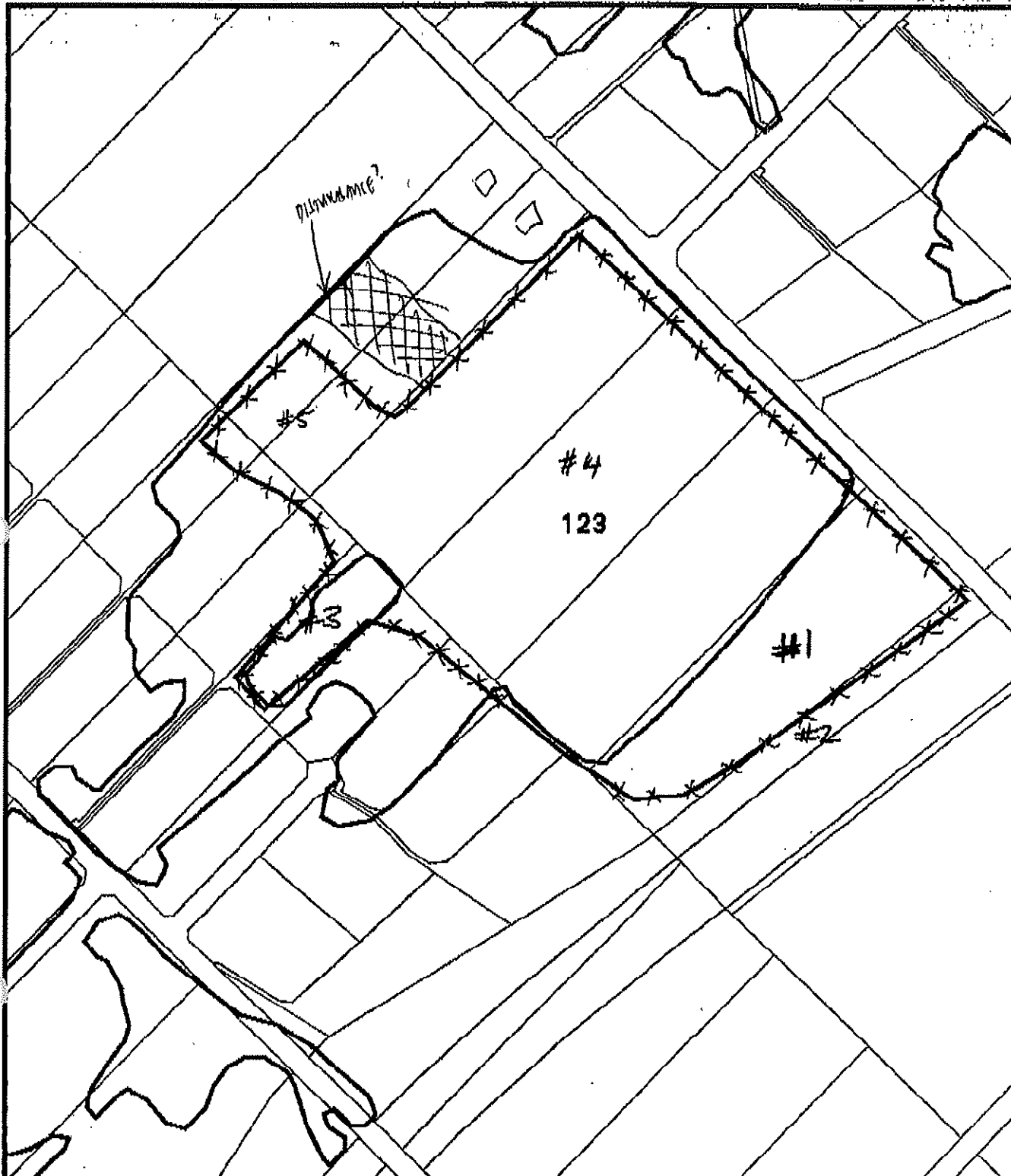

Scale 1:4807



bp site 123

Site boundary * * *

OTROLINE IS VEG (A-LWA)

-  Bushplan sites (no ccw), boundaries
-  Bush, Swan Coastal Plain, boundary
-  Cadastral

MFP INTERNAL USE ONLY

Prepared By: Andrea Zappacosta

Prepared For:



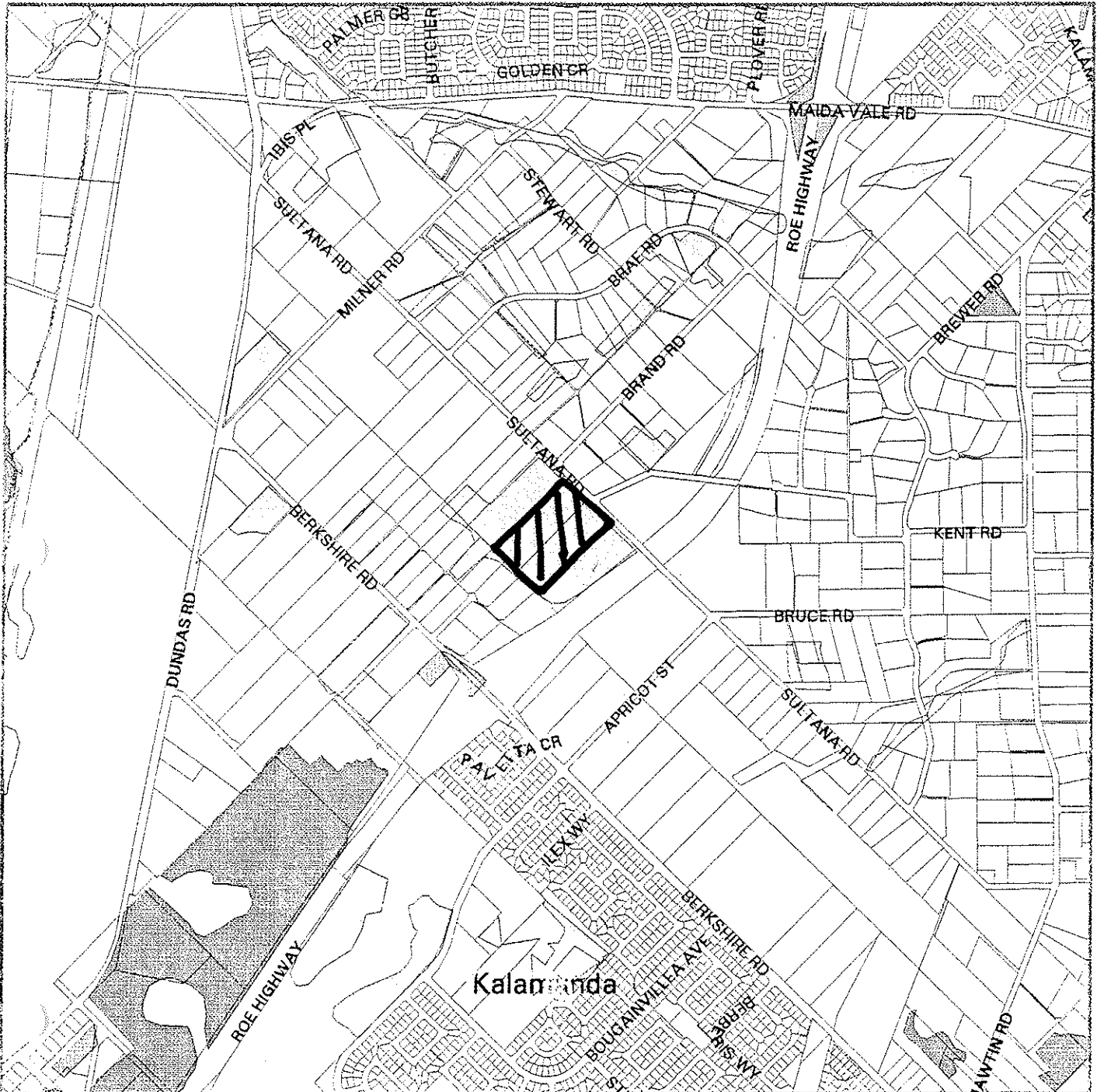

Map Id: plot981014_1

Date: 14 Oct 98

Scale 1:4807



MFP INTERNAL USE ONLY

-  Cadastre
-  Vegetation in very poor condition
-  Vegetation in poor condition
-  Vegetation in good condition
-  Local Government Areas - Metro

Sultana Road Bushland

High Wycoribe Veg Condition

**Department of Environmental Protection System 6 Update: Site Based Flora List for
Sultana Rd Threatened and/or Poorly Reserved Plant Community Area**
(82 taxa, Sultaa, B.J. Keighery, 6/6/96)

Anthericaceae

- 1 Johnsonia pubescens
- 2 Thysanotus arbuscula
- 3 Tricoryne elatior

Apiaceae

- 4 Trachymene pilosa

Asteraceae

- * Hypochaeris glabra
- 5 Millotia tenuifolia
- 6 Podotheca angustifolia
- * Sonchus oleraceus
- * Ursinia anthemoides

Caesalpiniaceae

- 7 Labichea punctata

Campanulaceae

- 8 Wahlenbergia preissii

Casuarinaceae

- 9 Allocasuarina humilis

Colchicaceae

- 10 Burchardia congesta

Cyperaceae

- 11 Caustis dioica
- 12 Cyathochaeta clandestina
- 13 Lepidosperma scabrum
- 14 Mesomelaena pseudostygia
- 15 Schoenus curvifolius
- 16 Tetraria capillaris

Dasypogonaceae

- 17 Calectasia cyanea
- 18 Dasypogon obliquifolius
- 19 Lomandra sericea

Dilleniaceae

- 20 Hibbertia huegelii
- 21 Hibbertia hypericoides

Droseraceae

- 2 Drosera erythrorhiza

Epacridaceae

- 4 Conostephium pendulum
- 4 Leucopogon sp. scps
- 5 Lysinema ciliatum
- 6 Styphelia tenuiflora

Euphorbiaceae

- 1 Poranthera microphylla
- 2 Stachystemon vermicularis

Goodeniaceae

- 7 Scaevola repens var. repens

Haemodoraceae

- 30 Conostylis aurea
- 1 Conostylis setigera
- 2 Haemodorum loratum
- 3 Haemodorum spicatum
- 4 Phlebocarya filifolia

Iridaceae

- * Gladiolus caryophyllaceus

Lauraceae

- 5 Cassytha sp. scps

Mimosaceae

- 6 Acacia applanata
- 7 Acacia sessilis

Myrtaceae

- 8 Calytrix sp. scps
- 7 Eremaea fimbriata
- 40 Melaleuca aff. trichophylla scps

Orchidaceae

- 1 Caladenia sp. scps
- 2 Microtis media subsp. media

Papilionaceae

- 3 Daviesia divaricata
- 4 Daviesia nudiflora
- 5 Daviesia preissii
- 6 Daviesia triflora
- 7 Templetonia biloba
- * Trifolium arvense
- * Trifolium subterraneum

Pittosporaceae

- 8 Pronaya fraseri

Poaceae

- 9 Amphipogon turbinatus
- * Briza maxima
- 50 Danthonia occidentalis
- * Ehrharta calycina
- 1 Stipa compressa
- * Vulpia myuros

Proteaceae

- 2 Adenanthos cygnorum
- 3 Banksia attenuata
- 4 Banksia incana
- 5 Banksia menziesii
- 6 Conospermum undulatum
- 7 Dryandra nivea
- 8 Isopogon drummondii
- 9 Lambertia multiflora var. darlingensis MS
- 60 Persoonia angustiflora
- 1 Petrophile linearis
- 2 Petrophile macrostachya
- 3 Stirlingia latifolia

Restionaceae

- 4 Alexgeorgea nitens
- 5 Loxocarya fasciculata
- 6 Lyginia barbata
- 7 Restio sinuosus MS

Rutaceae

- 8 Eriostemon spicatus

Stylidiaceae

- 9 *Levenhookia stipitata*
- 79 *Stylidium diuroides*
- 1 *Stylidium piliferum*

Thymelaeaceae

- 2 *Pimelea sp. scps*

Xanthorrhoeaceae

- 3 *Xanthorrhoea drummondii*



SULTØ1 Sultana Road. Threatened and poorly reserved plant community type

BS 103 9001/1011

LIBRARY
DEPARTMENT OF ENVIRONMENTAL PROTECTION
WESTRALIA SQUARE
141 ST. GEORGE'S TERRACE, PERTH

**VEGETATION AND FLORA
SURVEY
OF THE
SHIRE OF KALAMUNDA
VESTED RESERVES**

**VOLUME 1 - REPORT
OCTOBER 1992 TO MARCH 1993**

**PAUL ARMSTRONG RESEARCH OFFICER
SHIRE OF KALAMUNDA**

TABLE OF CONTENTS

INTRODUCTION	Page 1
METHODOLOGY	Page 2
2.1 RESERVES	Page 2
2.2 ANALYSIS	Page 3
RESULTS AND DISCUSSION	Page 6
3.1 FLORA	Page 6
3.1.1 Species Distribution	Page 9
3.1.2 Range Extensions	Page 11
3.1.3 Declared Rare and Priority Species	Page 12
3.1.4 Unidentified species	Page 15
3.1.5 Introduced Species	Page 15
3.2 RESERVES	Page 17
3.2.1 Assessment	Page 17
3.2.2 Comments on specific reserves	Page 21
3.3 COMPUTER FILES	Page 20
CONCLUSION	Page 21
4.1 FLORA	Page 21
4.2 RESERVES	Page 22
4.3 OVERALL	Page 22
ACKNOWLEDGMENTS	Page 23
REFERENCES	Page 24

LIST OF APPENDICES

APPENDIX I.	SPECIES LIST	Page 25
APPENDIX II.	SPECIES RICHNESS	Page 45
APPENDIX III.	SPECIES DISTRIBUTION	Page 47
APPENDIX IV.	VEGETATION CONDITION	Page 51

LIBRARY
DEPARTMENT OF ENVIRONMENTAL PROTECTION
WESTRALIA SQUARE
141 ST. GEORGE'S TERRACE, PERTH

LIBRARY
DEPARTMENT OF ENVIRONMENTAL PROTECTION
WESTRALIA SQUARE
141 ST. GEORGE'S TERRACE, PERTH

VEGETATION AND FLORA
SURVEY
OF THE
SHIRE OF KALAMUNDA
VESTED RESERVES

VOLUME 2 - RESERVE SPECIES LIST

OCTOBER 1992 TO MARCH 1993

BY PAUL ARMSTRONG RESEARCH OFFICER

SHIRE OF KALAMUNDA

MARCH 1993

TABLE OF CONTENTS

	Page
SHEET 01	1
SHEET 02	4
SHEET 05	6
SHEET 06	16
SHEET 10	33
SHEET 11	39
SHEET 12	50
SHEET 14	54
SHEET 15	61
SHEET 16	80
SHEET 21	85
SHEET 22	86

