

BEECHBORO ROAD BUSHLAND, CULLACABARDEE/BALLAJURA

Boundary Definition: proposed protected area boundary (Boundary adjusted from that in draft *Perth's Bushplan.*)

SECTION 1: LOCATION INFORMATION

Bush Forever Site no. 198

Area (ha): bushland 431.4

Map no. 35, 36

Map sheet series ref. no. 2034—II NE

Other Names: not known

Local Authorities (Suburb): Shire of Swan (Cullacabardee, Ballajura)

SECTION 2: REGIONAL INFORMATION

LANDFORMS AND SOILS

Bassendean Dunes

Bassendean Sands (Qpb: S8)

Bassendean Dunes/Pinjarra Plain

Bassendean Sands over Guildford Formation (Qpb/Qpa: S10)

VEGETATION AND FLORA

Vegetation Complexes

Bassendean Dunes

Bassendean Complex — Central and South

Combinations of Bassendean Dunes/Pinjarra Plain

Southern River Complex

Floristic Community Types: *not sampled, types inferred

Supergroup 2: Seasonal Wetlands

*4 *Melaleuca preissiana* damplands

Supergroup 3: Uplands centred on Bassendean Dunes and Dandaragan Plateau

*21c Low-lying *Banksia attenuata* woodlands or shrublands

*22 *Banksia ilicifolia* woodlands

*23a Central *Banksia attenuata* — *B. menziesii* woodlands

WETLANDS

Wetland Types: dampland, palusplain

Natural Wetland Groups

Bassendean—Pinjarra transition OR Bassendean with fluvial features

Bennet Brook (B/P.4)

Wetland Management Objectives: Conservation (91.2ha), Resource Enhancement, Multiple Use

Swan Coastal Plain Lakes EPP: none identified

THREATENED ECOLOGICAL COMMUNITIES

Not assessed

SECTION 3: SPECIFIC SITE DETAIL

Landscape Features: vegetated wetland, vegetated uplands

Vegetation and Flora

Structural Units: limited survey (DEP 1996, Mattiske Consulting Pty Ltd 1997)

Uplands: *Eucalyptus calophylla* Woodland over Low Woodlands to Low Open Woodlands dominated by *Melaleuca preissiana* and *Banksia ilicifolia*; Low Woodland dominated by *Allocasuarina fraseriana*, *Banksia attenuata* and *B. menziesii* with scattered *Eucalyptus totitiana*

Wetlands: *Eucalyptus calophylla* Forest to Open Woodland over *Melaleuca preissiana* Open Woodland; *Eucalyptus calophylla* and *Acacia saligna* Woodland

Scattered Native Plants: not assessed

Vegetation Condition: <10% Excellent, >90% Very Good to Good, with areas of severe localised disturbance

Total Flora: not known

Significant Flora: *Verticordia nitens*

Fauna: not known

Linkage: adjacent native vegetation to the north (Site 196 across road), south and east (Site 304 across road); part of a regionally significant fragmented bushland/wetland linkage (Part A, Map 7)

Other Special Attributes: recommended for protection in study of Shire of Wanneroo bushland (Trudgen 1996)

SECTION 4: INTERNATIONAL AND NATIONAL SIGNIFICANCE

Not listed

SECTION 5: SELECTION CRITERIA AND RECOMMENDATIONS

Criteria: Representation of ecological communities, General criteria for the protection of wetland, streamline and estuarine fringing vegetation and coastal vegetation

Recommendation: Proposed Parks and Recreation Reservation (see Table 3, Volume 1).

BEECHBORO ROAD BUSHLAND, CULLACABARDEE/BALLAJURA

Boundary Definition: bushland (part taken to cadastre) boundary

SECTION 1: CADASTRAL INFORMATION

(Lots, locations and derived information to be updated in the public submission period)

Bushplan Site no. 198	Map no. 46	Map sheet series ref. no. 2034-II NE
Other Names: not known		Area (ha): total 497.2; bushland 458.1
Local Authorities (Suburb) Shire of Swan (Cullacabardee, Ballajura)		Zoning MRS: Rural, Important Regional Roads TPS: Landscape, General Rural
Ownership Categories State Government		Lot/Location/Reserve numbers (Purpose), Street name 1, 2, 125, 126 Hepburn Ave; 51, 52, 123, 124, 10042 Marangaroo Dr; 1, 1000 street not identified Crown Reserve

SECTION 2: REGIONAL INFORMATION

LANDFORMS AND SOILS

Bassendean Dunes

Bassendean Sands (Qpb: S8)

Bassendean Dunes/Pinjarra Plain

Bassendean Sands over Guildford Formation (Qpb/Qpa:S10)

VEGETATION AND FLORA

Vegetation Complexes

Bassendean Dunes

Bassendean Complex — Central and South

Combinations of Bassendean Dunes/Pinjarra Plain

Southern River Complex

Floristic Community Types: *not sampled, types inferred

Supergroup 2: Seasonal Wetlands

*4 *Melaleuca preissiana* damplands

Supergroup 3: Uplands centred on Bassendean Dunes and Dandaragan Plateau

*21c Low lying *Banksia attenuata* woodlands or shrublands

*22 *Banksia ilicifolia* woodlands

*23a Central *Banksia attenuata* — *B. menziesii* woodlands

WETLANDS

Wetland Types: dampland, palusplain

Natural Wetland Groups

Bassendean—Pinjarra transition OR Bassendean with fluvial features

Bennet Brook (B/P.4)

Wetland Management Objectives: Conservation (91.2ha), Resource Enhancement, Multiple Use

Swan Coastal Plain Lakes EPP: none identified

THREATENED ECOLOGICAL COMMUNITIES

Not assessed

SECTION 3: SPECIFIC SITE DETAIL

Landscape Features: vegetated wetland, vegetated uplands

Vegetation and Flora

Structural Units: limited survey (DEP 1996, Mattiske Consulting Pty. Ltd. 1997)

Uplands: *Eucalyptus calophylla* Woodland over Low Woodlands to Low Open Woodlands dominated by *Melaleuca preissiana* and *Banksia ilicifolia*; Low Woodland dominated by *Allocasuarina fraseriana*, *Banksia attenuata* and *B. menziesii* with scattered *Eucalyptus todtiana*

Wetlands: *Eucalyptus calophylla* Forest to Open Woodland over *Melaleuca preissiana* Open Woodland; *Eucalyptus calophylla* and *Acacia saligna* Woodland

Scattered Native Plants: not assessed

Vegetation Condition: <10% Excellent, >90% Very Good to Good, with areas of severe localised disturbance

Significant Flora: *Verticordia nitens*

Fauna: no known information

Linkage: adjacent native vegetation to the north (BS196 across road), south and east (BS304 across road); part of a regionally significant fragmented bushland/wetland linkage (Volume 2A, Map 8)

Other Special Attributes: recommended for protection in study of Shire of Wanneroo bushland (Trudgen 1996)

SECTION 4: INTERNATIONAL AND NATIONAL SIGNIFICANCE

Not listed

SECTION 5: SELECTION CRITERIA AND RECOMMENDATIONS

Criteria: Representation of ecological communities, General criteria for the protection of wetland, streamline and estuarine fringing and coastal vegetation

Opportunities and/or Constraints

Opportunities: Bushplan Site/part Bushplan Site subject to Swan and Canning Rivers EPP, Gnangara Mound Crown Land EPP; location of conservation category wetlands; under TPS Landscape Zoning, Crown Reserve







Constraints: under MRD regional road requirements

Recommendation: The most appropriate mechanism for the protection of this Bushplan Site be considered through the public comment period in consultation with the land owner(s).



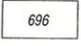
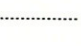

LEGEND

-  Bushplan Sites With Regionally Significant Bushland
-  Other Native Vegetation
-  Conservation Category Wetlands
-  Bushplan Sites With Some Existing Protection
-  Lot Number, Location Number
-  Channel Wetlands
-  Local Government Boundary

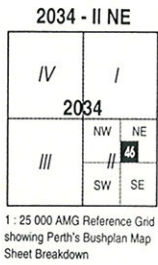

PERTH'S BUSHPLAN MAP INDEX

1	2
3	4
5	6
7	8
9	10
11	12
13	14
15	16
17	18
19	20
21	22
23	24
25	26
27	28
29	30
31	32
33	34
35	36
37	38
39	40
41	42
43	44
45	46
47	48
49	50
51	52
53	54
55	56
57	58
59	60
61	62
63	64
65	66
67	68
69	70
71	72
73	74
75	76
77	78
79	80
81	82
83	84
85	86
87	88
89	90
91	92
93	94
95	96
97	98
99	100
101	102
103	104
105	106

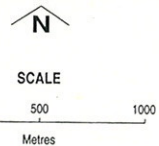

Produced by Project Mapping Section
Land Information Branch, Ministry for
Planning, Perth W.A. November 1998
ntw-map11/envirom/bushplan/bushv2_46.dgn
Cadastral Data supplied by Department
of Land Administration, W.A.
Wetlands Data supplied by
Water and Rivers Commission
Native Vegetation Extent for Study Area
supplied by Agriculture Western Australia

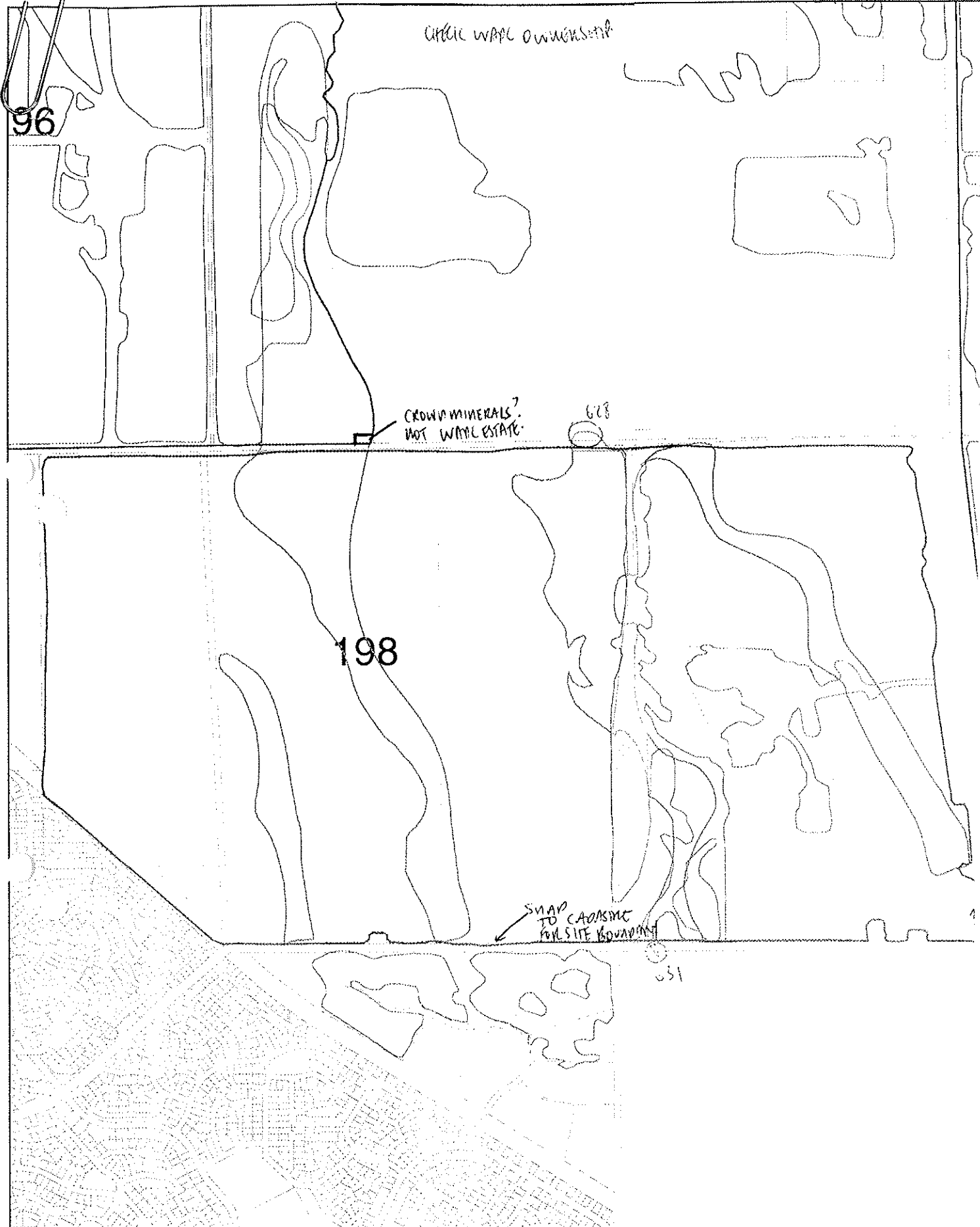

BUSHPLAN SITES CORRECTED



WESTERN
AUSTRALIAN
PLANNING
COMMISSION



CUSTOMER
FOCUS
WESTERN AUSTRALIA

B 7c/BK 22/10/98



295
P8056

Submission on Perth's Bushplan
by
The Bennett Brook Catchment Group

The Bennett Brook Catchment Group wish to commend the State Government on the production of Bushplan, which has a high standard of scientific data, and is very well researched. It is extremely important to protect the remnant bushland on the coastal plain before it is irretrievably degraded. The System 6 recommendations were designed to do the same thing, however as they were not implemented, many areas recommended or protection have since disappeared.

The catchment group wishes to draw the following points to your attention:

- It is vital that interim protection in legal terms is given to all Bushplan sites. This may take the form of statutory regulations under the Environmental Protection Act and may be assisted by the use of Planning Control Areas under the Metropolitan Region Town Planning Scheme. The creation of a new category such as Bushland Conservation Zone should be created under the MRS.
- It is also vital that Bushplan be implemented in full as soon as possible. 10 years for implementation is too long, and the aim should be for 4-5 years. The funds set aside for implementation are inadequate, and need to be tripled. This may need to be funded through an environmental levy.
- It is important to introduce Land Clearing Controls through legal regulation, as suggested on p32 (Vol. 1), however it must apply to all levels of government as well as to private landholders, and must have legally enforceable penalties to be effective.
- It is important to launch a major community awareness program about the value of local bushland, and to make the community aware of the unique nature of our flora and fauna and the threats to it.
- Support for private landholders should be increased, through mechanisms such as Land for Wildlife run by CALM.
- The Ministry for Planning currently has a number of policies and plans which need to be integrated ie Bushplan, Livable Neighbourhoods, Greenways, Model Scheme Text, Urban Bushland Policy

The following sites are within the Bennett Brook Catchment, and we wish to make specific comment about them. The catchment group is currently involved in restoration programs in some of these areas, and is keen to assist with the management of the others.

1. Bushplan site 06: Gnangara Rd Bushland

This area is an important link with Whiteman Park. The area needs to be managed by the landholders for conservation

2. Bushplan site 08: Beechboro Rd Bushland

Another important link with Whiteman Park. The area needs to be vested in a body able to manage it for conservation, in conjunction with the Aboriginal community.

3. Bushplan site 04: Whiteman Park

Whiteman Park has important areas for bushland conservation. It is important that future developments in the Park do not compromise the integrity of the conservation values. The Ministry for Planning need to allocate more resources to the Park for management of its bushland. The Park is linked to the Swan River via Bennett Brook.

SUBMISSION NO. 489

MINISTRY FOR PLANNING
28 APR 1999
805-2-1-32 p/12
FILE

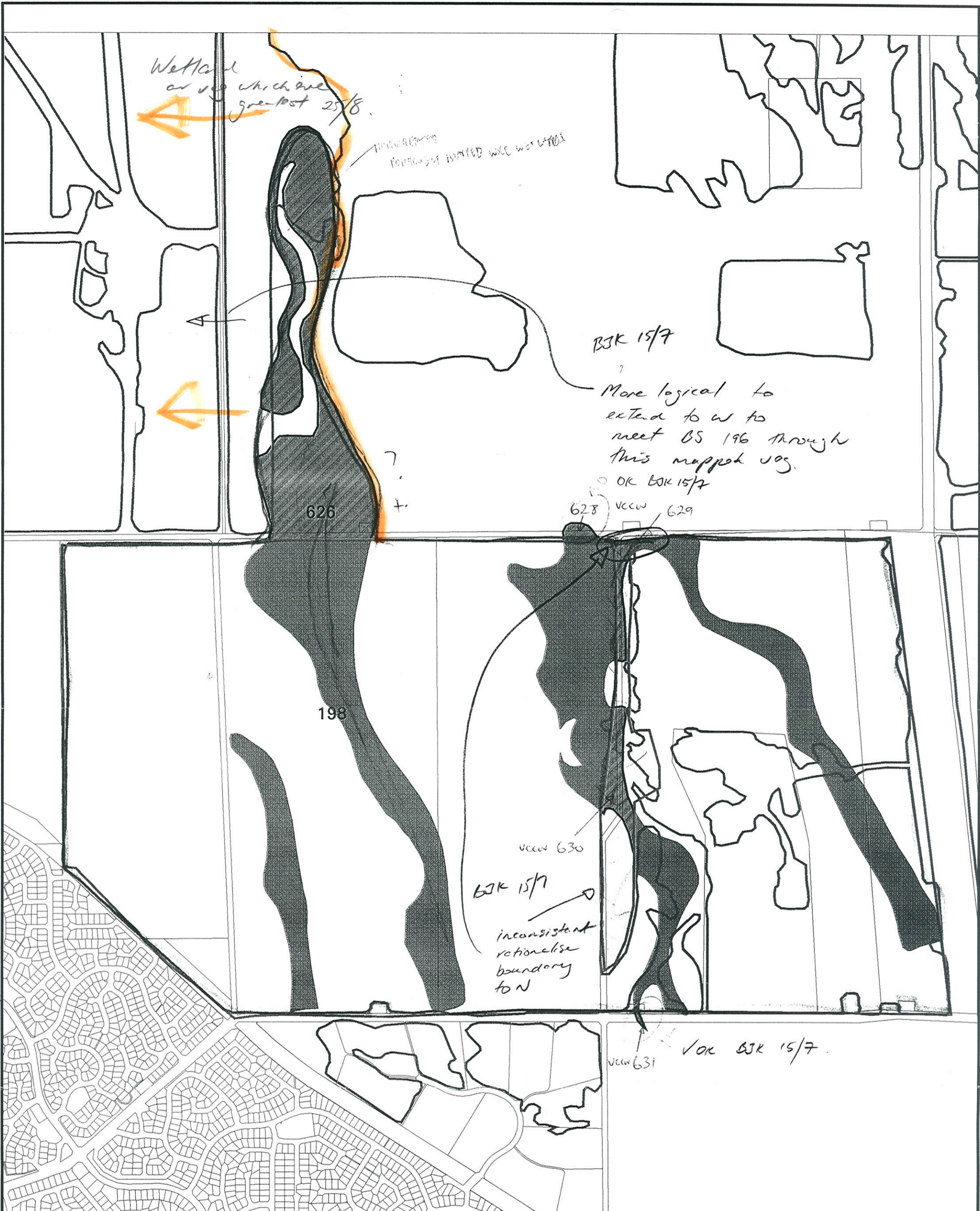

bp site 198

-  AG VEG 1998 BOUNDARY THEME
-  Cadastre
-  Bushplan sites refno 1-500 SCP BOUNDARY THEME
-  cons category wetlands
-  Verified CCWs

*DEB NOTE (LINES TO CADASTRE IN THE MAIN AVE TO MATCH WAPC / STATE GOVT OWNERSHIP)

Map Ident: plot980527_1	DATE: 27 May 98
Prepared By: Andrea Zappacosta	Prepared For:
Scale 1:AUTO	MFP INTERNAL USE ONLY

0  500 m