

## HELENA RIVER, HELENA VALLEY

**Boundary Definition:** protected area/bushland boundary

### SECTION 1: LOCATION INFORMATION

**Bush Forever Site no.** 215

**Area (ha):** bushland 77.7

**Map no.** 44, 50

**Map sheet series ref. no.** 2134—III SW

**Other Names:** not known

**Local Authorities (Suburb):** Shire of Mundaring (Helena Valley, Darlington), Shire of Kalamunda (Gooseberry Hill, Piesse Brook, Helena Valley)

**System 6 (1983):** Part M33, part M34 part System area bushland and part scattered native plants, all vegetation described

### SECTION 2: REGIONAL INFORMATION

#### LANDFORMS AND SOILS

**Darling Plateau (Darling Range)/Darling Scarp**

Even-grained Granite (Ae, Aes: M3, GR)

#### Foothills

Colluvial Deposits (Qc: Mgs2)

#### Pinjarra Plain

Guildford Formation (Qpa: Mgs1) (Qha: Cm2)

#### VEGETATION AND FLORA

##### Vegetation Complex

###### Scarps

Darling Scarp Complex

###### Foothills

Forrestfield Complex (Ridge Hill Shelf, Darling Plateau)

###### Pinjarra Plain

Swan Complex

**Floristic Community Types:** not sampled, types not inferred

#### WETLANDS

**Wetland Types:** river, creek

**Natural Wetland Groups** (undefined areas included in boundary)

##### Darling Plateau

Walyunga (D.1)

**Wetland Management Objectives:** Conservation (930m)

**Swan Coastal Plain Lakes EPP:** none identified

#### THREATENED ECOLOGICAL COMMUNITIES

Not determined

### SECTION 3: SPECIFIC SITE DETAIL

**Landscape Features:** vegetated wetland, creek

**Vegetation and Flora:** limited survey (DEP 1998)

#### Structural Units

Uplands (aerial photograph interpretation after Site 217): *Eucalyptus wandoo* Low Open Woodland to Open Woodland; *Eucalyptus calophylla* Open Woodland; *Hakea lissocarpa* and *Acacia pulchella* Open Heath

Wetlands: *Eucalyptus rudis* Tall Open Forest; *Melaleuca raphiophylla* Open Forest; *Eucalyptus calophylla* Open Woodland to Woodland

**Scattered Native Plants:** *Eucalyptus calophylla* Woodland to Open Woodland

**Vegetation Condition:** 30% Very Good, 30% Good, 40% Degraded, with areas of severe localised disturbance

**Total Flora:** not known

**Significant Flora:** *Anthocercis gracilis* (R), *Hakea myrtooides*

**Fauna:** Significant mammal species: Quenda (Friend 1996 D)

**Linkage:** adjacent bushland to the north; part of a regionally significant fragmented bushland/wetland linkage (Part A, Map 7); part of Greenways 25 (Tingay, Alan & Associates 1998a)

**Other Special Attributes:** naturally vegetated watercourses have particular conservation value in providing habitat for fauna and linkage between larger more intact areas of bushland; contains open space of regional significance (DCE 1983); contains 4860m of regionally significant river (WRC 1996a GIS)

***SECTION 4: INTERNATIONAL AND NATIONAL SIGNIFICANCE***

Not listed

***SECTION 5: SELECTION CRITERIA AND RECOMMENDATIONS***

**Criteria:** Representation of ecological communities, Rarity, General criteria for the protection of wetland, streamline and estuarine fringing vegetation and coastal vegetation, Criteria not relevant to determination of regional significance, but which may be applied when evaluating areas having similar values

**Recommendation:** Part A: Site with Some Existing Protection; existing Parks and Recreation Reserve. Part B: Regional Creekline Mechanism (with mapped vegetation) (see Table 3, Volume 1).

## HELENA RIVER, HELENA VALLEY

**Boundary Definition:** protected area/bushland boundary

### SECTION 1: CADASTRAL INFORMATION

(Lots, locations and derived information to be updated in the public submission period)

**Bushplan Site no.** 215      **Map no.** 53, 54      **Map sheet series ref. no.** 2134-III SW

**System 6 (1983):** Part M33, part M34 part System area bushland and part scattered native plants, all vegetation described

**Other Names:** not known

**Area (ha):** total 80.7; bushland 77.7

**Local Authorities (Suburb)**

**Zoning**

Shire of Mundaring (Helena Valley, Darlington), Shire of Kalamunda (Gooseberry Hill, Piesse Brook, Helena Valley)

**MRS:** Rural, Parks and Recreation

**TPS:** Landscape, Rural Landscape Living

**Ownership Categories**

Commonwealth Government, State Government, Local Government

**Lot/Location/Reserve numbers (Purpose),**

**Street name**

3, 34, 35, 36, 37 Clayton Rd; 38, 39 Fyfe St; 0, 11, 252, 253, 254, 255, 256, 257, 258 Helena Valley Rd; 216, 217, 582, 2822 Victor Rd; 14 Atoifi Gdns; 12742 street not identified; Water

Crown Reserve

### SECTION 2: REGIONAL INFORMATION

#### LANDFORMS AND SOILS

**Darling Plateau (Darling Range)/Darling Scarp**

Even-grained Granite (Ae, Aes: M3, GR)

#### Foothills

Colluvial Deposits (Qc: Mgs2)

#### Pinjarra Plain

Guildford Formation (Qpa: Mgs1) (Qha: Cm2)

#### VEGETATION AND FLORA

##### Vegetation Complex

###### Scarps

Darling Scarp Complex

###### Foothills

Forrestfield Complex (Ridge Hill Shelf, Darling Plateau)

###### Pinjarra Plain

Swan Complex

**Floristic Community Types:** not sampled, types not inferred.

#### WETLANDS

**Wetland Types:** river, creek

**Natural Wetland Groups** (undefined areas included in boundary)

##### Darling Plateau

Walyunga (D.1)

**Wetland Management Objectives:** Conservation (930m)

**Swan Coastal Plain Lakes EPP:** none identified

#### THREATENED ECOLOGICAL COMMUNITIES

Not determined

### SECTION 3: SPECIFIC SITE DETAIL

**Landscape Features:** vegetated wetland, creek

**Vegetation and Flora:** limited survey (DEP 1998)

#### Structural Units

Uplands (aerial photograph interpretation after BS217): *Eucalyptus wandoo* Low Open Woodland to Open Woodland; *Eucalyptus calophylla* Open Woodland; *Hakea lissocarpa* and *Acacia pulchella* Open Heath

Wetlands : *Eucalyptus rudis* Tall Open Forest; *Melaleuca raphiophylla* Open Forest; *Eucalyptus calophylla* Open Woodland to Woodland

**Scattered Native Plants:** *Eucalyptus calophylla* Woodland to Open Woodland

**Vegetation Condition:** 30% Very Good, >30% Good, 40% Degraded, with areas of severe localised disturbance

**Total Flora:** not known

**Significant Flora:** *Anthocercis gracilis* (R), *Hakea myrtoides* (3)

**Fauna:** no systematic survey. Significant mammal species: Quenda (Friend 1996 D)

**Linkage:** adjacent bushland to the north and west; part of a regionally significant fragmented bushland/wetland linkage (Volume 2A, Map 8)



**Other Special Attributes:** naturally vegetated watercourses have particular conservation value in providing habitat for fauna and linkage between larger more intact areas of bushland; contains open space of regional significance (DCE 1983); contains 4860m of regionally significant river (WRC 1996a GIS)

**SECTION 4: INTERNATIONAL AND NATIONAL SIGNIFICANCE**

Not listed

**SECTION 5: SELECTION CRITERIA AND RECOMMENDATIONS**

**Criteria:** Representation of ecological communities, Rarity, General criteria for the protection of wetland, streamline and estuarine fringing and coastal vegetation, Criteria not relevant to determination of conservation value, but which may be applied when evaluating areas having similar values

**Opportunities and/or Constraints**

**Opportunities:** Bushplan Site/part Bushplan Site subject to Swan and Canning Rivers EPP; location of Declared Rare Flora, conservation category wetlands; under MRS Parks and Recreation Reservation and TPS Landscape Zoning, Crown Reserve

**Recommendation:** The most appropriate mechanism for the protection of this Bushplan Site be considered through the public comment period in consultation with the land owner(s).



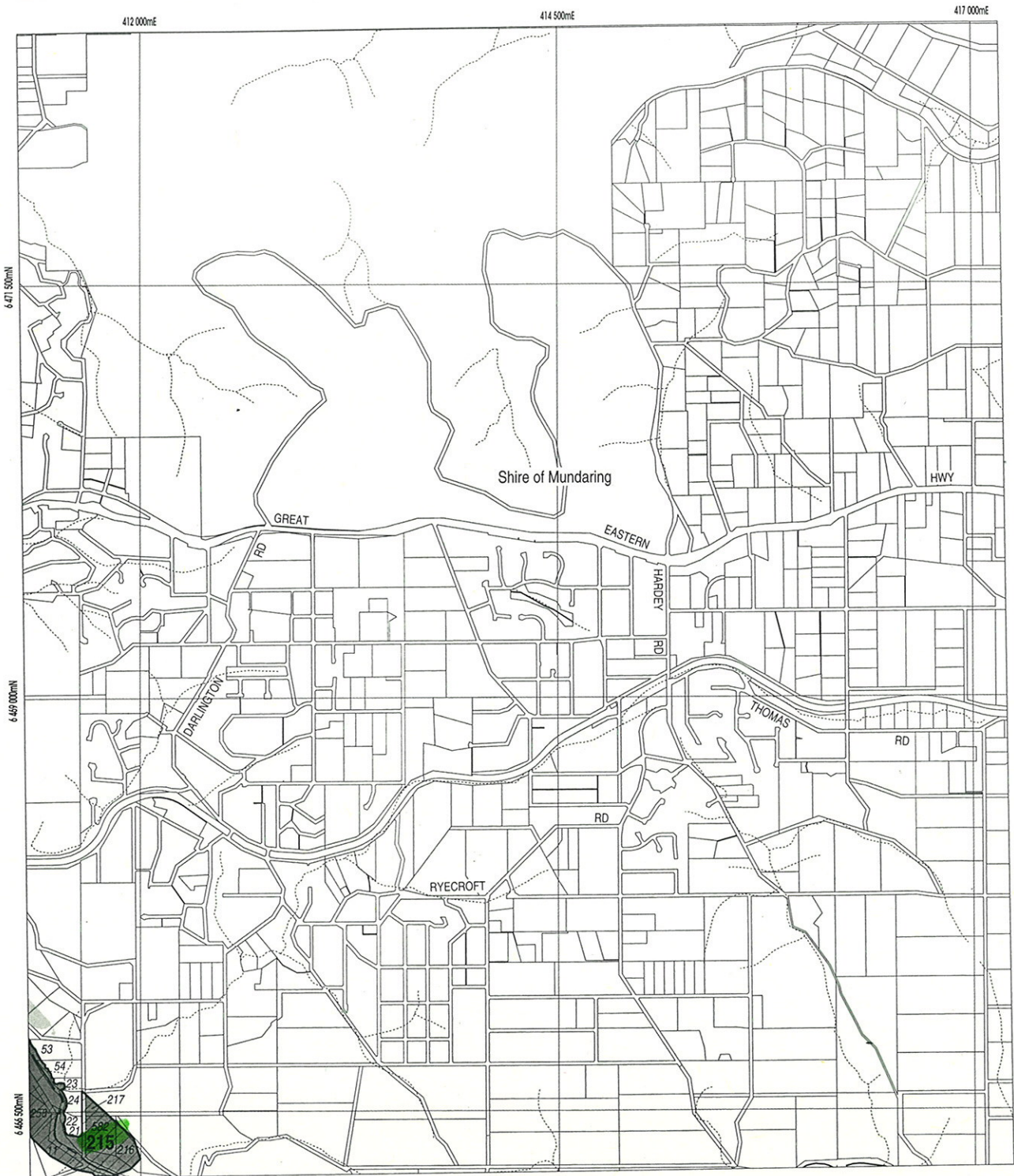

- LEGEND**
- 472 Bushplan Sites With Regionally Significant Bushland
  - Other Native Vegetation
  - Conservation Category Wetlands
  - Bushplan Sites With Some Existing Protection
  - 696 Lot Number, Location Number
  - Channel Wetlands
  - Local Government Boundary

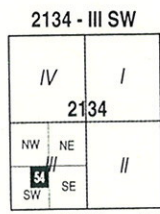

1 : 25 000 AMG Reference Grid showing Perth's Bushplan Map Sheet Breakdown

**PERTH'S BUSHPLAN MAP INDEX**

1	2										
3	4	5									
6	7	8	9	10	11						
12	13	14	15	16							
17	18	19	20	21	22	23					
24	25	26	27	28	29	30					
31	32	33	34	35	36						
37	38	39	40	41	42						
43	44	45	46	47	48						
49	50	51	52	53	54						
55	56	57	58	59							
60	61	62	63	64							
65	66	67	68	69	70						
71	72	73	74	75	76	77					
78	79	80	81	82	83	84					
85	86	87	88	89	90	91					
92	93	94	95	96	97						
98	99	100	101	102							
103	104	105	106								

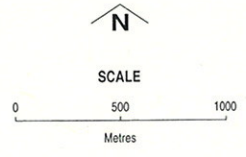

Produced by Project Mapping Section  
 Land Information Branch, Ministry for  
 Planning, Perth W.A. November 1998  
 ntw-map18/environ/bushplan/bushv2\_54.dgn





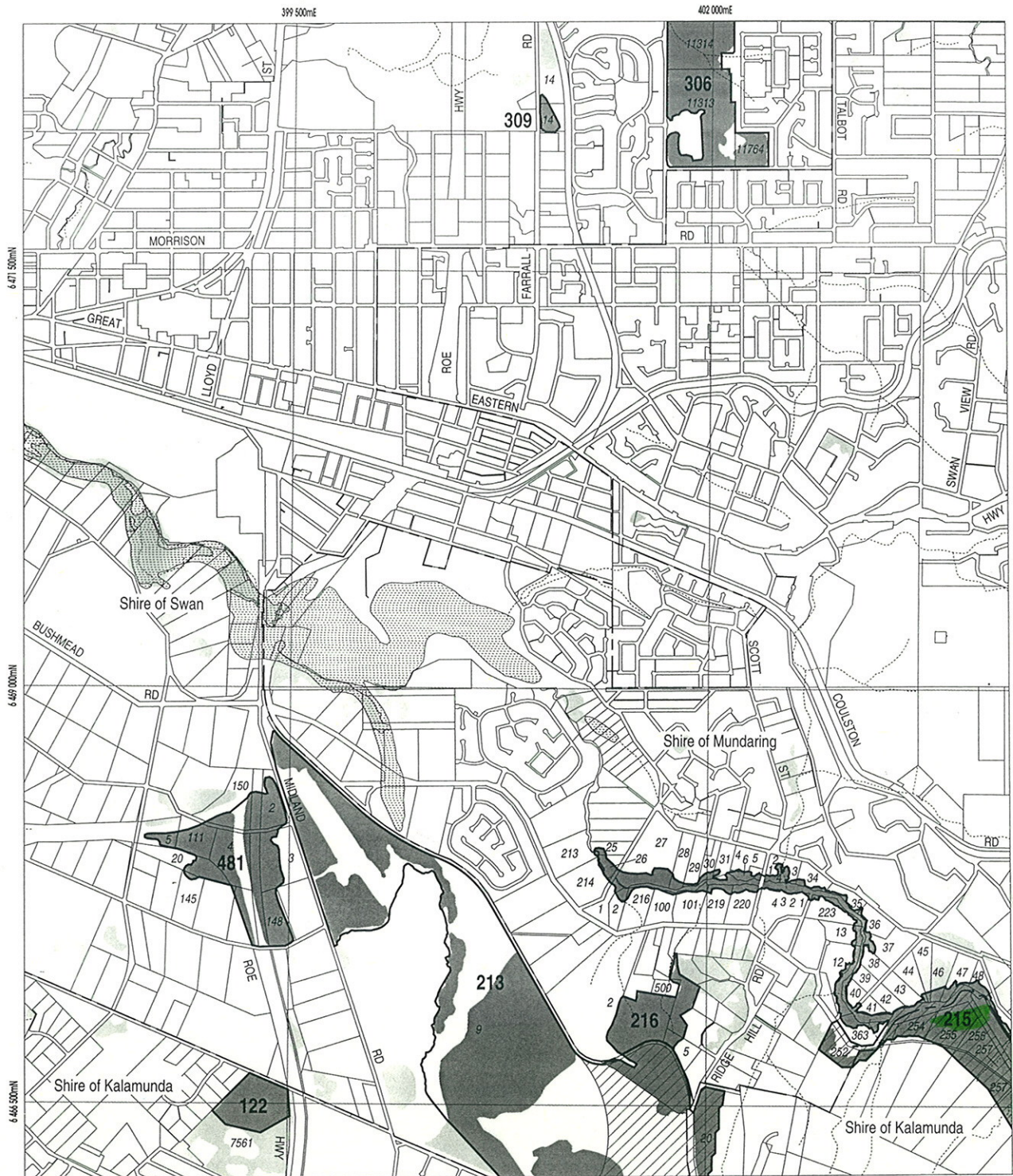

Cadastral Data supplied by Department  
 of Land Administration, W.A.

Wetlands Data supplied by  
 Water and Rivers Commission

Native Vegetation Extent for Study Area  
 supplied by Agriculture, Western Australia



**LEGEND**

-  Bushplan Sites With Regionally Significant Bushland
-  Other Native Vegetation
-  Conservation Category Wetlands
-  Bushplan Sites With Some Existing Protection
-  Lot Number, Location Number
-  Channel Wetlands
-  Local Government Boundary

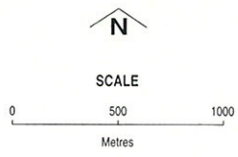
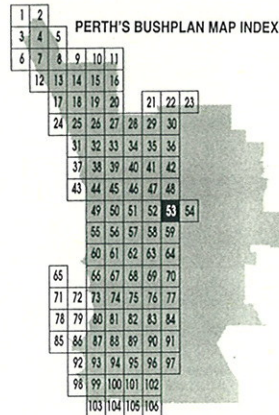
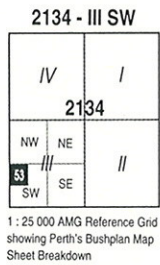

Produced by Project Mapping Section  
Land Information Branch, Ministry for  
Planning, Perth W.A. November 1998  
ntw-map18/enviro/bushplan/bushv2\_53.dgn  
Cadastral Data supplied by Department  
of Land Administration, W.A.  
Wetlands Data supplied by  
Water and Rivers Commission  
Native Vegetation Extent for Study Area  
supplied by Agriculture Western Australia

**PLEASE SUPPORT THE OPPORTUNITY TO PROTECT AND LOOK AFTER  
MUNDJALLINA COUNTRY AT "BELLE VIEW" AND "HAWK VALLEY"**

**IN A SIMILAR WETLAND LANDSCAPE TO THAT AT KAKADU**

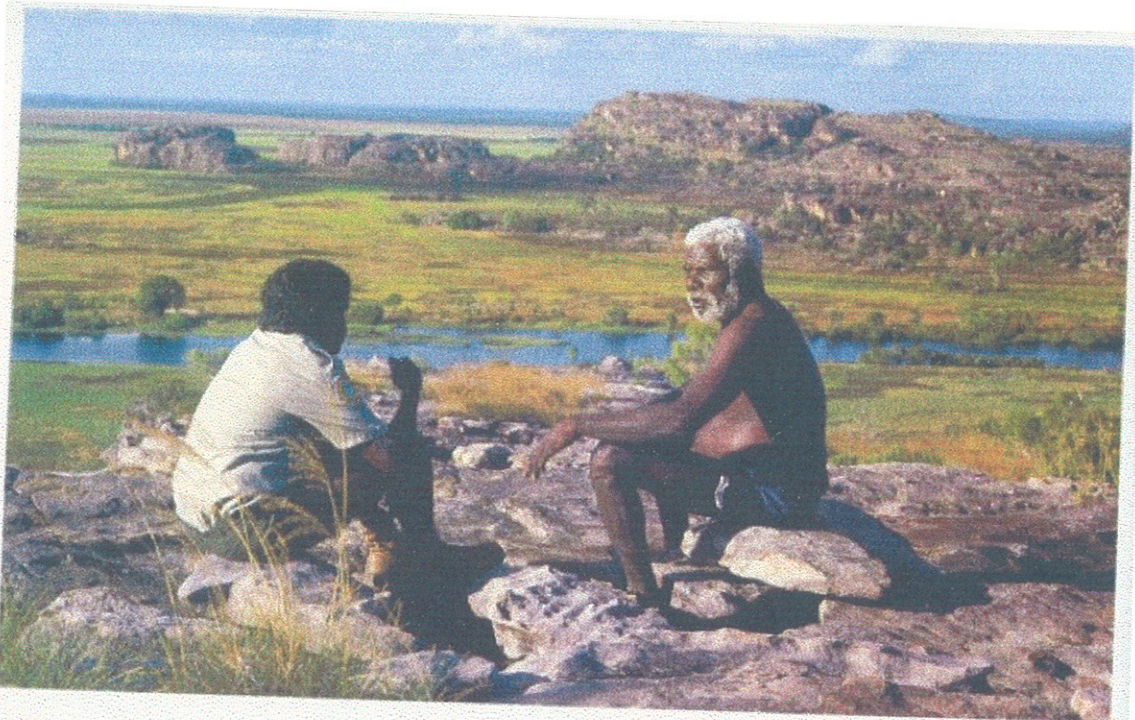

*Neidjie and Yarramarna sit in the heart of Bininj country at a place that overlooks all their traditional lands.*

The two climb higher onto the rocks. Neidjie's breathing is laboured but he struggles on right to the summit. A cool breeze now fans their perspiring faces. Below them, all around, is a panoramic view of their clan's lands: the plains, forests, billabongs, Indjuwanydjuwa and Warrayangal. Snaking through it is the East Alligator River. It is their life and their beliefs at a glance. Seated on a rock Neidjie looks around him for long, savoured minutes. Then slowly he points out the landmarks one by one and explains their significance to Yarramarna.

Several days later Yarramarna, accompanied by his father, puts his hand stencil on rocks close to Hawk Dreaming, a symbolic commitment to his Aboriginal heritage.

Buoyed by his son's interest Neidjie decides to take some of the Aboriginal park rangers deep into the bush to a special place few white people go. He asks Kapiirigi and Ilkiri to come along also. Iyanuk is too frail to make the journey.

*Heard melodies are sweet, but those unheard are sweeter, Keats (1795-1821)*

*Eagle there! e can look plain and water there longside and you feel yourself...  
This time White European must come to Aborigine, listen Aborigine and understand it.  
Understand that culture, secret, what dreaming...  
If you got story, heart... then speak yourself, stand for it! , Bill Neidjie (1913-2002)*

*Little Eagles were the most commonly observed raptor, seen on 158 occasions, Michael Brooker (2001)*

**BRINGING BACK MUNDJALLINA BY RECOGNISING AND PROTECTING,  
THE SPECIAL VALUES OF BELLE VIEW, BUSHMEAD, KADINA BROOK  
AND THE HELENA RIVER - JULY 2002**

Note: The family of the late Bill Neidjie, have given permission for his image to continue to be used, to celebrate his life and his continued contribution to cross cultural understanding in Australia



- Lot 24 - Stirling Cresc.
- Registered Abandoned sites
- 1933 area to be placed into parks



KALLEEP MUNDAY CULTURAL PRECINCTS & HERITAGE TRAILS

BASEMAP & BOUNDARIES FROM: DARLING RANGE REGIONAL PARK CONCEPT MAP 3  
 MINISTRY FOR PLANNING (1995) PROPOSALS FOR THE DARLING RANGE REGIONAL PARK

Was Subject to approval by Nyungar Elders

	A	B	C	D
1	Identification	Midgegooroo Precinct 1	Midgegooroo Precinct 2	Midgegooroo Precinct 3
2	Current Name	Bushmead/Riffe Range	Kadina Bk Wetlands	Belle View
3	Other Name	Nyungar (Nyungar)	Helena Valley	Mundoon (Nyungar)
4	Other Name	Bush forever site 213	Wetland 200v NE	Helena Valley Farm
5	Other Name	Kadina Bk Greenway No 49	Kadina Bk Greenway No 49	Helena & Kadina Greenway 25.49.50
6	Other Name	Potential Darling Range Reg Park	Potential Darling Range Reg Park	Potential Darling Range Reg Park
7	Approximate Area	300Ha	40 Ha	100Ha
8	Address	Midland Rd Bushmead WA	Helena Valley Rd	Lot 50 Wakkara Rd
9	Town	Maida Vale	Helena Valley	Bellevue
10	State	WA	WA	WA
11	Nearest Town	1Krn	Helena Valley	Bellevue
12	Distance		4km	20m
13	Direction	NW	W	S
14	LGA	Swan	Mundaring	S
15	Property & Boundary	Whole Site	Wetlands + 50m less	Mundaring Whole Site
17	Nominator	Helena River Catchment Group	Helena River Catchment Group	Helena River Catchment Group
18	Address	C/ Po Box 20 Mundaring	C/ Po Box 20 Mundaring	C/ Po Box 20 Mundaring
19	Suburb	Mundaring	Mundaring	Mundaring
20	Signature	Yes	Yes	Yes
21	Nominator Disclosed	No	No	No
22	Owners	Dept of Defence	Private Current rezoning 1044/03 for housing	Company Private Owned Rezoning for houses proposal
26	Admin Cat		9952 '8952/9983'	9952
27	Previous Heritage Assessments	AHC RNE (2) Listed 017825		State Heritage Council Listed Whole Site 26/98 ref 3636
30	AURPGSR-5182	DIA Reg Aboriginal Sites	DIA Reg Aboriginal Sites	DIA Reg Aboriginal Sites
31		Bush Forever 2000 Listed 213		
32			Cons Cat Wetlands 1996	Cons Cat Wetlands 1996
33				
34				
35				
36				
37	Place description	Perth Greenway Listed 49.50	Perth Greenway Listed 49	Perth Greenway Listed 25.49.50
38		Bushmead Heritage Areas	Wetland Area- cons category	State Heritage- Belle View m
39		Bushland transition from riverine to wetland to scrub - catena	Bushmead Belleview Link	Wetland Area- cons category
40		Nyungar mythology of turtle black snake and quenda	Rezonng proposal 1044/03	Bushmead Belleview Link
41		Aboriginal mythology of turtle black snake and quenda	Dale(1829) Heritage Route	Rezonng proposal 1044/03
42		Aboriginal mythology of turtle black snake and quenda	Railway Bridge fatal crash 1904	Dale(1829) Heritage Route
43		Aboriginal mythology of turtle black snake and quenda	Aboriginal sites	Railway Bridge fatal crash 1904
44		Aboriginal mythology of turtle black snake and quenda	Aboriginal sites	Aboriginal sites
45		Aboriginal mythology of turtle black snake and quenda	Aboriginal sites	Aboriginal sites
46		Aboriginal mythology of turtle black snake and quenda	Aboriginal sites	Aboriginal sites
47	Condition and Integrity	As a whole unit priceless Parts excellent condition	Kadina brook Greenway As whole unit priceless Braided creek in wetland Previously grazed One house, paddocks Superbly positioned for park	Kadina brook Greenway As whole unit priceless Braided creek in wetland Previously grazed One house, paddocks Superbly positioned for park
48				
49				
50				
51				
52				
53				
54				
55	Sources of Further Information			Core of Mundaling Main Run
56		HGM, 1991 Bushmead EIA	HGM, 1991 Bushmead EIA	HGM, 1991 Bushmead EIA
57		HGM, 1992 BUSHMEAD EIA SUP	HGM, 1992 EIA SUP	HGM, 1992 EIA SUP
58		Bates(Various) in Bridge (1992)	Bates(Various) in Bridge (1992)	Bates(Various) in Bridge (1992)
59		Green(1984) Broken Spears	Green(1984) Broken Spears	Green(1984) Broken Spears
60		Green(1979) Nyungar The People	Green(1979) Nyungar The People	Green(1979) Nyungar The People
61		DCE(1983) System6	DCE(1983) System6	DCE(1983) System6
62		Friends of Quenda Creek(1998)	Friends of Quenda Creek(1998)	Friends of Quenda Creek(1998)
63		Brooker(2001)	Brooker(2001)	Brooker(2001)
64		Alan Tingay & Assoc(1998)	Alan Tingay & Assoc(1998)	Alan Tingay & Assoc(1998)
65		Hil et al(1999)	Hil et al(1999)	Hil et al(1999)
66		AHC RNE Listings (2)	AHC RNE Listings (2)	AHC RNE Listings (2)
67		Min for Planning(1995) DRRP1	Min for Planning(1995) DRRP1	Min for Planning(1995) DRRP1
68		Min for Planning(1995) DRRP2	Min for Planning(1995) DRRP2	Min for Planning(1995) DRRP2
69		Government of WA (2000) Bush Fore	G of WA(2000) Bush Forever	G of WA(2000) Bush Forever
70		DIA(2002) Sites Listing	DIA(2002) Sites Listing	DIA(2002) Sites Listing
71			A Line on Kalamunda	Scowder (1983)
72				State Heritage Council (2002)
73				
74				
75				
76	Prominent Associated Persons			
77				
78		Midgegooroo Nyungar leader warrior & elder, May 1833	Midgegooroo	Midgegooroo
79			Dale	Dale
80		Munday, Jobbych	Munday, Jobbych	Munday, Jobbych
81		Johnash Seabrook	Train Crash Victims (2)1904	Noc Wester
82	Statements of Significance			
83	A.1	See Register of Nat Estate Listing		A.1 Important archeological site
84	A.2			A.2 Natural Coastal & Scarp Catchment of H
85	A.3			A.3 Turles, his habitat
86	A.4			A.4 Cultural Significance Mundalinga Myth
87	A.5			A.5 Midgegooroo capture 1833
88	B.1			B.1 Conservation category wetland, braided
89	B.2			B.2 Example of Colonial Farm Heritage
90	B.3			B.3 Representative undisturbed Catchment
91	B.4			B.4 1904 fatal crash site
92	B.5			B.5 Archaeological Site 25450 years
93	B.6			B.6 Archeological Site 25450 years
94	B.7			B.7 Archeological Site 25450 years
95	B.8			B.8 Archeological Site 25450 years
96	B.9			B.9 Archeological Site 25450 years
97	B.10			B.10 Archeological Site 25450 years
98	B.11			B.11 Archeological Site 25450 years
99	B.12			B.12 Archeological Site 25450 years
100		Major natural and cultural significant area	Major Heritage corridor, Major substantial habitat and cultural link from Belle View to Bushmead from turtle to black snake area	Mundalinga Main Run, Priceless European Heritage Farm Landscape Belle View House
101		Many Aboriginal Sites	Aboriginal Sites	Many Aboriginal Sites
102				Adjacent to Schweder(1983)
103				Archaeological site 29,400 yrs
104				Potential for Heritage Pavilion for preservation of Nyungar heritage
105				Darling Range Regional Park, Zoned Parks & Recreation
106				Confluence with Kadina Brook Midgegooroo association
107				
108				
109				
110				
111				
112				
113				

	A	E	F	G	H	I	J
1	Identification	Midgegooroo Precinct 4	Midgegooroo Precinct 5	Midgegooroo Precinct 6	Midgegooroo Precinct 7	Midgegooroo Precinct 8	Midgegooroo Precinct 9
2	Current Name	Bellevue Primary School	Hawk Valley Bushland	Roe Highway Verge	Quenda Creek/Kadina Brook Reserve	Gooseberry Hill National Park	Maida Vale Reserve
3	Other Name	Potential Bellevue Heritage Centre	Regional Open Space plus	Midgegooroo Greenway	Kabonmooche (Nyungar)/Gooseberry	Zigzag	Jijoonza (Nyungar)
4	Other Name		Perth Greenway 50, 112	29400 Year Burrows site Schwedel (1983)	System 6 Area M34	System 6 Area M34	Bushforever site 316
5	Other Name		Perth Bushforever Site 123 plus	Roe Highway Greenway No 50	Bush Forever Site 466		Ridgetop Rd Greenway 113
6	Other Name	Potential Dering Range Reg Park	Perth Greenway 50, 112	Midgegooroo Greenway	Dering Range Regional Park	Dering Range Regional Park	Dering Range Regional Park
7	Approximate Area	1 Ha	20Ha plus	10Km x 100m	150Ha	100Ha	20Ha
8	Access	Clayton Rd	Bellevue	Bellevue	Gooseberry Hill Rd/Ridge#4 Rd	Loscelles Parade/Ridge Hill Rd	Ridge Hill Rd
9	Town	Bellevue	Bellevue	Bellevue	Gooseberry Hill	Gooseberry Hill	Maida Vale
10	State	WA	WA	WA	WA	WA	WA
11	Nearest Town	Bellevue	High Wycombe	Bellevue to Goswatts	Kalamunda	Gooseberry Hill	Maida Vale
12	Distance	0m	2Km	0.0	500m	2Km	110m
13	Direction	S	S	S	S	N	W
14	LGA	Swan	Kalamunda	Swan	Kalamunda	Kalamunda	Kalamunda
15	Property & Boundary	Whole Site	Bush F. Site plus more	Bellevue to Goswatts Corridor including water verges where possible	DRRP + Kadina Broomer Brook reserve	part DRRP + Nat Park	Reserve and Primary School bushland
17	Nominator	Helena River Catchment Group	Helena River Catchment Group	Helena River Catchment Group	Helena River Catchment Group	Helena River Catchment Group	Helena River Catchment Group
18	Address	C/ Po Box 20 Mundaring	C/ Po Box 20 Mundaring	C/ Po Box 20 Mundaring	C/ Po Box 20 Mundaring	C/ Po Box 20 Mundaring	C/ Po Box 20 Mundaring
19	Suburb	Mundaring	Mundaring	Mundaring	Mundaring	Mundaring	Mundaring
20	Signature	Yes	Yes	Yes	Yes	Yes	Yes
21	Nominator Disclosed	No	No	No	No	No	No
22	Owners	Ed Department	ROS	Main Roads Department	CALM, LGA	CALM	Kalamunda Shire/Ed Dept
23	Admin Cat		9983, 9983, 9952		9983, 9983/9956	9983	9955
24	Previous Heritage Assessments	State Heritage Council Listed Schwedel (1983) Archaeological Site	Perth Bushforever Site	Extreme High Diversity		AHC RNE Listed	
25	AURPGSR-9182	29400 years of occupation adjacent					
26							
27							
28							
29							
30							
31							
32							
33							
34							
35							
36							
37	Place description	Perth Greenway Listed	Perth Greenway Listed 50, 112	Perth Greenway Listed No 50	Perth Greenway 101, 112, Kadina Greenway	Perth Greenway Listed, 25, 112, 113, Stunning views over Bushmead	Perth Greenway Listed, Rare plants, High diversity
38		State Heritage - Bellevue Primary School	Rare plants - High diversity	Archaeological site	Gooseberry Hill ROS	High diversity ref Hussey	Rare plants, High diversity
39		Creek/Stream	Quenda	Bushmead Beebler Link	Stunning views		
40		Bushmead Bellevue Link		Potential for heritage trail	Quenda, Grey kangaroo, Mardo		
41		Potential for heritage center			Epikma, Bush rat		
42		Daler (1929) Heritage Route					
43		Near Railway Bridge fatal crash 1904					
44		Aboriginal sites	Aboriginal Sites	Aboriginal sites	High diversity	Aboriginal sites	
45		Aboriginal mythological link		Aboriginal European History link	Railway track	Railway track	
46		Turtle-back snake-quenda	Little Eagle or eaglehawk mytilis	Aboriginal Heritage Mundana Link			
47		Kadina brook Greenway	Wairi & Manleh	Greenway			
48	Condition and Integrity	As whole unit priceless	Wairi & Woodring	As whole unit priceless			
49		Braided creek in wetland		Bushland very good in parts			
50		Previously grazed		Some previously cleared			
51		One house, paddocks					
52		Superbly positioned for heritage centre		Superbly positioned near heritage centre			
53		Adjacent to good sized oval		Adjacent to Belle View			
54		Core of Mundagina Main Run		Core and link to Mundagina Main Run			
55	Sources of Further Inform						
56		HGM, 1991 Bushmead EIA	HGM, 1991 Bushmead EIA	HGM, 1991 Bushmead EIA	HGM, 1991 Bushmead EIA	HGM, 1991 Bushmead EIA	HGM, 1991 Bushmead EIA
57		HGM, 1992 EIA SUP	HGM, 1992 EIA SUP	HGM, 1992 EIA SUP	HGM, 1992 EIA SUP	HGM, 1992 EIA SUP	HGM, 1992 EIA SUP
58		Bates (various) in Bridge (1992)	Bates (various) in Bridge (1992)	Bates (various) in Bridge (1992)	Bates (various) in Bridge (1992)	Bates (various) in Bridge (1992)	Bates (various) in Bridge (1992)
59		Green (1984) Broken Spears	Green (1984) Broken Spears	Green (1984) Broken Spears	Green (1984) Broken Spears	Green (1984) Broken Spears	Green (1984) Broken Spears
60		Green (1979) Nyungar The People	Green (1979) Nyungar The People	Green (1979) Nyungar The People	Green (1979) Nyungar The People	Green (1979) Nyungar The People	Green (1979) Nyungar The People
61		DCE (1983) Systems	DCE (1983) Systems	DCE (1983) Systems	DCE (1983) Systems	DCE (1983) Systems	DCE (1983) Systems
62		Friends of Quenda Creek (1998)	Friends of Quenda Creek (1998)	Friends of Quenda Creek (1998)	Friends of Quenda Creek (1998)	Friends of Quenda Creek (1998)	Friends of Quenda Creek (1998)
63		Brooker (2001)	Brooker (2001)	Brooker (2001)	Brooker (2001)	Brooker (2001)	Brooker (2001)
64		Alan Tingay & Assoc (1998)	Alan Tingay & Assoc (1998)	Alan Tingay & Assoc (1998)	Alan Tingay & Assoc (1998)	Alan Tingay & Assoc (1998)	Alan Tingay & Assoc (1998)
65		Hil et al (1996)	Hil et al (1996)	Hil et al (1996)	Hil et al (1996)	Hil et al (1996)	Hil et al (1996)
66		AHC RNE Listings (2)	AHC RNE Listings (2)	AHC RNE Listings (2)	AHC RNE Listings (2)	AHC RNE Listings (2)	AHC RNE Listings (2)
67		Min for Planning (1995) DRRP1	Min for Planning (1995) DRRP1	Min for Planning (1995) DRRP1	Min for Planning (1995) DRRP1	Min for Planning (1995) DRRP1	Min for Planning (1995) DRRP1
68		Min for Planning (1995) DRRP2	Min for Planning (1995) DRRP2	Min for Planning (1995) DRRP2	Min for Planning (1995) DRRP2	Min for Planning (1995) DRRP2	Min for Planning (1995) DRRP2
69		G of WA (2000) Bush Forever	G of WA (2000) Bush Forever	G of WA (2000) Bush Forever	G of WA (2000) Bush Forever	G of WA (2000) Bush Forever	G of WA (2000) Bush Forever
70		DIA (2002) Sites Listing	DIA (2002) Sites Listing	DIA (2002) Sites Listing	DIA (2002) Sites Listing	DIA (2002) Sites Listing	DIA (2002) Sites Listing
71		Boushford (2002) History of Swan		Swedel (1983)	King AAC (1945) Australia Holiday	Monansari (1961)	Monansari (1961)
72		State Heritage Council (2002)	Shire of Kalamunda (1996) DCS	Shire of Kalamunda (1996) DCS	Shire of Kalamunda (1996) DCS	Shire of Kalamunda (1996) DCS	Shire of Kalamunda (1996) DCS
73			Shire of Kalamunda (1998) WCS	Shire of Kalamunda (1998) WCS	Shire of Kalamunda (1998) WCS	Shire of Kalamunda (1998) WCS	Shire of Kalamunda (1998) WCS
74					Brown (1976) A Line on Kalamunda	A Line on Kalamunda	
75					Murdoch W (1948) My Bushfire		
76	Prominent Associated Per						
77							
78		Midgegooroo	Midgegooroo	Midgegooroo	Midgegooroo, Munday	Midgegooroo	Midgegooroo
79					Water Murdoch, HC Coombes	Seventy, HC Coombes	
80		Munday, Joobytch	Munday, Joobytch	Munday, Joobytch	Calhorne King, Joobytch, Goolaklan	Munday, Joobytch	Munday, Joobytch
81		Joanna Seabrook OA					
82	Statement of Significance						
83	A.1.						
84	A.2.						
85	A.3.						
86	A.4.						
87	A.5.						
88	B.1.						
89	B.2.						
90	B.3.						
91	C.1.						
92	C.2.						
93	D.1.						
94	D.2.						
95	E.1.						
96	F.1.						
97	G.1.						
98	H.1.						
99							
100		Adjacent to Belle View	Aboriginal sites	Midgegooroo - Beebler link	Marshall 1888	Very high diversity	
101		Historic significance	Many Eagles	Perth regional greenway		Eagle mythology	
102		Heritage listed	Best bushland on SCP	Wildlife Corridor		Wildlife Corridor	
103		Adjacent to Helena River	Rare species			Views over bushmead	
104		Core of Mundagina	Edge mythology				
105		Major potential for Heritage centre	Bushforever Site				
106							
107							
108							
109							
110							
111							
112							
113							



	A	B	C	D	
1	Identification				
2	Identification				
3	Current Name	Mundjalina Heritage Precinct 21	21	Mundjalina Heritage Precinct 22	22
4	Other Name	Upper Helena		Lower Helena	Munday Heritage Precinct 31
5	Other Name	Balladong Creation Story		Balladong Creation Story	C 21172, Canning Mills
6	Other Name	Booroloy-Sourca, booroloy rock		Garvey Park- Bebo- Booroloy	Camping Ground
7	Other Name	State Forest		Darling Range National Park	Beeloo Park (proposed)
8	Approximate Area	Helena River Catchment			Munday Brook
9	Address	Mundaring Weir Catchment			Victoria Reservoir Catchment
10	Town	Mundaring Weir Rd		Wilkins St/ Catherine St	40Ha
11	State	Mundaring		Helena Valley	Canning Rd, Canning Mills
12	Nearest Town	WA		WA	Cermel
13	Distance	Mundaring Weir			WA
14	Direction	200m			Kangullen
15	LGA	E			1Km
16	Property & Boundary	Mundaring			N
17					Kalamunda
18	Nominator				State Forrest
19	Address	Helena River Catchment Group			Near Orchards
20	Suburb	C/- Po Box 20 Mundaring		Helena River Catchment Group	Helena River Catchment Group
21	Signature	Mundaring		Mundaring	C/- Po Box 20 Mundaring
22	Nominator Disclosed	Yes		Yes	Mundaring
23		No		No	Yes
24	Owners				No
25		Water Corporation		Water Corporation	
26	Admin Cat	State Forest		Darling Range Regional Park	Water Corporation
27					
28	Previous Heritage				
29	Assessments	Nyungar teaching area		Nyungar teaching area	
30	AURPGSR-5182	See McIntyre & Dodson (1999)		See McIntyre & Dodson (1999)	System 6 Site M79
31					Perth Greenway
32		Bushland high significance		Bushland high significance	
33					
34					
35					
36					
37					
38	Place description				
39					One of the most important heritage sites in WA
40					Currently virtually unknown
41					Site expected to be that of village
42					described by TB Wilson in October
43					1829
44					Railway Track
45					Black Cockatoos
46					Munday's village
47	Condition and Integrity				
48					Pristine
49					Spiritual Place
50					Possible Future Nyungar Healing Place
51					
52					
53					
54					
55					
56	Sources of Further Information				
57					Wilson TB (1835) Narrative of a Voyage round the
58					Beeloo Village October 1829 70 people
59					Green (1984) Broken Spears - Site of Punitive Exp
60					Breaking of hunters spears, destruction of gather
61					Noble speech in defence by Lyons
62					Subsequently ignored, isolated Lyons
63					Green (1984)
64					No acknowledgement of Nyungars
65					on plaques at Victoria dam
66					To be rectified
67					
68					
69					
70					
71					
72					
73					
74					
75					
76					
77	Prominent Associated Persons				
78					Munday, Yagan?, TB Wilson, er
79					Bannister
80					
81					
82	Statement of Significance				
83					
84					
85					Major State and National Significance

	A	E	F	G
1	Identification			
2	Identification	Munday Heritage Precinct 32	32	33
3	Current Name	Railway Track G Hill -Carmel	Munday Heritage Precinct 33	Munday Heritage Precinct 34
4	Other Name	Kalamunda National Park	Dixon Rd Reserve	Kalamunda National Park
5	Other Name	Piesse Brook Reserves	Opposite History Village	System 6 Area M34, Bibblumun Track
6	Other Name	Schipp Rd Reserves	Location of future Nyungar	Jerguson Park & Schipp Rd Reserves
7	Other Name	Darling Range Regional Park	Monument	Darling Range Regional Park
8	Approximate Area		Add to DRRP?	Helena Pipehead Catchment
9	Address			1000Ha
10	Town	Hummerston Rd	Dixon Rd	Schipp Rd Kalamunda
11	State	Kalamunda	Kalamunda	Piesse Brook
12	Nearest Town	WA	WA	WA
13	Distance	Kalamunda	Kalamunda	Kalamunda
14	Direction	1Km	100m	50m
15	LGA	E	N	E
16	Property & Boundary	Kalamunda	Kalamunda	Kalamunda
17		Darling Range Regional Park	Native Title Claim	Darling Range Regional Park
18	Nominator	Helena River Catchment Group	Helena River Catchment Group	Helena River Catchment Group
19	Address	C/- Po Box 20 Mundaring	C/- Po Box 20 Mundaring	C/- Po Box 20 Mundaring
20	Suburb	Mundaring	Mundaring	Mundaring
21	Signature	Yes	Yes	Yes
22	Nominator Disclosed	No	No	No
23	Owners	CALM, LGA, MRPA	DOLA, Homeswest	CALM, Min for Planning, Shire of Kalamunda
24		Kalamunda		
25	Admin Cat			
26	Previous Heritage	System 6 Area M34 (part)	Nyungar teaching area	System 6 Site M34
27	Assessments		See McIntyre & Dobson (1989)	Perth Greenway
28	AURPGSR-5182		Native Title Claim	Register of National Estate
29			Bushland high significance	
30	Place description			
31				
32				
33				
34				
35				
36				
37				
38				
39				
40				
41				
42				
43				
44				
45				
46				
47				
48	Condition and Integrity			
49				
50				
51				
52				
53				
54				
55				
56	Sources of Further Information	World	McIntyre & Dodson (1989)	Wilson TB (1835) Narrative of a Voyage round the
57			Wildflower Society submission to	Beeloo Village October 1829 70 people
58			Perth Bushplan (1988)	
59			Kalamunda Historic Society	
60				
61				
62				
63				
64				
65				
66				
67				
68				
69				
70				
71				
72				
73				
74				
75				
76				
77	Prominent Associated Persons			
78				
79				
80				
81				
82	Statement of Significance			
83				
84				
85				

Major State and National Significance

	A	H	I	J
1	Identification			
2	Identification		35	
3	Current Name	Munday Heritage Precinct 35	Munday Heritage Precinct 36	36
4	Other Name	Reserve 22865	Reserve 20641	Munday Heritage Precinct 37
5	Other Name	System 6 Area M77	System 6 Area M77	Reserve C10001
6	Other Name	Bannister Park (proposed)	Wilson Park (proposed)	System 6 Area M78
7	Other Name	Darling Range Regional Park	Darling Range Regional Park	Ngilgee Park (proposed)
8	Approximate Area	Helena Pipehead Catchment	Helena Pipehead Catchment	Darling Range Regional Park
9	Address	50 ha	50 Ha	Bickley Brook Pipehead Catchment
10	Town	Mundaring Weir Rd	Mitchel Rd	40Ha
11	State	Kalamunda	Kalamunda	Canuing Rd
12	Nearest Town	WA	Bickley	Carmel
13	Distance	Kalamunda	WA	WA
14	Direction	1km	Kalamunda	Kalamunda
15	LGA	SE	1km	3Km
16	Property & Boundary	Kalamunda	SE	SE
17		Darling Range Regional Park	Kalamunda	Kalamunda
18	Nominator		Darling Range Regional Park	Darling Range Regional Park
19	Address	Helena River Catchment Group	Helena River Catchment Group	Helena River Catchment Group
20	Suburb	C/- Po Box 20 Mundaring	C/- Po Box 20 Mundaring	C/- Po Box 20 Mundaring
21	Signature	Mundaring	Mundaring	Mundaring
22	Nominator Disclosed	Yes	Yes	Yes
23		No	No	No
24	Owners			
25		Water Corporation	Water Corporation	Water Corporation
26				
27	Admin Cat			
28				
29	Previous Heritage Assessments			
30		System 6 Site M77	System 6 Site M77	System 6 Site M78
31	AURPGSR-5182	Darling Range Regional Park Register of National Estate	Darling Range Regional Park Register of National Estate	Darling Range Regional Park Register of National Estate
32				
33				
34				
35				
36				
37				
38	Place description			
39		An important heritage site in WA	An important heritage site in WA	Animal loving traditional Nyungar lady Ngilgee
40		Currently virtually unknown	Currently virtually unknown	Lived at Maamba
41		Site expected to be that visited by T Wilson	Site expected to be that visited by T Wilson	Walked away to hills reserves to successfully evade attempts to kill her dogs
42		described by TB Wilson in October 1829	described by TB Wilson in October 1829	
43		in company of men from Munday's tribe	in company of men from Munday's tribe	
44				
45		Wonderful description by Wilson (1835)	Wonderful description by Wilson (1835)	Very good profile and photographs by Daisy Bates
46		Reconciliation site - proposed Name	Reconciliation site - proposed name	Reconciliation site proposed name
47				
48	Condition and Integrity			
49		Companion of Wilson, Explorer of SW	Thomas Braidwood Wilson was founding father of Braidwood NSW, respected man	
50				
51				
52				
53				
54				
55				
56	Sources of Further Information			Bates(1908) in Bridge (1992) Aboriginal Perth p1
57		Wilson TB (1835) Narrative of a Voyage round the Beefoo Village October 1829 70 people	Wilson TB (1835) Narrative of a Voyage round the Beefoo Village October 1829 70 people	Wilson TB (1835) Narrative of a Voyage round the
58				
59				
60				
61				
62				
63		No acknowledgement of Nyungars	No acknowledgement of Nyungars	No acknowledgement of Nyungars
64				
65		To be rectified	To be rectified	To be rectified
66				
67				
68				
69				
70				
71				
72				
73				
74				
75				
76				
77	Prominent Associated Persons			
78		Munday, Yagan?, TB Wilson, er	Munday, Yagan?, TB Wilson, er	Ngilgees, Joobyact, Munday, Munday's family names in census 1855
79		Bannister	Bannister	
80				
81				
82	Statement of Significance			
83				
84				
85		Major State and National Significance	Major State and National Significance	Major State and National Significance

	A	K	L	M
1	Identification			
2	Identification		41	42
3	Current Name	Joobyich Heritage Precinct 41	Joobyich Heritage Precinct 42	Joobyich Heritage Precinct 43
4	Other Name	Lesmurdie Region Open Space	Brixton St Reserve	Tonkin Highway Road verge
5	Other Name	Lesmurdie Falls Nat Park	Kenwick Swamp	
6	Other Name			
7	Other Name	Darling Range Reg Park		Perth Greenway
8	Approximate Area	1000Ha	200Ha	50Ha
9	Address	Kalamunda Rd. Gosnell	Brixton St	Kalamunda Rd. Gosnell
10	Town	Kalamunda		Kalamunda
11	State	WA		WA
12	Nearest Town	Kalamunda		Kalamunda
13	Distance	500m		500m
14	Direction	W		W
15	LGA	Kalamunda, Gosnell		Kalamunda, Gosnell
16	Property & Boundary	Darling Range Regional park		Darling Range Regional park
17	Nominator	Helena River Catchment Group	Helena River Catchment Group	Helena River Catchment Group
18	Address	C/- Po Box 20 Mundaring	C/- Po Box 20 Mundaring	C/- Po Box 20 Mundaring
19	Suburb	Mundaring		Mundaring
20	Signature	Yes	Yes	Yes
21	Nominator Disclosed	No		No
22	Owners	CALM Water Corp, MRPA		CALM Water Corp, MRPA
23	Admin Cat	Kalamunda, Gosnell		Kalamunda, Gosnell
24	Previous Heritage			
25	Assessments	System 6 site	System 6 Site M09	System 6 site
26	AURPOSSR-5182	Bushforever Site	Bush Forever Site	Bushforever Site
27		Perth Greenways	Perth Greenways	Perth Greenways
28				
29	Place description	Darling Scarp	Nationally important wetland	Darling Scarp
30		Site of Munday's campfires		Site of Munday's campfires
31		Kala Mundar		Kala Mundar
32		Sites where Joobyich hunted		Sites where Joobyich hunted
33		Sites where Joobyich shared Nyungar names with Daisy Bates		Sites where Joobyich shared Nyungar names with Daisy Bates
34				
35				
36				
37				
38	Condition and Integrity	Very Good	Excellent	Very Good
39		Subject to restoration, weed control		Subject to restoration, weed control
40				
41				
42				
43				
44				
45				
46				
47				
48	Sources of Further Information	System 6	Bates (1923) Policeman Joobyich	System 6
49		Darling Range Regional Park Reports		Darling Range Regional Park Reports
50		Marshall (1988)	Government of WA (2000) Perth Bush Forever	Marshall (1988)
51		Marshall (1988)		Marshall (1988)
52		Bates(1922) in Bridge(1992)		Bates(1922) in Bridge(1992)
53				
54		Majer (1987) Scarp conference		Majer (1987) Scarp conference
55		Armstrong(1993)		Armstrong(1993)
56		Shire		Shire
57				
58				
59				
60				
61				
62				
63				
64				
65				
66				
67				
68				
69				
70				
71				
72				
73				
74				
75				
76				
77	Prominent Associated Persons		Joobyich	
78				
79				
80				
81				
82	Statement of Significance	Regional Significance	Wetland of State /National importance	Regional Significance
83				
84				
85				

	A	N	O	P
1	Identification			
2	Identification		44	45
3	Current Name	Joobytch Heritage Precinct 44	Joobytch Heritage Precinct 45	Joobytch Heritage Precinct 46
4	Other Name	Reserve C28860	Poison Gulley Reserves	Munday Swamp (part)
5	Other Name	Forrestfield Damplands		Olite Worrell Reserve Part
6	Other Name			High Wycombe Wetlands
7	Other Name	Wetland Conservation, Perth Greenways		
8	Approximate Area	Bush Forever Sites Shire Wildlife Corridor	Bush Forever Sites Shire Wildlife Corridor	
9	Address	100 Ha	40 Ha	1000Ha
10	Town	Tonkin / Roe Highways	Maida Vale Rd	Abermethy Rd
11	State	Kalamunda	Kalamunda	Kalamunda
12	Nearest Town	WA	WA	WA
13	Distance	Forrestfield	High Wycombe/Maida Vale Rd	Kalamunda
14	Direction	500m	500m	500m
15	LGA	W	S	W
16	Property & Boundary	Kalamunda	Maida Vale Rd	Abermethy Rd
17		Main Roads Dept	Shire of Kalamunda	Extend area of constructed wetland
18	Nominator	Helena River Catchment Group	Helena River Catchment Group	Helena River Catchment Group
19	Address	C/- Po Box 20 Mundaring	C/- Po Box 20 Mundaring	C/- Po Box 20 Mundaring
20	Suburb	Mundaring	Mundaring	Mundaring
21	Signature	Yes	Yes	Yes
22	Nominator Disclosed	No	No	No
23	Owners	Main Roads Department	CALM, Water Corp, MRPA	Water Corp, Shire of Kalamunda
24		Kalamunda	Kalamunda	Kalamunda
25	Admin Cat			
26	Previous Heritage			
27	Assessments	System 6 site		
28	AURPGSR 6182	Bushforever Site	Bushforever Site	Wetland and Main Drain
29		Perth Greenways	Perth Greenways	Aboriginal Site
30		Wetlands, Cons Cat & Resource Enhance Cat	Aboriginal Site	Perth Greenways
31				
32				
33				
34				
35				
36				
37				
38	Place description			
39		Darling Scarp	Darling Scarp	Darling Scarp
40		Kala Munday	Kala Munday	Kala Munday
41		Sites where Joobytch hunted	Sites where Joobytch hunted	Sites where Joobytch hunted
42		Sites where Joobytch shared Nyungar names with Daisy Bates	Sites where Joobytch shared Nyungar names with Daisy Bates	Sites where Joobytch shared Nyungar names with Daisy Bates
43				
44				
45				
46				
47				
48	Condition and Integrity	Very Good	Very Good	Very Good
49		Subject to restoration, weed control	Subject to restoration, weed control	Subject to restoration, weed control
50				
51				
52				
53				
54				
55				
56	Sources of Further Information	System 6	System 6	System 6
57		Darling Range Regional Park Reports	Darling Range Regional Park Reports	Darling Range Regional Park Reports
58				
59				
60		Marshall (1988)	Marshall (1988)	Marshall (1988)
61		Marshall (1999)	Marshall (1999)	Marshall (1999)
62		Bates (1922) in Bridge (1992)	Bates (1922) in Bridge (1992)	Bates (1922) in Bridge (1992)
63				
64				
65		Majer (1987) Scarp conference	Majer (1987) Scarp conference	Majer (1987) Scarp conference
66		Armstrong (1993)	Armstrong (1993)	Armstrong (1993)
67		Shire	Shire	Shire
68				
69				
70				
71				
72				
73				
74				
75				
76				
77	Prominent Associated Persons			
78				
79				
80				
81				
82	Statement of Significance	Regional Significance	Regional Significance	Regional Significance
83				
84				
85				

	A	Q	R	S
1	Identification			
2	Identification		47	
3	Current Name	Joobyth Heritage Precinct 47	Joobyth Heritage Precinct 48	48
4	Other Name	Lesmurdie Reserves	Canning River Forshore	5
5	Other Name	Lesmurdie Creeks	System 6 Area M76	
6	Other Name			
7	Other Name	Wildlife Corridor Strategy	Perth Greenways	
8	Approximate Area			
9	Address	30 Ha	20 Ha	
10	Town	Welshpool Rd	Alban Hwy / Mills Rd	150 Ha
11	State	Kalamunda	Gosnells	Hartfield Rd
12	Nearest Town	WA	WA	Forrestfield
13	Distance	Kalamunda	Gosnells	WA
14	Direction	500m	50m	Forrestfield
15	LGA	W	N	200m
16	Property & Boundary	Welshpool Rd	Albany Highway/ Mills Rd	SW
17		Perth Bushplan	Perth Bushplan	Kalamunda
18	Nominator	Wildlife Corridor Strategy		Divided by
19	Address	Helena River Catchment Group	Helena River Catchment Group	Tonkin Hwy
20	Suburb	Cf. Po Box 20 Mundaring	Cf. Po Box 20 Mundaring	Helena River Catchment Group
21	Signature	Mundaring	Mundaring	Cf. Po Box 20 Mundaring
22	Nominator Disclosed	Yes	Yes	Mundaring
23		No	No	Yes
24	Owners			No
25		CALM, Water Corp, MRPA	Shire of Gosnells	Shire of Kalamunda Reserve
26		Kalamunda	Gosnells	
27	Admin Cat			
28				
29	Previous Heritage			
30	Assessments		System 6 Site 75	System 6
31	AURPGSR-5182	Bushforever Site	Bushforever Site	Bushforever Site
32		Perth Greenways	Perth Greenways	Perth Greenways
33		Wildlife Corridor		
34				
35				
36				
37				
38	Place description			
39		Darling Scarp	Southern Boundary of Kallioop Munday	Very important reserve
40				Established by Premier John
41		Kala Munday	Kala Munday	Forrest for Nyungar people
42		Sites where Joobyth hunted	Sites where Joobyth hunted	Balbak & other
43		Sites where Joobyth shared Nyungar names with Daisy Bates	Sites where Joobyth shared Nyungar names with Daisy Bates	Nyungar people
44				66 Joobyth
45				Niplies
46				
47				
48	Condition and Integrity	Very Good	Very Good	Bushforever Site
49		Subject to restoration, weed control	Subject to restoration, weed control	Conservation Category Wetland
50				Beautiful Bushland continually
51				under threat for sport facilities
52				Federation Gardens Sculpture
53				
54				
55				
56	Sources of Further Information			
57		Darling Range Regional Park Reports	Darling Range Regional Park Reports	Government of WA (2000) Perth Bush Forever
58				Hill et al (1996) Wetlands Atlas
59				Kalamunda Shire Council (1997) Hartfield Park M
60		Marshall (1988)	Marshall (1988)	Bates D (1922) in Bridge (1992) Aboriginal Perth
61		Marshall (1992)	Marshall (1992)	Bates (numerous) in Bridge (1992) Aboriginal Perth
62		Bates (1922) in Bridge (1992)	Bates (1922) in Bridge (1992)	Site of Corrobory described by
63				Bates (numerous) in Bridge (1992) photographs
64		Mayer (1987) Scarp conference	Mayer (1987) Scarp conference	
65		Armstrong (1993)	Armstrong (1993)	
66		Shire	Shire	
67				
68				
69				
70				
71				
72				
73				
74				
75				
76				
77	Prominent Associated Persons			Munday, Joobyth, Balbak
78				Bates, John Forrest
79				
80				
81				
82	Statement of Significance	Regional Significance	Regional Significance	Major State and National Significance
83				Where the passing of the Biblumun tribe was
84				written
85				

With Compliments

Department of Environmental Protection

Westralia Square

141 St George's Terrace, Perth

Western Australia 6000

Telephone (09) 222 7000

Facsimile (09) 322 1598

Stuart 28/6/01  
The information we  
discussed on Flooded Gum and  
Wandoo is attached.  
Cheero Bronwin Keigley

# Leaf & Branch

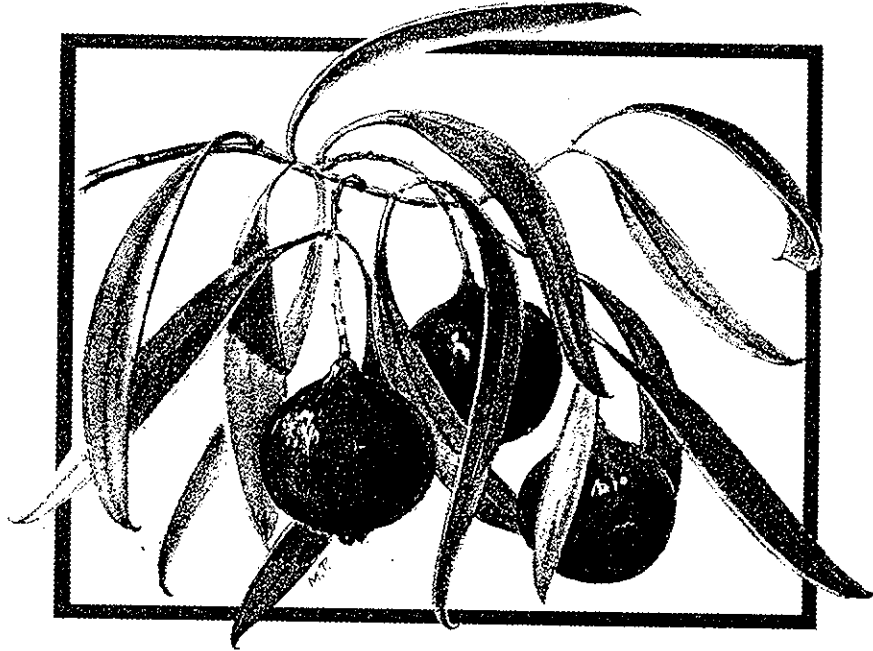

TREES AND TALL SHRUBS OF PERTH

ROBERT POWELL

Illustrated by  
Margaret Pieroni  
and Susan Patrick



**RECORD OF DISCUSSION**

Meeting

Telephone  
Conversation

Other  
Discussion

Project name: ~~BUSHPLAN~~ Bush Forever  
Date: 4 April 2001 Time:

File Number:  
805/2/1/40 P215

Between: Sam Stokes of the Ministry for Planning Bush forever Office  
and: Stuart Fellows of <sup>2565 or</sup> lot 2 Helen Valley Telephone: 9255 2467  
Other participants: N/A Helen Valley

Record of Discussion:

Creekline was diverted 35 years ago and not near property. Large Reservoir on adjoining land  
Only 3 big trees on property, although he has recently planted 100 seedlings  
~~He~~ Appreciates what Bush Forever is trying to achieve, but wants Bush Forever removed from his property

\*\* Site Visit? 26/6/2001 (10am) BJ Keighan  
Met with Stuart F. with H. Colliver (MPP) and Cathy Walker (WRRC).  
Miscellaneous tending about location of the BF S area. Fully 'vegetated' with E. redis (actual area) - old flood plain  
Fenced but grazed by horses 'thinning' E. redis.

DEPARTMENT OF ENVIRONMENTAL PROTECTION RECORDS SECTION  
FILE NO \_\_\_\_\_  
NAME \_\_\_\_\_  
FILE NO \_\_\_\_\_  
NAME Karen Clarke

Discussed restoration / reveg. Sent Ericidis & Ewendso pages from 'heat and branch'. Cathy to send Catchment Info MO

Follow up action: Site Visit  
By whom: Bush forever Office  
When: ASAP - discuss time at coord group Tues 10/4/01 and phone Stuart  
Signed: [Signature]

Watsonia being controlled. NO  
understorey. Single sedge alongside  
'dam' (within 13m contour).

Mostly *E. rudis* only, small amount  
of *Mel rhex* towards river bed (fenced  
from property).

Land owner happy with  
situation.

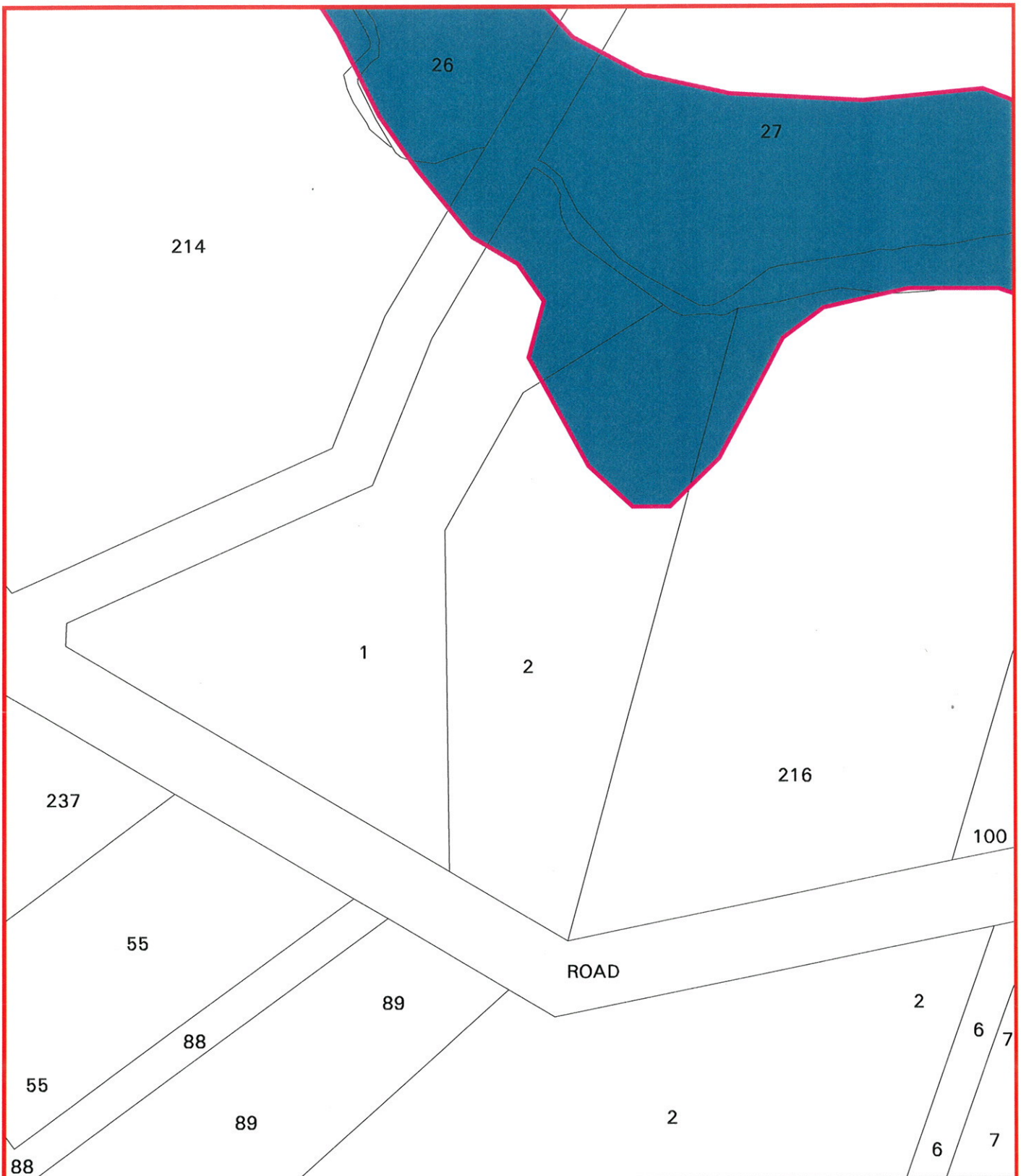

**Bush Forever Site 215**  
**Lot 2 Helena Valley Road**  
**Helena Valley**  
**Not for Distribution**

-  Cadastre with Lot Numbers
-  Bush Forever Sites - Boundaries
-  Swan Complex

**MFP INTERNAL USE ONLY**

Prepared By: Huia Colliver

Prepared For:

Map Ident: plot010528\_1

Date: 28 May 2001

Scale 1:2244

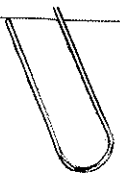

271

REF TO MAP: SITE NOT LISTED IN

SITE CROSS REFERENCE

BUSHPLAN SITES CORRECTED

B 18 22/10/98



WESTERN AUSTRALIAN PLANNING COMMISSION



CUSTOMER FOCUS WESTERN AUSTRALIA

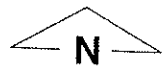

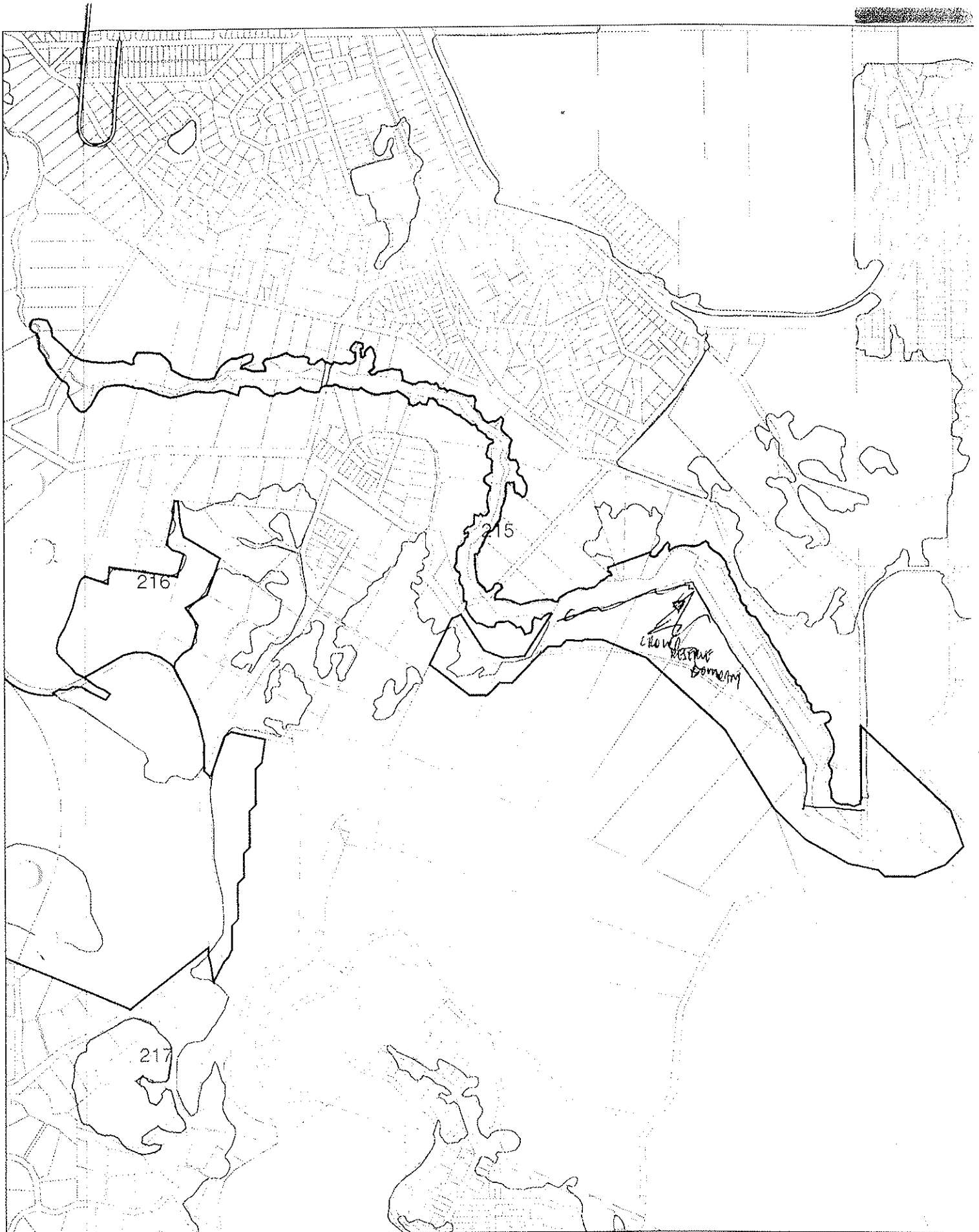

**BUSHPLAN SITES CORRECTED**

*B 27/10/76*



**WESTERN  
AUSTRALIAN  
PLANNING  
COMMISSION**



**CUSTOMER  
FOCUS  
WESTERN AUSTRALIA**



## BE A CATCHMENT CARER TOO!

The Helena River Catchment needs  
your help.

### YOU CAN .....

- Protect bushland and creeks on your property
- Grow native plants on creek banks and in your garden
- Protect wildlife—eg. bell your cat!
- Adopt a bushland reserve near you
- Use slow release fertilisers
- Don't dump garden waste in the bush—use authorised tip sites
- Always use marked trails
- Enjoy the natural environment

SMALL actions can have a BIG effect.

## CONTACT THE GROUP

To find out more about the group  
please call:

**LINDA RAYNOR**

*Catchment Landcare Officer*

Tel: (08) 9290 6675

[lindaraynor@mundaring.wa.gov.au](mailto:lindaraynor@mundaring.wa.gov.au)

TO THE LANDHOLDER

*This brochure is proudly sponsored by the*



**Help Keep Our Rivers Healthy**

## HELENA RIVER CATCHMENT GROUP Inc.

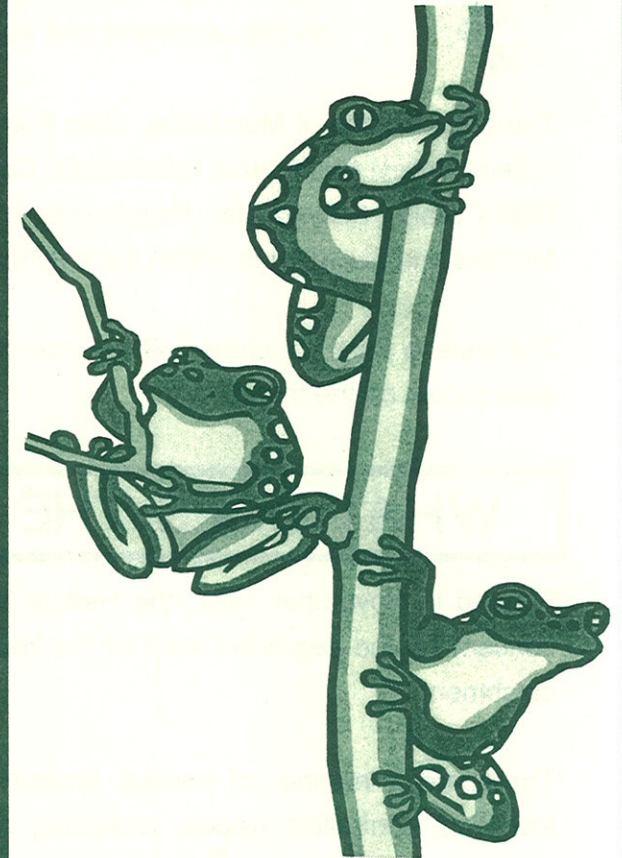

**A COMMUNITY GROUP  
CARING FOR YOUR  
CATCHMENT**

## WHERE IS THE HELENA RIVER CATCHMENT?



The Helena River Catchment is divided into three separate catchments (Upper, Middle and Lower), mainly because of its size, but also because of the impacts of the major dams (Mundaring Weir and Lower Helena Pipehead) on the catchment and waterways.

The communities of Mundaring, Glen Forrest, Darlington, Boya, Helena Valley, Bushmead, Kalamunda, Carmel, Gooseberry Hill, Maida Vale, Koongamia, Hazelmere, High Wycombe, West Midland and Guildford lie within the catchment area.

The Helena River Catchment Group mainly works in the shaded area shown on the map.

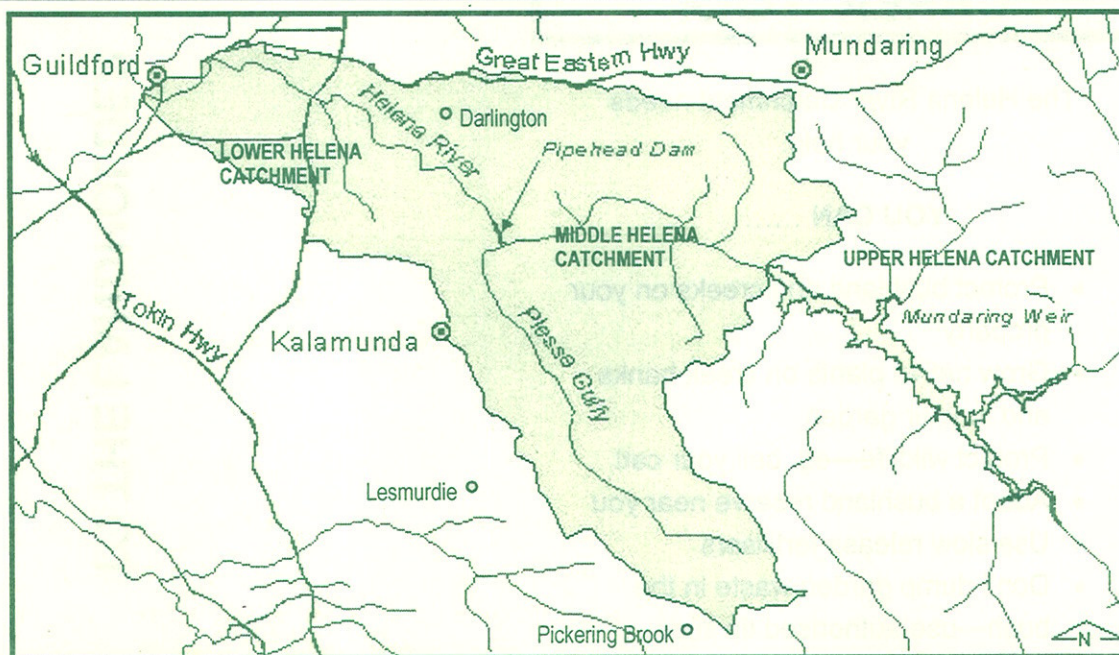

## WHAT DOES THE CATCHMENT GROUP DO?

Formed in November 1997, the Helena River Catchment Group (HRCG) grew out of community concern for the degraded state of the Helena River and the effect of land use impacts within the catchment.

There are a number of serious environmental management issues of concern to the Group, including; controlling weeds, protecting bushland, maintaining water quality, preventing erosion, protecting natural and cultural heritage and managing the impacts of access to the river by the community.

The Catchment Group develops and implements action plans to address these issues, conducts on-ground projects and works closely with the Shires and Government Agencies to protect and enhance the natural values of the beautiful Helena River Catchment.

## LOOK WHAT WE'RE ACHIEVING!

- Helena River Catchment Strategy and Plan of Priority Actions
- The Restoration of Nyaania Creek in Darlington and Piesse Brook in Kalamunda
- Cultural/Historical Study of the Catchment
- Raising peoples awareness of catchment care



DECEP. UPDATED

DEP SYSTEM 6 UPDATE SUBMISSION SURVEY SHEET

B.J. KEIGHERY 2/96

BUSHLAND AREA B 215 Hollow Creek SITES YES/NO

DATE 6/5 RECORDERS [initials]

Observations edge transects

Geographic Location	Latitude	S Longitude	E
Reference Map			

Photograph	Photographer's Name	Photo No	<u>(A)</u>
------------	---------------------	----------	------------

Transect of landscape units (draw in transect incorporating features listed and any other relevant unit)

dunes  
dry/wet flats  
sumplands  
uplands  
type

Soil - surface	type	% area	sub -soil
Exposed rock			

FLORA/VEGETATION (list dominant and significant plants below, see over for vege association descriptions)

Eucalypts	<i>E. calophylla</i>	<i>E. wandoo</i>	<i>E. marginata</i>	<i>E. todtianna</i>	<i>E. rudis</i>
	<i>E. decipiens</i>	<i>E. drummondii</i>	<i>E. haematoxylon</i>	<i>E. lanepolei</i>	<i>E. gomphocephala</i>
	<i>E. accedens</i>	<i>E. patens</i>	<i>E. laeliae</i>	<i>E. megacarpa</i>	
Sheoaks	<i>Allocasuarina fraserana</i>		<i>Casuarina obesa</i>		
Banksia	<i>B. attenuata</i>	<i>B. menziesii</i>	<i>B. prionotes</i>	<i>B. illicifolia</i>	<i>B. grandis</i> <i>B. littoralis</i>
Melaleuca	<i>M. preissii</i>	<i>M. raphiophylla</i>	<i>M. lanceolata</i>	<i>M. cuticularis</i>	
Others	<i>Callitris preissii.</i>				
Mallees	Eucalypts	<i>E. argutifolia</i>	<i>E. petrensis</i>	<i>E. decurva</i>	<i>E. foecunda</i> <i>E. latens</i>

SIGNIFICANT SPECIES

(see over for vegetaion descriptions)

Vegetation Condition - Keighery 1994 (Trudgen 1993) (show range and indicate predominant class)

- 1 = 'Pristine' (Excellent)
- 2 = Excellent (Very Good)
- 3 = Very Good (Good) ✓
- 4 = Good (Poor)
- 5 = Degraded (Very Poor)
- 6 = Completely Degraded

Specific aspects of disturbance

partial clearing
weeds (list): <u>Frame trees / (Arnds) / [unclear] / [unclear]</u>
selective removal of species: timber cutting    mowing    fire    grazing    dieback    %area
fire frequency:
'enrichment plantings' (list)
animal impact: horse    foxes    rabbits    cats    dogs    goats    pigs    overgrazing by native mammals
soil movement:    mining    dumping    rubbish dumping    roadworks
changes in water regimes:    flooding    drainage    watering    nutrient influx
Tracks:    fire breaks <u>walk trails</u> off road vehicle use <u>animal tracks</u>
Service corridors:    SEC    Main Roads    Water Authority    Telecom
Other

LIFE FORM/HEIGHT CLASS	CANOPY COVER			
	DENSE 70-100%	MID-DENSE 30-70%	SPARSE 10-30%	VERY SPARSE 2-10%
Trees >30m Trees 15-30m Trees 5-15m Trees <5m	Dense Tall Forest Dense Forest Dense Low Forest A Dense Low Forest B	Tall Forest Forest Low Forest A Low Forest B	Tall Woodland Woodland Low Woodland A Low Woodland B	Open Tall Woodland Open Woodland Open Low Woodland A Open Low Woodland B
Mallee tree form Mallee shrub form	Dense Tree Mallee Dense Shrub Mallee	Tree Mallee Shrub Mallee	Open Tree Mallee Open Shrub Mallee	Very Open Tree Mallee Very Open Shrub Mallee
Shrubs >2m Shrubs 1.5-2.0m Shrubs 1.0-1.5m Shrubs 0.5-1.0m Shrubs 0.0-0.5m	Dense Thicket Dense Heath A Dense Heath B Dense Low Heath C Dense Low Heath D	Thicket Heath A Heath B Low Heath C Low Heath D	Scrub Low Scrub A Low Scrub B Dwarf Scrub C Dwarf Scrub D	Open Scrub Open Low Scrub A Open Low Scrub B Open Dwarf Scrub C Open Dwarf Scrub D
Mat plants Hummock Grass  Bunch grass >0.5m Bunch grass <0.5m Herbaceous spp.	Dense Mat Plants Dense Hummock Grass Dense Tall Grass Dense Low Grass Dense Herbs	Mat Plants Mid-Dense Hummock Grass Tall Grass Low Grass Herbs	Open Mat Plants Hummock Grass  Open Tall Grass Open Low Grass Open Herbs	Very Open Mat Plants Open Hummock Grass  Very Open Tall Grass Very Open Low Grass Very Open Herbs
Sedges >0.5m Sedges <0.5m	Dense Tall Sedges Dense Low Sedges	Tall Sedges Low Sedges	Open Tall Sedges Open Low Sedges	Very Open Tall Sedges Very Open Low Sedges
Ferns Mosses, liverwort	Dense Ferns Dense Mosses	Ferns Mosses	Open Ferns Open Mosses	Very Open Ferns Very Open Mosses

VEGETATION (describe each unit of vegetation using dominants and life form/height class and canopy cover according to the Muir codes above)

(1)

Eucalyptus nitida 730m 60-70%

Melaleuca thorpiana 715m 40%

Sedgemoor 0.8-2.0 15%

+ weeds see 0101

(3)

Mallee



(c)

wood 00

Fauna comments

Adjacent bushland (refer to aerial photograph)

bp site 215

-  AG VEG 1998 BOUNDARY THEME
-  Cadastre
-  Bushplan sites refno 1-500 SCP BOUNDARY THEM

*Site*  
 - Swan Complex / former field  
 - Local TPS and River  
 - Major TPS and River  
 - FSC Public Reserve  
 - Issues follow past  
 - Wetland lines subject  
 to correction

*25/98*  
 Regionally Significant  
 Wetland  
 - Major linkage  
 - Follow HighWA  
 as per Kieron  
 to Swan River x Scarp

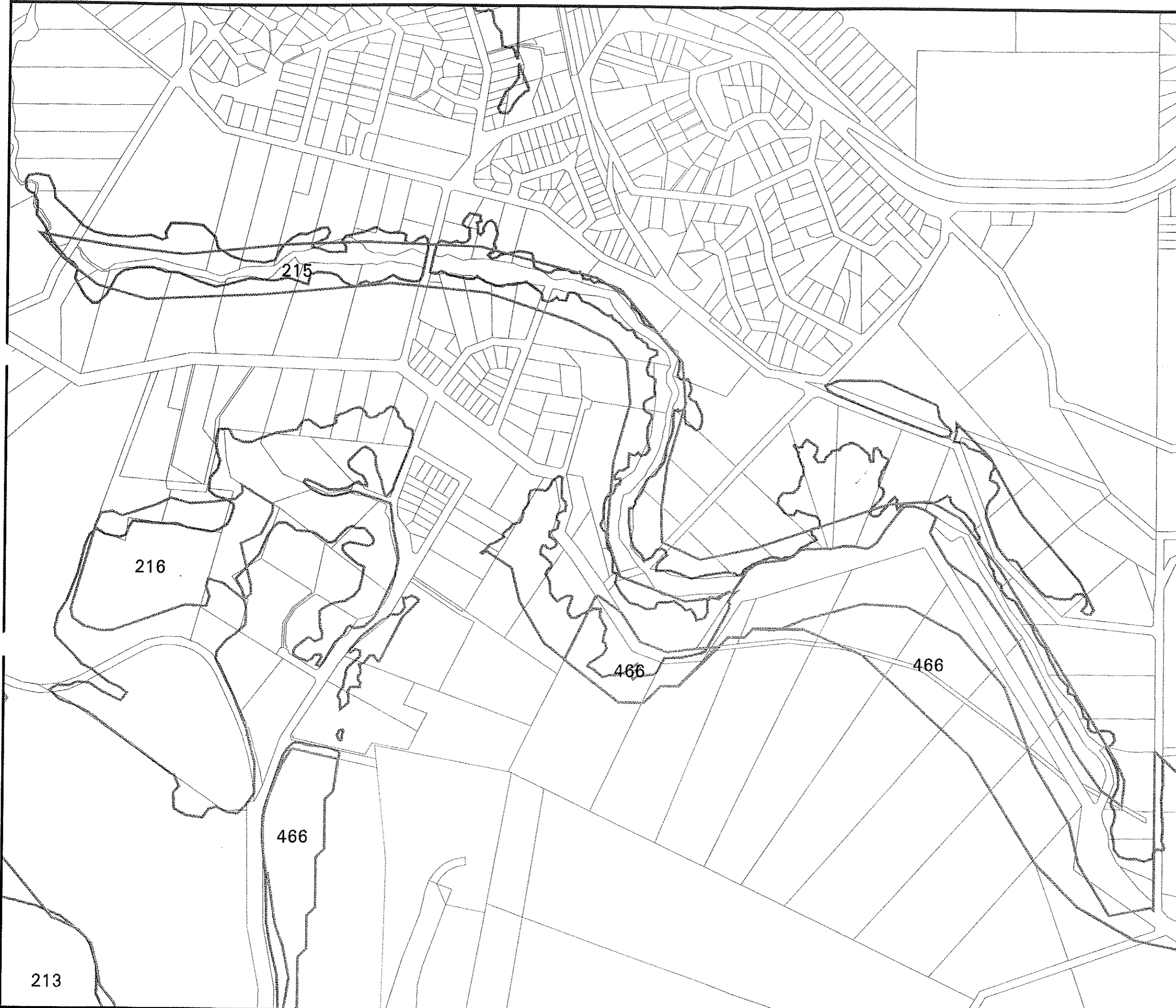

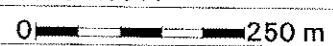
Map Ident: plot980526\_1  
 Prepared By: Andrea Zappacosta  
 Prepared For:  
 Date: 26 May 98  
 Scale 1:9041  
  
 MFP INTERNAL USE ONLY

213



Rivers edge E. road, Mel rhyph and Ast fossic. Ulfsonia Control

**Bush Forever Site 215**  
 Lt 2 Helena Valley Road  
 Helena Valley  
 Not for Distribution

- Cadastre with Lot Numbers
- Bush Forever Sites - Boundaries
- Contours - 1m (DOLA)

Map Ident: plot010528_1	DATE: 28 May 2001
Prepared By: Huia Colliver	Prepared For:
Scale 1:AUTO	<b>MFP INTERNAL USE ONLY</b>