

## CHITTY ROAD BUSHLAND, PINJAR

**Boundary Definition:** protected area with bushland (part taken to cadastre)/conservation wetland boundary (areas of bushland within the boundaries of the Site are not accurately mapped. The boundary has been drawn to include any unmapped bushland.)

### SECTION 1: LOCATION INFORMATION

**Bush Forever Site no.** 398

**Area (ha):** bushland 928.5 (Site also includes open water.)

**Map no.** 21, 22

**Map sheet series ref. no.** 2034-I SE, 2034-I SW

**Other Names:** State Forest East of Lake Pinjar, part Submission Area 288, part of proposed Gnangara Park

**Local Authorities (Suburb):** Shire of Wanneroo (Pinjar), Shire of Swan (Bullsbrook)

**Includes CALM Managed Land:** State Forest 65

### SECTION 2: REGIONAL INFORMATION

#### LANDFORMS AND SOILS

##### Bassendean Dunes

Bassendean Sands (Qpb: S8)

##### Bassendean Dunes/Pinjarra Plain

Bassendean Sands over Guildford Formation (Qpb/Qpa: S10)

##### Wetlands (within the Bassendean Dunes)

Holocene Swamp Deposits (Qhw: Cps)

#### VEGETATION AND FLORA

##### Vegetation Complexes

###### Bassendean Dunes

Bassendean Complex — North

Bassendean Complex — North Transition

###### Wetlands

Pinjar Complex

**Floristic Community Types:** \*not sampled, types inferred

##### Supergroup 2: Seasonal Wetlands

\*5 Mixed shrub damplands

##### Supergroup 3: Uplands centred on Bassendean Dunes and Dandaragan Plateau

\*21c Low-lying *Banksia attenuata* woodlands or shrublands

\*22 *Banksia ilicifolia* woodlands

\*23a Central *Banksia attenuata* — *B. menziesii* woodlands

\*23b Northern *Banksia attenuata* — *B. menziesii* woodlands

#### WETLANDS

**Wetland Types:** creek, dampland, sumpland

##### Natural Wetland Groups

###### Bassendean Dunes

Pinjar (B.1)

Gnangara (B.2)

Jandakot (B.3)

Riverdale (B.4)

**Wetland Management Objectives:** Conservation (108.9ha), Resource Enhancement

**Swan Coastal Plain Lakes EPP:** none identified

#### THREATENED ECOLOGICAL COMMUNITIES

Not assessed

### SECTION 3: SPECIFIC SITE DETAIL

**Landscape Features:** open water, vegetated wetland, vegetated uplands

**Vegetation and Flora:** limited survey (DEP 1998 (observations from roadside), McArthur and Mattiske 1985, Trudgen 1996)

**Structural Units:** mapping (McArthur and Mattiske 1985)

Uplands: *Eucalyptus todtiana*, *Banksia attenuata*, *B. menziesii* Low Woodland with occasional *Nuytsia floribunda* and *Banksia ilicifolia*; Very Open Woodland of *Banksia menziesii*, *B. attenuata*, *B. ilicifolia* and *Nuytsia floribunda* over mixed Shrubland dominated by *Xanthorrhoea preissii*, *Verticordia nitens*, *Regelia inops*, *Hypocalymma angustifolium*

Wetlands: *Regelia inops* Open Heath with occasional *Xanthorrhoea* sp. and occasional emergent *Banksia ilicifolia*; *Regelia inops* Closed Heath with emergent trees of *Melaleuca preissiana* and *Eucalyptus rudis*; Mixed Open Low Heath dominated by *Hypocalymma angustifolium* and *Dasypogon bromeliifolius*, *Hypocalymma angustifolium* Low Shrubland, *Phlebocarya ?ciliata*. Open Herblands

**Vegetation Condition:** >60% Pristine to Excellent, >20% Very Good, with areas of severe localised disturbance

**Total Flora:** not known

**Significant Flora:** the following are recorded from State Forest 65 and would be expected in the Site — *Stachystemon axillaris* (4), *Conostephium minus* (4); *Verticordia nitens*, *Boronia purdieana*, *Hensmania turbinata*, *Astroloma xerophyllum*, *Stylidium crossocephalum*, *Leucopogon kingianus*

**Fauna:** not known

**Linkage:** adjacent native vegetation to east (Sites 462 and 399); part of Greenways 36, 41 (Tingay, Alan & Associates 1998a); part of a regionally significant fragmented bushland/wetland linkage (Part A, Map 7)

**Other Special Attributes:** recommended for protection in study of City of Wanneroo bushland (Trudgen, 1996); included in Gnangara Park proposal (Bailey 1997)

#### **SECTION 4: INTERNATIONAL AND NATIONAL SIGNIFICANCE**

Not listed

#### **SECTION 5: SELECTION CRITERIA AND RECOMMENDATIONS**

**Criteria:** Representation of ecological communities, Rarity, Maintaining ecological processes or natural systems, General criteria for the protection of wetland, streamline and estuarine fringing vegetation and coastal vegetation

**Recommendation:** Site with Some Existing Protection; the existing care, control and management of this Site is endorsed (Proposed 'Gnangara Park' - Cabinet 1996) (see Table 3, Volume 1).

## CHITTY ROAD BUSHLAND, PINJAR

**Boundary Definition:** protected area with bushland (part taken to cadastre)/conservation wetland boundary (Areas of bushland within the boundaries of the Bushplan Site are not accurately mapped. The boundary has been drawn to include any unmapped bushland.)

### SECTION 1: CADASTRAL INFORMATION

(Lots, locations and derived information to be updated in the public submission period)

**Bushplan Site no.** 398      **Map no.** 27, 28, 33      **Map sheet series ref. no.** 2034-I SE, 2034-I SW

**Other Names**

State Forest East of Lake Pinjar, part Submission Area 288

**Area (ha):** total 1046.8 (includes open water); bushland 928.5

**Local Authorities (Suburb)**

Shire of Wanneroo (Pinjar), Shire of Swan (Bullsbrook)

**Zoning**

**MRS:** State Forests, Rural, Public Purposes-Commonwealth Government

**TPS:** Landscape

**Ownership Categories**

State Government

**Lot/Location/Reserve numbers (Purpose),**

**Street name**

5607 Perry Rd; 5607 Ziatas Rd; 5607 Kirby Rd

State Forest 65

CALM Managed Land

### SECTION 2: REGIONAL INFORMATION

#### LANDFORMS AND SOILS

**Bassendean Dunes**

Bassendean Sands (Qpb: S8)

**Bassendean Dunes/Pinjarra Plain**

Bassendean Sands over Guildford Formation (Qpb/Qpa:S10)

**Wetlands (within the Bassendean Dunes)**

Holocene Swamp Deposits (Qhw: Cps)

#### VEGETATION AND FLORA

**Vegetation Complexes**

**Bassendean Dunes**

Bassendean Complex — North

Bassendean Complex — North Transition

**Wetlands**

Pinjar Complex

**Floristic Community Types:** \*not sampled, types inferred

**Supergroup 2: Seasonal Wetlands**

\*5 Mixed shrub damplands

**Supergroup 3: Uplands centred on Bassendean Dunes and Dandaragan Plateau**

\*21c Low lying *Banksia attenuata* woodlands or shrublands

\*22 *Banksia ilicifolia* woodlands

\*23a Central *Banksia attenuata* — *B. menziesii* woodlands

\*23b Northern *Banksia attenuata* — *B. menziesii* woodlands

#### WETLANDS

**Wetland Types:** creek, dampland, sumpland

**Natural Wetland Groups**

**Bassendean Dunes**

Pinjar (B.1)

Gnangara (B.2)

Jandakot (B.3)

Riverdale (B.4)

**Wetland Management Objectives:** Conservation (108.9ha), Resource Enhancement

**Swan Coastal Plain Lakes EPP:** none identified

#### THREATENED ECOLOGICAL COMMUNITIES

Not assessed

### SECTION 3: SPECIFIC SITE DETAIL

**Landscape Features:** open water, vegetated wetland, vegetated uplands

**Vegetation and Flora:** limited survey (DEP 1998 (observations from roadside), McArthur and Mattiske 1985, Trudgen 1996)



**Structural Units:** mapping (McArthur and Matiske 1985)

Uplands: *Eucalyptus todtiana*, *Banksia attenuata*, *B. menziesii* Low Woodland with occasional *Nuytsia floribunda* and *Banksia ilicifolia*; Very Open Woodland of *Banksia menziesii*, *B. attenuata*, *B. ilicifolia* and *Nuytsia floribunda* over mixed Shrubland dominated by *Xanthorrhoea preissii*, *Verticordia nitens*, *Regelia inops*, *Hypocalymma angustifolium*

Wetlands: *Regelia inops* Open Heath with occasional *Xanthorrhoea* sp. and occasional emergent *Banksia ilicifolia*; *Regelia inops* Closed Heath with emergent trees of *Melaleuca preissiana* and *Eucalyptus rudis*; Mixed Open Low Heath dominated by *Hypocalymma angustifolium* and *Dasypogon bromeliifolius*, *Hypocalymma angustifolium* Low Shrubland, *Phlebocarya ?ciliata*. Open Herblands

**Vegetation Condition:** >60% Pristine to Excellent, >20% Very Good, with areas of severe localised disturbance

**Total Flora:** not known

**Significant Flora:** the following are recorded from State Forest 65 and would be expected in the Bushplan Site — *Stachystemon axillaris* (4), *Conostephium minus* (4); *Verticordia nitens*, *Boronia purdieana*, *Hensmania turbinata*, *Astroloma xerophyllum*, *Stylidium crossocephalum*, *Leucopogon kingianus*

**Fauna:** no known information

**Linkage:** adjacent native vegetation to east (BS462 and BS399); part of proposed Greenways 37, 42 (Tingay, Alan & Associates 1997a); part of a regionally significant fragmented bushland/wetland linkage (Volume 2A, Map 8)

**Other Special Attributes:** recommended for protection in study of City of Wanneroo bushland (Trudgen 1996); included in Gnangara Park proposal (Bailey 1997)

#### SECTION 4: INTERNATIONAL AND NATIONAL SIGNIFICANCE

Not listed

#### SECTION 5: SELECTION CRITERIA AND RECOMMENDATIONS

**Criteria:** Representation of ecological communities, Rarity, Maintaining ecological processes or natural systems, General criteria for the protection of wetland, streamline and estuarine fringing and coastal vegetation

##### Opportunities and/or Constraints

**Opportunities:** Bushplan Site/part Bushplan site subject to Gnangara Mound Crown Land EPP; location of conservation category wetlands; under TPS Landscape Zoning, Planning Control Area No. 29



**Constraints:** under General Mineral Resource Area (sand)

**Recommendation:** The existing care, control and management of the CALM managed area of this Bushplan Site is endorsed. Part of this site lies within the proposed 'Gnangara Park' (concept announced by Cabinet in 1996) within which areas of remnant native vegetation, such as this Bushplan Site, should be managed in the future to retain and enhance their conservation values. The most appropriate mechanism for the protection of the remainder of this Bushplan Site be considered through the public comment period in consultation with the land owner(s).

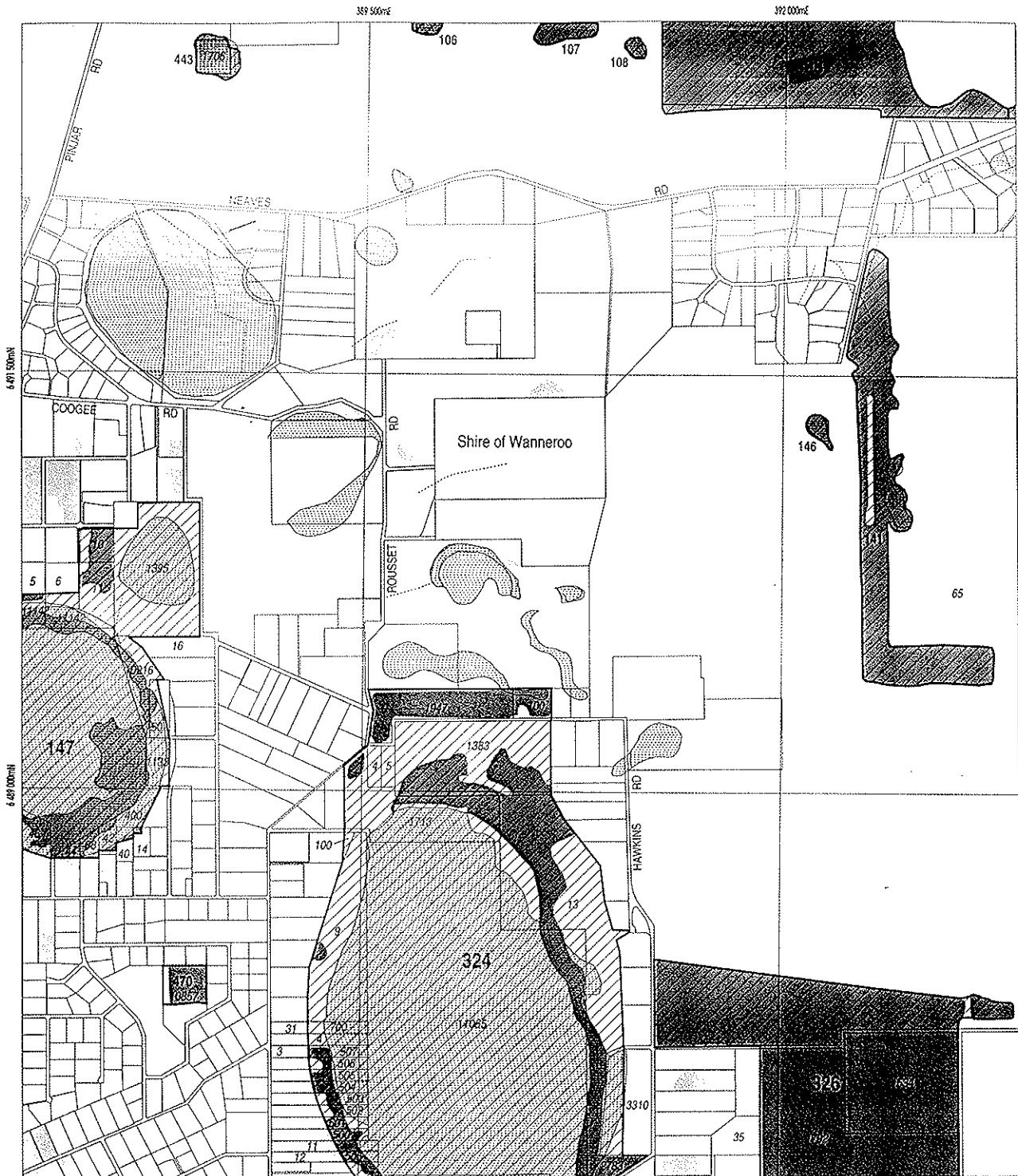

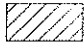
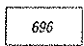
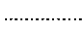
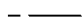

**LEGEND**

-  Bushplan Sites With Regionally Significant Bushland
-  Other Native Vegetation
-  Conservation Category Wetlands
-  Bushplan Sites With Some Existing Protection
-  Lot Number, Location Number
-  Channel Wetlands
-  Local Government Boundary

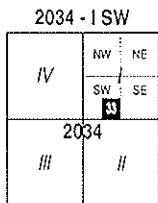

1:25 000 AMG Reference Grid showing Perth's Bushplan Map Sheet Breakdown

PERTH'S BUSHPLAN MAP INDEX

1	2											
3	4	5										
6	7	8	9	10	11							
12	13	14	15	16								
17	18	19	20	21	22	23						
24	25	26	27	28	29	30						
31	32	33	34	35	36							
37	38	39	40	41	42							
43	44	45	46	47	48							
49	50	51	52	53	54							
55	56	57	58	59								
60	61	62	63	64								
65	66	67	68	69	70							
71	72	73	74	75	76	77						
78	79	80	81	82	83	84						
85	86	87	88	89	90	91						
92	93	94	95	96	97							
98	99	100	101	102								
103	104	105	106									

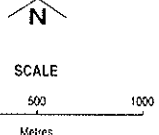

Produced by Project Mapping Section  
 Land Information Branch, Ministry for  
 Planning, Perth W.A. November 1998  
 ntw-map11/environ/bushplan/bushv2\_33.dgn  
 Cadastral Data supplied by Department  
 of Land Administration, W.A.  
 Wetlands Data supplied by  
 Water and Rivers Commission  
 Native Vegetation Extent for Study Area  
 supplied by Agriculture Western Australia



**LEGEND**

- 472 Bushplan Sites With Regionally Significant Bushland
- Other Native Vegetation
- Conservation Category Wetlands
- Bushplan Sites With Some Existing Protection
- 696 Lot Number, Location Number
- Channel Wetlands
- Local Government Boundary

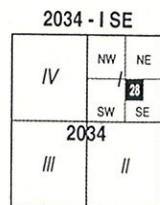

1 : 25 000 AMG Reference Grid showing Perth's Bushplan Map Sheet Breakdown

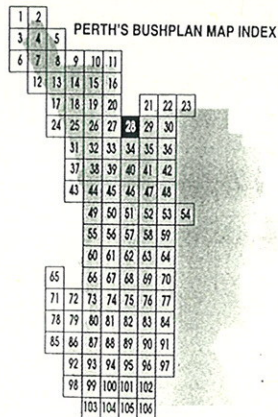

**SCALE**

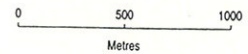

Produced by Project Mapping Section  
 Land Information Branch, Ministry for  
 Planning, Perth W.A. November 1998  
 ntw-map11\\environ\bushplan\bushv2\_28.dgn  
 Cadastral Data supplied by Department  
 of Land Administration, W.A.  
 Wetlands Data supplied by  
 Water and Rivers Commission  
 Native Vegetation Extent for Study Area  
 supplied by Agriculture Western Australia



**LEGEND**

- Bushplan Sites With Regionally Significant Bushland
- Other Native Vegetation
- Conservation Category Wetlands
- Bushplan Sites With Some Existing Protection
- Lot Number, Location Number
- Channel Wetlands
- Local Government Boundary

**2034 - I SW**

IV	NW	NE
	27	
	SW	SE

**2034**

III	II
-----	----

1 : 25 000 AMG Reference Grid showing Perth's Bushplan Map Sheet Breakdown

**PERTH'S BUSHPLAN MAP INDEX**

1	2					
3	4	5				
6	7	8	9	10	11	
12	13	14	15	16		
17	18	19	20	21	22	23
24	25	26	27	28	29	30
31	32	33	34	35	36	
37	38	39	40	41	42	
43	44	45	46	47	48	
49	50	51	52	53	54	
55	56	57	58	59		
60	61	62	63	64		
65	66	67	68	69	70	
71	72	73	74	75	76	77
78	79	80	81	82	83	84
85	86	87	88	89	90	91
92	93	94	95	96	97	
98	99	100	101	102		
103	104	105	106			

**N**

**SCALE**

0 500 1000

Metres

Produced by Project Mapping Section  
Land Information Branch, Ministry for  
Planning, Perth W.A. November 1998  
ntw-map11\\environ\bushplan\bushv2\_27.dgn



Cadastral Data supplied by Department  
of Land Administration, W.A.

Wetlands Data supplied by  
Water and Rivers Commission

Native Vegetation Extent for Study Area  
supplied by Agriculture Western Australia

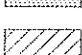
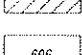
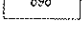
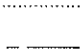

**LEGEND**

-  Bushplan Sites With Regionally Significant Bushland
-  Other Native Vegetation
-  Conservation Category Wetlands
-  Bushplan Sites With Some Existing Protection
-  Lot Number, Location Number
-  Channel Wetlands
-  Local Government Boundary

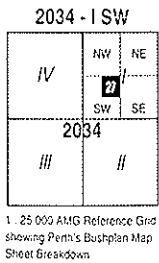

**PERTH'S BUSHPLAN MAP INDEX**

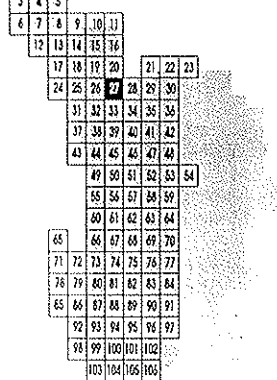

SCALE

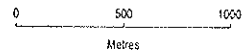

Produced by Project Mapping Section  
Land Information Branch, Ministry for  
Planning, Perth W.A. November 1996  
ntw-map11/enviro/bushplan/bushlv2\_27.dgn  
Cadastral Data supplied by Department  
of Land Administration, W.A.  
Wetlands Data supplied by  
Water and Rivers Commission  
Native Vegetation Extent for Study Area  
supplied by Agriculture Western Australia

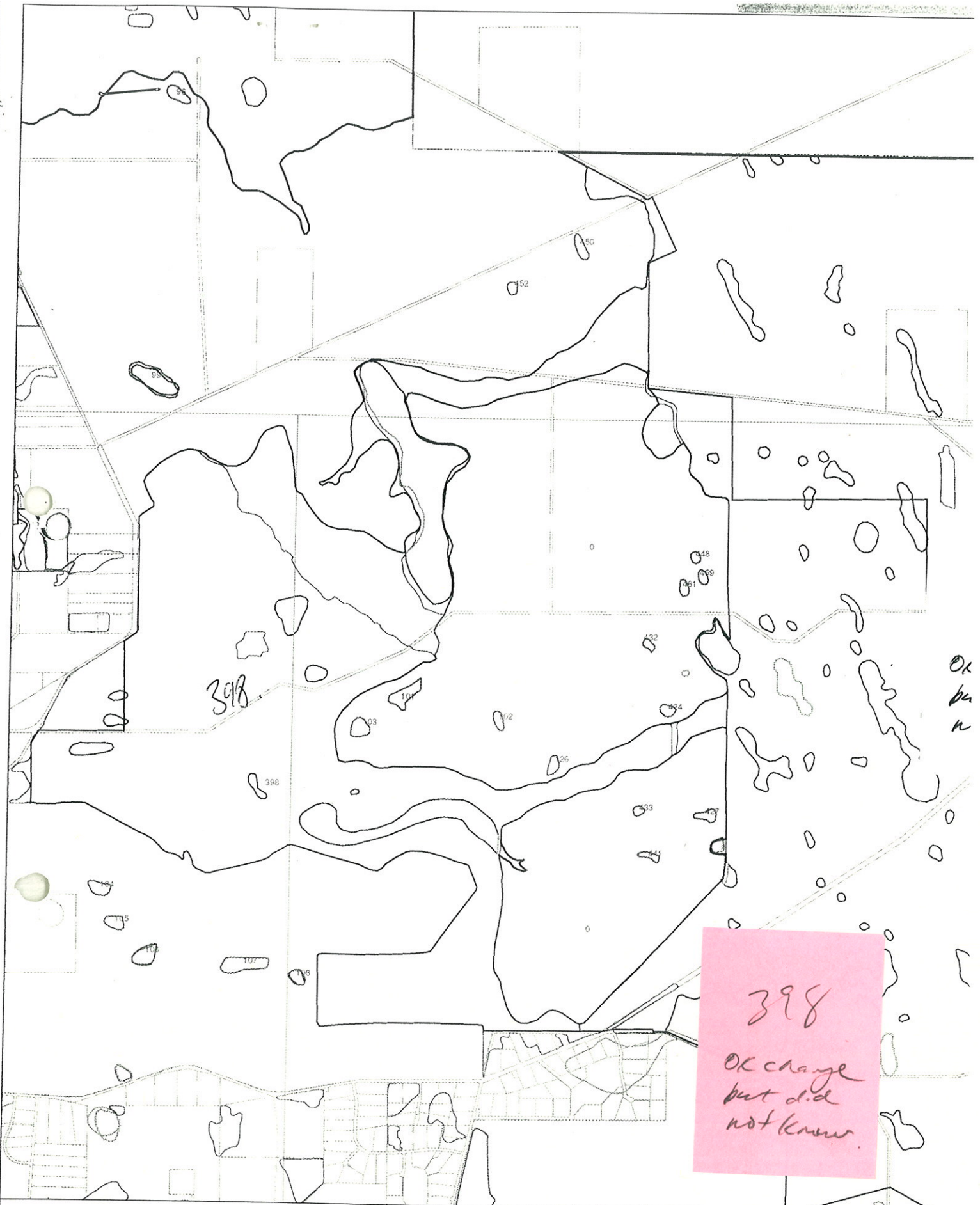

**BUSHPLAN SITES CORRECTED**



WESTERN  
AUSTRALIAN  
PLANNING  
COMMISSION



B 21/10/98

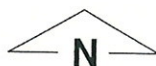

NO, NO REMAINS ON THIS SIDE

NT/BC 25/9  
 Some significant  
 crossings of veg  
 • (i) why leave out?  
 • (ii) Agreed (appears to be parquats)  
 • • • Subject to  
 (iv) reason

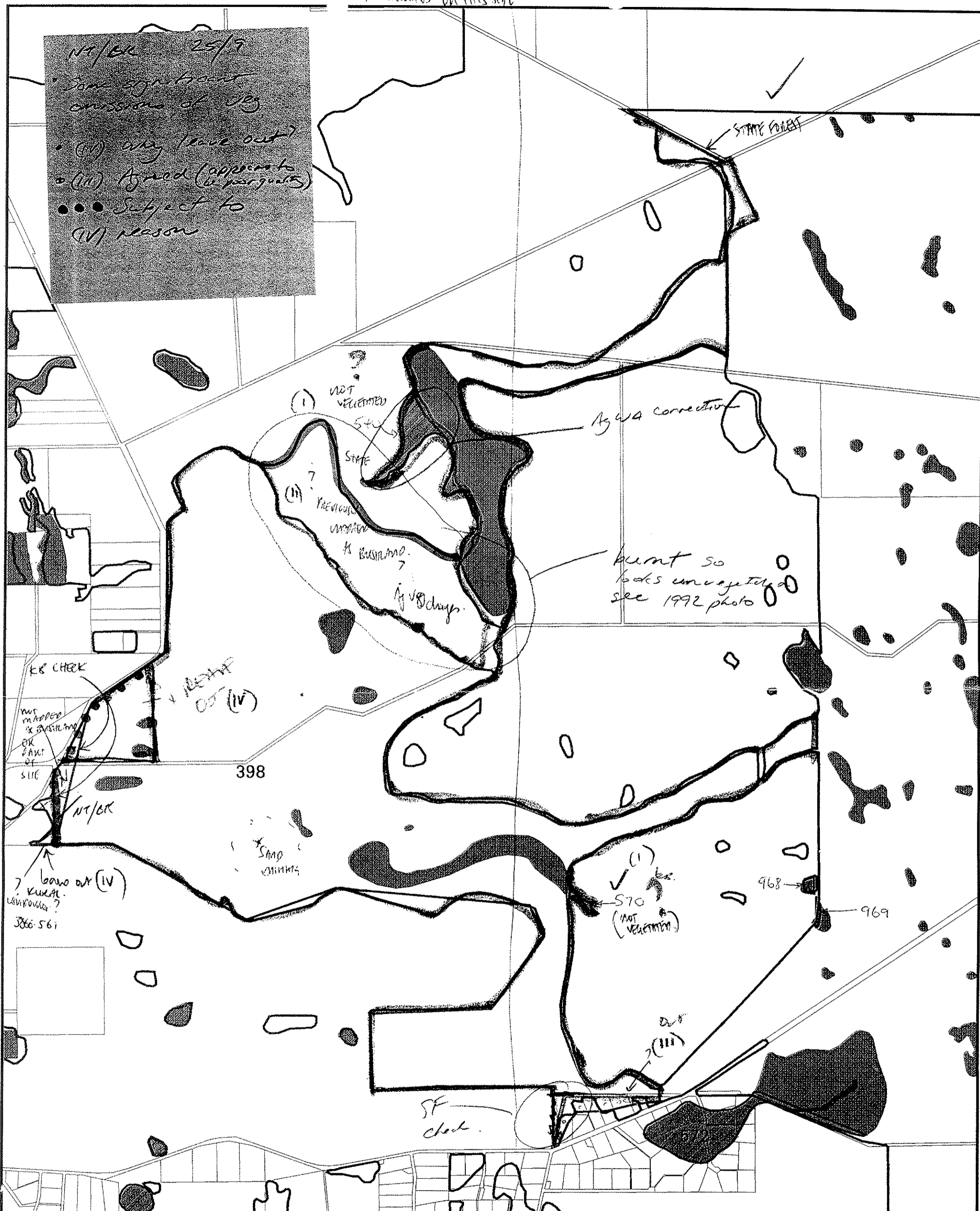

bp site 398

- Cadastre
- Bushplan sites refno 1-500 SCP BOUNDARY THEME
- cons category wetlands
- Verified CCWs
- AG VEG 1998 BOUNDARY THEME

(i) PROBABLY INCLUDE 570/540  
 (ii) Yes as shown  
 (iii) Special event that Bassenden should  
 leave out

Map Ident: plot980805_1	DATE: 05 Jun 98
Prepared By: Andrea Zappacosta	Prepared For:
Scale 1:AUTO	MFP INTERNAL USE ONLY

0 1.25 Km

\* NO MAPPING OTHER VCCW AS PER LIST \*

(iv) Leave out K&B check

**BS 398**

STATE FOREST No 65

**BASSENDAN DUNES**

- Ja** Jandakot Low hills and ridges with more than 5m relief; iron podzols; *Banksia* spp. low open woodland with a dense shrub layer.
- Ja-steep** Ridges with more than 10m relief; iron podzols; *Banksia* spp. low open woodland with sparse shrub layer.
- Ga** Gavin Flat or gently undulating landscape; iron — humus podzols; *Banksia* spp. low open woodland with scattered emergent *Eucalyptus calophylla* and *Melaleuca preissiana*; dense shrub layer.
- J** Joel Poorly drained depressions; humus podzols; scattered *M. preissiana*, *E. rudis* and *Banksia ilicifolia* with a dense shrub layer.
- Ws** Seasonal Swamps Depressions with free water in winter; humus podzols and peats; dense *M. preissiana*, *M. raphiophylla* and *E. rudis* around the edges with reeds and sedges in the centre.
- P** Pinjar Extensive flat swampy areas; sandy surface with some admixture of diatomite in the surface and organic hard plan below; *E. rudis*, *B. littoralis* and *M. preissiana* around edges; sedges and reeds with scattered *M. teretifolia* in centre; *Jacksonia furcellata* and *Viminaria juncea* on low sandy rises.
- Wp** Permanent Lakes and Swamps Depressions; humus podzols and peats around the edges often with some diatomite; zoned vegetation with heath on upper slopes. *Melaleuca* spp. and *E. rudis* at waters edge, reeds and sedges in shallow water.
- Wy** Yeal Swamp Complex A pattern of low sandy rises and many small seasonal swamps; rises have iron-humus or iron podzols and *Banksia* spp. low open woodland; swamps have surface layer of diatomite over sand; dense *Melaleuca* spp. and *E. rudis* around fringe with sedges in central parts of swamps.
- DL** Drainage Lines Broad, shallow channels. peaty soils. fringe of *Melaleuca* spp. and *E. rudis*; reeds and sedges in central zone.

**THE GNANGARA MOUND LANDFORMS SOILS AND VEGETATION**

WAWA 1995b

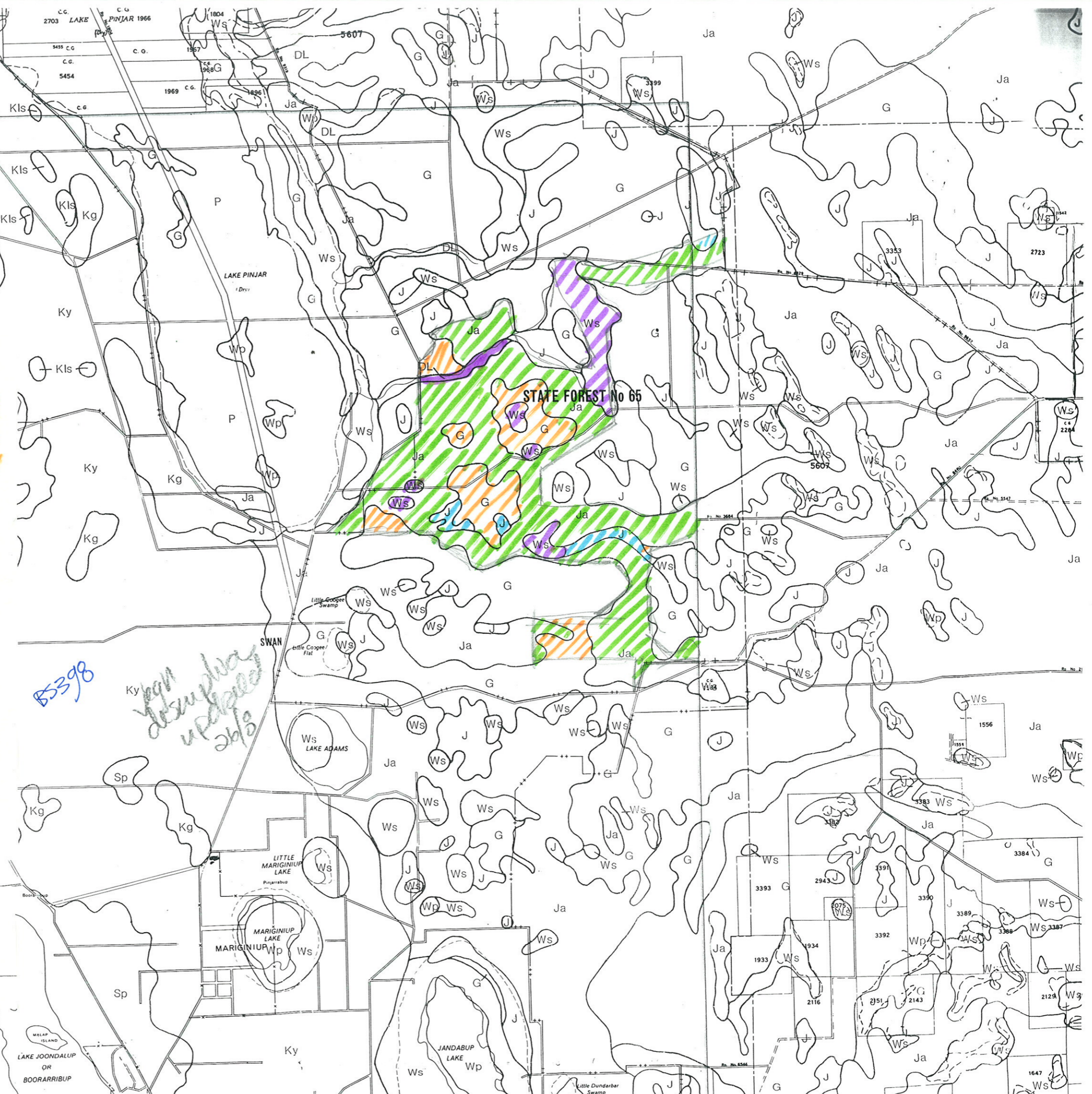

93061111

23.1.98

↑



74C 930

Frid Lager

Bridge

93061111

Koada

Buloka

5015 WA 3166(C) METRO REGIONAL AREA & EXT. RUN 10 (5001-5087) 1:20000 11-DE

McIntyre Press

5238 WA 3169(C) METRO REGIONAL AREA & EXT. RUN 11 (5233-5311) 1:20000 15 DEC 02



DEP SYSTEM 6/BUSHLAND SURVEY SHEET B.J. KEIGHERY 6/97  
 BUSHLAND AREA 5398 East of LAKE DINGAR SITES YES/NO  
 DATE 23.1.98 RECORDERS Natalie + Dina

Vol 2 Descrip updated 12/3

Observations edge transects

Geographic Location Latitude S Longitude E  
 Reference Map

Photograph Photographer's Name Natalie Photo No 36 37 1 2 3 4 5 6 7

Transect of landscape units (draw in transect incorporating features listed and any other relevant unit)

dunes  
 dry/wet flats  
 sumplands  
 uplands  
 type

Soil - surface grey-brown sub -soil  
 Exposed rock type % area

FLORA/VEGETATION (list dominant and significant plants below, see over for vege association descriptions)

Eucalypts	<i>E. calophylla</i>	<i>E. wandoo</i>	<i>E. marginata</i>	<i>E. todtianna</i>	<i>E. rudis</i>
	<i>E. decipiens</i>	<i>E. drummondii</i>	<i>E. haematoxylon</i>	<i>E. lanepoolei</i>	<i>E. gomphocephala</i>
	<i>E. accedens</i>	<i>E. patens</i>	<i>E. laeliae</i>	<i>E. megacarpa</i>	
Sheoaks	<i>Allocasuarina fraserana</i>		<i>Casuarina obesa</i>		
Banksia	<i>B. attenuata</i>	<i>B. menziesii</i>	<i>B. prionotes</i>	<i>B. illicifolia</i>	<i>B. grandis</i> <i>B. littoralis</i>
Melaleuca	<i>M. preissii</i>	<i>M. raphiophylla</i>	<i>M. lanceolata</i>	<i>M. cuticularis</i>	
Others	<i>Callitris preissii.</i>				
Mallees	Eucalypts	<i>E. argutifolia</i>	<i>E. petrensis</i>	<i>E. decurva</i>	<i>E. foecunda</i> <i>E. latens</i>
SIGNIFICANT SPECIES / <u>DOMINANT SPECIES</u>					
(see over for vegetation descriptions)					

Vegetation Condition - Keighery 1994 (Trudgen 1993) (show range and indicate predominant class)

- 1 = 'Pristine' (Excellent) PRISTINE - EXCEL - V. GOOD
- 2 = Excellent (Very Good)
- 3 = Very Good (Good)
- 4 = Good (Poor)
- 5 = Degraded (Very Poor)
- 6 = Completely Degraded

Specific aspects of disturbance

partial clearing						
weeds (list):						
selective removal of species: timber cutting mowing fire grazing dieback %area						
fire frequency:						
'enrichment plantings' (list)						
animal impact: horse foxes rabbits cats dogs goats pigs overgrazing by native mammals						
soil movement: mining dumping rubbish dumping roadworks						
changes in water regimes: flooding drainage watering nutrient influx						
Tracks: fire breaks walk trails off road vehicle use animal tracks						
Service corridors: SEC Main Roads Water Authority. Telecom						
Other						

VEGETATION (describe each unit of vegetation using dominants and life form/height class and canopy cover according to the Muir/<sup>Kessler</sup> codes above)

(A)  
Photo 36

Euc. tall }  
B. menziesii } (4-7m) 30%  
B. attenuata }

occ. N. f  
occ. B. illic

EREMEA  
shrubs: ~~Adiantum~~ ~~strobiliferum~~ (0.5-1m) 50-70%  
Macraea  
X.P.  
Peloponia linearis  
non Eriogon = SCHOLTZIA INVOLUCRATA  
Neraxia  
Dactyloctenium  
occ Lemniscata d JACKSONIA

weedy B. sp  
grad. li.

(B)  
Photo 37

Very open woodland of Banksia menziesii + B. a + Nf + Bi  
10%

Shrub layer of X? p (50-100)  
Vaccinium nitens  
Cassipouia  
Sida = Regelia inops  
Hypochaeris angustifolia  
for Jactynia } 50%

Fauna comments

Adjacent bushland (refer to aerial photograph)

OTHER COMMENTS

(C)  
Photo 1

Open wetland area of  
dense heath (0.5-1.2m)  
occ. Regelia inops 60%  
X. preiss  
non S. m... 20% = HYPOCHLYMMA ANGUST  
H. b... raumosa  
occ. emergent of B. illic

Adiantum along edges

- surrounded by Bm + Ba + Nf + Bi + occ. M.P.

398 (E)  
P-003

Xip (30-40%) } 60%  
Eremna-pauiflora

Dasyprocta bonet } (40-60) 15%  
Pellomys sciud }  
? Phelobryza (10-15) < 2%

- dens. palus  
d. Piradiza nitens

Xalob. nalgiz f.  
" B. lili  
" B. m.  
" M. preissii  
" E. td. } (3-6m)

area has been burnt

WSTE edge - Em Bz Bz <sup>OPEN WOODLAND.</sup> area with low  
country, XP, Pet line of  
Pezonia saricata

398

photo 2

① - ~~Sida~~ <sup>Regia</sup> <sup>INOPS</sup> 856 (1-1.5m)  
 - emergent Melaleuca PRESENT (4-6m)  
 Euc. rads. 15+

occ. Nutsia f.  
 occ. Totara

- sedge  
 - Phlebomera

Asyragas brom (20-40) 10%  
~~non sp. white~~ (60-1.2) 10% = HYPOXYLUMMA NUGAUS

edge - Bm + Bat + ET

\$398  
(F)

photo 4

281.90

~swale. Mol preiss.  
- LIMESTONE

Open Woodland.

Acacia dodl.	7-8m	} 730%
Nyctia	6-7m	
Bm	} 8m	
Bm		
B. nodosa	6-7m.	

tall trees dominant

Adenotus	} 10%
fat Jacksonia	
Acacia pulchella	

lowe shrubs

lowe shrubs	① <del>Callitris</del> <del>fraxinea</del>	} 45%
	<del>melaleuca</del> EREMEA	
DM	② <del>Callitris</del> SUTOLZIA INVOL	
	leucophloea leucophloea	
	Ptelemyia occidentalis	
DM	③ Melaleuca low shrub	
	occ vellicarda niter	
	occ Hobbita ?raemosa	

soil white/grey sand

Newcastle aboriginal 10cm <2

Weg  
(H)  
[PHOTO. 5]

~ H<sub>2</sub>O waf. = DISSEMINATED BY ROAD.

Melaluca pceissii (10-14m) 15%

ons: dense scrubland d. *Asplen. sp. fasciculata* (1-1.5)

w/ xp.

~~non S. non E. w/ myrte = HYPOC~~ (8-12) *Androsyrt* 55%

*Regelia Inops*

\* *Salsola rostrata* ??

? *Loxocarya* 10-30m 40%

Mo LWA  
° Aof. + Ha ~~HEATH~~

edge →

occ *Nutsa* *floubanda*  
3 *ulicifolia*  
*Euc. magirata*

*Briza* on edge

398.

23.1.98

(I) (1)

Melaleuca premissa 6-15m

5-10%

Limnecia juncea 2-7m 25-40%

oc Banksia litorea 4-14m  
Natsia floribunda >10m

edge: ~~Schizia revuka~~ <sup>(20-105m)</sup> RECAELIA INOPS 25%  
Meronelva stigia (15-25) 5%  
Lpouyana? longitudinale (1-1.2) 15-20%  
Dasyphyon bromelifolium  
Pellonthera tall.

- Pileocarpus twisted  
tall seed - flat twisted leaf

lygia babata

oo Mp OLW w/ occ Bi + Nf  
and y thicket  
and Ri LSc.  
and Llong. OTS.

New Species to be described by Russell Barrett

There was 1 record found for your search terms: 'id:29103 state:WA'

Pages  
1

## PERTH 07215363

*Calectasia* sp. Pinjar (C. Tauss 557)  
Dasypogonaceae

**Plant Description:** Herbaceous perennial shrub ca 40 cm x 50 cm in height with multiples stems and stilted roots. Flowers blue and fading to white.

**Vegetation:** Banksia menziesii - Banksia attenuata - Banksia woodland (30-50% cover < 6m in height) over Regelia inops (2-10% cover < 1.2 m in height) mixed low shrubs (10- 30% cover < 0.5 m in height) rushes, sedges, perennial monocots (10-30%) and herbs-grasses (2-10%). Common associates include Alexgeorgea nitens, Andersonia heterophylla, Austrodanthonia occidentalis, Austrostipa compressa, Beaufortia elegans, Calothamnus sanguineus, Calytrix flavescens, Chordifex microdon, Desmocladius flexuosus, Gonocarpus pithyoides, Hensmania turbinata, Hibbertia aurea, Hibbertia subvaginata, Hibbertia sp. Gnangara (J.R. Wheeler 2629), Hyalosperma cotula, Lechenaultia floribunda, Leucopogon conostephioides, Melaleuca seriata, Nuytsia floribunda, Patersonia occidentalis, Podotheca chrysantha, Phlebocarya ciliata, Regelia inops, Schotzia involucrata, Stylidium repens, Thysanotus thrysoideus, Trachymene pilosa.

**Site Description:** On gentle slope above dampland, deep grey quartz sand. Last fire ca 20-30 years ago.

**Frequency:** only two plants found.

**Locality:** ca 300 m E of Perry Road in Chitty Road bushland (Bush Forever Site No. 398), Pinjar (City of Wanneroo) **State:** WA

**Lat:** 31° 39' 59.500" S **Long:** 115° 50' 4.000" E (GDA94)

**Collector:** C. Tauss 557

**Collection Date:** 8 November 2005

**Conservation Status:** P1

**Determinavit:** R.L. Barrett **Date:** 15 November 2005

**Origin:** PERTH

**Type Status:** Holotype

Pages  
1

Your use of this site is subject to your acceptance of the [copyright and disclaimer information](#).

Will probably become DRF!

[Return to previous search](#)

***Calectasia* sp. Pinjar (C. Tauss 557)**

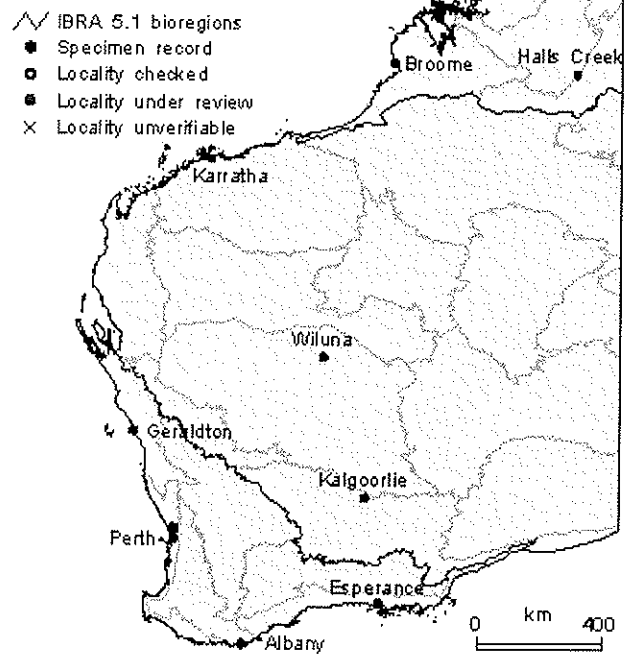

Your use of this site is subject to your acceptance of the copyright and disclaimer information.

Sussex Site 398  
23-1-98



Area A



Area B

Bushplan Site 398

23-1-98



Area C

Area D



Area E



Area F

Bushplan site 398  
23-1-98

Area H

Area I

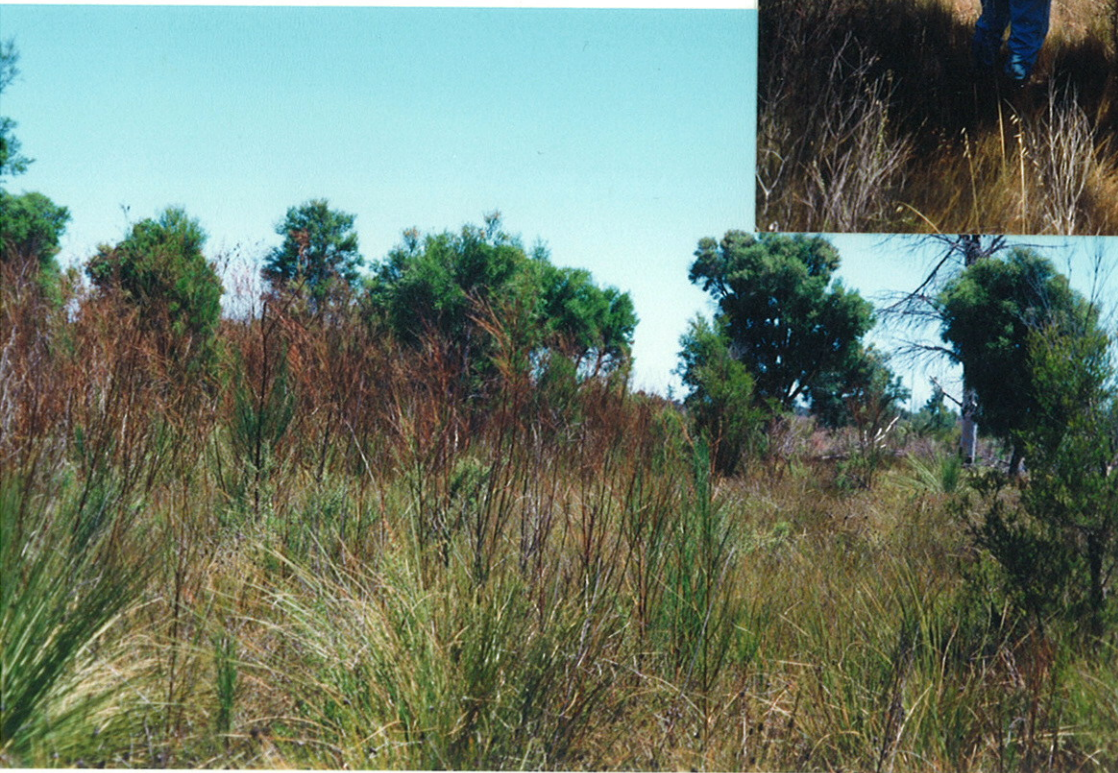

WILD 1574UAGA  
Nr. 13037 152.72

000049



WILD 1574UAGA  
Nr 13037 152.72

000050

-5022-1 267 -56 100 0200 0300 56-

000000 00334 20 025 60 0335

WILD 15740A6A  
Nr. 13037 152 72

100162

-5022-1 267-57 100 0200 0260 56-

000000 003165 021025 601909



WILD 1574 UAGA  
Nr 13037 152.72

000164

-5022-1 266-57 100 0200 0280 56-

000000 00365 21012 02510 03029 01873

