

BOUGAINVILLEA AVENUE BUSHLAND, FORRESTFIELD

Boundary Definition: protected area boundary (Areas of bushland within the boundaries of the Bushplan Site are not accurately mapped. The boundary has been drawn to include any unmapped bushland)

SECTION 1: CADASTRAL INFORMATION

(Lots, locations and derived information to be updated in the public submission period)

Bushplan Site no. 401 **Map no.** 58, 59 **Map sheet series ref. no.** 2034-II SE, 2134-III SW

Other Names

Agriculture Protection Board

Local Authorities (Suburb)

Shire of Kalamunda (Forrestfield)

Ownership Categories

State Government

CALM Managed Land

Area (ha): total 13.3; bushland 5.4

Zoning

MRS: Urban

TPS: Public Building, Recreation/Open Space

Lot/Location/Reserve numbers (Purpose),

Street name

11858 Bougainvillea Ave

Crown Reserve

Reserve 29815 (Use and requirements of Agricultural Protection Board and conservation)

SECTION 2: REGIONAL INFORMATION

LANDFORMS AND SOILS

Bassendean Dunes

Bassendean Sands (Qpb: S8)

VEGETATION AND FLORA

Vegetation Complexes

Combinations of Bassendean Dunes/Pinjarra Plain

Southern River Complex

Floristic Community Types

Supergroup 3: Uplands centred on Bassendean Dunes and Dandaragan Plateau

20a *Banksia attenuata* woodlands over species-rich dense shrublands

WETLANDS

No wetlands mapped

THREATENED ECOLOGICAL COMMUNITIES

Endangered (floristic community type 20a)

SECTION 3: SPECIFIC SITE DETAIL

Landscape Features: vegetated uplands

Vegetation and Flora: detailed survey (Robinson and Mawson 1992); limited survey (Gibson *et al.* 1994 (APBF 01-02))

Structural Units

Uplands: *Eucalyptus marginata* Open Woodland; *Banksia menziesii* and *B. attenuata* Open Forest to Woodland over Mixed Open Heath; Mixed Open Heath

Vegetation Condition: >90% Excellent, <10% Pristine, with areas of severe localised disturbance

Total Flora: 182 native taxa (Robinson and Mawson 1992) (estimated >90% expected flora)

Significant Flora: *Conospermum undulatum* (R); *Haemodorum loratum* (3), *Lambertia multiflora* var. *darlingensis* (3), *Isopogon drummondii* (3), *Dryandra pteridifolia* subsp. *vernalis* (3) (Robinson and Mawson 1992), *Olax scalariformis* (3) (Robinson and Mawson 1992); *Dasyogon obliquifolius*, *Schoenus latitans*, *Xanthorrhoea drummondii*, *Eremaea fimbriata*, *Hakea conchifolia*, *Pityrodia bartlingii*, *Stenanthemum humile*, *Banksia incana*

Fauna: multiple surveys for birds (55) (Mawson & Massam 1995). Good assemblage of resident and seasonal visitors. Significant bird species: category 1 (2), category 3 (4) and category 4 (7). Significant mammal species: Quenda (Friend 1996 D)

Linkage: no adjacent bushland

Other Special Attributes: Threatened or Poorly Reserved Plant Community (EPA 1994 GIS); contains plant communities representative of the eastern side of the Swan Coastal Plain



SECTION 4: INTERNATIONAL AND NATIONAL SIGNIFICANCE

Not listed

SECTION 5: SELECTION CRITERIA AND RECOMMENDATIONS

Criteria: Representation of ecological communities, Diversity, Rarity, Scientific or evolutionary importance

Opportunities and/or Constraints

Opportunities: Bushplan Site/ part Bushplan Site subject to Swan and Canning Rivers EPP; location of Declared Rare Flora and Scheduled Fauna; under TPS Recreation/Open Space Zoning; Crown Reserve

Constraints: under MRS Urban Zoning

Recommendation: The existing care, control and management intent of the reserve is endorsed. Long-term security and support for conservation management of the Bushplan Site to be enhanced by applying appropriate mechanisms in consultation with the reserve management body.





LEGEND

-  Bushplan Sites With Regionally Significant Bushland
-  Other Native Vegetation
-  Conservation Category Wetlands
-  Bushplan Sites With Some Existing Protection
-  Lot Number, Location Number
-  Channel Wetlands
-  Local Government Boundary

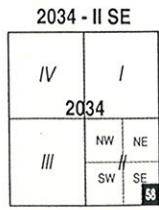

1 : 25 000 AMG Reference Grid showing Perth's Bushplan Map Sheet Breakdown

PERTH'S BUSHPLAN MAP INDEX

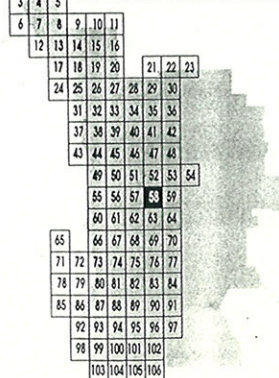



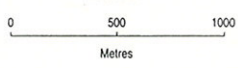

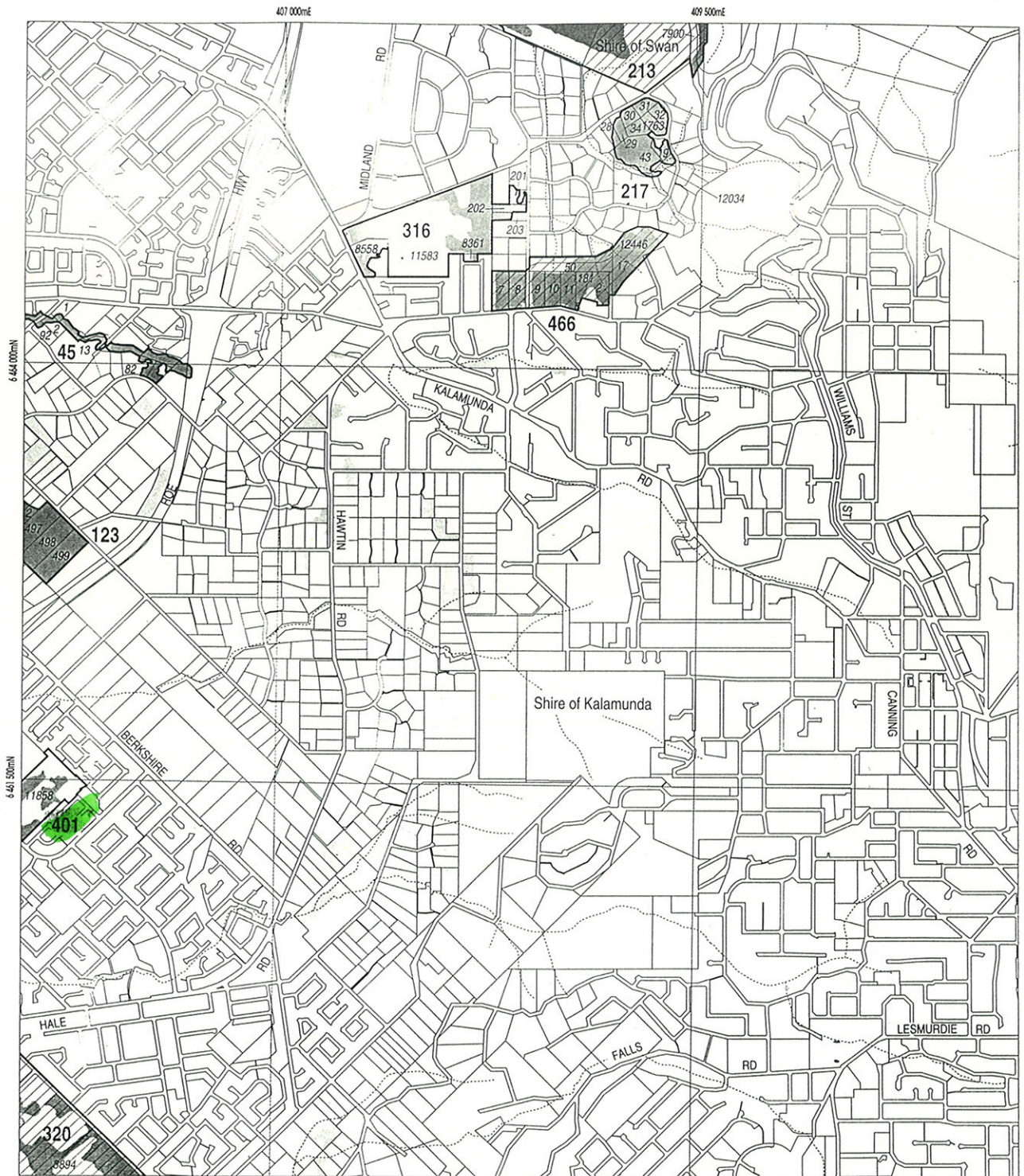

SCALE



Produced by Project Mapping Section
 Land Information Branch, Ministry for
 Planning, Perth W.A. November 1998
 nwt-map11/environ/bushplan/bushv2_58.dgn
 Cadastral Data supplied by Department
 of Land Administration, W.A.
 Wetlands Data supplied by
 Water and Rivers Commission
 Native Vegetation Extent for Study Area
 supplied by Agriculture Western Australia



LEGEND

-  Bushplan Sites With Regionally Significant Bushland
-  Other Native Vegetation
-  Conservation Category Wetlands
-  Bushplan Sites With Some Existing Protection
-  Lot Number, Location Number
-  Channel Wetlands
-  Local Government Boundary

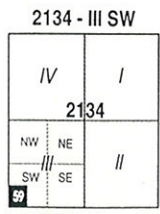

1: 25 000 AMG Reference Grid showing Perth's Bushplan Map Sheet Breakdown

PERTH'S BUSHPLAN MAP INDEX

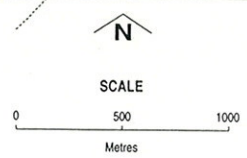

1	2	3	4	5						
6	7	8	9	10	11					
12	13	14	15	16						
17	18	19	20	21	22	23				
24	25	26	27	28	29	30				
31	32	33	34	35	36					
37	38	39	40	41	42					
43	44	45	46	47	48					
49	50	51	52	53	54					
55	56	57	58	59						
60	61	62	63	64						
65	66	67	68	69	70					
71	72	73	74	75	76	77				
78	79	80	81	82	83	84				
85	86	87	88	89	90	91				
92	93	94	95	96	97					
98	99	100	101	102						
103	104	105	106							

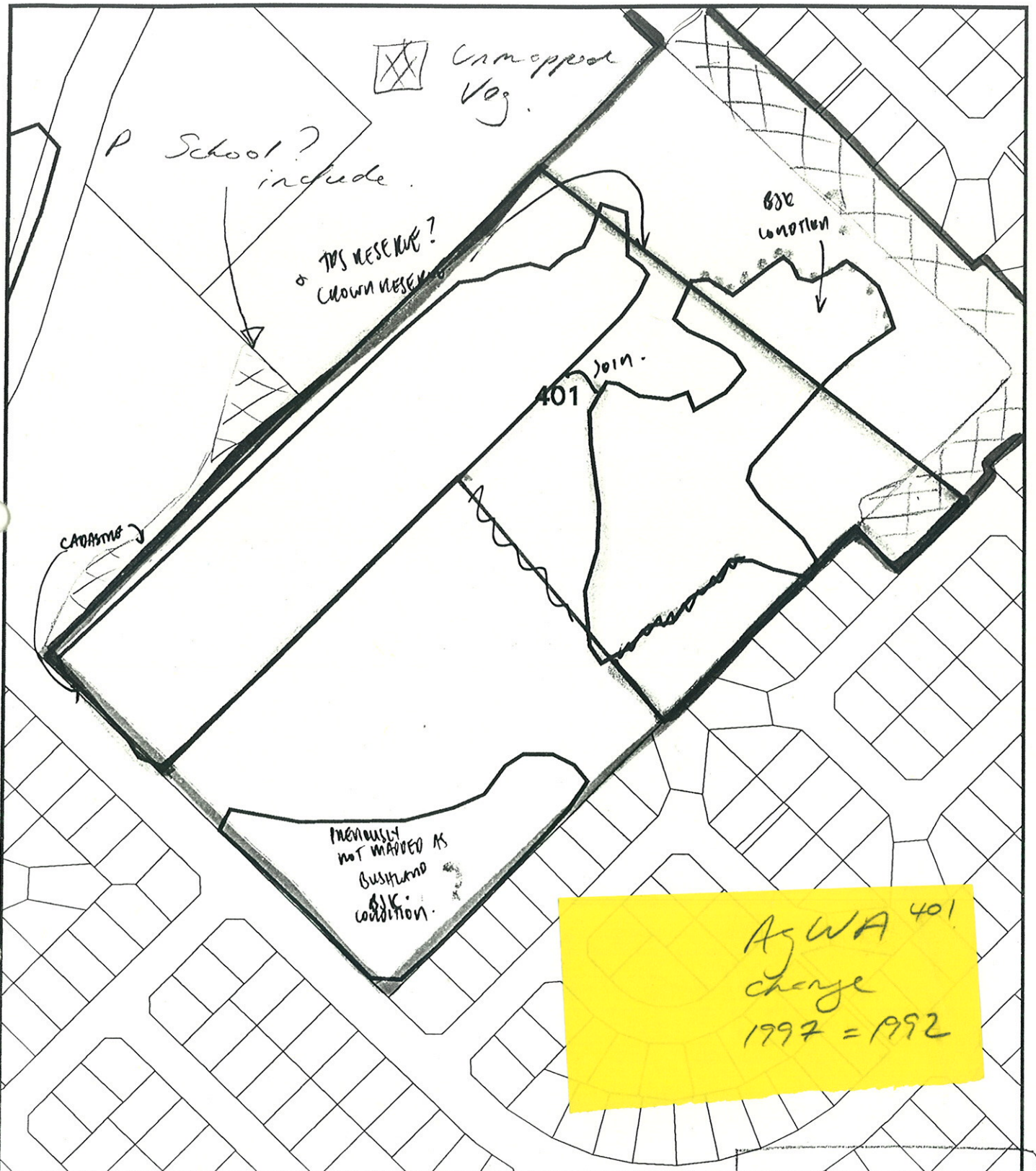

Produced by Project Mapping Section
 Land Information Branch, Ministry for
 Planning, Perth W.A. November 1998
 nwt-map111/environ/bushplan/bushv2_59.dgn
 Cadastral Data supplied by Department
 of Land Administration, W.A.
 Wetlands Data supplied by
 Water and Rivers Commission
 Native Vegetation Extent for Study Area
 supplied by Agriculture Western Australia



bp site 401

-  Cadastre
-  Bushplan sites refno 1-500 SCP BOUNDARY THEME • TEC
-  AG VEG 1998 BOUNDARY THEME

BK/NT 25/9

• DLF Site
ie as below
with boundary on
reserve boundary.

MFP INTERNAL USE ONLY

Prepared By: Andrea Zappacosta

Prepared For:

Map Ident: plot980608_1

Date: 08 Jun 98

Scale 1:2912

Cult

All Public Building TPS and
owned C Class Crown Reserve. Subject
to conditions could include areas shown.
because Slinen

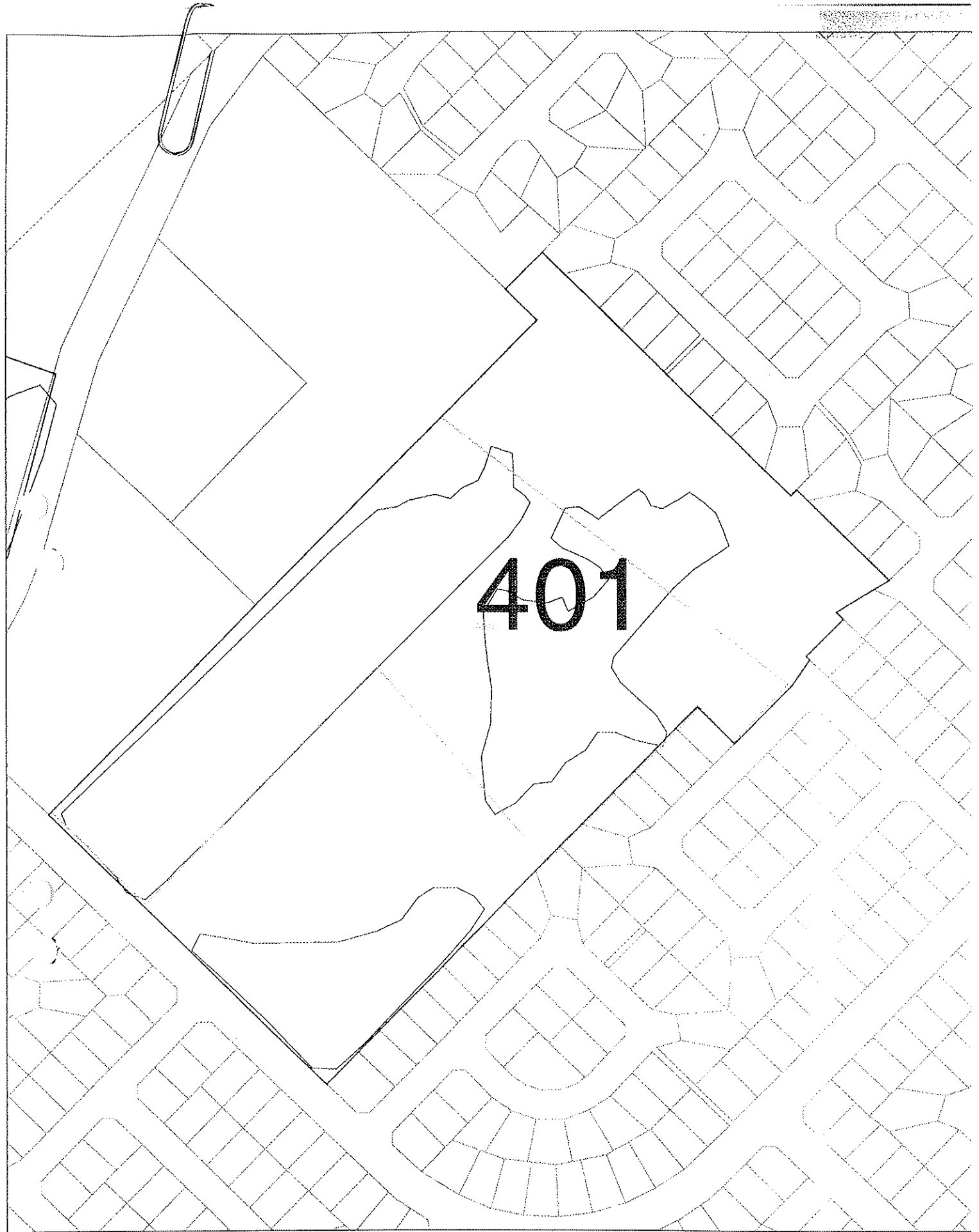

BUSHPLAN SITES CORRECTED



WESTERN
AUSTRALIAN
PLANNING
COMMISSION



CUSTOMER
FOCUS
WESTERN AUSTRALIA



B BK 28/6/96

'Crown Reserves @ June/97'

32476

PIN	=	1079089
RESCLASS	=	C
RESERVE_NO	=	29815
CURRAREA	=	13.34
PURPOSE_DESC	=	USE AND REQUIREMENTS OF THE AGRICULTURE PROTECTIO
GPRPFX	=	
CONS	=	

=====



WEST

USHMEAD RD

M45

M45

TALAMOND RD

MIDLAND RD

activ

M52

SULTANA

DUNDAS RD

M53

APP

HARTFIELD
HARTFIELD

M58

WELSHIPOL RD

M70

BRIXTON1

M69

BRIXTON1

BICKLEY RD

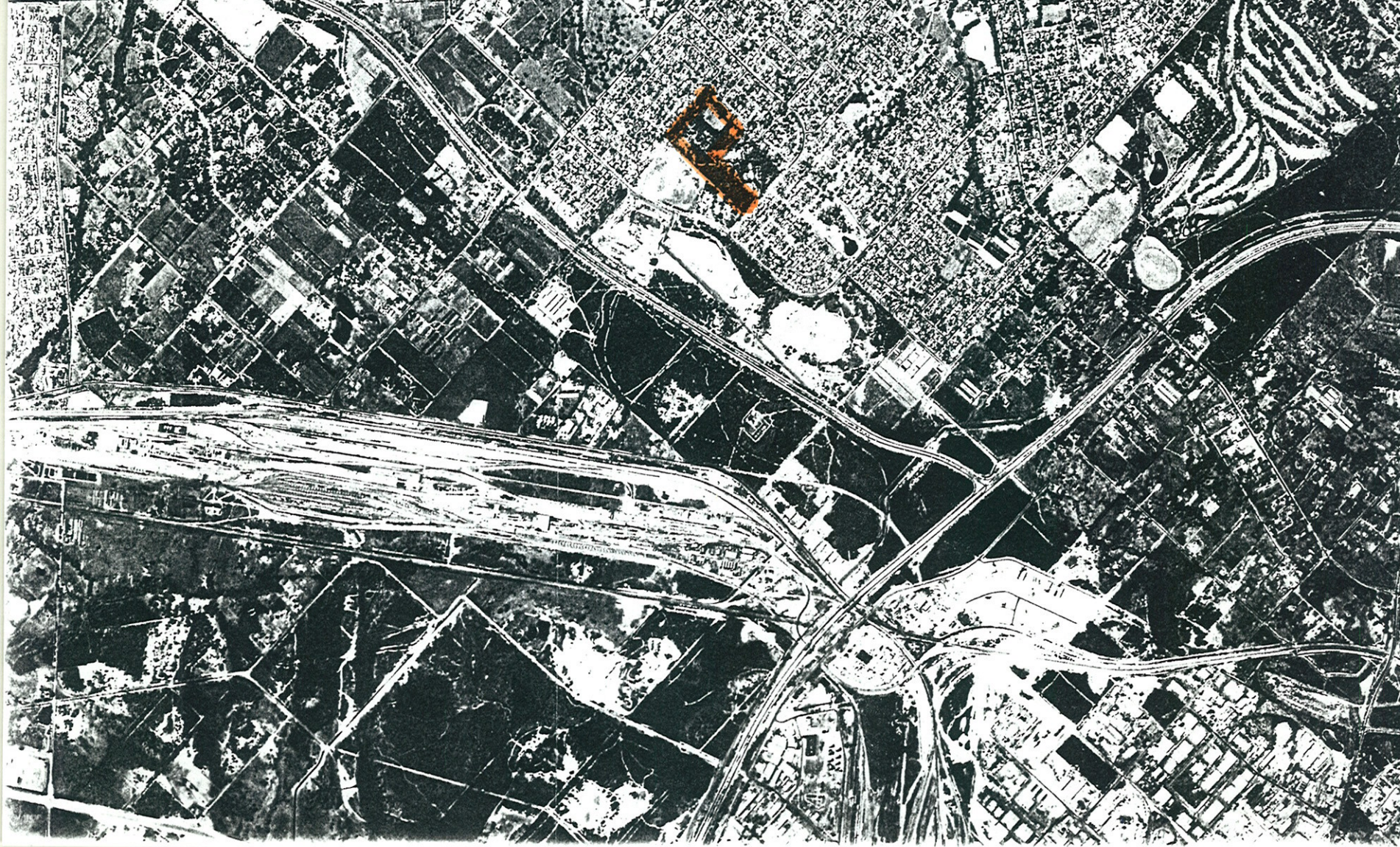

CONTACT DR N. GIBSON CALM WOODVALE for further information.

Flora list for APB (extracted from Swan Coastal Plain database, APBF01-02, 104 taxa, 25/5/1995).

Department of Environmental Protection System 6 Update: Site Based Flora List APB

(extracted from the CALM Swan Coastal Plain database, APBF01-02, 104 taxa, 25/5/95)

Anthericaceae

Johnsonia pubescens
Thysanotus patersonii
Thysanotus sp. scps
Thysanotus triandrus
Tricoryne elatior
Tricoryne tenella

Caesalpiniaceae

Labichea punctata

Casuarinaceae

Allocasuarina humilis

Chloanthaceae

Pityrodia bartlingii

Colchicaceae

Burchardia umbellata

Cyperaceae

Caustis dioica
Cyathochaeta clandestina
Lepidosperma "coastal terete" scps (BJK&NG 231)
Lepidosperma angustatum
Mesomelaena pseudostygia
Mesomelaena tetragona
Schoenus brevisetis
Schoenus clandestinus
Schoenus latitans
Schoenus pleiostemoneus
Schoenus subbarbatus
Tetraria octandra
Tricostularia neesii var. neesii

Dasypogonaceae

Dasypogon obliquifolius
Kingia australis
Lomandra caespitosa
Lomandra hermaphrodita
Lomandra nigricans
Lomandra preissii
Lomandra sericea

Dilleniaceae

Hibbertia huegelii
Hibbertia hypericoides

Droseraceae

Drosera erythrorhiza
Drosera menziesii
Drosera stolonifera

Epacridaceae

Astroloma pallidum
Astroloma stomarrhena
Conostephium pendulum
Leucopogon sprengelioides
Lysinema ciliatum
Styphelia tenuiflora

Euphorbiaceae

Monotaxis grandiflora
Stachystemon vermicularis

Goodeniaceae

Dampiera linearis
Scaevola repens var. repens

Haemodoraceae

Conostylis aurea
Conostylis caricina
Haemodorum laxum
Haemodorum loratum
Phlebocarya filifolia

Iridaceae

Patersonia juncea
Patersonia occidentalis

Lamiaceae

Hemiandra pungens

Lauraceae

Cassytha flava
Cassytha glabella
Cassytha racemosa

Mimosaceae

Acacia willdenowiana

Myrtaceae

Conothamnus trinervis
Eremaea fimbriata
Eremaea pauciflora subsp. pauciflora seps
Eucalyptus marginata
Eucalyptus todtiana
Melaleuca scabra

Olacaceae

Olax benthamiana

Orchidaceae

Prasophyllum sp. seps

Papilionaceae

Bossiaea eriocarpa
Daviesia angulata
Daviesia nudiflora
Gompholobium confertum

Gompholobium knightianum
Jacksonia densiflora
Jacksonia lehmannii
Sphaerolobium linophyllum

Poaceae

Amhipogon turbinatus

Polygalaceae

Comesperma calymega

Proteaceae

Adenanthos cygnorum
Banksia attenuata
Banksia incana
Banksia menziesii
Conospermum undulatum scps map
Dryandra armata
Dryandra nivea
Hakea conchifolia
Hakea ruscifolia
Isopogon drummondii
Lambertia multiflora
Petrophile linearis
Petrophile macrostachya
Stirlingia latifolia
Synaphea spinulosa

Restionaceae

Alexgeorgea nitens
Loxocarya fasciculata
Lyginia barbata
Restio sinosus scps ms

Rhamnaceae

Cryptandra humilis

Rutaceae

Boronia ramosa
Eriostemon spicatus

Stylidiaceae

Stylidium brunonianum
Stylidium carnosum
Stylidium diuroides
Stylidium piliferum
Stylidium repens

Violaceae

Hybanthus calycinus

Xanthorrhoeaceae

Xanthorrhoea drummondii

AREA INFORMATION

System 6 Area (C or M) or Update Area (Update) **APB**

Conservation Area
Nature Reserve
Reserve No
National Park
Reserve No
Local Government
Reserve No
Other
Proposed Conservation Areas
Local Government
Reserve No
Other APB

Conservation Area

Nature Reserve
Reserve No
National Park
Reserve No
Local Government
Reserve No
Other

TOTAL AREA

Bushland Area	7	hectares
Completely Degraded		

AREA MAPPED FLORISTIC UNITS

Units	Site (Condition)	Code G : APBF	Bound	Area (ha)
20a	Ø1 ()	Ø2 ()		

Boundaries determined by use of

aerial photograph	Metro Street Directory run 13 5183 4/1/91
orthophoto	2034 11 SE Check
vegetation map	
soil map	

with WS3

SYSTEM 6 BUSHLAND SUBMISSION FORM
FOR CONSIDERATION IN THE UPDATE PROGRAMME

If you wish to submit more than one area for consideration in the System 6 update, please use a separate form for each area.

Please fill in each section giving as much information as possible.

LOCATION, OWNERSHIP AND ZONING OF THE AREA

1. Location APB Land, Forrestfield.

Please give as accurate and detailed a description as possible of the site location.

Please include either a hand drawn or copied map showing the area of the area.

a) Bordering Roads: Bougainvillea Ave, Forrestfield

b) Nearest Corner: Bougainvillea and Dawson Ave

c) Lot Number: Street Number:

d) Town/Suburb/Location: Forrestfield

e) Local Council: Kalamunda

f) Site Name (if any): APB Land, Forrestfield

g) Approximate size of the area (ha): 13.8 ha

h) Please locate the area on a map and give us map references if possible:

see attached

i) Map: 22 Streetsmart /UBD/Other:

j) Map no.: M

k) Grid Ref: M8

l) Please give any other information that may help us to find the location:

m) Are you aware of any development proposals that are likely to affect the area?

no

NOTE: Areas that have already been given development APPROVAL should not be nominated

Please fill out those questions that you can answer

2. Who owns the area? (If owned by the person/s making the nomination please indicate) *vested in the APB, owned by the state*

3. If you own the area, and may be interested in participating in conservation on private land initiatives please indicate (and leave your name and address at the end of this submission form)

4 .What is the area zoned? (please indicate whether zoning is Town Planning Scheme or Metropolitan Region Scheme) *Urban (MRS)*

CAN YOU TELL US A LITTLE ABOUT THE PHYSICAL CHARACTERISTICS OF THE AREA

5. Why do you consider this area important? (Refer to Guiding Issues paper) *yes, see attached reports*

6. What is/are the soil type/s and colours ?

Type: Sand/Clay/Gravel/Loam/Silt

Colour: White/Grey/Brown/Orange/Yellow/Red/Black

7. Does the area have any special features such as unusual landforms / landscapes that still retain their natural vegetation? Yes/No

If yes, what are they? *Banksia / jarrah woodland which has not been subject to fire for over 22 years*

8. Is the area a wetland or does it include a wetland?

If yes, what kind of a wetlands is it?

a) lake

b) river

c) stream

d) swamp

e) estuary

f) seasonally wet

g) other

9. What percentage of the wetland is open water in summer?

CAN YOU TELL US A LITTLE ABOUT THE VEGETATION /FAUNA ON THE NOMINATED AREA.

10. What percentage of the area is indigenous vegetation? *over 50%*

11. If the area includes regions cleared of native bushland please indicate reasons for the inclusion.

12. Has any previous flora or fauna survey work been done on the area?
yes

If yes, please give details of the work *see attached*

13. How would you rate the condition of the native bushland? (see attached table)

- a) pristine (*some*)
- b) excellent (*most*)
- c) very good
- d) good *(small amount)*
- e) degraded
- f) completely degraded
- g) don't know

14. Please indicate the disturbances affecting the area and where appropriate the percentage of the area disturbed.

- a) Partial clearing
- b) fragmentation
- c) Selective removal of species: timber cutting, wildflower picking, mowing dieback and other plant diseases
- d) Fire regime, including intensity, season and frequency
- e) 'Enrichment plantings' that is plantings of species not found in that community
- f) Weed invasion
- g) Animal impact: horses, foxes, rabbits, cats, dogs, camels, goats etc
- h) Soil movement, both removal and dumping
- i) Changes in water regimes; flooding, drainage and watering
- j) Salinity
- k) Fertiliser drift and along waterways nutrient influx
- l) Mining, including that for road works

- m) Grazing: stock, overgrazing by feral or native mammals
 - n) Proliferation of tracks, fire breaks and walk trails
 - o) Off-road vehicle use
 - p) Use as service corridors by the SEC, Main Roads, Water Authority.
- (Source: B Keighery. Bushland Plant Survey, September 1994)

15. Does the area contain any plant species of special interest that you know of? (eg. declared rare flora, priority taxa, outlier populations) yes

Do you know what they are? see attached, one in particular is *Drosera vestita* which usually occurs on Darling Scarp

16. Do you know of any native animals that use the area? yes

Can you list those you know of? (birds, mammals, reptiles, amphibians etc)

bandicoots, possums, reptiles

17. Is the area used by any native animals of special interest? (eg. endangered species, large/important populations) yes

If yes, please name them and indicate source of information

Southern Brown Bandicoot

CAN YOU TELL US A LITTLE ABOUT THE SURROUNDING AREA

18. Are there any bushland areas (including wetlands) near to this area?

If yes, how close are they? Pawson Ave Cold landfill site has

small areas of lower quality remnant vegetation and is known to form a link to the west

Are they already conservation reserves? no

What is their approximate size? bushland area < 1 ha

19. Does the submitted area link other bushland areas? no, fairly isolated

Please attach any additional information about the area which may be of use when assessing it.



WATER RESOURCES MANAGEMENT PLAN

MIDDLE CANNING CATCHMENT

(STAGE 1 - VOLUME 1)

Prepared for the

Water Authority of Western Australia

By

Evangelisti & Associates
Consulting Engineers and Project Managers

in association with

Landvision
Consultants in Urban and Environmental Planning

and

The V & C Semeniuk Research Group
Environmental Scientists

October 1995

85 401 4007/1993
LIBRARY
DEPARTMENT OF ENVIRONMENTAL PROTECTION
WESTRALIA SQUARE
141 ST. GEORGE'S TERRACE, PERTH

**VEGETATION AND FLORA
SURVEY
OF THE
SHIRE OF KALAMUNDA
VESTED RESERVES**

**VOLUME 1 - REPORT
OCTOBER 1992 TO MARCH 1993**

PAUL ARMSTRONG RESEARCH OFFICER

SHIRE OF KALAMUNDA

581.9(44)
ARM
950264

TABLE OF CONTENTS

INTRODUCTION	Page 1
METHODOLOGY	Page 2
2.1 RESERVES	Page 2
2.2 ANALYSIS	Page 3
RESULTS AND DISCUSSION	Page 6
3.1 FLORA	Page 6
3.1.1 Species Distribution	Page 9
3.1.2 Range Extensions	Page 11
3.1.3 Declared Rare and Priority Species	Page 12
3.1.4 Unidentified species	Page 15
3.1.5 Introduced Species	Page 15
3.2 RESERVES	Page 17
3.2.1 Assessment	Page 17
3.2.2 Comments on specific reserves	Page 21
3.3 COMPUTER FILES	Page 20
CONCLUSION	Page 21
4.1 FLORA	Page 21
4.2 RESERVES	Page 22
4.3 OVERALL	Page 22
ACKNOWLEDGMENTS	Page 23
REFERENCES	Page 24

LIST OF APPENDICES

APPENDIX I.	SPECIES LIST	Page 25
APPENDIX II.	SPECIES RICHNESS	Page 45
APPENDIX III.	SPECIES DISTRIBUTION	Page 47
APPENDIX IV.	VEGETATION CONDITION	Page 51

LIBRARY
DEPARTMENT OF ENVIRONMENTAL PROTECTION
WESTRALIA SQUARE
141 ST. GEORGE'S TERRACE, PERTH

LIBRARY
DEPARTMENT OF ENVIRONMENTAL PROTECTION
WESTHALIA SQUARE
141 ST. GEORGE'S TERRACE, PERTH

VEGETATION AND FLORA
SURVEY
OF THE
SHIRE OF KALAMUNDA
VESTED RESERVES

VOLUME 2 - RESERVE SPECIES LIST

OCTOBER 1992 TO MARCH 1993

BY PAUL ARMSTRONG RESEARCH OFFICER

SHIRE OF KALAMUNDA

MARCH 1993

TABLE OF CONTENTS

	Page
SHEET 01	1
SHEET 02	4
SHEET 05	6
SHEET 06	16
SHEET 10	33
SHEET 11	39
SHEET 12	50
SHEET 14	54
SHEET 15	61
SHEET 16	80
SHEET 21	85
SHEET 22	86



THE WESTERN AUSTRALIAN NATURALIST

Vol. 20 No. 1
July 31 1995

Copyright
Registered by Australia Post
— Publication No. WBQ 0566
ISSN 0726 9609

THE BIRDS OF A REMNANT OF NATIVE VEGETATION ON THE EASTERN SWAN COASTAL PLAIN

By P.R. MAWSON* and M.C. MASSAM.
Agriculture Protection Board of Western Australia, Bougainvillea Avenue,
Forrestfield 6058.

*Present address: 5a Canni Place, Willetton, 6155

ABSTRACT

A three year study of the avifauna of a 13.8 ha. reserve on the eastern edge of the Swan Coastal Plain 15 km east of Perth, Western Australia recorded 55 species of bird, of which 21 were resident and 17 bred. Despite being surrounded by suburban housing development nearly a quarter of the species present are those normally associated with undisturbed forest communities. This study shows that, given adequate protection, even small reserves can provide suitable habitats for a large number of bird species within a suburban environment.

INTRODUCTION

Within the Perth metropolitan area few areas contain native vegetation which provides suitable habitat for native birds. Reserves such as Kings Park (400 ha), Bold Park (300+ ha.) and Whiteman Park (390 ha.) are obvious exceptions but share a common fate with smaller reserves in that they are isolated from one another. Most birds which inhabit such reserves can move out into the surrounding suburbs but few species are capable of moving from one reserve to another. For many species of birds their continued survival in the metropolitan area is dependent on the preservation and management of these reserves.

This paper describes the avifauna of a small reserve on the eastern part of the Swan Coastal Plain at Forrestfield, adjacent to the Darling Scarp (Figure 1).

SITE DESCRIPTION

The reserve (No. 29815) occurs on land

owned by the State Government and managed by the Agriculture Protection Board of Western Australia (APB). The APB complex at Forrestfield covers an area of 13.8 ha, of which approximately 8 ha. remain as natural vegetation. The site was partially cleared and developed for use by the APB in 1970.

The vegetation is mature and in most places heath forms a dense cover to about one metre high. Within the small area encompassed by the site there is considerable variation in the vegetation associations. Open Banksia woodland over low heath, open Jarrah (*Eucalyptus marginata*) woodland over low heath and low heath alone, are all represented. A detailed description of the site, a vegetation map and a complete list of the plant species present have been published previously (Robinson and Mawson 1992). The last fire to burn through the area occurred in the summer of 1969/70.

THE FLORA OF A REMNANT OF NATIVE VEGETATION ON THE EASTERN SWAN COASTAL PLAIN.

By M.H. ROBINSON and P.R MAWSON. Agriculture Protection Board of Western Australia, Bougainvillea Avenue, Forrestfield 6058.

INTRODUCTION

The increased requirement for land, to meet demands for housing and industrial development, in the immediate vicinity of Perth has led to the clearing of much of the native vegetation on the Swan Coastal Plain. Despite increasing public awareness of the need to conserve representative areas of natural bushland, in many suburbs that option no longer exists. Areas of natural bushland may however still be present but are privately owned or are vested in local, state or federal government bodies. In many cases, the conservation of the flora and fauna over significant portions of these holdings will not conflict with the landholders' operations. Providing the landholders' rights are respected, such areas can become valuable islands in the urban sprawl. Of particular importance is the fact that the isolation of such remnants from the general public affords them a level of protection that is virtually impossible to provide on public lands.

This paper describes the flora of a remnant patch of vegetation located on the Swan Coastal Plain at Forrestfield (15 km east of Perth), adjacent to the Darling Scarp.

SITE DESCRIPTION

The remnant vegetation described in this paper occurs on land owned by the State Government and managed by the Agriculture Protection Board of Western Australia (APB). The APB complex at Forrestfield covers an area totalling 13.8 ha., of which approximately 8 ha. remain as natural vegetation (Figure 1).

The area is surrounded by a 2 m high security fence and the boundaries and buildings are surrounded by graded fire-breaks. There has been minimal intrusion of introduced weed species, such as African Lovegrass (*Eragrostis curvula*) and Veldtgrass (*Ehrharta calycina*), into the areas of native vegetation.

The APB has managed the site since 1971, and during that time there have been no fires in any sections of the complex. However a fire did burn through the area in the summer of 1969/70 (Tony Oliver pers. comm.). Burnt stumps and fire scars on many of the larger Jarrah (*Eucalyptus marginata*) trees indicate that there have been other fires in the recent past. Records held by the Department of Conservation and Land Management indicate that the area was never logged for timber on a commercial basis,

however there are clear indications that small amounts of timber have been cut at some time during the past.



aceous soils of aeolian origin). There are no swamps or

forms a dense cover to about 10m. In places where the site has been passed by the site there is a dense cover of open Banksia woodland over low heath and low heath. The variation in vegetation appears to be associated with underlying soil profiles, with the open banksia woodland confined to the areas with deeper white sands. Several species of plant are associated with only one type of soil profile and as such are confined to only a few locations within the site.

METHODS

Plant specimens were collected opportunistically during the period August 1989 to November 1992. Where possible, all collections included flowering material. Duplicate specimens were taken at the time of collection, one being sent as a voucher specimen to the State Herbarium for confirmation of identification and the other retained at the APB's research laboratories. Unless otherwise noted, the identification of specimens was confirmed by staff at the Western Australian Herbarium.

Collections were limited to the naturally occurring flora and did not include any introduced species.

RESULTS AND DISCUSSION

The plant species known to be present at the site are listed in Appendix 1. Nomenclature follows Marchant *et al.* (1987). The exact identity of several specimens remains to be confirmed, but these have been treated as distinct taxa for the purpose of this paper.

A total of 182 flowering plant taxa were recorded within the APB complex, belonging to 106 genera and 34 families. The families Proteaceae (26 species), Papilionaceae (15), Myrtaceae (13), Orchidaceae (13) and Anthericaceae (12) are the richest in species (Table 1).

The presence of at least 182 species of plant from 34 families indicates that this floral community is rich and diverse. It is important to note that no species of the family Asteraceae were recorded during the survey. This is

WILD 1574 UAGA
Nr 13037 152.72

000078



-5022-1268-571000200022056-

56810952101215025000000000