

FOLLY POOL, BALDIVIS

Boundary Definition: bushland taken to cadastre/zoning boundary

SECTION 1: CADASTRAL INFORMATION

(Lots, locations and derived information to be updated in the public submission period)

Bushplan Site no. 418

Map no. 94

Map sheet series ref. no. 2033-II NW

Other Names: not known

Area (ha): total 9.39 (includes open water); bushland 7.69

Local Authorities (Suburb)
City of Rockingham (Baldivis)

Zoning

MRS: Rural, Controlled Access Highways

TPS: Public Purposes, Rural, Landscape

Lot/Location/Reserve numbers (Purpose),

Ownership Categories
State Government

Street name

1361 Baldivis Rd

Crown Reserve

SECTION 2: REGIONAL INFORMATION

LANDFORMS AND SOILS

Pinjarra Plain

Guildford Formation (Qpa: Mc2, C2)

VEGETATION AND FLORA

Vegetation Complexes

Pinjarra Plain

Serpentine River Complex

Floristic Community Types: not sampled, types not inferred

Supergroup 2: Seasonal Wetlands

WETLANDS

Wetland Types: sumpland, palusplain, artificial channel, principal channel

Natural Wetland Groups

Pinjarra Plain

Keysbrook (P.1)

Wetland Management Objectives: Resource Enhancement, Multiple Use

Swan Coastal Plain Lakes EPP: 6.9ha

THREATENED ECOLOGICAL COMMUNITIES

Not determined

SECTION 3: SPECIFIC SITE DETAIL

Landscape Features: open water, vegetated wetland

Vegetation and Flora: limited survey (DEP 1998)

Structural Units

Wetlands: *Eucalyptus rudis* Woodland over *Melaleuca raphiophylla* Low Forest; *Baumea* sp. Sedgeland;

Vegetation Condition: Very Good to Degraded

Total Flora: not known

Significant Flora: none recorded

Fauna: no known information

Linkage: no adjacent bushland; part of proposed Greenway 137 (Tingay, Alan & Associates 1997a), part of a regionally significant potential bushland/wetland linkage (Volume 2A, Map 8)

Other Special Attributes: mapped within the boundaries of the eastern side of the Swan Coastal Plain

SECTION 4: INTERNATIONAL AND NATIONAL SIGNIFICANCE

Not listed, Indicative Place on Register of the National Estate

SECTION 5: SELECTION CRITERIA AND RECOMMENDATIONS

Criteria: Representation of ecological communities, General criteria for the protection of wetland, streamline and estuarine fringing and coastal vegetation



Opportunities and/or Constraints

Opportunities: Bushplan Site/part Bushplan Site subject to Swan Coastal Plain Lakes EPP, Peel-Harvey Estuary EPP/SPP; under TPS Landscape Zoning, Crown Reserve

Constraints: under MRD regional road requirements, General Mineral Resource Area (clay)

Recommendation: The existing care, control and management intent of the reserve is endorsed. Long-term security and support for conservation management of the Bushplan Site to be enhanced by: amending the purpose of the reserve to include conservation; and applying appropriate mechanisms in consultation with the reserve management body.



418

BUSHPLAN SITES CORRECTED



WESTERN
AUSTRALIAN
PLANNING
COMMISSION



B BK 27/10/19

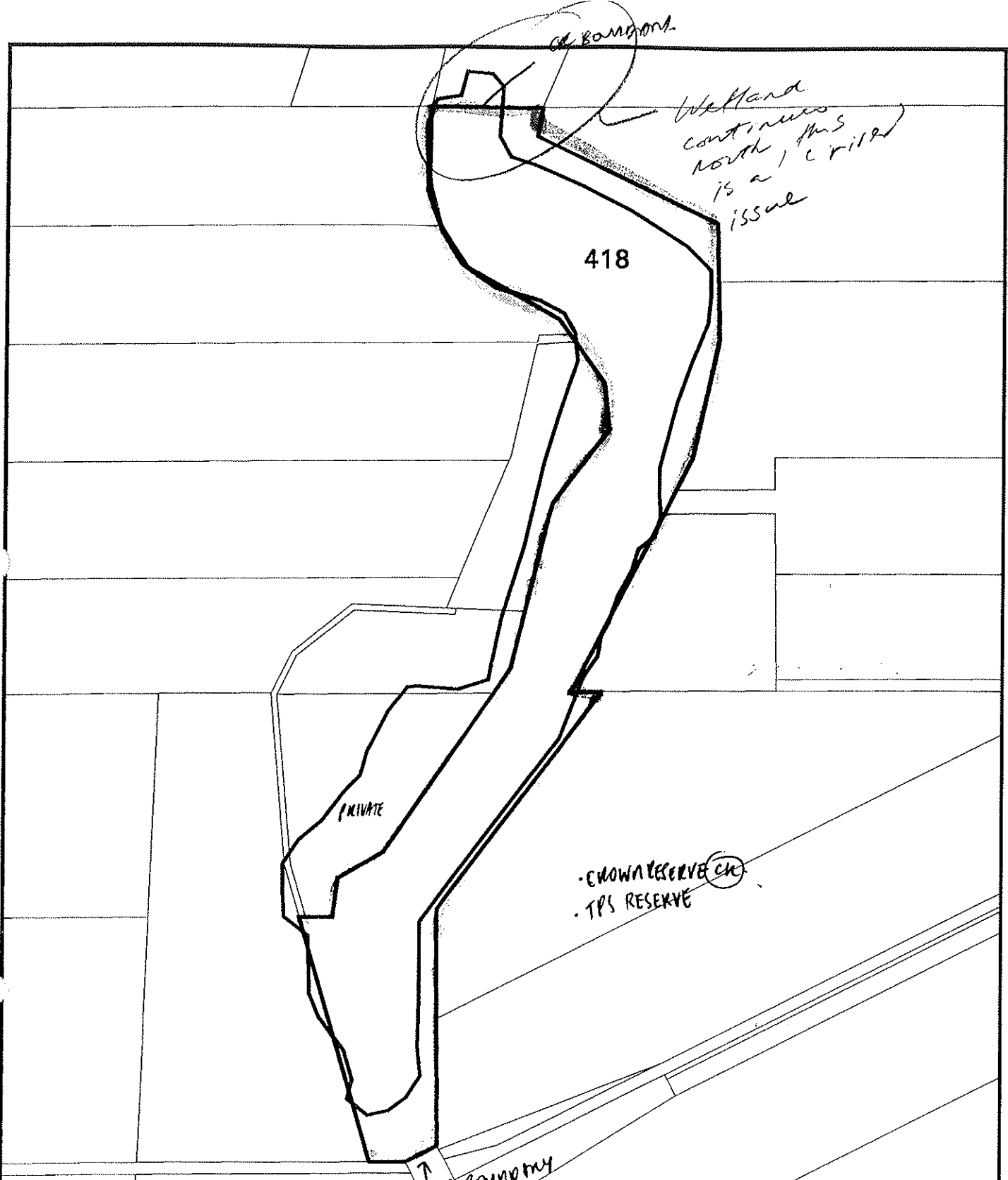

bp site 418

- Cadastre
- Bushplan sites refno 1-500 SCP BOUNDARY THEME
- AG VEG 1998 BOUNDARY THEME

MFP INTERNAL USE ONLY
 Prepared By: Andrea Zappacosta
 Prepared For:
 Map Ident: plot980608_1
 Date: 08 Jun 98
 Scale 1:4551

BJK 23/9
Should this be continued to the N to cover welland?



41
BS418
PB207

CITY OF ROCKINGHAM

Civic Boulevard, Rockingham
Western Australia

OUR REF: TP11-2-44 PM.mw
YOUR REF:

ENQUIRIES TO: Mr Monks

23rd April 1999

Manager
Environmental Planning Branch
Ministry for Planning
469 Wellington Street
PERTH WA 6000

MINISTRY FOR
PLANNING
27 APR 1999
805-2-1-32PT12
FILE

Dear Sir

Re: Submission on the Draft Perth's Bushplan

I refer to your letter dated the 27th November 1998 inviting comment on the draft Perth's Bushplan. The report and plans were presented to Council at its ordinary Meeting held on the 23rd March 1999, where it was resolved to submit the following comments, which are divided into four sections:-

1. Principles and Recommendations.
2. Comments on specific sites nominated in the City of Rockingham.
3. General Comments.
4. Implementation.

1. PRINCIPLES AND RECOMMENDATIONS

The retention of regionally and locally significant bushland is an important measure that has the support of the City of Rockingham, and the draft Perth Bushplan provides important information and recommendations to achieve this objective.

The methodology used to establish which sites are of regional significance is clear, once the reporting structure of the various volumes of the documents is understood.

Council has attended a number of briefing sessions organised by the Ministry for Planning and WAMA and these sessions have played a very important role in understanding both the implications of the recommendations of Perth Bushplan, and the views of the various parties that are affected by the Report.

SUBMISSION NO. 501

- (xiii) Bushplan Site No. 367 - Penguin, Seal, Bird and Gull Islands and Shag Rock

These sites are part of the Shoalwater Islands Marine Park and are reserved in the MRS as 'Parks and Recreation'. The sites are subject to a management strategy prepared by CALM which is responsible for protection and ongoing management.

- (xiv) Bushplan Site No. 368 - Doghill Road Bushland, Baldivis

This site contains significant remnant vegetation and is wholly contained within private ownership. It is appropriate that Council, the Bushplan Co-ordinator and the Ministry for Planning liaise with the landowners on a negotiated planning solution that enables the retention of the significant vegetation whilst catering for the aspirations of the affected landowners.

Council's Rural Land Strategy permits subdivision of lots in the precinct within which these lots are located, to a minimum size of 2ha, however, it is a usual part of any planning process to identify physical features worthy of preservation and this should also occur in this instance.

It should be noted that Council has received copies of submissions from two of the affected landowners. Council supports the need for all the above parties to meet to determine the future development potential of the various landholdings, after taking into account the significant on-site vegetation.

- (xv) Bushplan Site No. 369 - Port Kennedy

The Port Kennedy area is reserved in the MRS as 'Parks and Recreation' and is an 'A' Class Reserve for Scientific Purposes. The site is also part of the Rockingham Lakes Regional Park, for which CALM is currently preparing a Management Plan.

- (xvi) Bushplan Site No. 370 - Anstey Swamp, Karnup

Anstey Swamp is currently reserved 'Parks and Recreation' in the MRS. The swamp is also an EPP and Conservation status sumpland and is appropriately nominated as a Bushplan site.

- (xvii) Bushplan Site No. 371 - Folly Pool, Baldivis

Folly Pool is vested with the Water Corporation and as such, management responsibilities should primarily rest with this authority, in consultation with other relevant authorities, including the City. The site is a nominated EPP and Resource Enhancement status sumpland.

VOL 2 DESCRIPTION - updated

DEP SYSTEM 6/BUSHLAND - SURVEY SHEET B.J. KEIGHERY 6/97
 BUSHLAND AREA BS 418 Folly Pool SITES YES/NO
 DATE 9/1/98 RECORDERS

Observations edge transects walked along E bank

Geographic Location Latitude S Longitude E
 Reference Map

Photograph Photographer's Name Photo No

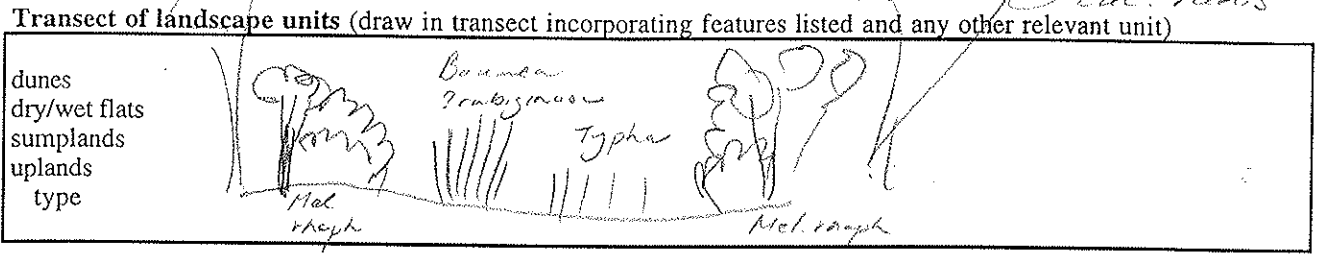

Soil - surface sub -soil
 Exposed rock type % area

FLORA/VEGETATION (list dominant and significant plants below, see over for vege association descriptions)

Eucalypts	<i>E. calophylla</i>	<i>E. wandoo</i>	<i>E. marginata</i>	<i>E. todtianna</i>	<i>E. rudis</i>
	<i>E. decipiens</i>	<i>E. drummondii</i>	<i>E. haematoxylon</i>	<i>E. lanepoolei</i>	<i>E. gomphocephala</i>
	<i>E. accedens</i>	<i>E. patens</i>	<i>E. laeliae</i>	<i>E. megacarpa</i>	
Sheoaks	<i>Allocasuarina fraserana</i>		<i>Casuarina obesa</i>		
Banksia	<i>B. attenuata</i>	<i>B. menziesii</i>	<i>B. prionotes</i>	<i>B. illicifolia</i>	<i>B. grandis</i> <i>B. littoralis</i>
Melaleuca	<i>M. preissii</i>	<i>M. raphiophylla</i>	<i>M. lanceolata</i>	<i>M. cuticularis</i>	
Others	<i>Callitris preissii</i>				
Mallees	Eucalypts	<i>E. argutifolia</i>	<i>E. petrensis</i>	<i>E. decurva</i>	<i>E. foecunda</i> <i>E. latens</i>

SIGNIFICANT SPECIES / DOMINANT SPECIES

Euc rudis forest over *Mel raph* low forest
Typha wet and *Baumea rambisnosa*

(see over for vegetation descriptions)

Vegetation Condition - Keighery 1994 (Trudgen 1993) (show range and indicate predominant class)

1 = 'Pristine' (Excellent)
 2 = Excellent (Very Good) *Good regen of Mel / Euc*
 3 = Very Good (Good) *scattered after on banks*
 4 = Good (Poor) *No weevil in restoration apparent*
 5 = Degraded (Very Poor)
 6 = Completely Degraded

Specific aspects of disturbance

partial clearing

weeds (list):

selective removal of species: timber cutting mowing fire grazing dieback %area

fire frequency:

'enrichment plantings' (list)

animal impact: horse foxes rabbits cats dogs goats pigs overgrazing by native mammals

soil movement: mining dumping rubbish dumping roadworks

changes in water regimes: flooding drainage watering nutrient influx

Tracks: fire breaks walk trails off road vehicle use animal tracks

Service corridors: SEC Main Roads Water Authority. Telecom

Other

(m) Twin Bartram Swamp, Hird Road Swamp, Solomon Road Swamp and Gibbs / Russell Swamp in Jandakot. These small wetlands are the best remaining examples of the Jandakot suite of wetlands. They are reserved in the local open space system and are well documented by V. Semeniuk in the report to Gold Estates on Wetlands East of Thomsons Lake.

(n) Creery Wetlands. These important samphire marshes should be added to C50 (Peel Inlet). Their values are fully documented in the Bamford Report which was attached to the proposal for the Harbour City Canal Estate.

(o) Vasse - Wonnerup Regional park. The whole area of the Broadwater, Deadwater and the Vasse Wonnerup estuaries should become a regional park. This concept should be proposed in the System Six update.

(p) Cockburn Wetlands - Eastern Chain M93. The boundaries of this area should be modified to coincide with the boundaries of the Beeliar Regional Park.

(q) Folly, Maramanup, Duck and Beenyup Pools, Baldivis. These small pools on the Folly Drain are important breeding and feeding areas for wildlife. The Folly Drain is an important wildlife corridor and its conservation value should be recognised in the System Six Report.

(r) West Corio Swamp, Karnup. This is an important breeding area for the straw-necked ibis. It should be protected. The EPA did an assessment of it several years ago when sand mining was proposed.

(s) Serpentine River Valley. The entire length of the Serpentine River and its flood plain should be listed in the System Six Report. It is a major wildlife corridor and a habitat for many species. It should be recommended as a regional park.

(t) Wilbinga and Guilderton. Two large blocks of coastal heathland south of the mouth of the Moore River. The Wilbinga block was proposed as a land swap for M1 which has been approved for subdivision. These blocks are adjacent to C12 and together provide an outstanding opportunity to conserve the best remaining transect of coastal vegetation in the northern part of System Six.

If you require further information about any aspect of this submission, please contact me. I would like some feedback on your decision about these areas.

Yours faithfully,



Philip Jennings
President



Register of the National Estate Database

[[RNE search](#) | [AHC Home](#) | [Disclaimer](#) | ©]

Location of Folly Pool , Rockingham WA

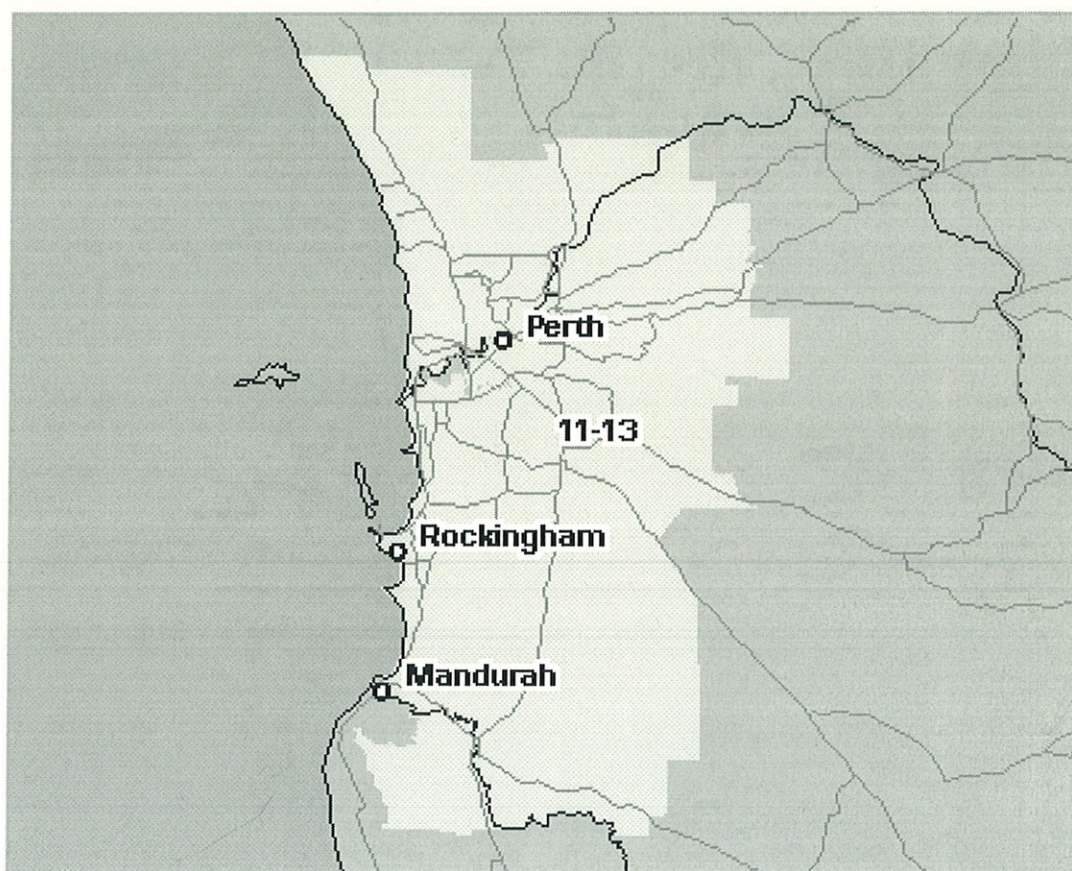
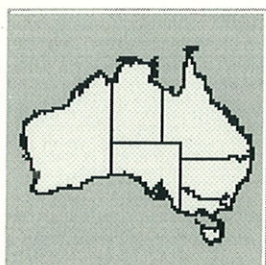

Class: Natural

Legal Status: Indicative Place

Database Number: 017280

File Number: 5/12/022/0014

Statement of Significance: The place is considered to have important conservation and recreation values. This wetland is important in the maintenance of ongoing ecological processes, mainly as a bird habitat site. The place is considered to be an important summer refuge site for waterbirds. Folly Pool is also part of a group of wetlands used by waterbirds in the Rockingham area. It contains vegetation communities which have now become rare within the Pinjarra Plain System, due to extensive agricultural clearing. Folly Pool also has important aesthetic characteristics. The WA Aboriginal Sites Department notes that this area contains Aboriginal Artefacts.

Description : Folly Pool is mesoscale permanent artificial billabong which is part of the Swan River Wetland

Suite (Semeniuk and Semeniuk 1991). It is situated in the City of Rockingham on the Swan Coastal Plain about 40 km south of Perth in Western Australia. Folly Pool is located on the Pinjarra Plain, a Pleistocene to Holocene system of alluvial flats (Bettenay et al. 1960). The wetland's soils consist of a black plastic clay. Maramanup Pool is part of a drainage line which flows into the Serpentine River about 6 km to the south. This site, which was once a sumpland, has been altered to become a lake with an artificially maintained water level. The wetland is 0.4 m to 1.4 m depth covering an area of about 50 ha. The water salinity varies from fresh to hyposaline - poikilohaline. Folly Pool is characterised by moving water in winter and sparse vegetation. The place contains vegetation communities representative of the Wetlands on the Pinjarra Plain Vegetation System (Beard 1981). The vegetation is a zoniform of BAUMEA Rushland, TYPHA ORIENTALIS sedgelands and MELALEUCA RHAPHIOPHYLLA forest (Semeniuk and Semeniuk 1991). Grassland is also present. There is generally no native vegetation on the uplands surrounding this wetlands. Aquatic plant growth has been noted from Folly Pool. The areas open water and surrounding vegetation attracts a wide range of waterbirds. 21 species have been recorded and a further 19 may be expected to be present (Semeniuk and Semeniuk 1991). Waterbirds recorded include dabbling ducks and members of Rallidae especially Dusky Moorhens and Purple Swamphens. Species which use the open water areas and TYPHA zone habitats for feeding include dabbling ducks, coot, spoonbill. The fringing zone of inundated MELALEUCA woodland are used for roosting by species such as darter, cormorants and herons.

Condition and Integrity : The place is located on privately own land used primarily for rural activities. Native vegetation is located within the wetland, however the surrounding upland vegetation has been totally modified or cleared.

Location : Adjacent to Folly Road, Baldivis: from the south -east corner of lot 922, the boundary runs generally north, following the eastern boundaries of lots 922, 921 an unnumbered lot, lots 549-536 to the north-eastern corner of Lot 535, then due east to a point on the western boundary of an unnumbered lot, thence generally south, following the western boundaries of another unnumbered lot, then lots 568,903-911,923,924, to Folly Road then due west to the start.

The Register of the National Estate has been compiled since 1976. The Commission is in the process of developing and/or upgrading official statements of significance for places listed prior to 1991.

Report produced : 22/7/1997
RNEDB URL : <http://www.ahc.gov.au/net/rnedb.html>

[[RNE search](#) | [AHC Home](#) | [Disclaimer](#) | [©](#)]

