

MARAMANUP POOL, BALDIVIS

Boundary Definition: bushland taken to cadastre/zoning boundary

SECTION 1: CADASTRAL INFORMATION

(Lots, locations and derived information to be updated in the public submission period)

Bushplan Site no. 419

Map no. 94

Map sheet series ref. no. 2033-II NW

Other Names: not known

Area (ha): total 17.5 (includes open water); bushland 13.8

Local Authorities (Suburb)

Zoning

City of Rockingham (Baldivis)

MRS: Rural

TPS: Public Purposes

Ownership Categories

State Government

Lot/Location/Reserve numbers (Purpose), Street name

1360 Young Rd

Crown Reserve

SECTION 2: REGIONAL INFORMATION

LANDFORMS AND SOILS

Pinjarra Plain

Guildford Formation (Qpa: Mc2)

VEGETATION AND FLORA

Vegetation Complexes

Pinjarra Plain

Serpentine River Complex

Floristic Community Types: not sampled, types not inferred

Supergroup 2: Seasonal Wetlands

WETLANDS

Wetland Types: sumpland, palusplain, creek

Natural Wetland Groups

Pinjarra Plain

Keysbrook (P.1)

Wetland Management Objectives: Resource Enhancement, Multiple Use

Swan Coastal Plain Lakes EPP: 5.6ha

THREATENED ECOLOGICAL COMMUNITIES

Not determined

SECTION 3: SPECIFIC SITE DETAIL

Landscape Features: open water, vegetated wetland

Vegetation and Flora not surveyed from aerial photography interpretation, expected to be similar to BS418

Vegetation Condition: Good (Connell 1995)

Total Flora: not known

Significant Flora: none recorded

Fauna: no systematic survey. Significant mammal species: Quenda (Friend 1996 D)

Linkage: no adjacent bushland; part of proposed Greenway 137 (Tingay, Alan & Associates 1997a); part of a regionally significant potential bushland/wetland linkage (Volume 2A, Map 8)

Other Special Attributes: mapped within the boundaries of the eastern side of the Swan Coastal Plain

SECTION 4: INTERNATIONAL AND NATIONAL SIGNIFICANCE

Not listed, Indicative Place of the Register of the National Estate

SECTION 5: SELECTION CRITERIA AND RECOMMENDATIONS

Criteria: Representation of ecological communities, Rarity, General criteria for the protection of wetland, streamline and estuarine fringing and coastal vegetation

Opportunities and/or Constraints

Opportunities: Bushplan Site/part Bushplan Site subject to Swan Coastal Plain Lakes EPP, Peel-Harvey Estuary EPP/SPP, Crown Reserve

Constraints: under General Mineral Resource Area (clay)

Recommendation: The most appropriate mechanism for the protection of this Bushplan Site be considered through the public comment period in consultation with the land owner(s).



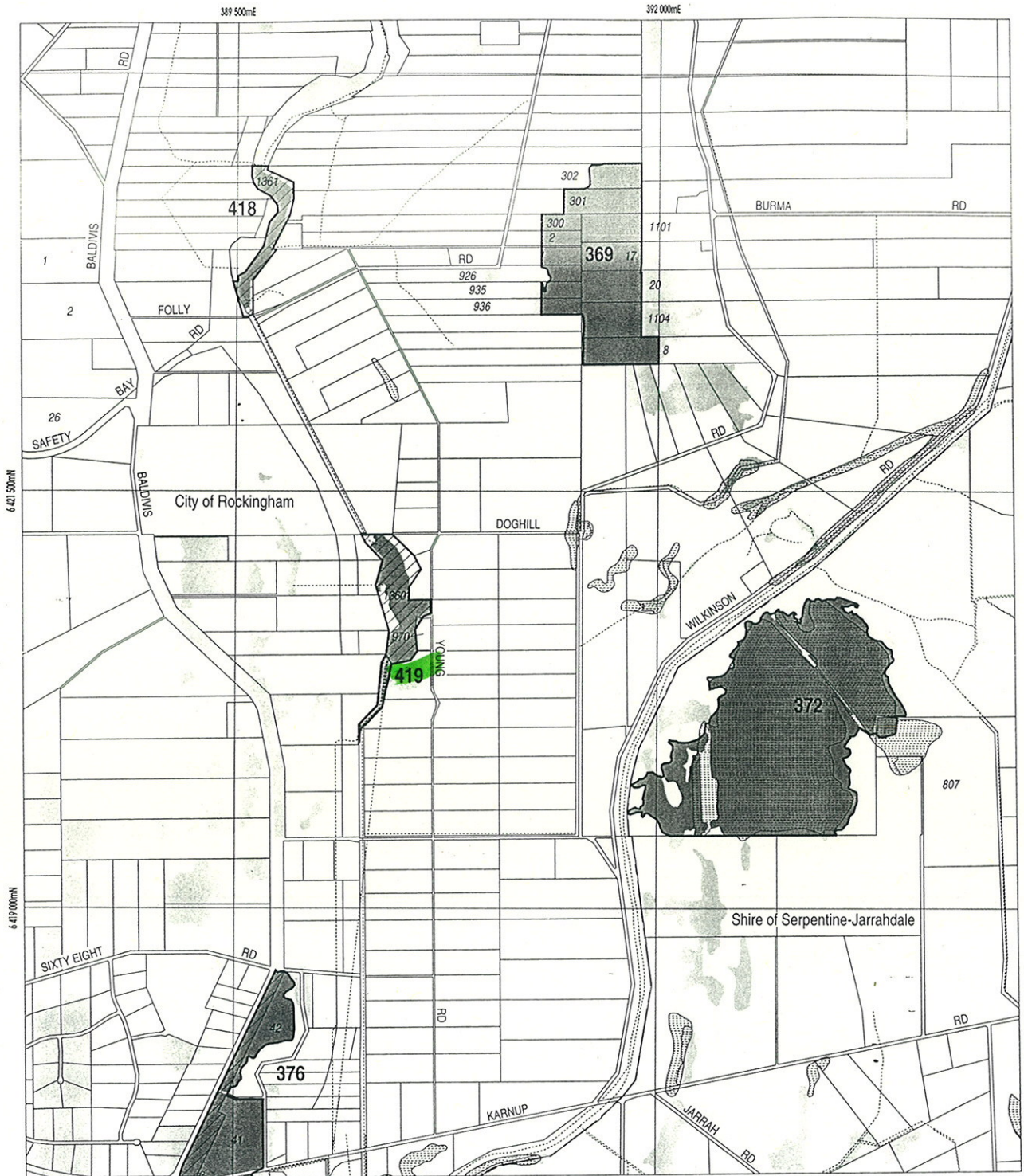

LEGEND

- Bushplan Sites With Regionally Significant Bushland
- Other Native Vegetation
- Conservation Category Wetlands
- Bushplan Sites With Some Existing Protection
- 696 Lot Number, Location Map
- Channel Wetlands
- Local Government Boundary

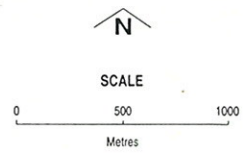
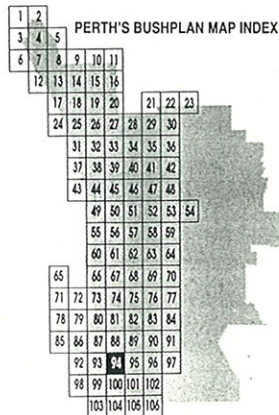
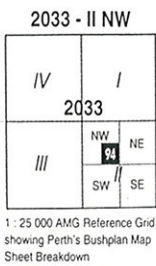

Produced by Project Mapping Section
 Land Information Branch, Ministry for
 Planning, Perth W.A. November 1998
 ntw-map17\\environ\bushplan\bushv2_94.dgn

Cadastral Data supplied by Department
 of Land Administration, W.A.

Wetlands Data supplied by
 Water and Rivers Commission

Native Vegetation Extent for Study Area
 supplied by Agriculture Western Australia

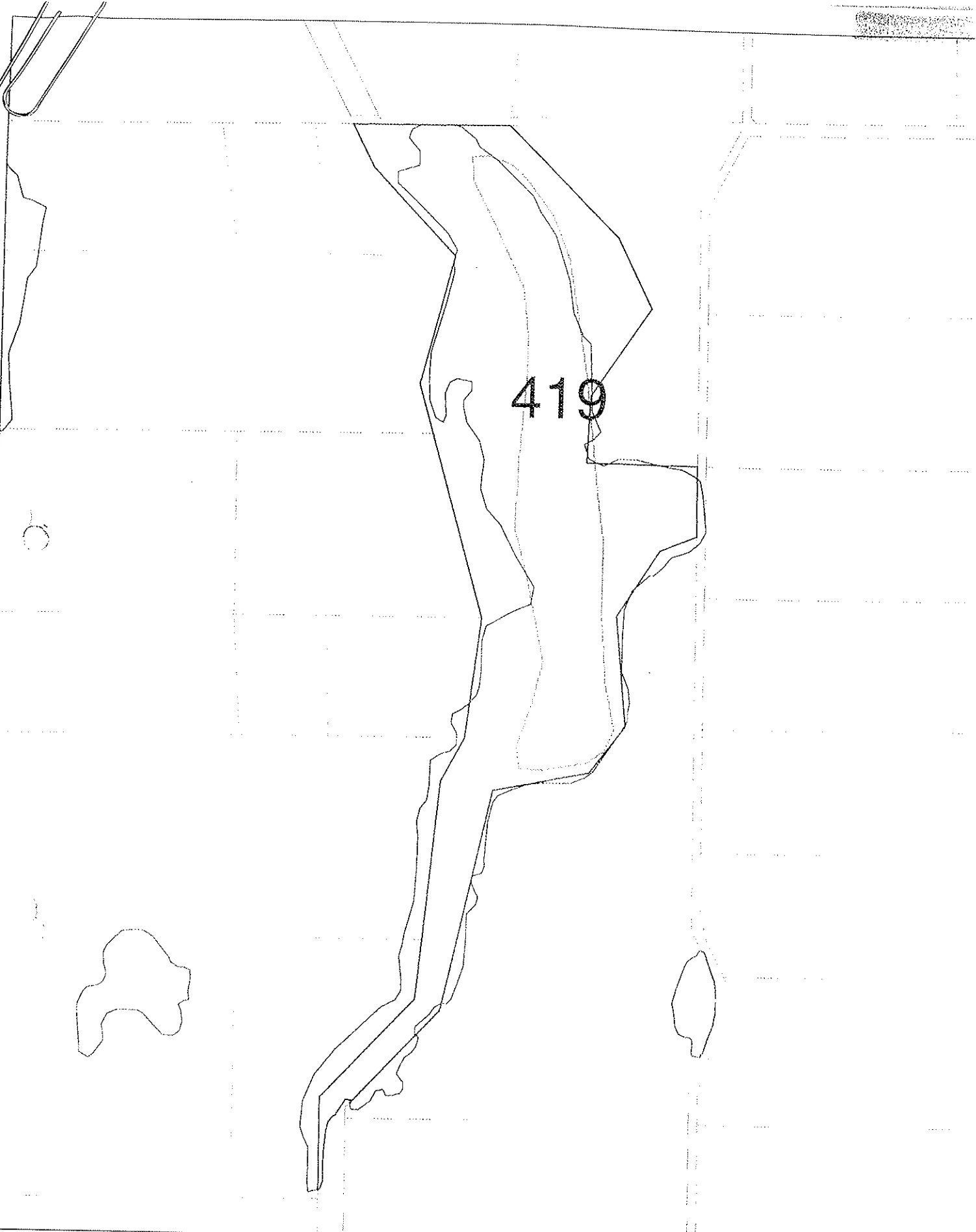

BUSHPLAN SITES CORRECTED



**WESTERN
AUSTRALIAN
PLANNING
COMMISSION**

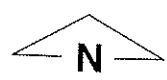

B BK 28/3/98

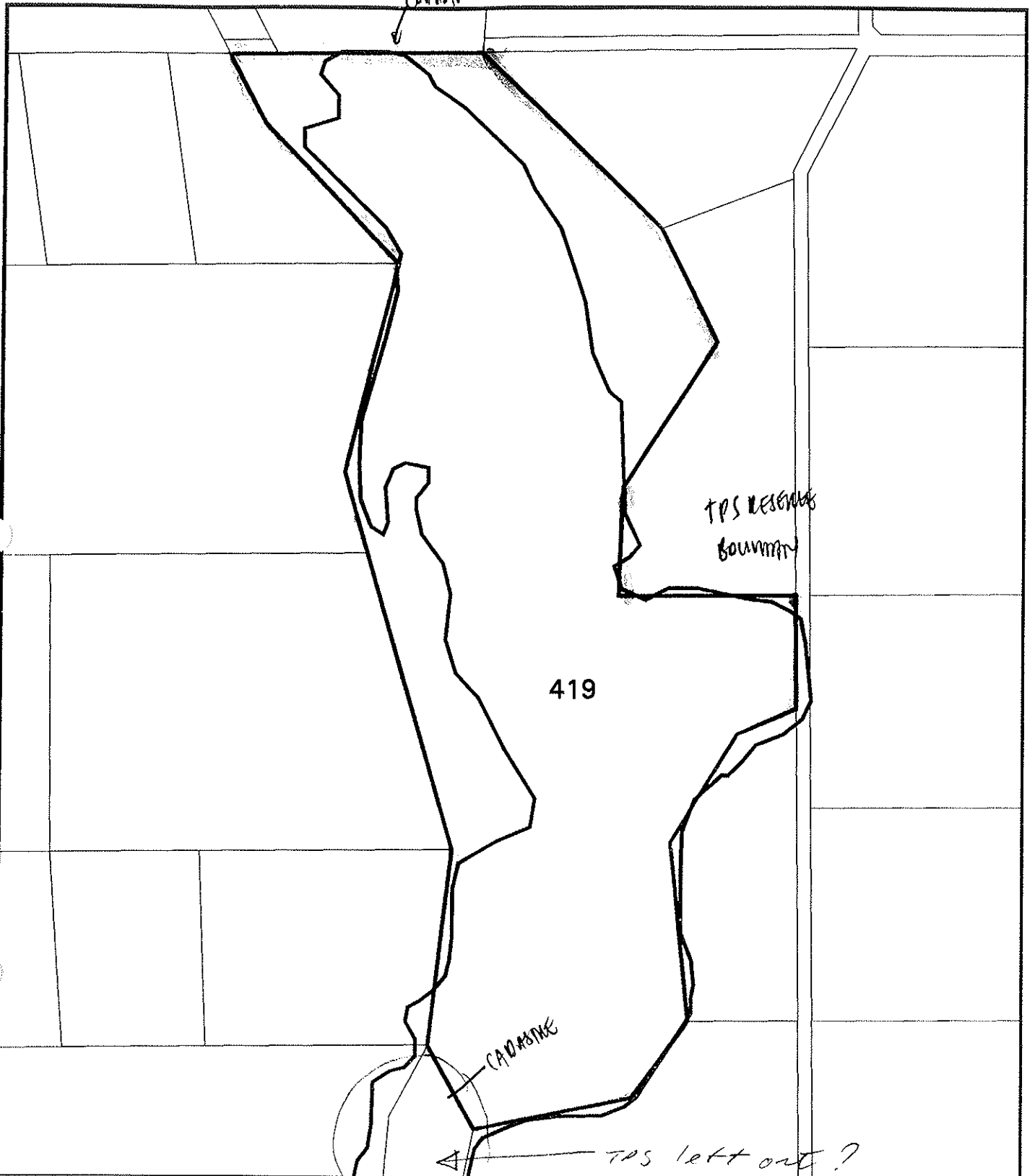

bp site 419

- Cadastre
- Bushplan sites refno 1-500 SCP BOUNDARY THEME
- AG VEG 1998 BOUNDARY THEME

NT 25/9
 OK
 add TPS renumber
 where veg exists

MFP INTERNAL USE ONLY
 Prepared By: Andrea Zappacosta
 Prepared For:
 Map Ident: plot980608_1
 Date: 08 Jun 98
 Scale 1:3925

✓ OK
 Do you want to include
 more of TPS RESERVE TO SOUTH





BS419

41
PB208

CITY OF ROCKINGHAM

Civic Boulevard, Rockingham
Western Australia

OUR REF: TP11-2-44 PM.mw
YOUR REF:

ENQUIRIES TO: Mr Monks

23rd April 1999

Manager
Environmental Planning Branch
Ministry for Planning
469 Wellington Street
PERTH WA 6000

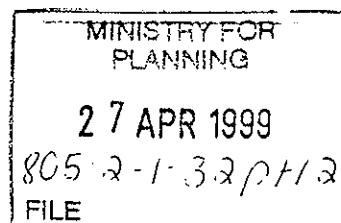

Dear Sir

Re: Submission on the Draft Perth's Bushplan

I refer to your letter dated the 27th November 1998 inviting comment on the draft Perth's Bushplan. The report and plans were presented to Council at its ordinary Meeting held on the 23rd March 1999, where it was resolved to submit the following comments, which are divided into four sections:-

1. Principles and Recommendations.
2. Comments on specific sites nominated in the City of Rockingham.
3. General Comments.
4. Implementation.

1. PRINCIPLES AND RECOMMENDATIONS

The retention of regionally and locally significant bushland is an important measure that has the support of the City of Rockingham, and the draft Perth Bushplan provides important information and recommendations to achieve this objective.

The methodology used to establish which sites are of regional significance is clear, once the reporting structure of the various volumes of the documents is understood.

Council has attended a number of briefing sessions organised by the Ministry for Planning and WAMA and these sessions have played a very important role in understanding both the implications of the recommendations of Perth Bushplan, and the views of the various parties that are affected by the Report.

SUBMISSION NO. 501

(xviii) Bushplan Site No. 119 - Maramanup Pool, Baldivis

Maramanup Pool is vested with the Water Corporation and, as such, management responsibilities should primarily rest with this authority in consultation with other relevant authorities, including the City. The site is a nominated EPP and Resource Enhancement status sumpland.

3. GENERAL COMMENTS

The following more general comments are provided below:-

- Several areas of native vegetation are not accurately mapped; including cleared areas on the Port Kennedy golf course and cleared areas at Secret Harbour, St Michel Estate and Gngangara Drive Shopping Centre.
- The CALM land at Eighty/Sixty Eight Roads is a pine plantation and its inclusion in the Bushplan as 'Other Native Vegetation' is inappropriate.
- Concerns are raised that nomination of certain Bushplan sites will undermine Council's objectives in retaining significant local vegetation. There may be a presumption that, if an area of vegetation is not a Bushplan site, it is not significant and therefore can be removed.
- Clarification is required regarding the legal status of a Bushplan listing in terms of whether such listing provides sufficient grounds in refusing an application for development.
- The validity of Bushplan sites covered by the Basic Raw Materials Policy and whether raw material extraction overrides any Bushplan designation needs to be clarified.
- Clarification on clearing controls should be expanded. Clearing of 1ha or more of land requires the Commissioner of Soil Conservation and Council approval, however, any clearing could be considered to be 'development' or a 'change of use'. Formal approval should therefore be given for any clearing.

4. IMPLEMENTATION

The major issue with Perth Bushplan is how the recommendations are to be implemented. Given that only \$100 million has been allocated for acquisition of Bushplan sites over ten years and that the priority for acquisition are the sites affected by urban or commercial zonings, it is apparent that the majority of the sites will be protected by negotiated outcomes. Local Government is undoubtedly the most affected agency in resolving the implementation of the Bushplan recommendations, as far as specific sites are concerned.

In this regard, the lack of information contained within Perth Bushplan on the type of planning solutions that could be pursued is disappointing. A list of examples would greatly assist.

WILD 1574 UAGA
Nr 13037 152.72

100093

- 5 0 2 2 - 1 2 6 8 - 5 5 1 0 0 0 1 8 0 0 2 8 0 5 6 -

1 5 1 1 3 9 7
0 9
5 2
1 0 0 2
5 5 5 2 0 0
0 0 0 0 0 0