

TEA TREE CLOSE BUSHLAND, JANDAKOT

Boundary Definition: protected area/bushland group boundary

SECTION 1: CADASTRAL INFORMATION

(Lots, locations and derived information to be updated in the public submission period)

Bushplan Site no. 458 **Map no.** 67, 74 **Map sheet series ref. no.** 2033-I NW, 2033-I SW

Other Names: not known

Area (ha): total 44.7 (includes open water); bushland 23.8

Local Authorities (Suburb)
City of Cockburn (Jandakot)

Zoning
MRS: Parks and Recreation Restricted, Important Regional Roads
TPS: Landscape

Ownership Categories
State Government, Private (commercial organisation)

Lot/Location/Reserve numbers (Purpose), Street name
40, 505 Tea Tree Cl; 0, 10, 227, 228, 231 Forrest Rd; 228 North Lake Rd; 12 Beelihar Dr; 1 Poletti Rd; 0, 27950 street not identified
Crown Reserve

SECTION 2: REGIONAL INFORMATION

LANDFORMS AND SOILS

Bassendean Dunes

Bassendean Sands (Qpb: S8)

Bassendean Dunes/Pinjarra Plain

Bassendean Sands over Guildford Formation (Qpb/Qpa:S10)

Wetlands (within the Bassendean Dunes/Pinjarra Plain)

Holocene Swamp Deposits (Qhw: Ms5)

VEGETATION AND FLORA

Vegetation Complexes

Bassendean Dunes

Bassendean Complex — Central and South

Floristic Community Types: *not sampled, types inferred

Supergroup 2: Seasonal Wetlands

*4 *Melaleuca preissiana* damplands

Supergroup 3: Uplands centred on Bassendean Dunes and Dandaragan Plateau

*23a Central *Banksia attenuata* — *B. menziesii* woodlands

WETLANDS

Wetland Types: sumpland, dampland

Natural Wetland Groups

Bassendean Dunes

Jandakot (B.3)

Wetland Management Objectives: Resource Enhancement, Multiple Use

Swan Coastal Plain Lakes EPP: 1.9 ha

THREATENED ECOLOGICAL COMMUNITIES

Not assessed

SECTION 3: SPECIFIC SITE DETAIL

Landscape Features: open water, vegetated wetland, vegetated uplands

Vegetation and Flora limited survey (DEP 1998)

Structural Units

Uplands: *Eucalyptus todtiana* Low Woodland with occasional *Banksia menziesii*, *B. attenuata* and *Nuytsia floribunda*

Wetlands: *Banksia littoralis* Low Open Woodland, *Melaleuca preissiana* Closed Forest; *Melaleuca ?incana* Closed Tall Scrub

Scattered Native Plants: *Melaleuca preissiana* Low Open Woodland — regionally significant vegetation recognised as being included in the area of Bushplan Site in need of protection

Vegetation Condition: Excellent to Very Good, with areas of severe localised disturbance.

Total Flora: not known

Significant Flora: none recorded

Fauna: no systematic survey. Significant mammal species: Quenda (Friend 1996 D)

Linkage: adjacent bushland to the east and west; part of proposed Green Tree 96, 95 (Tingay, Alan & Associates 1997a)



SECTION 4: INTERNATIONAL AND NATIONAL SIGNIFICANCE

Not listed

SECTION 5: SELECTION CRITERIA AND RECOMMENDATIONS

Criteria: Representation of ecological communities, Rarity, General criteria for the protection of wetland, streamline and estuarine fringing and coastal vegetation

Opportunities and/or Constraints

Opportunities: Bushplan Site/part Bushplan Site subject to Swan Coastal Plain Lakes EPP; under MRS Parks and Recreation Restricted Zoning and TPS Landscape Zoning, Crown Reserve

Constraints: private land; under MRD regional road requirements

Recommendation: The most appropriate mechanism for the protection of this Bushplan Site be considered through the public comment period in consultation with the land owner(s). (Those parts of the Bushplan Site reserved for Parks and Recreation in the Metropolitan Region Scheme should be made a Crown Reserve with a conservation purpose).



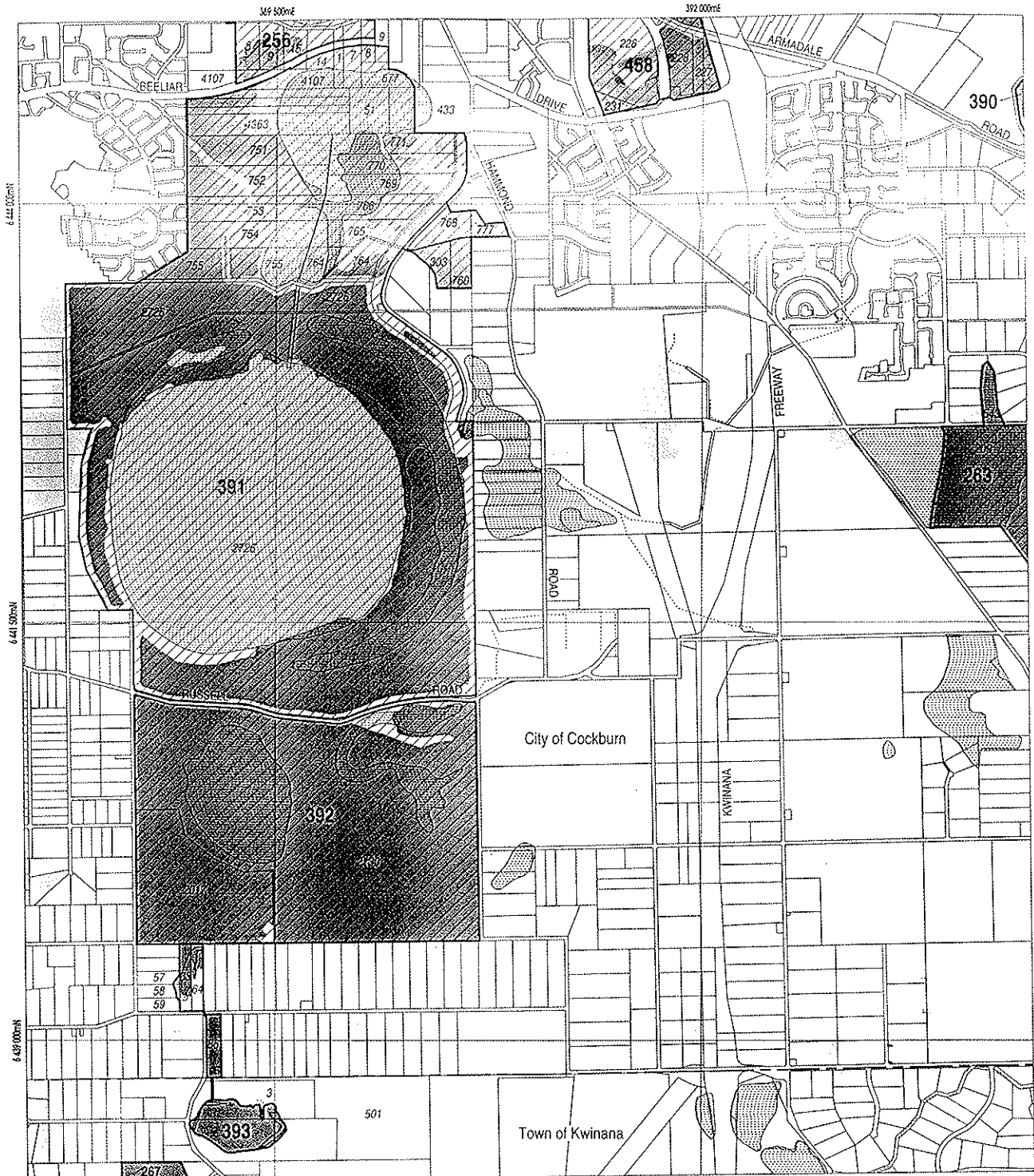

LEGEND

- 472** Bushplan Sites With Regionally Significant Bushland
- Other Native Vegetation
- Conservation Category Wetlands
- Bushplan Sites With Some Existing Protection
- 696** Lot Number, Location Number
- Channel Wetlands
- Local Government Boundary

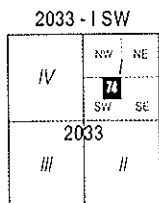

1 : 25 000 AMG Reference Grid showing Perth's Bushplan Map Sheet Breakdown

PERTH'S BUSHPLAN MAP INDEX

1	2
3	4
6	7
8	9
10	11
12	13
14	15
16	18
17	18
19	20
21	22
23	24
25	26
27	28
29	30
31	32
33	34
35	36
37	38
39	40
41	42
43	44
45	46
47	48
49	50
51	52
53	54
55	56
57	58
59	60
61	62
63	64
65	66
67	68
69	70
71	72
73	74
75	76
77	78
79	80
81	82
83	84
85	86
87	88
89	90
91	92
93	94
95	96
97	98
99	100
101	102
103	104
105	106



SCALE

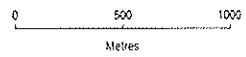

Produced by Project Mapping Section
 Land Information Branch, Ministry for
 Planning, Perth W.A. November 1998
 nw-map9/environ/bushplan/bushv2_74.dgn
 Cadastral Data supplied by Department
 of Land Administration, W.A.
 Wetlands Data supplied by
 Water and Rivers Commission
 Native Vegetation Extent for Study Area
 supplied by Agriculture Western Australia

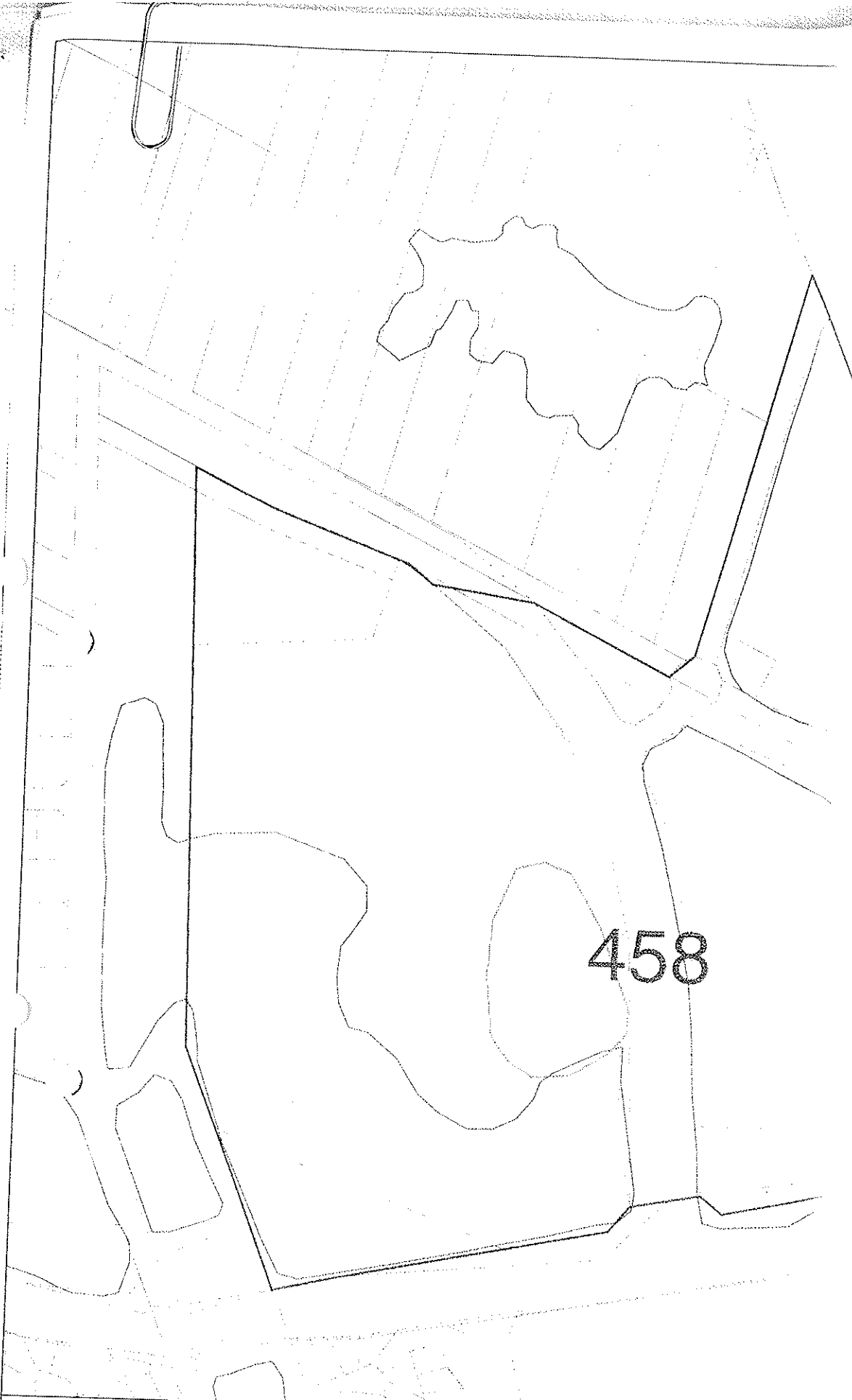

BUSHPLAN SITES CORRECTED



**WESTERN
AUSTRALIAN
PLANNING
COMMISSION**





B 76 28/10/92



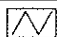

bp site 458

-  Cadastre
-  Bushplan sites refno 1-500 SCP BOUNDARY THEME
-  AG VEG 1998 BOUNDARY THEME

MFP INTERNAL USE ONLY
 Prepared By: Andrea Zappacosta
 Prepared For:
 Map Ident: plot980608_1
 Date: 08 Jun 98
 Scale 1:5308

Cult Asked some weeks ago for Mastepan

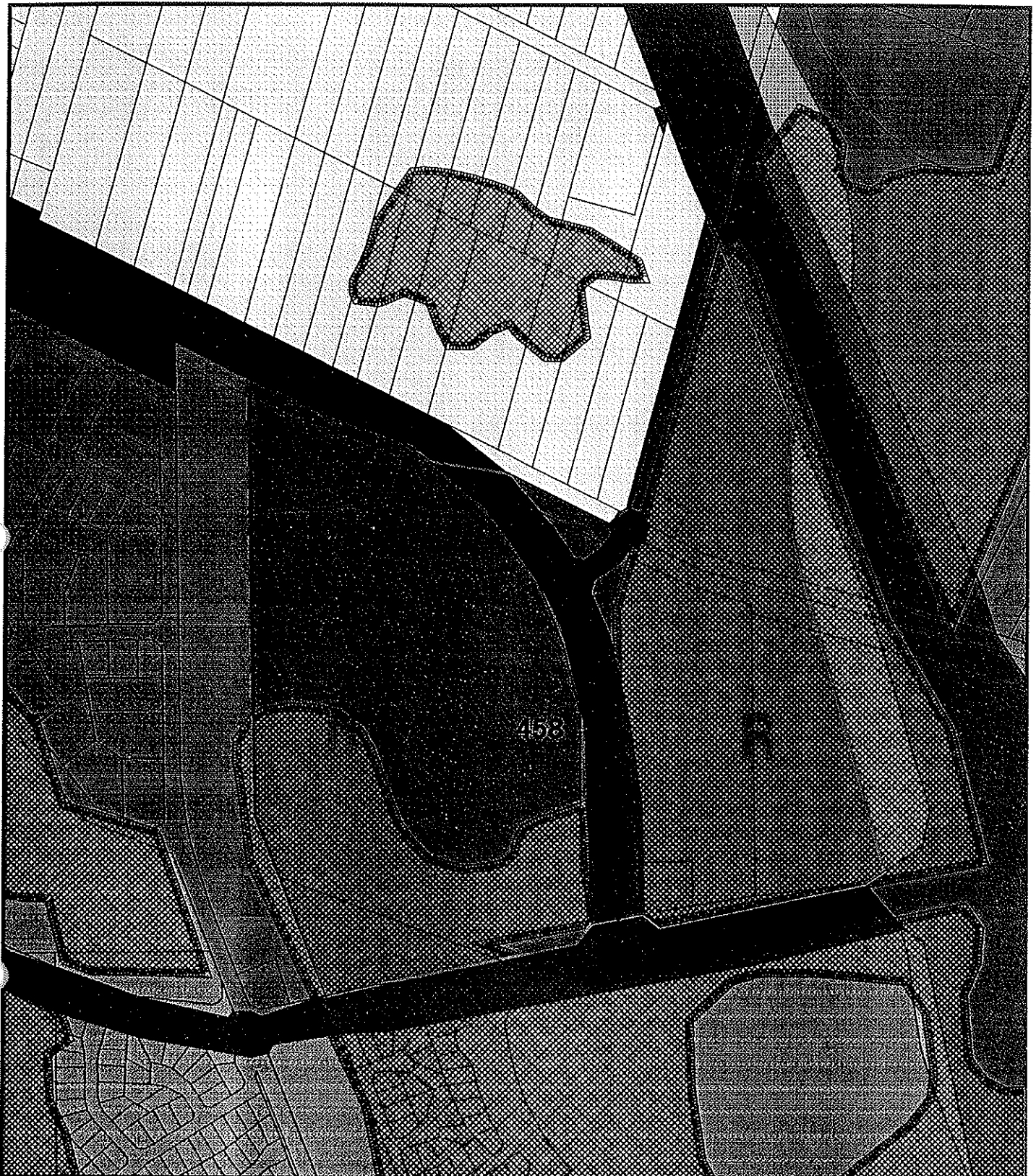

Bushplan Site 458
Thomson's Lake Area

KB. Park Area.
SEE G. McKeown for MASTERPLAN Proposal

MFP INTERNAL USE ONLY









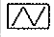

Prepared By: Andrea Zappacosta

Prepared For: Reference Purposes

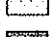
Map Ident: plot980728_1









Date: 28 Jul 98

Scale 1:6718

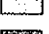
- | | | | |
|---|---|---|--------------------------------------|
|  | Bushplan sites refno 1-500 SCP BOUNDARY THEME |  | Bassendean Complex-Central And South |
|  | Cadastral | | |
|  | URBAN | | |
|  | URBAN DEFERRED | | |
|  | INDUSTRIAL | | |
|  | PARKS & RECREATION RESTRICTED | | |
|  | RAILWAYS | | |
|  | CONTROLLED ACCESS HIGHWAYS | | |
|  | IMPORTANT REGIONAL ROADS | | |



Bushplan Site 458
Thomson's Lake Area

-  Bushplan sites refno 1-500 SCP BOUNDARY THEME
-  Cadastre
-  URBAN
-  URBAN DEFERRED
-  INDUSTRIAL
-  PARKS & RECREATION RESTRICTED
-  RAILWAYS
-  CONTROLLED ACCESS HIGHWAYS
-  IMPORTANT REGIONAL ROADS
-  Bassendean Complex-Central And South

MFP INTERNAL USE ONLY
 Prepared By: Andrea Zappacosta
 Prepared For: Reference Purposes
 Map Ident: plot980728_1
 Date: 28 Jul 98
 Scale 1:6718

The land is zoned "urban" but it may be possible to achieve a land swap which meets with the owner's approval.

We recommend you extend site 391 to include the above bushland and Hird Road Swamp.

Map 74 & 67 - Bushplan Site

I suggest this site be extended further to the west to abut Poletti Road and include the corridor of bush below the Western Power transmission lines. This strip of bush is regenerating strongly after being cleared for the Transmission Lines many years ago. It contains Banksia Woodland, various native shrubs and woolybush. Orchid numbers are increasing together with other flora. Particularly, I note the presence of many Honeyeaters, Wrens and other birds utilising this portion.

From my examination of the Greenways Scheme it maybe that the land is ear marked for that Scheme. but I are keen to have it properly secured under Bushplan.

I recommend extension of site 458 to include the western power transmission line corridor.

Map 74 - SW & SE Quadrant:

At the bottom on Map 74 the shaded area (having the words Town of Kwinana) is bushland worthy of consideration of retention of Bushplan. Part of the land is subject to a current sand mine. ***I suggest inclusion of the area of excellent Banksia Woodland extending through to Wattlelup Road.***

Map 74 - Bushplan Site

The above site includes the Harry Wearing Marsupial Reserve. Adjoining that reserve on its eastern side bounded by Russell Road on its north side is another large bushland parcel having a 'damp land', diverse flora and shrubs and Banksia woodland. I recommend **extension** of Bushplan site 392 to include this additional parcel.

Map 74 - South East Quadrant:

The bushland on the south east corner of Gibbs Road and Lyon Road, east of the Kwinana Freeway is good quality Banksia woodlands. It is on an important portion of the Jandakot Groundwater mound and its coverage under Bushplan would help the community realise its aspirations for an unspoilt water supply. The native bird population in this section is excellent.

LIFE FORM/HEIGHT CLASS	CANOPY COVER			
	DENSE 70-100%	MID-DENSE 30-70%	SPARSE 10-30%	VERY SPARSE 2-10%
Trees >30m Trees 15-30m Trees 5-15m Trees <5m	Dense Tall Forest Dense Forest Dense Low Forest A Dense Low Forest B	Tall Forest Forest Low Forest A Low Forest B	Tall Woodland Woodland Low Woodland A Low Woodland B	Open Tall Woodland Open Woodland Open Low Woodland A Open Low Woodland B
Mallee tree form Mallee shrub form	Dense Tree Mallee Dense Shrub Mallee	Tree Mallee Shrub Mallee	Open Tree Mallee Open Shrub Mallee	Very Open Tree Mallee Very Open Shrub Mallee
Shrubs >2m Shrubs 1.5-2.0m Shrubs 1.0-1.5m Shrubs 0.5-1.0m Shrubs 0.0-0.5m	Dense Thicket Dense Heath A Dense Heath B Dense Low Heath C Dense Low Heath D	Thicket Heath A Heath B Low Heath C Low Heath D	Scrub Low Scrub A Low Scrub B Dwarf Scrub C Dwarf Scrub D	Open Scrub Open Low Scrub A Open Low Scrub B Open Dwarf Scrub C Open Dwarf Scrub D
Mat plants Hummock Grass Bunch grass >0.5m Bunch grass <0.5m Herbaceous spp.	Dense Mat Plants Dense Hummock Grass Dense Tall Grass Dense Low Grass Dense Herbs	Mat Plants Mid-Dense Hummock Grass Tall Grass Low Grass Herbs	Open Mat Plants Hummock Grass Open Tall Grass Open Low Grass Open Herbs	Very Open Mat Plants Open Hummock Grass Very Open Tall Grass Very Open Low Grass Very Open Herbs
Sedges >0.5m Sedges <0.5m	Dense Tall Sedges Dense Low Sedges	Tall Sedges Low Sedges	Open Tall Sedges Open Low Sedges	Very Open Tall Sedges Very Open Low Sedges
Ferns Mosses, liverwort	Dense Ferns Dense Mosses	Ferns Mosses	Open Ferns Open Mosses	Very Open Ferns Very Open Mosses

VEGETATION (describe each unit of vegetation using dominants and life form/height class and canopy cover according to the Muir codes above)

Euc. tottricularis 6-10m 15%
Bm 4-6m } 5%
Bm 4-6m }
Nf 4-6m } 2 jarrah

Adiantum *pratense* 10-3m
Dalmanella *brunneifolia* 10%
Polygonum *orientalis* 2%
Lycopodium 10-15 10%
Leptocarpus small Mat 10-15 2%
Lyso *pea*
Syntherisma
Chenopodium *tenax* 0-30
Polygonum *linearis*
Lepidosperma *fraseri*
Fern *sedge* 2%
 " *mosses* 1m 5% *Lycopodium* *humboldtii*

patches dominated by *Lycopodium* *brunneifolia*.

Melaleuca *prostrata* 10-12m 70% edge = NF [EX-VX]
(all tall herbaceous vegetation) 20% *Dalmanella*
 ? *Acacia* ? long tree 2% *Adiantum*
Polygonum *linearis* *arum*
 " *strobiliferum*

Fauna comments

domesticae *Ad jarrah* 20m

Adjacent bushland (refer to aerial photograph)

① Metallura ? near
long burnt / dead bogged. 5-6m 90% BS&S
1. occasional juncus ? ? Nel ??

edges
Rhytisma mag.
Banksia nica
e Dasyglossa
Eumeloides

HEAVILY HEAVY
for ? bank juncus

- did not appear to take it ??
- ? drying it out.

① *Eucalyptus* 6-10m

3 *...* 1-9

3 *...* 1-9 *...*

...

...

Albos. humis

Adenanthos

... 30

Shilingia

triseda ...

Nia ...



Peraphite

Gamp...

hibb...

Syn...

...



Regelia ...

dam...



Tablet
Chart

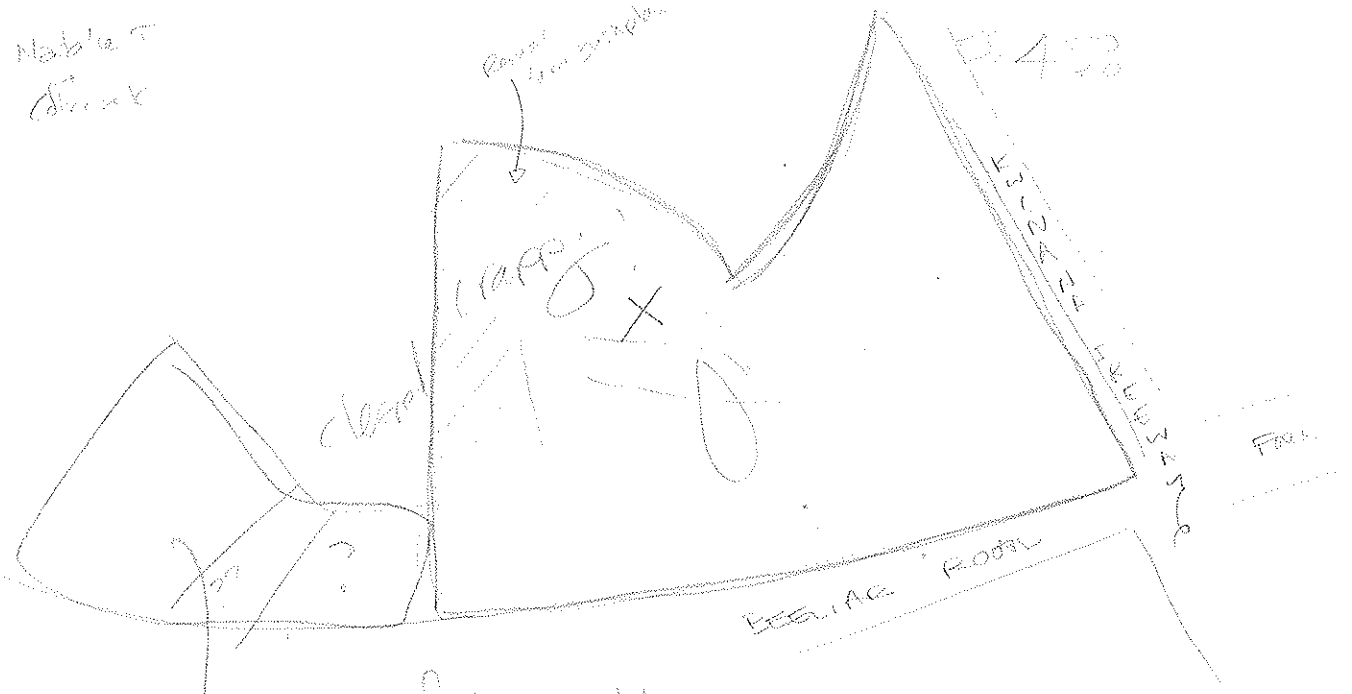

prepared for
having a site



**DRAFT MANAGEMENT PROPOSAL
FOR WETLANDS IN THE CITY OF COCKBURN**

Students of N319: Environmental Management,
Environmental Science, Murdoch University
1994

**Full document
available
on request**

940394

BS 458 PART 9

LIBRARY
ENVIRONMENTAL PROTECTION AUTHORITY
WESTRALIA SQUARE
38 MOUNTS BAY ROAD, PERTH

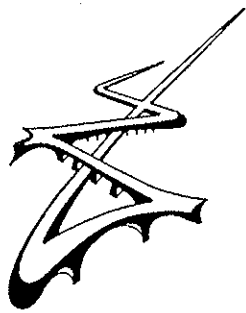

MAIN ROADS
WESTERN AUSTRALIA

KWINANA FREEWAY

FORREST ROAD TO THOMAS ROAD

PUBLIC ENVIRONMENTAL REVIEW IMPACT ON WETLANDS



AIREY RYAN & HILL
Consulting Engineers

In Association With

LE PROVOST ENVIRONMENTAL CONSULTANTS

551.48(941)

AIR

Copy B

TABLE OF CONTENTS

List of Figures

<u>Section No.</u>	<u>Title</u>	<u>Page</u>
1.0	SUMMARY	
2.0	INTRODUCTION	
2.1	The Proponent	
2.2	Background	
2.3	Details and Timing	
2.4	Previous Social Impact Studies	
2.5	Zoning	
2.6	Recognised Conservation Values	
2.7	Statutory Processes	
2.8	Scope	
3.0	DESCRIPTION OF PROPOSAL	
3.1	Overall Concept, Location & Layout	
3.2	Location of Wetlands	
3.3	Land Uses & Zonings	
3.4	Filling Materials	
3.5	Stormwater Discharge	
3.6	Wildlife Crossings	
3.7	Services	
3.7.1	Electricity	
3.7.2	Water	
3.7.3	Drainage	
3.7.4	Telecom	
3.7.5	Sewerage	
3.7.6	Gas	
3.8	Construction	
4.0	EXISTING ENVIRONMENT	
4.1	Introduction	
4.2	Physical Environment	
4.2.1	Soils & Topography	
4.2.2	Drainage & Hydrology - Existing Water Level Regimes	
4.2.3	Wetland Processes	
4.2.4	Wetland Morphology & Regional Representation	
4.3	Biological Environment	
4.3.1	Wetlands	
4.3.2	Flora & Vegetation - Wetlands	
4.3.3	Fauna	
4.3.4	Phytophthora	
4.4	Social Environment	
4.4.1	Present Land Use	
4.4.2	Existing Wetland Management	
4.4.3	Future Wetland Management	
4.4.4	Visual Resource - Landscape Value	

5.0	EVALUATION OF ALTERNATIVES
6.0	IMPACTS
6.1	Introduction
6.2	Temporary (Construction) Impacts
6.2.1	Clearing
6.2.2	Drainage
6.2.3	Dust
6.2.4	Waste Lubricating Oil
6.3	Permanent and Ongoing Impacts
6.3.1	Loss of Wetland Habitat
6.3.2	Effects on Wetland Vegetation, Including Fringing Vegetation
6.3.3	Effects on Wetland Associated Fauna
6.3.4	Effects on the Wetlands as a System
6.3.5	Effects of Chemical Spillage
6.3.6	Services
7.0	PUBLIC PARTICIPATION & CONSULTATION
8.0	ENVIRONMENTAL MANAGEMENT
8.1	Construction
8.1.1	Clearing & Dieback Management
8.1.1.1	Clearing
8.1.1.2	Dieback
8.1.2	Drainage Management - Construction
8.1.3	Aboriginal Sites
8.1.4	Dust
8.1.5	Construction Vehicle Servicing
8.2	Operational Management
8.2.1	Stormwater Drainage
8.2.2	Spillage of Contaminants
8.2.3	Revegetation
8.2.4	Fauna
9.0	LIST OF COMMITMENTS BY PROPONENT
10.0	CONCLUSIONS
11.0	REFERENCES
12.0	APPENDICES
12.1	Appendix A - Guidelines for the Public Environmental Review Kwinana Freeway Extension - Forrest Rd to Thomas Rd
12.2	Appendix B- Glossary

LIST OF FIGURES

<u>Figure No.</u>	<u>Description</u>
2.1	Location Plan 1
2.2	South West Corridor
2.3	Zoning Plan
3.1	Proposed Construction - 1st Stage
3.2	Subgrade Improvement
3.3	Existing and Proposed Surface Drainage - Ultimate Design
4.1	Wetlands Location
4.2	Aerial Photograph of Freeway Route & Adjacent Wetlands
4.3	Typical Wetland Cross-section
8.1	Typical Detention Basin

LIST OF TABLES

<u>Table No.</u>	<u>Description</u>
4.1	Scores and management categories for the wetlands affected by the freeway proposal and areas of each affected.

WILD 15/4 UAGA
No 13037-152.72

000079

↑
Bealier
Kogdun