

PASSMORE STREET BUSHLAND, SOUTHERN RIVER

Boundary Definition: bushland taken to cadastre boundary

SECTION 1: CADASTRAL INFORMATION

(Lots, locations and derived information to be updated in the public submission period)

Bushplan Site no. 465 **Map no.** 69 **Map sheet series ref. no.** 2033-I NE

Other Names **Area (ha):** total 15.4; bushland 13.7

Submission Area 216; Gosnells remnant bushland area

46/49 (Trudgen and Keighery 1995)

Local Authorities (Suburb)

City of Gosnells (Southern River)

Zoning

MRS: Rural

TPS: Rural

Lot/Location/Reserve numbers (Purpose),

Street name

2 Furley Rd; 4, 31, 1782 Phoebe St

Ownership Categories

Private

SECTION 2: REGIONAL INFORMATION

LANDFORMS AND SOILS

Bassendean Dunes

Bassendean Sands (Qpb: S8)

Bassendean Dunes/Pinjarra Plain

Bassendean Sands over Guildford Formation (Qpb/Qpa: S10)

Wetlands (within the Bassendean Dunes/Pinjarra Plain)

Holocene Swamp Deposits (Qrw: Sp1)

VEGETATION AND FLORA

Vegetation Complexes

Combinations of Bassendean Dunes/Pinjarra Plain

Southern River Complex

Floristic Community Types: *not sampled, types inferred

Supergroup 1: Foothills/Pinjarra Plain

*3 *Eucalyptus calophylla* woodlands

Supergroup 2: Seasonal Wetlands

*4 *Melaleuca preissiana* damplands

*5 Mixed shrub damplands

*8 Herb-rich shrublands in clay pans

*15 Forests and woodlands of deep seasonal wetlands

WETLANDS

Wetland Types: dampland

Natural Wetland Groups

Bassendean — Pinjarra transition OR Bassendean with fluvial features

Bennet Brook (B/P.4)

Wetland Management Objectives: Conservation (11.8ha), Resource Enhancement

Swan Coastal Plain Lakes EPP: none identified

THREATENED ECOLOGICAL COMMUNITIES

Vulnerable (floristic community types 3, 8 and 15), possible occurrence of Critically Endangered Shrublands and Woodlands on Muchea Limestone communities, the most southern known location of *Eucalyptus decipiens* (an indicator of Muchea Limestone communities) on the eastern side of the Plain in the PMR having been found adjacent to this Site

SECTION 3: SPECIFIC SITE DETAIL

Landscape Features: vegetated wetland, river, creek, vegetated uplands, possible Muchea Limestones

Vegetation and Flora: limited survey (Trudgen and Keighery 1995)

Structural Units: mapping (Trudgen and Keighery 1995)

Uplands: *Eucalyptus calophylla* Open to Tall Open Woodland

Wetlands: *Melaleuca preissiana* Low Open Woodland often with the co-dominants *Allocasuarina fraseriana*, *Banksia grandis*, *Nuytsia floribunda*; *Jacksonia furcellata*, *Viminaria juncea*, *Nuytsia floribunda* and *Melaleuca preissiana* Low Open Woodland; *Viminaria juncea* Tall Open Shrubland to Low Woodland *Melaleuca* Shrubland to Tall Shrubland dominated by *Melaleuca viminea*, *M. uncinata* and *M. raphiophylla* and combinations of these; *Melaleuca pauciflora* Open Shrubland to Open Heath; *Kunzea recurva* Low Open Shrubland; *Pericalymma ellipticum* Open Shrubland; Sedgeland dominated by *Gahnia trifida*, *Leptocarpus coangustatus* and *Lepidosperma longitudinale* and combinations of these

Scattered Native Plants: not assessed

Vegetation Condition: >65% Excellent to Very Good, >30% Good to Degraded, with areas of severe localised disturbance



Total Flora: not known

Significant Flora: *Rhodanthe pyrethrum* (3), Trudgen and Keighery 1995 — *Acacia benthamii* (2), *Trichocline* sp. Treeton (BJK and NG 564) (2), *Stylidium longitubum* (3), *Anthotium junciforme* (4), *Verticordia lindleyi* subsp. *lindleyi* (4); *Podolepis gracilis* Swamp Form (GJK 13126), *Jacksonia gracilis*

Fauna: no known information

Linkage: adjacent bushland to the south; part of proposed Greenway 142 (Tingay, Alan & Associates 1997a); part of a regionally significant fragmented bushland/wetland linkage (Volume 2A, Map 8)

Other Special Attributes: encompasses five floristic community types; bushland recommended to be protected with the purpose of conservation of nature and recreation compatible with the conservation of nature in study of bushland in the City of Gosnells (Trudgen and Keighery 1995); Bushplan Site Category Two Area Middle Canning Catchment Study (Evangelisti & Associates *et al.* 1995); contains plant communities representative of the eastern side of the Swan Coastal Plain

SECTION 4: INTERNATIONAL AND NATIONAL SIGNIFICANCE

Not listed

SECTION 5: SELECTION CRITERIA AND RECOMMENDATIONS

Criteria met for inclusion: Representation of ecological communities, Diversity, Rarity, General criteria for the protection of wetland, streamline and estuarine fringing and coastal vegetation

Opportunities and Constraints

Opportunities: Bushplan Site/part Bushplan Site location of conservation category wetlands

Constraints: private land

Recommendation: The most appropriate mechanism for the protection of this Bushplan Site be considered through the public comment period in consultation with the land owner(s).

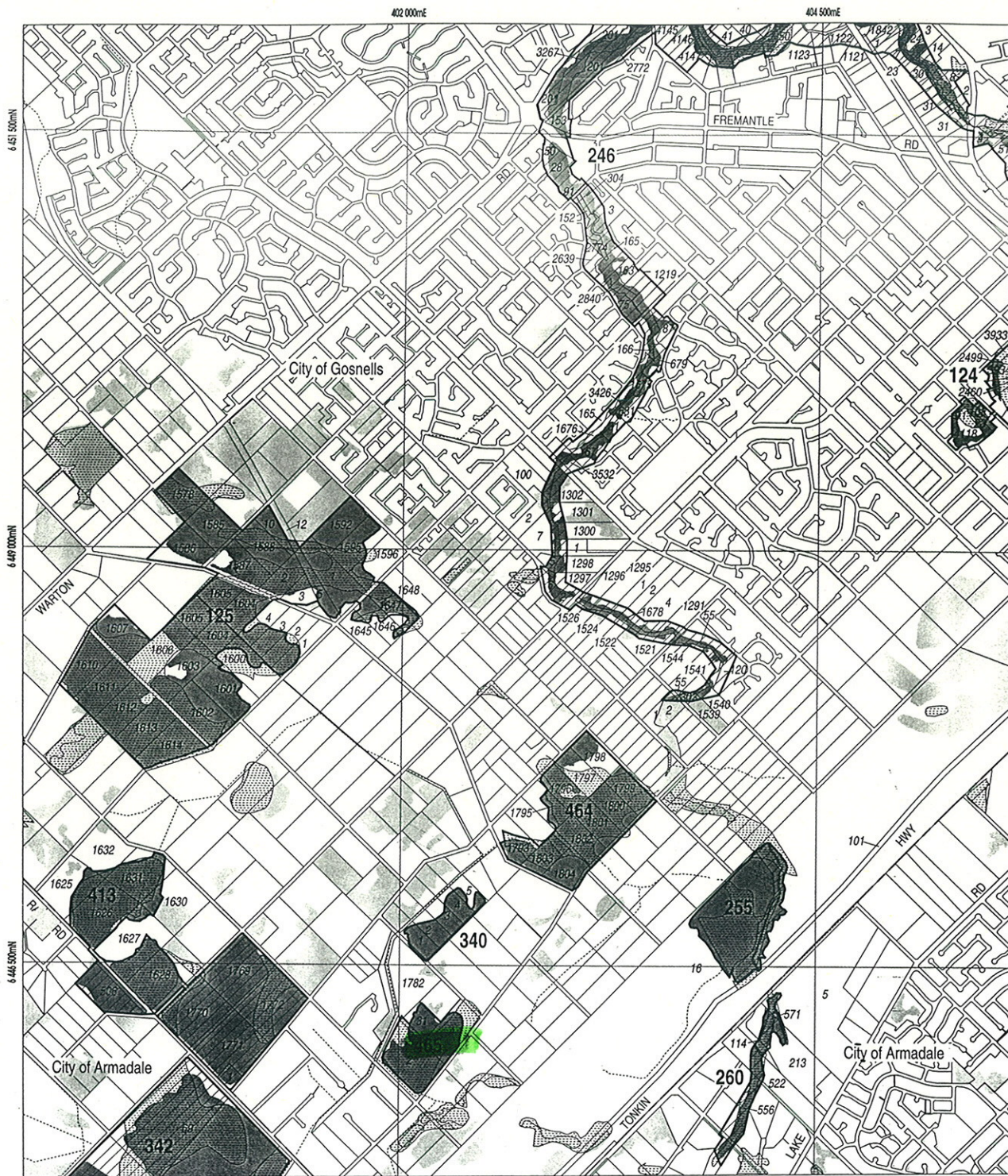

LEGEND

- Bushplan Sites With Regionally Significant Bushland
- Other Native Vegetation
- Conservation Category Wetlands
- Bushplan Sites With Some Existing Protection
- Lot Number, Location Number
- Channel Wetlands
- Local Government Boundary

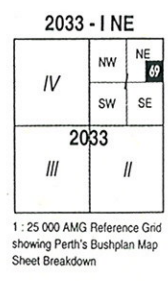

PERTH'S BUSHPLAN MAP INDEX

1	2
3	4
5	6
7	8
9	10
11	12
13	14
15	16
17	18
19	20
21	22
23	24
25	26
27	28
29	30
31	32
33	34
35	36
37	38
39	40
41	42
43	44
45	46
47	48
49	50
51	52
53	54
55	56
57	58
59	60
61	62
63	64
65	66
67	68
69	70
71	72
73	74
75	76
77	78
79	80
81	82
83	84
85	86
87	88
89	90
91	92
93	94
95	96
97	98
99	100
101	102
103	104
105	106

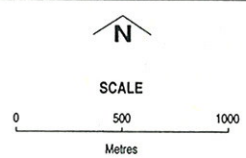

Produced by Project Mapping Section
 Land Information Branch, Ministry for
 Planning, Perth W.A. November 1998
 ntw-map18/environ/bushplan/bush2_69.dgn
 Cadastral Data supplied by Department
 of Land Administration, W.A.
 Wetlands Data supplied by
 Water and Rivers Commission
 Native Vegetation Extent for Study Area
 supplied by Agriculture Western Australia

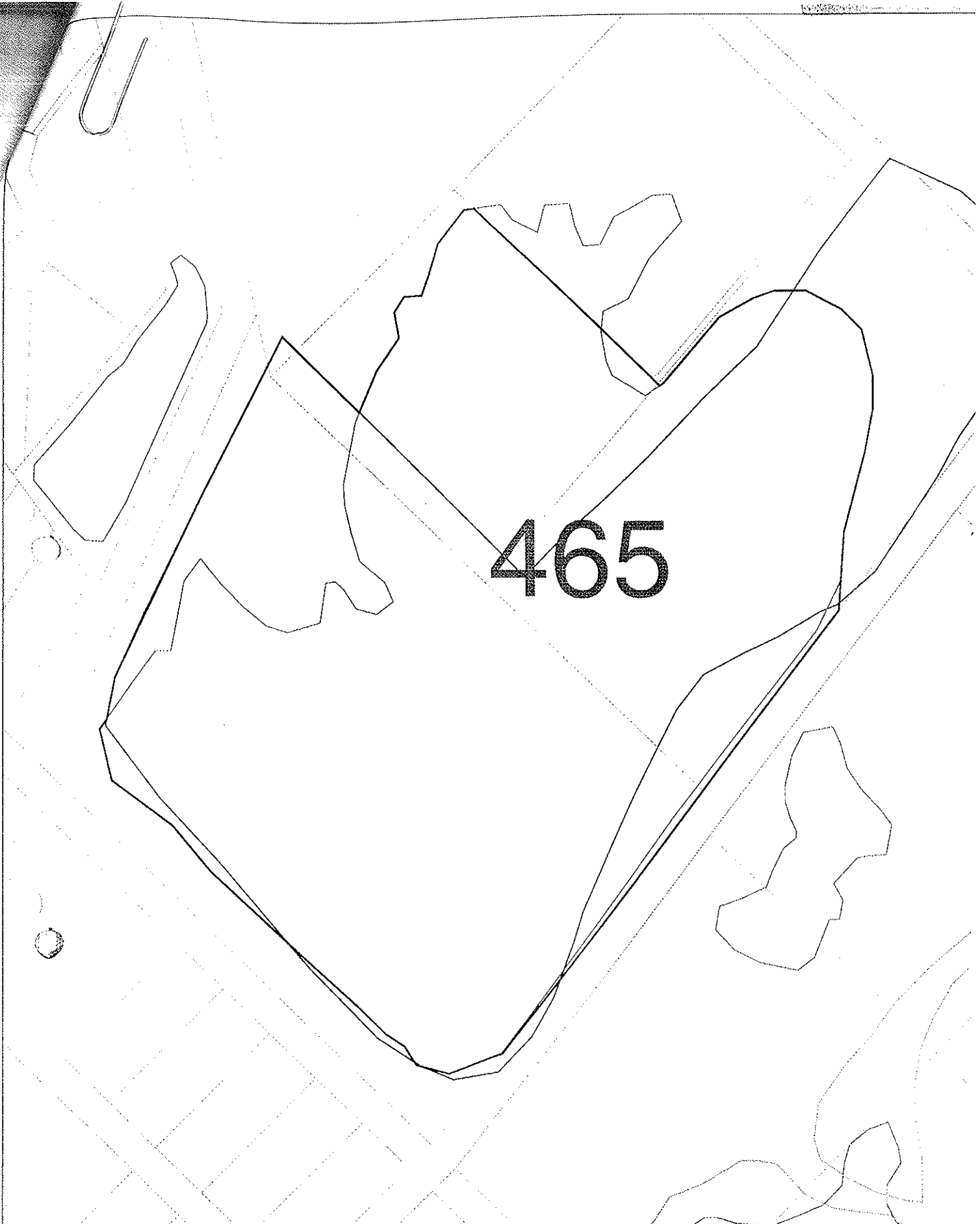

465

BUSHPLAN SITES CORRECTED



WESTERN
AUSTRALIAN
PLANNING
COMMISSION



CUSTOMER
FOCUS
WESTERN AUSTRALIA

B 465 25/10/98



* agree with blue highlighter boundary

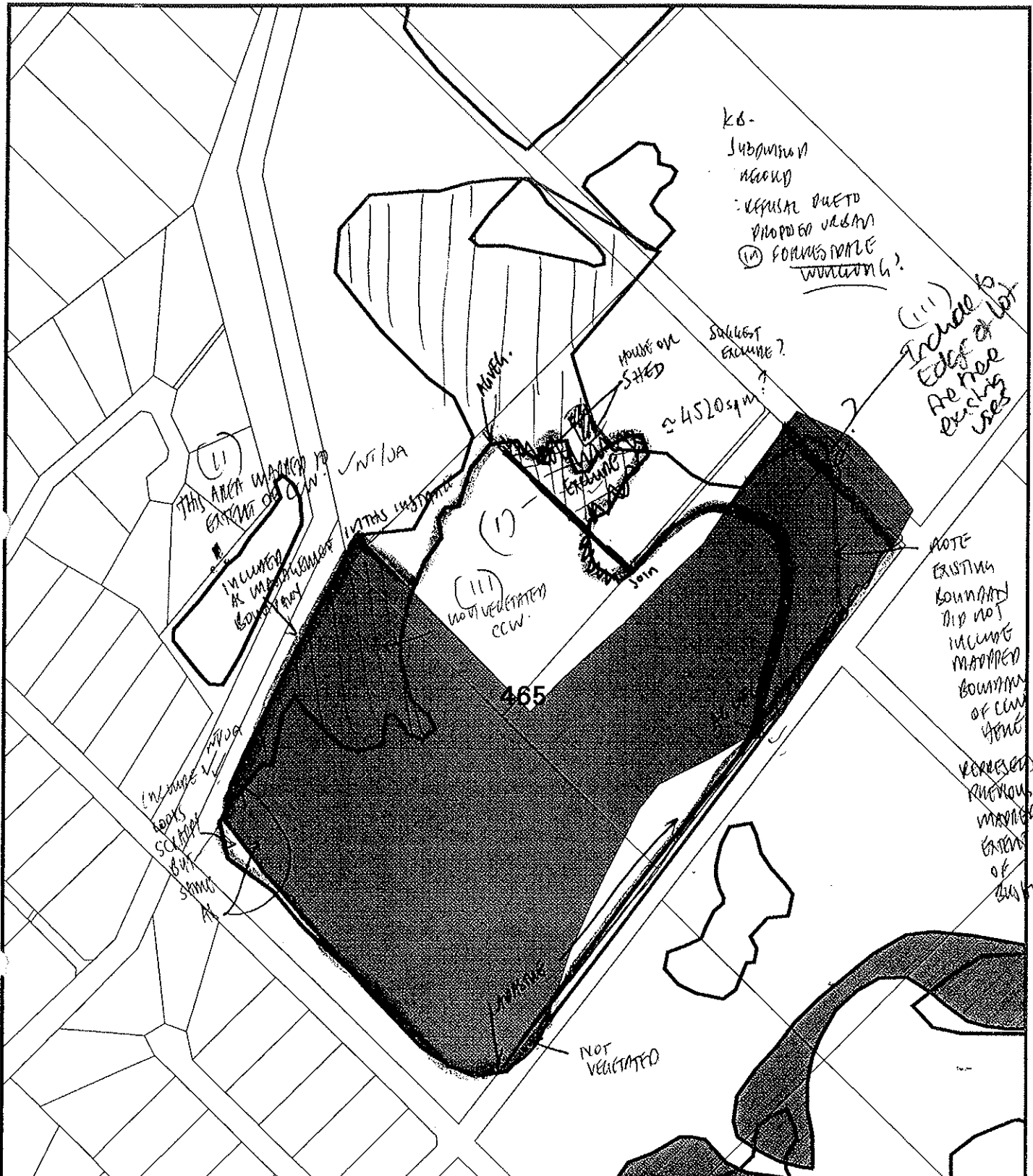

kb-
Submission
around
- usual due to
proposed urban
FORMS MORE
WARRANTY?

(iii) include to
edge of lot
are here
existing
uses





(i)
THIS AREA WANTED TO
EXTEND TO...
INCL. AS MAPPED
BOUNDARY

(ii)
NOT VEGETATED
CCW

NOTE
EXISTING
BOUNDARY
DID NOT
INCLUDE
MAPPED
BOUNDARY
OF CCW
FENCE
REVERSED
APPROX.
MAPPING
EXTENT
OF
BUSHPLAN

bp site 465

CHECK SUBSITES & DAB.

-  AG VEG 1998 - BOUNDARIES SCP
-  Bushplan sites refno 1-500 SCP BOUNDARY THEME
-  Cadastral
-  cons category wetlands
-  Verified CCWs

- (i) Exclude ✓
- (ii) Include A Cran lesion ✓
- (iii) Include CCWs as NPS, proposition and give us note to bargain with ✓

MRS KUMAR

MFP INTERNAL USE ONLY
Prepared By: Andrea Zappacosta
Prepared For:
Map Ident: plot980915_1
Date: 15 Sep 98
Scale 1:4710

DRAFT PERTH'S BUSHPLAN -

ASSESSMENT OF
BUSHLAND AREAS WITHIN THE
**SOUTHERN RIVER-FORRESTDAL-
BROOKDALE-**
WUNGONG DRAFT STRUCTURE PLAN

**DALLEN ROAD BUSHLAND,
SOUTHERN RIVER/GOSNELLS (BS 255)**

**PHOEBE STREET BUSHLAND,
SOUTHERN RIVER (BS 340)**

**MATISON STREET BUSHLAND,
SOUTHERN RIVER (BS 464)**

**PASSMORE STREET BUSHLAND,
SOUTHERN RIVER (BS 465)**

Department of Environmental Protection
B. Keighery
December 1999

copy of full report in BS 255