



System 6 Update - Floristic Community Type Mapping Information **DRAFT ONLY**

**AREA INFORMATION**

System 6 Area (C or M) or Update Area (Update)

M29

Conservation Area
Nature Reserve
Reserve No
National Park
Reserve No
Local Government
Reserve No
Other
Proposed Conservation Areas
Local Government
Reserve No
Other

Greenmount

A25313

Shire of Mundaring

C820

C11940 C21081 unvested lots 2&1296 + parks of location 16 & Helena location 20a - freehold MRA

Conservation Area

Nature Reserve
Reserve No
National Park
Reserve No
Local Government
Reserve No
Other

**AREA**

Total Area	hectares
Completely Degraded	hectares
comments:	

**AREA MAPPED FLORISTIC UNITS**

Boundaries: System6 CALM

Units	Site (Condition)	Code	Bound	Area (ha)	Area(ha)

Boundaries determined by use of

aerial photograph
orthophoto
vegetation map
soil map

MRA 16A 5265 23/12/92

**M29 Greenmount National Park**

Friends Advocate Management

Other Names:

Specific Study/studies Miscellaneous studies

Flora

Vegetation Map	1	2	3	
Flora list	1	2	3	4
Significant Taxa		done	/suitable/	doubtful

Fauna

Mammals	1	2	
Birds	1	2	RAOU
Reptiles and Amphibia	1	2	
Invertebrates	1	2	

Vegetation Condition Map Sites Comment

Disturbance Factors Comment Management

Swan Coastal Plain Floristic Survey

AHC: National Estate- Listed / Interim / Nominated / Notified NT (WA): Heritage Classification

Notes	<i>Darling Range Regional Park</i>
	<i>Mundaring</i>

**M29 Greenmount National Park**

M29.1 Regional park recommendations be applied to this area.

Implementation Progressing

This area is being considered as part of the Darling Range Regional Park study coordinated by the Department of Planning and Urban Development.  
The Regional Parks Task Force report also lists Darling Range as a proposed regional park.  
CALM's 1992 draft Forests Strategy recommends that this part of the regional park be a conservation park.





DEPARTMENT OF LANDS AND SURVEYS

Cathedral Avenue,  
Perth,  
Western Australia 6000

DEPARTMENT OF LANDS AND SURVEYS  
PLANNING AND ENVIRONMENT

14 JUL 1982

FILE NO. 110/81 M29

Your Ref.

Our Ref: 1017/980 M.B./SD

Telephone Enquiries 323 1387

Attention  
Mr. M. A. D. O. P. O. L. I. S. D.  
Perth

Re: ...

The work effected by the subject ... is incorporated in the ... records for ...

Accordingly, please find enclosed for your information a copy of correspondence this day forwarded to the ...

*[Handwritten Signature]*  
Date 14 July 1982



DEPARTMENT OF LANDS AND SURVEYS

Cathedral Avenue,  
Perth,  
Western Australia 6000

Your Ref.

Our Ref. 1017/980 HIB:BJ

Telephone 323 1387  
Enquiries

SECRETARY  
METROPOLITAN REGION PLANNING  
AUTHORITY

RE: PROPOSED ROAD CLOSURES

This Department has approved of the request by the Shire of Mundaring, to close the roads shown coloured blue on the attached print.

The land in the closed roads, excepting Section AB, is offered to the M.R.P.A. for the purchase price of \$100.00.

You will notice that Section AB abutts "Recreation" Reserve No. 8120, which is vested in favour of the Shire of Mundaring. Accordingly, this section can be offered to the M.R.P.A. (at no additional cost) or can be included in that reserve. The Shire of Mundaring has been requested to liaise with you direct in an effort to determine the future of the subject section of road.

When the above matter has been resolved, please advise this Department in order that closure and disposal action may proceed.

ACTING UNDER SECRETARY FOR LANDS

July 13 1982

CT 1037/546

The M.R.P.A.

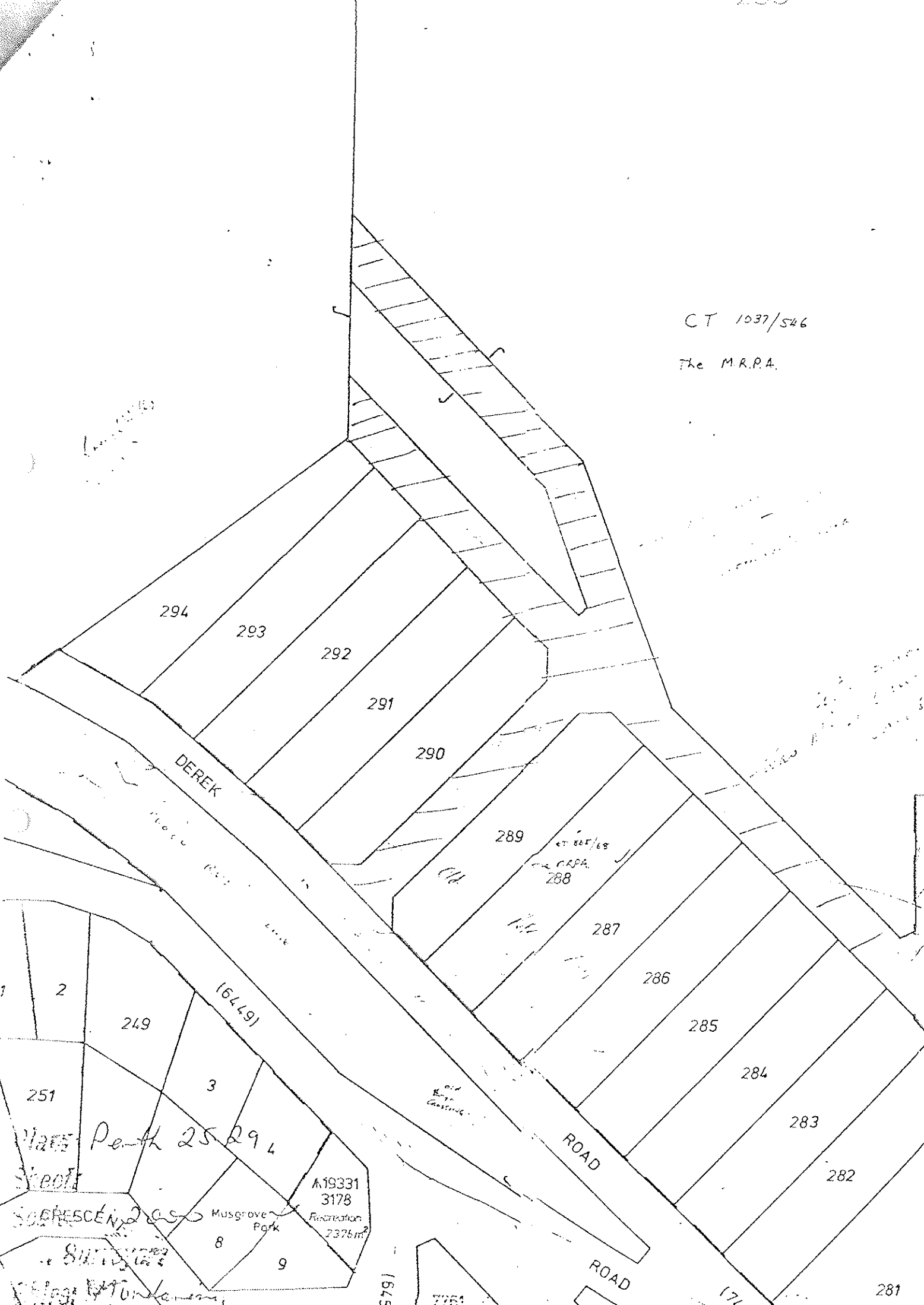

294

293

292

291

290

DEREK ROAD

289

CT 1037/68  
M.R.P.A.  
288

288

287

286

285

284

283

282

281

249

(6779)

251

3

Musgrove Park 25 294

Street

SOPHRESCENT

...

...

Musgrove Park

8

9

A19331  
3178

Recreation  
2376m<sup>2</sup>

579)

7751

ROAD

(742

old Reg. Certificate

1546

*Handwritten notes:*  
No. 1. 2. 3. 4. 5. 6. 7. 8. 9. 10. 11. 12. 13. 14. 15. 16. 17. 18. 19. 20. 21. 22. 23. 24. 25. 26. 27. 28. 29. 30. 31. 32. 33. 34. 35. 36. 37. 38. 39. 40. 41. 42. 43. 44. 45. 46. 47. 48. 49. 50. 51. 52. 53. 54. 55. 56. 57. 58. 59. 60. 61. 62. 63. 64. 65. 66. 67. 68. 69. 70. 71. 72. 73. 74. 75. 76. 77. 78. 79. 80. 81. 82. 83. 84. 85. 86. 87. 88. 89. 90. 91. 92. 93. 94. 95. 96. 97. 98. 99. 100. 101. 102. 103. 104. 105. 106. 107. 108. 109. 110. 111. 112. 113. 114. 115. 116. 117. 118. 119. 120. 121. 122. 123. 124. 125. 126. 127. 128. 129. 130. 131. 132. 133. 134. 135. 136. 137. 138. 139. 140. 141. 142. 143. 144. 145. 146. 147. 148. 149. 150. 151. 152. 153. 154. 155. 156. 157. 158. 159. 160. 161. 162. 163. 164. 165. 166. 167. 168. 169. 170. 171. 172. 173. 174. 175. 176. 177. 178. 179. 180. 181. 182. 183. 184. 185. 186. 187. 188. 189. 190. 191. 192. 193. 194. 195. 196. 197. 198. 199. 200. 201. 202. 203. 204. 205. 206. 207. 208. 209. 210. 211. 212. 213. 214. 215. 216. 217. 218. 219. 220. 221. 222. 223. 224. 225. 226. 227. 228. 229. 230. 231. 232. 233. 234. 235. 236. 237. 238. 239. 240. 241. 242. 243. 244. 245. 246. 247. 248. 249. 250. 251. 252. 253. 254. 255. 256. 257. 258. 259. 260. 261. 262. 263. 264. 265. 266. 267. 268. 269. 270. 271. 272. 273. 274. 275. 276. 277. 278. 279. 280. 281. 282. 283. 284. 285. 286. 287. 288. 289. 290. 291. 292. 293. 294. 295. 296. 297. 298. 299. 300. 301. 302. 303. 304. 305. 306. 307. 308. 309. 310. 311. 312. 313. 314. 315. 316. 317. 318. 319. 320. 321. 322. 323. 324. 325. 326. 327. 328. 329. 330. 331. 332. 333. 334. 335. 336. 337. 338. 339. 340. 341. 342. 343. 344. 345. 346. 347. 348. 349. 350. 351. 352. 353. 354. 355. 356. 357. 358. 359. 360. 361. 362. 363. 364. 365. 366. 367. 368. 369. 370. 371. 372. 373. 374. 375. 376. 377. 378. 379. 380. 381. 382. 383. 384. 385. 386. 387. 388. 389. 390. 391. 392. 393. 394. 395. 396. 397. 398. 399. 400. 401. 402. 403. 404. 405. 406. 407. 408. 409. 410. 411. 412. 413. 414. 415. 416. 417. 418. 419. 420. 421. 422. 423. 424. 425. 426. 427. 428. 429. 430. 431. 432. 433. 434. 435. 436. 437. 438. 439. 440. 441. 442. 443. 444. 445. 446. 447. 448. 449. 450. 451. 452. 453. 454. 455. 456. 457. 458. 459. 460. 461. 462. 463. 464. 465. 466. 467. 468. 469. 470. 471. 472. 473. 474. 475. 476. 477. 478. 479. 480. 481. 482. 483. 484. 485. 486. 487. 488. 489. 490. 491. 492. 493. 494. 495. 496. 497. 498. 499. 500. 501. 502. 503. 504. 505. 506. 507. 508. 509. 510. 511. 512. 513. 514. 515. 516. 517. 518. 519. 520. 521. 522. 523. 524. 525. 526. 527. 528. 529. 530. 531. 532. 533. 534. 535. 536. 537. 538. 539. 540. 541. 542. 543. 544. 545. 546. 547. 548. 549. 550. 551. 552. 553. 554. 555. 556. 557. 558. 559. 560. 561. 562. 563. 564. 565. 566. 567. 568. 569. 570. 571. 572. 573. 574. 575. 576. 577. 578. 579. 580. 581. 582. 583. 584. 585. 586. 587. 588. 589. 590. 591. 592. 593. 594. 595. 596. 597. 598. 599. 600. 601. 602. 603. 604. 605. 606. 607. 608. 609. 610. 611. 612. 613. 614. 615. 616. 617. 618. 619. 620. 621. 622. 623. 624. 625. 626. 627. 628. 629. 630. 631. 632. 633. 634. 635. 636. 637. 638. 639. 640. 641. 642. 643. 644. 645. 646. 647. 648. 649. 650. 651. 652. 653. 654. 655. 656. 657. 658. 659. 660. 661. 662. 663. 664. 665. 666. 667. 668. 669. 670. 671. 672. 673. 674. 675. 676. 677. 678. 679. 680. 681. 682. 683. 684. 685. 686. 687. 688. 689. 690. 691. 692. 693. 694. 695. 696. 697. 698. 699. 700. 701. 702. 703. 704. 705. 706. 707. 708. 709. 710. 711. 712. 713. 714. 715. 716. 717. 718. 719. 720. 721. 722. 723. 724. 725. 726. 727. 728. 729. 730. 731. 732. 733. 734. 735. 736. 737. 738. 739. 740. 741. 742. 743. 744. 745. 746. 747. 748. 749. 750. 751. 752. 753. 754. 755. 756. 757. 758. 759. 760. 761. 762. 763. 764. 765. 766. 767. 768. 769. 770. 771. 772. 773. 774. 775. 776. 777. 778. 779. 780. 781. 782. 783. 784. 785. 786. 787. 788. 789. 790. 791. 792. 793. 794. 795. 796. 797. 798. 799. 800. 801. 802. 803. 804. 805. 806. 807. 808. 809. 810. 811. 812. 813. 814. 815. 816. 817. 818. 819. 820. 821. 822. 823. 824. 825. 826. 827. 828. 829. 830. 831. 832. 833. 834. 835. 836. 837. 838. 839. 840. 841. 842. 843. 844. 845. 846. 847. 848. 849. 850. 851. 852. 853. 854. 855. 856. 857. 858. 859. 860. 861. 862. 863. 864. 865. 866. 867. 868. 869. 870. 871. 872. 873. 874. 875. 876. 877. 878. 879. 880. 881. 882. 883. 884. 885. 886. 887. 888. 889. 890. 891. 892. 893. 894. 895. 896. 897. 898. 899. 900. 901. 902. 903. 904. 905. 906. 907. 908. 909. 910. 911. 912. 913. 914. 915. 916. 917. 918. 919. 920. 921. 922. 923. 924. 925. 926. 927. 928. 929. 930. 931. 932. 933. 934. 935. 936. 937. 938. 939. 940. 941. 942. 943. 944. 945. 946. 947. 948. 949. 950. 951. 952. 953. 954. 955. 956. 957. 958. 959. 960. 961. 962. 963. 964. 965. 966. 967. 968. 969. 970. 971. 972. 973. 974. 975. 976. 977. 978. 979. 980. 981. 982. 983. 984. 985. 986. 987. 988. 989. 990. 991. 992. 993. 994. 995. 996. 997. 998. 999. 1000.

A

ΔKV35

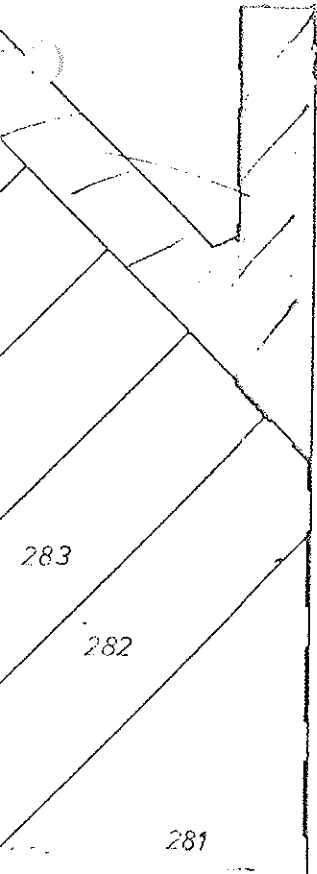

Λ8120  
3213

Recreation  
185761ha.  
Vested: Mendering Shire

CTE 1292/550 ✓  
1291/983  
1194/519  
The M.R.P.A.

ΔHV35

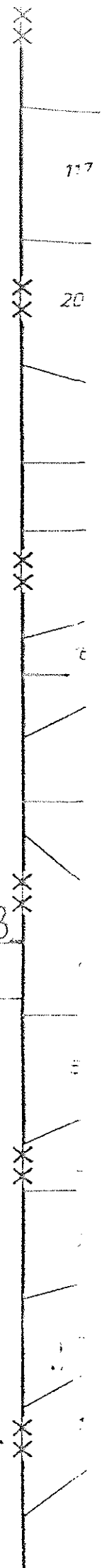

A8120  
3213

Recreation

185761ha.

Visited: Monday 3/1/93

M29 - Greenmount National Park



1. View from ~~the~~ Navigation beacon - looking north along Darling Scarp.



2. View from Nav. beacon - looking west (city in background - MRPA land in foreground).



3. Small marrubidgee on slope of hill.



5. Slope to MRPA land.



6. - Disused railway track to S.E. of recommendation area.



4. Typical cross section of upper slope of hill.



LMS  
AIR PHOTO



0-0-0



KODAK SAFETY FILM

KODAK SAFETY FILM

5015

00115 1 05000 150-0 007-01 100-NO 010017