

AREA INFORMATION

System 6 Area (C or M) or Update Area (Update)

M107

Conservation Area	
Nature Reserve	
Reserve No	
National Park	
Reserve No	
Local Government	
Reserve No	
Other	
Proposed Conservation Areas	Peelhurst, Singleton & Madora
Local Government	
Reserve No	
Other	DOLA unvested res C25043, C27066

Conservation Area

PRIVATE - Mandurah rd Subdivision lots 2-4, 15, 16
Cockburn location 16 lots 1, 7, 442, 688, 3, 3, 4, 10-12, 101

Conservation Area	
Nature Reserve	
Reserve No	
National Park	
Reserve No	
Local Government	
Reserve No	
Other	

TOTAL AREA

Bushland Area	hectares
Completely Degraded	

AREA MAPPED FLORISTIC UNITS

Units	Site (Condition)	Code	Bound	Area (ha)
	NO SITES			

Boundaries determined by use of

aerial photograph	Melro Street Directory 1976 5039-43 5/1/91
orthophoto	2033 11 SW Aug 1991
vegetation map	
soil map	

← some in M106

M107 Peelhurst, Singleton and Madora

Bulletins 648 (Golden Bay - lot 12&Res 34664), 649 (Lot 1001)

Friends Advocate Management

Other Names:

Specific Study/studies Miscellaneous studies

?

Flora

Vegetation Map	1	2	3	
Flora list	1	2	3	4
Significant Taxa				done / suitable / doubtful

?

Fauna

Mammals	1	2	
Birds	1	2	RAOU
Reptiles and Amphibia	1	2	
Invertebrates	1	2	

Vegetation Condition Map Sites Comment

Disturbance Factors Comment Management

Swan Coastal Plain Floristic Survey

AHC: National Estate- Listed / Interim / Nominated / Notified NT (WA): Heritage Classification

Notes

M107 Peelhurst, Singleton and Madora
 Bulletins 648 (Golden Bay - lot 12&Res 34664), 649 (Lot 1001)

M107.1 Reserve C25043 be vested in Shire of Mandurah.	Implemented	Vested in the local authority for Public Recreation.
M107.2 Reserve C27066 be vested in Shire of Rockingham.	Implemented	Vested in the local authority for Public Recreation.
M107.3 Ways and means of protecting the recreational and landscape values of lots 2 to 9, 15 and 16 (Mandurah Rd subdivision), lots 1, 7, 492 and 688 and parts of lots 2, 3, 4, 10 to 12 and 101 (Cockburn Sound Location 16) be sought through planning procedures.	Unresolved Issues	EPA has released report and recommendations for development of this area. East-west links to be developed, additional foreshore reserve to be set aside. Singleton Ratepayers Association has an interest in this area.
M108.1 Regional park recommendations be applied to this area.	Implementation Progressing	The portion of M108 outside the metropolitan region is being considered as part of the Peel Regional Park study being coordinated by DPUD. CALM's 1992 Draft South-west Forests Strategy recommends part of area to be nature reserve.
M108.2 Purpose of Reserve 26351 be amended to Conservation of Flora and Fauna and Reserve vested in NPNC.	Unresolved Issues	Local authority's current position still to be determined. The local authority had previous concerns regarding adequate mosquito control. Discussions between the LGA and CALM have since occurred on this issue.

Please circle the appropriate response or respond in the space provided.

Area M107 Name

✓ Golden Bay amendment to the Metropolitan Region Scheme (affecting part of the System 6 Area M107) : public environmental review [H & B Developments Pty Ltd] / Alan Tingay & Associates ; Martin Goff & Associates

✓ Singleton amendment to the Metropolitan Region Scheme (affecting part of System 6 area M107) : consultative environmental review /Alan Tingay and Associates ; Warren F. Johnson & Co.

Government

Corporate

Community Group

Management Plan

Soils

Units mapped described referenced

Landscape

Features described referenced

Flora

Vegetation Map

Units Site based (no)

Mapped

Veg Units Comparable Heddle *et al* Compared Heddle *et al*. Unit not mapped by Heddle *et al*.

Flora list

Timing %completion Significant Taxa
Trees Shrubs Herbs Sedges Weeds DRF CALM Priority Other

Fauna

Timing %completion Significant Taxa
Mammals Birds Sched1 Sched2 Other
Reptiles Invertebrates

Vegetation Condition

Site based Mapped Units

Disturbance Factors

Phytophthora observed Other incidental
tested itemised

Notes

✓ SINGLETON AMENDMENT TO THE METROPOLITAN REGION SCHEME (AFFECTING PART OF SYSTEM 6 AREA M107) : CONSULTATIVE ENVIRONMENTAL REVIEW / Alan Tingay & Associates: Warren F. Johnson & Co. -- [South Perth] Alan Tingay and Associates, 1992.

1. SYSTEM SIX. 2. METROPOLITAN REGION SCHEME. 3. ENVIRONMENTAL REVIEW.

PEP TOPIC: 1. MISCELLANEOUS.

Location(s) : CALM

CER "Urban development of Lot 12 and Reserve 34664 (affecting part of System 6 recommendation M107), Golden Bay.
Bulletin 648 relates to this

EPA 920590 ✓

711.435 (941) WES

PIC:
PREPARED FOR:

Date prepared:
04/14/94

Continued)

URBAN DEVELOPMENT OF LOT 1001 (AFFECTING PART OF SYSTEM SIX RECOMMENDATION M107), SINGLETON : TEMWOOD HOLDINGS PTY LTD : REPORT AND RECOMMENDATIONS OF THE ENVIRONMENTAL PROTECTION AUTHORITY / WESTERN AUSTRALIA. ENVIRONMENTAL PROTECTION AUTHORITY -- PERTH: THE AUTHORITY, SEP 1992.

(BULLETIN 649.)

1. WESTERN AUSTRALIA. 2. EPA BULLETINS. 3. ZONING. 4. LAND USE. 5. DEVELOPMENTS. 6. SINGLETON. 7. SYSTEM SIX. 8. FORESHORES. 9. GROUNDWATER. 10. ENVIRONMENT. 11. SOUTH WEST REGION. 12. WA.
PEP TOPIC: 1. HYDROGEOLOGICAL FEATURES.

ISBN: 073094719

Location(s) : DPUD

PERTH 502.5/.8 (941) WES

M107

System 6 - REPORT Information Search

Date 5/94

Please circle the appropriate response or respond in the space provided.

Area M/07 Name Secret Harbour

Title

Author: Integrated Environmental Services **EIA 908756**
 Date: 1981 **711-582(210.5) HAL**
 Title: Flora and fauna terrestrial
 Source: In: Environmental Review and Management Programme (Appendices) Secret Harbour, Ralph Stanton Planners, Perth Unpublished Report

✓ DEP
 Purpose (why was the report prepared?)

- Government
- Corporate
- Community Group
- Management Plan

Soils

Units mapped described referenced

Landscape

Features described referenced

Flora

Vegetation Map

Units Site based (no)

Mapped

Veg Units Comparable Heddle *et al* Compared Heddle *et al*. Unit not mapped by Heddle *et al*.

Flora list

Timing %completion Significant Taxa

Trees Shrubs Herbs Sedges Weeds DRF CALM Priority Other

Fauna

Timing %completion Significant Taxa

Mammals Birds Sched1 Sched2 Other

Reptiles Invertebrates

Vegetation Condition

Site based Mapped Units

Disturbance Factors

Phytophthora observed Other Incidental

tested itemised

Notes

Notes

SINGLETON AMENDMENT TO THE METROPOLITAN REGION SCHEME (AFFECTING PART OF SYSTEM 6 AREA M107) : CONSULTATIVE ENVIRONMENTAL REVIEW / Alan Tingay & Associates: Warren F. Johnson & Co. -- [South Perth] Alan Tingay and Associates, 1992.

1. SYSTEM SIX. 2. METROPOLITAN REGION SCHEME. 3. ENVIRONMENTAL REVIEW.
PEP TOPIC: 1. MISCELLANEOUS.

Location(s) : CALM

CER "Urban development of Lot 12 and Reserve 34664 (affecting part of System 6 recommendation M107), Golden Bay. Bulletin 648 relates to this

PIC:
PREPARED FOR:

Date prepared:
04/14/94

(Continued)

URBAN DEVELOPMENT OF LOT 1001 (AFFECTING PART OF SYSTEM SIX RECOMMENDATION M107), SINGLETON : TEMWOOD HOLDINGS PTY LTD : REPORT AND RECOMMENDATIONS OF THE ENVIRONMENTAL PROTECTION AUTHORITY / WESTERN AUSTRALIA. ENVIRONMENTAL PROTECTION AUTHORITY -- PERTH: THE AUTHORITY, SEP 1992.

(BULLETIN 649.)

1. WESTERN AUSTRALIA. 2. EPA BULLETINS. 3. ZONING. 4. LAND USE. 5. DEVELOPMENTS. 6. SINGLETON. 7. SYSTEM SIX. 8. FORESHORES. 9. GROUNDWATER. 10. ENVIRONMENT. 11. SOUTH WEST REGION. 12. WA.
PEP TOPIC: 1. HYDROGEOLOGICAL FEATURES.

ISBN: 073094719

Location(s) : DPUD PERTH 502.5/.8 (941) WES

GOLDEN BAY AMENDMENT TO THE METROPOLITAN REGION SCHEME (AFFECTING PART OF THE SYSTEM 6 AREA M107) : PUBLIC ENVIRONMENTAL REVIEW [H & B DEVELOPMENTS PTY LTD] / Alan Tingay & Associates: Martin Goff & Associates -- [South Perth] Alan Tingay & Associates, 1992.

1. SYSTEM SIX. 2. GOLDEN BAY. 3. METROPOLITAN REGION SCHEME. 4. ENVIRONMENTAL REVIEW.
PEP TOPIC: 1. MISCELLANEOUS.

Location(s) : CALM

SYSTEM 6 BUSHLAND SUBMISSION FORM FOR CONSIDERATION IN THE UPDATE PROGRAMME

If you wish to submit more than one area for consideration in the System 6 update, please use a separate form for each area.

Please fill in each section giving as much information as possible.

LOCATION, OWNERSHIP AND ZONING OF THE AREA

1. Location

Please give as accurate and detailed a description as possible of the site location
Please include either a hand drawn or copied map showing the area of the area

a) Bordering Roads:

b) Nearest Corner:

c) Lot Number: Street Number:

d) Town/Suburb/Location:

e) Local Council: MANDURAH

f) Site Name (if any):

g) Approximate size of the area (ha): 140

h) Please locate the area on a map and give us map references if possible:
.....

i) Map: Streetsmart /UBD/Other:

j) Map no.:

k) Grid Ref:

l) Please give any other information that may help us to find the location:
.....

m) Are you aware of any development proposals that are likely to affect the area?
No - OTHER THAN IT, WILL BE DEVELOPED
SOMETIME IN THE FUTURE.

NOTE: Areas that have already been given development APPROVAL should not be nominated

SEE
MAP
1

Please fill out those questions that you can answer

2. Who owns the area? (If owned by the person/s making the nomination please indicate)
H. PERRY (OF H & N PERRY, REAL ESTATE AGENTS)

3. If you own the area, and may be interested in participating in conservation on private land initiatives please indicate (and leave your name and address at the end of this submission form)

4. What is the area zoned? (please indicate whether zoning is Town Planning Scheme or Metropolitan Region Scheme) FUTURE URBAN

CAN YOU TELL US A LITTLE ABOUT THE PHYSICAL CHARACTERISTICS OF THE AREA

5. Why do you consider this area important? (Refer to Guiding Issues paper)

.....
SEE ATTACHMENT (2)

6. What is/are the soil type/s and colours ? SAND, GREY

Type: Sand/Clay/Gravel/Loam/Silt
Colour: White/Grey/Brown/Orange/Yellow/Red/Black

7. Does the area have any special features such as unusual landforms / landscapes that still retain their natural vegetation? (Yes) No

If yes, what are they? SEE ATTACHMENT 3.

8. Is the area a wetland or does it include a wetland? DAMPLAND IN THE SWALES

If yes, what kind of a wetlands is it?

- a) lake
- b) river
- c) stream
- d) swamp
- e) estuary
- f) seasonally wet
- ✓ g) other

9. What percentage of the wetland is open water in summer? NONE

CAN YOU TELL US A LITTLE ABOUT THE VEGETATION /FAUNA ON THE NOMINATED AREA.

10. What percentage of the area is indigenous vegetation? 80%

11. If the area includes regions cleared of native bushland please indicate reasons for the inclusion. N/A

12. Has any previous flora or fauna survey work been done on the area?
..... NO

If yes, please give details of the work

13. How would you rate the condition of the native bushland? (see attached table)

- a) pristine
- b) excellent
- c) very good
- d) good
- e) degraded
- f) completely degraded
- g) don't know

14. Please indicate the disturbances affecting the area and where appropriate the percentage of the area disturbed.

- a) Partial clearing
- b) fragmentation
- c) Selective removal of species: timber cutting, wildflower picking, mowing dieback and other plant diseases
- d) Fire regime, including intensity, season and frequency
- e) 'Enrichment plantings' that is plantings of species not found in that community
- f) Weed invasion - GENERAL
- g) Animal impact: horses, foxes, rabbits, cats, dogs, camels, goats etc
- h) Soil movement, both removal and dumping
- i) Changes in water regimes; flooding, drainage and watering
- j) Salinity
- k) Fertiliser drift and along waterways nutrient influx
- l) Mining, including that for road works

- m) Grazing: stock, overgrazing by feral or native mammals
 - ✓ n) Proliferation of tracks, fire breaks and walk trails ^{FEW}
 - o) Off-road vehicle use
 - p) Use as service corridors by the SEC, Main Roads, Water Authority.
- (Source: B Keighery. Bushland Plant Survey, September 1994)

15. Does the area contain any plant species of special interest that you know of? (eg. declared rare flora, priority taxa, outlier populations) YES

Do you know what they are? SEE POINT 4

16. Do you know of any native animals that use the area? YES

Can you list those you know of? (birds, mammals, reptiles, amphibians etc)

..... SEE POINT 5

17. Is the area used by any native animals of special interest? (eg. endangered species, large/important populations)..... YES

If yes, please name them and indicate source of information

..... BANDICOOTS - HAVE OBSERVED

CAN YOU TELL US A LITTLE ABOUT THE SURROUNDING AREA

18. Are there any bushland areas (including wetlands) near to this area?

..... YES - SEE MAP 2

If yes, how close are they? ANSTEY SWAMP } 3-4 km
 PAGANONI SWAMP }

Are they already conservation reserves? YES

What is their approximate size? Anstey 250ha, Paganoni - unknown

19. Does the submitted area link other bushland areas? YES - The coastal & road landscape protection & reserve areas

Please attach any additional information about the area which may be of use when assessing it.

It is great to be able to nominate an area of bush I consider is worthy of preserving, but I feel that I am on the back foot, as I can only reply in layman's language. I hope this aspect does not jeopardise this piece of land's chances.

(2)

This piece of land forms the southern most boundary of the metropolitan area. It is relatively untouched, with high coastal dunes & deep swales, well vegetated and with diverse fauna. It contains a system 6 transect, M107, between Singleton and Madora Bay, on the Singleton boundary. Because of the extensive coastal clearing by both Mandurah & Rockingham developers, this is the last large area of good coastal bush, and I believe it should be preserved in its entirety. It will be a substantial buffer at the end of the Metropolitan area, and will also provide a sustainable habitat for the flora & fauna, already resident.

③ The land is fenced by very high vegetation dunes, & deep swales, from the ocean to Mandurah Road. It is an excellent example of the Quindalup dunal system, which used to exist before the many coastal billiard table developments.

④ Many stands of healthy, fruiting Quandong, Orchids, *Handbergia*, *Spinifex*, *scavola* & lots of bushes & plants I do not have a name for.

⑤ Southern brown bandicoots, kangaroos, splendid whens, red capped parrots, Port Lincoln Parrots, Galahs, several species of honeyeaters, different finches, hawks, namkeen kestrel, all the black & white birds like butcher birds, red lark etc, bobtails, legless lizards, dugites, tiger snakes, quite a few different small lizards.

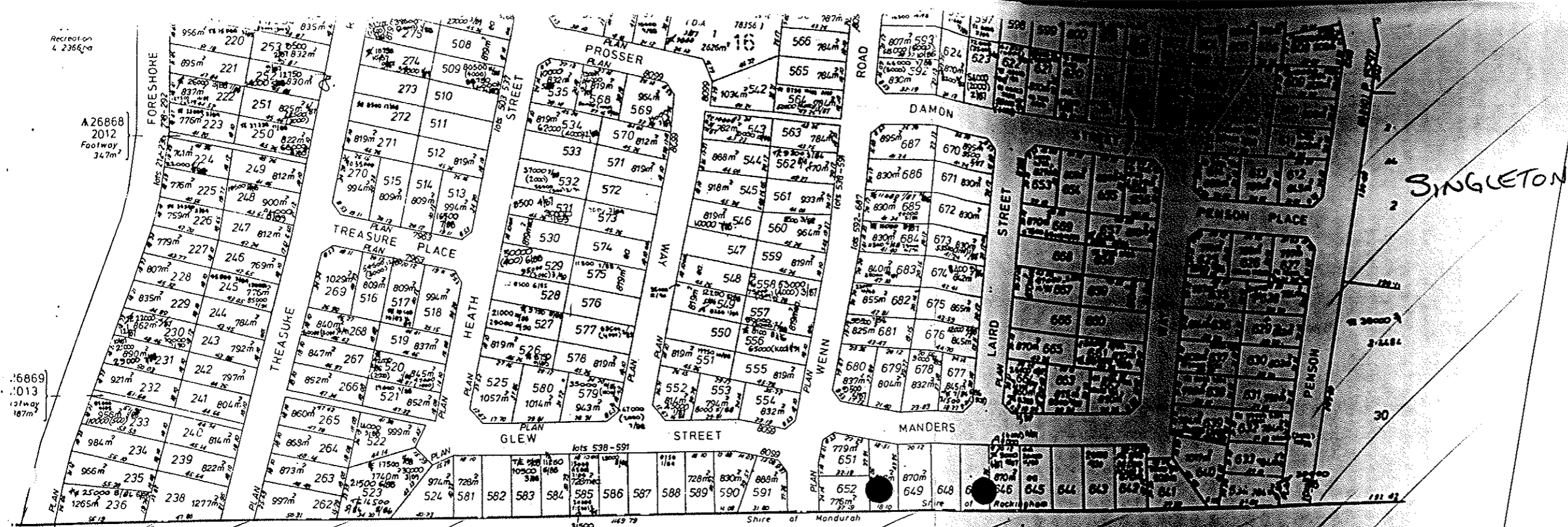

A26868
2012
Footway
34.7m

58669
013
Footway
18.7m

M107

PT 3

PLAN 140 425970 3064

(THIS BLANK AREA NOT TO SCALE)



2592
Reserve for
Recreation

A 27512
2044
5 3684 ha
Pub Recn

LANDSCAPE PROTECTION

MANDURAH ROAD

MADORA BAY

SINGLETON



M103

197

CITY OF ROCKINGHAM

Civic Boulevard, Rockingham,
Western Australia

OUR REF: TP11-2-11 PM.mw

YOUR REF:

3rd October 1995

ENQUIRIES TO: Mr Monks

The System Six Study Team
Department of Environmental Protection
141 St George's Terrace
PERTH WA 6000

ATT: Mr K McAlpine

Dear Sir

Re: System Six Update

The current review of the System Six recommendations were considered by Council at its ordinary Meeting held on the 26th September 1995. Council resolved that the following modifications and additions to the System Six Areas be submitted for consideration:-

1. Modification of Existing System Six Areas

(i) M107 - Peelhurst, Singleton and Madora

The recommendations of the System Six Report have in part been overturned by the EPA and the Minister for the Environment in approving urban development at Singleton and Golden Bay.

It is recommended that the boundaries of this recommendation should be modified to exclude the east-west transects where urban development has been approved. It is desirable, however, that the System Six recommendations remain over the land currently zoned Rural in the Metropolitan Region Scheme and Special Rural under Town Planning Scheme No.1, this being the Peelhurst and Singleton Special Rural Zones (see attached plan).

(ii) Similarly M103 should be modified to delete the area between Green Meadows and the Port Kennedy Business Park recently rezoned to Urban and Industrial under the Metropolitan Region Scheme, a portion of which is currently being rezoned to Development Zone under Town Planning Scheme No.1. M103 should, however, be extended to take into account the MRS Parks and Recreation Reserve around Tamworth Swamp (see attached plan).

(iii) M106 at Port Kennedy should be modified to exclude that portion of Secret Harbour approved for urban development and to rationalise the boundaries to coincide with the boundaries of the 'Scientific Park' to the west of the Warnbro Sound Avenue extension (see attached plan).

BOUNDARY TO BE EXTENDED TO
WARNBRO SOUND AVENUE

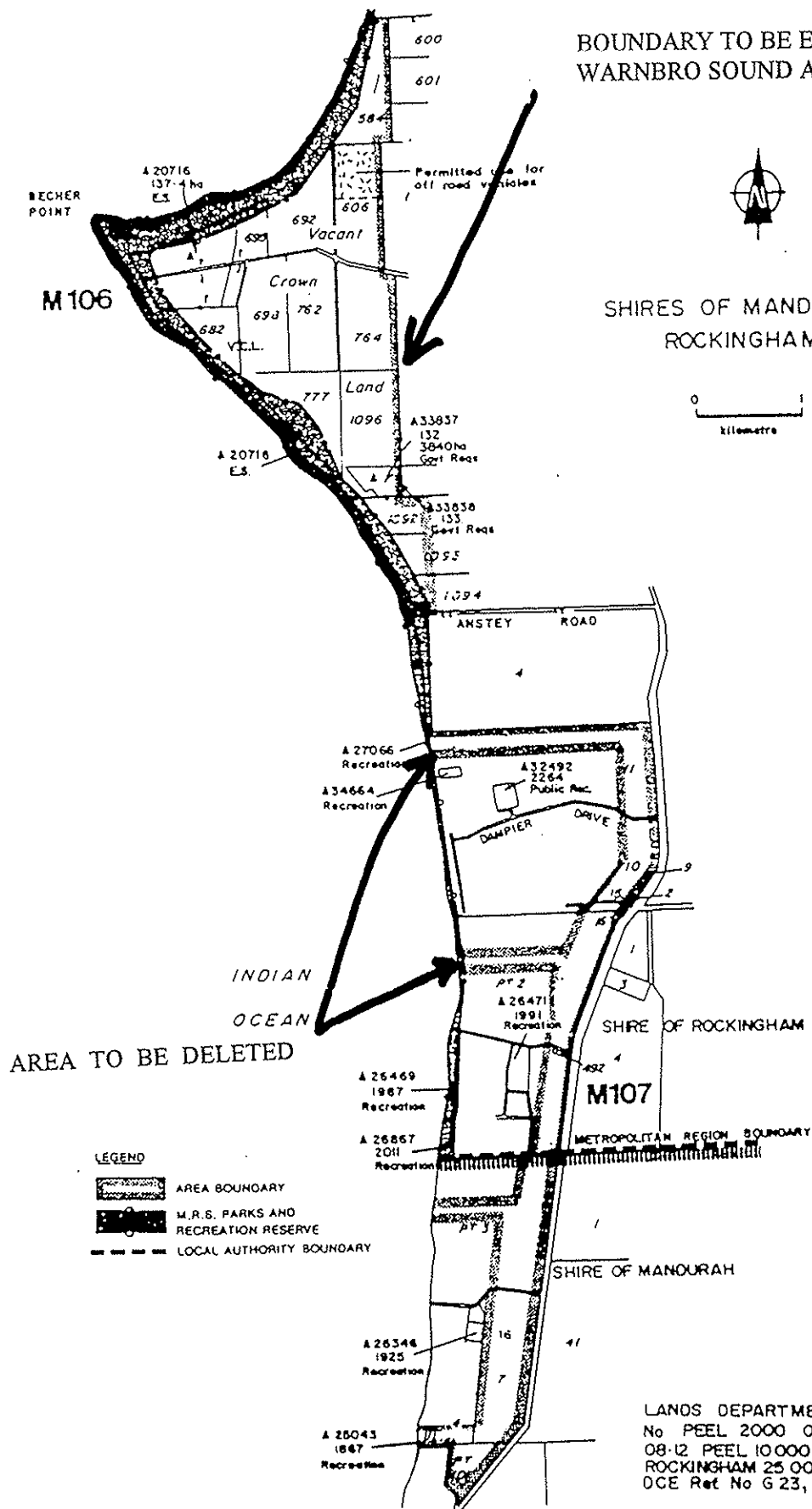

LANDS DEPARTMENT PUBLIC PLAN
No PEEL 2000 07-06, 07-12, 08-06,
08-12 PEEL 10000 2-3, R 136-4,
ROCKINGHAM 25 000 R 120, R 119/135-4
DCE Ref No G 23, H 2,

Figure 164
33

To: Mr. Colin Sanders, Director Policy and Strategic Studies,
Department of Environmental Protection.
cc: Secretary, WA Insect Study Society

From: Matthew Williams, Andrew Williams, Trevor Lundstrom, Paul Hutchison,
Bob Hay, Hugh Bollam; members, WA Insect Study Society

Date: January 15, 1996

Subject: System 6 update: Potential Invertebrate Sites

Dear Mr. Sanders,

Dr. Terry Houston passed on to me a copy of your letter dated 30 Oct 1995, requesting information about potential invertebrate sites in the system 6 study area. I have discussed this issue with fellow members of the society who, like me, have an interest in butterflies, and we have co-ordinated our response. Attached is a list of sites that we feel are important sites for butterflies within the study area. Naturally we would be happy to provide any additional information about the listed species or sites if this is needed.

I also attach a copy of a letter prepared by Ms. M. Barrett, who is currently undertaking a survey of the Western Petalura dragonfly. In this letter, prepared in response to your request for information, Ms. Barrett has nominated a number of important sites for this species.

I hope that this information is of some use to you in updating the System 6 red book recommendations.

Yours Sincerely



Matthew Williams

093721 INFO

Nshl
K.M.A

not
file
7/5/ab

Site	Species	Reason for importance
Warwick Open Space (The area bounded by Wanneroo, Warwick, Erindale and Beach Roads, Warwick); and Bushland, Koondoola (The area bounded by Alexander and Marangaroo Drives, Koondoola Avè, Waddington Crescent and Beach Rd)	<i>Hypochrysois halyaetus</i> (Western Jewel), <i>Trapezites sciron sciron</i> (Sciron Skipper), <i>Mesodina cyanophracta</i> (Cyanophracta Skipper), Other species	Two of few remaining areas that contain an intact fauna representative of the original butterfly fauna of the Swan Coastal Plain near Perth. The three identified taxa, all endemic to Western Australia, are now rare within the Perth Metropolitan region. These two sites are currently the southernmost locations of the western jewel.
Rottneest Island	<i>Geitoneura klugii insula</i>	This subspecies of Klug's Xenica occurs only on Rottneest.
Bushland, Yanchep (The area within an approximately 500m radius of Smokebush Hill)	<i>Acrodipsas brisbanensis brisbanensis</i> (Large Ant-blue)	This is the only known site for this butterfly in Western Australia. This butterfly is rare or uncommon along the eastern seaboard.
Julimar Conservation Park	<i>Neolucia agricola</i> aff. <i>occidens</i> (Fringed Blue)	This is the only known locality of the recently discovered autumn-flying form of the Fringed Blue. The taxonomic status of this form is currently being investigated.
Manjedal Scout Camp, Manjedal Brook, North of Jarrahdale	<i>Candalides aff. hyacinthinus</i>	This is one of only two localities within the study area where this undescribed subspecies of the Common Dusky Blue occurs (the other site is Yalgorup NP)
Jarrahdale forest, Pickering Brook (The area bounded by Ashendon, Pickering Brook, Lockwood and Mundaring Weir roads.	<i>Exometoeca nycteris</i> (Western Flat), <i>Ogyris idmo idmo</i> (Large Brown Azure), Other species	This is an area known to contain a butterfly fauna representative of jarrahdale forest areas. The two nominated species, both of which occur within this area, are both considered rare and in need of further study.

<p>Area surrounding the Surf Life Saving Club, Ocean Beach, Bunbury</p>	<p><i>Vanessa cardui</i> (European Painted Lady)</p>	<p>Although the European Painted Lady is thought to have been introduced to Western Australia, there is no evidence to suggest that it is not a self-established immigrant. Specimens are known from Rottnest and Fremantle to as far south as Bunbury, but currently only the area surrounding the Surf Life Saving Club at Bunbury is known to harbour a resident population.</p>
<p>Bushland, Singleton (The area bounded by Crystaluna Drive, Peelhurst, Fitch St and Mandurah Rd, Singleton, and the coast). I believe that this site is currently being cleared for housing.</p>	<p><i>Theclinesthes hesperia hesperia</i> (Western Blue), <i>Croitana croites</i> (Croites Skipper), <i>Jalmenus inous</i> (Inous Blue)</p>	<p>This is one of only three currently known localities for the endemic Western Blue butterfly. The other subspecies (<i>T. h. littoralis</i>) is restricted to the south coast. The other two species, both Western Australian endemics, occur abundantly at this site, but are elsewhere scarce.</p>

M107.1 Syst to Library

8/15/95



LEGEND

- A *Spinifex hirsutus* Grassland
- B *Olearia axillaris* Shrubland
- C *Spyridium globulosum*, *Acacia cyclops* Open Heathland
- D *Acacia rostellifera*, *Spyridium globulosum* Closed Scrub
- E *Spyridium globulosum* Closed Heathland
- F *Lepidosperma gladiatum* Sedgeland
- G *Juncus kraussii* Sedgeland
- H *Acacia rostellifera* Closed Scrub
- Ha *Acacia rostellifera* Closed Scrub - degraded condition
- I *Isolepis nodosus* Sedgeland
- J *Lomandra maritima* Herbland
- K *Acacia saligna* Open Scrub over *Lomandra maritima* Herbland
- L *Jacksonia furcellata*, *Spyridium globulosum*, *Acacia saligna*,
Olearia axillaris Open Heathland to Shrubland
- M *Diplolaena dampieri*/*Jacksonia furcellata* Open Heathland
- N *Melaleuca acerosa* Open Heathland
- O *Hakea trifurcata* Closed Heathland
- P *Templetonia retusa* Open Heathland
- Q *Dryandra sessilis* Closed Scrub
- R *Eucalyptus gomphocephala* Woodland
- S *Melaleuca acerosa*, *Acacia pulchella* Open Heathland
- T *Melaleuca acerosa* Open Shrubland over *Lomandra maritima* Herbland
- U *Acacia rostellifera* Open Shrubland over *Lomandra maritima* Herbland
- V *Acacia saligna*, *Olearia axillaris* Open Shrubland



Cleared

Golden Bay Boundary

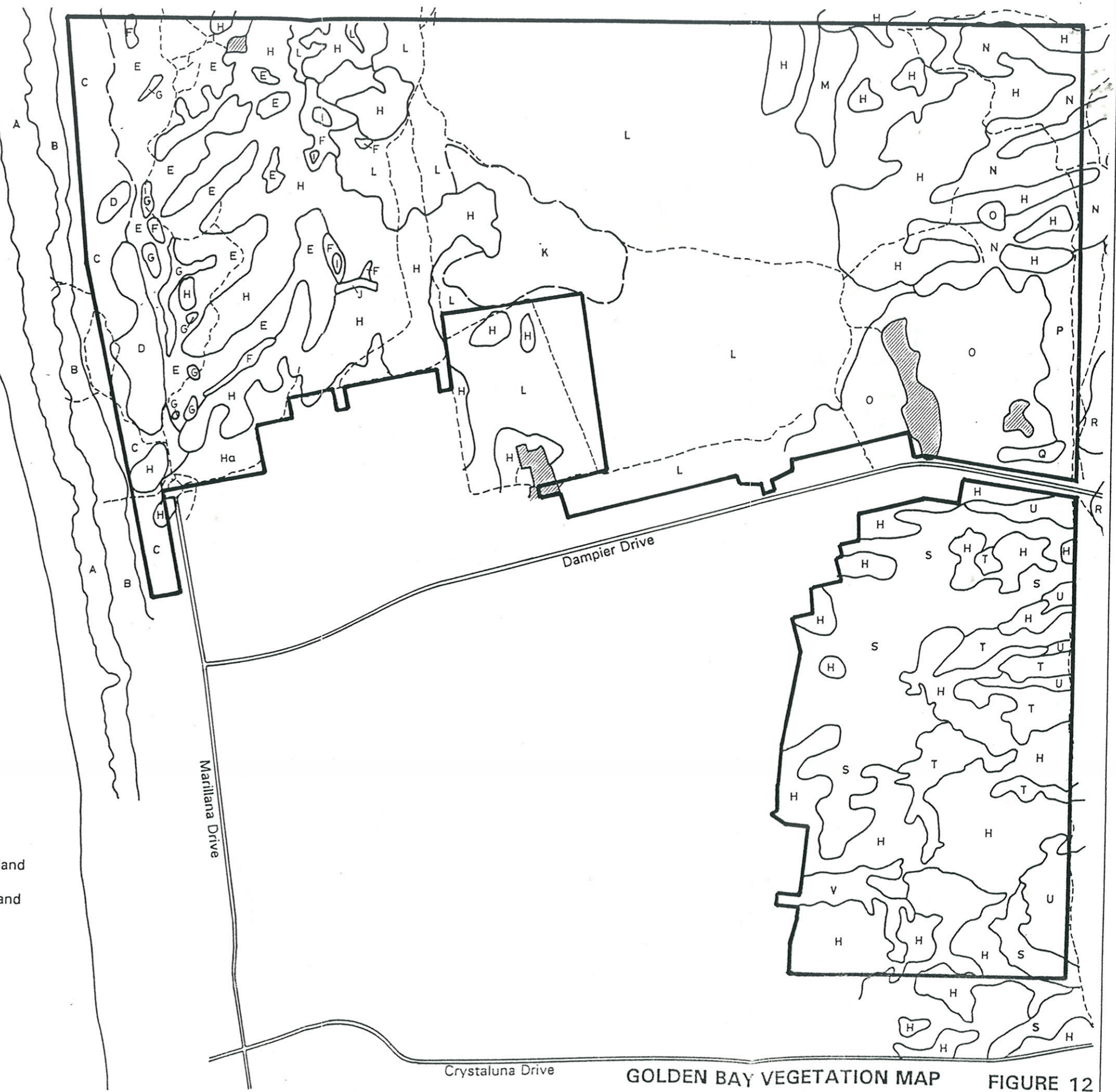
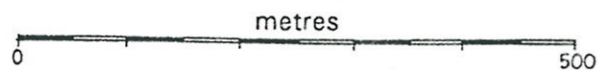

GOLDEN BAY VEGETATION MAP FIGURE 12

From: Alan Tingay & Assoc. & Warren Johnson & Co. 1992

Singleton Amendment to the MRS (affecting part of System 6 area M107) CLR.

18/4/95 M107-2 Syst 6 library



INDIAN OCEAN

LEGEND

- A *Spinifex hirsutus* Grassland
- B *Olearia axillaris* Shrubland
- C *Spiridium globulosum, Acacia cyclops* Open Heathland
- F *Lepidosperma gladiatum* Sedgeland
- H *Acacia rostellifera* Closed Scrub
- L *Jacksonia furcellata, Spyridium globulosum, Acacia saligna, Olearia axillaris* Open Heathland to Shrubland
- S *Melaleuca acerosa* Open Heathland
- W *Allocasuarina humilis* Heathland

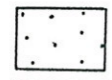

Beach

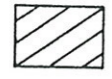

Existing Residential Areas

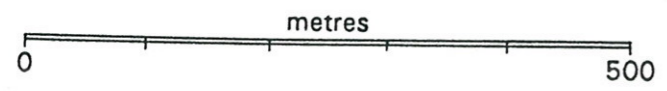

M107

**Urban development of part lot 12 and Reserve
34664 (affecting part of System Six
Recommendation M107), Golden Bay**

H & B Developments Pty Ltd

**Report and recommendations
of the Environmental Protection Authority**

**Full document
available
on request**

**Environmental Protection Authority
Perth, Western Australia
Bulletin 648
September 1992**

**Urban development of lot 1001 (affecting part of
System Six Recommendation M107), Singleton**

Temwood Holdings Pty Ltd

**Report and recommendations
of the Environmental Protection Authority**

**Full document
available
on request**

**Environmental Protection Authority
Perth, Western Australia
Bulletin 649
September 1992**