

373

383

372

374

363

353/1-1

1-2

1-3

1-4

353/1-1

363/1-1

1-5

1-4

1-9

353/1-1

363/1-1

363/2-1

363/2-2

363/2-6

Sent to Ag 4

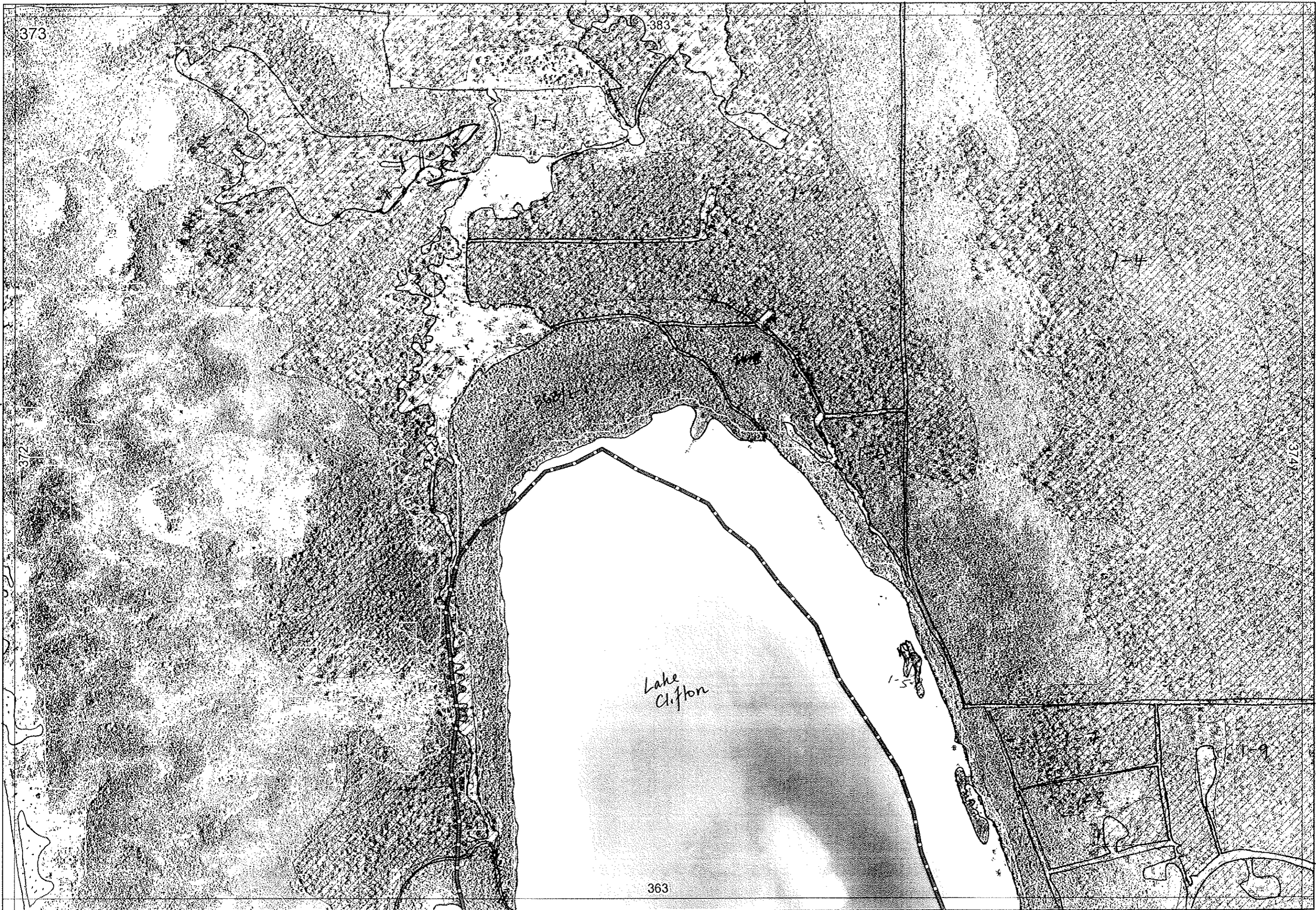

Lake Clifton

373

383

372

374

363

363/1-1

363/1-1

363/2-1

363/2-2

363/2-3

1-1

1-2

1-3

1-4

1-9

1-5

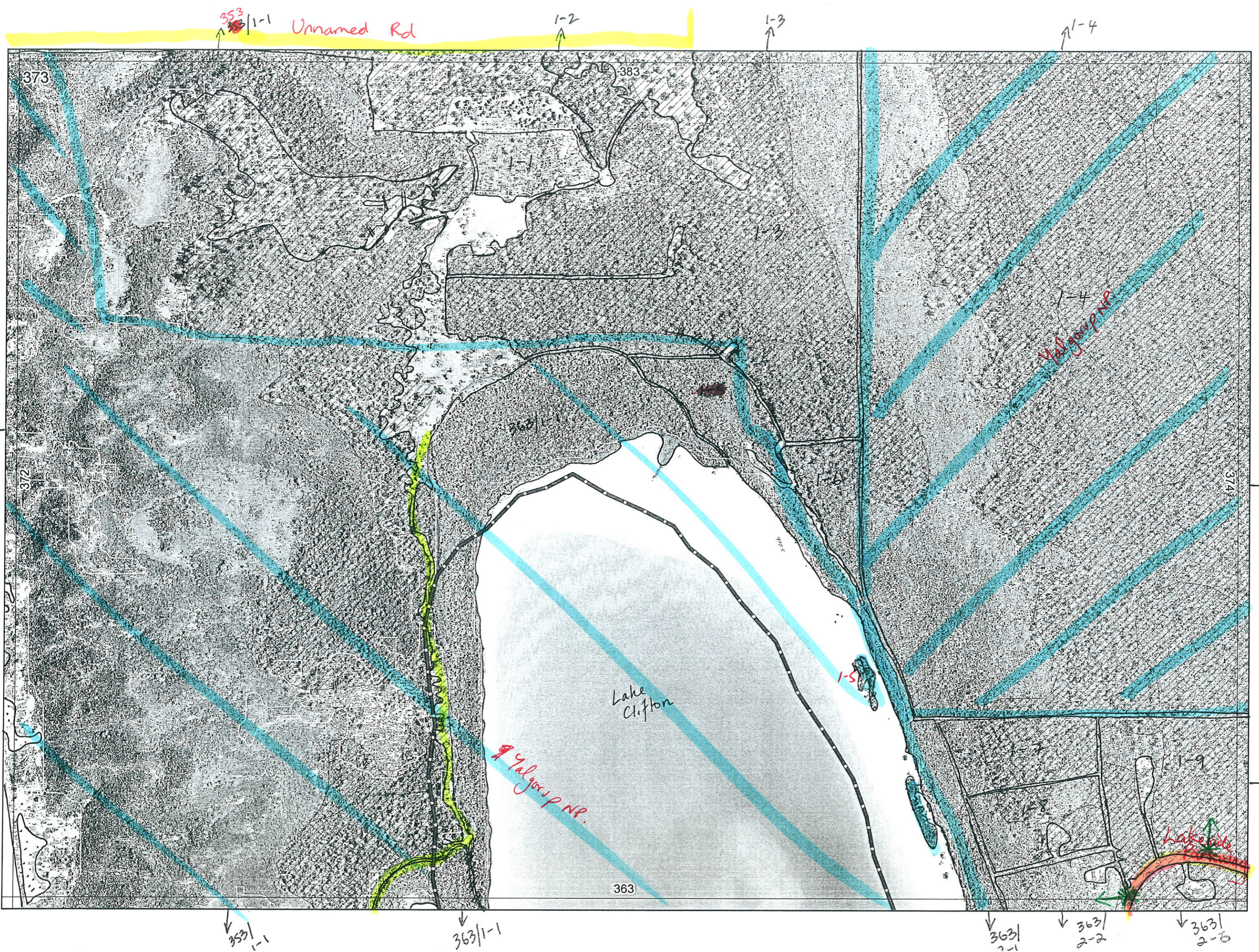

R E M	RE M2	XM AP	LIN TYPE	L I N E A R	M L U	U N I T S	U P L A N D ?	W E T L A N D ?	V I S I T ?	DETAIL/ Area Name	VEG CON	Field date 200_	OBS From	YNOTASS	D E T V I S R E Q D	COMMENTS	VEG STRUC/ DENS	FCT	DOMINANTS		
																			1	2	3
11					M	2	✓	✓				-	Aerial Int	No ACCESS		Grazed					
12	✓				M	1	✓					-	Aerial Int	NO ACCESS		Grazed / Parkland cleared					
13	✓				M S	3	✓	✓				-	Aerial Int	NO ACCESS		Grazed but good tree density					
																Limestone ridge					
14	✓		-	N	S	4	✓	✓	N	Part Yalgourup NP	-	-	Aerial	Detail	N	Partly mapped by Trudgen (1991)	-	-	-	-	-
15					M	1		✓		Yalgourup NP - Lake Clifton Flshore		-	Aerial Int	NO ACCESS							
16					M	2	✓	✓				-	Aerial Int	NO ACCESS							
17					S	1	✓	✓				Ex 20/4	Aerial	No Access	X N						
																	F			Eucgom	Agoflex
18					S	1	✓	✓				Ex 20/4	Aerial	No Access	X N						
																	F			Eucgom	Agoflex
19	✓				S	2	✓	✓				Ex 20/4	Edge		X N	Jarrah down slope & then Tuart paperbark present	F			Banatt	Eucral
																	F			Eucgom	Agoflex

Summary/General Comments