

SYSTEM 6 BUSHLAND SUBMISSION FORM  
FOR CONSIDERATION IN THE UPDATE PROGRAMME

If you wish to submit more than one area for consideration in the System 6 update, please use a separate form for each area.

Please fill in each section giving as much information as possible.

LOCATION, OWNERSHIP AND ZONING OF THE AREA

1. Location

Please give as accurate and detailed a description as possible of the site location  
Please include either a hand drawn or copied map showing the area of the area

a) Bordering Roads: .....

b) Nearest Corner: .....

c) Lot Number: ..... Street Number: .....

d) Town/Suburb/Location: .....

e) Local Council: MANDURAH

f) Site Name (if any): .....

g) Approximate size of the area (ha): 140

h) Please locate the area on a map and give us map references if possible:  
.....

i) Map: ..... Streetsmart /UBD/Other: .....

j) Map no.: .....

k) Grid Ref: .....

l) Please give any other information that may help us to find the location:  
.....

m) Are you aware of any development proposals that are likely to affect the area?  
NO - OTHER THAN IT WILL BE DEVELOPED  
SOMETIME IN THE FUTURE.

NOTE: Areas that have already been given development APPROVAL should not be nominated

SEE

MAP

1

Please fill out those questions that you can answer

2. Who owns the area? (If owned by the person/s making the nomination please indicate)

H. PERRY (OF H & N PERRY, REAL ESTATE AGENTS)

3. If you own the area, and may be interested in participating in conservation on private land initiatives please indicate (and leave your name and address at the end of this submission form)

4. What is the area zoned? (please indicate whether zoning is Town Planning Scheme or Metropolitan Region Scheme) FUTURE URBAN

CAN YOU TELL US A LITTLE ABOUT THE PHYSICAL CHARACTERISTICS OF THE AREA

5. Why do you consider this area important? (Refer to Guiding Issues paper)

SEE ATTACHMENT (2)

6. What is/are the soil type/s and colours? SAND, GREY

Type: Sand/Clay/Gravel/Loam/Silt  
Colour: White/Grey/Brown/Orange/Yellow/Red/Black

7. Does the area have any special features such as unusual landforms / landscapes that still retain their natural vegetation? Yes/No

If yes, what are they? SEE ATTACHMENT 3.

8. Is the area a wetland or does it include a wetland? DAMPLAND IN THE SWALES

If yes, what kind of a wetlands is it?

- a) lake
- b) river
- c) stream
- d) swamp
- e) estuary
- f) seasonally wet
- ✓ g) other

9. What percentage of the wetland is open water in summer? ..... NONE .....

CAN YOU TELL US A LITTLE ABOUT THE VEGETATION /FAUNA ON THE NOMINATED AREA.

10. What percentage of the area is indigenous vegetation? ..... 80% .....

11. If the area includes regions cleared of native bushland please indicate reasons for the inclusion. .... N/A .....

12. Has any previous flora or fauna survey work been done on the area? ..... No .....

If yes, please give details of the work .....

13. How would you rate the condition of the native bushland? (see attached table)

- a) pristine
- b) excellent
- c) very good
- d) good
- e) degraded
- f) completely degraded
- g) don't know

14. Please indicate the disturbances affecting the area and where appropriate the percentage of the area disturbed.

- a) Partial clearing
- b) fragmentation
- c) Selective removal of species: timber cutting, wildflower picking, mowing dieback and other plant diseases
- d) Fire regime, including intensity, season and frequency
- e) 'Enrichment plantings' that is plantings of species not found in that community
- f) Weed invasion - GENERAL
- g) Animal impact: horses, foxes, rabbits, cats, dogs, camels, goats etc
- h) Soil movement, both removal and dumping
- i) Changes in water regimes; flooding, drainage and watering
- j) Salinity
- k) Fertiliser drift and along waterways nutrient influx
- l) Mining, including that for road works

- m) Grazing: stock, overgrazing by feral or native mammals
  - ✓ n) Proliferation of tracks, fire breaks and walk trails
  - o) Off-road vehicle use
  - p) Use as service corridors by the SEC, Main Roads, Water Authority.
- (Source: B Keighery. Bushland Plant Survey, September 1994)

15. Does the area contain any plant species of special interest that you know of? (eg. declared rare flora, priority taxa, outlier populations) ..... YES .....

Do you know what they are? ..... SEE POINT 4 .....

16. Do you know of any native animals that use the area? ..... YES .....

Can you list those you know of? (birds, mammals, reptiles, amphibians etc)  
..... SEE POINT 5 .....

17. Is the area used by any native animals of special interest? (eg. endangered species, large/important populations)..... YES .....

If yes, please name them and indicate source of information  
..... BANDICOOTS - HAVE OBSERVED .....

CAN YOU TELL US A LITTLE ABOUT THE SURROUNDING AREA

18. Are there any bushland areas (including wetlands) near to this area?  
..... YES - SEE MAP 2 .....

If yes, how close are they? ..... ANSTEY SWAMP } 3-4 km  
..... PAGANONI SWAMP } .....

Are they already conservation reserves? ..... YES .....

What is their approximate size? ..... Anstey 250ha, Paganoni - unknown .....

19. Does the submitted area link other bushland areas? YES - The coastal  
+ road landscape protection + RESERVE AREAS .....

Please attach any additional information about the area which may be of use when assessing it.

It is great to be able to nominate an area of bosc. I consider it worthy of preserving, but I feel that I am on the back foot, as I can only reply in layman's language. I hope this aspect does not jeopardise this piece of land's chances.

(2)

This piece of land forms the southernmost boundary of the metropolitan area. It is relatively untouched, with high coastal dunes + deep swales, well vegetated and with diverse fauna. It contains a system 6 transect, M107, between Singleton and Raderon Bay, at the Singleton boundary.

Because of the extensive coastal clearing by both Mandurah + Rockingham developers, this is the last large area of good coastal bush, and I believe it should be preserved in its entirety. It will be a substantial buffer at the end of the Metropolitan area, and will also provide a sustainable habitat for the flora + fauna, already resident.

③ The land is fenced by very high vegetated  
dunes, & deep swales, from the ocean to  
Henderson Road. It is an excellent example of  
the Quidrup dunal system, which used to exist  
before the many coastal billiard table developments

④ Many stands of healthy, fruiting Quidrups,  
Orchids, *Hardenburgia*, *Spinifex*, *Scaevola* & lots  
of bushes & plants I do not have a name for.

⑤ Southern brown bandicoots, kangaroos, splendid whrens,  
red capped parrots, Port Lincoln parrots, Galahs, several  
species of honeyeaters, different finches, hawks,  
Newman Kestrel, all the black & white birds like butcher  
birds, rindlark etc, bobtails, legless lizards, dogites,  
tiger snakes, quite a few different small lizards.

MAP 2

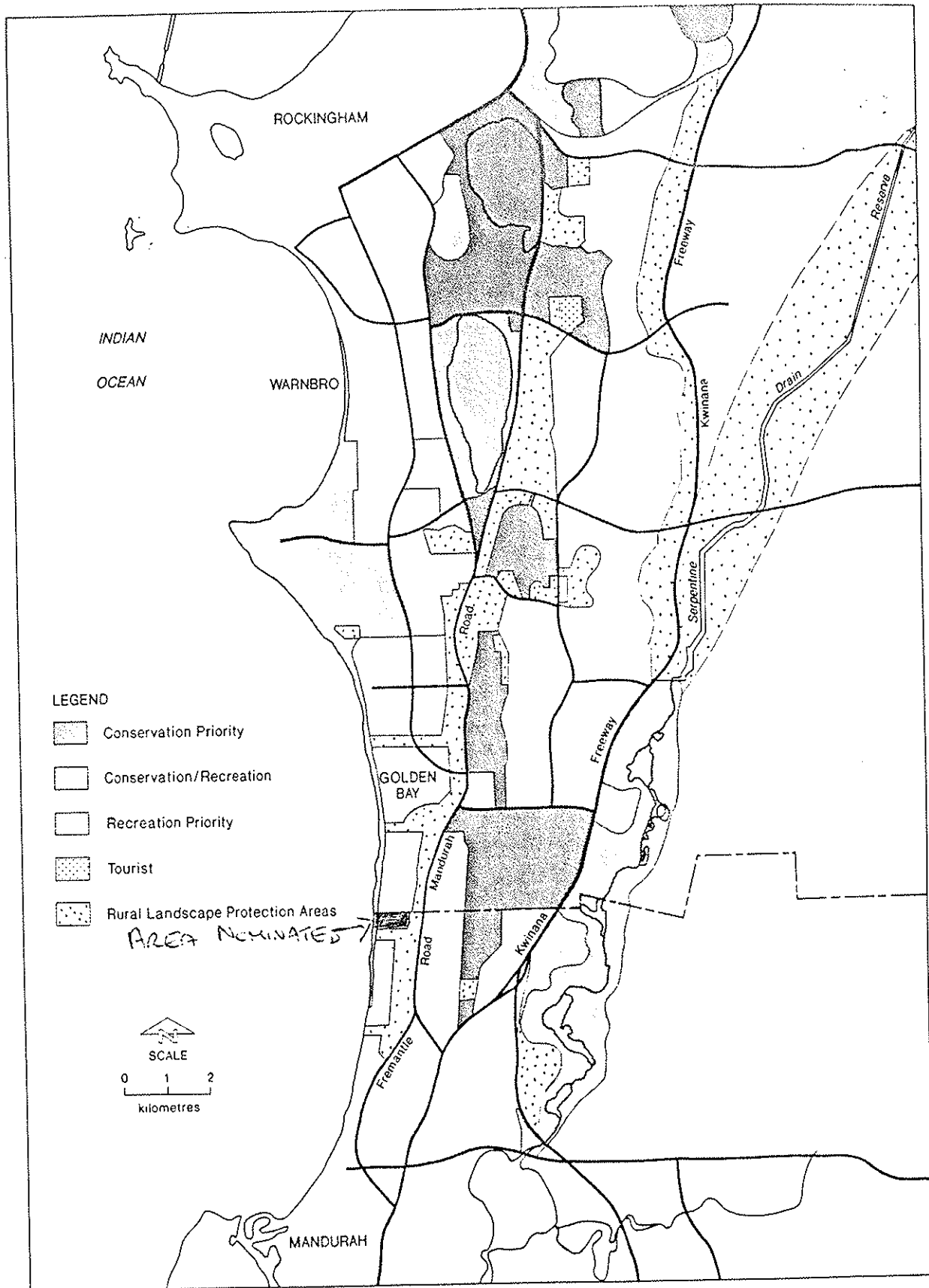

Figure 11 REGION OPEN SPACE SYSTEM CATEGORIES



SINGLETON

M107

PT 3

140 4259ha

PLAN 3064

(THIS BLANK AREA NOT TO SCALE)

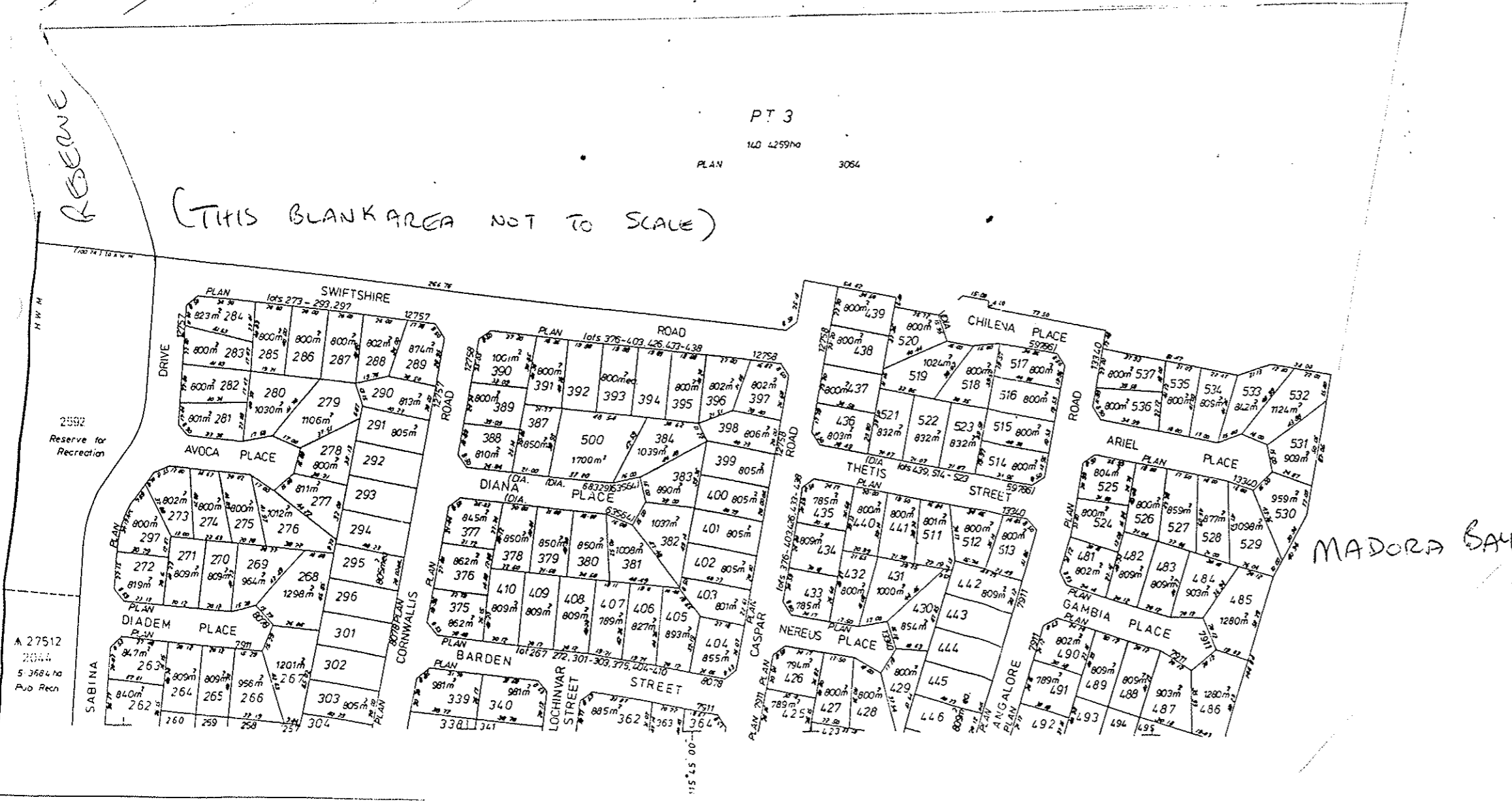

MANDURAH ROAD

MADORA BAY

LANDSCAPE PROTECTION

A 268E8  
2012  
Footway  
34.7m

6869  
013  
Footway  
18.7m

A 27512  
2044  
5.3684ha  
Pub Recn

WILD 1574 UA6A  
Nr 13037 152.72

000025



- 5 0 2 2 - 1 2 6 8 - 5 6 1 0 0 0 2 0 0 0 2 6 0 5 6 -

0 0 0 0 0 0 0 0 3 1 9 7 2 2 0 1 2 5 6 0 1 8 7 2