

(g) property W of Major Springs  
Arthur Lawson owns  
296 1038

look at, not much rem. veg.

(h) Henley St

(i) Saunders St ? lot 53  
W of lot 55 (next to)  
Mrs Gordon <sup>8850</sup> W. Swan Rd 296 4464

look at

(j) Rookwood St , road reserve .

(k) Rookwood St track ? lot 65 .

~~g~~

Shire of Swan 274 9800  
Dave Saunders.

274 5839  
Attention Rates Opt  
(198 - 208)

Subm 137.

except b (199)

(a) lot 15 + 16 Partridge St  
bounded by Woolcott, Youledean, Lord, Partridge

(c) Henley Brook (itself)

(d) The dam.  $\approx 80$  acres.  
end of Casuarina Place, little W of Roberts Rd.

(f) The Pit.  
Homeswest - Ellenbrook Management  
on Arangara Rd

(e) Woolcott St  
? Homeswest or Shire of Swan

# Facsimile Message

Department of Environmental Protection

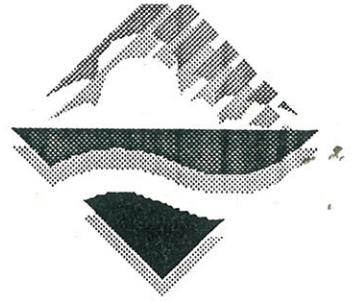

ATTENTION: RATES DPT  
FROM: NATALIE THORNING  
TELEPHONE: 222 7051 No. of sheets following 2  
DATE: 4-10-95

---

MESSAGE Please could you give me the ownership/  
vesting & addresses of the properties outlined in  
thick line. I have marked in the nearby lots  
as interpreted from aerial photo to help.  
Please call if need more info Thankyou.

Westralia Square, 141 St Georges Tce Perth, WA 6000. Fax: (09) 321 5184 Tel: (09) 222 7000

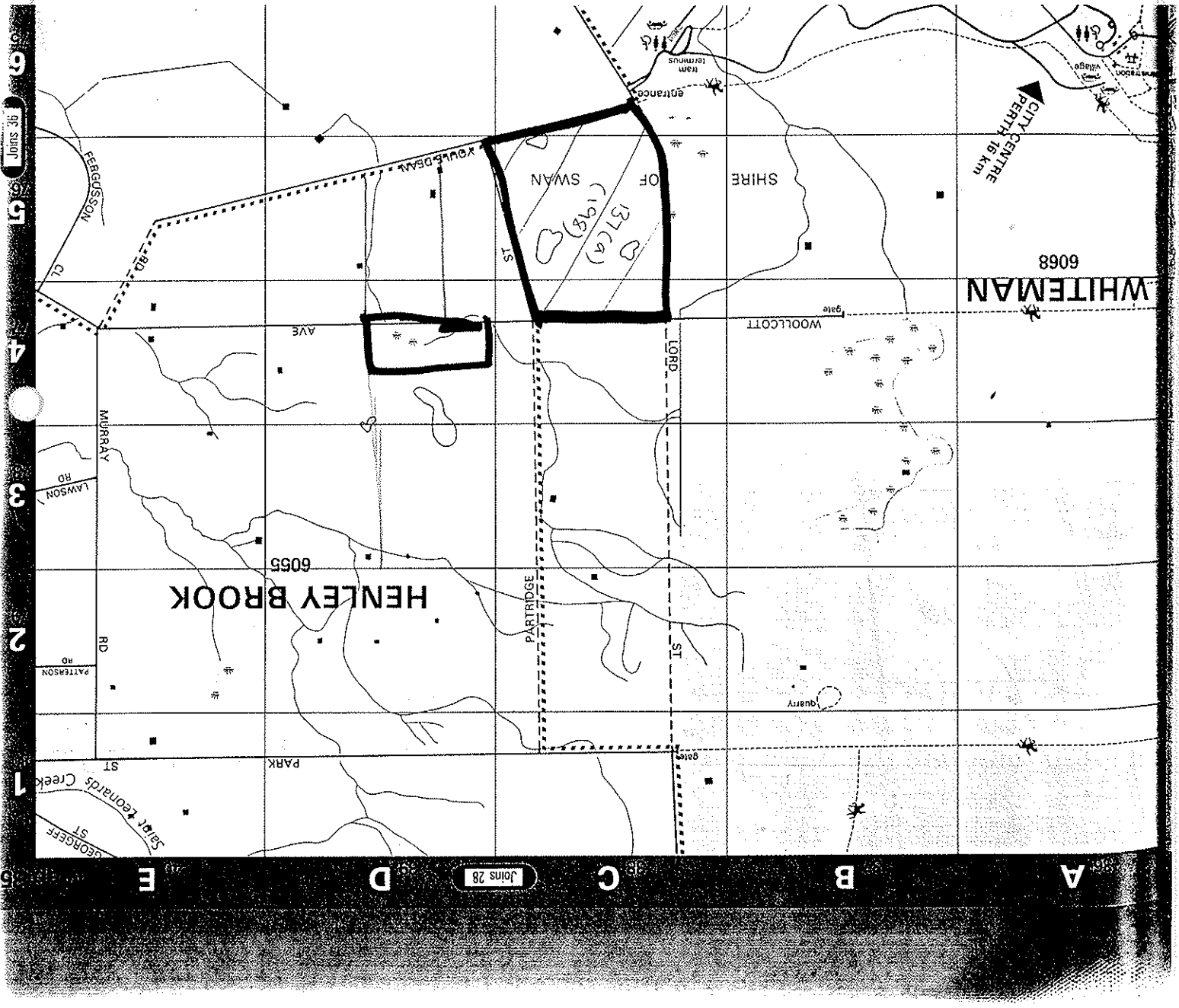
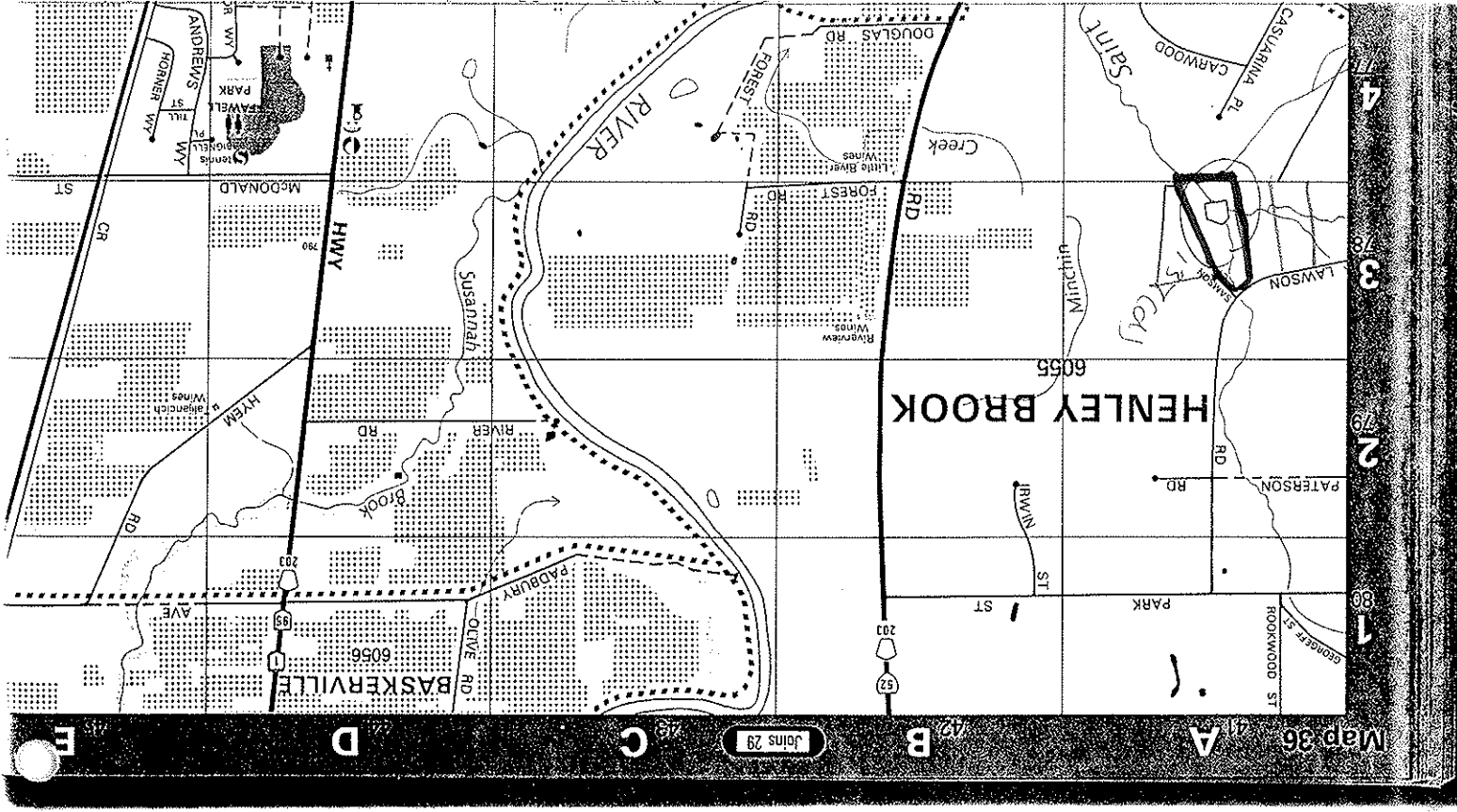

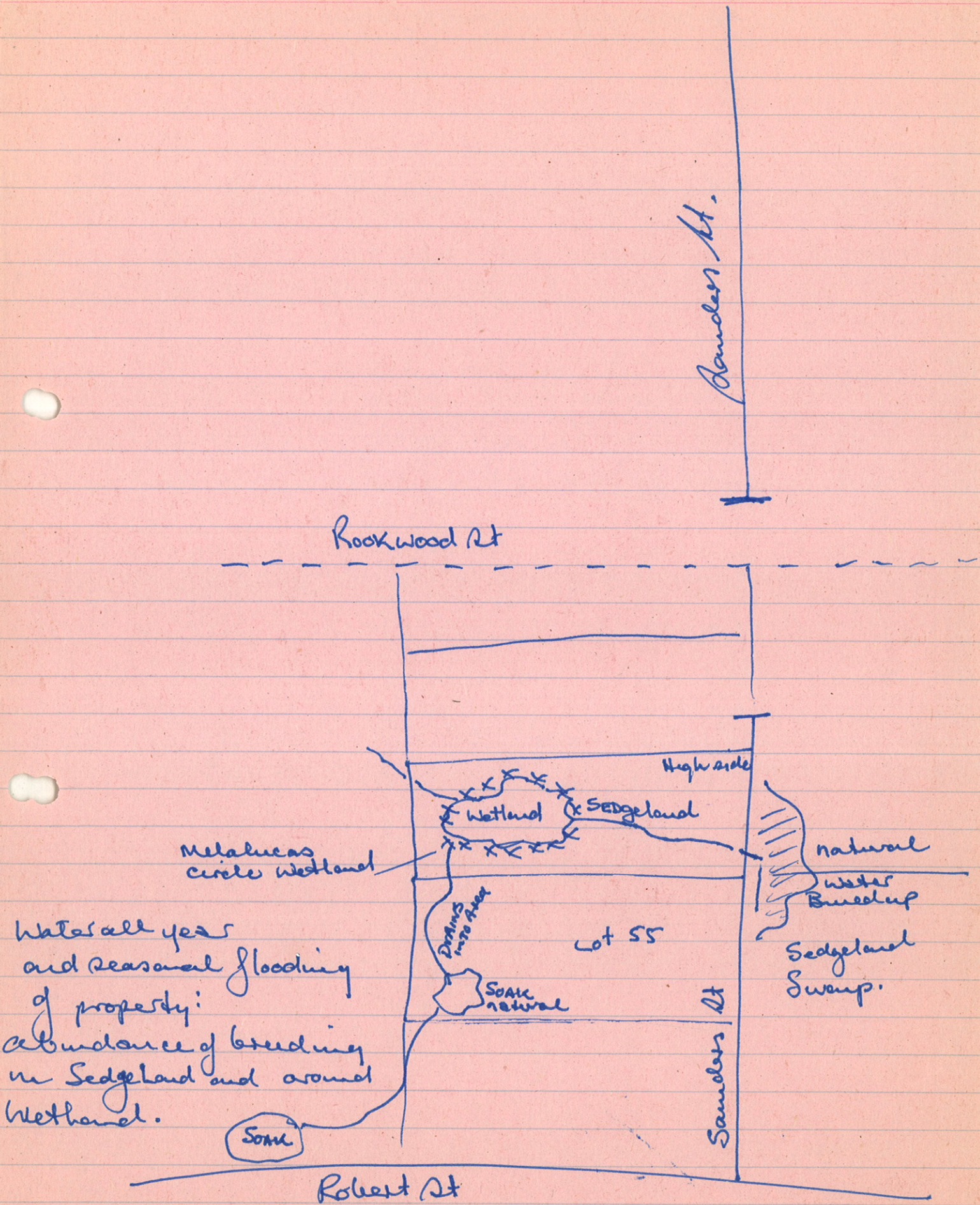

Water all year  
and seasonal flooding  
of property:  
abundance of breeding  
in Sedgeland and around  
Wetland.

Some

Rookwood St

Sanders St.

High side

Melaleucas  
circle wetland

Drains  
into Area

Soak  
natural

Lot 55

natural  
water  
Buildup

Sedgeland  
Swamp.

Sanders St

Robert St

### SYSTEM 6 BUSHLAND SUBMISSION FORM FOR CONSIDERATION IN THE UPDATE PROGRAMME

If you wish to submit more than one area for consideration in the System 6 update, please use a separate form for each area.

Please fill in each section giving as much information as possible.

**LOCATION, OWNERSHIP AND ZONING OF THE AREA**

1. Location *CNR YOULEDEAN ST, and Partudge ST, Woolcott ST  
West Swan*

Please give as accurate and detailed a description as possible of the site location

Please include either a hand drawn or copied map showing the area of the area

a) Bordering Roads: *'Whiteman Park' and on above*

b) Nearest Corner: *Youledean and Lord St*

c) Lot Number: *15 + 16* Partudge ST Street Number: .....

d) Town/Suburb/Location: *West Swan.*

e) Local Council: *Swan Shire*

f) Site Name (if any): *'Sweetwater'*

g) Approximate size of the area (ha): *?*

h) Please locate the area on a map and give us map references if possible:

.....

i) Map: ..... Streetsmart /UBD/Other: .....

j) Map no.: .....

k) Grid Ref: .....

l) Please give any other information that may help us to find the location:

*refer to Map.*

m) Are you aware of any development proposals that are likely to affect the area?

*One side - Lord St Extension:*

*Having trouble with this and now will go into*

**NOTE: Areas that have already been given development APPROVAL should not be nominated**

*Whiteman Park or not use at all.  
HAS no town Planning Approval  
only MRS 950/33*

Please fill out those questions that you can answer

2. Who owns the area? (If owned by the person/s making the nomination please indicate) .....  
? OWNERS CHANGED HANDS RECENTLY.

3. If you own the area, and may be interested in participating in conservation on private land initiatives please indicate (and leave your name and address at the end of this submission form) .....

4. What is the area zoned? (please indicate whether zoning is Town Planning Scheme or Metropolitan Region Scheme) ..... MRS 950/33

CAN YOU TELL US A LITTLE ABOUT THE PHYSICAL CHARACTERISTICS OF THE AREA

5. Why do you consider this area important? (Refer to Guiding Issues paper)  
.....  
Hydrological Priority 1 Area - Rare to See.

6. What is/are the soil type/s and colours? .....

Type: Sand/Clay/Gravel/Loam/Silt  
Colour: White/Grey/Brown/Orange/Yellow/Red/Black

7. Does the area have any special features such as unusual landforms / landscapes that still retain their natural vegetation? Yes/No

If yes, what are they? AS ABOVE  
'See attachment'

8. Is the area a wetland or does it include a wetland? Yes

If yes, what kind of a wetlands is it?

- a) lake
- b) river
- c) stream
- d) swamp
- e) estuary
- f) seasonally wet
- g) other hydrological 1 Area  
Floating Carpets of Grass

9. What percentage of the wetland is open water in summer? *100%*.....

CAN YOU TELL US A LITTLE ABOUT THE VEGETATION /FAUNA ON THE NOMINATED AREA.

10. What percentage of the area is indigenous vegetation? *?*.....

11. If the area includes regions cleared of native bushland please indicate reasons for the inclusion. ....

*Feeder of Water into Caspersham Cribbase and Whittema Park and in turn Bennett Brook.*

12. Has any previous flora or fauna survey work been done on the area?  
..... *No*

If yes, please give details of the work .....

13. How would you rate the condition of the native bushland? (see attached table)

- a) pristine
- b) excellent
- c) very good
- d) good
- e) degraded
- f) completely degraded
- g) don't know

14. Please indicate the disturbances affecting the area and where appropriate the percentage of the area disturbed.

- a) Partial clearing
- b) fragmentation
- c) Selective removal of species: timber cutting, wildflower picking, mowing dieback and other plant diseases
- d) Fire regime, including intensity, season and frequency
- e) 'Enrichment plantings' that is plantings of species not found in that community
- f) Weed invasion
- g) Animal impact: *(horses)*, foxes, rabbits, cats, dogs, camels, goats etc
- h) Soil movement, both removal and dumping
- i) Changes in water regimes; flooding, drainage and watering
- j) Salinity
- k) Fertiliser drift and along waterways nutrient influx
- l) Mining, including that for road works

- m) Grazing: stock overgrazing by feral or native mammals
- n) Proliferation of tracks, fire breaks and walk trails
- o) Off-road vehicle use
- p) Use as service corridors by the SEC, Main Roads, Water Authority.

(Source: B Keighery. Bushland Plant Survey, September 1994)

15. Does the area contain any plant species of special interest that you know of? (eg. declared rare flora, priority taxa, outlier populations) .....

Do you know what they are? .....

16. Do you know of any native animals that use the area? Kangaroos .....

Can you list those you know of? (birds, mammals, reptiles, amphibians etc)

17. Is the area used by any native animals of special interest? (eg. endangered species, large/important populations).....

If yes, please name them and indicate source of information

**CAN YOU TELL US A LITTLE ABOUT THE SURROUNDING AREA**

18. Are there any bushland areas (including wetlands) near to this area?

yes .....

If yes, how close are they? across the road on two sides: .....

Whitemans Park and Caversham Arbore. .....

Are they already conservation reserves? - .....

What is their approximate size? ? .....

19. Does the submitted area link other bushland areas? .....

yes. .....

Please attach any additional information about the area which may be of use when assessing it.

Sweetwater (2 properties - differing owners).

This Area is environmentally in Bushland possibly very degraded.

It has been cleared for grazing of horses. even though, it would come back, as each year, huge crops of Bullrushes, sedges and variety of bush grow over the Area. Huge Melaleucas, to the West of the property.

Many birds are seen resting in Bullrushes, and in the treetops throughout the year.

Kangaroos hop through the fences into this Area from Whitman Park, and you see large groups over the Area.

This was part of the Gwangara Hill Complex, and Mountain Group of Sand, that spread from this property in an Arc to the Sandpit known as 'the Pit' in Henley Brook, and then across Gwangara Rd to Ellenbrook and where Basal Constructions are Sandstone at present, and have Mining leases in the Gwangara Mine Inset.

All these Areas have now been cleared or mined.

In this case:

Sandhills were 40 feet above Sea level.

Cleared to certain height.

This is higher than the House.

It is at base ground water level, and the Soak (very large) is at the same level all year, I've only seen it drop once about 15-20 years ago, to about 2 metres below current level.

" Base constructed in this Area, hit the Channel Sands, and that's how W&W knew of its significance.

In November, Area recharges, water flows out of side of hills into lakes, that have never been measured, (as far as my knowledge).

Then it goes into Springs on Yuledean Rd in the Caretaker's Carbare, into Rose Swamp in Whiteman Park, then into Bennett Brook.

In some areas of the property,  
Ground always green, sedgelands etc,  
Whole ground moves for at least ~~3~~ <sup>4</sup> ~~its~~  
all the hill and lowland, if you jump on it.  
Animals do not go on this Area, only Birds,  
Cranes Herons etc, which breed and feed young  
over the Area.

It has Aboriginal significance in parts for  
watering holes, Noongar people state this, I  
feel this would be true, with amount of water,  
in lakes, water pouring out of side of Hills etc.

This property was also listed in the 'Hally Some'  
Cattle Tracks. (Mary Durako').

In the great droughts, cattlemen drove their cattle  
to the water on this property, as there was always  
water, along with the Springs on Henley Brook itself.

I feel the Area is significant, for Water and thereon,  
for further afield, other environmental Areas,  
Such as Bennett Brook.

If this Area, interfered with, could have  
consequences for all Areas around Whiteman Park.

Very High Level

Woolcott St

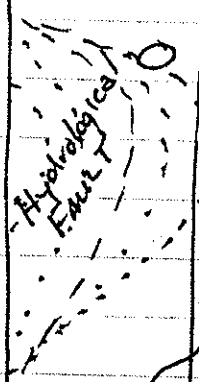
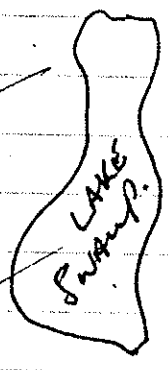

SEASONAL WETLANDS

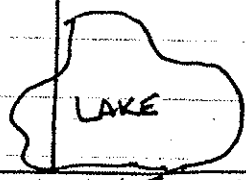

Pantridge St

Youledon St

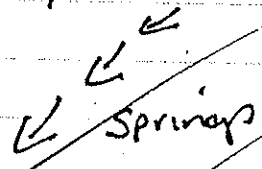

Horse Swamp

Whitman Park

Lord St

Caversham Airbase

Harrow St



CONFIDENTIAL

Sweetwater

(2 properties - differing owners).

This Area is environmentally in Bushland possibly very degraded.

It has been cleared for grazing of horses. even though, it would come back, as each year, huge crops of Bullrushes, sedges and variety of bush grow over the Area. Huge Melaleucas, the West of the property.

Many birds are seen resting in Bullrushes, and in the treetops throughout the year.

Kangaroos hop through the fences into this Area from Whiteman Park, and you see large groups over the Area.

This was part of the Gwangara Hill Complex, and Mountain Group of Sand, that spread from this property in an Arc to the Sandpit known as 'the Pit' in Henley Brook, and then across Gwangara Rd to Ellenbrook and where Basal Constructions are Sandblowing at present, and have Mining leases in the Gwangara Mine Inset.

All these Areas have now been cleared or mined.

In this case:

Sandhills were 40 feet above Sea level.

Cleared to certain height.

This is higher than the House.

It is at base ground water level, and the Soak (very large) is at the same level all year, I've only seen it drop once about 15-20 years ago, to about 2 metres below current level.

Base constructed in this Area, hit the Channel Sands, and that's how WATA knew of its significance.

In November, Area recharges, water flows out of side of hills into lakes, that have never been measured, (as far as my knowledge).

Then it goes into Springs on Yuledean Rd in the Careedham Curbare into Heres Swamp in Whitman Park, then into Bennett Brook.

In some areas of the property,  
Ground always green, sedge lands etc,  
Whole ground moves for at least ~~3~~  
all the hill and lowland, if you jump on it.  
Animals do not go on this Area, only Birds,  
Cranes Herons etc, which breed and feed young  
over the Area.

It has Aboriginal significance in parts for  
Watering holes, Noongar people state this, I  
feel this would be true, with amount of water,  
in lakes, water pouring out of side of Hills etc.

This property was also listed in the 'Hally Lane'  
Cattle Tracks. (Mary Durako').

In the great droughts, cattlemen drove their cattle  
to the water on this property, as there was always  
water, along with the Springs on Henley Brook itself.

I feel the Area is significant, for Water and thereon,  
for further afield, other environmental Areas,  
such as Bennett Brook.

If this Area, interfered with, could have  
consequences for all Areas around Whiteman Park.

Very High Canal

Woolcott ST

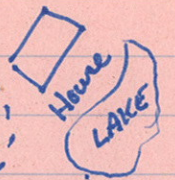
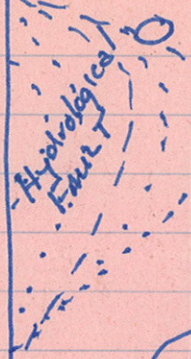
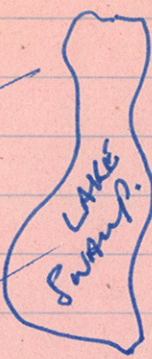

SEASONAL WETLANDS

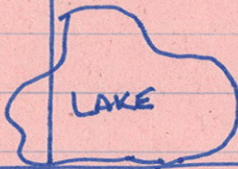

Pontrege ST

Yuledean St

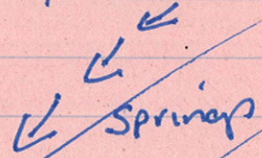

Horse Swamp

Whiteman Park

Lord ST

Caversham Airbase

Harrow St

c.

**SYSTEM 6 BUSHLAND SUBMISSION FORM  
FOR CONSIDERATION IN THE UPDATE PROGRAMME**

If you wish to submit more than one area for consideration in the System 6 update, please use a separate form for each area.

Please fill in each section giving as much information as possible.

**LOCATION, OWNERSHIP AND ZONING OF THE AREA**

1. Location HENLEY BROOK (The Brook itself).  
Never been Surveyed

Please give as accurate and detailed a description as possible of the site location

Please include either a hand drawn or copied map showing the area of the area

a) Bordering Roads: Gnaragara, West Swan, Robert, Brockman ST, John S

b) Nearest Corner: as above

c) Lot Number: ..... Street Number: .....

d) ~~Town~~/Suburb/Location: Henley Brook

e) Local Council: Swan Shire

f) Site Name (if any): .....  
?

g) Approximate size of the area (ha): .....

h) Please locate the area on a map and give us map references if possible:  
.....

i) Map: ..... Streetsmart /UBD/Other: .....

j) Map no.: .....

k) Grid Ref: .....

l) Please give any other information that may help us to find the location:  
.....

m) Are you aware of any development proposals that are likely to affect the area?

No:

EXCEPT: Egerton Development north side of Gnaragara Road.

**NOTE: Areas that have already been given development APPROVAL should not be nominated**

Please fill out those questions that you can answer

2. Who owns the area? (If owned by the person/s making the nomination please indicate) .....

Variety of Landowners.

3. If you own the area, and may be interested in participating in conservation on private land initiatives please indicate (and leave your name and address at the end of this submission form) .....

4. What is the area zoned? (please indicate whether zoning is Town Planning Scheme or Metropolitan Region Scheme) .... Rural - general .....

CAN YOU TELL US A LITTLE ABOUT THE PHYSICAL CHARACTERISTICS OF THE AREA

5. Why do you consider this area important? (Refer to Guiding Issues paper) .....

Refer to attachment.

6. What is/are the soil type/s and colours? .... Variety. ....

Type: Sand/Clay/Gravel/Loam/Silt  
Colour: White/Grey/Brown/Orange/Yellow/Red/Black

7. Does the area have any special features such as unusual landforms / landscapes that still retain their natural vegetation? Yes/No

If yes, what are they? Brook itself: made up of Springs, feeder creeks etc. ....

8. Is the area a wetland or does it include a wetland? .....

If yes, what kind of a wetlands is it?

- a) lake
- b) river ✓
- c) stream
- d) swamp
- e) estuary
- f) seasonally wet (Wet all year) ✓
- g) other

9. What percentage of the wetland is open water in summer? ..... 100%

CAN YOU TELL US A LITTLE ABOUT THE VEGETATION /FAUNA ON THE NOMINATED AREA.

10. What percentage of the area is indigenous vegetation? ..... 80-100%

11. If the area includes regions cleared of native bushland please indicate reasons for the inclusion. ....

12. Has any previous flora or fauna survey work been done on the area?  
..... No..

If yes, please give details of the work .....

13. How would you rate the condition of the native bushland? (see attached table)

- a) pristine
- b) excellent
- c) very good
- d) good
- e) degraded
- f) completely degraded
- g) don't know

14. Please indicate the disturbances affecting the area and where appropriate the percentage of the area disturbed.

- a) Partial clearing near Houses.
- b) fragmentation
- c) Selective removal of species: timber cutting, wildflower picking, mowing dieback and other plant diseases
- d) Fire regime, including intensity, season and frequency
- e) 'Enrichment plantings' that is plantings of species not found in that community
- f) Weed invasion
- g) Animal impact: horses <sup>in part.</sup> foxes, rabbits, cats, dogs, camels, goats etc
- h) Soil movement, both removal and dumping
- i) Changes in water regimes, flooding, drainage and watering <sub>natural</sub>
- j) Salinity
- k) Fertiliser drift and along waterways nutrient influx
- l) Mining, including that for road works

- m) Grazing: stock, overgrazing by feral or native mammals
- n) Proliferation of tracks, fire breaks and walk trails
- o) Off-road vehicle use
- p) Use as service corridors by the SEC, Main Roads, Water Authority.

(Source: B Keighery. Bushland Plant Survey, September 1994)

15. Does the area contain any plant species of special interest that you know of (eg. declared rare flora, priority taxa, outlier populations) .....

Do you know what they are? .....

16. Do you know of any native animals that use the area? .....

*a number of different Birds, cranes etc.*  
Can you list those you know of? (birds, mammals, reptiles, amphibians etc)

17. Is the area used by any native animals of special interest? (eg. endangered species, large/important populations).....

If yes, please name them and indicate source of information  
.....  
.....

CAN YOU TELL US A LITTLE ABOUT THE SURROUNDING AREA

18. Are there any bushland areas (including wetlands) near to this area?  
*yes* .....

If yes, how close are they ? .....

Are they already conservation reserves? *No* .....

What is their approximate size? *?* .....

19. Does the submitted area link other bushland areas? .....

*yes* .....

Please attach any additional information about the area which may be of use when assessing it.

## HENLEY BROOK (Brook itself)

This has never been surveyed:

However, very deep in parts and fast flowing.  
Made up of Springs, feeder creeks,  
in parts builds up to make small Dams,  
then feeds further down into Swan River  
and into one of the feeder Creeks of  
Yandoob Creek, and the Ellen Brook, before hitting  
into the River.

Diverse Vegetation:

Heavy forest canopy in Henley Brook near  
Rockwood St, abutting properties of John St etc.

Birds roost in trees, along with Ducks etc.

Huge populations of Black Cockatoos since  
Ellenbrook Development cleared land.

Only certain times. Huge populations of Herons  
and Cranes.

Quite a number of Shrub Vegetation:

Used also by Vigeans further downstream  
into the Swan Valley.

West Swan Road Area John St - Kangaroos only everywhere and  
again: Ducks everywhere.

Supports Wetlands.

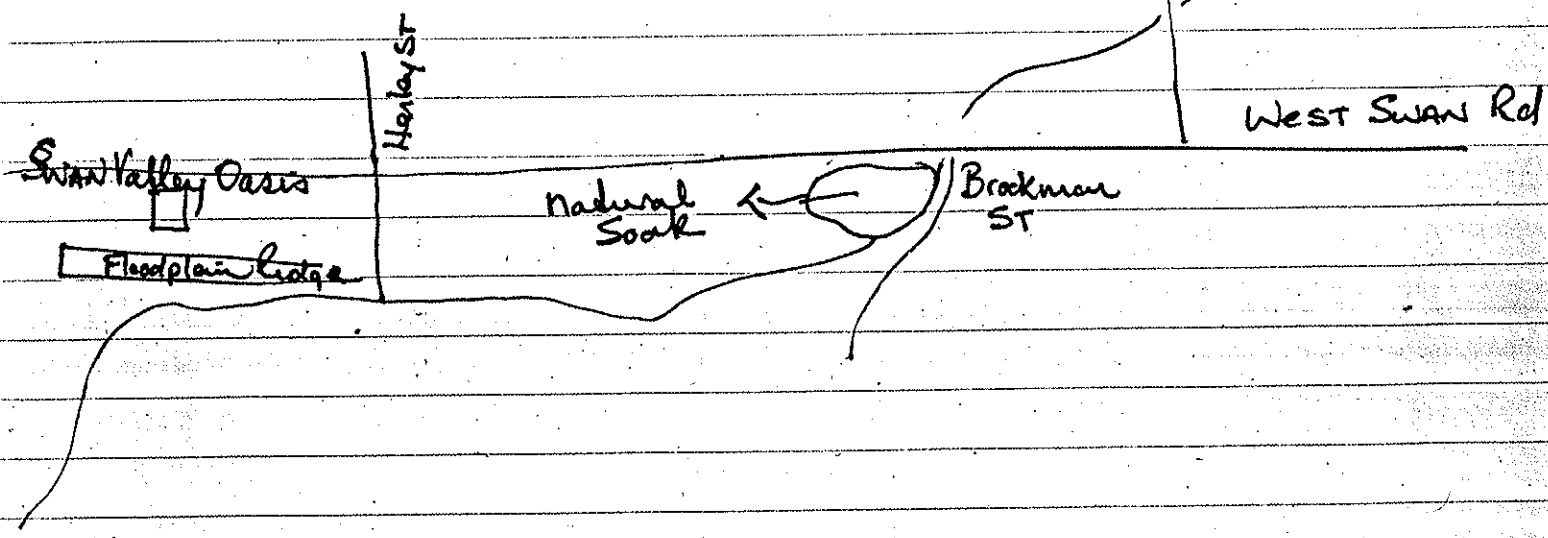
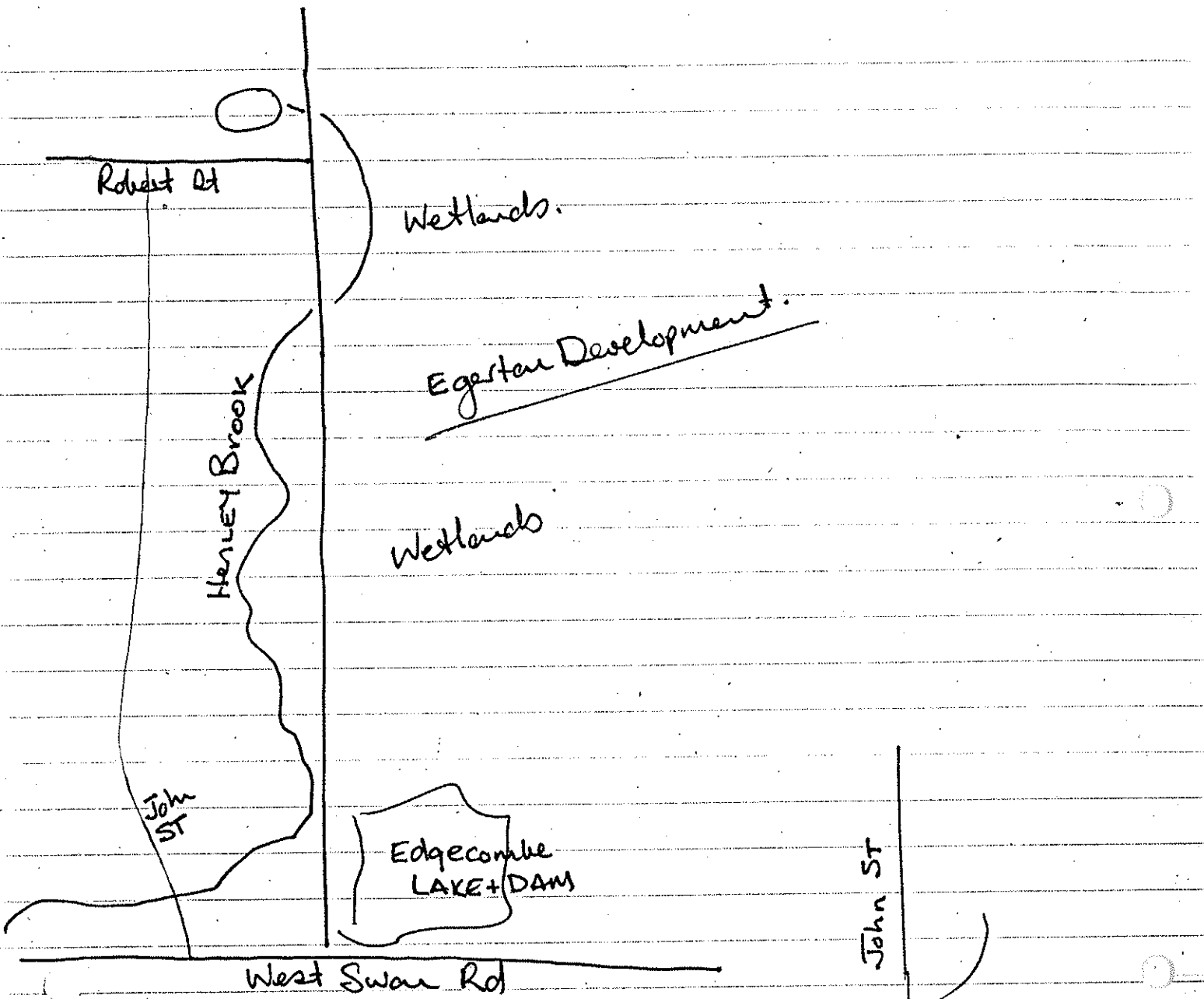

## CONFIDENTIAL

HENLEY BROOK  
(Brook itself)

This has never been surveyed:

However, very deep in parts and fast flowing.  
Made up of Springs, feeder creeks,  
in parts builds up to make small Dams,  
then feeds further down into Swan River  
and into one of the feeder Creeks of  
Jondoo Creek, and the Ellen Brook, before hitting  
into the River.

Diverse Vegetation:

Heavy Suetop Canopy in Henley Brook near  
Rockwood St, abutting properties of John St etc.

Birds roost in trees, along with Ducks etc.

Huge populations of Black Cockatoos since  
Ellenbrook Development cleared land.

Only certain times. Huge populations of Herons  
and Cranes.

Quite a number of Shrub Vegetation:

Used also by Vigeans further downstream  
into the Swan Valley.

West Swan Road Area John St - Kangaroos only every now and  
again: Ducks everywhere.

Supports Wetlands.

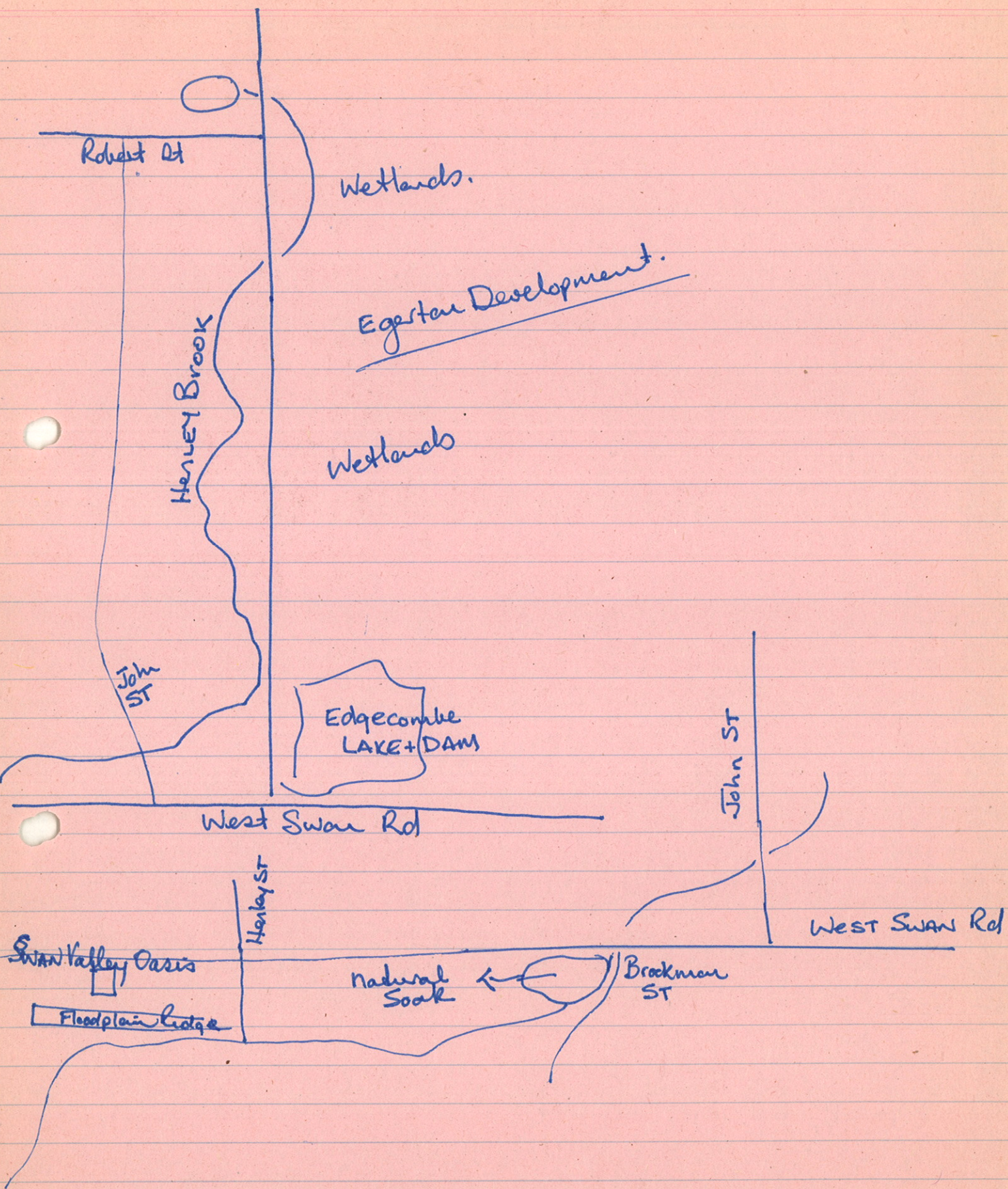

Robert St

Wetlands.

Egerton Development.

Henley Brook

Wetlands

John ST

Edgecombe LAKE + DAM

West Swan Rd

John ST

West Swan Rd

Swan Valley Oasis

Floodplain Ledge

Natural Soak

Brookman ST

# SYSTEM 6 BUSHLAND SUBMISSION FORM FOR CONSIDERATION IN THE UPDATE PROGRAMME

If you wish to submit more than one area for consideration in the System 6 update, please use a separate form for each area.

Please fill in each section giving as much information as possible.

**LOCATION, OWNERSHIP AND ZONING OF THE AREA**

1. Location *DAM- natural } Henley Brook.  
LAWSON ST*

Please give as accurate and detailed a description as possible of the site location  
Please include either a hand drawn or copied map showing the area of the area

a) Bordering Roads: *BACKS onto CASUARINA place.*

b) Nearest Corner: *Murray ST or Bend of LAWSON ST*

c) Lot Number: ..... Street Number: .....

d) Town/Suburb/Location: *Henley Brook*

e) Local Council: *Swan Shire*

f) Site Name (if any): *Locally known as 'The Dam'*

g) Approximate size of the area (ha): *a good 2 acres.*

h) Please locate the area on a map and give us map references if possible:

.....

i) Map: ..... Streetsmart /UBD/Other: .....

j) Map no.: .....

k) Grid Ref: .....

l) Please give any other information that may help us to find the location:

.....

m) Are you aware of any development proposals that are likely to affect the area?

*No.*

.....

**NOTE: Areas that have already been given development APPROVAL should not be nominated**

Please fill out those questions that you can answer

2. Who owns the area? (If owned by the person/s making the nomination please indicate) .....  
..... ?

3. If you own the area, and may be interested in participating in conservation on private land initiatives please indicate (and leave your name and address at the end of this submission form) .....

4. What is the area zoned? (please indicate whether zoning is Town Planning Scheme or Metropolitan Region Scheme) ... Rural .....

CAN YOU TELL US A LITTLE ABOUT THE PHYSICAL CHARACTERISTICS OF THE AREA

5. Why do you consider this area important? (Refer to Guiding Issues paper)  
Lot of Vegetation; Birdlife up here etc.  
ITS A natural Basin for water from St Leonards Brook  
Very Very Deep - runs on into Wandli Creek system

6. What is/are the soil type/s and colours? .....  
Type: Sand/Clay/Gravel/Loam/Silt  
Colour: White/Grey/Brown/Orange/Yellow/Red/Black } Hard to tell.

7. Does the area have any special features such as unusual landforms / landscapes that still retain their natural vegetation? Yes/No  
If yes, what are they? Drainage system.  
Grass/Ridge lands along sides.

8. Is the area a wetland or does it include a wetland? .....  
If yes, what kind of a wetlands is it?

- a) Lake DAM. 'People Quite through the Area'  
Swim Hoses in Summer.
- b) river
- c) stream Kids play as a Swimming Pool.
- d) swamp
- e) estuary
- f) seasonally wet
- g) other

9. What percentage of the wetland is open water in summer? ..... 100%

CAN YOU TELL US A LITTLE ABOUT THE VEGETATION /FAUNA ON THE NOMINATED AREA.

10. What percentage of the area is indigenous vegetation? ..... ? all 100%.

11. If the area includes regions cleared of native bushland please indicate reasons for the inclusion. ....

12. Has any previous flora or fauna survey work been done on the area?

..... No.

If yes, please give details of the work .....

13. How would you rate the condition of the native bushland? (see attached table)

- a) pristine
- b) excellent
- c) very good
- d) good
- e) degraded
- f) completely degraded
- g) don't know

14. Please indicate the disturbances affecting the area and where appropriate the percentage of the area disturbed.

- a) Partial clearing
- b) fragmentation
- c) Selective removal of species: timber cutting, wildflower picking, mowing dieback and other plant diseases
- d) Fire regime, including intensity, season and frequency
- e) 'Enrichment plantings' that is plantings of species not found in that community
- f) Weed invasion
- g) Animal impact: horses, foxes, rabbits, cats, dogs, camels, goats etc
- h) Soil movement, both removal and dumping
- i) Changes in water regimes; flooding, drainage and watering
- j) Salinity
- k) Fertiliser drift and along waterways nutrient influx
- l) Mining, including that for road works

- m) Grazing: stock, overgrazing by feral or native mammals
  - n) Proliferation of tracks, fire breaks and walk trails
  - o) Off-road vehicle use
  - p) Use as service corridors by the SEC, Main Roads, Water Authority.
- (Source: B Keighery. Bushland Plant Survey, September 1994)

15. Does the area contain any plant species of special interest that you know of?  
(eg. declared rare flora, priority taxa, outlier populations) .....

Do you know what they are? .....

16. Do you know of any native animals that use the area? *Kangaroos*  
*Birds, reptiles, Frogs etc. (many tracks around area).*  
Can you list those you know of? (birds, mammals, reptiles, amphibians etc)

17. Is the area used by any native animals of special interest? (eg. endangered species, large/important populations).....

If yes, please name them and indicate source of information  
.....  
.....

CAN YOU TELL US A LITTLE ABOUT THE SURROUNDING AREA

18. Are there any bushland areas (including wetlands) near to this area?  
*Yes*.....

If yes, how close are they? *500 yards or so.*  
.....  
.....

Are they already conservation reserves? *No.*  
.....

What is their approximate size? *?*  
.....

19. Does the submitted area link other bushland areas? .....

*Not really - hard to say.*

Please attach any additional information about the area which may be of use when assessing it.

Woolcott ST

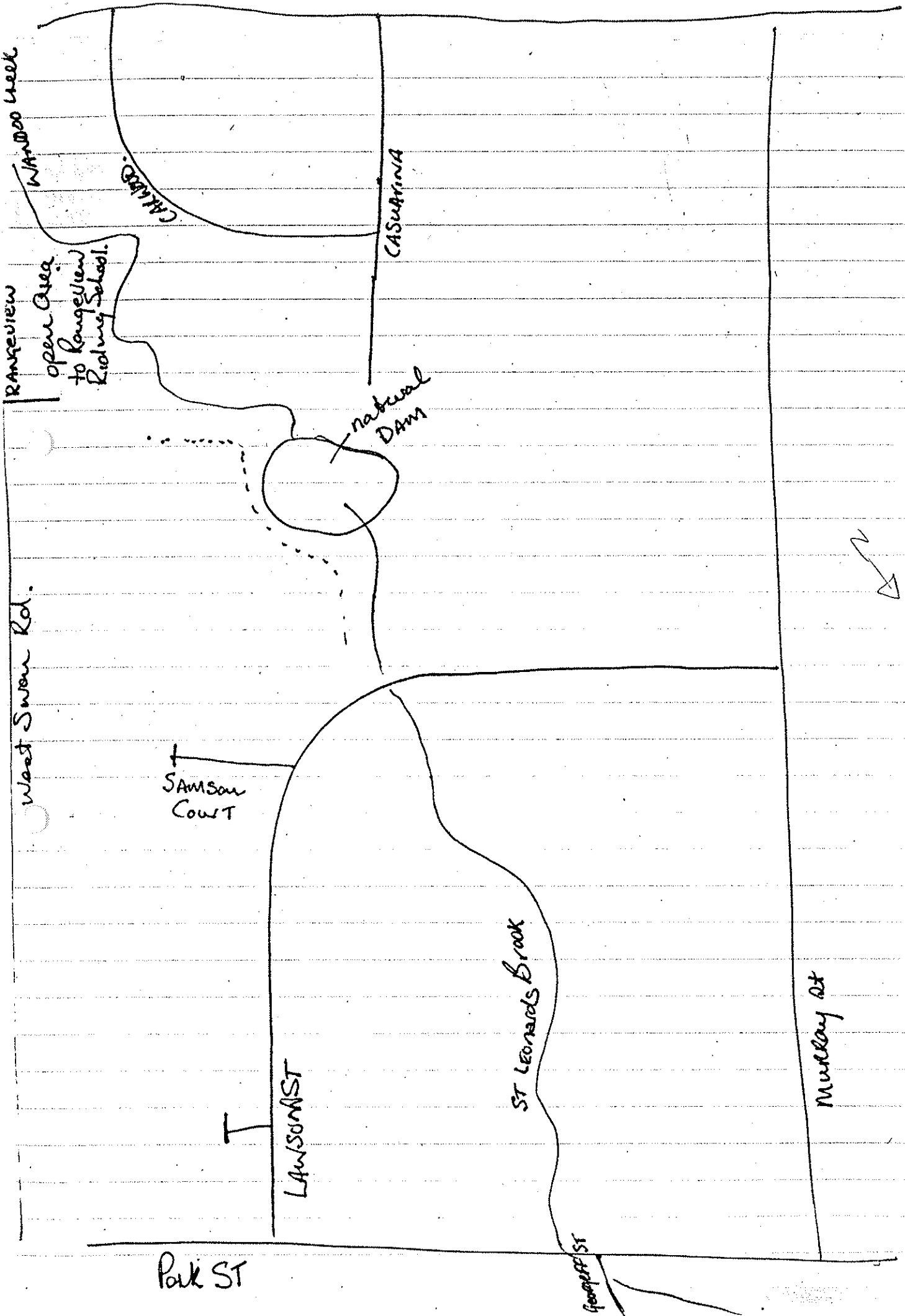

Rangview

open Area to Rangview Riding School.

CHARD

CASUARINA

natural DAM

West Swan Rd.

SAMSAN COURT

LAWSON ST

Park ST

ST LEONARDS Brook

Geoff ST

MULLAY St



CONFIDENTIAL

Box ST

137 d

LAWSON ST

LAWSON COURT

ST LEONARD'S BROOK

MURRAY ST

West Swan Rd.

RANGEVIEW

open Area  
to Rangeview  
Riding School.

WINDOOR CREEK

CALICOO

CASUARINA

natural  
Dam

WOLLCOTT ST

George St

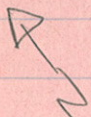

### SYSTEM 6 BUSHLAND SUBMISSION FORM FOR CONSIDERATION IN THE UPDATE PROGRAMME

If you wish to submit more than one area for consideration in the System 6 update, please use a separate form for each area.

Please fill in each section giving as much information as possible.

**LOCATION, OWNERSHIP AND ZONING OF THE AREA**

1. Location Woolcott ST West Swan/Henley Brook

Please give as accurate and detailed a description as possible of the site location  
Please include either a hand drawn or copied map showing the area of the area

a) Bordering Roads: Woolcott ST

b) Nearest Corner: MURRAY ST

c) Lot Number: ..... Street Number: .....

d) Town/Suburb/Location: West Swan - Henley Brook

e) Local Council: Swan Shire

f) Site Name (if any): ?

g) Approximate size of the area (ha): Quite an Area in Sections.

h) Please locate the area on a map and give us map references if possible:

.....

i) Map: ..... Streetsmart /UBD/Other: .....

j) Map no.: .....

k) Grid Ref: .....

l) Please give any other information that may help us to find the location:

halfway up Woolcott going West

m) Are you aware of any development proposals that are likely to affect the area?

No.

no development approval as no structure plan presented as yet.

**NOTE: Areas that have already been given development APPROVAL should not be nominated**

NOTE: I haven't been over the ridge for many years however I pass water on Woolcott ST Daily - abundance of Bushlife every day and sight Kangaroos etc.

Please fill out those questions that you can answer

2. Who owns the area? (If owned by the person/s making the nomination please indicate) NOT SURE!  
Either HOMESWEST OR SHIRE OF BAYSWATER?

3. If you own the area, and may be interested in participating in conservation on private land initiatives please indicate (and leave your name and address at the end of this submission form) .....

4. What is the area zoned? (please indicate whether zoning is Town Planning Scheme or Metropolitan Region Scheme) IN PART MRS 9.50/33 only.

CAN YOU TELL US A LITTLE ABOUT THE PHYSICAL CHARACTERISTICS OF THE AREA

5. Why do you consider this area important? (Refer to Guiding Issues paper)  
OVER THE YEARS: ONLY HUGE AREA OF WATER THAT IS SO FULL, SWIM HORSES IN WEST SWAN.

6. What is/are the soil type/s and colours? SOIL TYPE?

Type: Sand/Clay/Gravel/Loam/Silt  
Colour: White/Grey/Brown/Orange/Yellow/Red/Black

7. Does the area have any special features such as unusual landforms / landscapes that still retain their natural vegetation? Yes/No

If yes, what are they? A  $\frac{3}{4}$  Semi Arc on a hill: water one side: other side shallower: MANY TYPES OF ANIMALS ON LEE Side.

8. Is the area a wetland or does it include a wetland? .....

If yes, what kind of a wetlands is it?

a) lake

b) river

c) stream

d) swamp

e) estuary

f) seasonally wet wet all year.

g) other

9. What percentage of the wetland is open water in summer? ..... 100%

CAN YOU TELL US A LITTLE ABOUT THE VEGETATION /FAUNA ON THE NOMINATED AREA.

10. What percentage of the area is indigenous vegetation? ..... MELALUCAS IN ABUNDANCE.

11. If the area includes regions cleared of native bushland please indicate reasons for the inclusion. ....

ON North Side it looks grazed out other than cleared.

12. Has any previous flora or fauna survey work been done on the area?

..... No.

If yes, please give details of the work .....

13. How would you rate the condition of the native bushland? (see attached table)

- a) pristine
- b) excellent
- c) very good
- d) good
- e) degraded
- f) completely degraded
- g) don't know



14. Please indicate the disturbances affecting the area and where appropriate the percentage of the area disturbed.

- a) Partial clearing
- b) fragmentation
- c) Selective removal of species: timber cutting, wildflower picking, mowing dieback and other plant diseases
- d) Fire regime, including intensity, season and frequency
- e) 'Enrichment plantings' that is plantings of species not found in that community
- f) Weed invasion
- g) Animal impact: horses, foxes, rabbits, cats, dogs, camels, goats etc
- h) Soil movement, both removal and dumping
- i) Changes in water regimes; flooding, drainage and watering
- j) Salinity
- k) Fertiliser drift and along waterways nutrient influx
- l) Mining, including that for road works

m) Grazing: stock, overgrazing by feral or native mammals

n) Proliferation of tracks, fire breaks and walk-trails

o) Off-road vehicle use

p) Use as service corridors by the SEC, Main Roads, Water Authority.

(Source: B Keighery. Bushland Plant Survey, September 1994)

abundance of large colonies  
of differing families  
of Wallabies  
and Kangaroos

15. Does the area contain any plant species of special interest that you know of?  
(eg. declared rare flora, priority taxa, outlier populations) .....

Do you know what they are? .....

16. Do you know of any native animals that use the area? .....

WALLABIES (black gloved) - Kangaroos different markings in groups:

Can you list those you know of? (birds, mammals, reptiles, amphibians etc)

Thousands of Birds, From Ducks, Pelicans Swans at times etc.  
Herons cranes, to small birds.

17. Is the area used by any native animals of special interest? (eg. endangered species, large/important populations).....

If yes, please name them and indicate source of information

.....  
.....

CAN YOU TELL US A LITTLE ABOUT THE SURROUNDING AREA

18. Are there any bushland areas (including wetlands) near to this area?

Yes .....

If yes, how close are they?  $\frac{1}{4}$  -  $\frac{1}{2}$  mile

all around .....

Are they already conservation reserves? No:

What is their approximate size? .....

19. Does the submitted area link other bushland areas? .....

Not really .....

Please attach any additional information about the area which may be of use when assessing it.

Road Cut through Water

Cleared Land

Natural Under Hole  
Swim Here

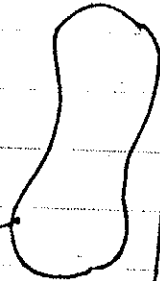

Woolcott ST

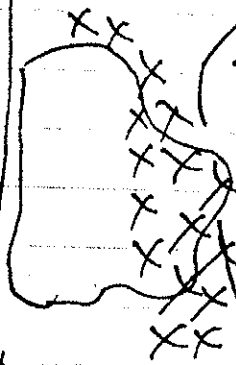

Ridge - Hill

Water

Sedges etc

Birds

Kangaroos etc

X Forest of Melaleucas.

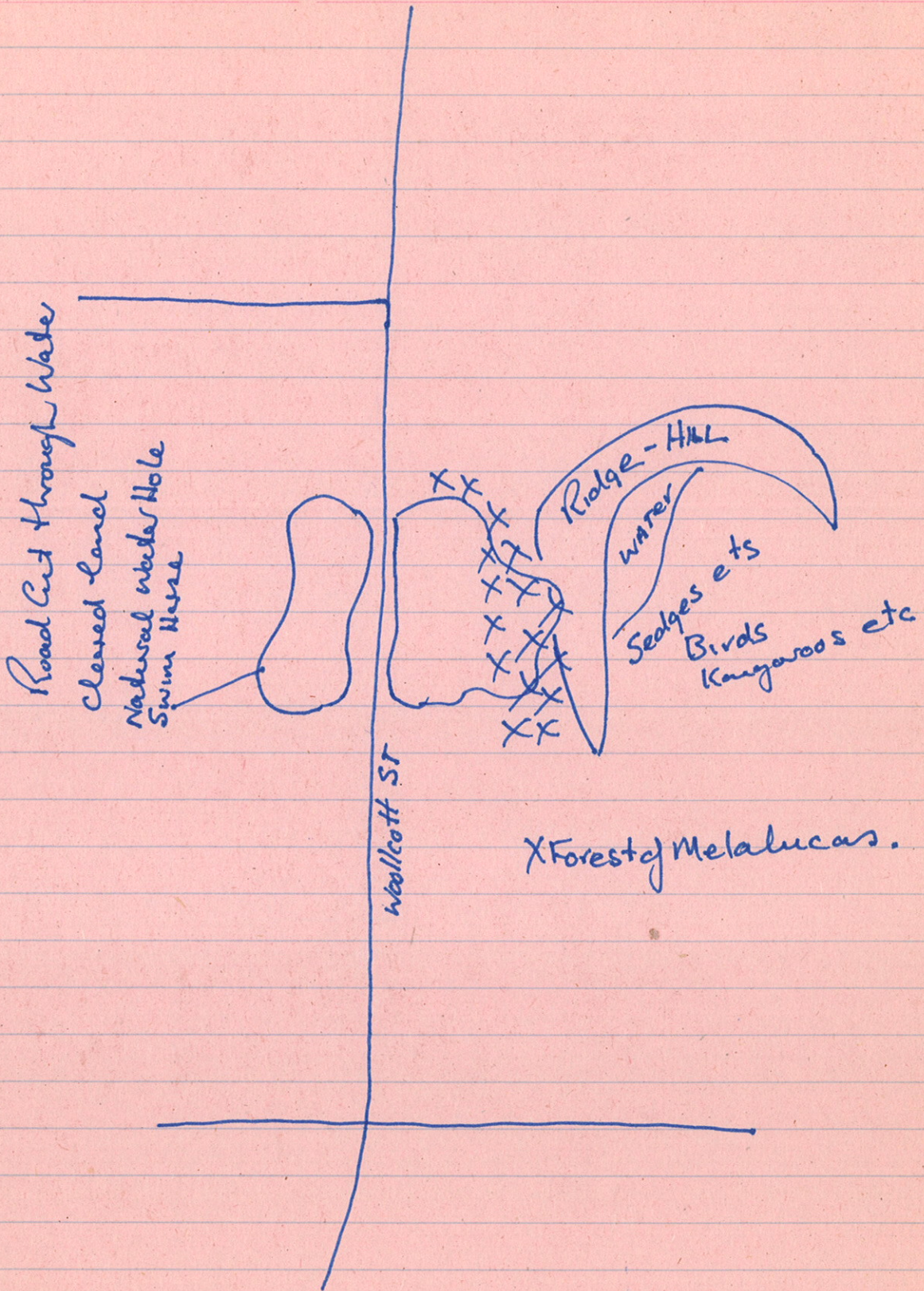

F.

**SYSTEM 6 BUSHLAND SUBMISSION FORM  
FOR CONSIDERATION IN THE UPDATE PROGRAMME**

If you wish to submit more than one area for consideration in the System 6 update, please use a separate form for each area.

Please fill in each section giving as much information as possible.

**LOCATION, OWNERSHIP AND ZONING OF THE AREA**

1. Location *'The Pit'*  
*'HENLEY BROOK itself'*

Please give as accurate and detailed a description as possible of the site location  
Please include either a hand drawn or copied map showing the area of the area

a) Bordering Roads: *Robert and Gungahra Roads*

b) Nearest Corner: *Robert ST*

c) Lot Number: ..... Street Number: .....

d) ~~Town~~/~~Suburb~~/Location: *Henley Brook*

e) Local Council: *Shire of Swan*

f) Site Name (if any): *Locally known as Henley Brook 'Pit'*

g) Approximate size of the area (ha): *80 acres*

h) Please locate the area on a map and give us map references if possible:

i) Map: ..... Streetsmart /UBD/Other: .....

j) Map no.: .....

k) Grid Ref: .....

l) Please give any other information that may help us to find the location:

*Vacant and degraded*

m) Are you aware of any development proposals that are likely to affect the area?

*in 15-20 years - forms part of Ellenbrook Development*

*Has not been Approved - No Concept or Structure plan as yet.*

**NOTE: Areas that have already been given development APPROVAL should not be nominated**

*(Henley Brook Ave proposed.)*

Please fill out those questions that you can answer

2. Who owns the area? (If owned by the person/s making the nomination please indicate) .....  
Ellenbrook Management - Homeswest.

3. If you own the area, and may be interested in participating in conservation on private land initiatives please indicate (and leave your name and address at the end of this submission form) .....

4. What is the area zoned? (please indicate whether zoning is Town Planning Scheme or Metropolitan Region Scheme) ....MRS 950/33.....

CAN YOU TELL US A LITTLE ABOUT THE PHYSICAL CHARACTERISTICS OF THE AREA

5. Why do you consider this area important? (Refer to Guiding Issues paper)  
.....  
refer attachment

6. What is/are the soil type/s and colours ? .....  
Type: Sand/Clay/Gravel/Loam/Silt ..... to the West  
Colour: White/Grey/Brown/Orange/Yellow/Red/Black ..... Ferrocete ridge, East.

7. Does the area have any special features such as unusual landforms / landscapes that still retain their natural vegetation? Yes/No  
If yes, what are they? ..... refer to attachment.

8. Is the area a wetland or does it include a wetland? ..... yes.

- If yes, what kind of a wetlands is it?
- a) lake
  - b) river
  - c) stream
  - d) swamp
  - e) estuary
  - f) seasonally wet
  - g) other
- Source of two river systems.  
refer to attachment.

9. What percentage of the wetland is open water in summer? ..... 100% .....

CAN YOU TELL US A LITTLE ABOUT THE VEGETATION /FAUNA ON THE NOMINATED AREA.

10. What percentage of the area is indigenous vegetation? ..... ? .....

11. If the area includes regions cleared of native bushland please indicate reasons for the inclusion. ....

..... Heathland .....

12. Has any previous flora or fauna survey work been done on the area?

..... No. ....

If yes, please give details of the work .....

13. How would you rate the condition of the native bushland? (see attached table)

- a) pristine
- b) excellent
- c) very good
- d) good
- e) degraded
- f) completely degraded
- g) don't know

14. Please indicate the disturbances affecting the area and where appropriate the percentage of the area disturbed.

- a) Partial clearing
- b) fragmentation
- c) Selective removal of species: timber cutting, wildflower picking, mowing dieback and other plant diseases
- d) Fire regime, including intensity, season and frequency
- e) 'Enrichment plantings' that is plantings of species not found in that community
- f) Weed invasion
- g) Animal impact: horses, foxes, rabbits, cats, dogs, camels, goats etc
- h) Soil movement, both removal and dumping
- \* i) Changes in water regimes; flooding, drainage and watering
- j) Salinity
- k) Fertiliser drift and along waterways nutrient influx
- l) Mining, including that for road works

- m) Grazing: stock, overgrazing by feral or native mammals
- n) Proliferation of tracks, fire breaks and walk trails
- o) Off-road vehicle use
- p) Use as service corridors by the SEC, Main Roads, Water Authority.

(Source: B Keighery. Bushland Plant Survey, September 1994)

15. Does the area contain any plant species of special interest that you know of?  
(eg. declared rare flora, priority taxa, outlier populations) .....

Do you know what they are? .....

16. Do you know of any native animals that use the area? .....

Can you list those you know of? (birds, mammals, reptiles, amphibians etc)

17. Is the area used by any native animals of special interest? (eg. endangered species, large/important populations).....

If yes, please name them and indicate source of information

.....  
.....

**CAN YOU TELL US A LITTLE ABOUT THE SURROUNDING AREA**

18. Are there any bushland areas (including wetlands) near to this area?  
.....

If yes, how close are they ? .....

.....  
.....

Are they already conservation reserves? .....

What is their approximate size? .....

19. Does the submitted area link other bushland areas? .....

.....  
.....

Please attach any additional information about the area which may be of use when assessing it.

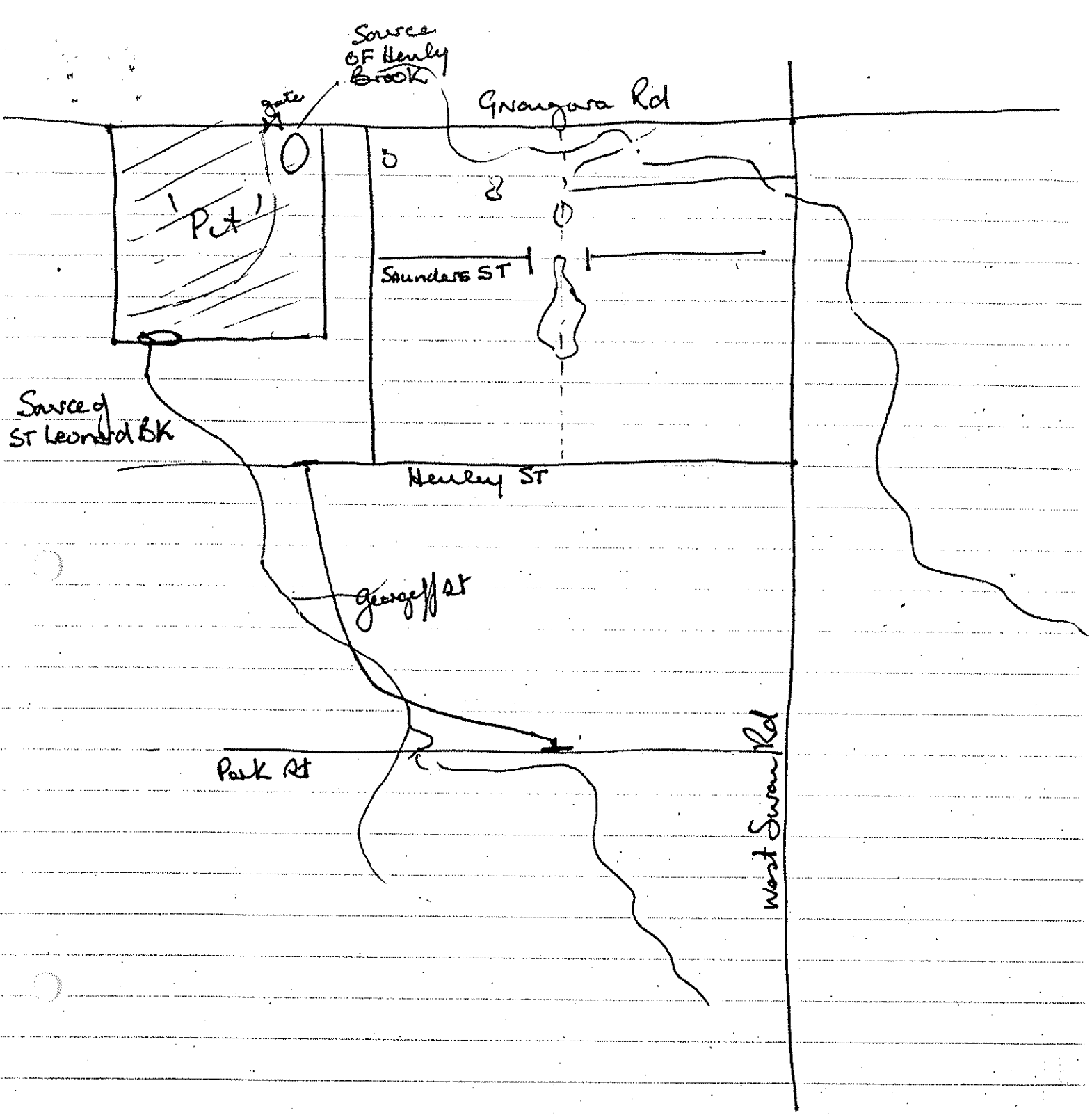

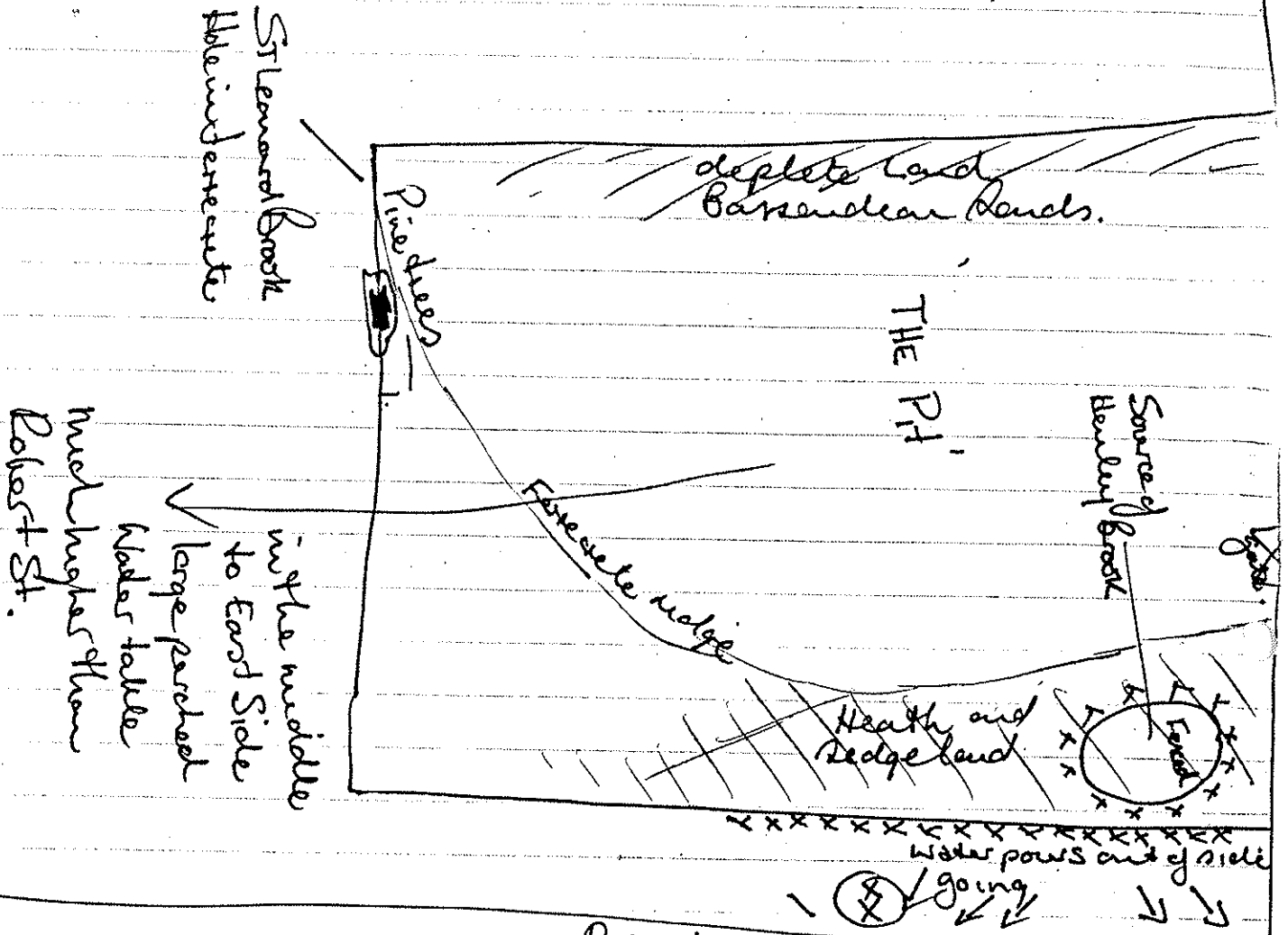

NB  
Once Water table rises in  
'Pit' comes down Robert ST  
Side causing flooding  
and creates sheeting and  
Springs.

NB (X) Full Artesian Spring  
Drink from.

(X) 2x Sanders St  
Bases are Semi Artesian

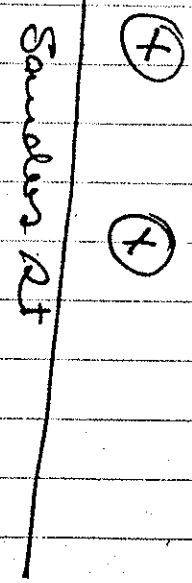

## Landscape History:

Previously formed part of the  
'Gwangara Hill Complex'  
30-40 feet above sea level.

The Area was mined for its Sand Value:

Only on the West Side:

Once the area started to be mined from  
the middle:

Kept hitting Water:

This Area consists of Two River Systems:

1 x Source of Henley Brook itself: (unsurveyed)  
at the bottom of the ferrocite ridge

1 x Source of St Leonard Brook itself (Surveyed)  
which comes out of the ferrocite  
hole in the (coffee rock) ferrocite.

and creates to the South a series of major  
Wetlands joining up with other systems.

Also the water table is 1.4 metres off the  
top of the Soil, this never changes, or hasn't for  
many years - so would be the base ground level  
of water,

The Pit is much higher than surrounding properties.

Also has 40 ponds under the surface.

Sighted at Present:

Completely cleared: flattened.  
Geraldton Wax has been replanted and other trees  
not to the Area.

Area - St Leonards Brook has a line of Pine Trees.

Area - Henley Brook -

Good Condition of Heath and Redgelands.

Quite a number of animal life and  
a family of Kites live in this Area.

If the concrete is damaged:

There will certainly be major flooding:

Major Water Source

for Wetlands, South, East and  
North East of Area.

Not only

Significant in a Regional Sense  
whole Area from Ridges of concrete.  
but very very sensitive.

If you think of this Area as being one of the  
'Plugs' of the Gwagara Mound.

'The Pit'  
Henley Brook  
South of Gungahara Road.

No 5. Why do you consider this Area important.?

No 7. Does this Area have any special features  
such as unusual landforms/landscapes.....?

I have no idea how you would equate the importance of this piece of land, in the regional sense to the degradation that you sight from previous government and non-government agencies. from the various land deals that forms part of the History of this Area of land.

Is it System 6 or more under the Guidelines.

'The Area is so significant, that the Community who abutt this Area to the east and the South of this Area in part, know that depending on the water table in this Area, how all the Wetlands, Swamps and Our own groundwater will be affected for the coming year.'

The Community East of the Pit, along the fence line ridges use these as indicators, on water intake, rain in the water etc for the year, and you see people going to check before cropping. It plays an important part of our environmental lives.

'The Pit'

could never fully be developed because of the water table.

It has perched water tables.

The water at most times, to the East, runs out of the concrete, into properties, causing flooding, onto Pallas Plains, each property and the area becoming seasonal wetlands and a sheeting effect.

Before any development:

an environmental assessment:

at either PER or Euper should be done over this area.

If the water ceases or is damaged here, there will be an environmental nightmare.

CONFIDENTIAL

Landscape History:

Previously formed part of the  
'Gwangara Hill Complex'  
30-40 feet above sea level.

The Area was mined for its Sand Value:

Only on the West Side:

Once the area started to be mined from  
the middle:

Kept hitting Water:

This Area consists of Two River Systems:

1 x Source of Henley Brook itself: (unsurveyed)  
at the bottom of the ferrocite ridge

1 x Source of ST Leonard Brook itself (Surveyed)  
which comes out of the ferrocite,  
hole in the (coffee rock) ferrocite.  
and creates to the South a series of major  
Wetlands joining up with other systems.

Also the water table is 1.4 metres off the  
top of the Soil, this never changes, or hasn't for  
many years - so would be the base ground level  
of water,

The Pit is much higher than surrounding properties.

Also has 40 ponds under the surface.

Sighted at Present:

Completely cessed: flattened.

Geraldton Wax has been replanted and other trees not to the Area.

Area - St Leonards Brook has a line of Pine Trees.

Area - Henley Brook -

Good Condition of Heath and Bedge lands.

Quite a number of animal life and a family of Kites live in this Area.

If the concrete is damaged:

There will certainly be major flooding:

Major Water Source

for Wetlands, South, East and North East of Area.

Not only

Significant in a Regional Sense whole Area from Ridges of concrete. but very very sensitive.

If you think of this Area as being one of the 'Plugs' of the Gwangara Mound.

'The Pit'  
Hewley Brook  
South of Gwangara Road.

No 5. Why do you consider this Area important.?

No 7. Does this Area have any special features  
such as unusual landforms/landscapes.....?

I have no idea how you would equate the importance of this piece of land, in the regional sense to the degradation that you sight from previous government and non-government agencies. from the various land deals that forms part of the History of this Area of land.

Is it System 6 or more under the Guidelines.

'The Area is so significant, that the Community who abutt this Area to the east and the South of this Area in part, know that depending on the Water table in this Area, how all the Wetlands, Swamps and Our own groundwater will be affected for the coming year.'

The Community East of the Pit, along the fence line ridges use these as indicators, on Water intake, iron in the water etc for the year, and you see people going to check before cropping. It plays an important part of an environmental link.

'The Pit'

could never fully be developed because of the water table.

It has perched water tables.

The water at most times, to the East, runs out of the concrete, into properties, causing flooding, onto Pallas plains, each property and the area becoming seasonal wetlands and a sheeding effect.

Before any development:

an environmental assessment:

at either PER or Euphor should be done over this area.

If the water ceases or is damaged here, there will be an environmental nightmare.

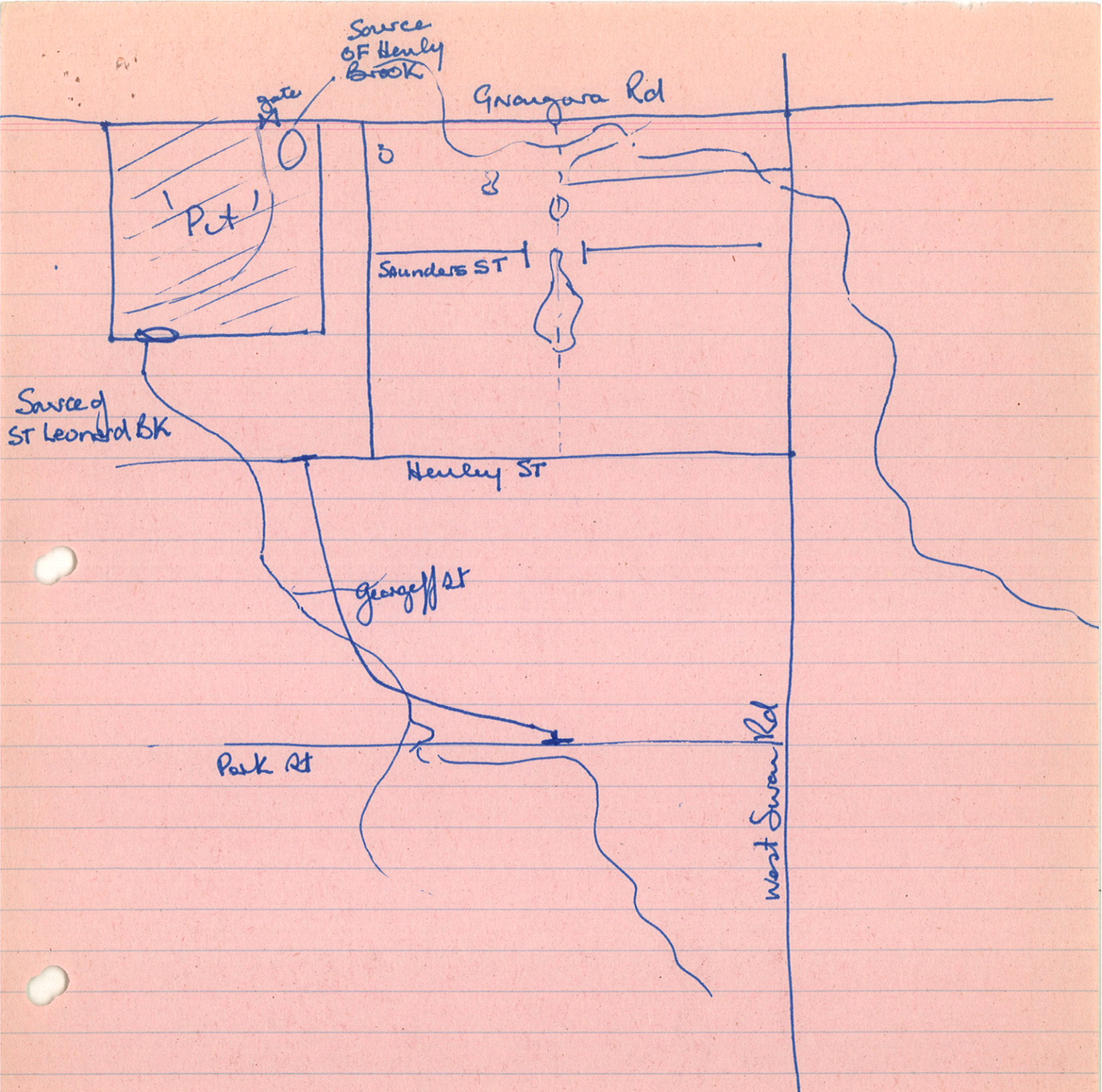

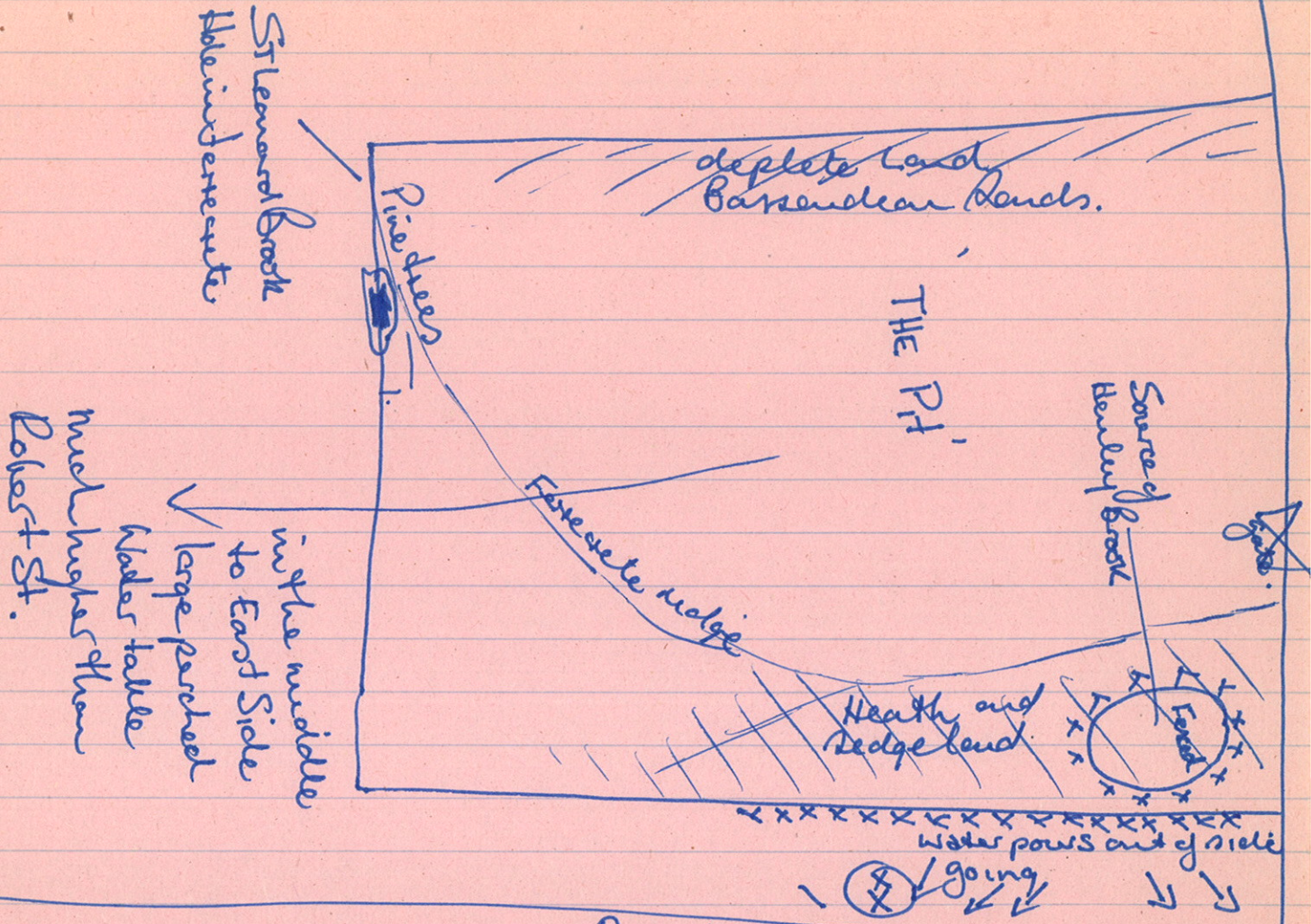

Robert St

Sanders St

NB  
Once Water table rises in  
the 'Pit' causes down Robert St  
Side causing flooding  
and creates sheeting and  
Springs.

NB (X) Full Artesian Spring  
Drink from.

(X) 2x Sanders St  
Bases are Semi Artesian

### SYSTEM 6 BUSHLAND SUBMISSION FORM FOR CONSIDERATION IN THE UPDATE PROGRAMME

If you wish to submit more than one area for consideration in the System 6 update, please use a separate form for each area.

Please fill in each section giving as much information as possible.

**LOCATION, OWNERSHIP AND ZONING OF THE AREA**

1. Location Gwangara Rd - 'Mayer Springs'  
Mr Arthur Lawsons property - West of 'Mayer Springs'

Please give as accurate and detailed a description as possible of the site location  
Please include either a hand drawn or copied map showing the area of the area

a) Bordering Roads: .....

b) Nearest Corner: West Swan Rd. .....

c) Lot Number: ..... Street Number: .....

d) ~~Town~~/Suburb/Location: Henley Brook. .....

e) Local Council: Swan Shire .....

f) Site Name (if any): 'Property next to Mayer Springs.' .....

g) Approximate size of the area (ha): .....  
?

h) Please locate the area on a map and give us map references if possible:  
.....

i) Map: ..... Streetsmart /UBD/Other: .....

j) Map no.: .....

k) Grid Ref: .....

l) Please give any other information that may help us to find the location:  
as above. (Pine trees in front of property) 78-80 years old.

m) Are you aware of any development proposals that are likely to affect the area?  
No.

**NOTE: Areas that have already been given development APPROVAL should not be nominated**

*Property was used turn of century  
'as stage coach horse exchange'*

Please fill out those questions that you can answer

2. Who owns the area? (If owned by the person/s making the nomination please indicate) .....  
Mr A LAWSON

3. If you own the area, and may be interested in participating in conservation on private land initiatives please indicate (and leave your name and address at the end of this submission form) .....

4. What is the area zoned? (please indicate whether zoning is Town Planning Scheme or Metropolitan Region Scheme) General Rural

CAN YOU TELL US A LITTLE ABOUT THE PHYSICAL CHARACTERISTICS OF THE AREA

5. Why do you consider this area important? (Refer to Guiding Issues paper)

As name suggests: MAJOR Springs except the Springs are on Mr LAWSON'S property.

6. What is/are the soil type/s and colours? .....

Type: Sand/Clay/Gravel/Loam/Silt  
Colour: White/Grey/Brown/Orange/Yellow/Red/Black Variety of Soils

7. Does the area have any special features such as unusual landforms / landscapes that still retain their natural vegetation? Yes/No

If yes, what are they? Springs and Water drainage Areas

8. Is the area a wetland or does it include a wetland? .....

If yes, what kind of a wetlands is it?

- a) lakes small series of: natural:
- b) river
- c) stream
- d) swamp
- e) estuary
- f) seasonally wet
- g) other

Mr Lawson has beautified Area: however, using the natural drainage system.

- m) Grazing: stock, overgrazing by feral or native mammals
- n) Proliferation of tracks, fire breaks and walk trails
- o) Off-road vehicle use
- p) Use as service corridors by the SEC, Main Roads, Water Authority.

(Source: B Keighery. Bushland Plant Survey, September 1994)

15. Does the area contain any plant species of special interest that you know of? (eg. declared rare flora, priority taxa, outlier populations) .....

Do you know what they are? .....  
 ?  
 .....

16. Do you know of any native animals that use the area? Birds. .....

Haven't been to property for many years.  
 Can you list those you know of? (birds, mammals, reptiles, amphibians etc)  
 .....

17. Is the area used by any native animals of special interest? (eg. endangered species, large/important populations).....

If yes, please name them and indicate source of information  
 .....  
 .....

**CAN YOU TELL US A LITTLE ABOUT THE SURROUNDING AREA**

18. Are there any bushland areas (including wetlands) near to this area?  
 ..... Yes. .....

If yes, how close are they? 1/4 to 1/2 mile .....

Wetlands all around. .....

Are they already conservation reserves? No. .....

What is their approximate size? .....

19. Does the submitted area link other bushland areas? .....

Yes. .....

Please attach any additional information about the area which may be of use when assessing it.

- m) Grazing: stock, overgrazing by feral or native mammals
- n) Proliferation of tracks, fire breaks and walk trails
- o) Off-road vehicle use
- p) Use as service corridors by the SEC, Main Roads, Water Authority.

(Source: B Keighery. Bushland Plant Survey, September 1994)

15. Does the area contain any plant species of special interest that you know of? (eg. declared rare flora, priority taxa, outlier populations) .....

Do you know what they are? .....  
 ?

16. Do you know of any native animals that use the area? *Birds.* .....

*Haven't been to property for many years.*  
 Can you list those you know of? (birds, mammals, reptiles, amphibians etc)

17. Is the area used by any native animals of special interest? (eg. endangered species, large/important populations).....

If yes, please name them and indicate source of information  
 .....  
 .....

CAN YOU TELL US A LITTLE ABOUT THE SURROUNDING AREA

18. Are there any bushland areas (including wetlands) near to this area?

*Yes.* .....

If yes, how close are they? *1/4 to 1/2 mile* .....

*Wetlands all around.*

Are they already conservation reserves? *No.* .....

What is their approximate size? .....

19. Does the submitted area link other bushland areas? .....

*Yes.* .....

Please attach any additional information about the area which may be of use when assessing it.

# Gwangosa Rd

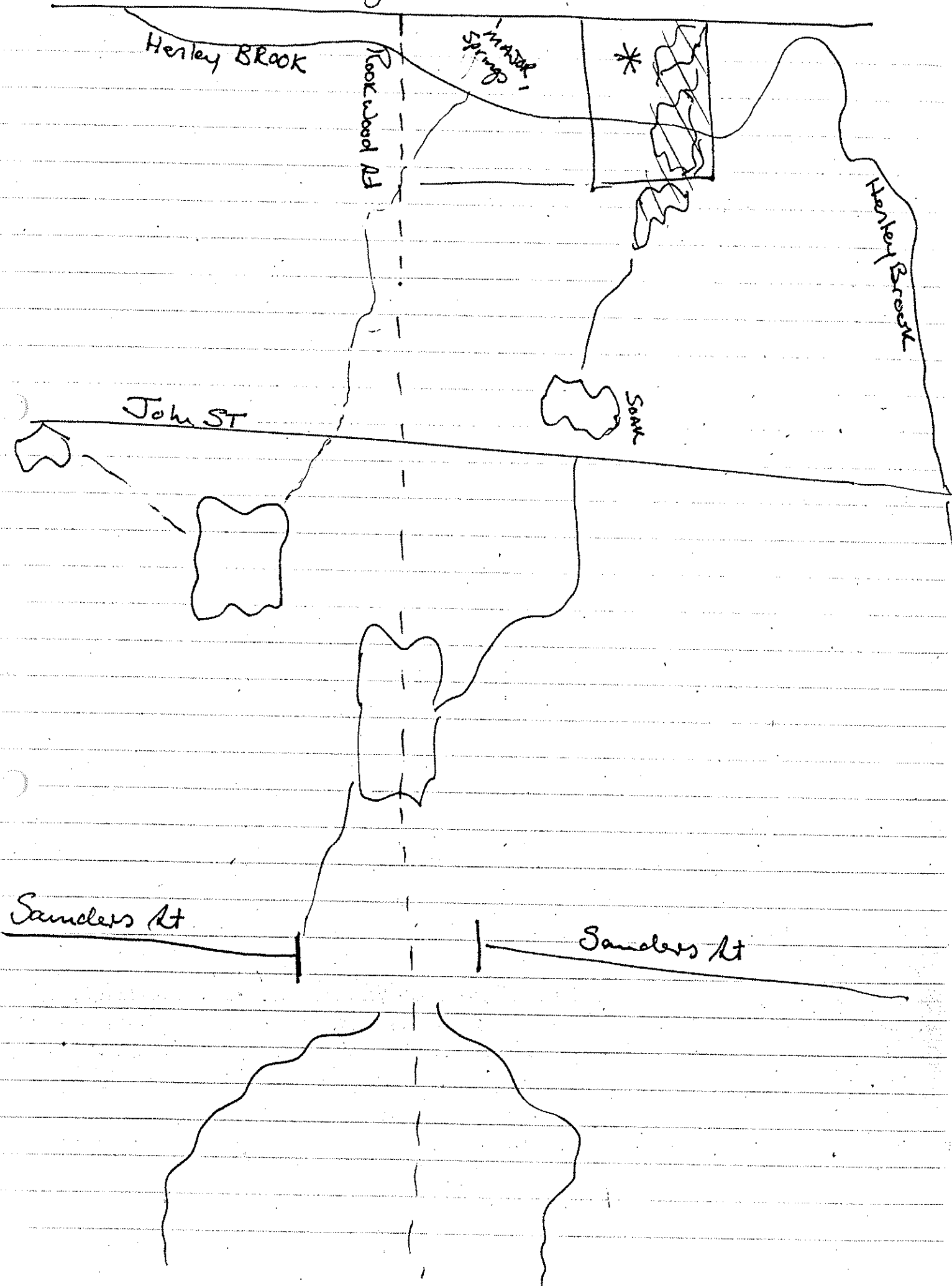

## SYSTEM 6 BUSHLAND SUBMISSION FORM FOR CONSIDERATION IN THE UPDATE PROGRAMME

If you wish to submit more than one area for consideration in the System 6 update, please use a separate form for each area.

Please fill in each section giving as much information as possible.

<b>LOCATION, OWNERSHIP AND ZONING OF THE AREA</b>
---

1. Location Saunders St Henley Brook  
(west end)

Please give as accurate and detailed a description as possible of the site location  
Please include either a hand drawn or copied map showing the area of the area

a) Bordering Roads: Robert St

b) Nearest Corner: Robert St (west) Saunders St/Rookwood

c) Lot Number: 53? Street Number: .....  
(next to SHURTS property)

d) Town/Suburb/Location: Henley Brook

e) Local Council: Shire Shire

f) Site Name (if any): Locally known as \$400 paddock

g) Approximate size of the area (ha): 6 1/2 acres

h) Please locate the area on a map and give us map references if possible:

i) Map: ..... Streetsmart /UBD/Other: .....

j) Map no.: .....

k) Grid Ref: .....

l) Please give any other information that may help us to find the location:

West of Lot 55 (next to)

m) Are you aware of any development proposals that are likely to affect the area?

No: Block is unbuildable: floodplain:  
natural drainage area

<b>NOTE: Areas that have already been given development APPROVAL should not be nominated</b>
--

Please fill out those questions that you can answer

2. Who owns the area? (If owned by the person/s making the nomination please indicate) ...MRS Gordon.....

3. If you own the area, and may be interested in participating in conservation on private land initiatives please indicate (and leave your name and address at the end of this submission form) .....

4. What is the area zoned? (please indicate whether zoning is Town Planning Scheme or Metropolitan Region Scheme) ...TPS general Rural.....

CAN YOU TELL US A LITTLE ABOUT THE PHYSICAL CHARACTERISTICS OF THE AREA

5. Why do you consider this area important? (Refer to Guiding Issues paper) natural drainage area from other areas: wet all year - Once becomes full, drains further into Henley Brook itself.

6. What is/are the soil type/s and colours? ..... Type: Sand/Clay/Gravel/Loam/Silt Colour: White/Grey/Brown/Orange/Yellow/Red/Black

7. Does the area have any special features such as unusual landforms / landscapes that still retain their natural vegetation? Yes/No

If yes, what are they? Melaleucas all round wetland: with heavy dense vegetation -

8. Is the area a wetland or does it include a wetland? yes

If yes, what kind of a wetlands is it?

- a) lake
b) river
c) stream
d) swamp
e) estuary
f) seasonally wet
g) other
Wetland Basin

9. What percentage of the wetland is open water in summer? 100%  
*even though slightly less than in winter.*

CAN YOU TELL US A LITTLE ABOUT THE VEGETATION /FAUNA ON THE NOMINATED AREA.

10. What percentage of the area is indigenous vegetation? ?

11. If the area includes regions cleared of native bushland please indicate reasons for the inclusion.

*Drainage Area: Breeding & Feeding Area for Birds.*

12. Has any previous flora or fauna survey work been done on the area?

*No.*

If yes, please give details of the work

13. How would you rate the condition of the native bushland? (see attached table)

a) pristine

b) excellent

c) very good

d) good

e) degraded

f) completely degraded

g) don't know

*} Area of Wetland*

*- other part of property overgrazed.*

14. Please indicate the disturbances affecting the area and where appropriate the percentage of the area disturbed.

a) Partial clearing

b) fragmentation

c) Selective removal of species: timber cutting, wildflower picking, mowing dieback and other plant diseases

d) Fire regime, including intensity, season and frequency

e) 'Enrichment plantings' that is plantings of species not found in that community

f) Weed invasion

g) Animal impact: horses, foxes, rabbits, cats, dogs, camels, goats etc

cattle

h) Soil movement, both removal and dumping

i) Changes in water regimes; flooding, drainage and watering

j) Salinity

k) Fertiliser drift and along waterways nutrient influx

*maybe from Sandlers st  
Drain easement.*

l) Mining, including that for road works

- m) Grazing: stock, overgrazing by feral or native mammals
- n) Proliferation of tracks, fire breaks and walk trails
- o) Off-road vehicle use
- p) Use as service corridors by the SEC, Main Roads, Water Authority.

(Source: B Keighery. Bushland Plant Survey, September 1994)

15. Does the area contain any plant species of special interest that you know of? (eg. declared rare flora, priority taxa, outlier populations) .....

Do you know what they are? .....

16. Do you know of any native animals that use the area? *yes* .....

*Variety of cranes, Herons, many many Ducks*

Can you list those you know of? (birds, mammals, reptiles, amphibians etc)

*Snakes, Bandicoots, frog etc.*

17. Is the area used by any native animals of special interest? (eg. endangered species, large/important populations).....

*Bird Life (Abundance of breeding of all types)*

If yes, please name them and indicate source of information

**CAN YOU TELL US A LITTLE ABOUT THE SURROUNDING AREA**

18. Are there any bushland areas (including wetlands) near to this area?

*yes* .....

If yes, how close are they? .....

*500 yards - 1/2 mile.*

Are they already conservation reserves? *No.* .....

What is their approximate size? *?* .....

19. Does the submitted area link other bushland areas? .....

*yes.* .....

Please attach any additional information about the area which may be of use when assessing it.

Sanders St.

Rockwood St

Melaleucas circle wetland

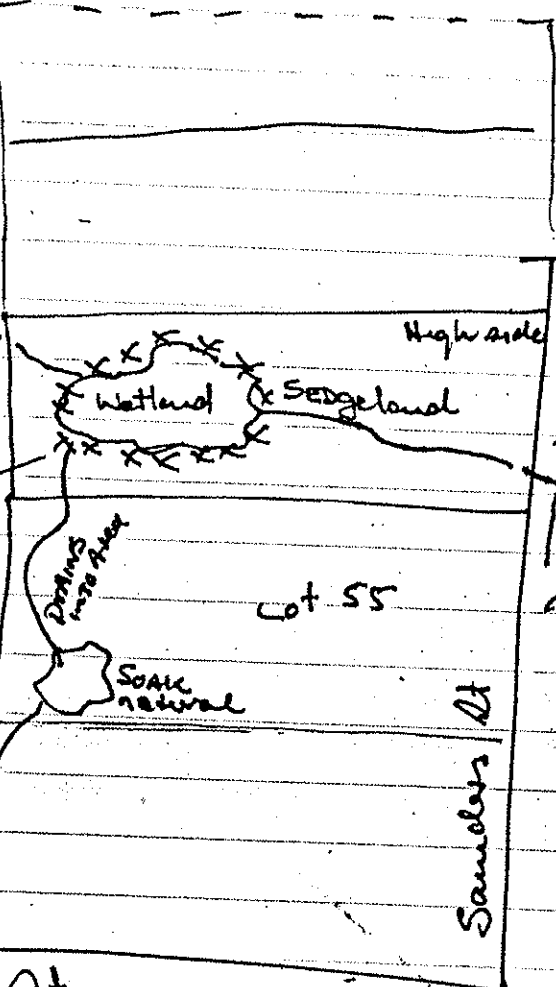

High side

Wetland

Sedgeland

Drooping tree area

Soak natural

Lot 55

natural water buildup

Sedgeland Swamp.

Sanders St

Robert St

Some

Water all year and seasonal flooding of property: abundance of breeding in Sedgeland and around Wetland.

CONFIDENTIAL

137j

John ST

504K

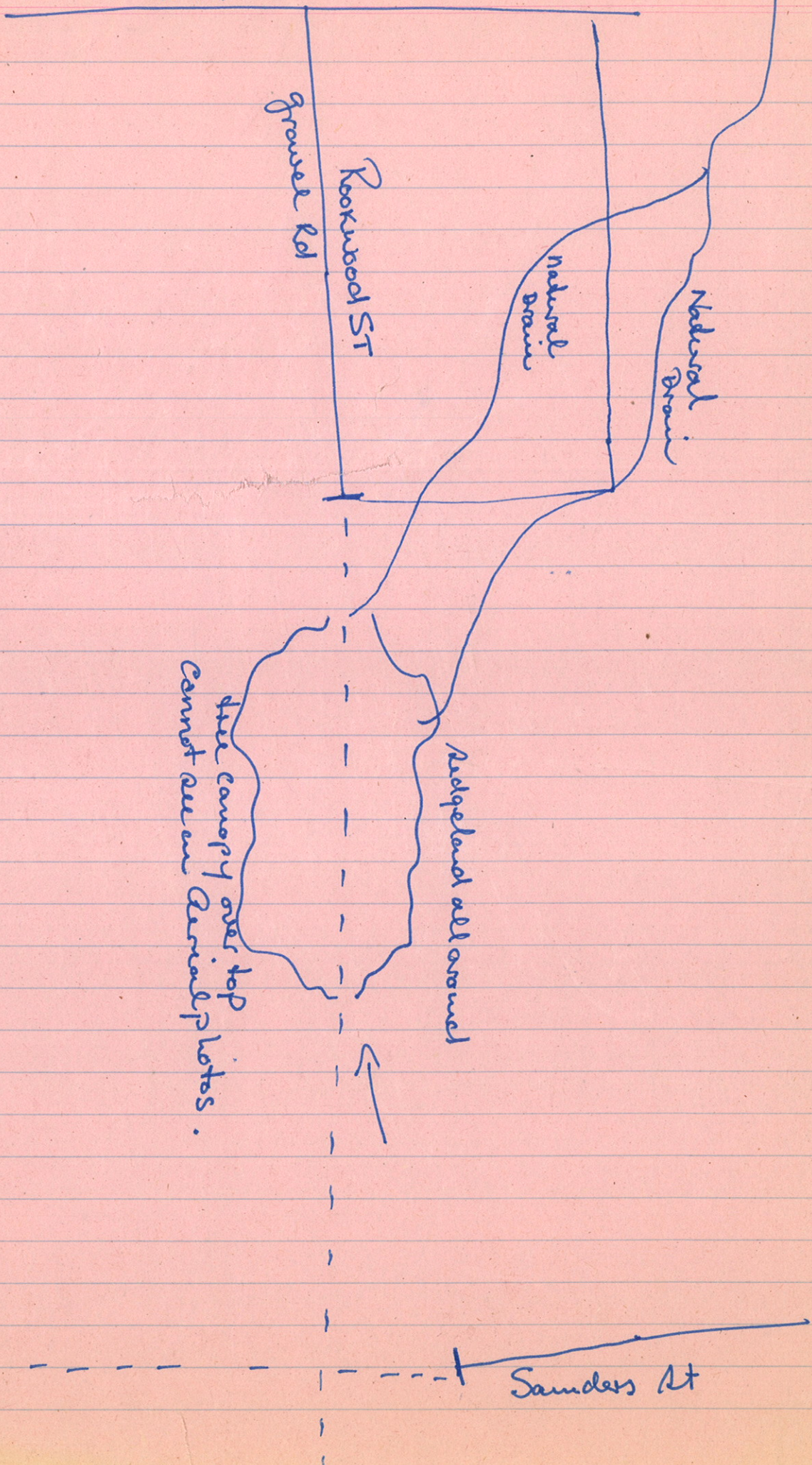

J.

**SYSTEM 6 BUSHLAND SUBMISSION FORM  
FOR CONSIDERATION IN THE UPDATE PROGRAMME**

If you wish to submit more than one area for consideration in the System 6 update, please use a separate form for each area.

Please fill in each section giving as much information as possible.

**LOCATION, OWNERSHIP AND ZONING OF THE AREA**

1. Location Rookwood St Henley Brook

Please give as accurate and detailed a description as possible of the site location

Please include either a hand drawn or copied map showing the area of the area

a) Bordering Roads: on Rookwood St Track (John St)

b) Nearest Corner: between gravel pit to houses + Sanders St

c) Lot Number: ..... Street Number: .....

d) ~~Town/Suburb~~/Location: on Track

e) Local Council: Swan Shire

f) Site Name (if any): (Locally known as the Snake Track - Horse Track)

g) Approximate size of the area (ha): ?

h) Please locate the area on a map and give us map references if possible:

i) Map: ..... Streetsmart /UBD/Other: .....

j) Map no.: .....

k) Grid Ref: .....

l) Please give any other information that may help us to find the location:

on Track between John St

m) Are you aware of any development proposals that are likely to affect the area?

No.

**NOTE: Areas that have already been given development APPROVAL should not be nominated**

Please fill out those questions that you can answer

2. Who owns the area? (If owned by the person/s making the nomination please indicate) .....

Road - never used (Sand track)

3. If you own the area, and may be interested in participating in conservation on private land initiatives please indicate (and leave your name and address at the end of this submission form) .....

4. What is the area zoned? (please indicate whether zoning is Town Planning Scheme or Metropolitan Region Scheme) ...TPS,.....

CAN YOU TELL US A LITTLE ABOUT THE PHYSICAL CHARACTERISTICS OF THE AREA

5. Why do you consider this area important? (Refer to Guiding Issues paper)

Basin of Water: heavy heathland over area: natural drainage into further water courses and other properties

6. What is/are the soil type/s and colours? .....

Type: Sand/Clay/Gravel/Loam/Silt

Colour: White/Grey/Brown/Orange/Yellow/Red/Black

7. Does the area have any special features such as unusual landforms / landscapes that still retain their natural vegetation? Yes/No

If yes, what are they? Heavy Sedge lands:

often see large Snakes in this Area:

8. Is the area a wetland or does it include a wetland? .....

If yes, what kind of a wetlands is it?

a) lake

b) river

c) stream

d) swamp

e) estuary

f) seasonally wet

10 months of year

g) other

natural Basin

9. What percentage of the wetland is open water in summer? ..... 30% .....

CAN YOU TELL US A LITTLE ABOUT THE VEGETATION /FAUNA ON THE NOMINATED AREA.

10. What percentage of the area is indigenous vegetation? ..... all .....

11. If the area includes regions cleared of native bushland please indicate reasons for the inclusion. ....

Area cleared: is <sup>Reserve for</sup> road - never used: Track used by Horses. ....

12. Has any previous flora or fauna survey work been done on the area?

..... No .

If yes, please give details of the work .....

13. How would you rate the condition of the native bushland? (see attached table)

- a) pristine
- b) excellent
- c) very good
- d) good
- e) degraded
- f) completely degraded
- g) don't know

14. Please indicate the disturbances affecting the area and where appropriate the percentage of the area disturbed.

- a) Partial clearing
- b) fragmentation
- c) Selective removal of species: timber cutting, wildflower picking, mowing dieback and other plant diseases
- d) Fire regime, including intensity, season and frequency
- e) 'Enrichment plantings' that is plantings of species not found in that community
- f) Weed invasion little .
- g) Animal impact: horses, foxes, rabbits, cats, dogs, camels, goats etc
- h) Soil movement, both removal and dumping
- i) Changes in water regimes; flooding, drainage and watering
- j) Salinity
- k) Fertiliser drift and along waterways nutrient influx ?
- l) Mining, including that for road works

- m) Grazing: stock, overgrazing by feral or native mammals
  - n) Proliferation of tracks, fire breaks and walk trails
  - o) Off-road vehicle use *Can't get through.*
  - p) Use as service corridors by the SEC, Main Roads, Water Authority.
- (Source: B Keighery. Bushland Plant Survey, September 1994)

15. Does the area contain any plant species of special interest that you know of?  
(eg. declared rare flora, priority taxa, outlier populations) .....

Do you know what they are? .....

16. Do you know of any native animals that use the area? *Very large Snakes, Ducks, frogs.*  
*on a Snake Track*

Can you list those you know of? (birds, mammals, reptiles, amphibians etc)

17. Is the area used by any native animals of special interest? (eg. endangered species, large/important populations).....

If yes, please name them and indicate source of information

**CAN YOU TELL US A LITTLE ABOUT THE SURROUNDING AREA**

18. Are there any bushland areas (including wetlands) near to this area?

*Yes* .....

If yes, how close are they? *all around. 1/4 mile.*

Are they already conservation reserves? *No.*

What is their approximate size? *?*

19. Does the submitted area link other bushland areas? .....

*Yes.*

Please attach any additional information about the area which may be of use when assessing it.

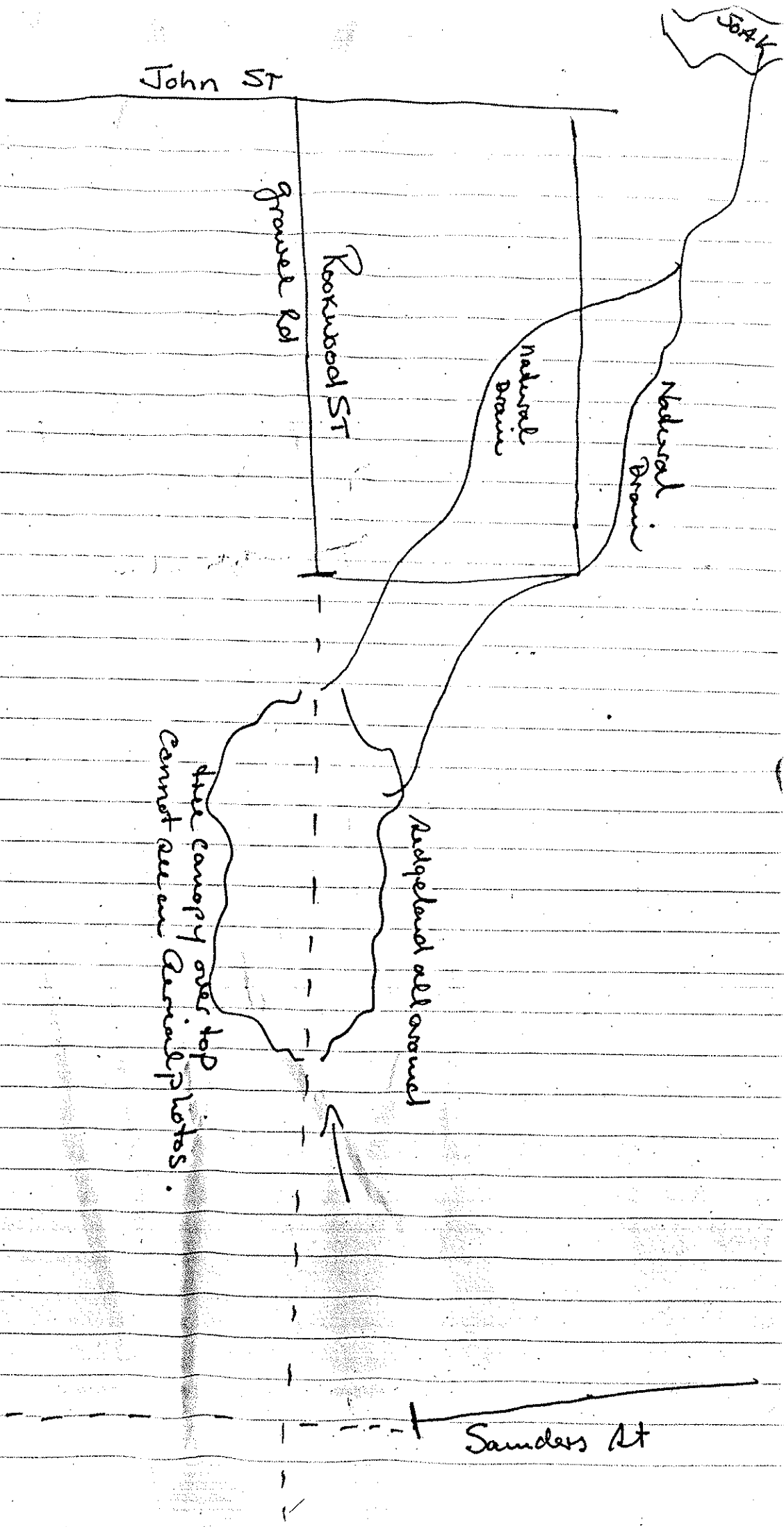

John St

Grover Rd

Rockwood St

Natural Drain

Natural Drain

5044

Wetland all around

These canopy over top cannot see our aerial photos.

Sanders St

Sanders St

CONFIDENTIAL

John St.

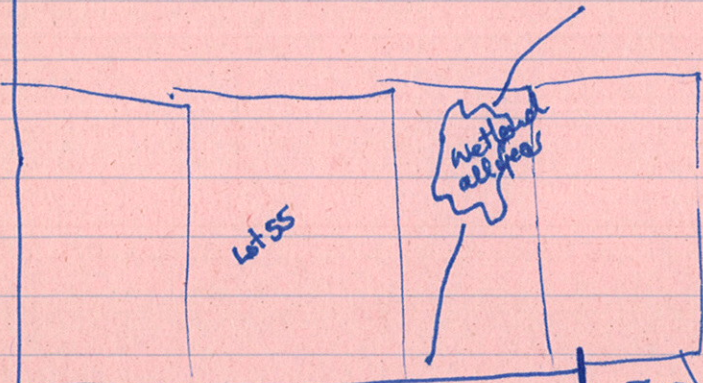
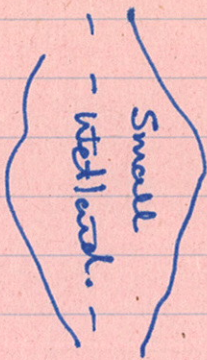

Sanders St

Sanders St

Abandoned  
cellular tower

Robert St

Tree farm

Brushland  
Vacant Block

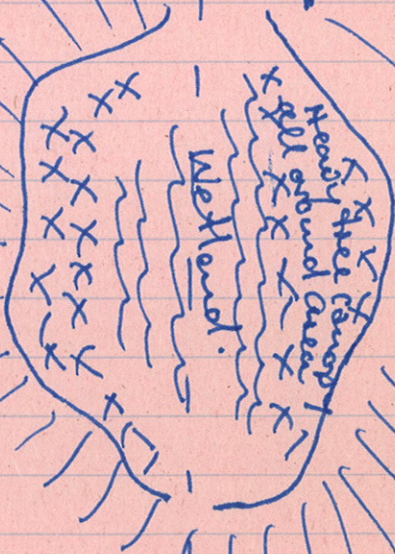

Wetland

Henley St

previously  
removed

note: large tree  
canopy:  
cannot see water  
on aerial  
photos.

# SYSTEM 6 BUSHLAND SUBMISSION FORM FOR CONSIDERATION IN THE UPDATE PROGRAMME

If you wish to submit more than one area for consideration in the System 6 update, please use a separate form for each area.

Please fill in each section giving as much information as possible.

**LOCATION, OWNERSHIP AND ZONING OF THE AREA**

1. Location Rookwood Street Henley Brook

Please give as accurate and detailed a description as possible of the site location

Please include either a hand drawn or copied map showing the area of the area

a) Bordering Roads: Saunders ST (West) and (middle of)

b) Nearest Corner: Saunders ST and Henley St.

c) Lot Number: 65? Street Number: .....

d) Town/Suburb/Location: Henley Brook

e) Local Council: Swan Shire

f) Site Name (if any): Known locally as (Rookwood Street Track)

g) Approximate size of the area (ha): ..... ? (possibly 10 acres)?

h) Please locate the area on a map and give us map references if possible:

.....

i) Map: ..... Streetsmart /UBD/Other: .....

j) Map no.: .....

k) Grid Ref: .....

l) Please give any other information that may help us to find the location:  
West Side of Aboriginal Area and East Side of Mr Hamiltans property

m) Are you aware of any development proposals that are likely to affect the area?

No.

.....

**NOTE: Areas that have already been given development APPROVAL should not be nominated**

Please fill out those questions that you can answer

2. Who owns the area? (If owned by the person/s making the nomination please indicate) ABORIGINAL TRUST?

Mr Hamilton

3. If you own the area, and may be interested in participating in conservation on private land initiatives please indicate (and leave your name and address at the end of this submission form) .....

4. What is the area zoned? (please indicate whether zoning is Town Planning Scheme or Metropolitan Region Scheme) General Rural TPS

CAN YOU TELL US A LITTLE ABOUT THE PHYSICAL CHARACTERISTICS OF THE AREA

5. Why do you consider this area important? (Refer to Guiding Issues paper)

Variety of Bushland: unimproved: Heathland: Wetland Area

Breeding Area for mammals + Birds.

6. What is/are the soil type/s and colours? Forming a Peat Bed

Type: Sand/Clay/Gravel/Loam/Silt

Colour: White/Grey/Brown/Orange/Yellow/Red/Black

7. Does the area have any special features such as unusual landforms / landscapes that still retain their natural vegetation? Yes/No

If yes, what are they? Peat land (huge amounts Vegetation) around a Wetland (all year around) covered by tree canopy

\*Aerial Photos don't pick up Area because of tree canopy.

8. Is the area a wetland or does it include a wetland? Yes

If yes, what kind of a wetlands is it?

a) lake

b) river

c) stream

d) swamp - ? doesn't have many sedges.

e) estuary

f) seasonally wet all year round.

g) other

9. What percentage of the wetland is open water in summer? *all 100%.*

CAN YOU TELL US A LITTLE ABOUT THE VEGETATION /FAUNA ON THE NOMINATED AREA.

10. What percentage of the area is indigenous vegetation? *100%.*

11. If the area includes regions cleared of native bushland please indicate reasons for the inclusion. ....

*Heathland*

12. Has any previous flora or fauna survey work been done on the area?

*currently? WAS nominated as an Area to be Studied by National Landcare Group: Newby Bk Locality Group -*

If yes, please give details of the work .....

*Previously Naturalist 'Bob Halsie' walked through Area and his view*

*was that it was the Best Heathland he'd seen in the Metropolitan Area*

*(PARTS better than Port Kennedy where he found many endangered species)*

13. How would you rate the condition of the native bushland? (see attached table)

*Snakes etc.*

a) pristine

b) excellent

c) very good

d) good

e) degraded

f) completely degraded

g) don't know

14. Please indicate the disturbances affecting the area and where appropriate the percentage of the area disturbed.

a) Partial clearing

b) fragmentation

c) Selective removal of species: timber cutting, wildflower picking, mowing dieback and other plant diseases

d) Fire regime, including intensity, season and frequency

e) 'Enrichment plantings' that is plantings of species not found in that community

f) Weed invasion

g) Animal impact: horses, foxes, rabbits, cats, dogs, camels, goats etc

h) Soil movement, both removal and dumping

i) Changes in water regimes; flooding, drainage and watering

j) Salinity

k) Fertiliser drift and along waterways nutrient influx

l) Mining, including that for road works

- m) Grazing: stock, overgrazing by feral or native mammals
  - n) Proliferation of tracks, fire breaks and walk trails
  - o) Off-road vehicle use
  - p) Use as service corridors by the SEC, Main Roads, Water Authority.
- (Source: B Keighery. Bushland Plant Survey, September 1994)

15. Does the area contain any plant species of special interest that you know of? (eg. declared rare flora, priority taxa, outlier populations) .....

Do you know what they are? Heathland and orchards.

16. Do you know of any native animals that use the area? Yes.

Sith's Brown Bandicoots, Breeding area for many Birds and each year a type of for Little Birds (1000 in population) come back to breed: Black Cockatoos, 25s, pink greys, pigeons, heaps of many varieties: Frogs, Snakes (2 large termite nests)

17. Is the area used by any native animals of special interest? (eg. endangered species, large/important populations).....?

If yes, please name them and indicate source of information

Previously upto 4 years ago - large group of Wallabies in this Area.

**CAN YOU TELL US A LITTLE ABOUT THE SURROUNDING AREA**

18. Are there any bushland areas (including wetlands) near to this area? yes

If yes, how close are they? all around.

Are they already conservation reserves? No.

What is their approximate size? .....

19. Does the submitted area link other bushland areas? Yes.

Please attach any additional information about the area which may be of use when assessing it.

miscellaneous  
non-mapped

note: large tree  
Canopy:  
Cannot see wastes  
on aerial  
photos.

Adjacent  
Residential

Sanderson St

Wetland

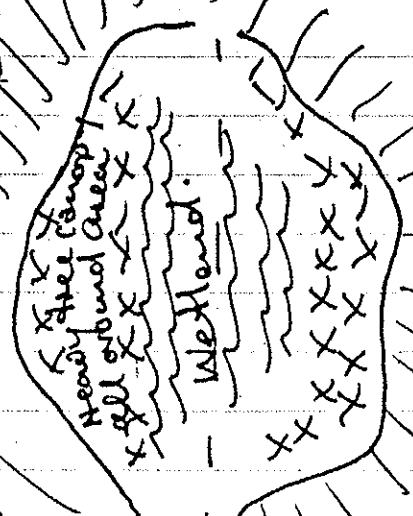

Brushland  
Vacant Block

Turf lot

Sanderson St

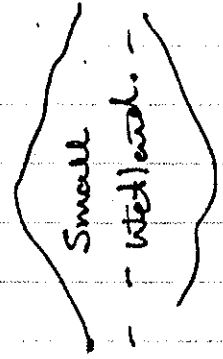

Small  
Wetland



Lot 55

Ibex St

Henley St

Robson St

SYSTEM 6 BUSHLAND SUBMISSION FORM  
FOR CONSIDERATION IN THE UPDATE PROGRAMME

If you wish to submit more than one area for consideration in the System 6 update, please use a separate form for each area.

Please fill in each section giving as much information as possible.

LOCATION, OWNERSHIP AND ZONING OF THE AREA

1. Location Henley Street  
Henley Brook

Please give as accurate and detailed a description as possible of the site location  
Please include either a hand drawn or copied map showing the area of the area

a) Bordering Roads: Henley Street

b) Nearest Corner: West Swan Rd (east) : Robert St (west)

c) Lot Number: ..... Street Number: .....

d) ~~Town~~/~~Suburb~~/Location: Henley Brook

e) Local Council: Swan Shire

f) Site Name (if any): Vacant Bush Block (East side of Mr Doyle next to Mr G. DOYLE)

g) Approximate size of the area (ha): 6

h) Please locate the area on a map and give us map references if possible:

See attached.

i) Map: ..... Streetsmart /UBD/Other: .....

j) Map no.: .....

k) Grid Ref: .....

l) Please give any other information that may help us to find the location:

Property behind is Aboriginal Community Settlement  
AT Saunders St.

m) Are you aware of any development proposals that are likely to affect the area?

No.

This Area General Rural (not part of MRS 950/53)

NOTE: Areas that have already been given development APPROVAL should not be nominated

Please fill out those questions that you can answer

2. Who owns the area? (If owned by the person/s making the nomination please indicate) .....

VACANT Block : unknown

3. If you own the area, and may be interested in participating in conservation on private land initiatives please indicate (and leave your name and address at the end of this submission form) .....

4. What is the area zoned? (please indicate whether zoning is Town Planning Scheme or Metropolitan Region Scheme) ..... General Rural TPS .....

CAN YOU TELL US A LITTLE ABOUT THE PHYSICAL CHARACTERISTICS OF THE AREA

5. Why do you consider this area important? (Refer to Guiding Issues paper)

5 rare banksias: Colonies of Wild Bees  
1 orchid: 1 tree = registered with Inse Society: Measured Annually

6. What is/are the soil type/s and colours? ... SAND .....

Type: Sand/Clay/Gravel/Loam/Silt

Colour: White/Grey/Brown/Orange/Yellow/Red/Black

7. Does the area have any special features such as unusual landforms / landscapes that still retain their natural vegetation? Yes/No

If yes, what are they? Whole Area has never been touched by any  
Development: Only firebreaks made by horses:  
LANDFORM - Flat Landscape - very vegetated.

8. Is the area a wetland or does it include a wetland? .....

If yes, what kind of a wetlands is it?

- a) lake
- b) river
- c) stream
- d) swamp
- e) estuary
- f) seasonally wet

g) other

Forms part of a Wetland Area  
bottom note.

9. What percentage of the wetland is open water in summer? .....

CAN YOU TELL US A LITTLE ABOUT THE VEGETATION /FAUNA ON THE NOMINATED AREA.

10. What percentage of the area is indigenous vegetation? ..... 95%

11. If the area includes regions cleared of native bushland please indicate reasons for the inclusion. ....

12. Has any previous flora or fauna survey work been done on the area?  
Was included to be looked at by National Landcare Group in the Area  
(Bronwyn Keiry to LOOK AT AREA) (GRANT) WITH Herley BK LOCALITY GROUP

If yes, please give details of the work .....  
Bob Halsie looked at Area: Thought Area was of Some Significance  
in overall context of Area.

13. How would you rate the condition of the native bushland? (see attached table)

- a) pristine
- b) excellent
- c) very good
- d) good
- e) degraded
- f) completely degraded
- g) don't know

14. Please indicate the disturbances affecting the area and where appropriate the percentage of the area disturbed.

- a) Partial clearing
- b) fragmentation
- c) Selective removal of species: timber cutting, wildflower picking, mowing dieback and other plant diseases
- d) Fire regime, including intensity, season and frequency
- e) 'Enrichment plantings' that is plantings of species not found in that community
- f) Weed invasion
- g) Animal impact: horses, foxes, rabbits, cats, dogs, camels, goats etc
- h) Soil movement, both removal and dumping
- i) Changes in water regimes; flooding, drainage and watering
- j) Salinity
- k) Fertiliser drift and along waterways nutrient influx
- l) Mining, including that for road works

- m) Grazing: stock, overgrazing by feral or native mammals
- n) Proliferation of tracks, fire breaks and walk trails
- o) Off-road vehicle use
- p) Use as service corridors by the SEC, Main Roads, Water Authority.

(Source: B Keighery. Bushland Plant Survey, September 1994)

15. Does the area contain any plant species of special interest that you know of? (eg. declared rare flora, priority taxa, outlier populations) .....

Do you know what they are? BANKSIAS x 5 (not seen in other Areas)  
tree (Manni?) registered by tree Society - measured annually: Orchids

16. Do you know of any native animals that use the area? .....

Can you list those you know of? (birds, mammals, reptiles, amphibians etc)  
Southern Brown Bandicoot, Snakes - tiger snake track, Frogs 2 differing colours  
geckos TPE: Bushbees? Quite a lot of Bird life.

17. Is the area used by any native animals of special interest? (eg. endangered species, large/important populations).....?

If yes, please name them and indicate source of information

I do not know.

**CAN YOU TELL US A LITTLE ABOUT THE SURROUNDING AREA**

18. Are there any bushland areas (including wetlands) near to this area?

YES.

If yes, how close are they? Whole Area full of Bushland  
Wetlands (on Paller Plains)

Are they already conservation reserves? No.

What is their approximate size? Variety.

19. Does the submitted area link other bushland areas? .....

YES

Please attach any additional information about the area which may be of use when assessing it.

Mr Doyle has fenced his property also which is fenced.  
Farms part of Roxwood St Area - prime heathland:  
which many Bandicoots feed and breed in.

West Swan Rd

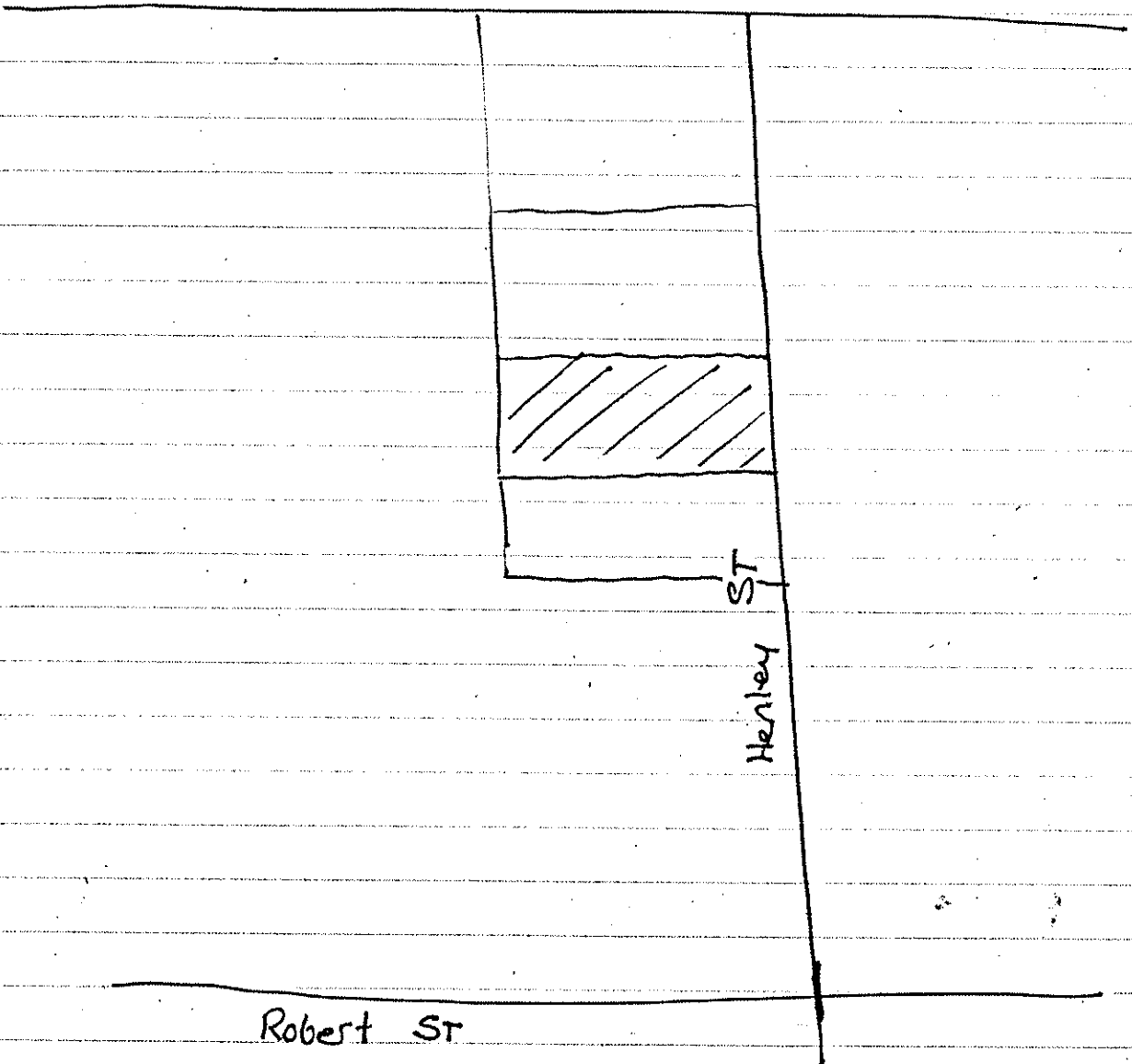

Robert St

Henley St

## Henley Brook Source

This Area is significant as the source of Henley Brook.

## 'The Pit' (Locally known as')

Goes under the road near the gate into 'Pit'

Hits into series of Wetland on Egerton Development Property,  
comes back South joining Henley Brook:

'HENLEY Brook' itself has never been surveyed:  
however as it weaves back into 'Major Springs'  
and then goes back into John St,  
under West Swan Rd to Brookman St,  
and then back behind Swan Valley Oasis  
before hitting into River (Swan)  
Vineyards etc use Henley Brook for reticulation.

If the Area at the Source destroyed:  
Significant wetlands NE and South  
would be destroyed.

x = Fenced off

Zoned Special Rural in MRS 950/33  
Significant Source

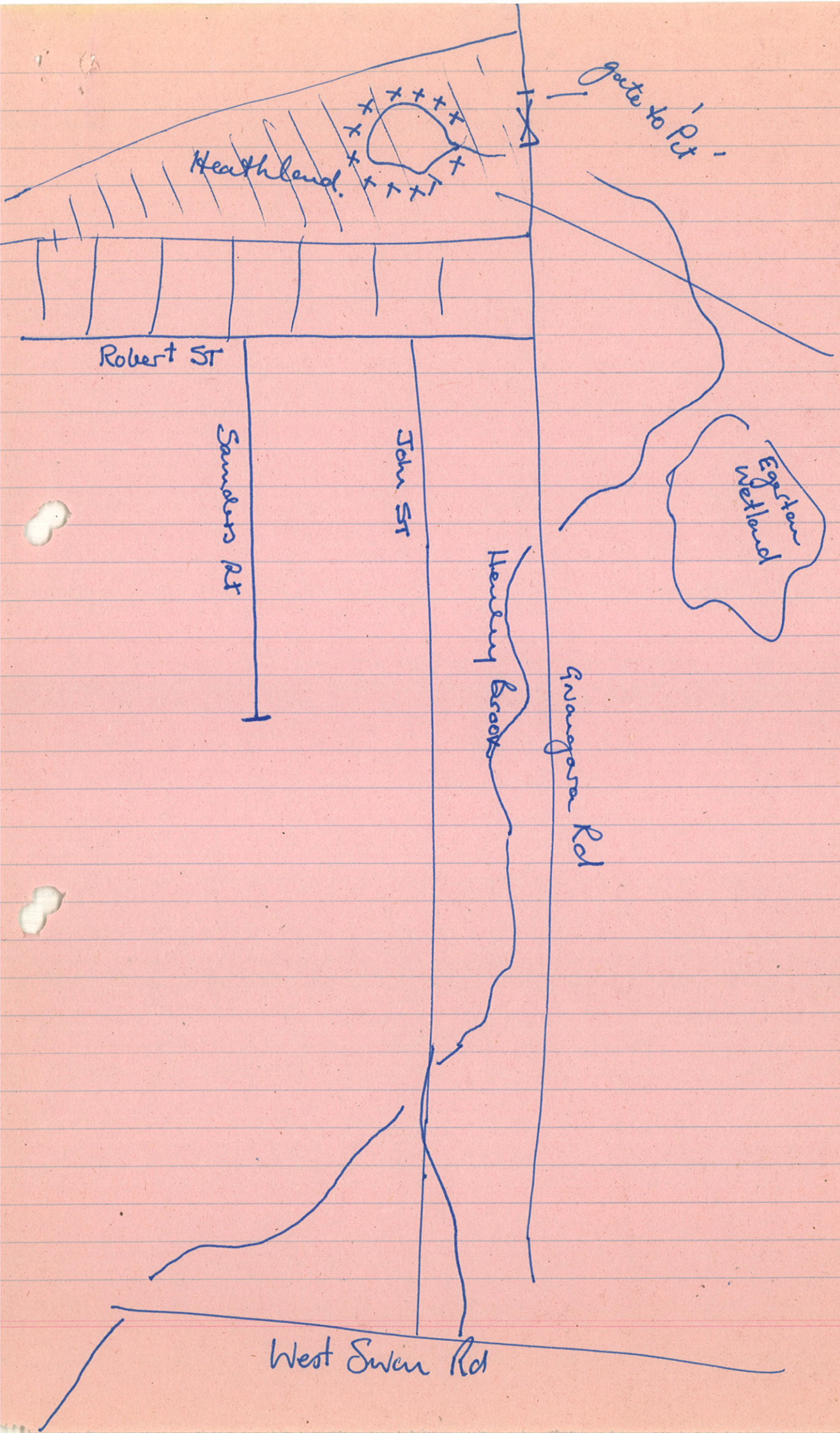

1.

**SYSTEM 6 BUSHLAND SUBMISSION FORM  
FOR CONSIDERATION IN THE UPDATE PROGRAMME**

If you wish to submit more than one area for consideration in the System 6 update, please use a separate form for each area.

Please fill in each section giving as much information as possible.

**LOCATION, OWNERSHIP AND ZONING OF THE AREA**

1. Location *The Source of Henley Brook itself*

Please give as accurate and detailed a description as possible of the site location

Please include either a hand drawn or copied map showing the area of the area

a) Bordering Roads: *Gnangara Rd*

b) Nearest Corner: *Robert Rd.*

c) Lot Number: ..... Street Number: .....

d) ~~Town~~/Suburb/Location: *Henley Brook*

e) Local Council: *Swan Shire*

f) Site Name (if any): *'The Pit'*

g) Approximate size of the area (ha): *? 2 hectares to 6 hectares.*

h) Please locate the area on a map and give us map references if possible:

i) Map: ..... Streetsmart /UBD/Other: .....

j) Map no.: .....

k) Grid Ref: .....

l) Please give any other information that may help us to find the location:

m) Are you aware of any development proposals that are likely to affect the area?

*Forms the Southern part of the  
Ellenbrook Development*

**NOTE: Areas that have already been given development APPROVAL should not be nominated**

*This portion of land  
MRS (Section made Specific Rural).  
950/33*

Please fill out those questions that you can answer

2. Who owns the area? (If owned by the person/s making the nomination please indicate) .....

Ellebrook Management.

3. If you own the area, and may be interested in participating in conservation on private land initiatives please indicate (and leave your name and address at the end of this submission form) .....

4. What is the area zoned? (please indicate whether zoning is Town Planning Scheme or Metropolitan Region Scheme) MRS 950/33 only.....  
(development stage not yet instigated).

CAN YOU TELL US A LITTLE ABOUT THE PHYSICAL CHARACTERISTICS OF THE AREA

5. Why do you consider this area important? (Refer to Guiding Issues paper)

Source of Henley Brook itself.

6. What is/are the soil type/s and colours? certain types.....

Type: Sand/Clay/Gravel/Loam/Silt

Colour: White/Grey/Brown/Orange/Yellow/Red Black

fenestis ridge

7. Does the area have any special features such as unusual landforms / landscapes that still retain their natural vegetation? Yes/~~No~~

If yes, what are they? Heathland:

Perched water table

Source of Henley Brook itself.

8. Is the area a wetland or does it include a wetland? yes.....

If yes, what kind of a wetlands is it?

a) lake

b) river

c) stream

d) swamp

e) estuary

f) seasonally wet

g) other ?

9. What percentage of the wetland is open water in summer? ..... 100% .....

CAN YOU TELL US A LITTLE ABOUT THE VEGETATION /FAUNA ON THE NOMINATED AREA.

10. What percentage of the area is indigenous vegetation? ..... R .....

11. If the area includes regions cleared of native bushland please indicate reasons for the inclusion. ....

Source of Henley Brook

12. Has any previous flora or fauna survey work been done on the area?

..... NO in a formal sense.

Yes: naturalist Bob Halsey checked site:

If yes, please give details of the work ..... thought area of regional significance: .....

13. How would you rate the condition of the native bushland? (see attached table)

- a) pristine
- b) excellent
- c) very good
- d) good
- e) degraded
- f) completely degraded
- g) don't know

14. Please indicate the disturbances affecting the area and where appropriate the percentage of the area disturbed.

- a) Partial clearing
- b) fragmentation
- c) Selective removal of species: timber cutting, wildflower picking, mowing dieback and other plant diseases
- d) Fire regime, including intensity, season and frequency
- e) 'Enrichment plantings' that is plantings of species not found in that community
- f) Weed invasion
- g) Animal impact: horses, foxes, rabbits, cats, dogs, camels, goats etc
- h) Soil movement, both removal and dumping
- i) Changes in water regimes; flooding, drainage and watering
- j) Salinity
- k) Fertiliser drift and along waterways nutrient influx
- l) Mining, including that for road works

- m) Grazing: stock, overgrazing by feral or native mammals
- n) Proliferation of tracks, fire breaks and walk trails
- o) Off-road vehicle use
- p) Use as service corridors by the SEC, Main Roads, Water Authority.

(Source: B Keighery. Bushland Plant Survey, September 1994)

15. Does the area contain any plant species of special interest that you know of?  
(eg. declared rare flora, priority taxa, outlier populations) .....

Do you know what they are? .....

16. Do you know of any native animals that use the area? Bandicoots:  
See tracks in abundance: Fowl: Herons etc: Kites, Small eagles  
Can you list those you know of? (birds, mammals, reptiles, amphibians etc)  
Ducks, Snakes. many tracks -

17. Is the area used by any native animals of special interest? (eg. endangered species, large/important populations).....

If yes, please name them and indicate source of information

**CAN YOU TELL US A LITTLE ABOUT THE SURROUNDING AREA**

18. Are there any bushland areas (including wetlands) near to this area?  
yes: .....

If yes, how close are they? all around. .....

Are they already conservation reserves? NO. .....

What is their approximate size? 2 hectares. .....

19. Does the submitted area link other bushland areas? .....

yes. .....

Please attach any additional information about the area which may be of use when assessing it.

## Henley Brook Source

This Area is significant as the source of Henley Brook.

'The Pit' (Locally known as')

Goes under the road near the gate into 'Pit'

Hits into series of Wetland on Egerton Development Property,  
comes back South joining Henley Brook:

'HENLEY Brook' itself has never been surveyed:  
however as it weaves back into 'Major Springs'  
and then goes back into John St,  
under West Swan Rd to Brookman St,  
and then back behind Swan Valley Oasis  
before hitting into River (Swan)  
Vineyards etc use Henley Brook for reticulation.

If the Area at the Source destroyed:  
Significant wetlands NE and South  
would be destroyed.

X = Fenced off

Zoned Special Rural in MRS 050133  
Significant Source

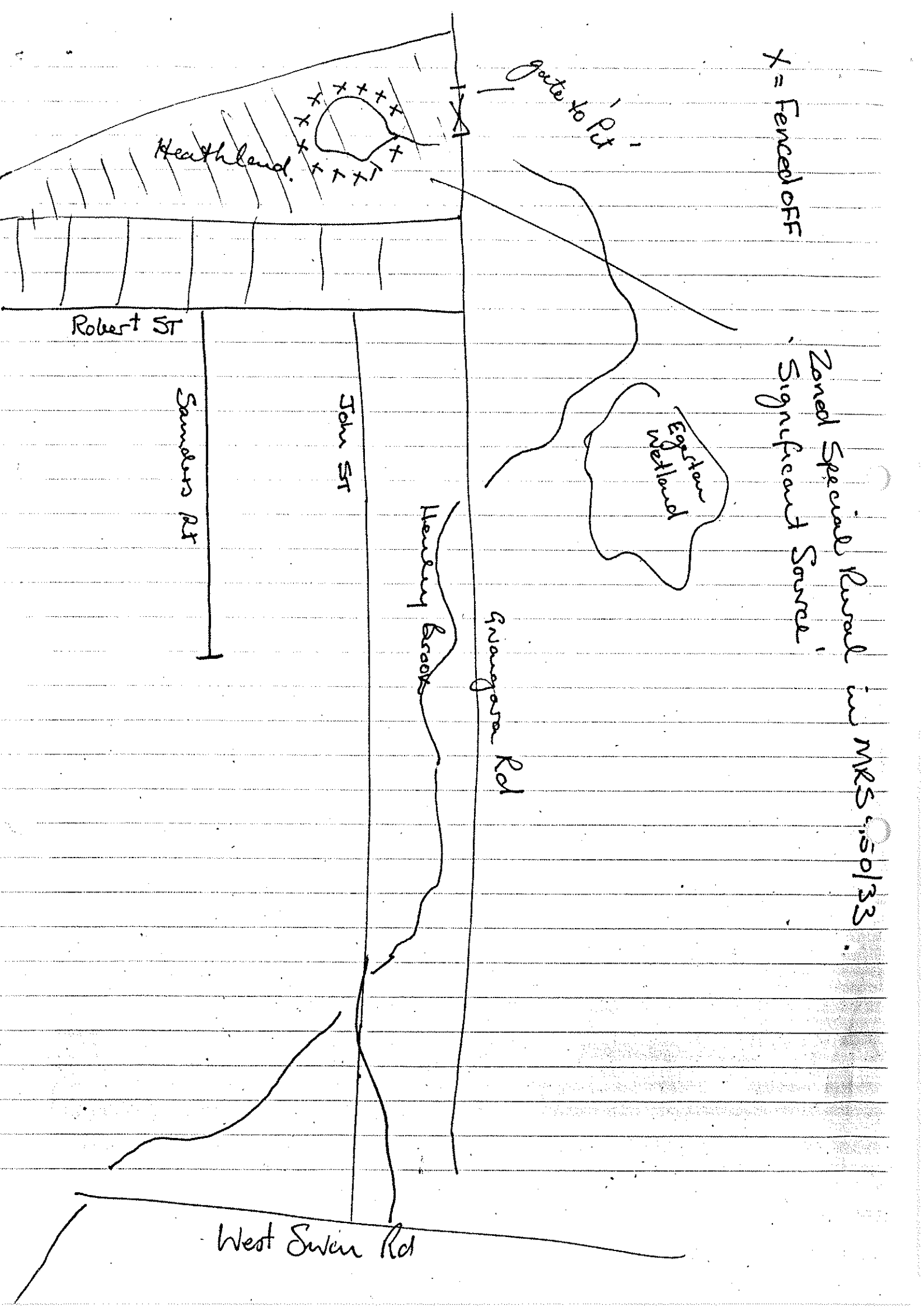

WILD 15740A6A  
Nr 13037 152.72

100089

