

SYSTEM 6 BUSHLAND SUBMISSION FORM FOR CONSIDERATION IN THE UPDATE PROGRAMME

If you wish to submit more than one area for consideration in the System 6 update, please use a separate form for each area.

Please fill in each section giving as much information as possible.

LOCATION, OWNERSHIP AND ZONING OF THE AREA

1. Location *From Lake McLarty north to Pt Grey & east to Carraburyup Nature Reserve & Austin Bay.*
Please give as accurate and detailed a description as possible of the site location

Please include either a hand drawn or copied map showing the area of the area

a) Bordering Roads: *Lake Meadup Rd. North, north-east to Carraburyup Rd*

b) Nearest Corner:

c) Lot Numbers *306 - 504*
252, Nature Reserve 2738, north portion 727,

Reserve 27528, Reserve 11718; (+ see attached map.)

d) ~~Town/Suburb~~ / Location: [*Lake McLarty Nature Reserve & north to Pt Grey.*]

e) Local Council: *Murray Shire.*

f) Site Name (if any): *East side of Harvey Estuary.*

g) Approximate size of the area (ha):

h) Please locate the area on a map and give us map references if possible:

Maps as attached.

i) Map: Streetsmart /UBD/Other:

j) Map no.:

k) Grid Ref:

l) Please give any other information that may help us to find the location:

Attached.

m) Are you aware of any development proposals that are likely to affect the area?

Yes.

NOTE: Areas that have already been given development APPROVAL should not be nominated

SYSTEM 6 BUSHLAND SUBMISSION FORM
FOR CONSIDERATION IN THE UPDATE PROGRAMME

If you wish to submit more than one area for consideration in the System 6 update, please use a separate form for each area.

Please fill in each section giving as much information as possible.

LOCATION, OWNERSHIP AND ZONING OF THE AREA

1. Location *From Lake McLarty north to Pt Grey & east to Carraburyup Nature Reserve & Austin Bay.*
Please give as accurate and detailed a description as possible of the site location

Please include either a hand drawn or copied map showing the area of the area

a) Bordering Roads: *Lake McLarty Rd. North, north-east to Carraburyup Rd*

b) Nearest Corner:

c) Lot Numbers *306 - 504*
252, Nature Reserve 2738, north portion 727, Reserve 27528, Reserve 11718; (& see attached map.)

d) ~~Town/Suburb~~ / Location: [*Lake McLarty Nature Reserve & north to Pt Grey.*]

e) Local Council: *Murray Shire.*

f) Site Name (if any): *East side of Harvey Estuary.*

g) Approximate size of the area (ha):

h) Please locate the area on a map and give us map references if possible:

Maps as attached.

i) Map: Streetsmart / UBD / Other:

j) Map no.:

k) Grid Ref:

l) Please give any other information that may help us to find the location:

Attached.

m) Are you aware of any development proposals that are likely to affect the area?

Yes.

NOTE: Areas that have already been given development APPROVAL should not be nominated

9. What percentage of the wetland is open water in summer?

CAN YOU TELL US A LITTLE ABOUT THE VEGETATION /FAUNA ON THE NOMINATED AREA.

10. What percentage of the area is indigenous vegetation? A. *Approx. 90 % of areas nominated.*

11. If the area includes regions cleared of native bushland please indicate reasons for the inclusion.

12. Has any previous flora or fauna survey work been done on the area? *yes.*
(*Scopewest, RAOU survey, Carraburup (Nature Reserve, 2707.)*)
(*" Swan coastal Plain Wetlands Study*)
If yes, please give details of the work "*Wetlands of the Swan Coastal Plain*" (Vol 7) WAWA, Storey - Vervest - Pearson - Holse
Waterbird Usage of Wetlands on the Swan Coastal Plain. (Reserve 7502)

13. How would you rate the condition of the native bushland? (see attached table)

- a) pristine
- b) excellent ✓
- c) very good
- d) good
- e) degraded
- f) completely degraded
- g) don't know

*12 Cont. Refer also:-
"A directory of Important Wetlands in Australia"
(WA) No 30. Lake McLarty System.
Australian Nature Conservation Agency.*

14. Please indicate the disturbances affecting the area and where appropriate the percentage of the area disturbed.

- a) Partial clearing
- b) fragmentation
- c) Selective removal of species: timber cutting, wildflower picking, mowing dieback and other plant diseases
- d) Fire regime, including intensity, season and frequency
- e) 'Enrichment plantings' that is plantings of species not found in that community
- f) Weed invasion *Very minimal.*
- g) Animal impact: horses, foxes, rabbits, cats, dogs, camels, goats etc
- h) Soil movement, both removal and dumping
- i) Changes in water regimes; flooding, drainage and watering
- j) Salinity
- k) Fertiliser drift and along waterways nutrient influx
- l) Mining, including that for road works

*Meallup Plain
Drain runs east-west through lot 252. }*

- m) Grazing: stock, overgrazing by feral or native mammals
 - n) Proliferation of tracks, ~~fire breaks and walk trails~~ *A track runs east - west through Lot 252.*
 - o) Off-road vehicle use
 - p) Use as service corridors by the SEC, Main Roads, Water Authority. *Drain, Lot 252.* }
- (Source: B Keighery. Bushland Plant Survey, September 1994)

15. Does the area contain any plant species of special interest that you know of? (eg. declared rare flora, priority taxa, outlier populations)

Do you know what they are?

16. Do you know of any native animals that use the area? *Yes*.....

Can you list those you know of? (birds, mammals, reptiles, amphibians etc)
Western Grey Kangaroo, Western Brush Wallaby, Brushtail Possum, Emu etc.

17. Is the area used by any native animals of special interest? (eg. endangered species, large/important populations).....

If yes, please name them and indicate source of information

CAN YOU TELL US A LITTLE ABOUT THE SURROUNDING AREA

18. Are there any bushland areas (including wetlands) near to this area?
Hatrey Estuary, Austin Bay, Robert Bay.

If yes, how close are they? *Adjacent*.....

Are they already conservation reserves? *No. only Meallup Pt 2738.*

What is their approximate size? *Meallup Pt Nature Reserve 2739 is 29.5 ha.* }

19. Does the submitted area link other bushland areas?

Yes.....

Please attach any additional information about the area which may be of use when assessing it.

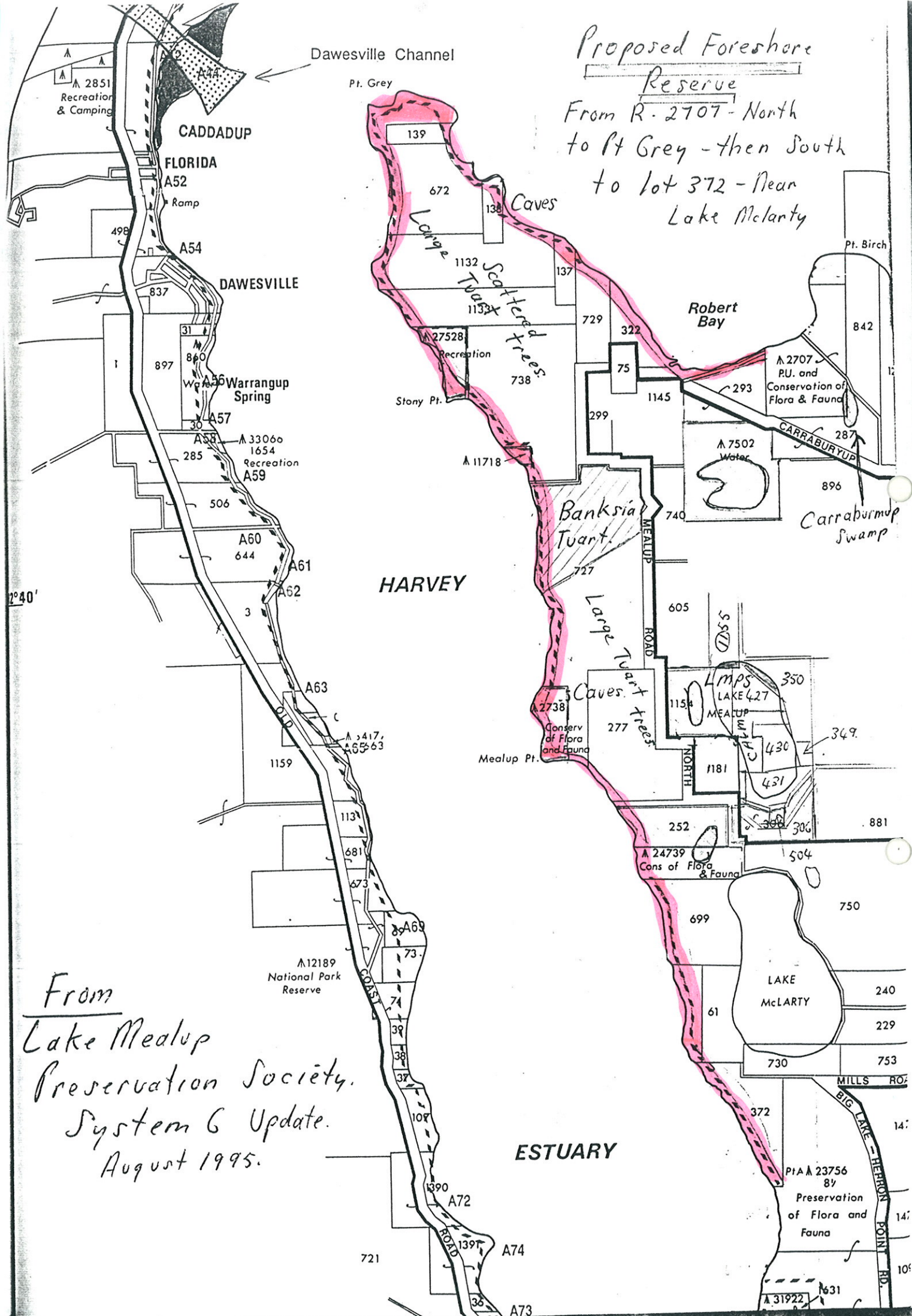

From
 Lake Mealup
 Preservation Society.
 System G Update.
 August 1995.

Proposed Foreshore
 Reserve
 From R. 2707 - North
 to Pt Grey - then South
 to lot 372 - Near
 Lake McLarty

ESTUARY

Carraburup
 Swamp

Banksia
 Tuart.

Caves
 Conserv of Flora
 and Fauna

Stony Pt.

Robert
 Bay

Pt. Birch

Davesville Channel

Pt. Grey

CADDADUP

FLORIDA
 A52

DAWESVILLE

Warrangup
 Spring

HARVEY

MEALUP
 ROAD

ROAD

ROAD

ROAD

MEALUP
 NORTH

MEALUP
 NORTH

MEALUP
 NORTH

MEALUP
 NORTH

MEALUP
 NORTH

MEALUP
 NORTH

MEALUP
 NORTH

MEALUP
 NORTH

MEALUP
 NORTH

MEALUP
 NORTH

A 24739
 Cons of Flora
 & Fauna

A 12189
 National Park
 Reserve

Pt A 23756
 87
 Preservation
 of Flora and
 Fauna

BIG LAKE - HEERON
 POINT RD.

721

A72

A74

A73

14'

14'

10'

2°40'

SYSTEM 6 UPDATE

Addition to C51 Harvey Estuary and Locality C52 Lakes McLarty and Mealup

The Lake Mealup Preservation Society strongly supports the listing of Localities C51 and C52 as shown in the System Six Red Book. However, these recommendations do not include all of the land which has conservation value on the eastern side of the Harvey Estuary. At present there is a core of isolated nature reserves adjoined by high quality privately owned bushland and buffers of parkland cleared farmland.

The potential exists to create a contiguous reserve from the Harvey Estuary to Yunderup, by acquisition or other arrangements with owners to secure the land adjoining the nature reserves. This would preserve wildlife corridors which are essential if the present value of the nature reserves to fauna is to be maintained.

We recommend that the following additions be made to C51 and C52:

1. A foreshore reserve of sufficient width to provide a wildlife corridor which follows natural boundaries, and which takes into account vegetation, topography and ecosystems. The minimum width of this reserve should be no less than 100 m at any point.

The Foreshore Reserve should commence at Nature Reserve 23756, proceed north through Murray Locations 372, 61, 699, Nature Reserve 24739, Murray Locations 252 and 277, Mealup Point Nature Reserve 2738, Murray Locations 727 and 738, Stony Point Nature Reserve 27528, Murray Locations 1133, 1132 and 672 then south-east along Robert Bay through Murray Locations 139, 672, 138, 1132, 137, 729 and 322 to join Carraburyup Nature Reserve 2707.

2. Lot 252 (next to Nature Reserve 24739) has very good to excellent banksia woodland and a seasonal wetland which is part of the wetland in A class Reserve 24739. Being closer to the foreshore than Lake Mealup and Lake McLarty, the flora is different, with good orchids.

There is a car track running through the block to the mouth of Mealup Drain. A small dump of old vehicle bodies should be removed. Mealup Main Drain dissects Lot 252 but does not detract from its conservation value.

3. Mealup Point Nature Reserve 2738 is not included in the System Six Red Book and should be included in the foreshore reserve (1 above).
4. Reserves 11718 and 27528 should be changed from Recreation to Conservation of Flora and Fauna. They could be vested in NPNCA and managed by CALM.
5. The large block of banksia (approximately 100 ha) in the northern half of Murray Location 727 should be acquired as part of C51. This may be the last opportunity to reserve this bushland before development occurs on the Point Grey peninsula. This would provide a wildlife corridor to Reserves 7502 and 2707.
6. Limestone caves (which are noted on the attached map and briefly discussed in attached information from the W.A. Speleology Group) are potentially of important conservation value.

If action is not taken now to preserve and expand the present reserve system on the eastern side of the Harvey Estuary, then piecemeal development will progressively isolate them in a sea of development, thus exposing them to increased edge effects, which will degrade their natural values.

The proposals we suggest would enable a contiguous reserve system to be secured on the eastern side of the Harvey Estuary.

Submitted by the Lake Mealup Preservation Society (Inc)

c/ 6/53 Ramsdale St
DOUBLEVIEW 6018

Telephone Margaret Telford 399 3493
David James 397 0276

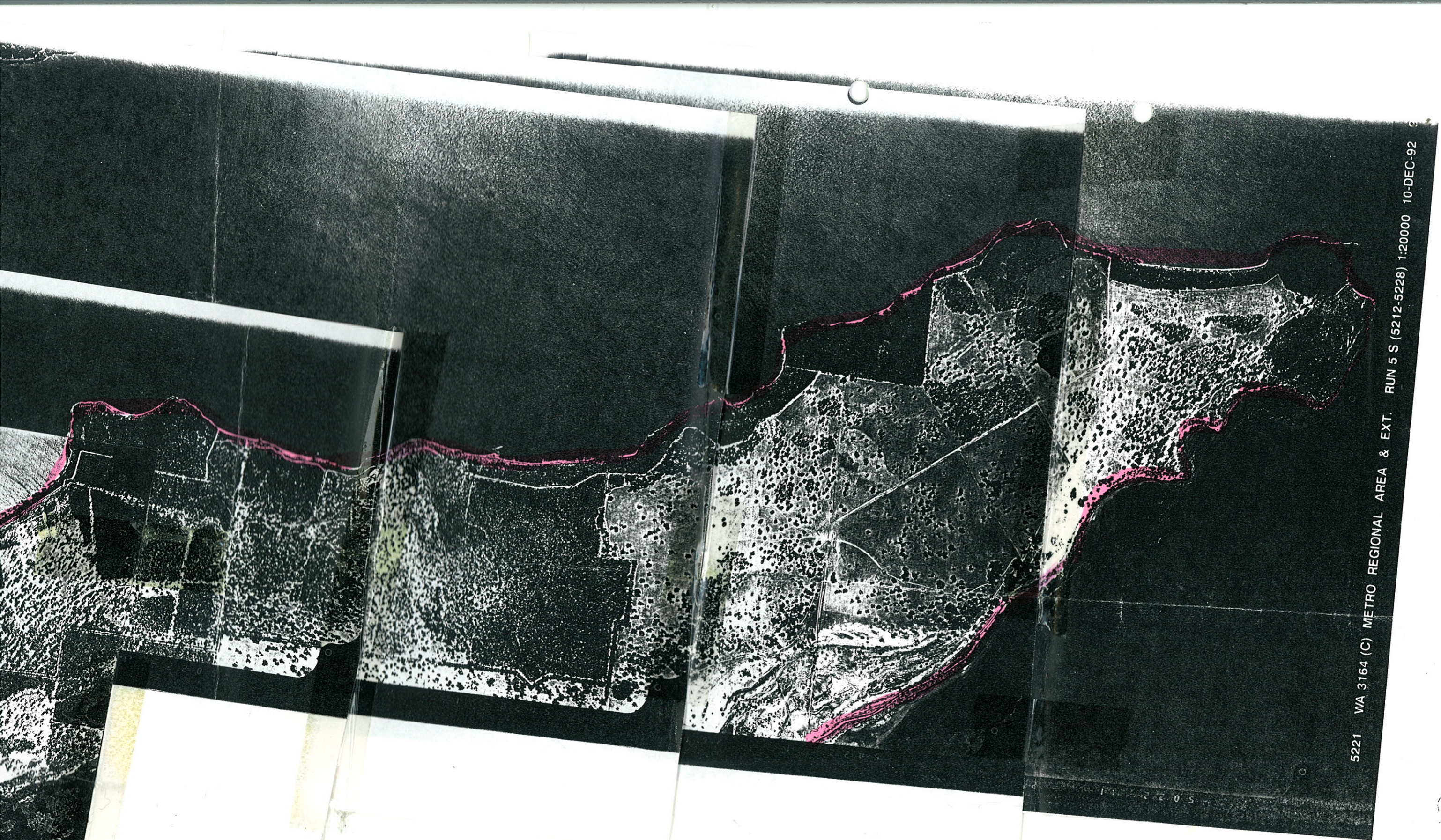

5221 WA 3164 (C) METRO REGIONAL AREA & EXT. RUN 5 S (5212-5228) 1:20000 10-DEC-92

5268 WA 316

4 (C) METRO REGIONAL AREA & EXT. RUN 6 S (5257-5273) 1:20000 10/DEC-92 92C

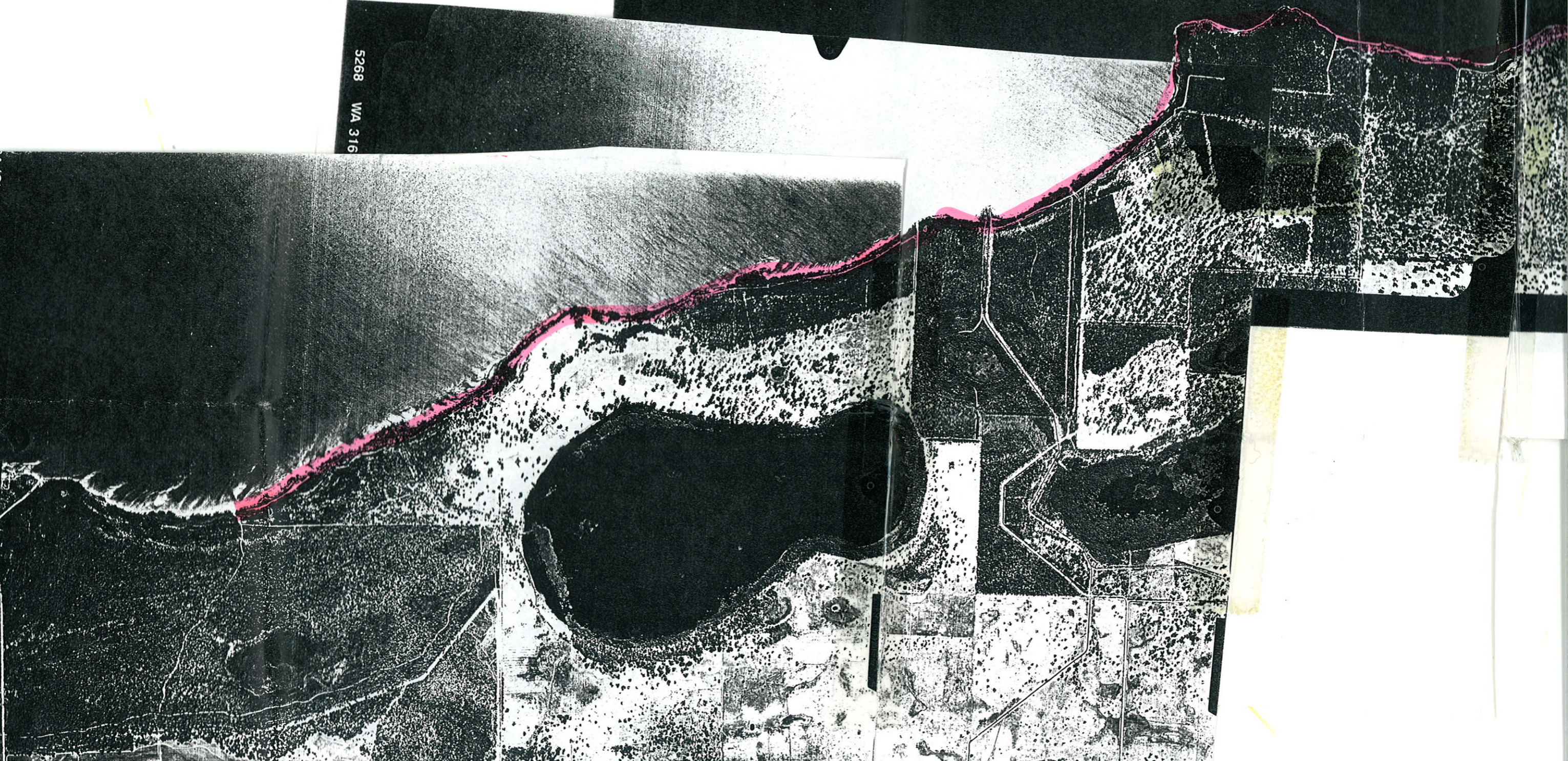

WILD 1574 UAGA
Nr 13037 152,72

000107

-5022 - 1 267 -57 100 0200 0300 402

000000 003221 20 01 25 60 1873

WILD 1574UA6A
Nr 13037 152,72

000109

5022 - 1 267 - 56 100 0200 0300 402

000000 003211 210125 601849

WILD 1574UA6A
Nr 13037 152,72

000110

5022 - 1 268 - 57 100 0200 0300 402

000000 000000 022000 032000 060000 087000

WILD 15/4 UAGA
Nr 13037 152.72

000111

- 5022 - 1 269 - 57 100 0200 0300 402

6481 09 52 10 12 11 23 00 0000000

WILD 1574 UAGA
N: 13037 152.72

100158

- 5022 - 1 269 - 55 100 0140 0300 402

00000 002278 22012560 2613

WILD 1574 UAGA
Nr 13032 152.72

100160

-5022-1 267 -56 100 0140 0300 402

2645 09 60 25 10 12 28 20 00 00 00 00

WILD 15/4 UAGA
Nr 13032 152.72

000161

- 5 0 2 2 - 1 2 6 8 - 5 7 1 0 0 0 1 4 0 0 3 0 0 4 0 2

0 0 0 0 0 0 0 2 2 8 2 2 3 0 1 2 5 6 0 2 6 1 2

WILD 1574 UA6A
Nr 13037 15272

000163

-5022-1269-5610001400320402

0000000022780022780220125602613