

I have been in Sydney please accept my late submission as I care so much about it *Jan 102*

SYSTEM 6 BUSHLAND SUBMISSION FORM FOR CONSIDERATION IN THE UPDATE PROGRAMME

If you wish to submit more than one area for consideration in the System 6 update, please use a separate form for each area.

Please fill in each section giving as much information as possible.

LOCATION, OWNERSHIP AND ZONING OF THE AREA

1. Location

Please give as accurate and detailed a description as possible of the site location

Please include either a hand drawn or copied map showing the area of the area

a) Bordering Roads: PERON AVE, CAVES ROAD, HOUSES EAST WEST N 7 S

b) Nearest Corner: OPPOSITE 21 PERON AVENUE

c) Lot Number: Street Number:

d) Town/Suburb/Location: DUNSBOROUGH WA

e) Local Council: BUSSELTON

f) Site Name (if any): ? RESERVE

g) Approximate size of the area (ha): 10 ha approx probably less.

h) Please locate the area on a map and give us map references if possible:

OPPOSITE ENTRANCE TO GOLF CLUB (DUNSBOROUGH LAKES) RESORT GOLF CLUB

i) Map: Streetsmart /UBD/Other: CAVES RD.

j) Map no.:

k) Grid Ref: PRIVATE HAND PERON AVE

l) Please give any other information that may help us to find the location: [21]

m) Are you aware of any development proposals that are likely to affect the area?

NO

NOTE: Areas that have already been given development APPROVAL should not be nominated

Please fill out those questions that you can answer

2. Who owns the area? (If owned by the person/s making the nomination please indicate) BUSSINGTON COUNCIL

3. If you own the area, and may be interested in participating in conservation on private land initiatives please indicate (and leave your name and address at the end of this submission form)

4. What is the area zoned? (please indicate whether zoning is Town Planning Scheme or Metropolitan Region Scheme) ? OPEN SPACE

CAN YOU TELL US A LITTLE ABOUT THE PHYSICAL CHARACTERISTICS OF THE AREA

5. Why do you consider this area important? (Refer to Guiding Issues paper)

NATURAL WETLAND, FISH, INSECTS, REPTILES
REMNANT BUSHLAND, WATER BIRDS, FROGS

6. What is/are the soil type/s and colours ? WHITE SAND & CLAY

Type: Sand/Clay/Gravel/Loam/Silt

Colour: White/Grey/Brown/Orange/Yellow/Red/Black

7. Does the area have any special features such as unusual landforms / landscapes that still retain their natural vegetation? Yes / No

If yes, what are they? WETLAND, PAPER BARKS, REMNANT VEGETATION.

8. Is the area a wetland or does it include a wetland? YES

If yes, what kind of a wetlands is it?

a) lake SUMMER

b) river

c) stream

d) swamp

e) estuary ? WINTER PART OF HOUSING MAY HAVE CUT IT OFF NOW HAS PIPE DRAIN TO OCEAN

f) seasonally wetter

g) other

9. What percentage of the wetland is open water in summer?

CAN YOU TELL US A LITTLE ABOUT THE VEGETATION /FAUNA ON THE NOMINATED AREA.

10. What percentage of the area is indigenous vegetation? $\frac{3}{4}$ or more

11. If the area includes regions cleared of native bushland please indicate reasons for the inclusion.

LOCAL RESIDENT OBTAINED COUNCIL PERMISSION TO BULLDOZE AREA OPPOSITE HOUSE TO GROW GRASS & DAFFODILS HAS NOW SAVED & LEFT THE AREA. COUNCIL FEEL THIS WAS INCORRECT & NO PERMISSION SHOULD HAVE BEEN GIVEN?

12. Has any previous flora or fauna survey work been done on the area?

I WOULD THINK NOT AS A HOUSING DEVELOPMENT WAS PLACED ON EXISTING WETLAND & REMNANT VEG AT THE TIME. PLEASE GIVE DETAILS OF THE WORK. SOUTHERN BIRD. WHAT'S NEW !!

DUNSBOROUGH WAS NOTED FOR ITS WILD FLOWERS THEY WILL SOON BE GONE THANKS TO PROGRESS

13. How would you rate the condition of the native bushland? (see attached table)

- a) pristine
- b) excellent
- c) very good
- d) good ✓
- e) degraded
- f) completely degraded
- g) don't know

PORTION SMALL. ~~1/2~~ acre approx

14. Please indicate the disturbances affecting the area and where appropriate the percentage of the area disturbed.

a) LITTER FROM THROW AWAY PACKAGING I GUESS IT LOOKS LIKE A GOOD RUBBISH DUMP SITE.

- a) Partial clearing
- b) fragmentation
- c) Selective removal of species: timber cutting, wildflower picking, mowing (dieback and other plant diseases WHO KNOWS IM NOT A SCIENTIST)
- d) Fire regime, including intensity, season and frequency
- e) 'Enrichment plantings' that is plantings of species not found in that community A FEW
- f) Weed invasion ALONG THE ROAD VERGES
- g) Animal impact: horses, foxes, rabbits, cats, dogs, camels, goats etc
- h) Soil movement, both removal and dumping OF RUBBLE & WEEDS FROM NEW DEVELOPMENT AREA
- i) Changes in water regimes; flooding, drainage and watering
- j) Salinity
- k) Fertiliser drift and along waterways nutrient influx ONE WOULD THINK SO
- l) Mining, including that for road works DRAWS NOT MAINTAINED PROPERLY
- m) I HAVE NOTICED THAT WITH THE INCREASE OF HOUSES BANK EROSION IS NOW EVIDENT AT THE LAKE EDGES
- n) CHANNEL (FOR WATER DRAINING FROM HOUSING ESTATE) IS ERODING AS DEVELOPERS HAVE NOT BE VEG BANKS AS WAS IN THEIR CONTRACT TO DO SO

- m) Grazing: stock, overgrazing by feral or native mammals
 - n) Proliferation of tracks, fire breaks and walk trails
 - o) Off-road vehicle use CROSSING IT IN SUMMER
 - p) Use as service corridors by the SEC, Main Roads, Water Authority. CAVES ROAD SIDE
- (Source: B Keighery. Bushland Plant Survey, September 1994)

15. Does the area contain any plant species of special interest that you know of? (eg. declared rare flora, priority taxa, outlier populations) IT HAS NOT BEEN STUDIED.

Do you know what they are?

16. Do you know of any native animals that use the area? YES

Can you list those you know of? (birds, mammals, reptiles, amphibians etc)
GREEN FROG, WADING BIRDS, BOBTAIL GOANNA, FISH? TYPE

17. Is the area used by any native animals of special interest? (eg. endangered species, large/important populations).....

If yes, please name them and indicate source of information
GREEN FROGS - I UNDERSTAND FROGS ARE A SIGN OF A HEALTHY ENVIRONMENT THEY DON'T SING AS LOUD AS THEY USED TO OR IS AGE MAKING ME DEAF.

CAN YOU TELL US A LITTLE ABOUT THE SURROUNDING AREA

18. Are there any bushland areas (including wetlands) near to this area?
YES

If yes, how close are they? TOBYS INLET 2 KM.

OPPOSITE ARTIFICIAL LAKES FROM DUNSBOROUGH LAKES ESTATE COASTAL LOW DUNES 1/2 KM. CONNECTED TO OCEAN VIA PIPE AND DRAIN

Are they already conservation reserves? YES ? DUNSBOROUGH LAKES NOT SURE IF THEY ARE PUBLIC OR OWNED BY GOLF CLUB.

What is their approximate size?

TOBYS - 100 ha GUESSING COASTAL DUNES - 100 ha

19. Does the submitted area link other bushland areas?

ONLY BY DRAIN TO COASTAL DUNES & BY AIR

IT LOOKS LIKE DRAINS CONNECT TO ALL OF DUNSBOROUGH AREA.

Please attach any additional information about the area which may be of use when assessing it.

A SYSTEMS DUNSBOROUGH WOULD BE GOOD TO LOOK AT.

TO: NATALIE - E.P.A.

FROM: JOHN KLOPIC - SHIRE OF BUSSELTON

RE: RESERVE 30148

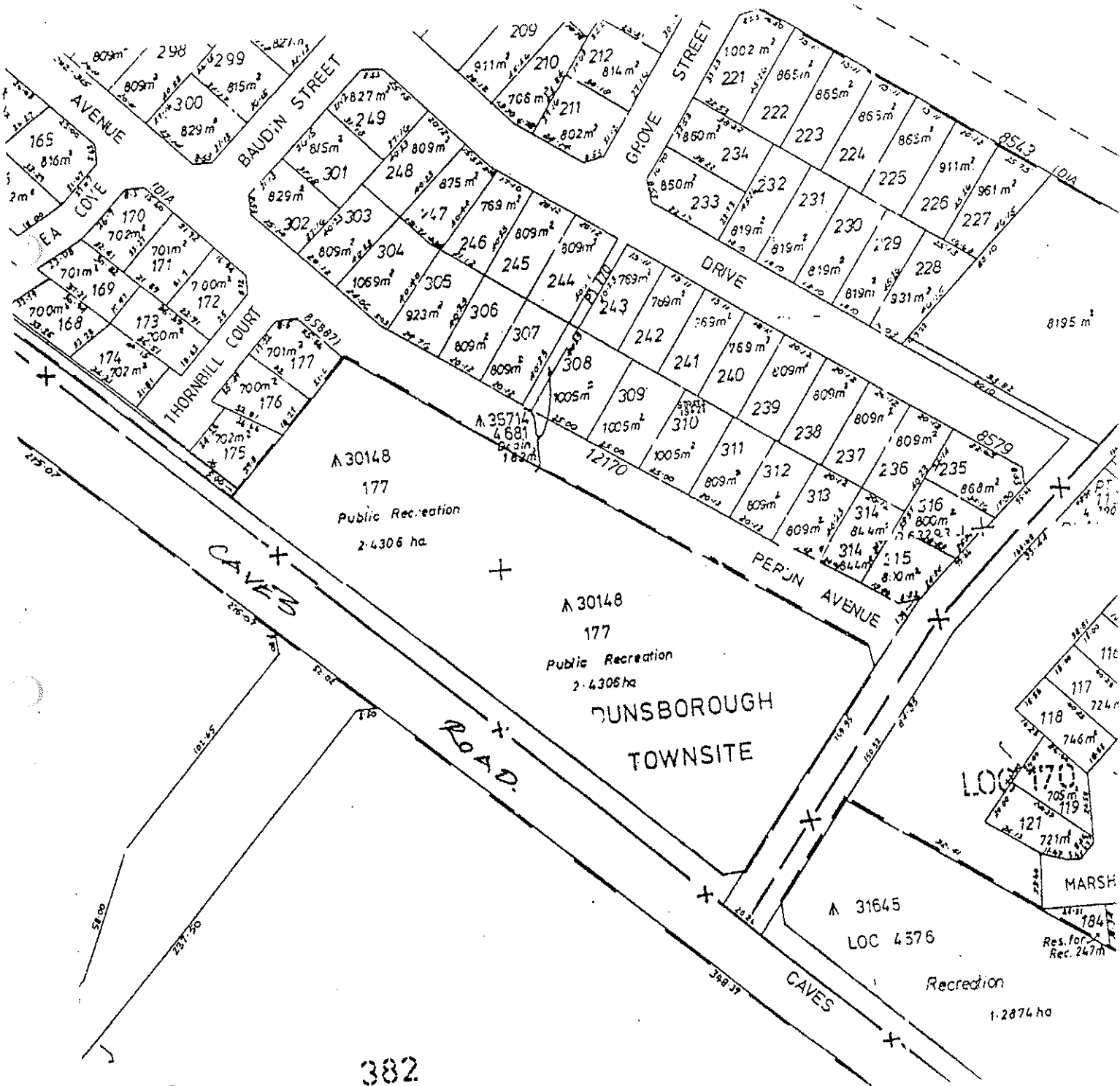

382

5-2-96

H.T.S.

WILD 15740AGA
Nr 13037 152.72

000067



5022-1 268-58 100-0160 024056

000000 002620 22012560 2353

5056

WA 2933(C) SWAN COASTAL PLAIN RUN 1 (5054-5058) 1:25000 28.11.90 900706